



SCULPFUN TS1 Laser Controller User Manual

[Home](#) » [SCULPFUN](#) » SCULPFUN TS1 Laser Controller User Manual 

Contents

- [1 SCULPFUN TS1 Laser Controller](#)
- [2 Overview](#)
- [3 List Of Accessories](#)
- [4 Usage On S9](#)
- [5 Interface Introduction](#)
- [6 Usage](#)
- [7 Matters needing attention](#)
- [8 Documents / Resources](#)
 - [8.1 References](#)



SCULPFUN TS1 Laser Controller



Overview

SCULPFUN Touch Screen TS1

- SD card
- Carte SD
- SD-Karte
- Tarjeta SD
- Scheda SD
- Karta SD



- Type-C interface
- Typ-C-Schnittstelle
- Interfaccia di tipo C
- Interface type - C
- Interfaz tipo - C
- Interfejs typu C

- USB port
- Port USB
- USB-Anschluss
- Puerto USB
- Porta USB
- Port USB

- Power interface
- Interface de puissance
- Stromversorgung
- Interfaz de alimentación
- Interfaccia di alimentazione
- Interfejs Stroma

- Stand bracket
- Support de plaque arrière
- Ständer/Halterung
- Soporte de la placa posterior
- Staffa di supporto
- Achterbordbeugel

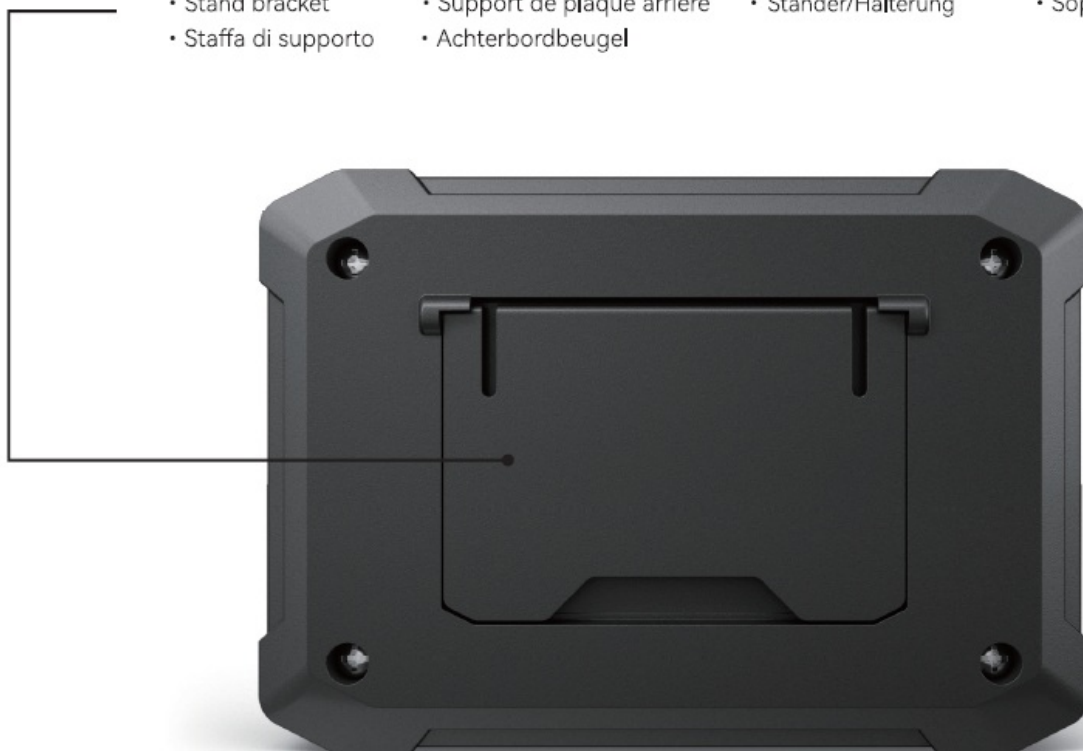

List Of Accessories

SCULPFUN Touch Screen TS1



- Power cord * 1
- Touch screen * 1

- Instruction manual * 1
- SD card * 1
- Card reader * 1

Usage On S9

Touch screen installation



- Connect USB cable to touchscreen and engraving machine

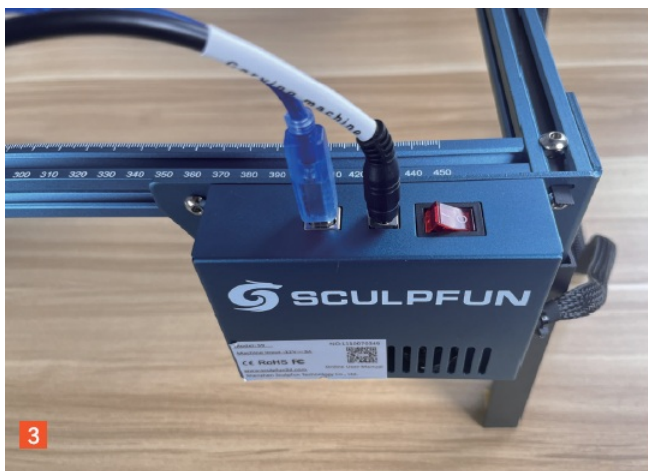

- Connect one and two power cables to the touch screen and the machine, and press the switch to turn it on

Interface Introduction

Main interface

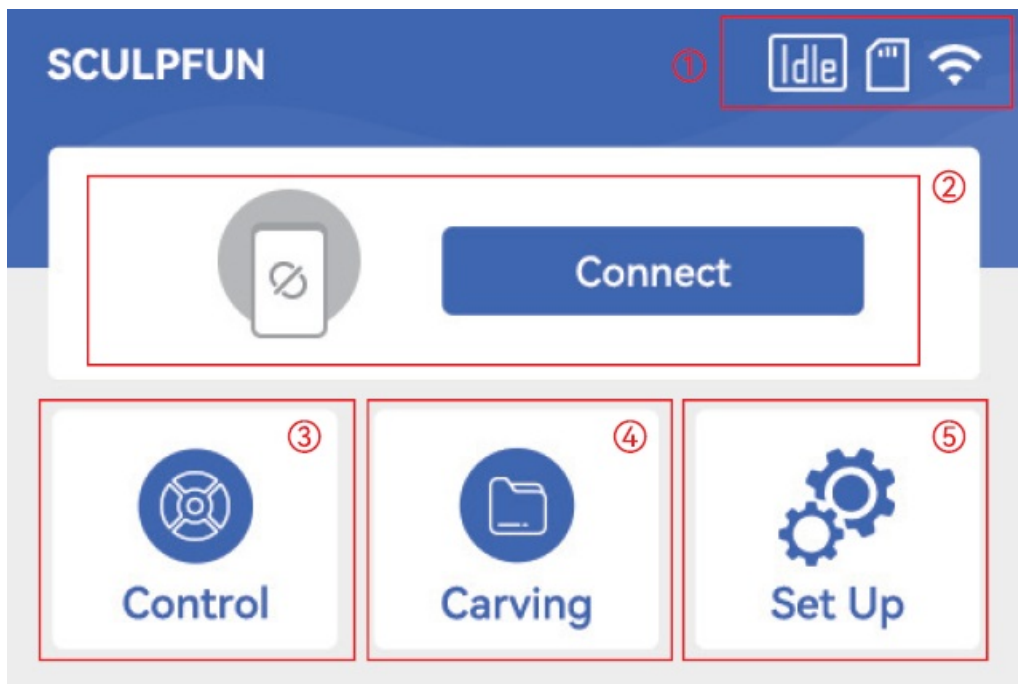

- It is mainly divided into 5 modules, status bar (1) / connection status (2) / control interface (3) / SD card files (4) / touch screen settings (5)

Control interface

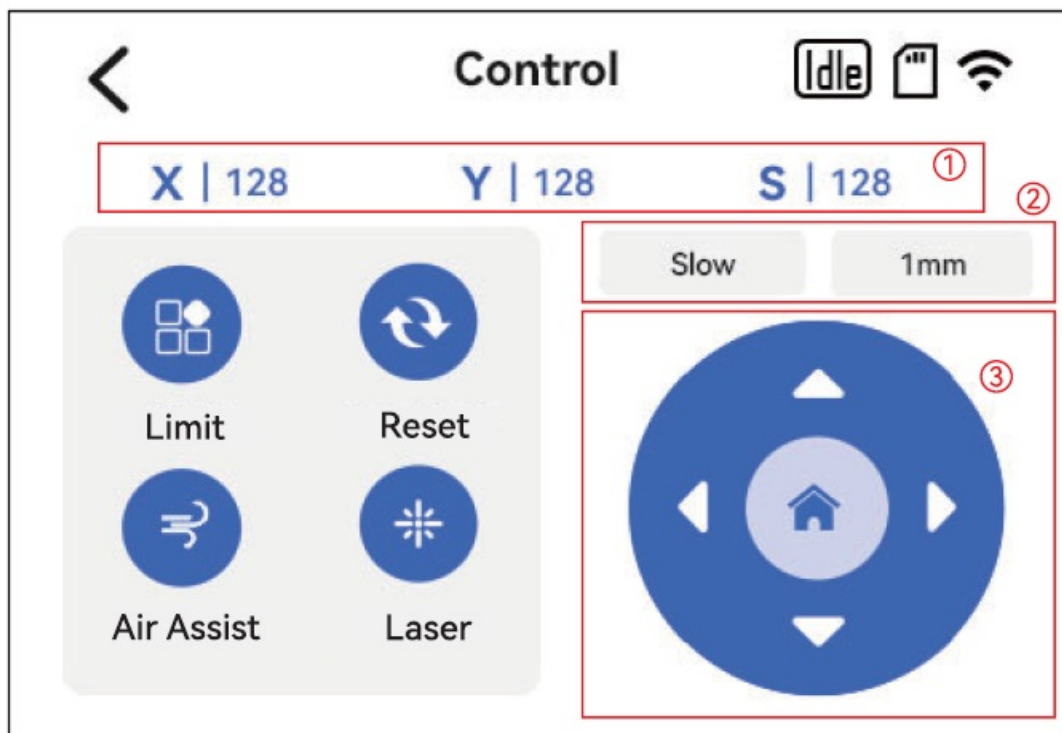

1. Current laser position coordinate information
2. Movement speed / distance
3. Move up, down, left, and right respectively
 - **Reset:** Return to the original position of the machine

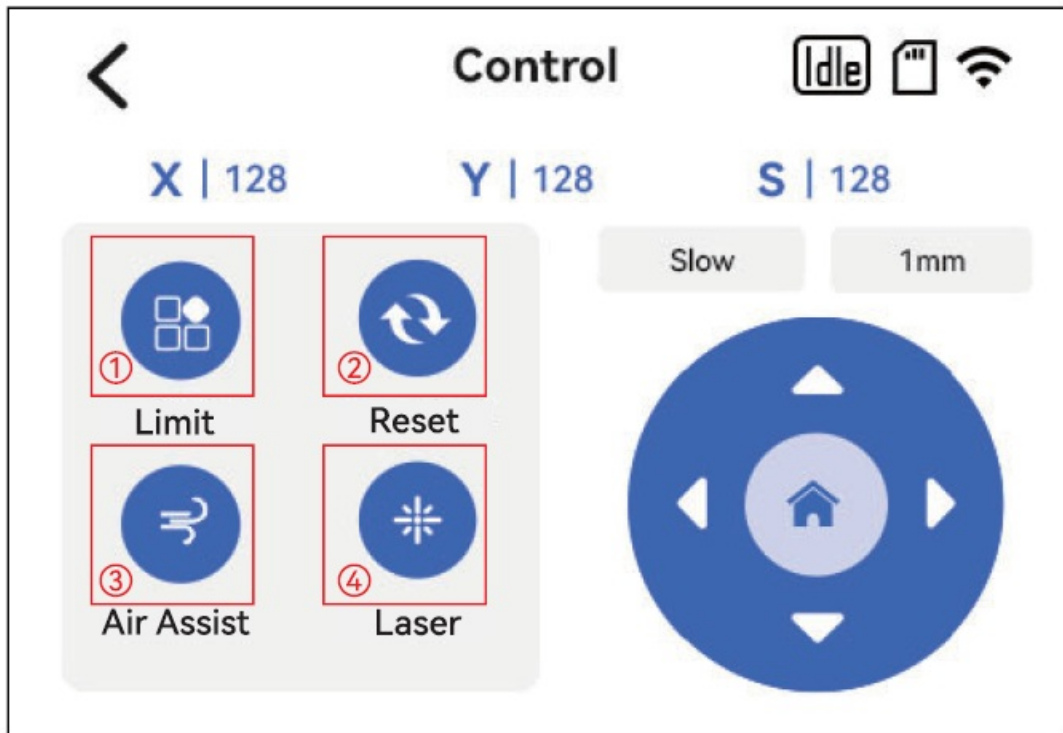

1. **Hard limit switch:** After opening, press “Homing” button to return to the origin, it will touch the limit switch to stop. After closing, press “Homing” button to return to the origin, it will return to the user’s origin.
2. **Reset button:** After the touch screen reports an error, clicking it will reset the touch screen.
3. **Air pump switch:** controls the air pump connected to the engraving machine.
4. **Laser preview switch:** When turned on, the laser will be previewed at 3% power.

File interface

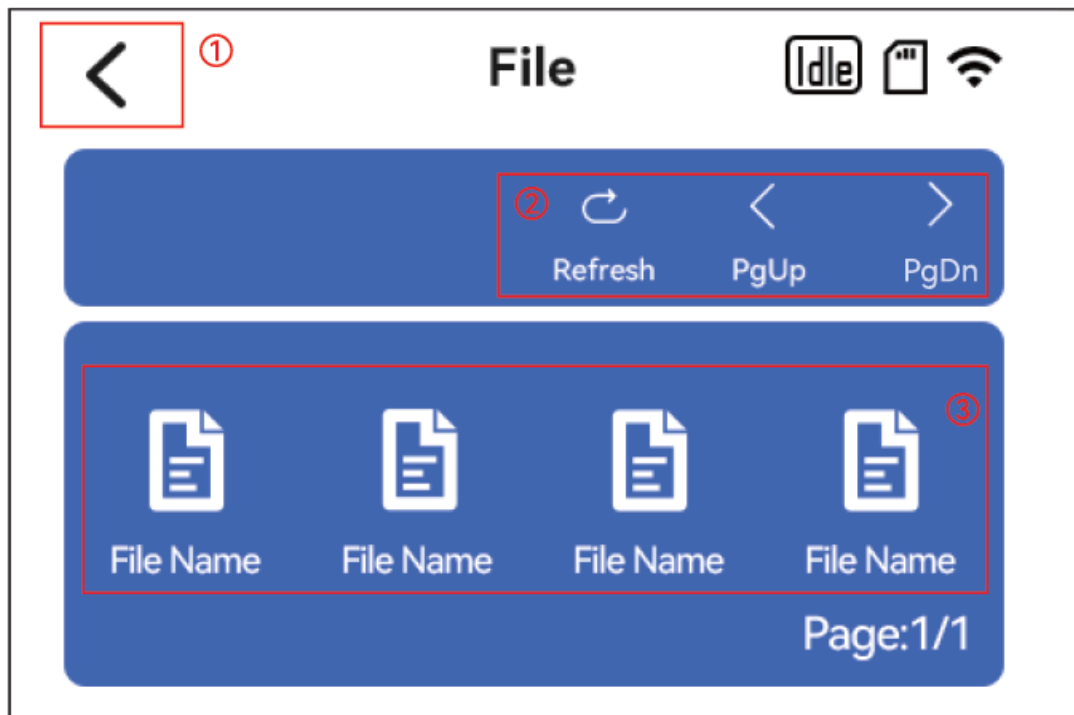

1. Go back to the previous page
2. Refresh/Previous / Next Page

3. Select the corresponding file name for engraving

Click the carving button to enter the carving page

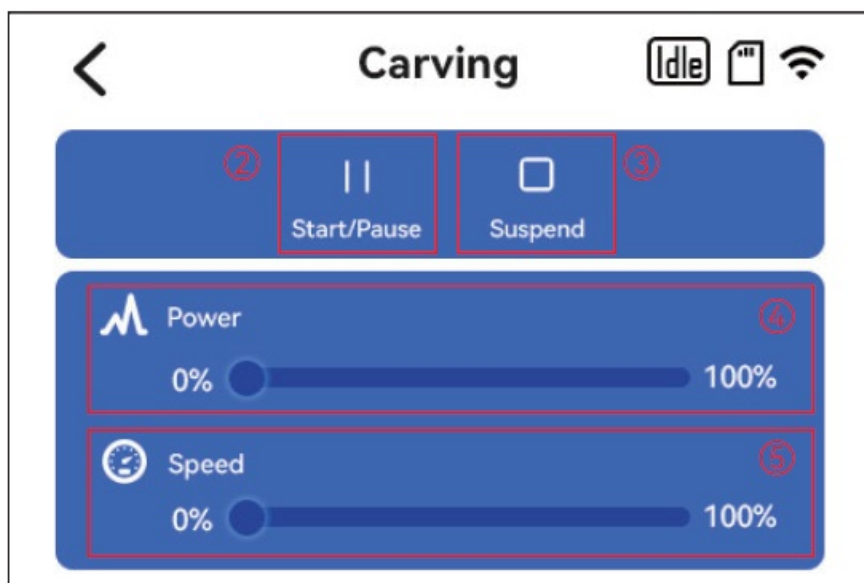
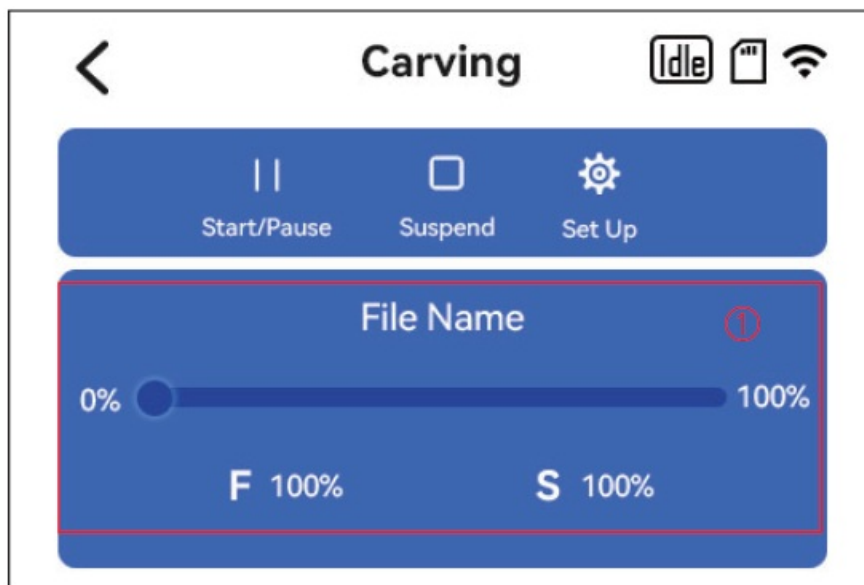

1. Display the name and completion percentage of the engraving file
2. Start/Pause button
3. Stop engraving button
4. Power coefficient adjustment
5. Speed coefficient adjustment

Settings interface

System language settings



- Supports English, French, German, Italian, Spanish, and Polish

Wireless network selection

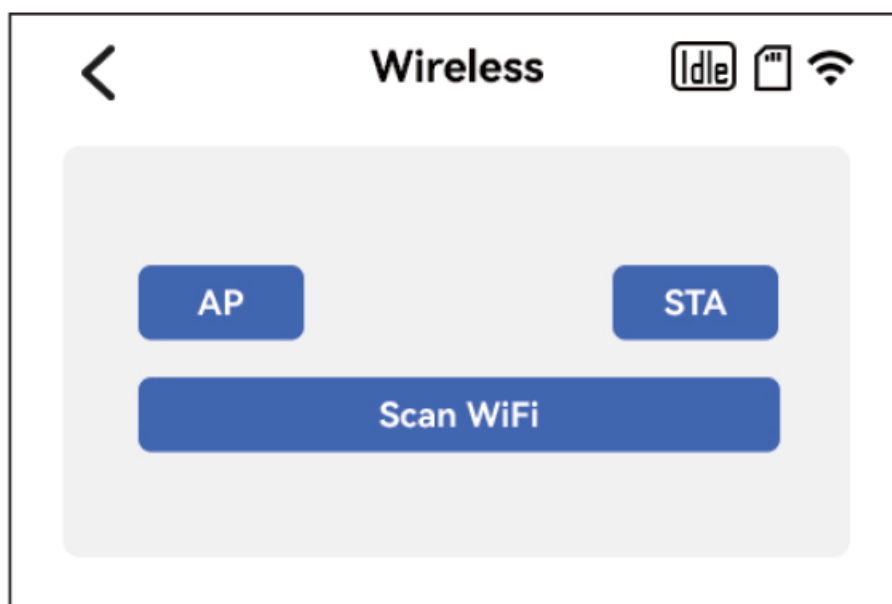

- You can choose AP / STA, or search nearby networks

Usage

Computer use



- Remove the SD card and insert it into the computer using a card reader

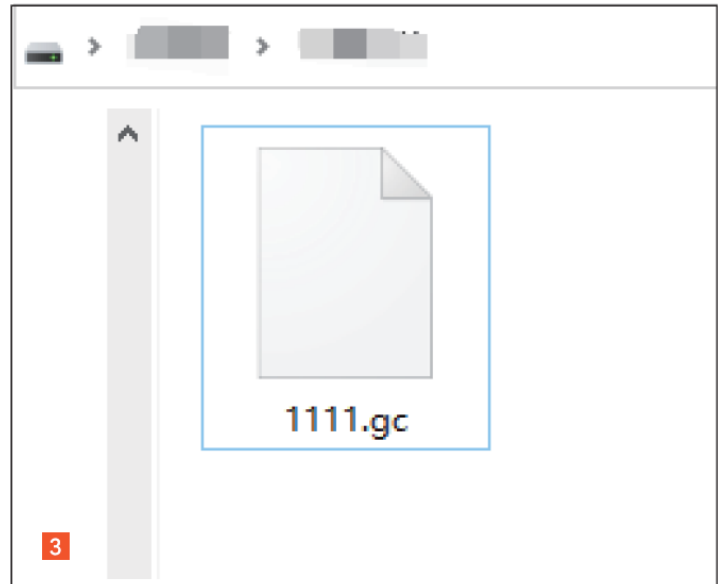
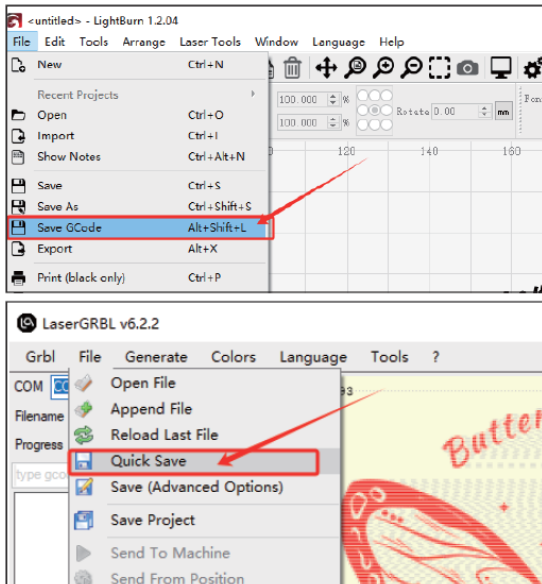

- Copy the Code file of lightburn or LaserGRBL to the SD card and insert it back into the touch screen



- Select the needed file and engrave it

Using mobile apps

AP mode



- Enter touch screen settings and select wireless settings



- Wireless mode selection AP mode
- Phone connected to touch screen WiFi,
 - WiFi name is Sculpfun TS1 XXXXX, default password is 12345678

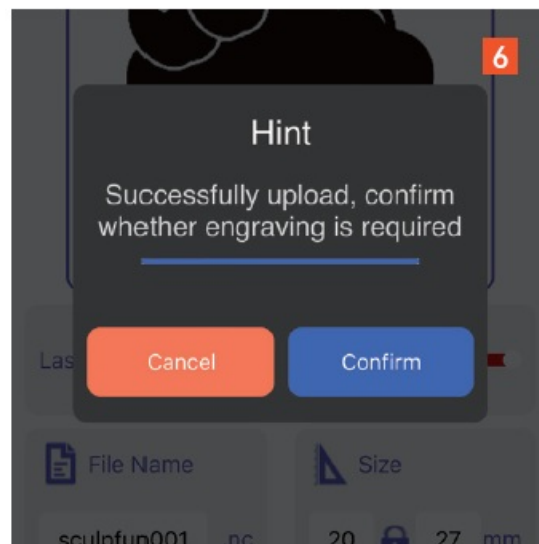
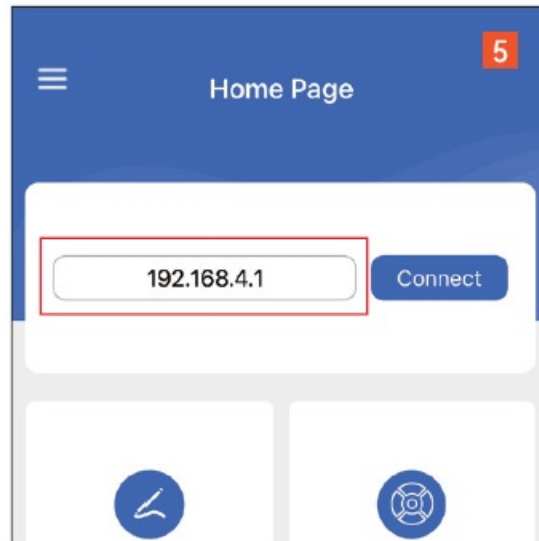

- Open the Sculpfun app on your phone and enter the IP address 192.168.4.1
- After successful connection, you can use the mobile app for slicing

Specific mobile app usage tutorial



Using mobile apps

STA mode



- Touch screen wireless mode selection STA mode



- Scan and connect to WiFi at home, Only supports 2.4GHz networks and must be connected to the same network as the phone
- In the touch screen wireless settings, view the current IP address

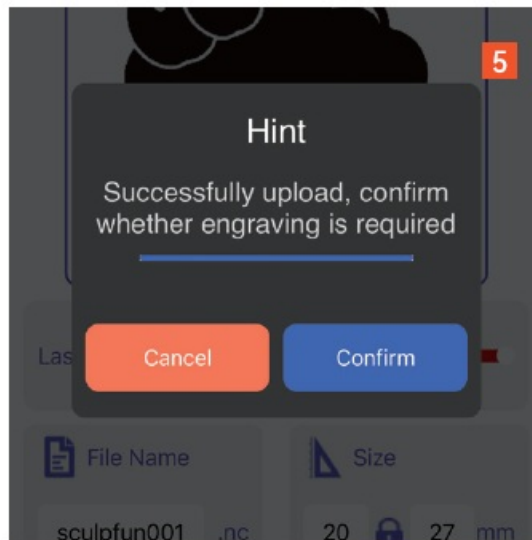
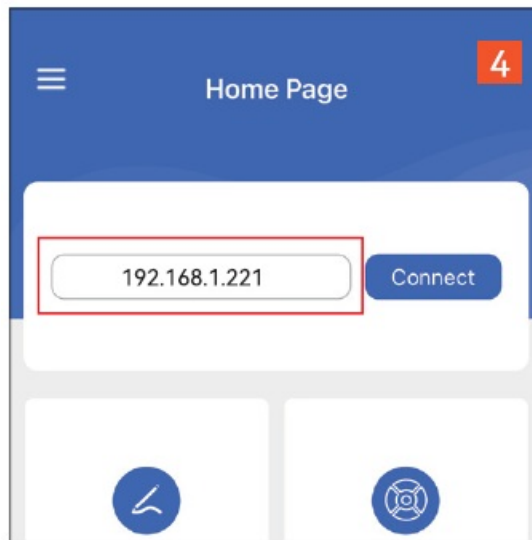

- Open the Sculpfun app on your phone and enter the corresponding IP address
- After successful connection, you can use the mobile app for slicing

Specific mobile app usage tutorial



Matters needing attention

1. It is recommended to prioritize using AP mode for Wi Fi connections, as STA mode may be affected by router performance or other connecting devices, resulting in poor user experience.
2. When using the app to slice, the slice upload failed. Please try restarting the touch screen, reinserting and unplugging the SD card, and switching to AP mode to connect to the touch screen Wi Fi to reduce interference.
3. Touch screen WiFi connection, only supports 2.4GHz band WiFi, not 5GHz WiFi.

4. If this is your first time using this product, please carefully read the accompanying materials to improve your user experience. If this product is not used according to the instructions and requirements, or due to improper use of the product, SCULPFUN shall not be responsible for any losses caused.
5. SCULPFUN has carefully checked the manual content, but there may still be errors or omissions. We are committed to continuously improving the functionality and quality of our products and services, and therefore reserve the right to make changes to the manual and the products or software described in the manual without prior notice.

Contact

- E-mail support@sculpfun.com
- Website sculpfun.com

Video tutorials & more help



Documents / Resources



[SCULPFUN TS1 Laser Controller](#) [pdf] User Manual
TS1 Laser Controller, TS1, Laser Controller, TS1 Controller

References

- [User Manual](#)

[Manuals+](#), [Privacy Policy](#)

This website is an independent publication and is neither affiliated with nor endorsed by any of the trademark owners. The "Bluetooth®" word mark and logos are registered trademarks owned by Bluetooth SIG, Inc. The "Wi-Fi®" word mark and logos are registered trademarks owned by the Wi-Fi Alliance. Any use of these marks on this website does not imply any affiliation with or endorsement.