

sctelcom Calix QSGCommandIQ App User Guide

[Home](#) » [sctelcom](#) » sctelcom Calix QSGCommandIQ App User Guide 



Calix QSGCommandIQ App User Guide

Contents

- [1 Calix QSGCommandIQ App](#)
- [2 Documents / Resources](#)
 - [2.1 References](#)
- [3 Related Posts](#)

Calix QSGCommandIQ App

Getting started with the App

The App allows you to manage your home or small business Wi-Fi network. You can self-install and be managing your home or business within a few minutes.

Download the app and start managing your home network today!

Next: Refer to the SCT WiFiConnect Consumer Product Guide for details on how to use specific features.

Need help?

Contact support: sctelcom.net/internet/home-support-apps (877) 723-6875

1. Download the app. You can search either the Apple App Store or Google Play Store for: SCT WiFiConnect then installs it on your mobile device.



2. Select "SIGN UP" towards the bottom of the screen.

The screenshot shows the login screen of the SCT WiFiConnect app. At the top, it says "Welcome to SCT WiFiConnect". Below this is a "Login" section with the text "Everything you need to secure and control your home network and connected devices." There are three input fields: "Email" with the value "jamie.lee@gmail.com" and a green checkmark, "Password" with the value "CommandIQ1" and an eye icon, and "Location" with the value "USA" and a dropdown arrow. A "Login" button is at the bottom, and a "Forgot Password?" link is at the very bottom.

3. Enter your personal information. The password you enter here will be used to access the app.
Note: Please wait at least 10 minutes after your BLAST System has been 'turned up' before attempting step 4.

9:41

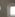
all  

Step 1 of 3

Sign Up

Create a new account

First Name

Jamie

Last Name

Lee

Email

jamie.lee@gmail.com 

Password



Location

USA 

☒ I accept the [terms & conditions](#) & [privacy policy](#)

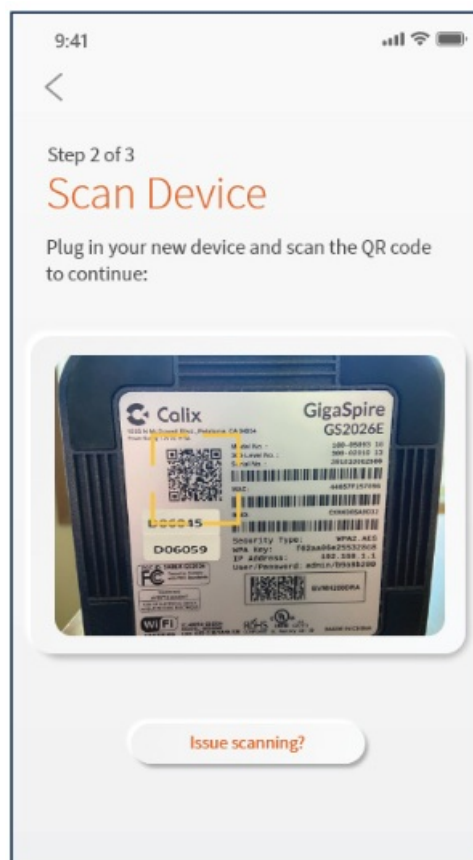

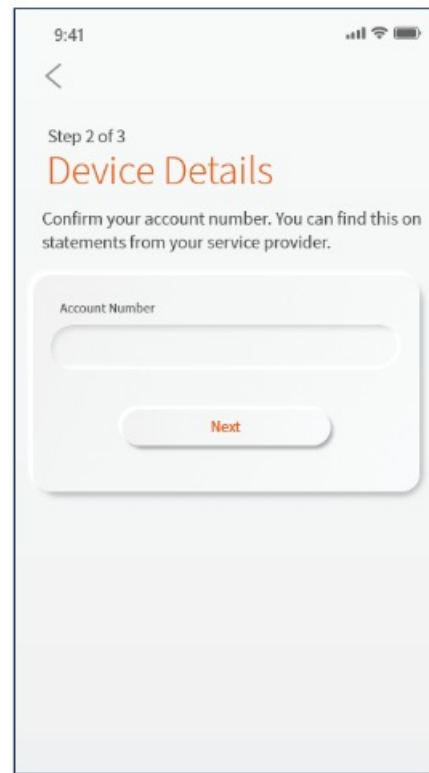
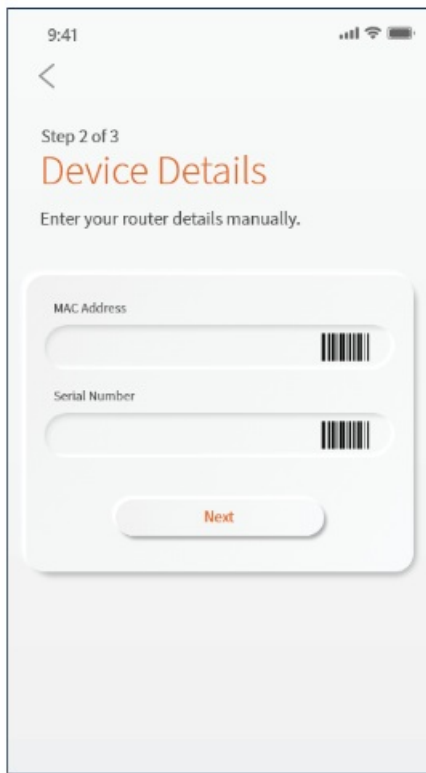

4b Unplug the device and remove all cables.
Wait 2 minutes.



4c After 2 minutes, plug the device back in and turn it on.

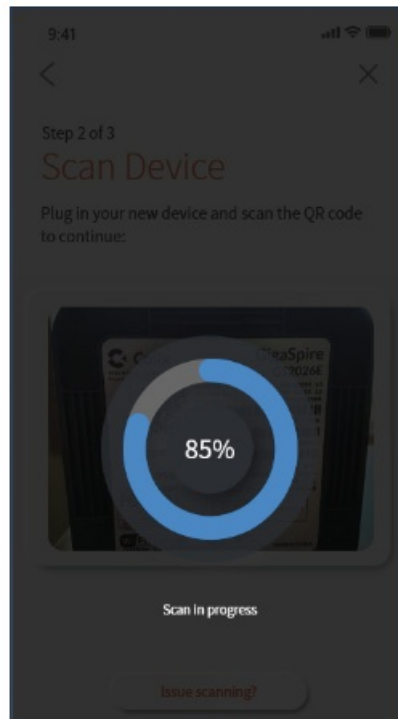

4d Connect the ethernet cable from the ethernet/ LAN port on your existing internet service devices to the port labeled WAN on your new system.

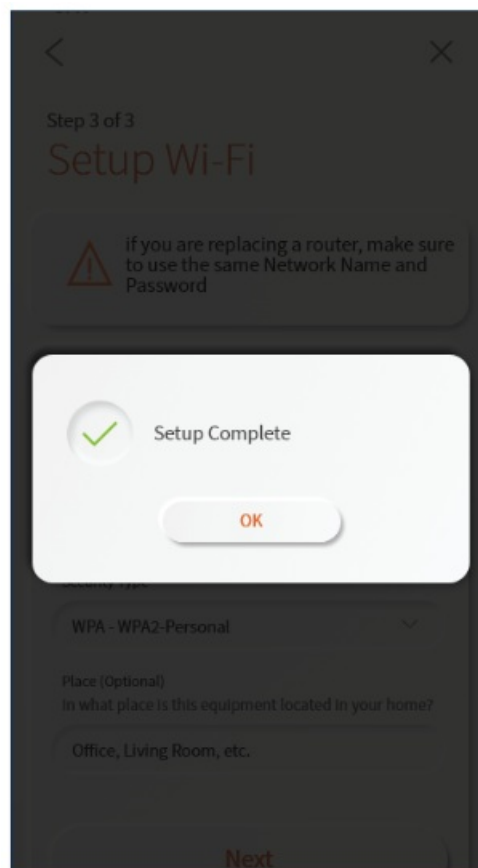

4e Now, connect your new system to a power outlet.

It may take several minutes for the unit to be ready. It will show a solid blue light. Once the device is connected, tap "Unit Ready."

Go back to step 5 on the previous page.

9:41

< X

Step 3 of 3

Setup Wi-Fi

 If you are replacing a router, make sure to use the same Network Name and Password

Network Name (SSID)

Jamie's Wi-Fi

Password

.....

Encryption Type

WPA - WPA2-Personal

Place (Optional)

In what place is this equipment located in your home?

Office, Living Room, etc.

5. Tap the QR code that appears within the app. (You will be asked to allow the app to access your camera.) Point your camera at the QR Code found on the bottom of your BLAST System, or on the sticker that came in your box (example shown below). Select OK. After you select "Submit", you may be asked to enter your account number.

Default Settings

SSID: CXNK001870CD

ONU MAC: 000631B41844

Security Type: WPA2.AES

WPA Key: 84f1415608b2cb13

IP Address: 192.168.1.1

User/Password: admin/3f7b1e66



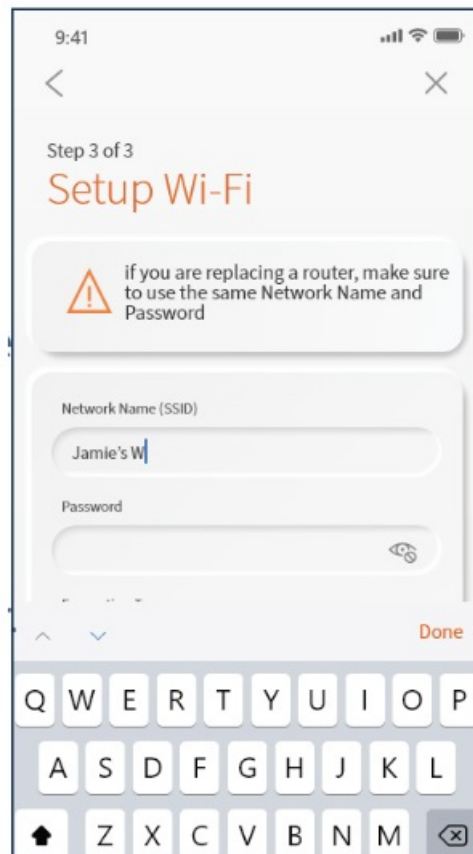

6. **Note:** If your system is already operating with Wi-Fi, tap the “Click here to skip” text.

Otherwise, complete these steps to set-up your Wi-Fi.

Name your network and create a password.

- The Router Name will be used throughout the app.
- The Network Name (SSID) is what you will use as your wireless connection name.
- Select a password for your wireless network, if you do not want to change it on all the devices in your home, use your existing wireless SSID and Password from your current router.

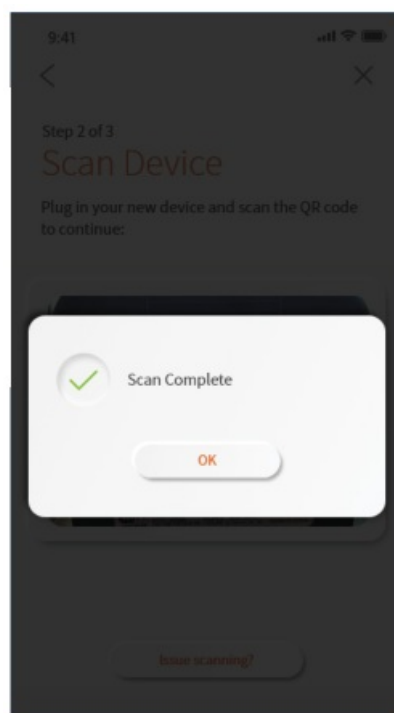

Click Submit and you're all done!

Documents / Resources

	<p>sctelcom Calix QSGCommandIQ App [pdf] User Guide Calix QSGCommandIQ App, QSGCommandIQ App, Calix App, App</p>
---	--

References

-  [Home Support Apps - SCTelcom, central Kansas, north central Oklahoma](#)

Manuals+.