



scs sentinel PAP0014 Additional Monitor User Manual

[Home](#) » [SCS sentinel](#) » **scs sentinel PAP0014 Additional Monitor User Manual** 

scs sentinel PAP0014 Additional Monitor User Manual



Contents

- [1 A-SAFETY INSTRUCTIONS](#)
- [2 B- DESCRIPTION](#)
- [3 C-WIRING/INSTALLING](#)
- [4 D4- Display](#)
- [5 Camera display](#)
- [6 Melody](#)
- [7 F-TECHNICAL FEATURES](#)
- [8 H-WARRANTY](#)
- [9 WARNINGS](#)
- [10 Documents / Resources](#)
 - [10.1 References](#)
- [11 Related Posts](#)

A-SAFETY INSTRUCTIONS

This manual is an integral part of your product.

These instructions are provided for your safety. Read this manual carefully before installing and keep it in a safe place for future reference. Select a suitable location. Make sure you can easily insert screws and wallplugs into the wall. Do not connect your electrical appliance until your equipment is totally installed and controlled. The installation, electric connections and settings must be made using best practices by a specialized and qualified person. The power supply must be installed in a dry place. Check the product is only used for its intended purpose. The function of this videophone is to identify a visitor, it must not be used for street surveillance. The use of this installation must be in compliance with the French law n° 78-17 of January 6, 1978 relating to data processing, files and freedoms. It is up to the buyer to ask the CNIL about the conditions and administrative authorisations required for use outside a strictly personal context. SCS Sentinel cannot be held responsible in case of use of this product outside the laws and regulations in force.

B- DESCRIPTION

B1-Content/Dimensions

Indoor monitor

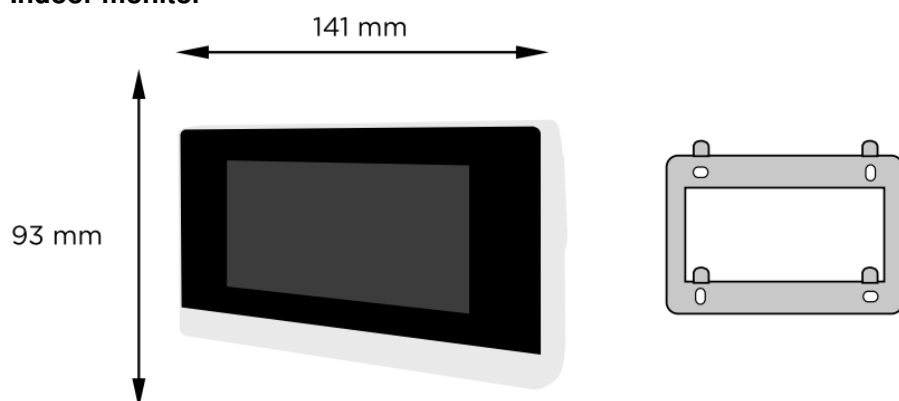

Adapter

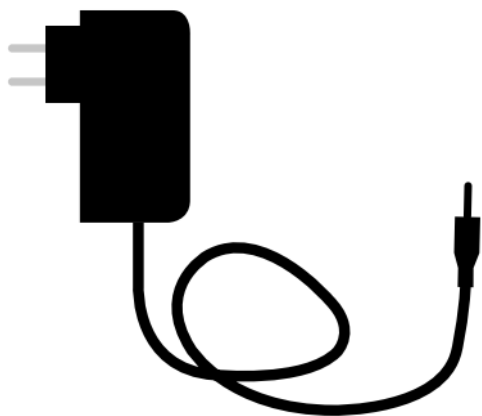

Screws

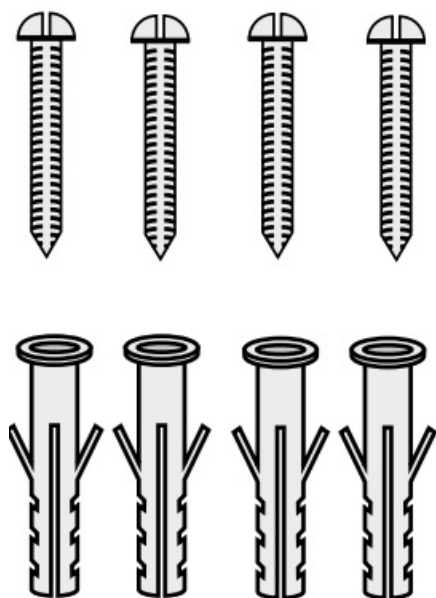

B2-Components

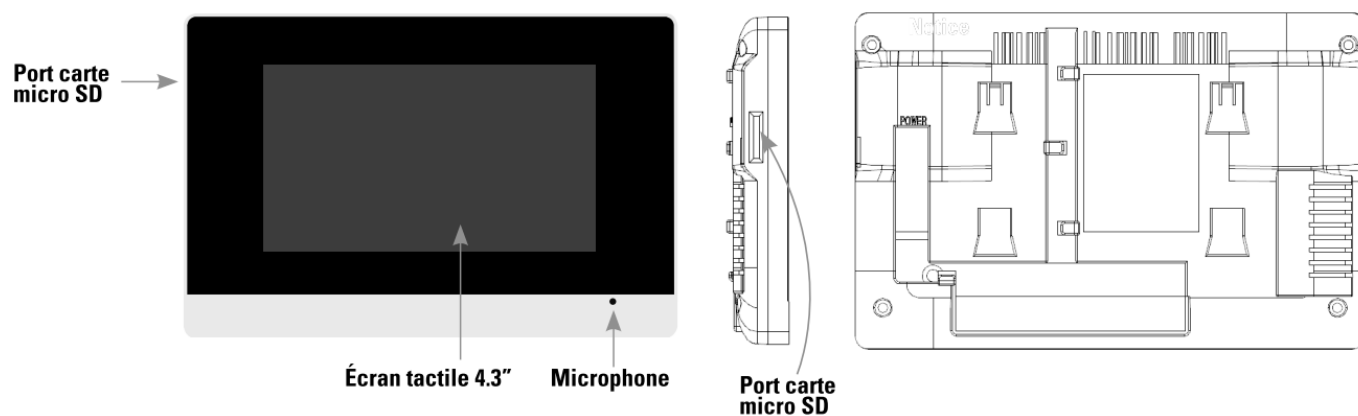

C-WIRING/INSTALLING

Installing

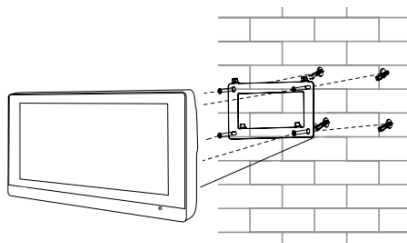
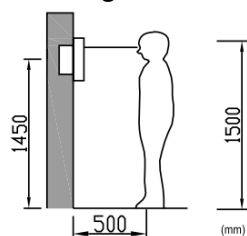

C2-Wiring diagram

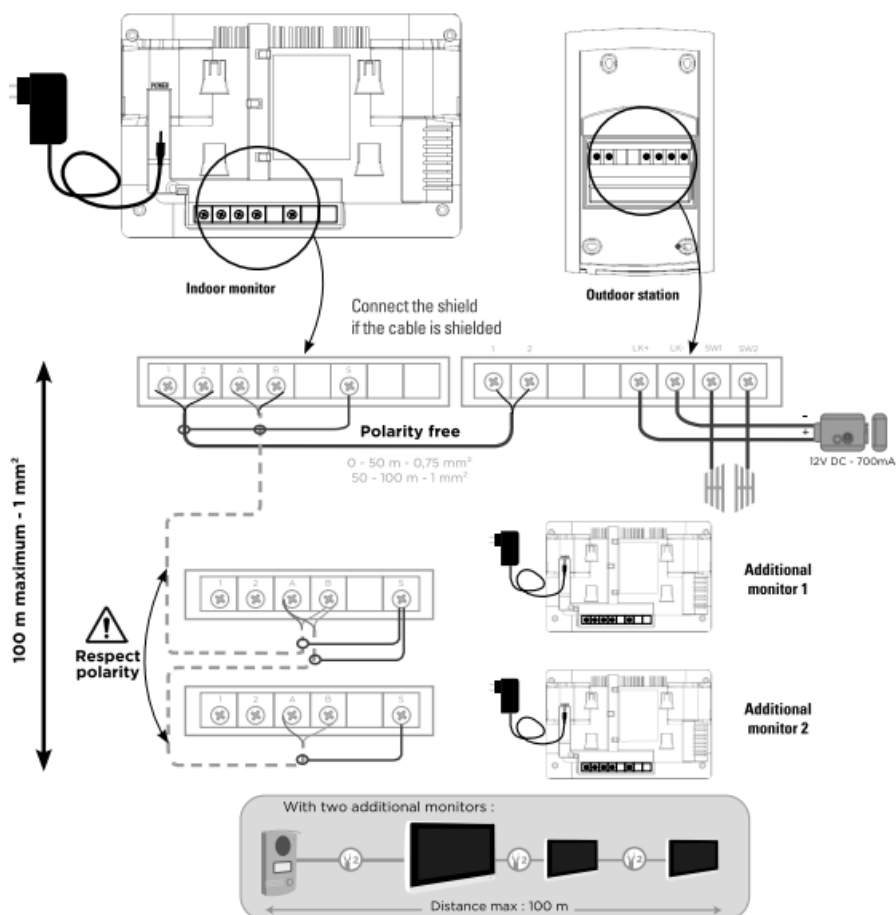

D- USING

D1- Call from the outdoor station

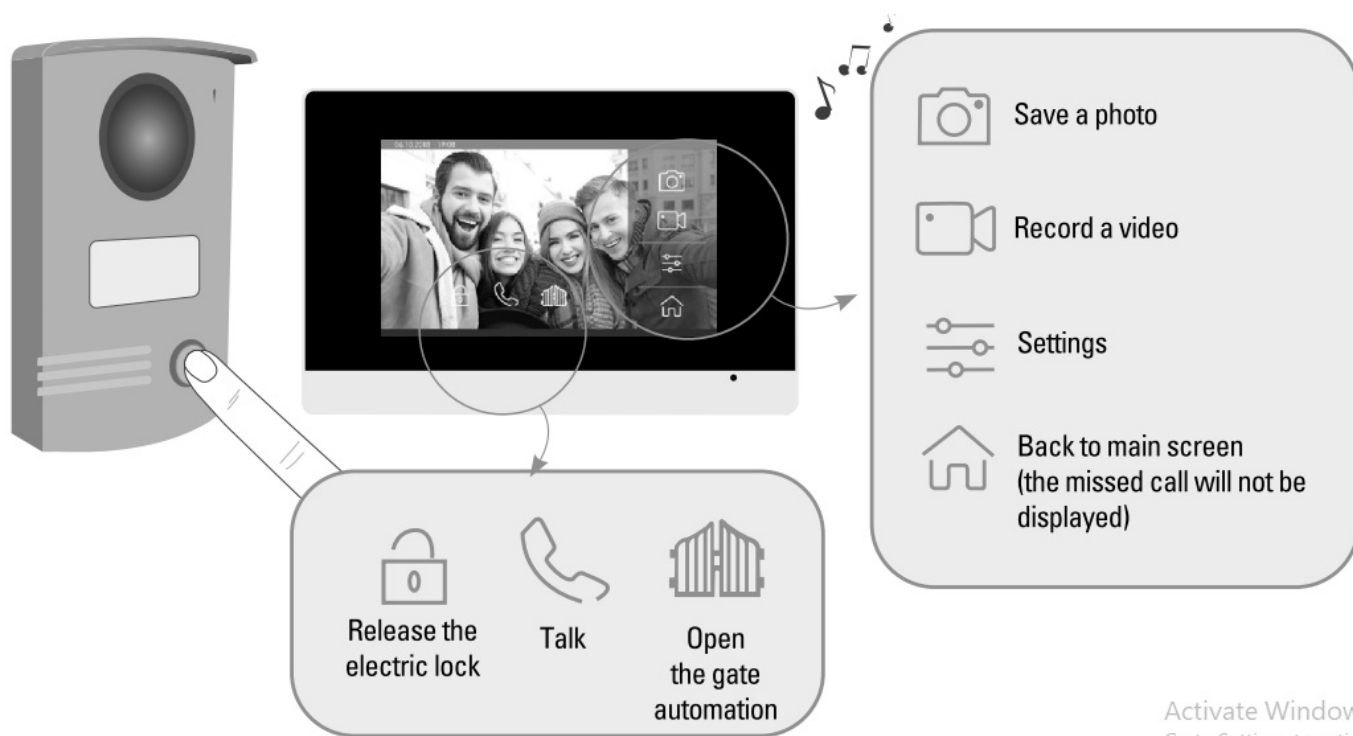

D2-Main screen

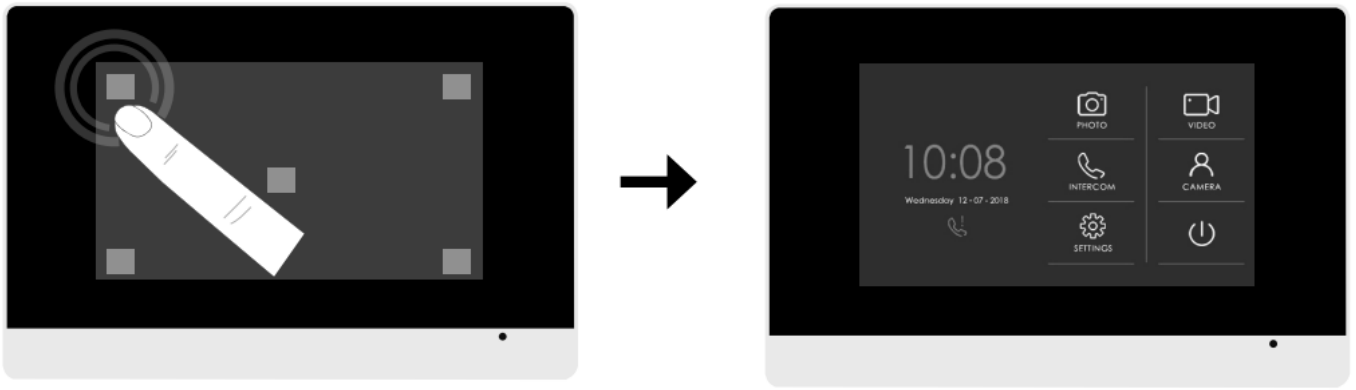

On start up, press on the 5 green targets which appear one after the other in the four corners of the screen and in the center. Wait until the main screen appears.

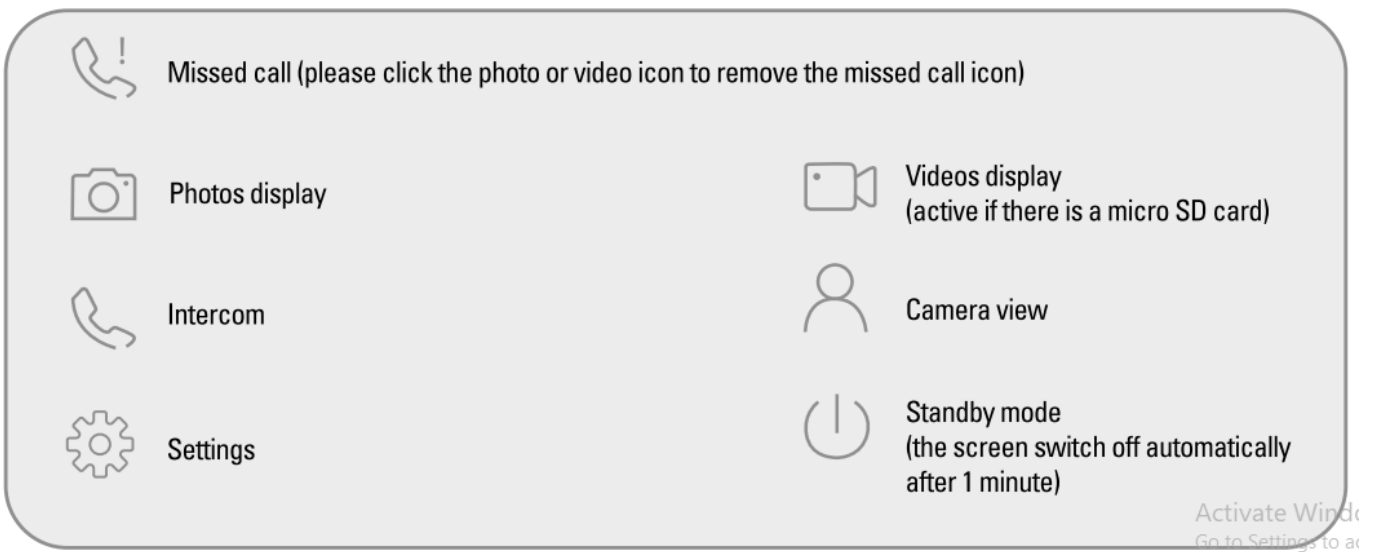

In case of disconnection, the monitor can take up to 15 seconds to turn on. Do not operate the door station until the home screen appears on the monitor.



Exit the standby mode, only touching the screen

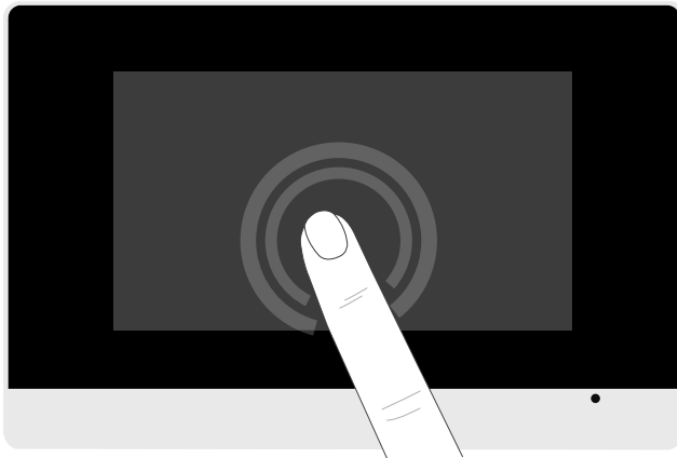

D3-Intercom function

You can connect up to 2 additional monitors to the same outdoor station and talk to another monitor. Press call icons to start/end the call.



D4- Display

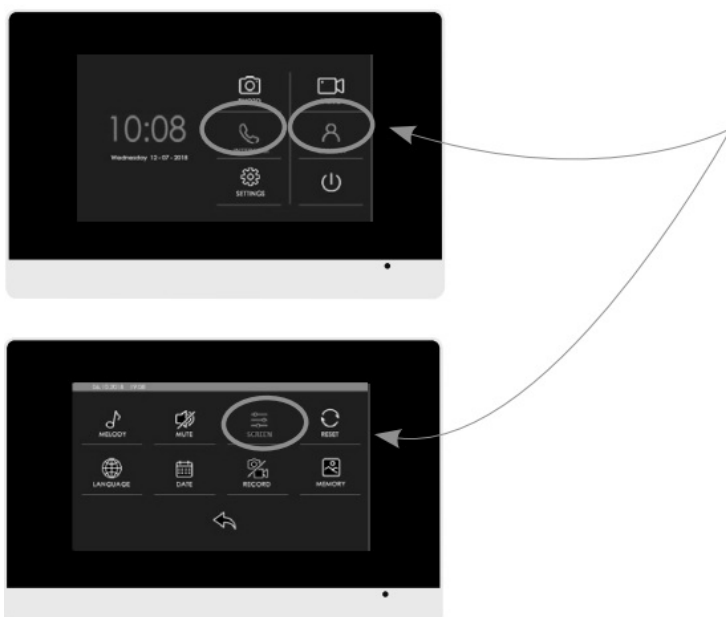

1/ When a monitor is talking to the outdoor unit, the <<intercom>> «screen» and «camera» functions of the other

monitors will be gray, which means that those functions cannot be used temporarily. 2/ When a monitor is talking to another monitor, the «intercom» «screen» and «camera» functions of the other monitors will be gray, which means that those functions cannot be used temporarily.

D5- Photos and videos display Photos



Photos

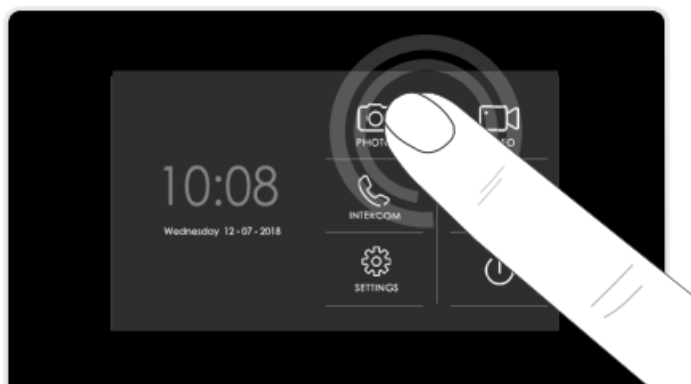

STORAGE

Display photos of the device

Micro SD

Display photos of the micro SD card



Delete photo



Back to main screen

Video's

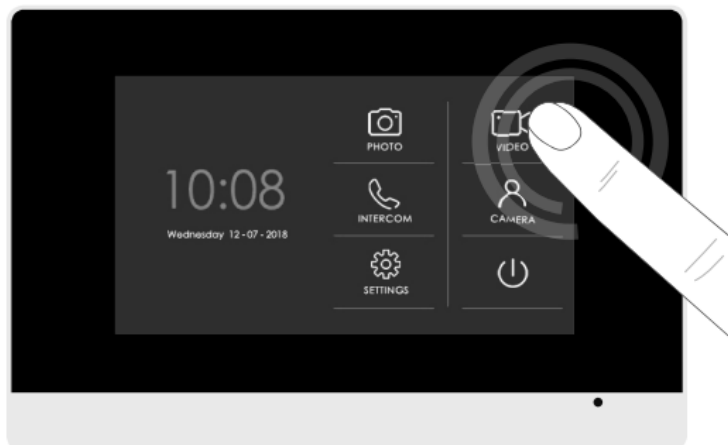

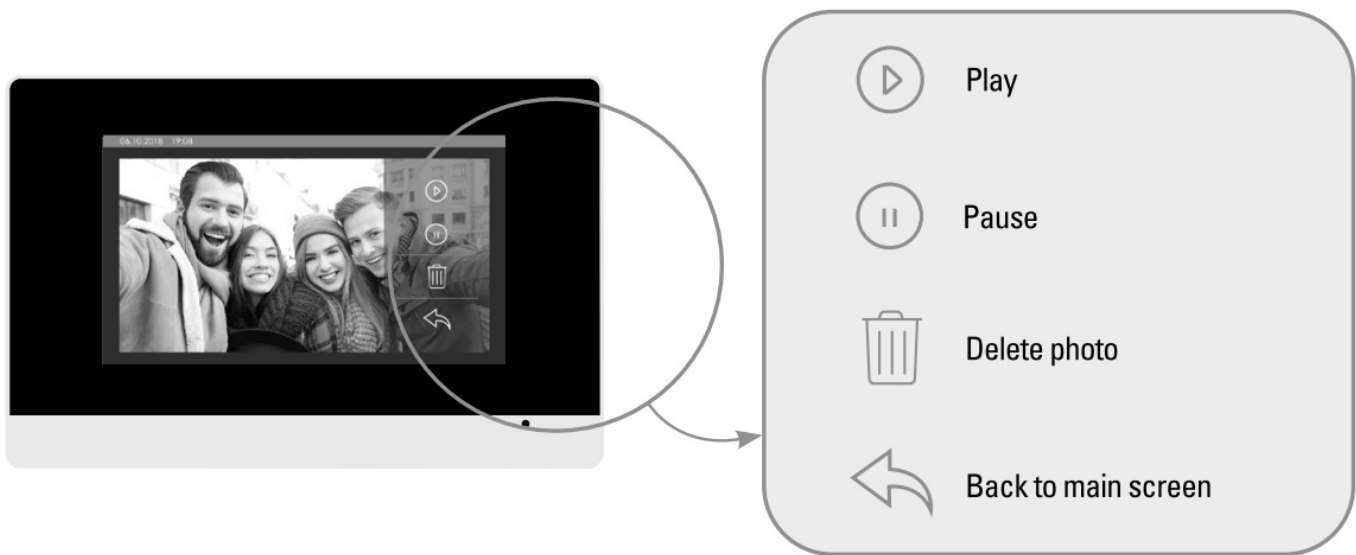

Videos will be recorded on micro SD card. The video recording will not be possible without micro SD card.

Camera display



Camera

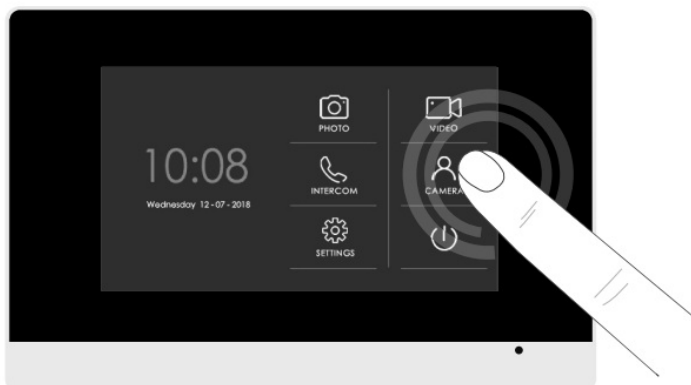

You can access the view of the door station from home by clicking on the camera icon



Set the ring melody	Silent mode	Settings	Reset
Set the language of the monitor	Set the date & time of the monitor	Select if the device takes a photo and/or video for each call.	Memory settings page. Delete all images or videos on the micro SD card, copy all images on the micro SD card and format micro SD card
	Back to main screen		

Melody

The ringtone of additional monitor cannot be set at outdoor unit. So in the Melody interface, there is no selection to enable or disable the ringtone.

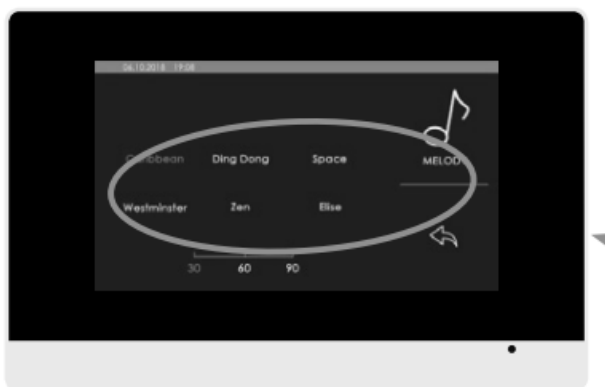

The <<melody>> function of the host monitor cannot be used via the main screen when the additional monitor is talking to the outdoor unit.

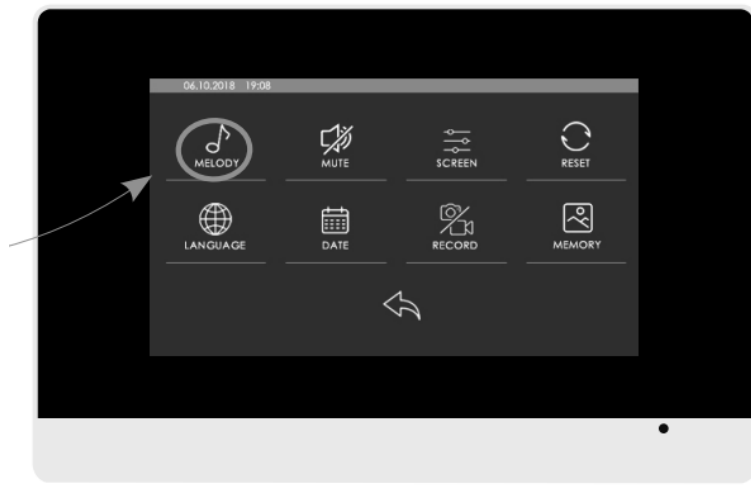

Silent mode

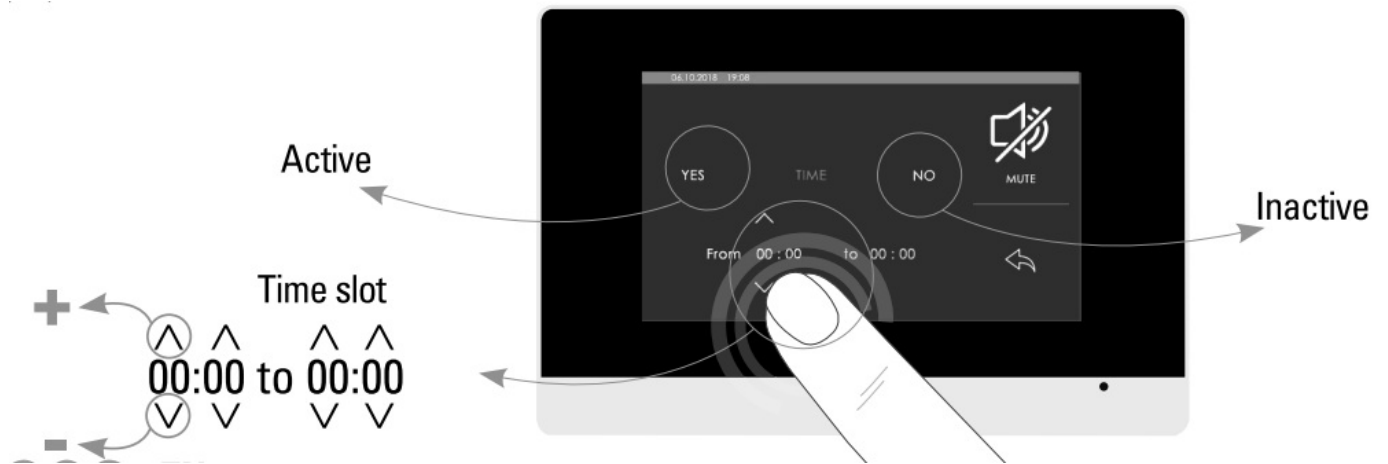

Settings screen



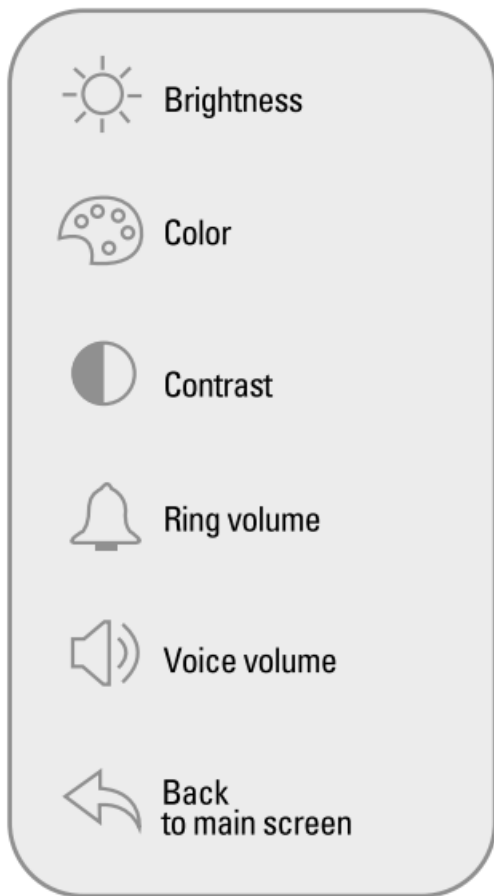

Reset

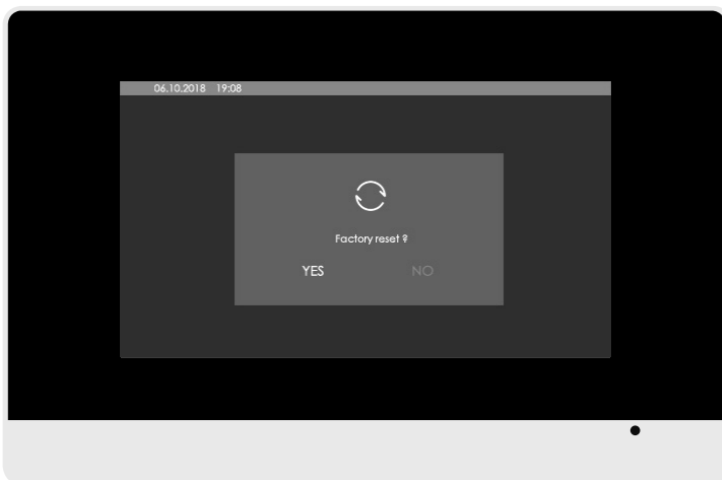

This function resets all the data and all the device's factory settings

Set the language



Set the date & time

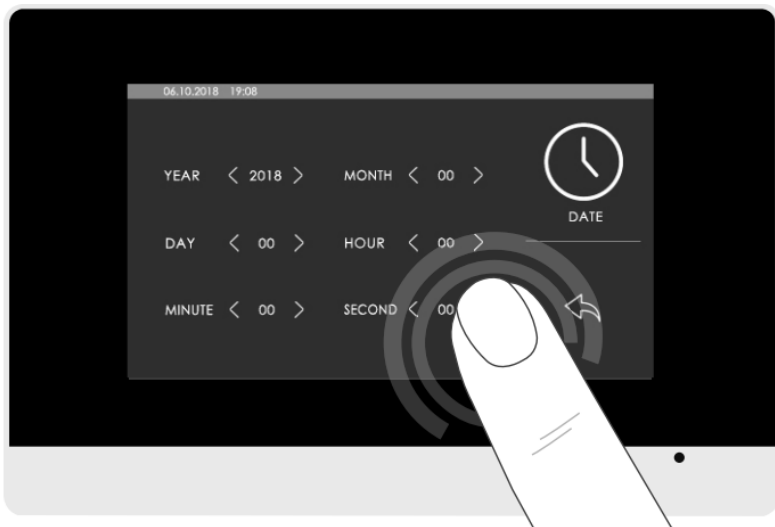
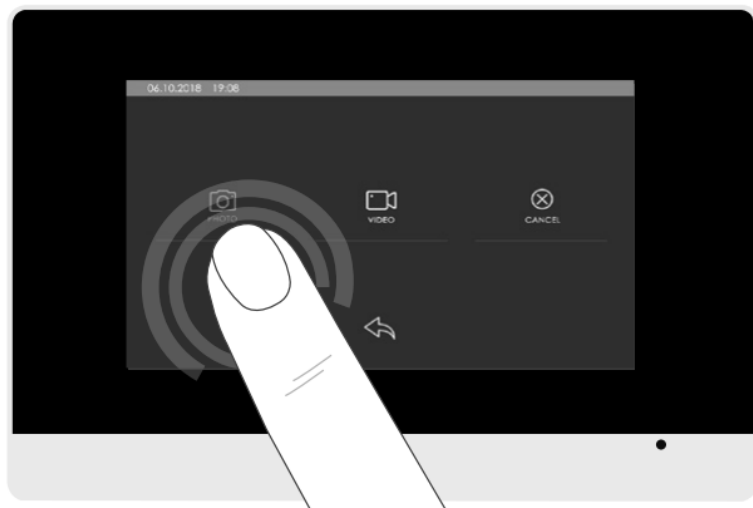
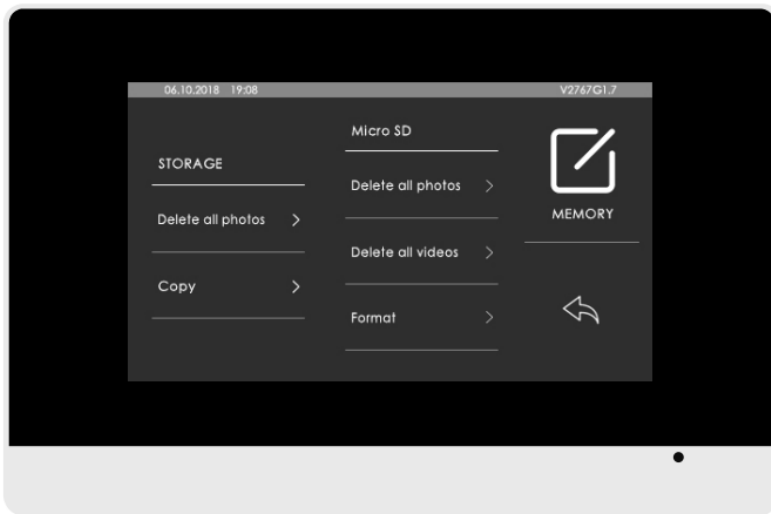

Photo and(or) video



Select if the device takes a photo and/or video for each call.

Memory



Copy: copy the photos from the monitor to the micro SD card in the BKUP PIC folder. Format: Delete the micro SD card content.

F-TECHNICAL FEATURES

Input power	15V DC 0,8A
Screen	4.3 inch digital TFT LCD touch screen
Résolution LCD	480 x 272
Memory capacity (photos)	Built-in memory (14MB) when full the newest photo will automatically overwrite the oldest one
External memory capacity (photos or videos)	MicroSD card (4 GB 32 GB class 4-10)MicroSD card must be formatted by monitor before using
Connection with additional monitor	Support 2 additional monitors

Adapter

Model identifier	SH-6000-15V-1A
Input voltage	110-240V AC
Input AC frequency	50/60Hz
Output voltage	15V DC
Output current	0.8A
Output power	12W
Average active efficiency	84.56%
Efficiency at low load (10%)	77.15%
No-load power consumption	0.065W

G-TECHNICAL ASSISTANCE

Online assistance



Any question? For an individual answer, use our online chat on our website www.scs-sentinel.com

H-WARRANTY



SCS Sentinel grants to this product a warranty period, beyond the legal time, as a sign of quality and reliability. The invoice will be required as proof of purchase date. Please keep it during the warranty period. Carefully keep the barcode and the proof of purchase, that will be necessary to claim warranty.

WARNINGS

- Maintain a minimum distance of 10 cm around the device for sufficient ventilation.
- Be sure that the device is not blocked by paper, tablecloth, curtain or other items that would impede airflow.
- Keep matches, candles and flames away from the device.
- Product functionality can be influenced by a strong electromagnetic interference.
- This equipment is intended for private consumer use only.
- The appliance should not be exposed to dripping or splashing water, no objects filled with liquids, such as vases, should be placed near the appliance.
- The mains plug is used as disconnect device and shall remain readily operable during intended use.
- The monitor and the adapter must only be used indoors.
- Connect all the parts before switching on the power.
- Only connect your appliance using the provided adapter. •
- Do not cause any impact on the elements as their electronics are fragile.
- Do not block the microphone.
- When installing the product, keep the packaging out of reach of children and animals. It is a source of potential danger.
- This appliance is not a toy. It is not designed to be used by children.



Disconnect the appliance from the main power supply before service. Do not clean the product with solvent, abrasive or corrosive substances. Only use a soft cloth. Do not spray anything on the appliance.



Make sure that your appliance is properly maintained and regularly checked in order to detect any sign of wear. Do not use it if a repair or adjustment is needed. Always call on qualified personnel.



Don't throw out of order products with the household waste (garbage). The dangerous substances that they are likely to include may harm health or the environment. Make your retailer take back these products or use the selective collect of garbage proposed by your city.



Direct current



Alternating current



Model class



The monitor is for indoor use only



Toutes les infos sur :

www.scs-sentinel.com



Documents / Resources

	<p>scs sentinel PAP0014 Additional Monitor [pdf] User Manual PAP0014, PAP0014 Additional Monitor, Additional Monitor, Monitor</p>
--	---

References

- [User Manual](#)

Manuals+ Privacy Policy

This website is an independent publication and is neither affiliated with nor endorsed by any of the trademark owners. The "Bluetooth®" word mark and logos are registered trademarks owned by Bluetooth SIG, Inc. The "Wi-Fi®" word mark and logos are registered trademarks owned by the Wi-Fi Alliance. Any use of these marks on this website does not imply any affiliation with or endorsement.