



scs sentinel AudioKit 3208D Audio Intercom User Manual

[Home](#) » [SCS sentinel](#) » scs sentinel AudioKit 3208D Audio Intercom User Manual 

Contents

- [1 scs sentinel AudioKit 3208D Audio Intercom](#)
- [2 SAFETY INSTRUCTIONS](#)
- [3 DESCRIPTION](#)
 - [3.1 Content/ Dimensions](#)
 - [3.2 Components](#)
- [4 WIRING/ INSTALLING](#)
 - [4.1 Wiring diagram](#)
 - [4.2 Attaching and connecting the elements](#)
- [5 TECHNICAL FEATURES](#)
- [6 WARRANTY](#)
- [7 Documents / Resources](#)
- [8 Related Posts](#)



scs sentinel AudioKit 3208D Audio Intercom



SAFETY INSTRUCTIONS

This manual is an integral part of your product.

These instructions are provided for your safety. Read this manual carefully before installing and keep it in a safe place for future reference. Select a suitable location. Make sure you can easily insert screws and wallplugs into the wall. Do not connect your electrical appliance until your equipment is totally installed and controlled. The installation, electric connections and settings must be made using best practices by a specialized and qualified person. Check the product is only used for its intended purpose.

DESCRIPTION

Content/ Dimensions

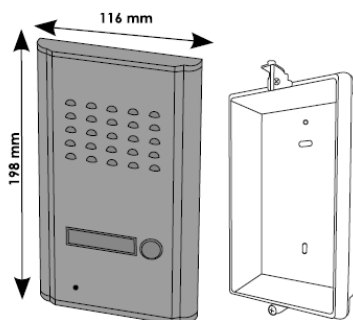
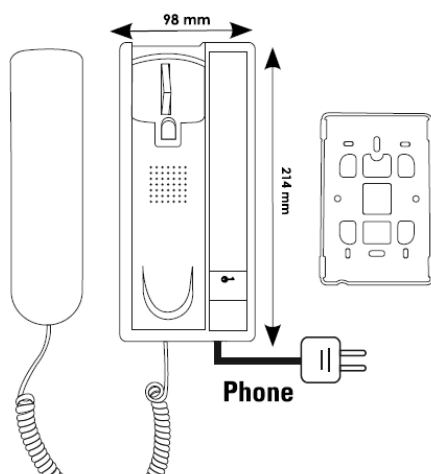

Outdoor unit



Screws



Manual

Components

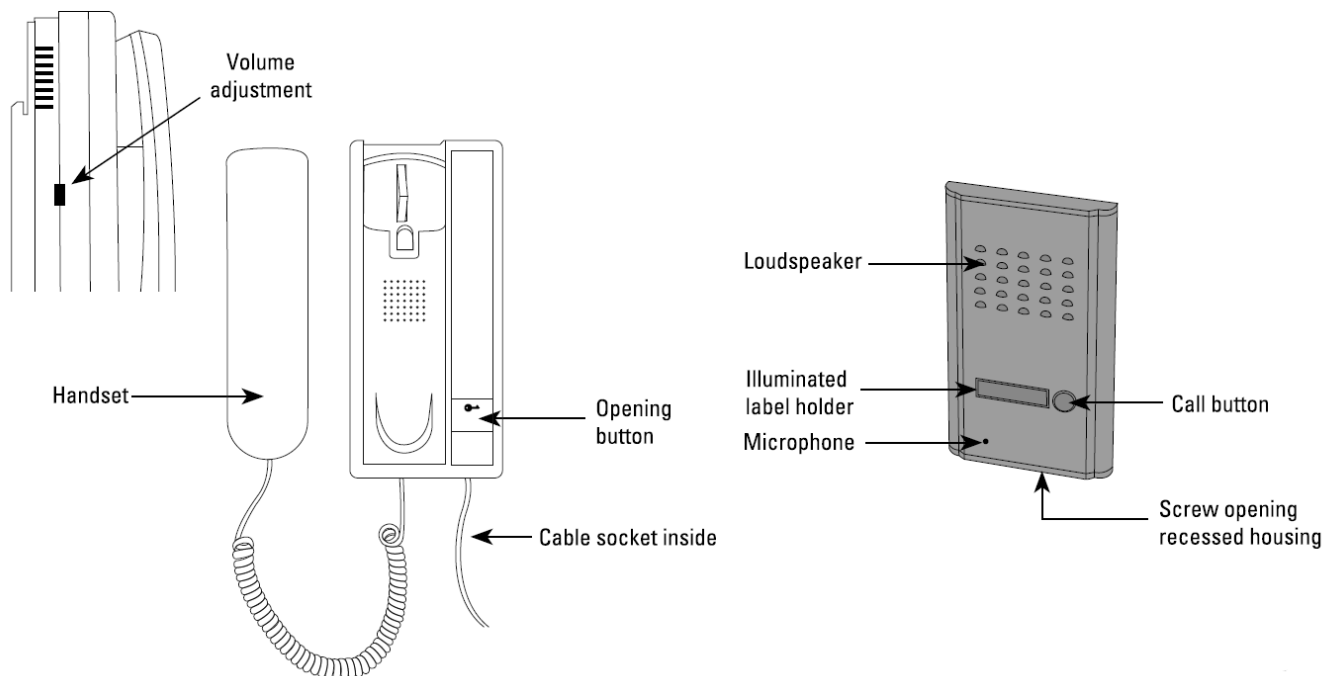

WIRING/ INSTALLING

Wiring diagram

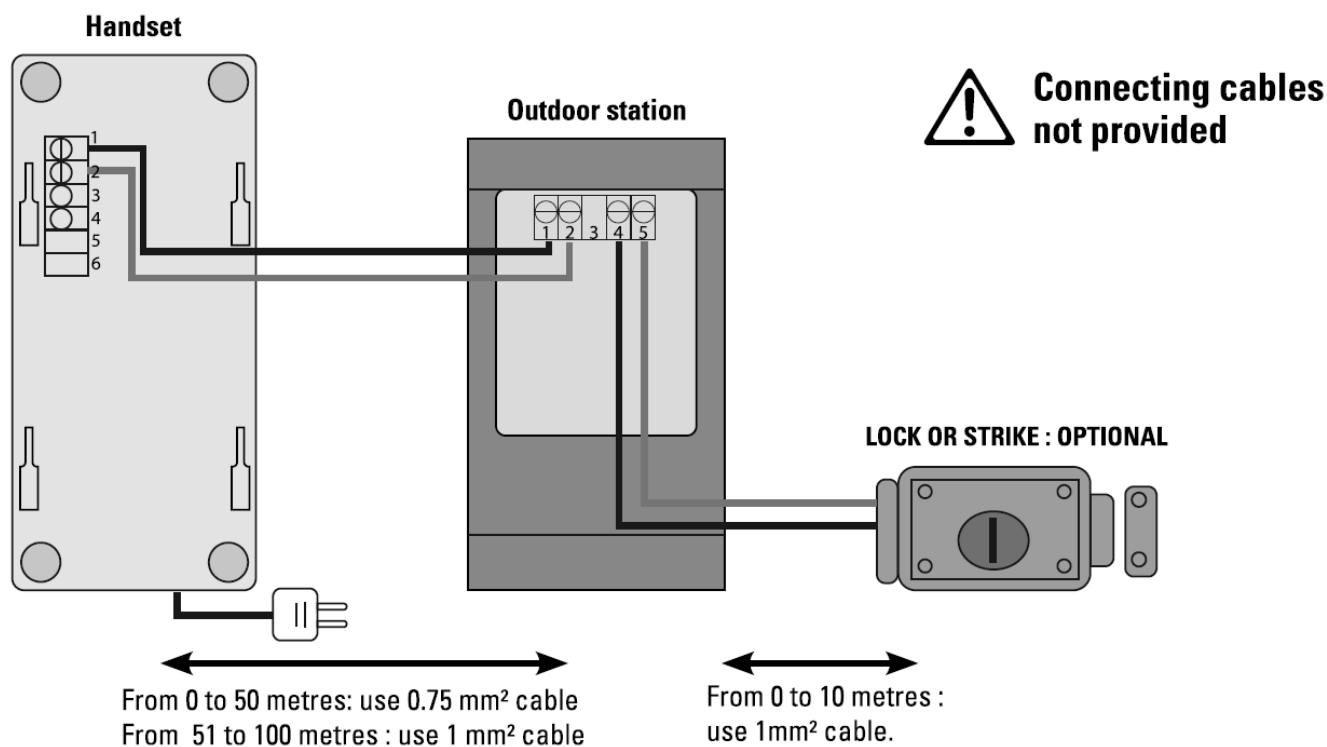

Attaching and connecting the elements

- Attach the outdoor station at a height of 1.5 meters mounted on a flat wall.
- Installation under a porch or a covered area is highly recommended.
- Remove the bottom from the panel, slightly lift the flush-mounted unit then slide off the front panel.
- Connect the outdoor station wire (as shown in the diagram below) and insert the outdoor station onto its support.
- Attach the interior unit at a height of 1.5 meters on a flat wall. First fit the rear plastic support, connect the wires

and place the handset on its support.

- Connect the interior unit.
- Perform functional test before finalizing fixing of the elements.

After installing and testing, place a clear silicon seal on the top and sides of the outdoor station (not on the Lil bottom) to avoid any risk of infiltration.

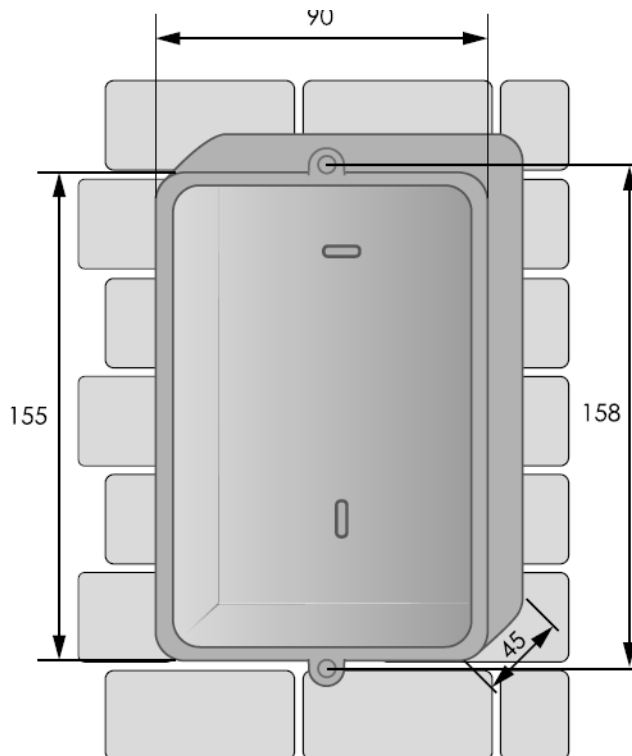
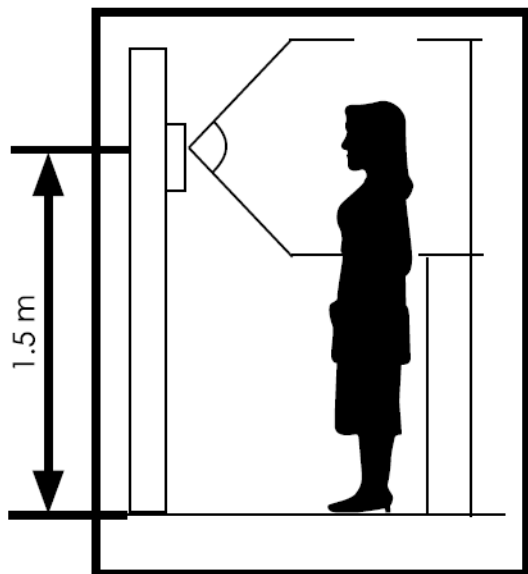

TECHNICAL FEATURES

Outdoor station

| | |
|--------------------------------------|-------------------|
| Installing | flush-mounted |
| Facade | aluminium |
| Control of a strike or electric lock | 12VDC /1,2A max |
| Dimensions | 116 x 198 x 55 mm |

Phone

| | |
|-------------------------|---|
| Installing | wall-mounted |
| Wiring | 0-50 meters: 0.75 mm ² cable (not supplied) from 51 to 100 meters: 1 mm ² cable (not supplied) |
| Maximum wiring distance | 100 m |
| Used | only indoors |
| Dimensions | 98 x 214 x 40 mm |

WARRANTY

Warranty 2 years

The invoice will be required as proof of purchase date. Please keep it during the warranty period. Carefully keep the barcode and the proof of purchase, that will be necessary to claim warranty.

WARNINGS

- Maintain a minimum distance of 10 cm around the device for sufficient ventilation.
- Be sure that the device is not blocked by paper, tablecloth, curtain or other items that would impede airflow.
- Keep matches, candles and flames away from the device.
- Product functionality can be influenced by a strong electromagnetic interference.

- This equipment is intended for private consumer use only.
- The appliance should not be exposed to dripping or splashing water; no objects filled with liquids, such as vases, should be placed near the appliance.
- Do not use in a tropical climate.
- The mains plug is used as disconnect device and shall remain readily operable during intended use.
- The handset must only be used indoors.
- Connect all the parts before switching on the power.
- Do not cause any impact on the elements as their electronics are fragile.
- Do not block the microphone.
- When installing the product, keep the packaging out of reach of children and animals. It is a source of potential danger.
- This appliance is not a toy. It is not designed to be used by children.
- The maximum ambient temperature of the appliance should not exceed 40°C.
- If the power cord or plug is broken, the appliance must be disposed of.



Disconnect the appliance from the main power supply before service. Do not clean the product with solvent, UW abrasive or corrosive substances. Only use a soft cloth. Do not spray anything on the appliance.



Make sure that your appliance is properly maintained and regularly checked in order to detect any sign of wear. Do not use it if a repair or adjustment is needed. Always call on qualified personnel.



Don't throw out of order products with the household waste (garbage). The dangerous substances that they are likely to include may harm health or the environment. Make your retailer take back these products or use the selective collect of garbage proposed by your city.



Model class 11



The handset is for indoor use only

~Alternating current

www.scs-sentinel.com



110, rue Pierre-Gilles de Gennes 49300 Chalet – France

[illegible]