



Contents [[hide](#)]

- 1 [scs sentinel ANIS Remote 4 Control Gate Channels](#)
- 2 [Product Information](#)
- 3 [Changing the Batteries](#)
- 4 [Warranty](#)
- 5 [Technical Assistance](#)
- 6 [Online Assistance](#)
- 7 [Environmental Disposal](#)
- 8 [Compliance](#)
- 9 [Contact Information](#)
- 10 [FAQ](#)
- 11 [Can I contact SCS Sentinel for personalized technical support?](#)
 - 11.1 [Documents / Resources](#)
 - 11.1.1 [References](#)



scs sentinel ANIS Remote 4 Control Gate Channels



Specifications

- Model: ControlGate AAM0049/85/94/84
- Battery Type: 2 x CR2016
- Manufacturer: SCS Sentinel
- Country of Origin: France

Product Information

The ControlGate AAM0049/85/94/84 is a battery-operated control gate device designed for use in automated gate systems. It is manufactured by SCS Sentinel in France.

Changing the Batteries

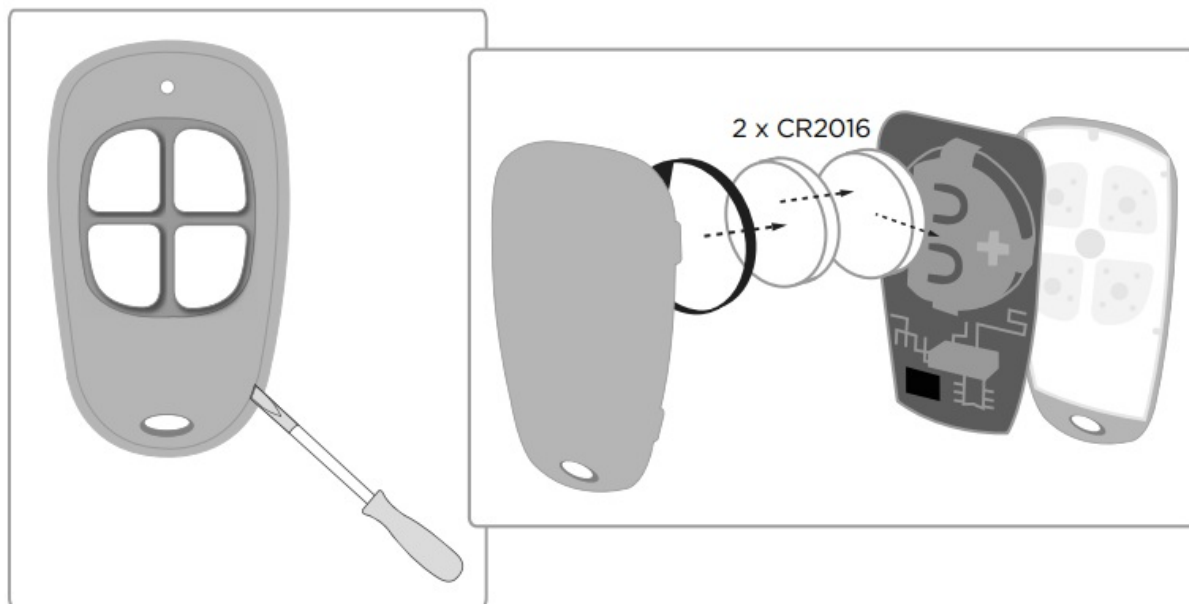

To change the batteries, use 2 x CR2016 batteries. Follow the diagram to open the remote and replace the batteries.

Warranty



The product comes with a 2-year warranty. The invoice and barcode will be required as proof of purchase date during the warranty period.

0 892 350 490

**Service 0,15 € / min
+ prix appel**

Technical Assistance

For technical assistance, contact the service at 0 892 350 490. Service costs 0.15 €/min plus call price. Service hours can be found on the website: www.scs-sentinel.com.

Online Assistance

- For an individual answer, use our online chat on our website www.scs-sentinel.com.

Warnings

Do not ingest battery, Chemical Burn Hazard. This product contains a button cell battery.

If swallowed, it can cause severe internal burns in just 2 hours and can lead to death. Keep new and used batteries away from children. If the battery compartment does not close securely, stop using the product and keep it away from children. If you think batteries might have been swallowed or placed inside any part of the body, seek immediate medical attention. Do not clean the remote control with abrasive or corrosive substances. Use a simple cloth. Do not allow children to play with the product or packaging.

Environmental Disposal

- Don't throw batteries or out of order products with the household waste (garbage). The dangerous substances that they are likely to include may harm health or the environment. Make your retailer take back these products or use the selective collection of garbage proposed by your city.

Compliance

EN: Hereby, SCS Sentinel declares that this product complies with the essential requirements and other relevant provisions of Directive 2014/53/UE. The EU declaration of conformity may be consulted on the website: www.scs-sentinel.com/downloads.

Contact Information

SCS Sentinel, 110, rue Pierre-Gilles de Gennes 49300 Cholet – France

FAQ

Can I contact SCS Sentinel for personalized technical support?

Yes, you can use the online chat feature on the SCS Sentinel website for personalized technical assistance.

How long do the batteries typically last in the ControlGate device?

The CR2016 batteries used in the ControlGate device usually last for several months under normal usage conditions.

Documents / Resources

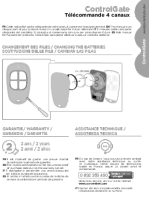
	scs sentinel ANIS Remote 4 Control Gate Channels [pdf] Instructions ANIS Remote 4 Control Gate Channels, ANIS, Remote 4 Control Gate Channels, 4 Control Gate Channels, Gate Channels
---	--

References

- [User Manual](#)

SCS

sentinel

4 Control Gate Channels, ANIS, ANIS Remote 4 Control Gate Channels, Gate Channels, Remote 4 Control Gate Channels, SCS sentinel

Leave a comment

Your email address will not be published. Required fields are marked *

Comment *

Name

Email

Website

☐ Save my name, email, and website in this browser for the next time I comment.

Post Comment

Search:

e.g. whirlpool wrf535swhz

Search

[Manuals+](#) | [Upload](#) | [Deep Search](#) | [Privacy Policy](#) | [@manuals.plus](#) | [YouTube](#)

This website is an independent publication and is neither affiliated with nor endorsed by any of the trademark owners. The "Bluetooth®" word mark and logos are registered trademarks owned by Bluetooth SIG, Inc. The "Wi-Fi®" word mark and logos are registered trademarks owned by the Wi-Fi Alliance. Any use of these marks on this website does not imply any affiliation with or endorsement.