

scs sentinel
7415 Simply
Control



scs sentinel 7415 Simply Control Instruction Manual

[Home](#) » [SCS sentinel](#) » scs sentinel 7415 Simply Control Instruction Manual 

Contents

- 1 [scs sentinel 7415 Simply Control](#)
- 2 [CHANGING THE BATTERIES](#)
- 3 [Specification](#)
- 4 [Warranty](#)
- 5 [Documents / Resources](#)
 - 5.1 [References](#)



scs sentinel 7415 Simply Control



This manual is an integral part of your product. Keep it in a safe place for future reference. Refer to your gate opener manual for the remote control learning process.

CHANGING THE BATTERIES

If the LED flashes for 1 second when the remote control is pressed, the battery must be changed.

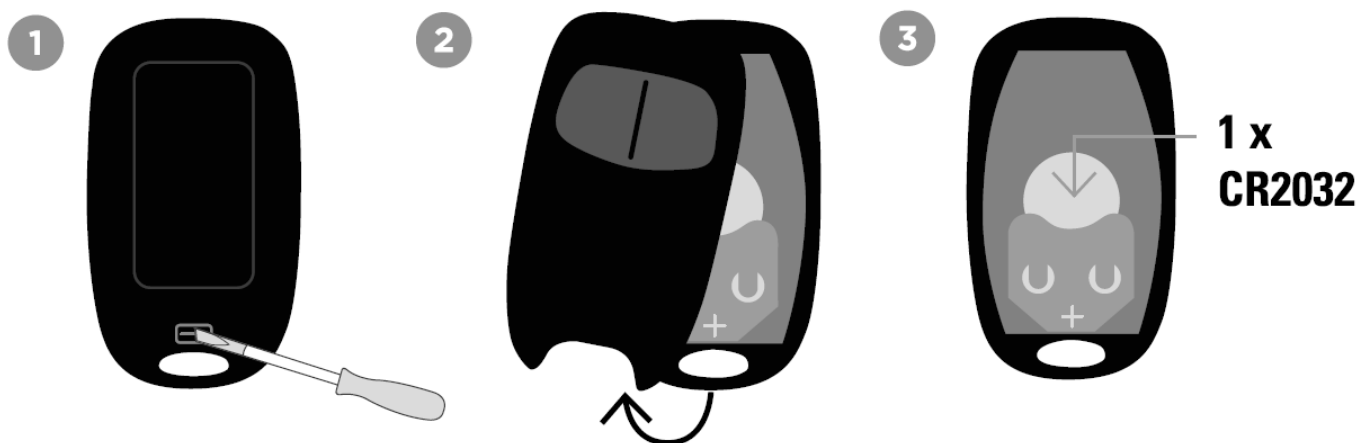

Specification

- Maximum transmitted power <10mW
- Frequency 433.05MHz à 434.79MHz
- Power supply 3V DC / 1 pile lithium CR2032 (supplied)
- Operating temperature -20 a +60°C

Warranty

3 years warranty, a warranty period, beyond the legal time, as a sign of quality and reliability. It is imperative to keep proof of purchase during the whole warranty period.

Service schedule, see on the website:

- www.scs-sentinel.com/contact.
- 0 892 350 490

For an individual answer, use our online chat on our website www.scs-sentinel.com.

WARNINGS

Don't throw batteries or out-of-order products with the household waste (garbage). The dangerous substances that they are likely to include may harm health or the environment. Make your retailer take back these products or use the selective collect of garbage proposed by your city.



Manufacturer of the battery supplied

CR2032

- Renata SA – Kreuzenstrasse 30 CH-4452 ITINGEN / Switzerland
- **Mail:** sales@renata.com
- www.renata.com.

Do not ingest battery, Chemical Burn Hazard. This product contains a button-cell battery. If the button cell battery is swallowed, it can cause severe internal burns in just 2 hours and can lead to death. Keep new and used batteries away from children. If the battery compartment does not close securely, stop using the product and keep it away from children. If you think batteries might have been swallowed or placed inside any part of the body, seek immediate medical attention. Do not clean the remote control with abrasive or corrosive substances. Use a simple cloth. Do not allow children to play with the product or packaging.

Hereby, SCS Sentinel declares that this product complies with the essential requirements and other relevant provisions of Directive 2014/53/UE. The UE declaration of conformity may be consulted on the website: www.scs-sentinel.com/downloads.

sentinel 110, rue Pierre-Gilles de Gennes 49300 Cholet – France.

Documents / Resources

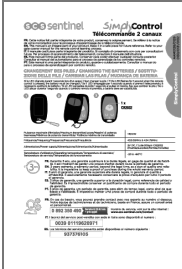

[scs sentinel 7415 Simply Control](#) [pdf] Instruction Manual
7415 Simply Control, 7415, Simply Control, Control

References

- [User Manual](#)

Manuals+, Privacy Policy

This website is an independent publication and is neither affiliated with nor endorsed by any of the trademark owners. The "Bluetooth®" word mark and logos are registered trademarks owned by Bluetooth SIG, Inc. The "Wi-Fi®" word mark and logos are registered trademarks owned by the Wi-Fi Alliance. Any use of these marks on this website does not imply any affiliation with or endorsement.