



SCHUBERTH SC1 Standard Communication System User Guide

[Home](#) » [SCHUBERTH](#) » SCHUBERTH SC1 Standard Communication System User Guide





SC1 Standard Communication System
User Guide

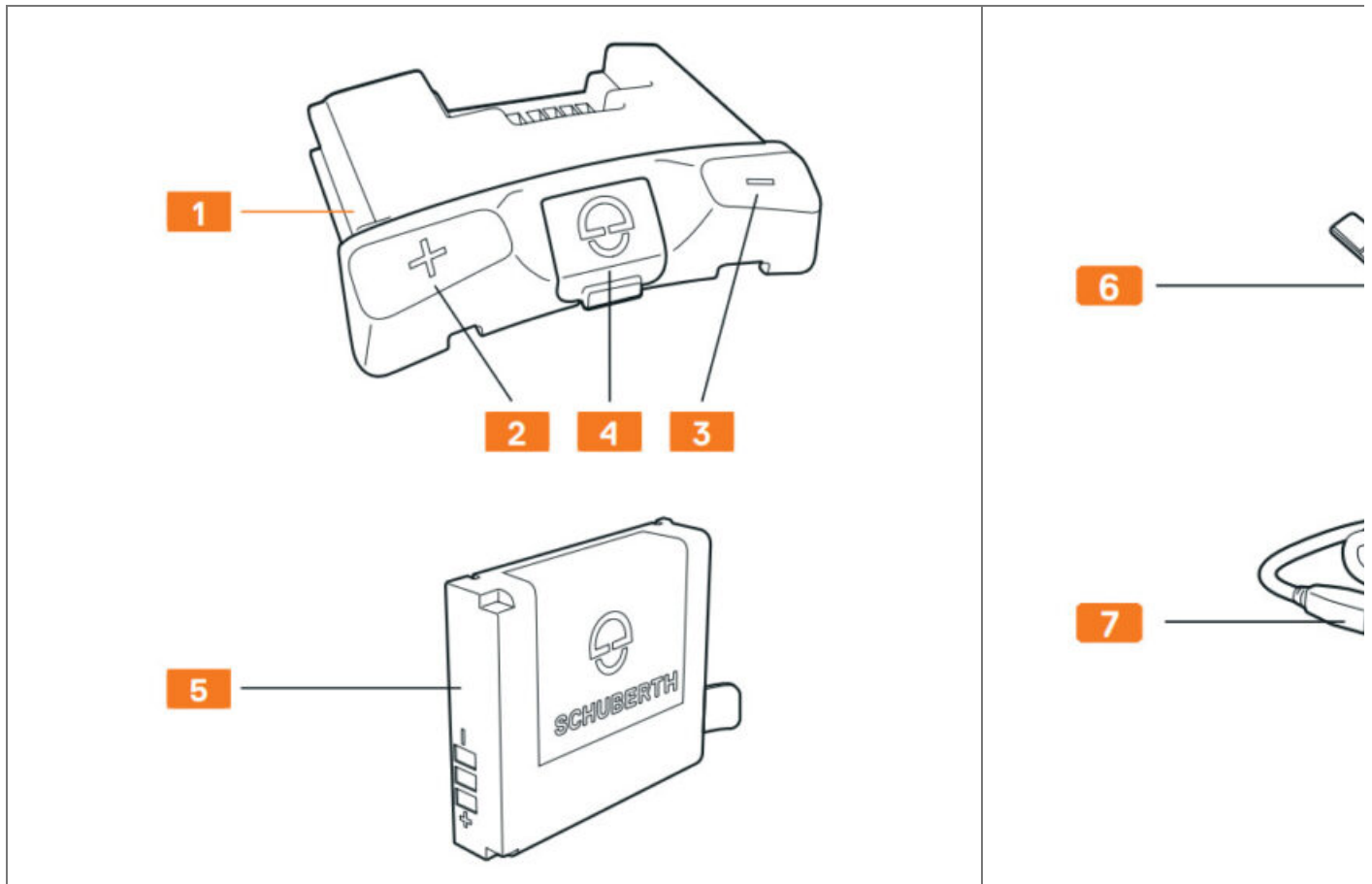

“Hello!” – the SCHUBERTH SC1 lets you stay connected with everything important to you: your friends on your motorbike and those waiting for you at home. The navigation system provides directions and keeps you entertained while traveling to your destination. Have a great journey and stay connected!

We recommend you to read the operating instructions carefully in addition to the Quick Start Guide, in order to understand all the functions and the correct operation. To find the complete manual please use the smartphone app or go to:



1. SC1
2.  Button
3.  Button
4. Charging Port
5. Battery
6. Release Tool
7. USB charging cable

Contents [[hide](#)

- 1 Installation
- 2 Charging
- 3 Button Operation
- 4 Basic Function
- 5 Intercom
- 6 Mobile Phone
- 7 Music
- 8 FM Radio
- 9 Smartphone App
- 10 Notice
- 11 Documents / Resources
 - 11.1 References
- 12 Related Posts

Installation

SCHUBERTH C4

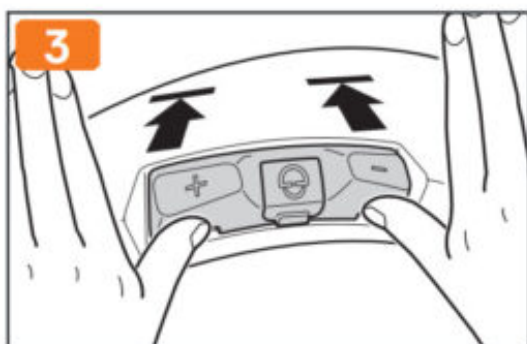
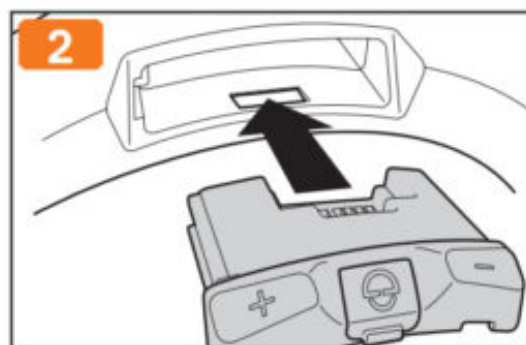
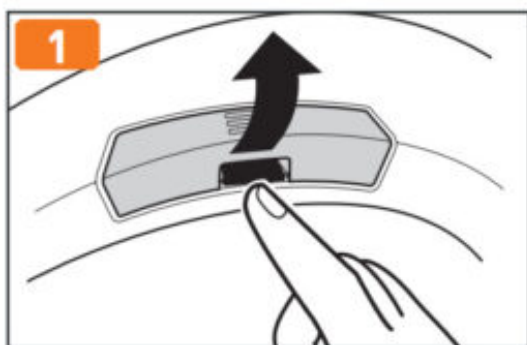

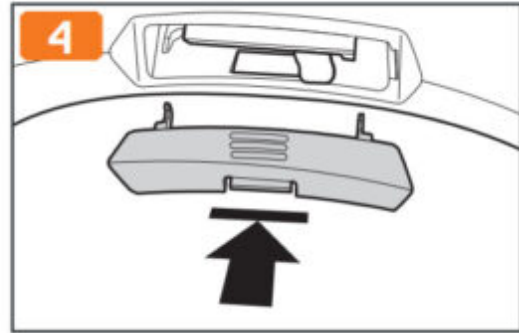
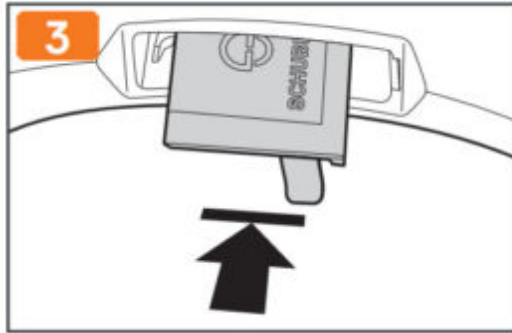
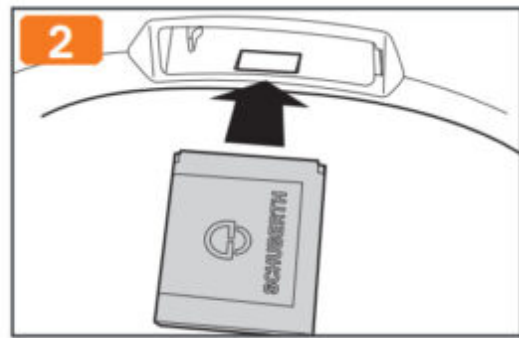
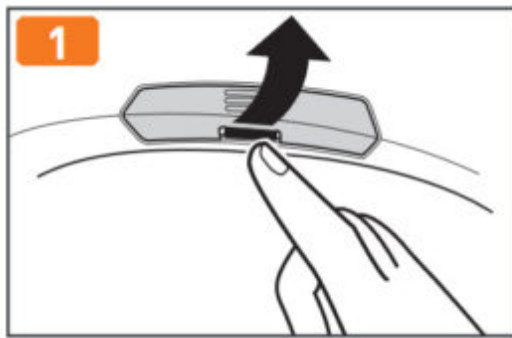

SCHUBERTH R2

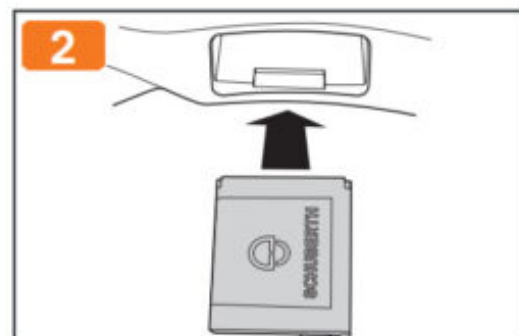
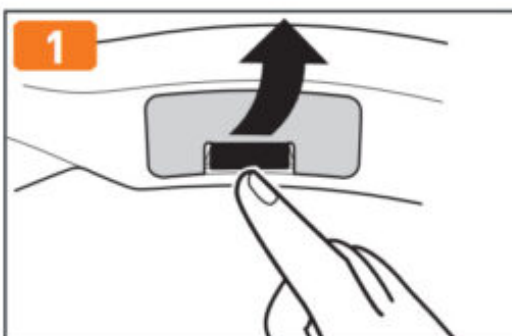
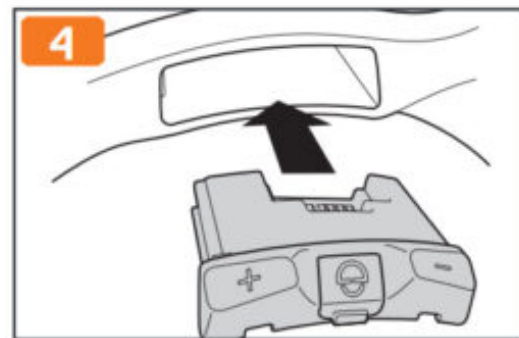
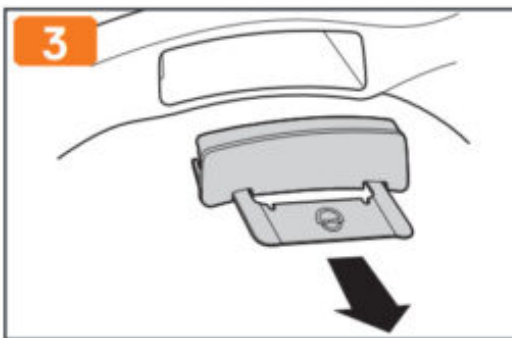
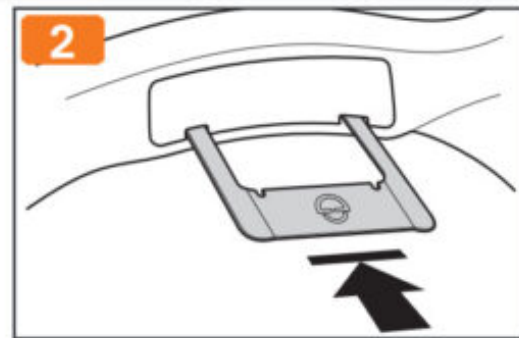
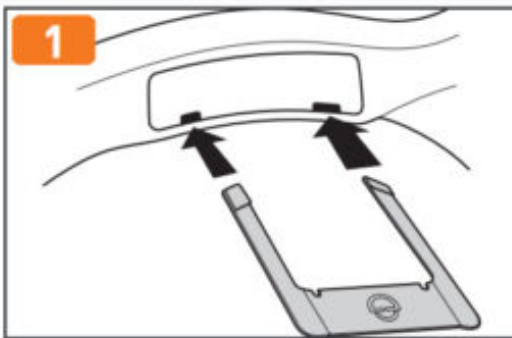

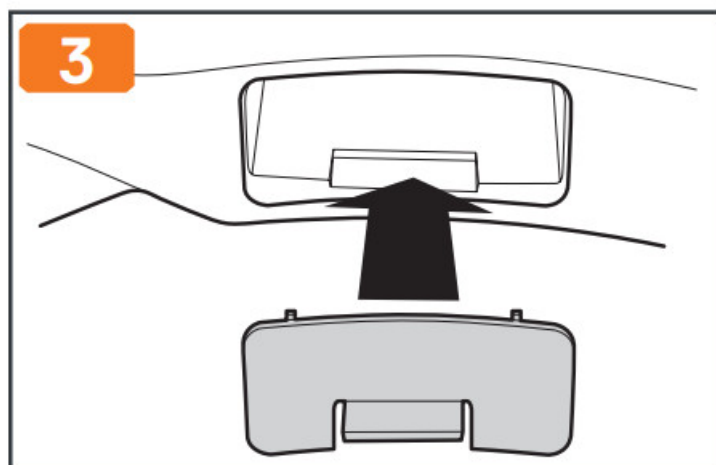

Charging

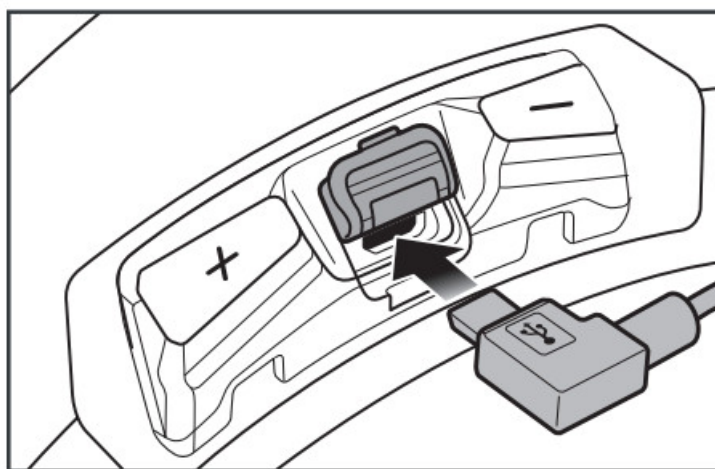

Button Operation

	Tapping
	Double Tapping
1sec	Press for 1sec

Basic Function

Power On

& 1sec

Power Off

 &   3sec

Volume Adjustment

Intercom

Pairing

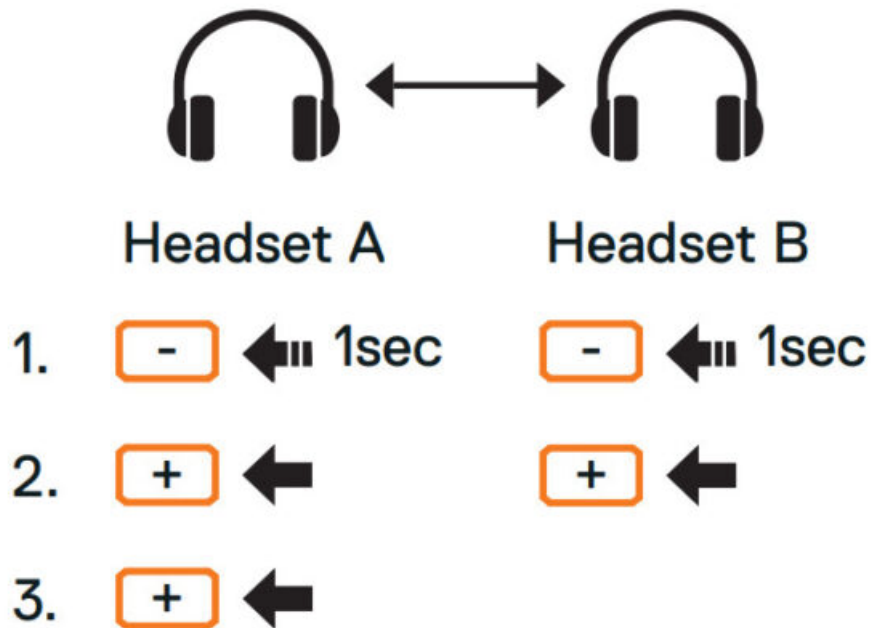

Start Group Intercom

  1sec

  1sec

End Group Intercom

  3sec

Mobile Phone

Mobile phone pairing

1.  or   10sec

2.   

Answer mobile phone call

End mobile phone call

  2sec

Composition vocale

  3sec

Reject incoming call

  2sec

Second Mobile Phone Pairing & GPS

1.  or   10sec

2.    

Music

Play & Pause Bluetooth music

  1sec

Track forward



FM Radio

Radio On & Off



Seek station up



*: only

SC1 ADVANCED

Smartphone App



Q SCHUBERTH



Notice

Attaching the product to the helmet is considered a modification to the helmet and may void your helmet's warranty or compromise your helmet's functionality.

This may entail risks during an accident, so be fully aware of this fact before using the product. Should you not accept this fact, you may return the product for a full refund.

In some regions, it is prohibited by law to ride motorcycles while wearing headsets or earbuds.

Therefore be certain you are aware of all relevant laws in the region where you are using the product and are sure that you comply with them.

Producer: Sena Technologies, Inc
19, Heolleung-ro 569-gil, Gangnam-gu
Seoul 06376, Republic of Korea

Importer in Europe: SCHUBERTH GmbH
Stegelitzer Straße 12
D-39126 Magdeburg, Germany

Importer in US: SCHUBERTH North America
9920 Pacific Heights Blvd., Suite 150
San Diego, CA 92121

Subject to change. Not responsible for mistakes or printing errors.

WWW.SCHUBERTH.COM

Documents / Resources

 The image shows the cover of a user guide for the SCHUBERTH SC1 Standard Communication System. It features a motorcycle helmet with yellow and black graphics, and the text 'QUICK START GUIDE' at the top. The SCHUBERTH logo and 'SC1' are at the bottom.	<p>SCHUBERTH SC1 Standard Communication System [pdf] User Guide SC1, Standard Communication System, SC1 Standard Communication System</p>
---	---

References

-  [SCHUBERTH Helme für Motorrad, Car Racing, Arbeitsschutz, Feuerwehr, Behörden & Militär - SCHUBERTH](#)