



SCHUBERT Prime Cube Customized Design with Pad Printing Installation Guide

[Home](#) » [Schubert](#) » SCHUBERT Prime Cube Customized Design with Pad Printing Installation Guide 

Contents

- [1 SCHUBERT Prime Cube Customized Design with Pad Printing](#)
- [2 Product Information](#)
- [3 Product Usage Instructions](#)
- [4 Frequently Asked Questions \(FAQ\)](#)
- [5 PRIME EXTEND TX DP INSTALLATION](#)
 - [5.1 DIMENSION DRAWING](#)
- [6 Documents / Resources](#)
 - [6.1 References](#)



SCHUBERT Prime Cube Customized Design with Pad Printing

SCHUBERT-Prime-Cube-Customized-Design-with-Pad-Printing-PRODUCT

Product Information

The Prime Extend TX DP is a modular product designed for easy installation and use. It is manufactured by Schubert System Elektronik GmbH, a leading company in the electronics industry.

Specifications

- Model: Prime Extend TX DP
- Dimensions: Refer to the dimension drawing
- Manufacturer: Schubert System Elektronik GmbH
- Contact: Tel. +49 (0) 7467 9497-0, Email: info@schubert-system-elektronik.de

Product Usage Instructions

Installation

To install the Prime Extend TX DP, follow the steps below:

1. Ensure that you have all the necessary components and tools for installation.
2. Identify a suitable location for the product installation.
3. Refer to the dimension drawing to determine the exact measurements for installation.
4. Using appropriate mounting hardware, securely attach the Prime Extend TX DP to the desired surface.
5. Make sure all connections are properly secured and tightened.

Setup

Once the Prime Extend TX DP is installed, follow the steps below to set it up:

1. Connect the necessary cables and wires to the respective ports of the Prime Extend TX DP.
2. Ensure that all connected devices are powered on and functioning correctly.
3. Configure any required settings or preferences using the provided user interface or software.
4. Perform a test to verify the connectivity and functionality of the Prime Extend TX DP.

Maintenance

To ensure optimal performance and longevity of the Prime Extend TX DP, follow these maintenance guidelines:

- Regularly inspect all connections and cables for any signs of damage or wear.
- Clean the product surfaces using a soft, lint-free cloth and mild cleaning solution if necessary.
- Avoid exposing the product to extreme temperatures or humidity.
- Keep the product away from liquids and ensure it is not submerged in water.

Frequently Asked Questions (FAQ)

Q: Can I use the Prime Extend TX DP with any display device?

A: The Prime Extend TX DP is compatible with most display devices that support the designated interface. However, it is recommended to check the device's specifications or consult the manufacturer for compatibility confirmation.

Q: What is the warranty period for the Prime Extend TX DP?

A: The warranty period for the Prime Extend TX DP is one year from the date of purchase. Please refer to the warranty documentation for further details and conditions.

Q: Can I extend the transmission distance of the Prime Extend TX DP?

A: Yes, the Prime Extend TX DP is designed to extend the transmission distance of audio and video signals. However, there may be limitations based on the specific setup and environmental factors. It is recommended to refer to the product documentation or consult technical support for guidance on achieving optimal performance.

PRIME EXTEND TX DP INSTALLATION

DIMENSION DRAWING

Side

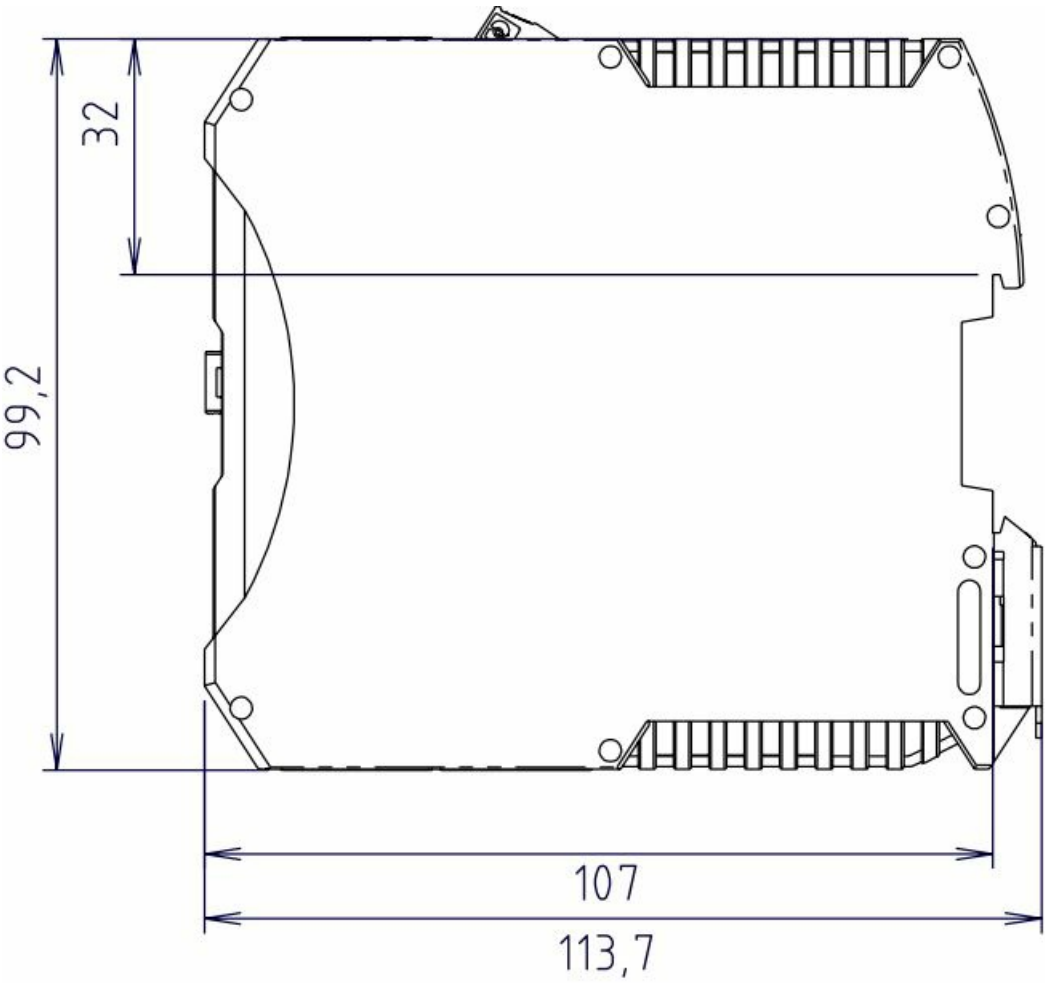

Top



Dimensions in mm, not in scale General Tolerance ISO 2768 – mK

Drawings may contain options.

Version 1.00 / 2023 © Schubert System Elektronik GmbH.

All rights and modifications reserved. All data are non-binding and do not ensure any properties. We assume no liability for printing errors. The company names, names and logos used are largely protected by copyright and/or trademarks, even if not explicitly marked as such. All product names used are brand names and/ or trademarks of the respective manufacturers.

Schubert System Elektronik GmbH

take-off Gewerbepark 36, D-78579 Neuhausen ob Eck

Tel. +49 (0) 7467 9497-0

www.schubert-system-elektronik.de

info@schubert-system-elektronik.de

Documents / Resources

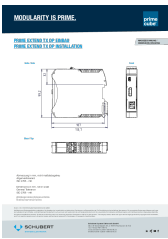
	<p>SCHUBERT Prime Cube Customized Design with Pad Printing [pdf] Installation Guide Prime Cube Customized Design with Pad Printing, Prime Cube, Customized Design with Pad P rinting, Design with Pad Printing, Pad Printing, Printing</p>
--	---

References

- [🌐 System-Elektronik](#)
- [🔧 Industrielle Computertechnik "Made in Germany" | Schubert System Elektronik](#)
- [User Manual](#)