



# SchSchumacher DSR164 Lithium Ion Jump Starter and USB Power Source Owner's Manual

[Home](#) » [SchSchumacher](#) » SchSchumacher DSR164 Lithium Ion Jump Starter and USB Power Source Owner's Manual 

## Contents

- 1 SchSchumacher DSR164 Lithium Ion Jump Starter and USB Power Source
- 2 SAVE THESE INSTRUCTIONS
- 3 PERSONAL SAFETY PRECAUTIONS
- 4 FEATURES
- 5 CONTROL PANEL
- 6 CHARGING THE INTERNAL BATTERY OF THE JUMP STARTER
- 7 OPERATING INSTRUCTIONS
- 8 MAINTENANCE AND STORAGE
- 9 TROUBLESHOOTING
- 10 REPLACEMENT PARTS
- 11 SPECIFICATIONS
- 12 BEFORE RETURNING FOR REPAIRS
- 13 LIMITED WARRANTY
- 14 Documents / Resources
  - 14.1 References
- 15 Related Posts



SchSchumacher DSR164 Lithium Ion Jump Starter and USB Power Source



## **SAVE THESE INSTRUCTIONS**

### **WARNING: RISK OF EXPLOSIVE GASES.**

WORKING IN THE VICINITY OF A LEAD-ACID BATTERY IS DANGEROUS. BATTERIES GENERATE EXPLOSIVE GASES DURING NORMAL OPERATION. IT IS IMPORTANT THAT YOU FOLLOW THESE INSTRUCTIONS EACH TIME YOU USE THE UNIT.

To reduce the risk of battery explosion, follow these instructions and those published by the battery manufacturer and the manufacturer of any equipment you intend to use in the vicinity of a battery. Review cautionary markings on these products and on the engine.

### **WARNING! RISK OF ELECTRIC SHOCK OR FIRE.**

1. Keep out of reach of children.
2. Do not disassemble the jump starter. Take it to a qualified service professional if service or repair is required. Incorrect assembly may result in fire or electrical shock.
3. Do not use the jump starter to jump a vehicle while charging the internal battery.
4. Do not recharge the jump starter with a damaged USB cable.
5. The jump starter gets hot during charging and must have proper ventilation.
6. Do not set the jump starter on flammable materials, such as carpeting, upholstery, paper, cardboard, etc.
7. Place the jump starter as far away from the battery being jumped as the cables will permit.
8. Do not expose the jump starter to rain or snow.
9. Never attempt to jump start a frozen battery.
10. Never place the jump starter directly above battery being jumped.
11. To prevent arcing, never allow the clamps to touch together or to contact the same piece of metal.
12. Use of an attachment not recommended or sold by the jump starter manufacturer may result in damage to the unit or personal injury.
13. Never operate the jump starter if it is damaged.

14. If someone else uses the jump starter, ensure they are well informed on how to use it safely, and have read and understood the operating instructions.
15. The jump starter is NOT designed to be installed as a replacement for a vehicle battery.
16. Use ONLY on vehicles, boats and garden tractors powered with a 12V DC battery system.
17. If the engine fails to start after the recommended number of attempts, disconnect the unit and look for other problems that may need to be corrected.
18. Use the jump starter for jump starting lead-acid batteries only. Do not use for dry cell batteries that are commonly used with home appliances.
19. Do not use a battery pack or appliance that is damaged or modified. Damaged or modified batteries may exhibit unpredictable behavior resulting in fire, explosion, or risk of injury.
20. To reduce the risk of electric shock, unplug the power pack from the outlet before attempting any instructed servicing.
21. Under abusive conditions, liquid may be ejected from the battery; avoid contact. If contact accidentally occurs, flush with water. If liquid contacts eyes, seek medical help. Liquid ejected from the battery may cause irritation or burns.
22. Do not expose a power pack to fire or excessive temperature. Exposure to fire or temperature above 265°F/130°C may cause explosion.
23. Have servicing performed by a qualified repair person using only identical replacement parts. This will ensure that the safety of the product is maintained.
24. Do not modify or attempt to repair the power pack except as indicated in the instructions for use and care.
25. Temporary outdoor use of equipment is allowed if these instructions are followed:
  - The device shall be stored indoors and protected from the elements;
  - The unit shall not be charged outdoors;
  - When in use outdoors, steps should be taken to reduce the exposure to rain, sleet, snow, and other weather events.

## **PERSONAL SAFETY PRECAUTIONS**

1. Wear complete eye protection and protective clothing when working near lead-acid batteries. Always have someone nearby for help.
2. Have plenty of freshwater, soap and baking soda nearby for use, in case battery acid contacts your eyes, skin, or clothing. Wash immediately with soap and water and seek medical attention.
3. If battery acid comes in contact with eyes, flush eyes immediately and get medical attention.
4. Neutralize any acid spills thoroughly with baking soda before attempting to clean up.
5. Remove all personal metal items from your body, such as rings, bracelets, necklaces and watches. A battery can produce a short circuit current high enough to weld a ring to metal, causing a severe burn.
6. Never smoke or allow a spark or flame in the vicinity of the battery or engine.
7. This product contains a lithium-ion battery. In case of fire, you may use water, a foam extinguisher, Halon, CO<sub>2</sub>, ABC dry chemical, powdered graphite, copper powder or soda (sodium carbonate) to extinguish the fire. Once the fire is extinguished, douse the product with water, an aqueous-based extinguishing agent, or other nonalcoholic liquids to cool the product and prevent the battery from re-igniting. NEVER attempt to pick up or move a hot, smoking, or burning product, as you may be injured.
8. NOTE: This equipment has been tested and found to comply with the limits for a Class B digital device,

pursuant to part 15 of the FCC Rules. These limits are designed to provide reasonable protection against harmful interference in a residential installation. This equipment generates, uses, and can radiate radio frequency energy and, if not installed and used in accordance with the instructions, may cause harmful interference to radio communications. However, there is no guarantee that interference will not occur in a particular installation. If this equipment does cause harmful interference to radio or television reception, which can be determined by turning the equipment off and on, the user is encouraged to try to correct the interference by one or more of the following measures:

- Reorient or relocate the receiving antenna.
- Increase the separation between the equipment and receiver.
- Connect the equipment into an outlet on a circuit different from that to which the receiver is connected.
- Consult the dealer or an experienced radio/TV technician for help.

## FEATURES

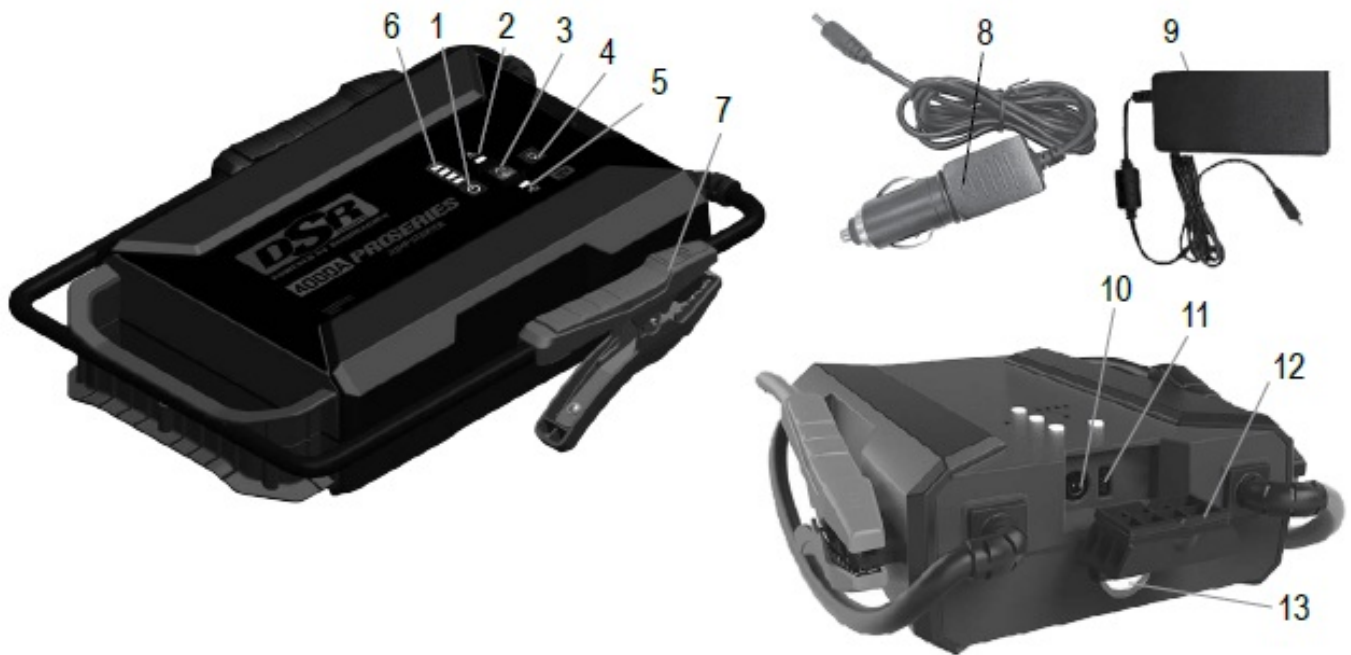

1. Power button
2. Fault LED
3. Jumpstart/Override button
4. Light button
5. Ready LED
6. Battery status indicators
7. Battery clamps
8. 12V DC car charger
9. 100V-240V AC wall charger
10. DC input port
11. USB output port
12. Port cover
13. Built-in work light

## CONTROL PANEL

## LED INDICATORS

- Battery status LED (GREEN) flashing: The internal battery is charging.
- Ready LED (GREEN) solid: The unit is ready to jump start.
- Ready LED (GREEN) flashing: The unit is ready to override.
- Fault LED (RED) solid: Short circuit connected or clamps reversed.

## FUNCTION BUTTONS

- Power button: Press the button to turn on the power and check the battery status. Press the button and hold to turn on the work light.
- NOTE: The unit will automatically turn off if not used for 30 seconds.
- Light button: Press the button and hold to turn on the work light.
- Jumpstart/ Override button: Press the button to jumpstart your vehicle. Press the button and hold for 5 seconds, to jump start your vehicle with low voltage.

## CHARGING THE INTERNAL BATTERY OF THE JUMP STARTER

IMPORTANT: CHARGE IMMEDIATELY AFTER PURCHASE, AFTER EACH USE AND EVERY 30 DAYS, TO KEEP THE JUMP STARTER'S INTERNAL BATTERY FULLY CHARGED AND PROLONG BATTERY LIFE.

## CHECKING THE LEVEL OF THE INTERNAL BATTERY

Press the Power button on the front of the unit. The LEDs will indicate the current charge level as follows:

- 100% charged
- 75% charged
- 50% charged
- 25% charged

Charge the internal battery if the LEDs indicate less than 75%.

## CHARGING THE INTERNAL BATTERY

The jump starter will fully charge in 3.5-4.5 hours (with 15V 3A charger).

**NOTE:** Use a 100V-240V AC wall charger to quickly recharge the jump starter. Using a charger with less than 3A will increase charge time.

1. Plug the AC wall charger into the input port.
2. Plug your charger into a live AC power outlet.
3. When the unit is fully charged, all four green LEDs turn solid for a short time, and then shut off.
4. When the battery is fully charged, disconnect your wall charger from the AC outlet and then remove the wall charger from the unit.
5. Charge the unit as soon as possible after use.

## CHARGING THE INTERNAL BATTERY WHILE DRIVING

You may also charge the internal batteries while driving, using the 12V DC car charger (included). The jump starter will fully charge in 5.5-6.5 hours.

1. Make sure the car is running.
2. Plug the 12V DC adaptor cable into the unit's 12V input socket.
3. Insert the other end of the accessory cable into the vehicle's accessory outlet.
4. When the unit is fully charged, all four green LEDs turn solid for a short time, and then shut off.
5. When the battery is fully charged, disconnect your charger from the power source and then remove the charging cable from the charger and the unit.
6. Charge the unit as soon as possible after use.

NOTE: Completely disconnect the charger cable when the engine is not running.

## **OPERATING INSTRUCTIONS**

### **JUMP STARTING A VEHICLE**

**IMPORTANT:** Using the jump starter without a battery installed in the vehicle will damage the vehicle's electrical system.

1. Turn the ignition OFF.
2. Lay the DC cables away from any fan blades, belts, pulleys, and other moving parts.  
NOTE: Make sure all of the vehicle's electrical devices are turned off.
3. For a negative-ground vehicle (as in most vehicles), connect the jump starter's POSITIVE (RED) clamp to the POSITIVE (POS, P, +) battery post. Next, connect the NEGATIVE (BLACK) clamp to the vehicle chassis or engine block, away from the battery.
4. For a positive-ground vehicle, connect the jump starter's NEGATIVE (BLACK) clamp to the NEGATIVE (NEG, N, -) battery post. Next, connect the POSITIVE (RED) clamp to the vehicle chassis or engine block away from the battery.
5. Press the Jump start/Override button to turn on the jump starter. The green Ready LED will light.
6. It is best to wait 30 seconds after clamp connection to attempt to start the vehicle. Crank for up to 5 seconds. If engine does not start, wait 30 seconds before cranking again.
7. After the engine starts, press the Jump start/Override button to turn the jump starter off, and then disconnect the black clamp (-) and the red clamp (+), in that order.
8. Recharge the unit as soon as possible after each use. NOTE: Recharge the unit when all Battery Status LEDs are off.

### **STARTING A BATTERY WITH LOW VOLTAGE**

If the vehicle's battery voltage is too low for the jump starter to detect that the clamps are connected, there is a manual start procedure to enable the jump start function.

1. Make sure the clamps are correctly connected.
2. Press the Jump start/Override button once then press and hold for 5 seconds, to turn on the override mode.  
The green Ready LED will flash.

**WARNING!** This overrides a safety feature. It will energize the clamps and cause sparking if they are touched together. If the clamp connections are shorted or reversed, damage to the unit, battery, and possibly the car's electrical system will occur.

## **USING THE USB PORT**

The USB port provides up to 2.4A at 5V DC.

1. Ensure the battery clamps are securely clipped on the storage holders.
2. Press the Power button on the front of the unit to turn on the power.
3. Plug your device into the USB port.
4. Turn on the USB device, if necessary.
5. When finished using the USB port, turn off the device (if necessary) and unplug the device.
6. Recharge the unit as soon as possible after each use. **NOTE:** Recharge the unit when all Battery Status LEDs are off.

## **USING THE WORK LIGHT**

1. Position the jump starter on a flat, stable surface near the intended work area.
2. Ensure the battery clamps are securely clipped on the storage holders.
3. Press the Light button on the front of the unit and hold for 0.75 second, to cycle through the following modes:
  - Steady glow
  - Flash for an SOS signal
  - Flash in strobe mode
4. When finished using the work light, press and hold the button for 0.75 second, to turn off the work light.
5. Recharge the unit as soon as possible after each use.

## **MAINTENANCE AND STORAGE**

1. Clean the clips and the case each time you are finished using it.
2. Charge battery to full capacity before storage.
3. Store this unit at the temperatures between 14°F to 113°F (-10°C to 45°C).
4. Store clips on their support posts, to ensure they do not come into contact with any metallic surface.
5. Never completely discharge the internal battery.
6. Charge after each use.
7. Charge at least once every month, if not in frequent use, to prevent over-discharge.

## **TROUBLESHOOTING**

PROBLEM	POSSIBLE CAUSE	SOLUTION
The jump starter won't jump start my car.	<p>Clamps are not making a good connection to the battery.</p> <p>Connections are reversed.</p> <p>The jump starter's battery is not charged.</p> <p>The vehicle's battery is defective. The jump starter is not turned on.</p>	<p>Check for poor connection to battery and frame. Make sure connection points are clean.</p> <p>Disconnect the jump starter and reverse the clamps.</p> <p>Press the Power button on the front of the unit. The LEDs will indicate the status of charge.</p> <p>Have the battery checked.</p> <p>Press the Jumpstart/Override button to turn on the jump starter.</p>
The jump starter will not operate.	The internal battery voltage is too low.	Use the wall charger or car charger to charge and activate.
The battery in the jump starter won't hold a charge.	The battery is bad (will not accept a charge).	Have the battery checked.

## REPLACEMENT PARTS

- 12V DC car charger .....  
2299003640Z
- 100V-240V AC wall charger .....  
930261016Z

## SPECIFICATIONS

- Internal battery type ..... Lithium-ion polymer
- Battery Capacity .....  
26,800mAh
- Cranking Current .....  
4000A peak
- USB output .....  
5V DC, 2.4A
- DC input .....15V DC, 2A /  
12V DC, 2A
- Charging temperature .....32°F to 113°F (0°C to 45°C)
- Discharging temperature ..... -4°F to 140°F (-20°C to 6°C)
- Storage temperature .....14°F to 113°F (-10°C to 45°C)



BEFORE RETURNING FOR REPAIRS

For REPAIRS OR RETURNS, visit 365rma.com Visit [schumacherelectric.com](http://schumacherelectric.com) for Replacement Parts.

LIMITED WARRANTY

For information on our one-year limited warranty, please visit [schumacherelectric.com](http://schumacherelectric.com) or call 1-800-621-5485 to request a copy. Go to schumacherelectric.com to register your product online.

Documents / Resources

	<a href="#">SchSchumacher DSR164 Lithium Ion Jump Starter and USB Power Source</a> [pdf] Owner's Manual DSR164, Lithium Ion Jump Starter and USB Power Source, Lithium Ion Jump Starter, Jump Starter
-----------------------------------------------------------------------------------	----------------------------------------------------------------------------------------------------------------------------------------------------------------------------------------------------------

References

- [\\*\\* 365RMA.COM \\*\\*](#)
- [Home Page - Schumacher Electric](#)