

Schröder
PF5LEDKIT
Tunnel Retrofit
Solution



Schröder PF5LEDKIT Tunnel Retrofit Solution Installation Guide

[Home](#) » [Schröder](#) » Schröder PF5LEDKIT Tunnel Retrofit Solution Installation Guide 

Contents

- [1 Schröder PF5LEDKIT Tunnel Retrofit Solution](#)
- [2 Product Overview](#)
- [3 INSTALLATION](#)
- [4 INPUT connection](#)
- [5 SAFETY INSTRUCTIONS](#)
- [6 MORE INFORMATION](#)
- [7 FAQs](#)
- [8 Documents / Resources](#)
 - [8.1 References](#)

Schröder

Schröder PF5LEDKIT Tunnel Retrofit Solution



Product Overview

- **Led colour code** 740 NW
- **Light source energy efficiency class** – High power C

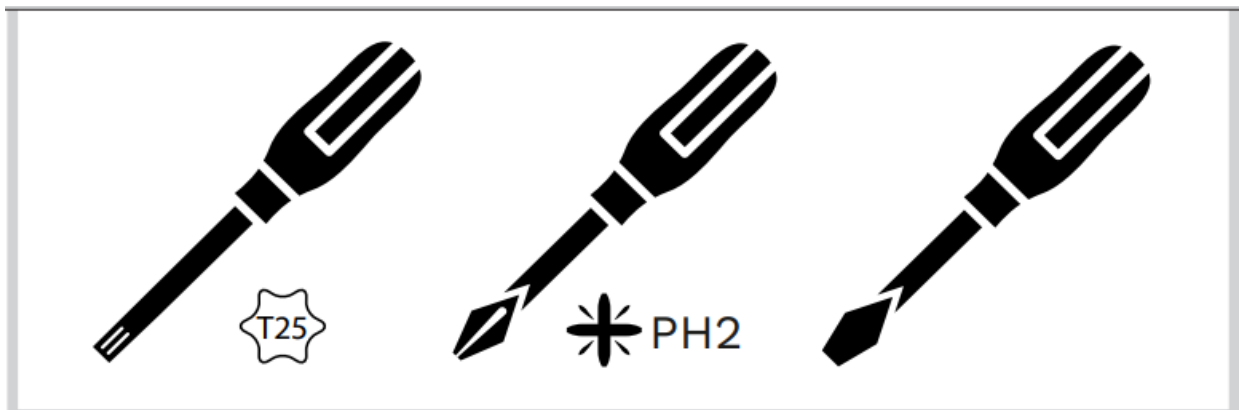

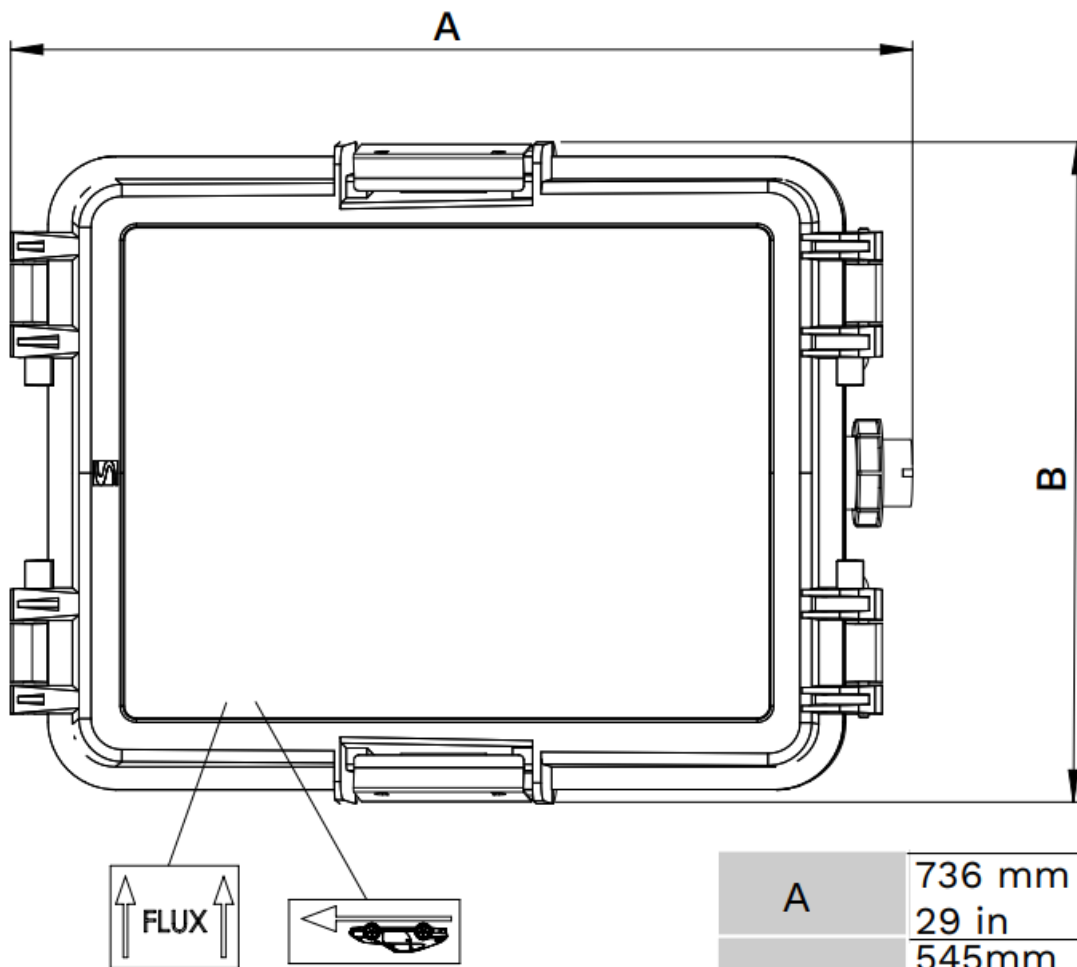

A	736 mm 29 in
B	545mm 21.4 in
C	195 mm 7.6 in
KG	17.5 kg 38.5 lb

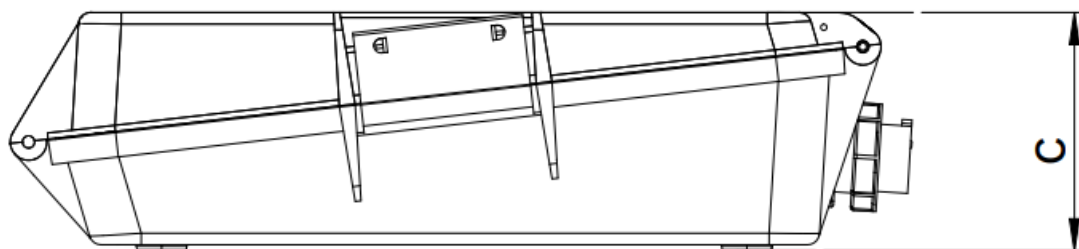

INSTALLATION

1

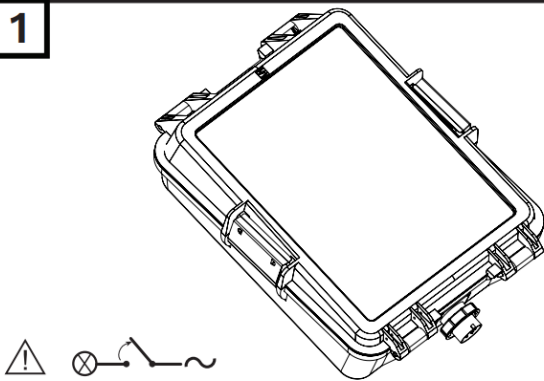

Make sure the luminaire is disconnected from the network and the glass plate is properly cleaned (any impurities removed) prior to the installation of the LED retrofit Kit.

2

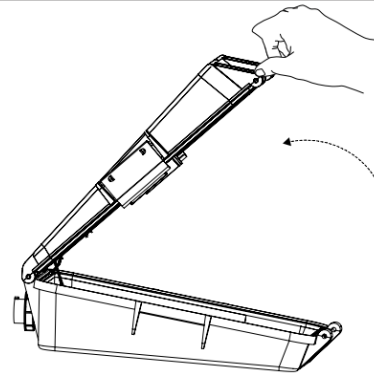

Open the luminaire for the gear compartment and light source installation (previously remove the old HID installation).

3

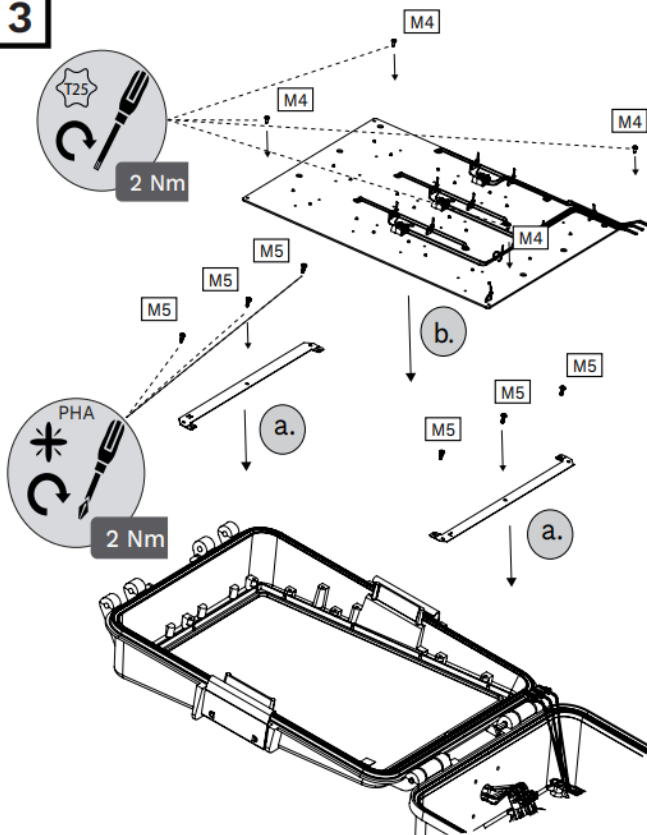

Mount light source
a. fix two brackets to the cover with 6 screws M5x15
b. place LLM plate to the fixed brackets with 4 screws M4x10

4

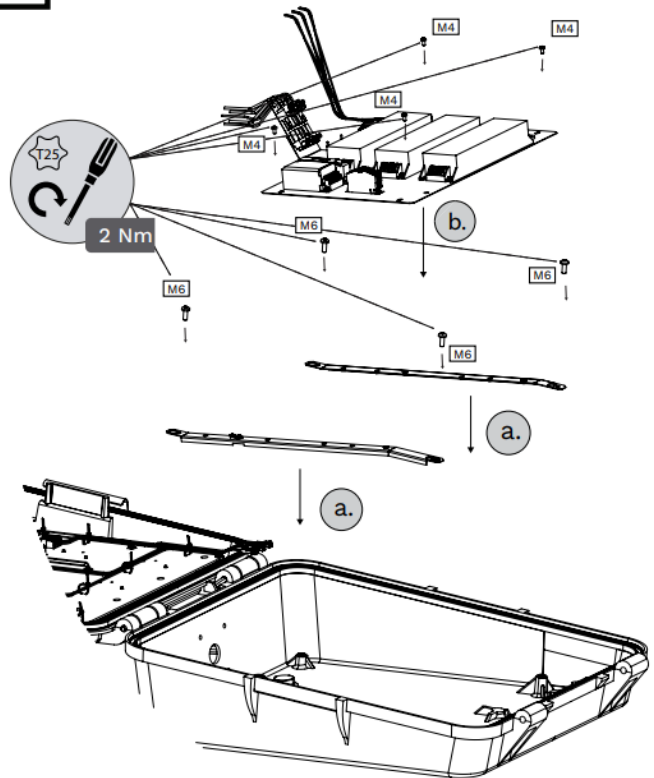

Mount gear compartment
a. fix two brackets to the body with 4 screws M6x16
b. place gear plate to the fixed brackets with 4 screws M4x8

5

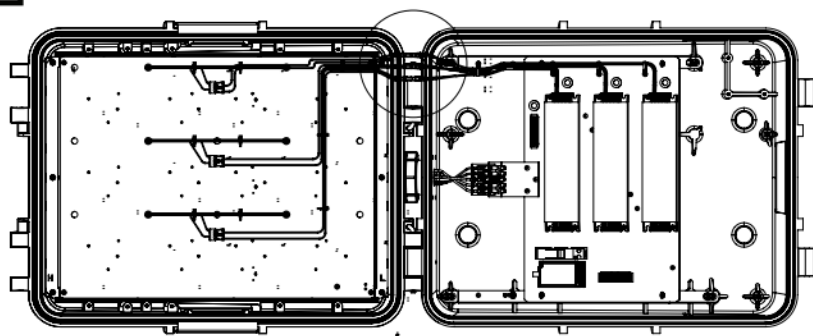

Connect LEDs to drivers outputs

6

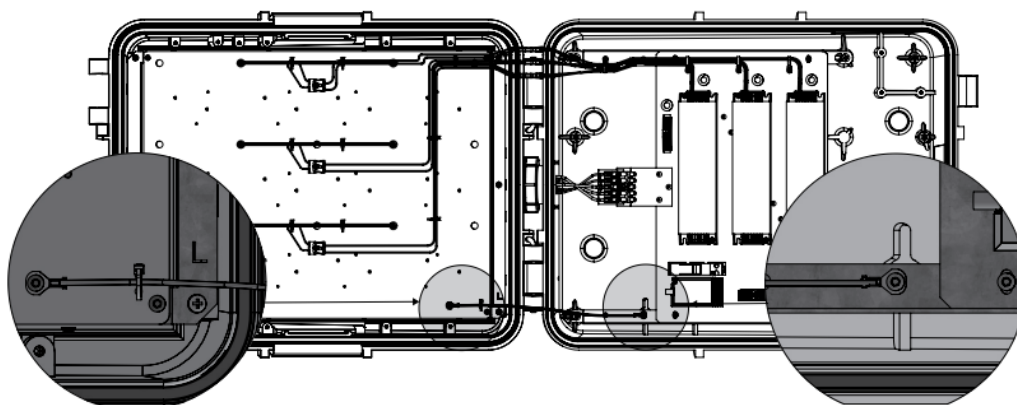

Screw the Earth cable

7

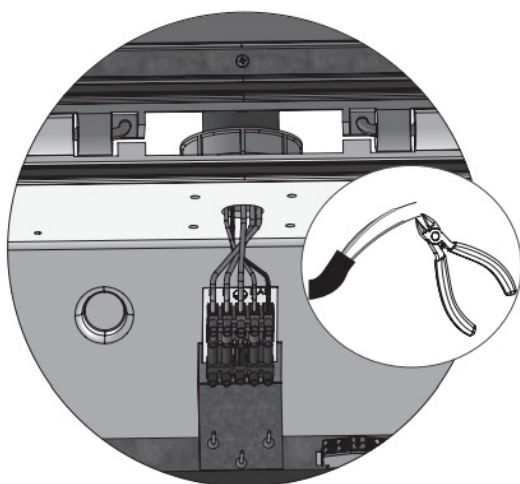

Screw mains cable to the pluggable terminal block and cut excess wire length if it's longer than expected (cross section connection - 2.5 mm² max).

8

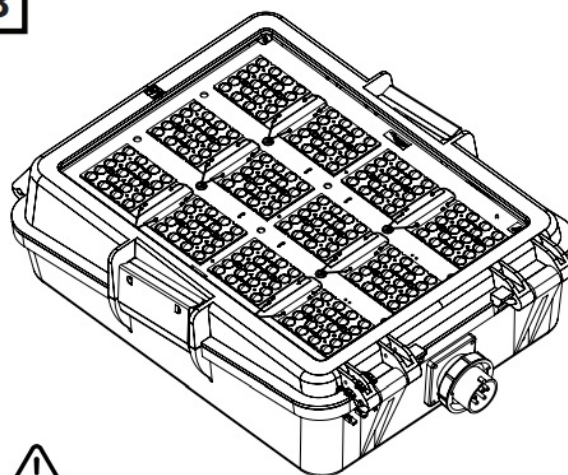

Close the luminaire and connect the assembly to the network

INPUT connection

c

INPUT connection

Mains and Controls combined**Wieland connector**

Connector position: CENTRAL

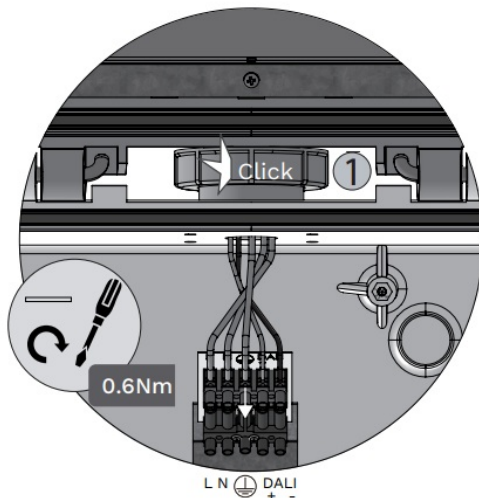
a

0-10V/DALI
1 : Wieland ST18 (5P)

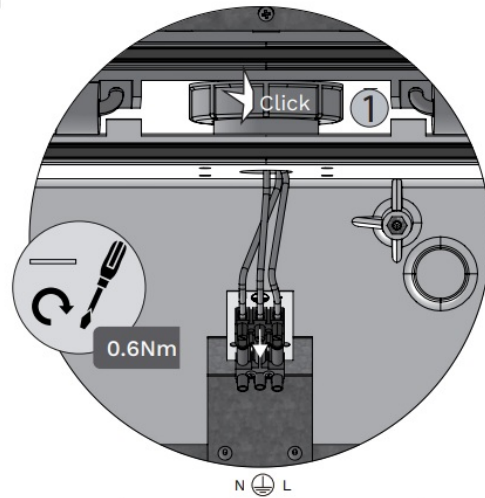
b

No Dim
1 : Wieland ST18 (3P)

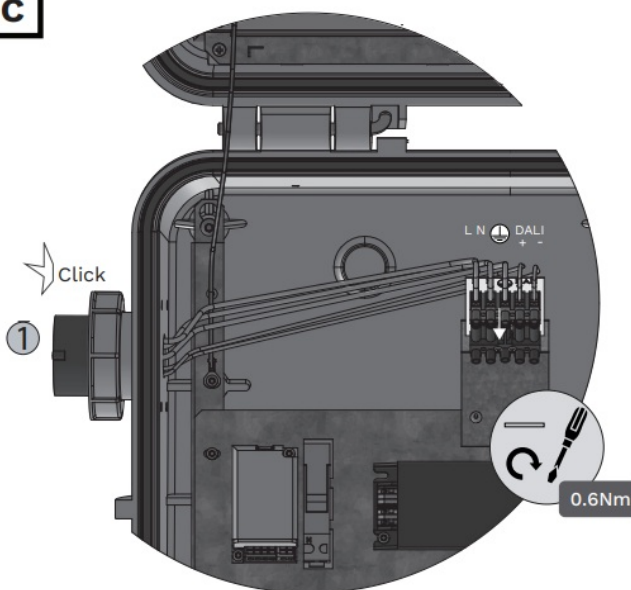
c

0-10V/DALI
1 : Wieland ST18 (5P)

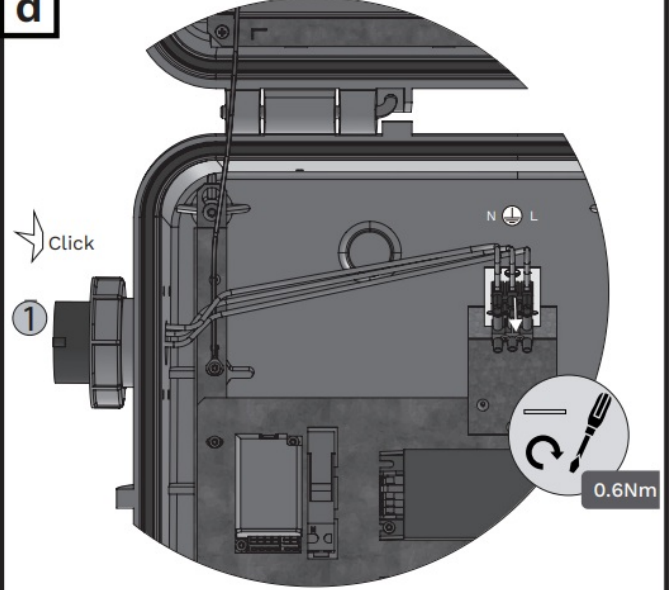
d

No Dim
1 : Wieland ST18 (3P)

Connector position: LEFT

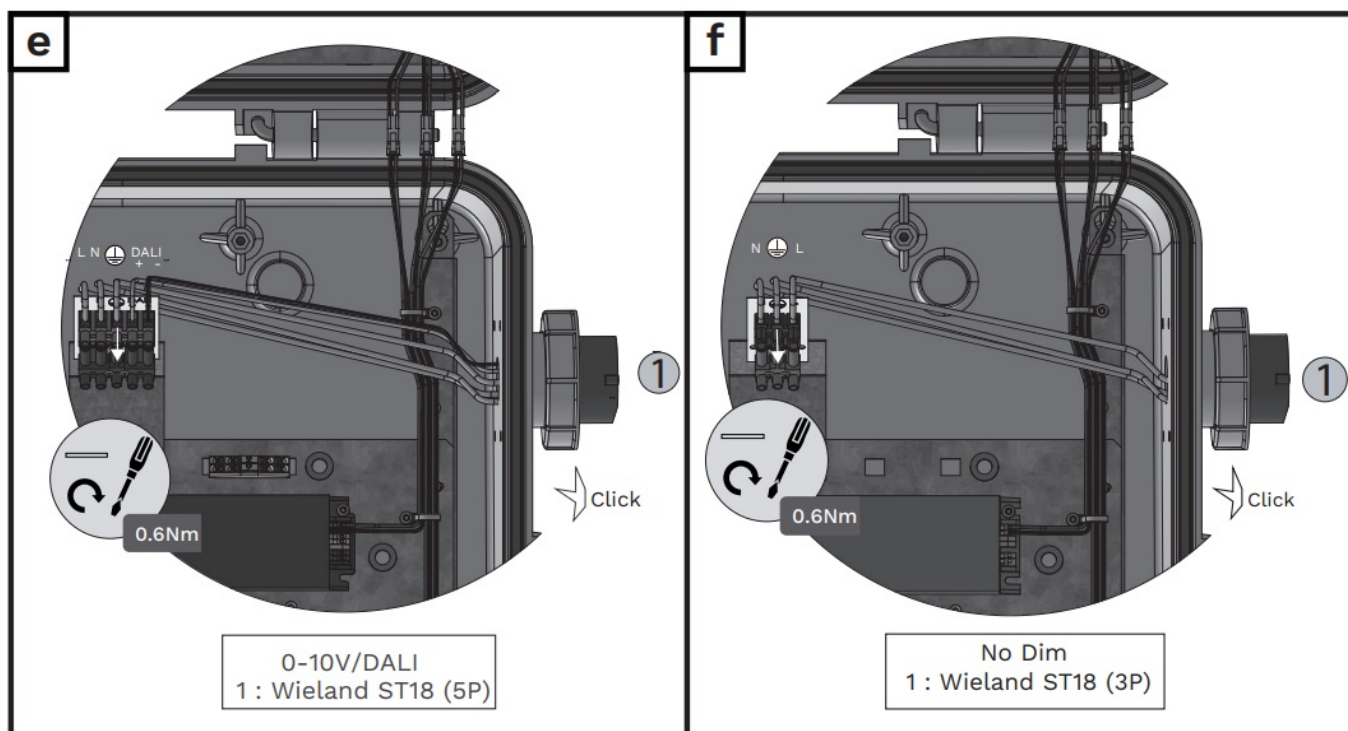

SAFETY INSTRUCTIONS

The light source contained in this luminaire shall only be replaced by the manufacturer or his service agent or a similar qualified person. Always switch off the power prior to installation, maintenance or repair activities.

RISK GROUP

RISK GROUP 2 – CAUTION! Hazardous optical radiation may be emitted from this product. Do not stare at the luminaire when operating as it may be harmful to the eyes. The luminaire should be positioned so that prolonged staring at the luminaire at a distance of less than 0.94m is not expected.

ENERGY EFFICIENCY

This product contains a light source of an energy efficiency class G or higher or see table on the first page.

PVC INSULATION AND Y CONNECTION

In the case of PVC insulated mains cable, the installer MUST ensure that the WHOLE cable is protected against climatic conditions, especially UV rays and rain, by making sure that the cable is contained inside the luminaire and pole. Y-connection: In case of damage to the wire, it has to be replaced only by the manufacturer, distributor, or by an expert, to avoid risks.

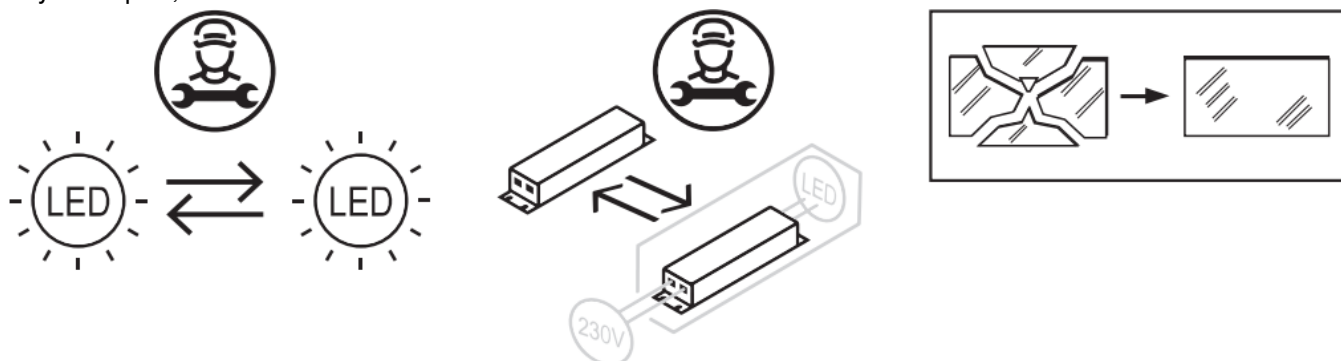

MORE INFORMATION



- www.schreder.com

FAQs

- **Q: What should I do if the product emits harmful optical radiation?**
 - **A:** Avoid visual contact with the light source during operation. Position the luminaire to prevent prolonged visual contact from a distance less than 0.94m.
- **Q: How should the main cable be secured?**
 - **A:** Screw the mains cable to the pluggable terminal block and cut excess wire length if necessary.

Documents / Resources

	<p>Schreder PF5LEDKIT Tunnel Retrofit Solution [pdf] Installation Guide PF5LEDKIT Tunnel Retrofit Solution, PF5LEDKIT, Tunnel Retrofit Solution, Retrofit Solution</p>
--	---

References

- [User Manual](#)

[Manuals+](#), [Privacy Policy](#)

This website is an independent publication and is neither affiliated with nor endorsed by any of the trademark owners. The "Bluetooth®" word mark and logos are registered trademarks owned by Bluetooth SIG, Inc. The "Wi-Fi®" word mark and logos are registered trademarks owned by the Wi-Fi Alliance. Any use of these marks on this website does not imply any affiliation with or endorsement.