

**Schröder
CLB1 Circle
LED Base**



Schröder CLB1 Circle LED Base Instruction Manual

[Home](#) » [Schröder](#) » Schröder CLB1 Circle LED Base Instruction Manual 

Contents

- [1 Schröder CLB1 Circle LED Base](#)
- [2 Specifications](#)
- [3 Product Usage Instructions](#)
- [4 FAQ](#)
- [5 TOOLS](#)
- [6 Dimension](#)
- [7 Installation Instructions](#)
- [8 Documents / Resources](#)
 - [8.1 References](#)
- [9 Related Posts](#)

Schröder

Schröder CLB1 Circle LED Base



Specifications

- **Product Name:** Circle LED Base 1 & 2 for Valentino
- **Dimensions:** 98mm x 141.8mm x 132mm
- **Weight:** Not specified
- **Manufacturer:** Schreder
- **Model Number:** 03-77-296
- **Revision:** A
- **Release Date:** April 2024
- **Website:** www.schreder.com

Product Usage Instructions

1. Disconnect the luminaire from the network and clean the surface.
2. Open the luminaire to access the gear compartment and light source.
3. Disconnect mains power and remove connectors from cables (keep them for later use).
4. Disconnect HID cables.
5. Remove the screws holding the optical compartment (keep them for later use) and then remove the optical compartment.
6. Remove the gearplate.
7. Place and fasten the adaptation plate into position in the luminaire body with the previously removed screws (tightening torque: 2Nm).
8. Put connectors on mains cable and CLB cable.
 - a. Connect the earthing cable of the adaptation plate to the luminaire body.
 - b. Connect mains cable to CLB unit.
9. Close the luminaire.
10. Connect the assembly back to the network.

FAQ

- **Q:** Can CLB2 be used for Valentino?
- **A:** Yes, CLB2 is also available for Valentino, with the same adaptation plate size dimensions (only the cut-out being different).

TOOLS

- All the tightening torques values are given for assemblies without the addition of a grease-decreasing friction.

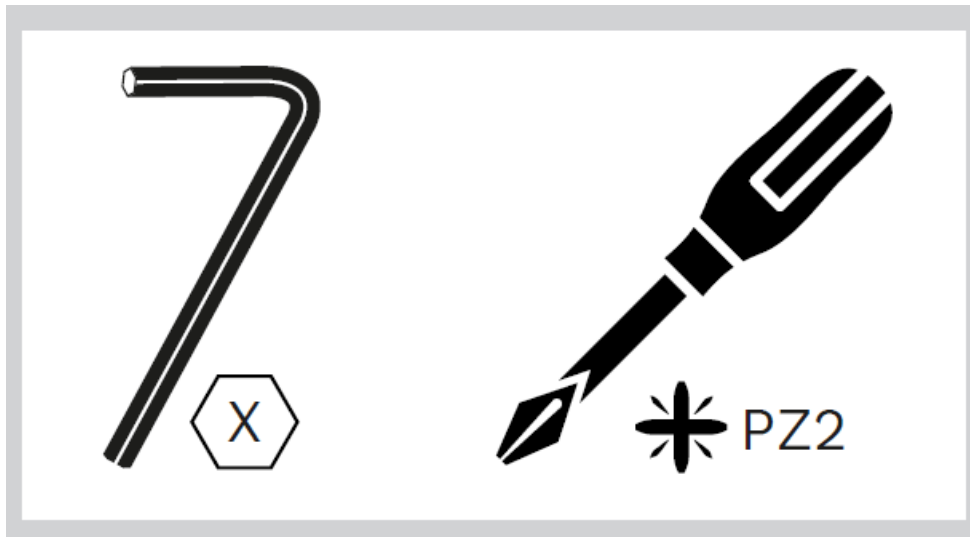

Dimension

VALENTINO WITH CLB1

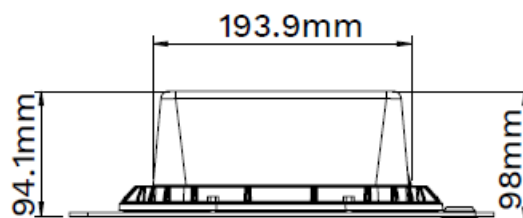
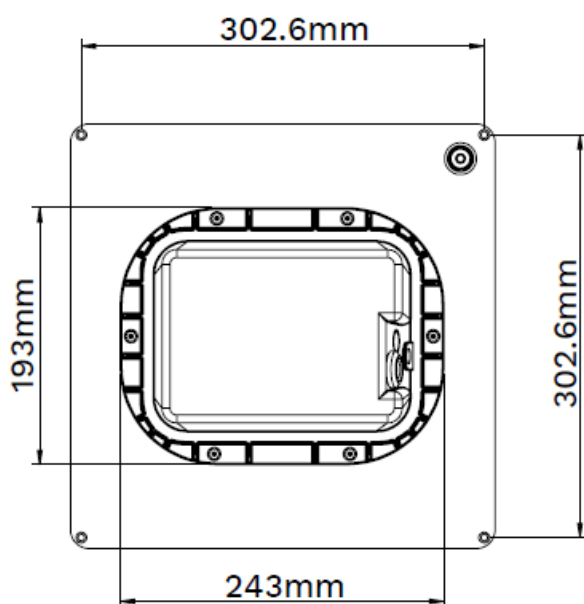
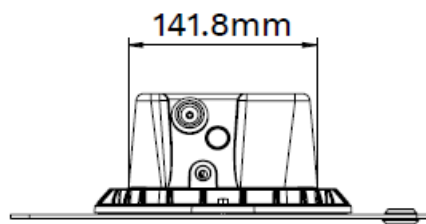
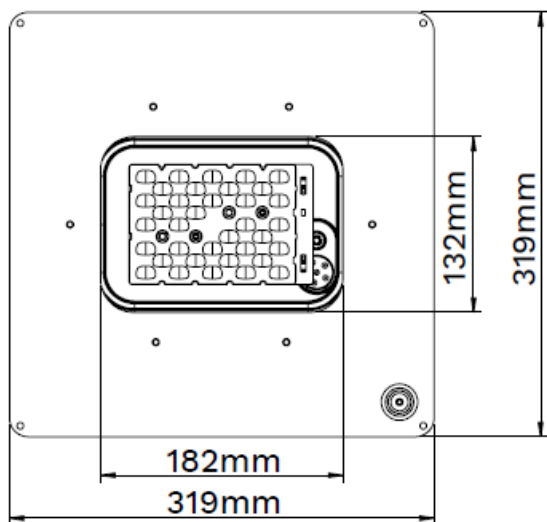

CLB2 is also available for VALENTINO, with the same adaptation plate size dimensions (only the cut-out being different)

Installation Instructions

1. Disconnect the luminaire from the network and clean the surface

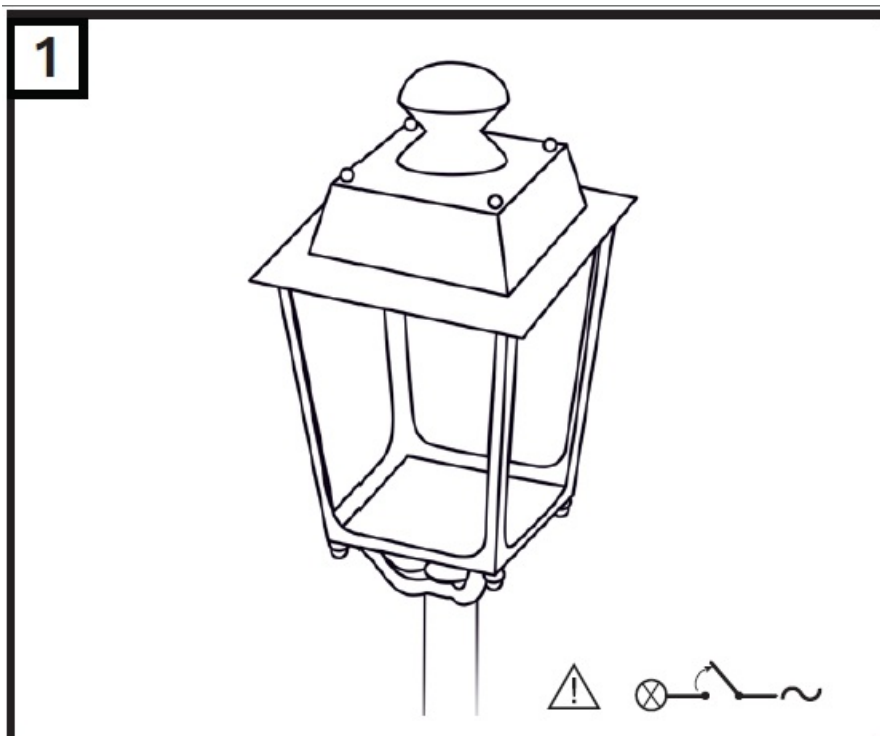

2. Open the luminaire for the gear compartment and light source access

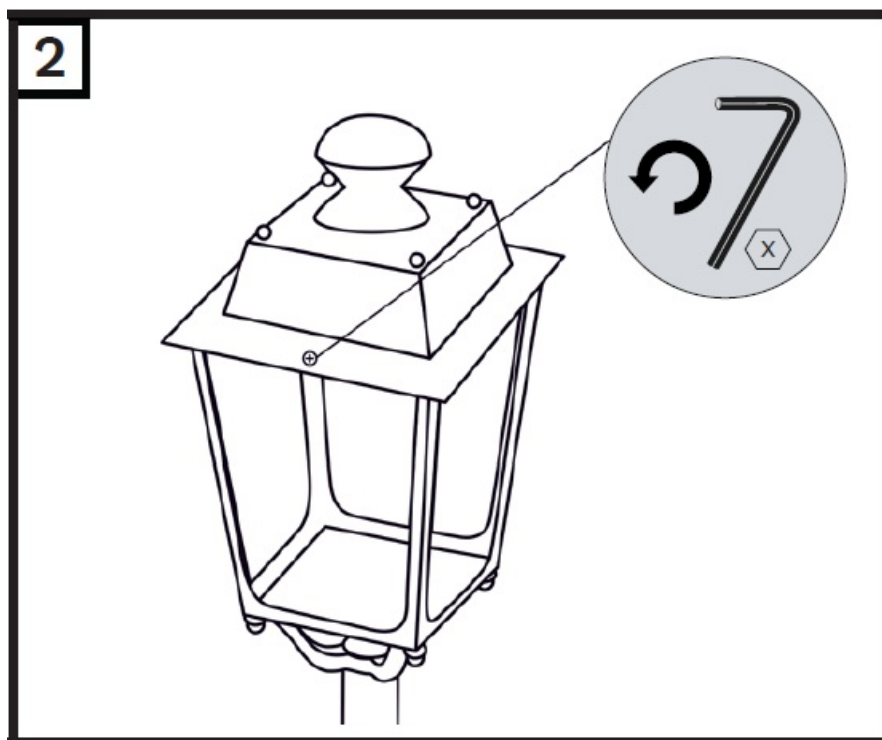

3. Disconnect mains and remove connectors from cables KEEP THESE FOR LATER USE!

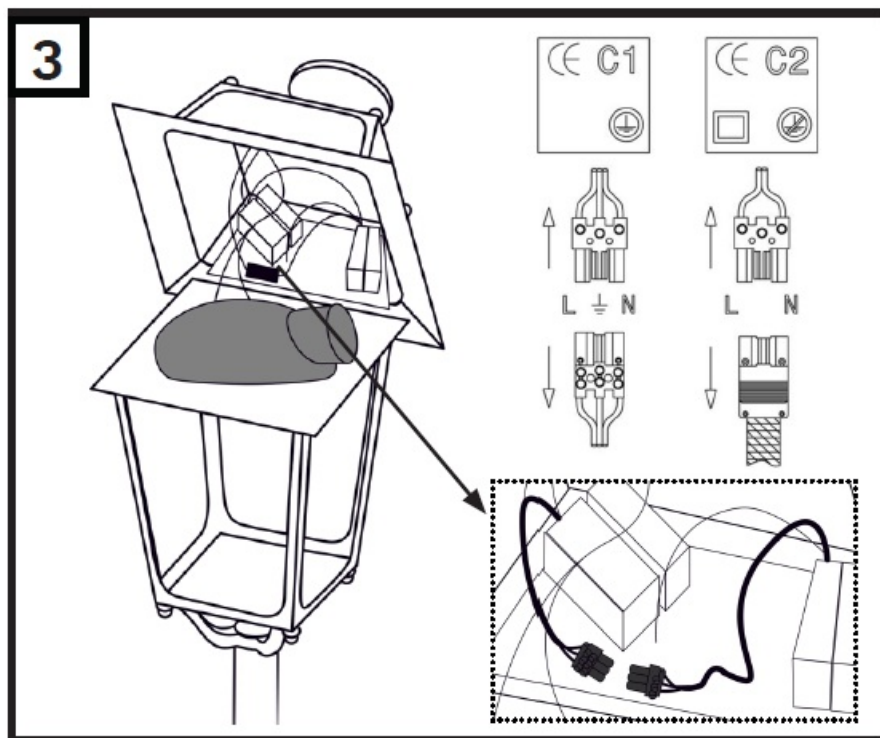

4. Disconnect HID cables

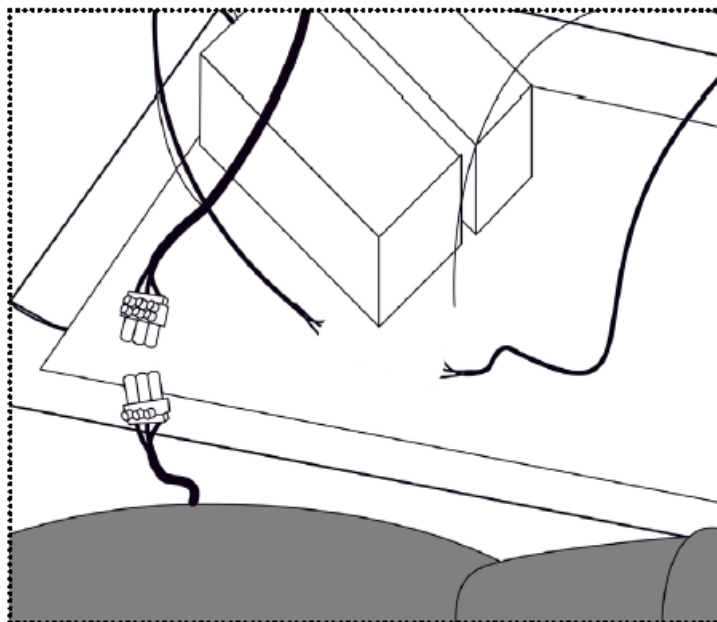

5. Remove the screws holding the optical compartment. KEEP THESE FOR LATER USE!

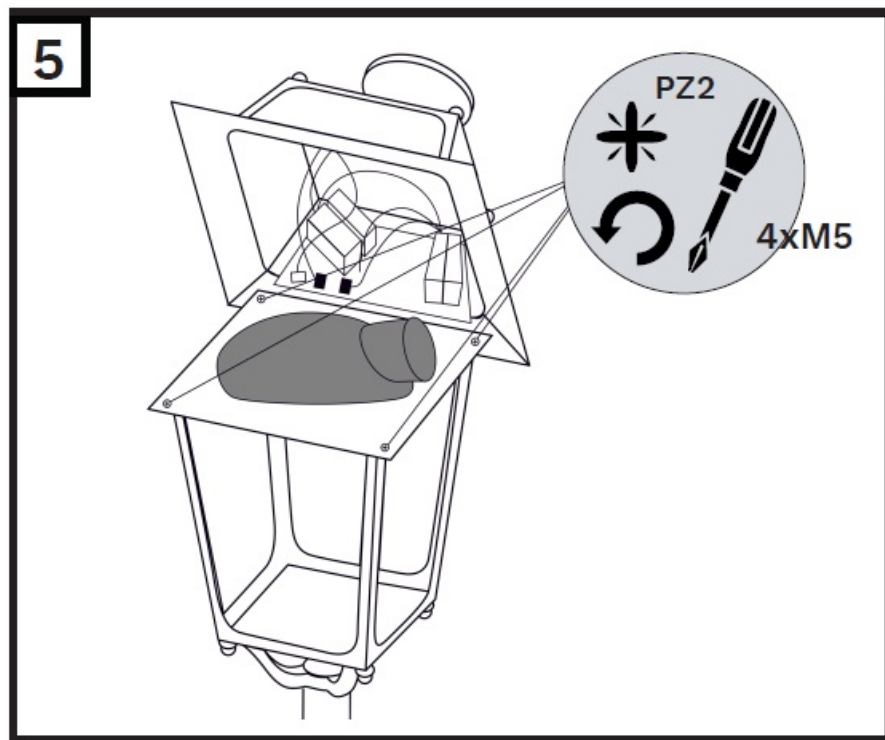

6. Remove optical compartment

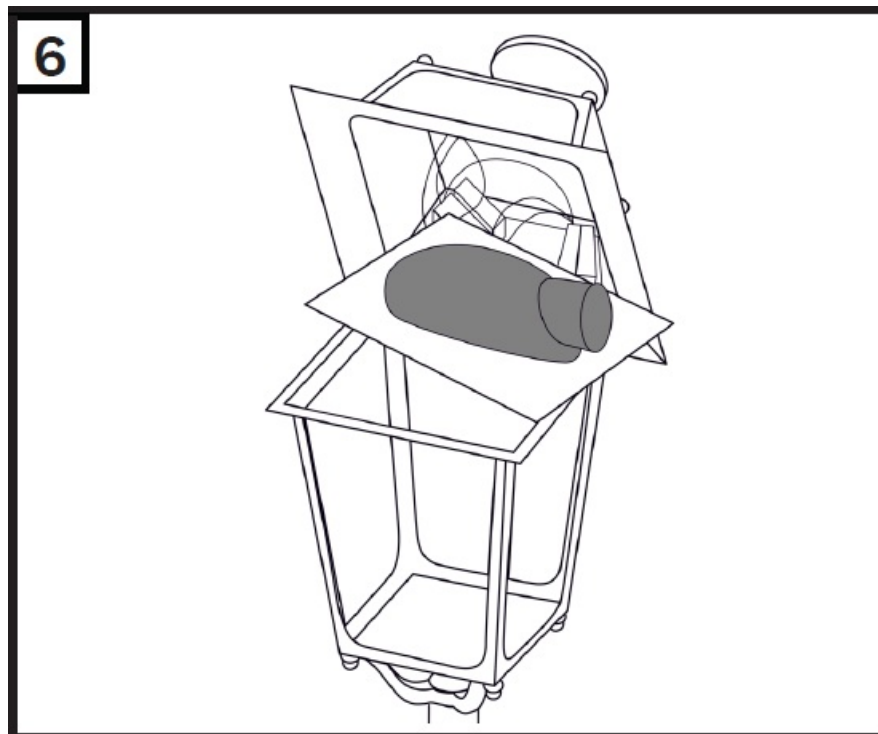

7. Remove gear plate

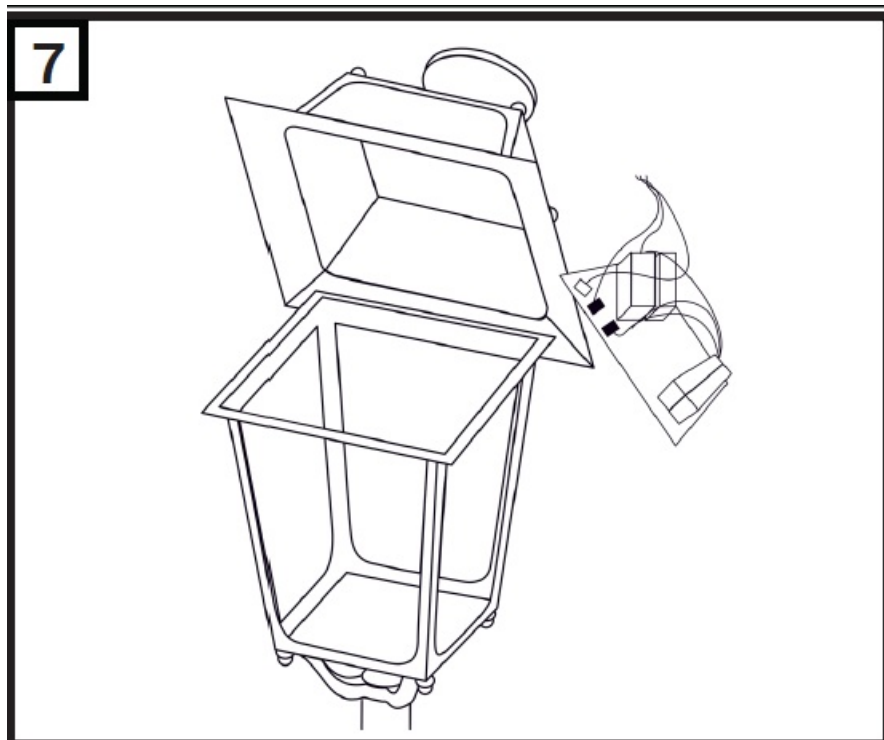

8. Place and fasten the adaptation plate into position in the luminaire body with the previously removed screws (tightening torque: 2Nm)

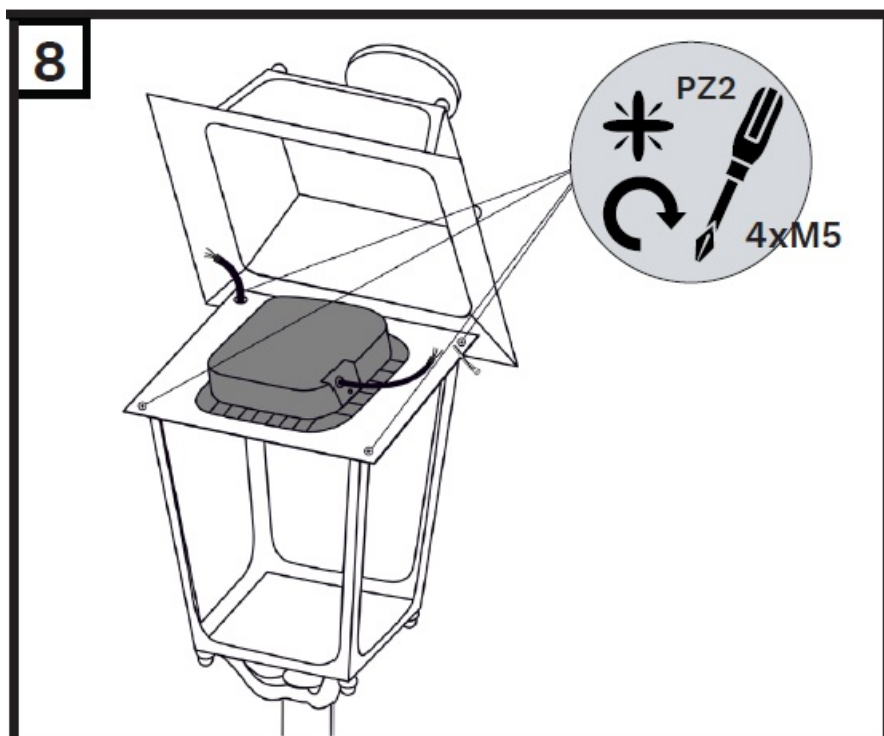

9. Put connectors on mains cable and CLB cable

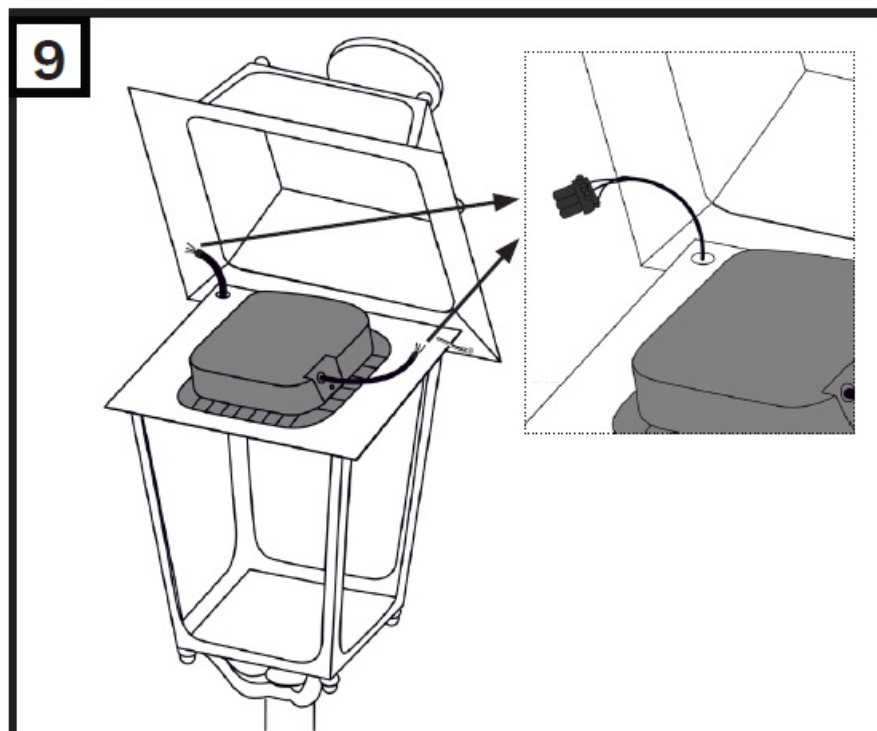

10. Connect the earthing cable of the adaptation plate to the luminaire body

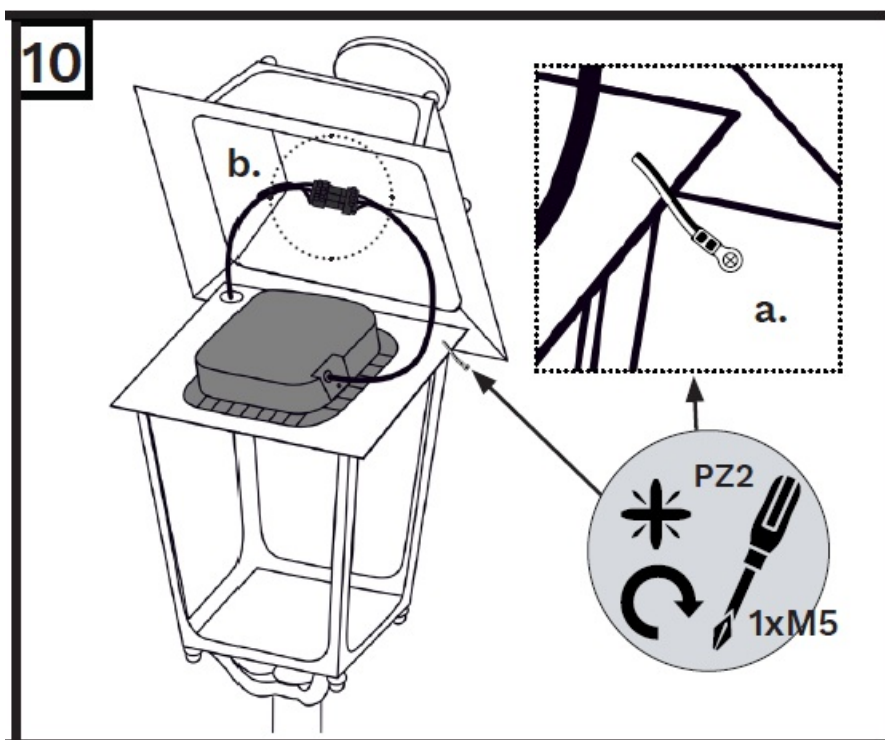

11. Connect mains cable to CLB unit

- Close the luminaire

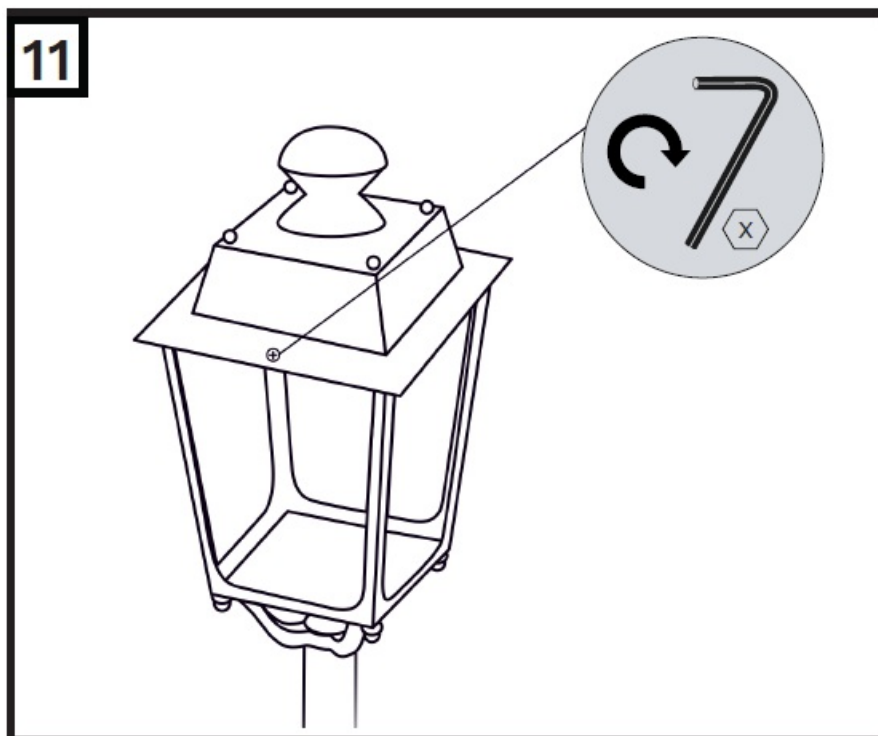

12. Connect the assembly back on the network

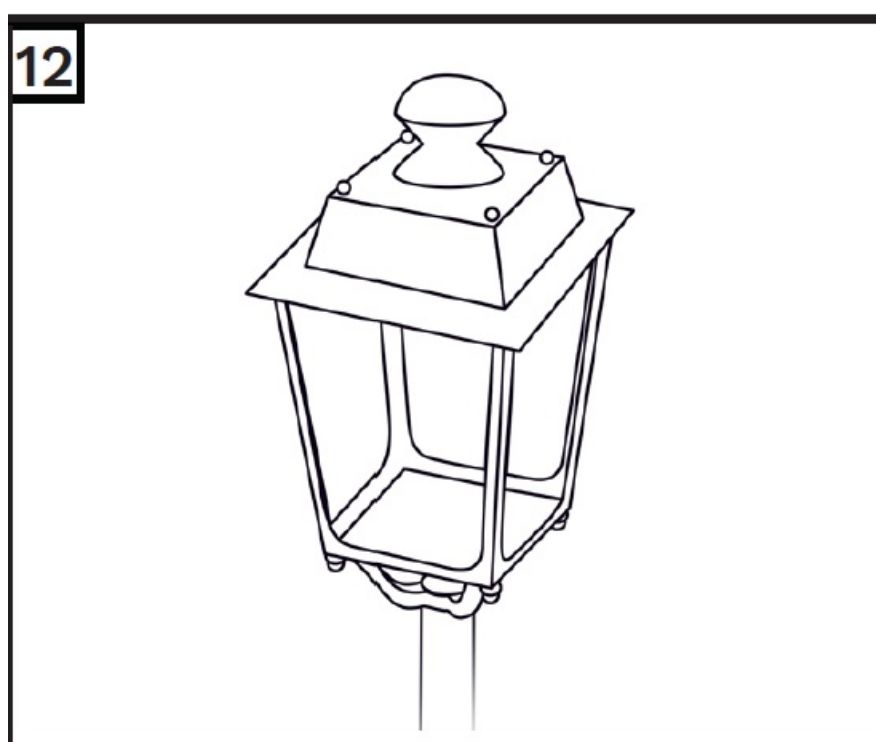

Copyright © Schröder S.A. 2024 – Executive Publisher: The information, descriptions and illustrations herein are only of an indicative nature and subject to changes without notice. www.schreder.com.

Documents / Resources

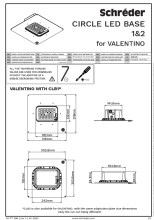

[Schreder CLB1 Circle LED Base](#) [pdf] Instruction Manual

CLB1, CLB2, CLB1 Circle LED Base, CLB1, Circle LED Base, LED Base, Base

References

- [User Manual](#)

Manuals+, Privacy Policy

This website is an independent publication and is neither affiliated with nor endorsed by any of the trademark owners. The "Bluetooth®" word mark and logos are registered trademarks owned by Bluetooth SIG, Inc. The "Wi-Fi®" word mark and logos are registered trademarks owned by the Wi-Fi Alliance. Any use of these marks on this website does not imply any affiliation with or endorsement.