



## Schreder BRITELINE GEN2 2 External Version Versatile and Efficient Lighting Instruction Manual

[Home](#) » [Schreder](#) » Schreder BRITELINE GEN2 2 External Version Versatile and Efficient Lighting Instruction Manual 

# Schréder

BRITELINE  
GEN2 2  
External version

### Contents

- 1 BRITELINE GEN2 2 External Version Versatile and Efficient Lighting
- 2 PRODUCT OVERVIEW
- 3 MOUNTING
- 4 ANGLE ADJUSTMENT
- 5 ALLOWED POSITIONING
- 6 GEAR INSTALLATION
- 7 SAFETY CABLE
- 8 ELECTRICAL CONNECTION
- 9 RECOMMENDATIONS
- 10 AIMING DEVICE
- 11 ACCESSORIES – HOOD
- 12 SAFETY INSTRUCTIONS
- 13 Documents / Resources

**BRITELINE GEN2 2 External Version Versatile and Efficient Lighting**

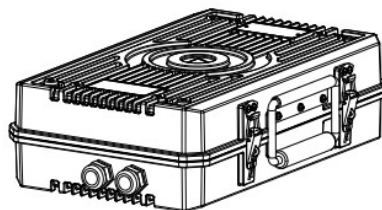
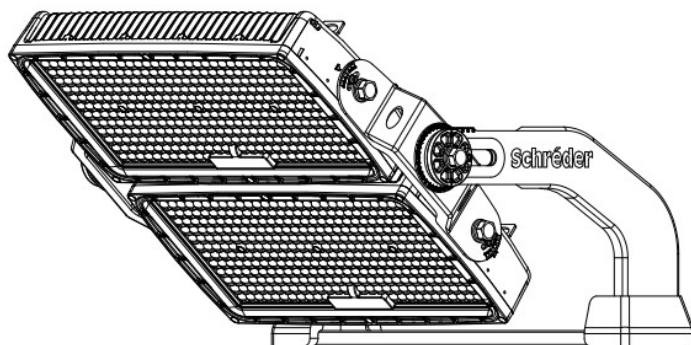

## INSTALLATION INSTRUCTIONS

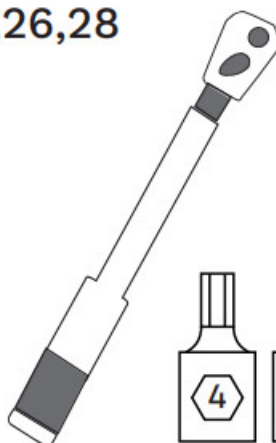
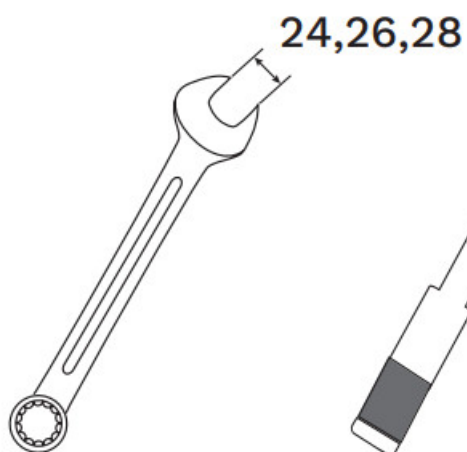
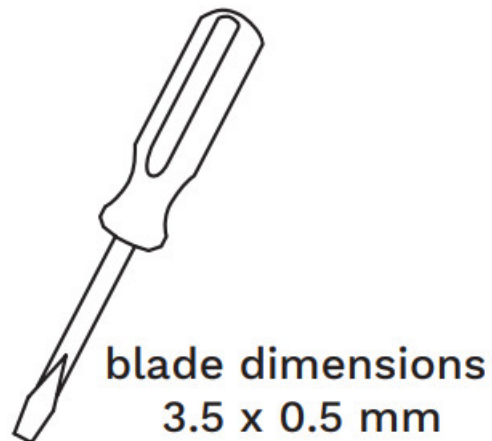
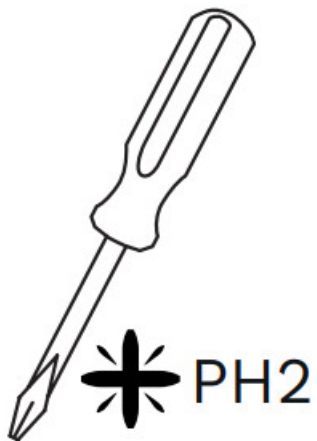
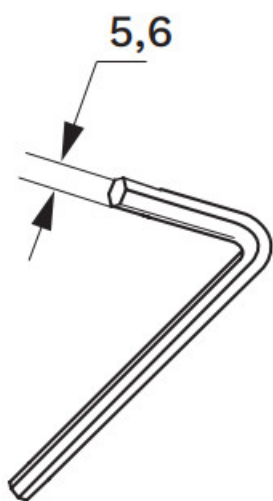



WEAR PROTECTIVE GLOVES

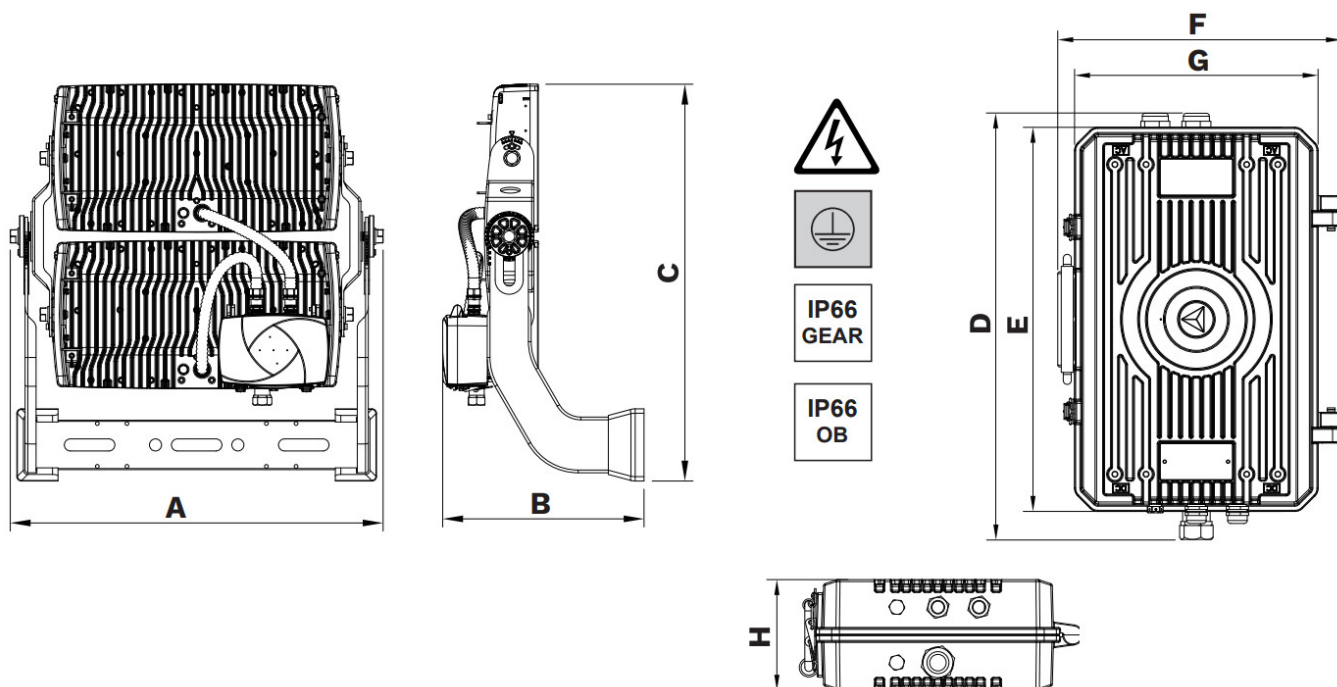

## PRODUCT OVERVIEW



BRITELINE GEN2 2				EXTERNAL GEAR BOX					
A	B	C		D	E	F	G	H	
679mm 26.73in	367mm 14.44in	723mm 28.46in	30kg 6613lbs	426mm 16.77in	384mm 15.11in	283mm 11.14in	243mm 9.56in	110mm 4.33in	10kg 22.04lbs

### EPA – Effective Projected Area

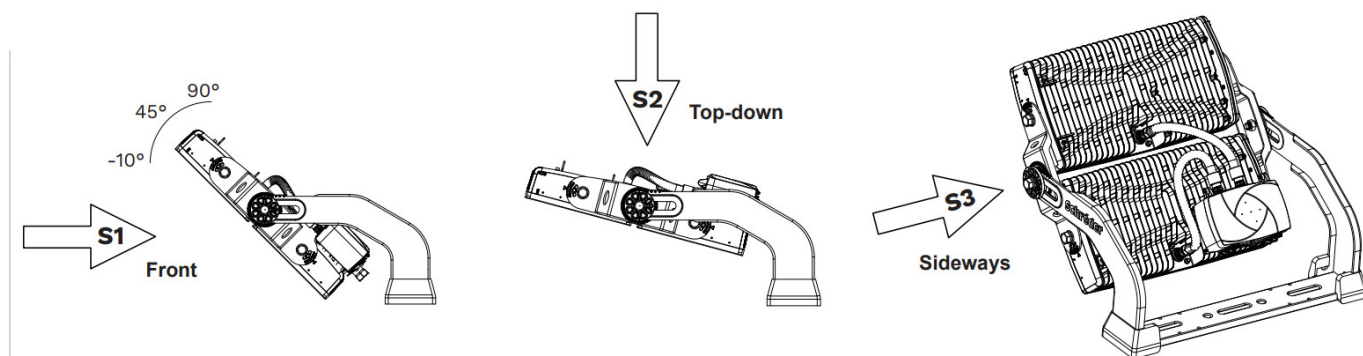

	a = 0°			a = 30°			a = 45°			a = 70°			a = 90°		
	S(m <sup>2</sup> )	CxS (m <sup>2</sup> )	EP A (ft <sup>2</sup> )	S(m <sup>2</sup> )	CxS (m <sup>2</sup> )	EP A (ft <sup>2</sup> )	S(m <sup>2</sup> )	CxS (m <sup>2</sup> )	EP A (ft <sup>2</sup> )	S(m <sup>2</sup> )	CxS (m <sup>2</sup> )	EP A (ft <sup>2</sup> )	S(m <sup>2</sup> )	CxS (m <sup>2</sup> )	EP A (ft <sup>2</sup> )
Si	0.063 3	0.08	0.8 2	1718	0.21	2.	0.225 3	0.28	3.	0.281 5	0.34	4.	0.291 5	0.35	4.
S2	0.291 5	0.35	377	0.276 4	0.34	4.	0.242 8	0.3	3.	0.153 0	19	2.	0.063 3	0.08	0.82
S3	0.062 5	0.08	0.8 1	0.062 5	0.08	0.81	0.062 5	0.08	0.81	0.062 5	0.08	0.81	0.062 5	0.08	0.81

MOUNTING

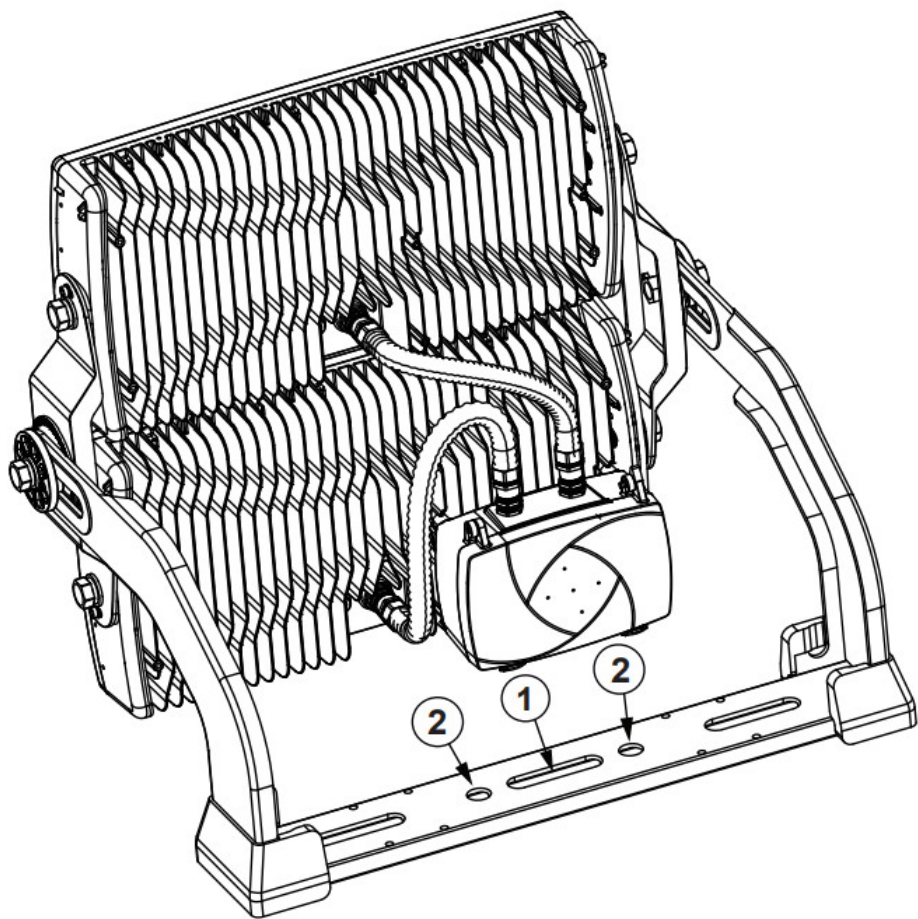

 Screws and washers are not included in the package!

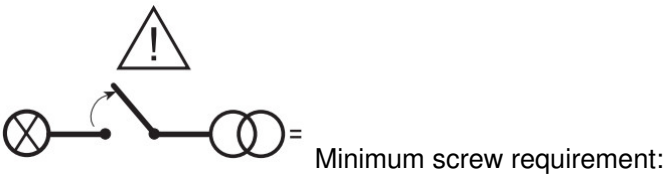

Vibration standard	IEC 0.5g / ANSI 1.5g
Minimum fastener requirement	1x M20 8.8 or A2-70 DIN9021 large plain washer
Tightening torques	1xM20: 200 Nm 2xM20: 140 Nm

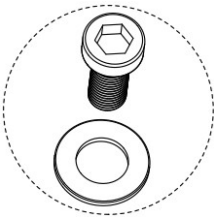

Recommended to use anti-seizing agent (Tikal Tef-Gel®) !

- 1. 1xM20 with extra large washer or
- 2. 2xM20 with extra large washer

Mounting dimensions

D1	D2	D3	D4	D5	D6
min 250mm min 9.84in	70mm 2.75in	150mm 5.9in	320mm 12,6in	460mm 15.98in	22mm 0.86in

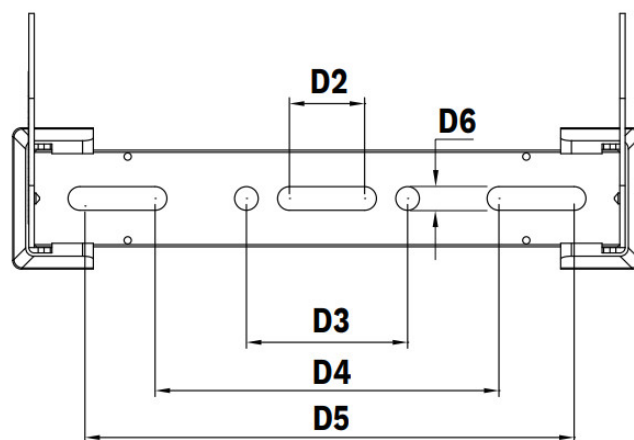
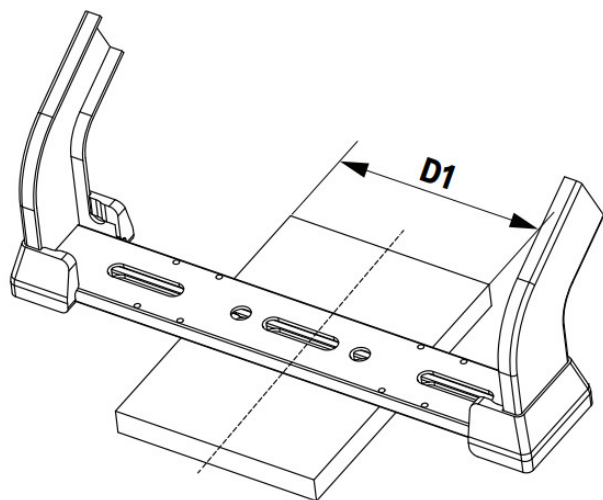

Minimum Surface Contact Area for screw fixation 124mm/4.88in

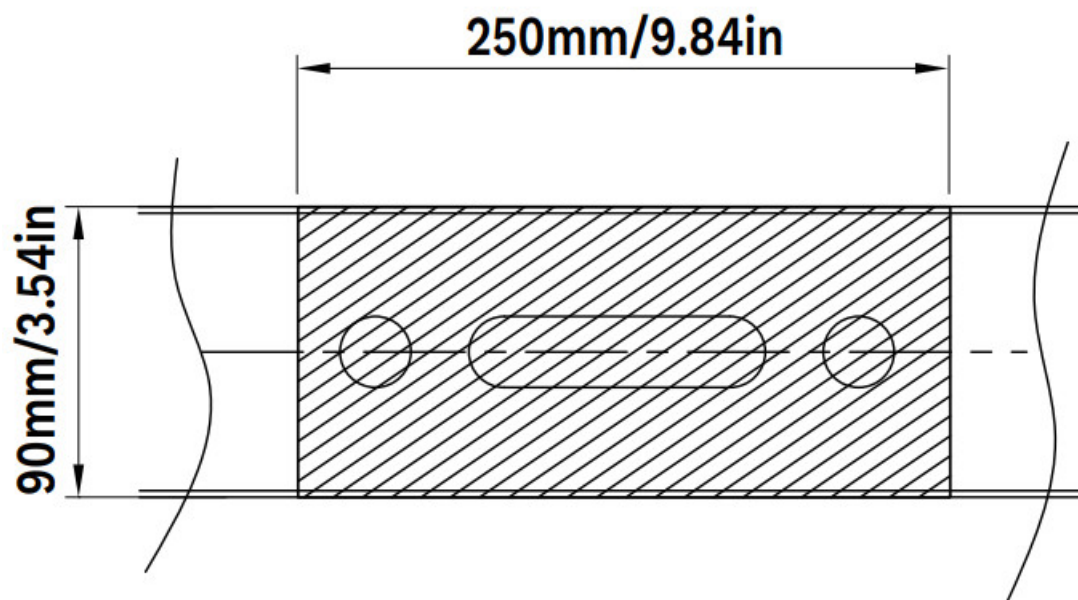

Fasteners are not included in the package!

Remark: the hatched area always need to be supported by a flat planar mounting surface as minimum. Wider surface contact is recommended, smaller is not allowed!

## ANGLE ADJUSTMENT

### C/1 – BRACKET TO FORK

1. Loosen the clamp screws



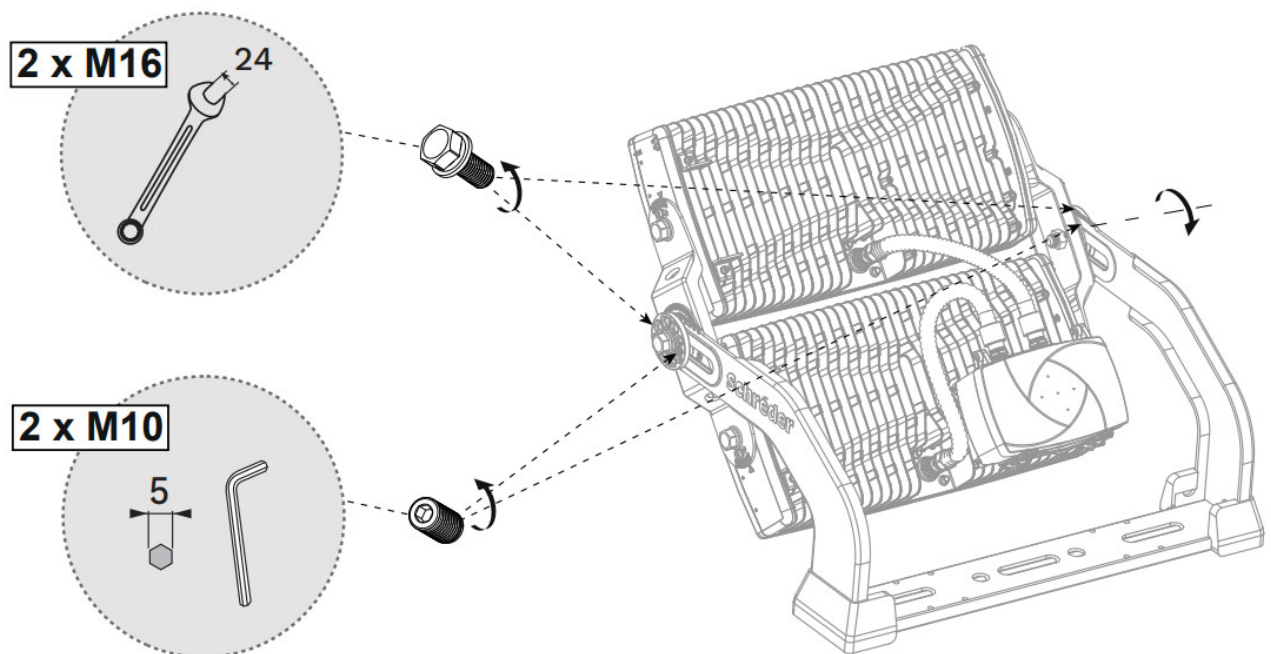

2. Adjust tilting angle

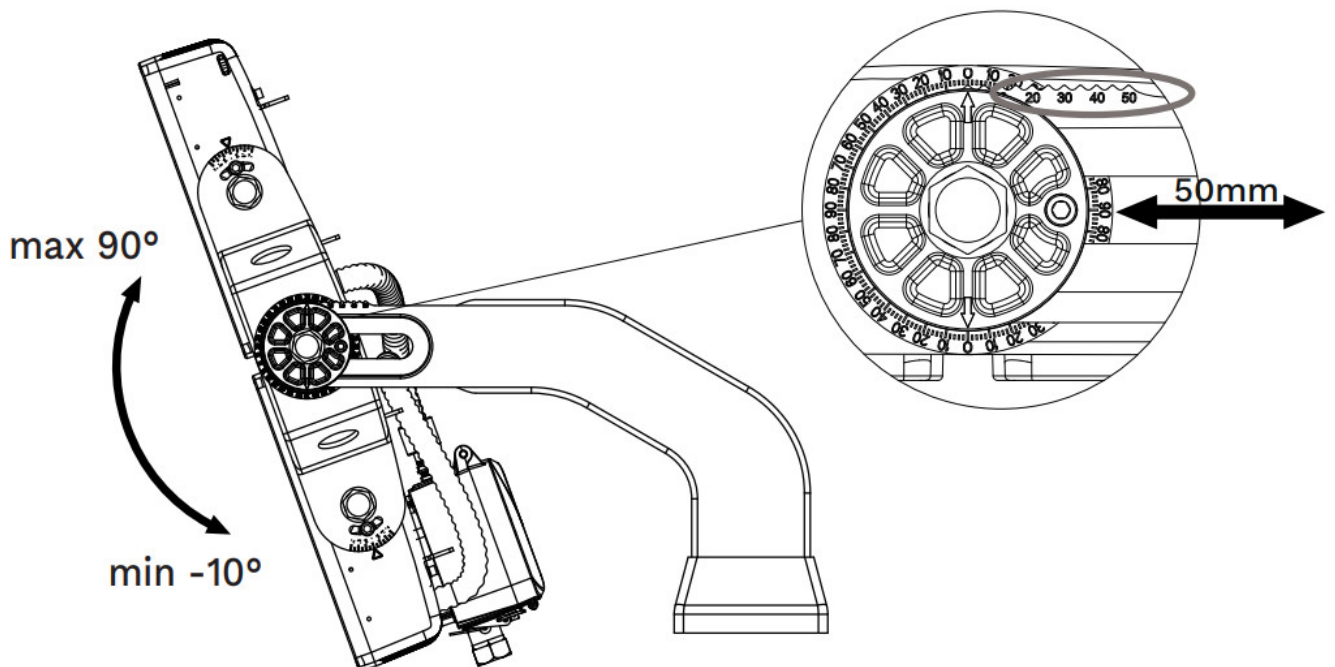

Separate scale for adjusting the distance of the optical 50mm block from the luminaire holder

The swing arm inclination is adjustable in 10 degree increments relative to fork base.



ALLOWED tilt angle is between -10° to 90°

80±1Nm

3. Tighten the clamp screws

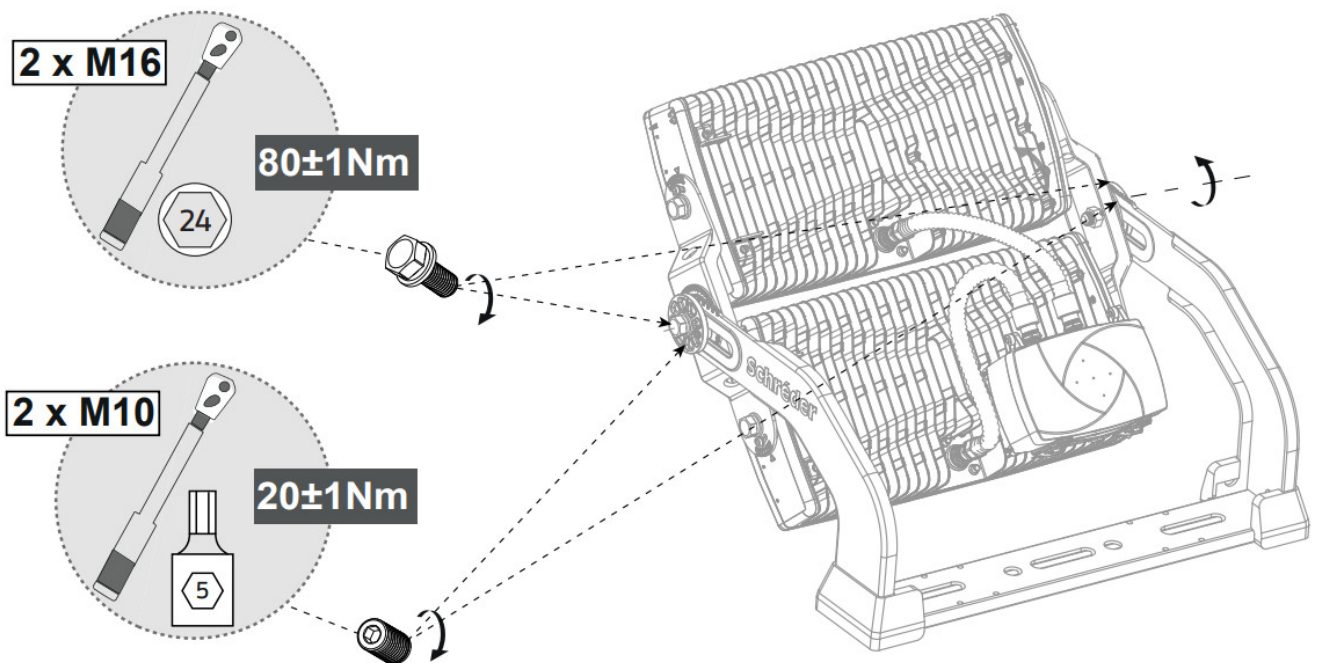

 Do not exceed the proposed torque levels, as it may result in fraction of the parts!

## C/2 – OPTICAL BLOCKS TO BRACKET

1. Loosen the clamp screws

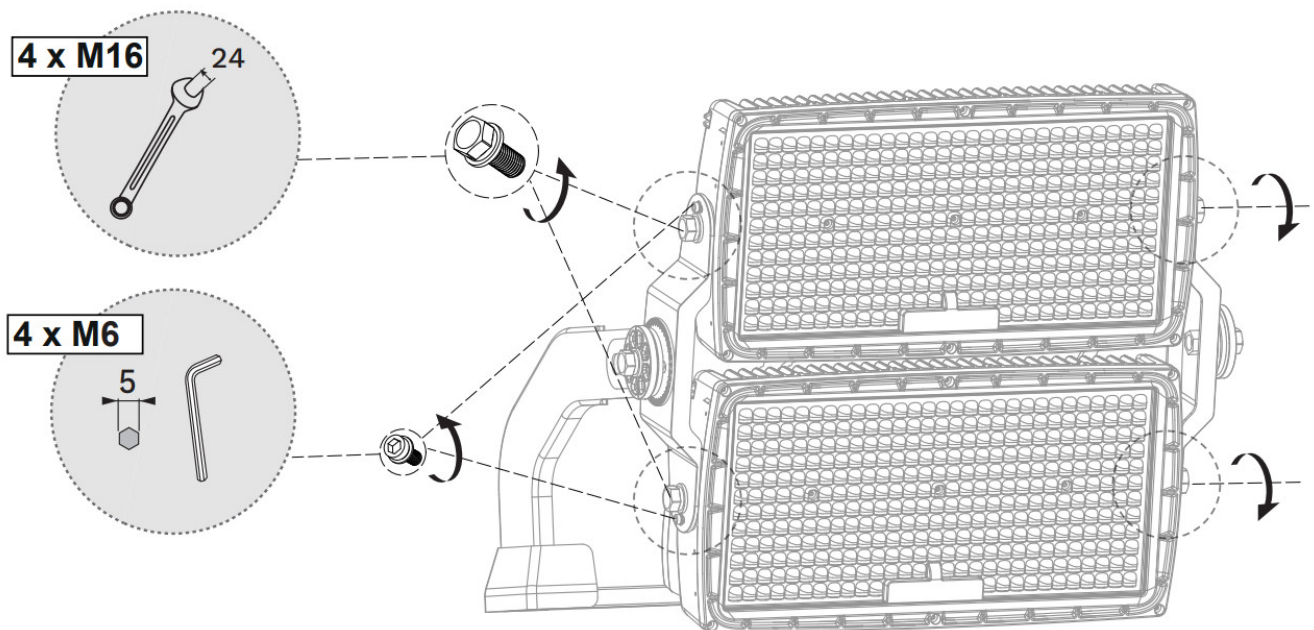

2. Adjust tilting angle

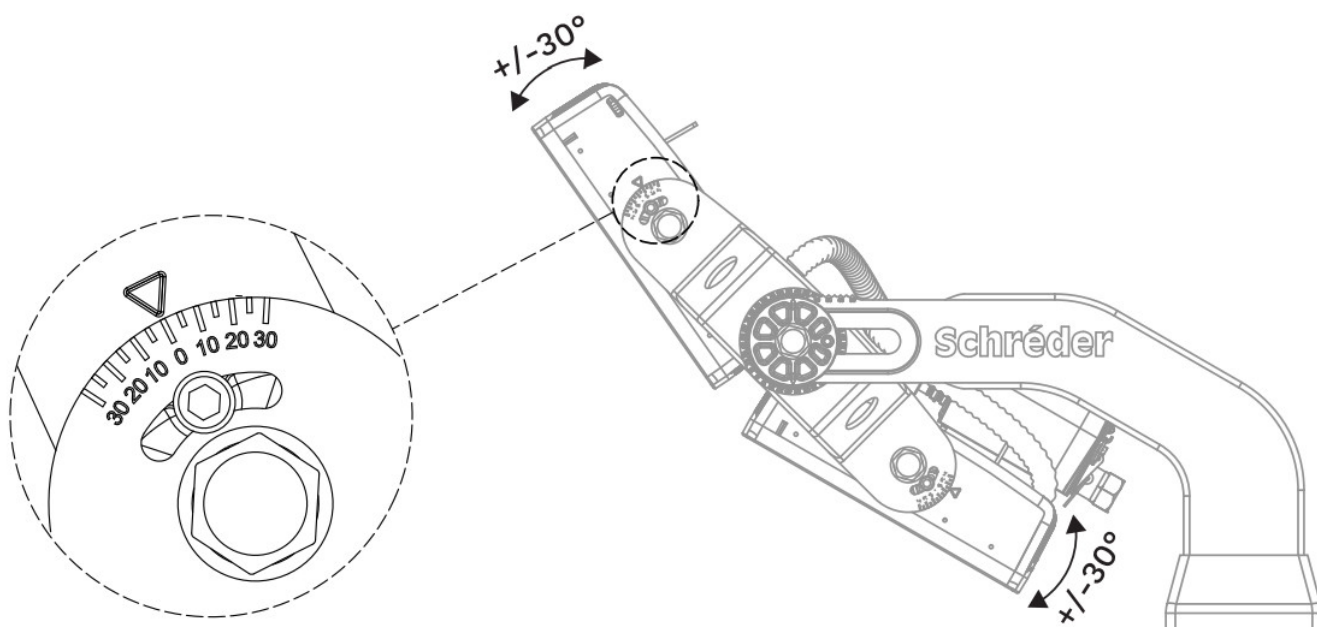

**!** ALLOWED tilt angle is between -30° to +30°

3. Tighten the clamp screws

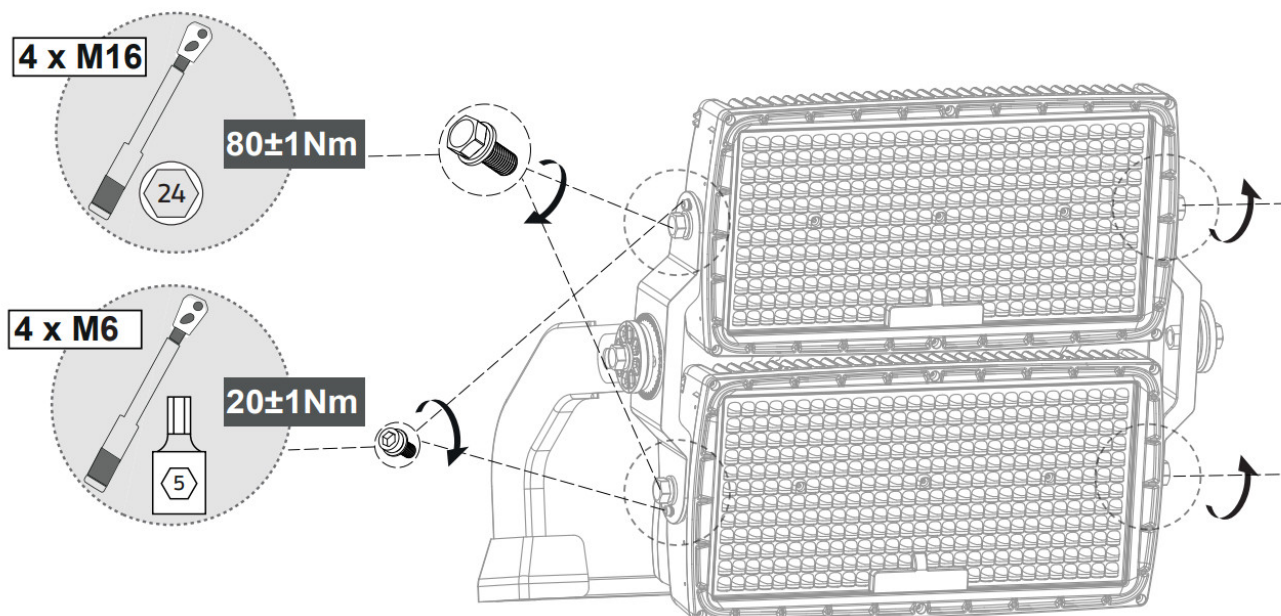

**!** Do not exceed the proposed torque levels, as it may result in fracture of the parts!

## ALLOWED POSITIONING



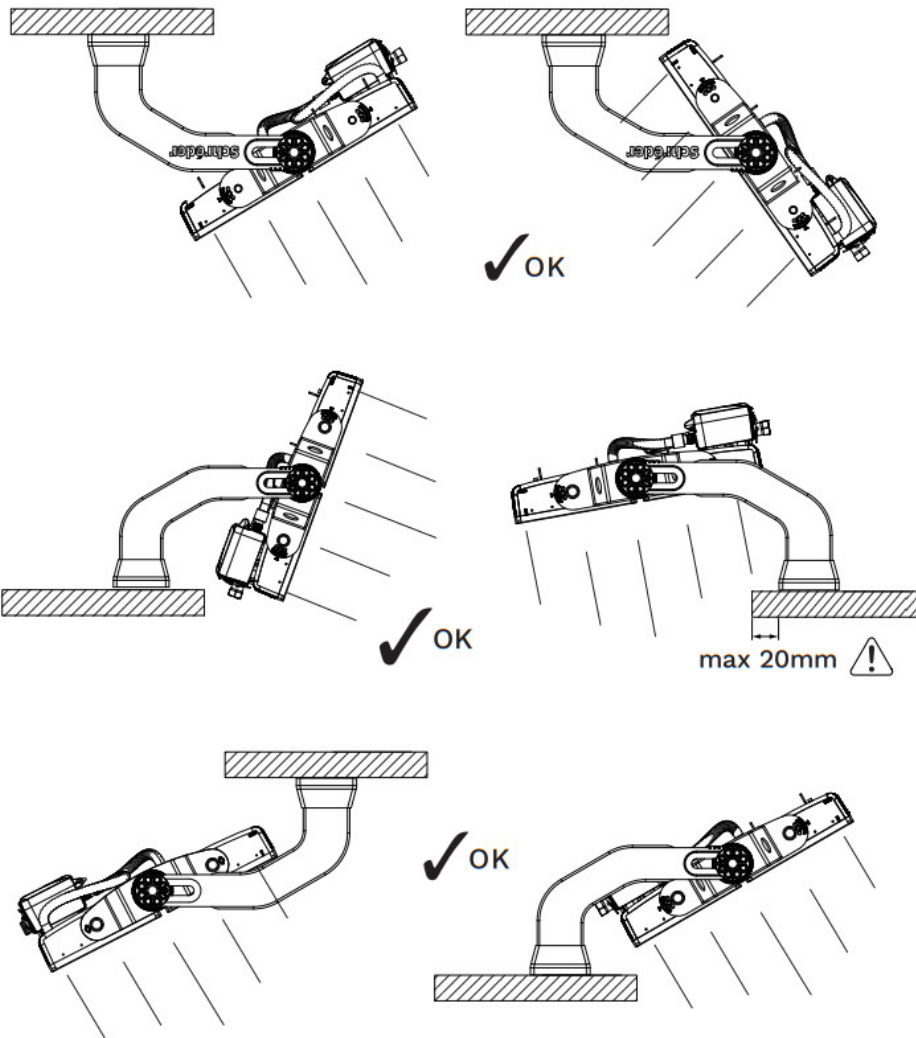

## GEAR INSTALLATION

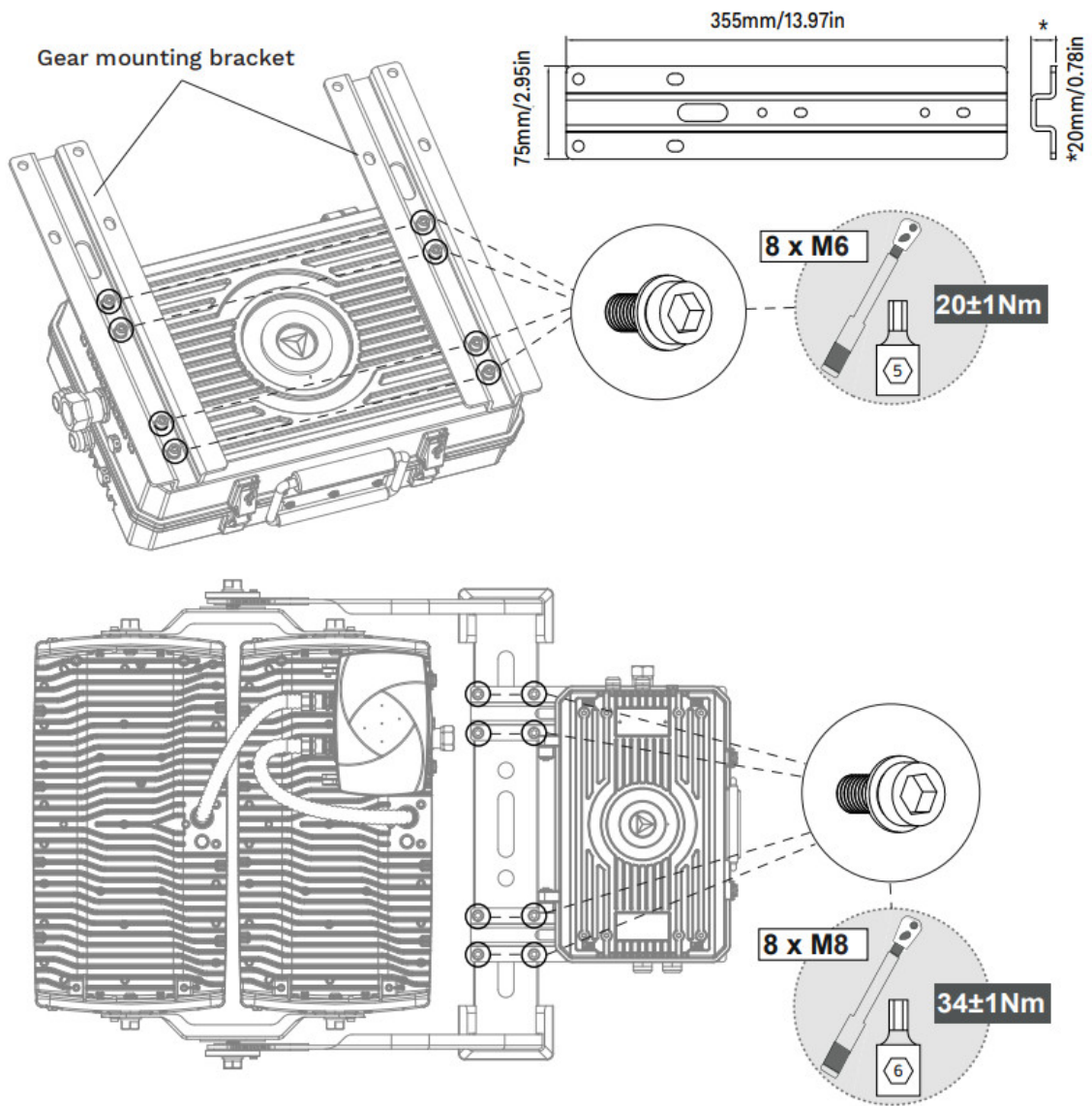

## SAFETY CABLE

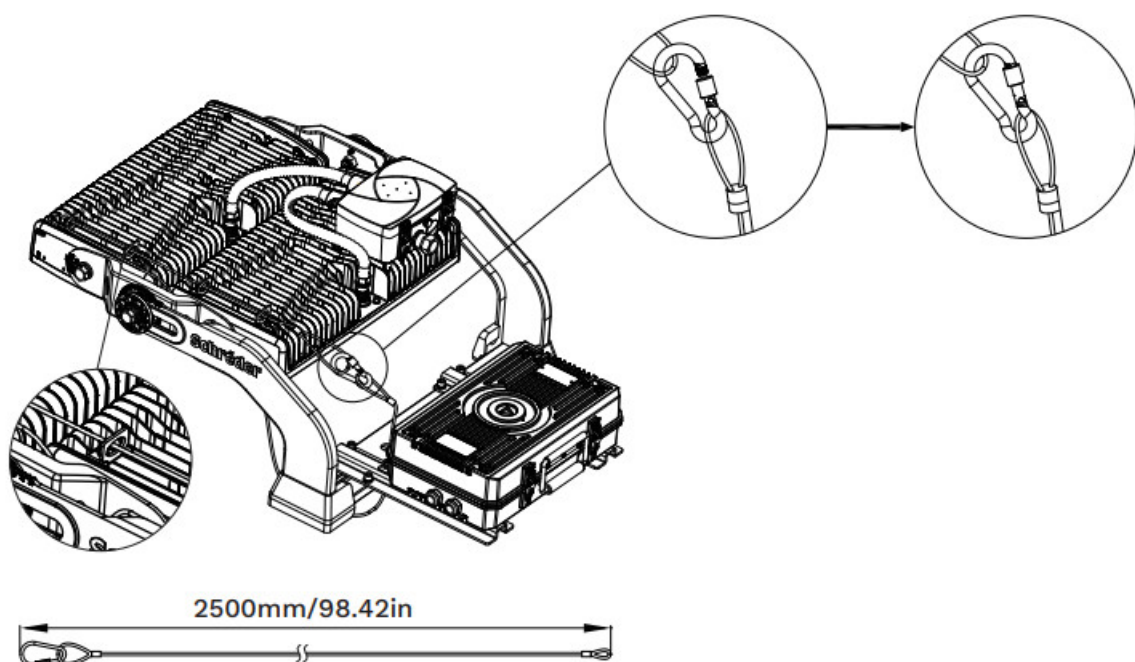

Steel safety cable should pass through the holes shown in the drawing in sequence. Then connect the two ends with the lock buckle and tighten the lock bolt by hand.



## ELECTRICAL CONNECTION

- 
- R-type buckle**

- 
- Junction box**
- M25 Cable Gland/cable protector compatibility
- Gear box**
- INPUT OUTPUT
- A B C D E

Cable ID	Connection	Cable gland	Suitable cable
A	Mains input	M20	06-10mm or 010-14mm
B	Mains re-launch		
C	DC output to optical block	M25/cable protection compatibility	06-10mm or 010-14mm
D	Dimming input	M16	04.5-7.5mm or 07.5-10.5mm
E	Dimming re-launch		

### 3. Cable types and cable gland



When using a larger external diameter cable, the plug and the smaller inner diameter seal need to be removed.

When using a smaller external diameter cable, simply remove the plug.

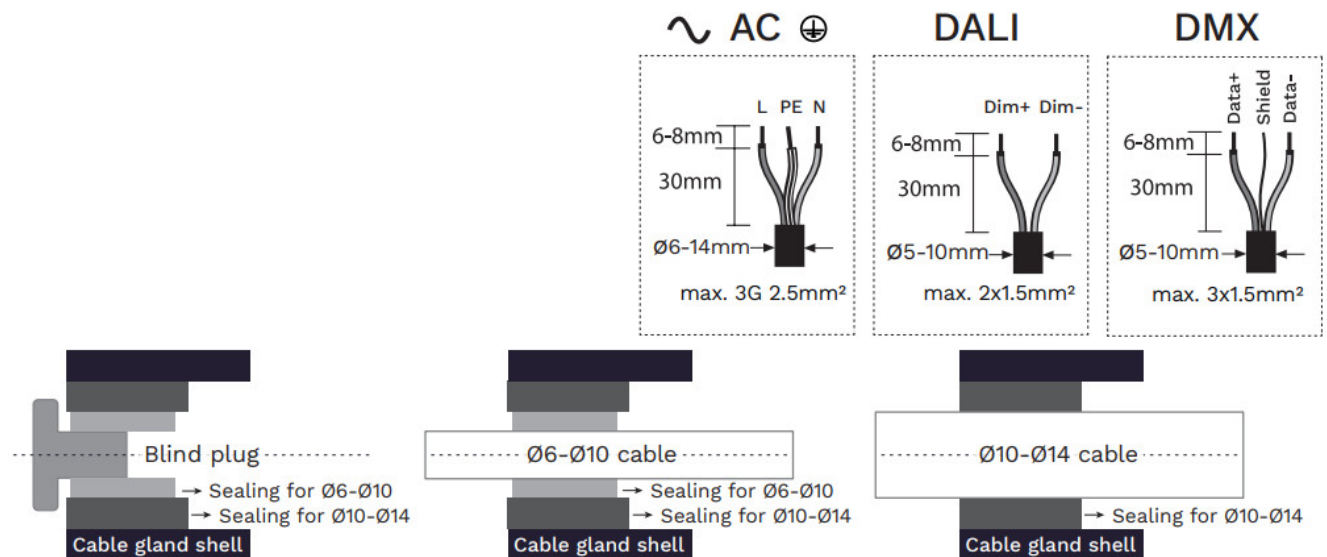

### 4. Make electrical connection Wiring should strictly follow the marking label instruction, otherwise the product could be damaged or the functions could be affected!



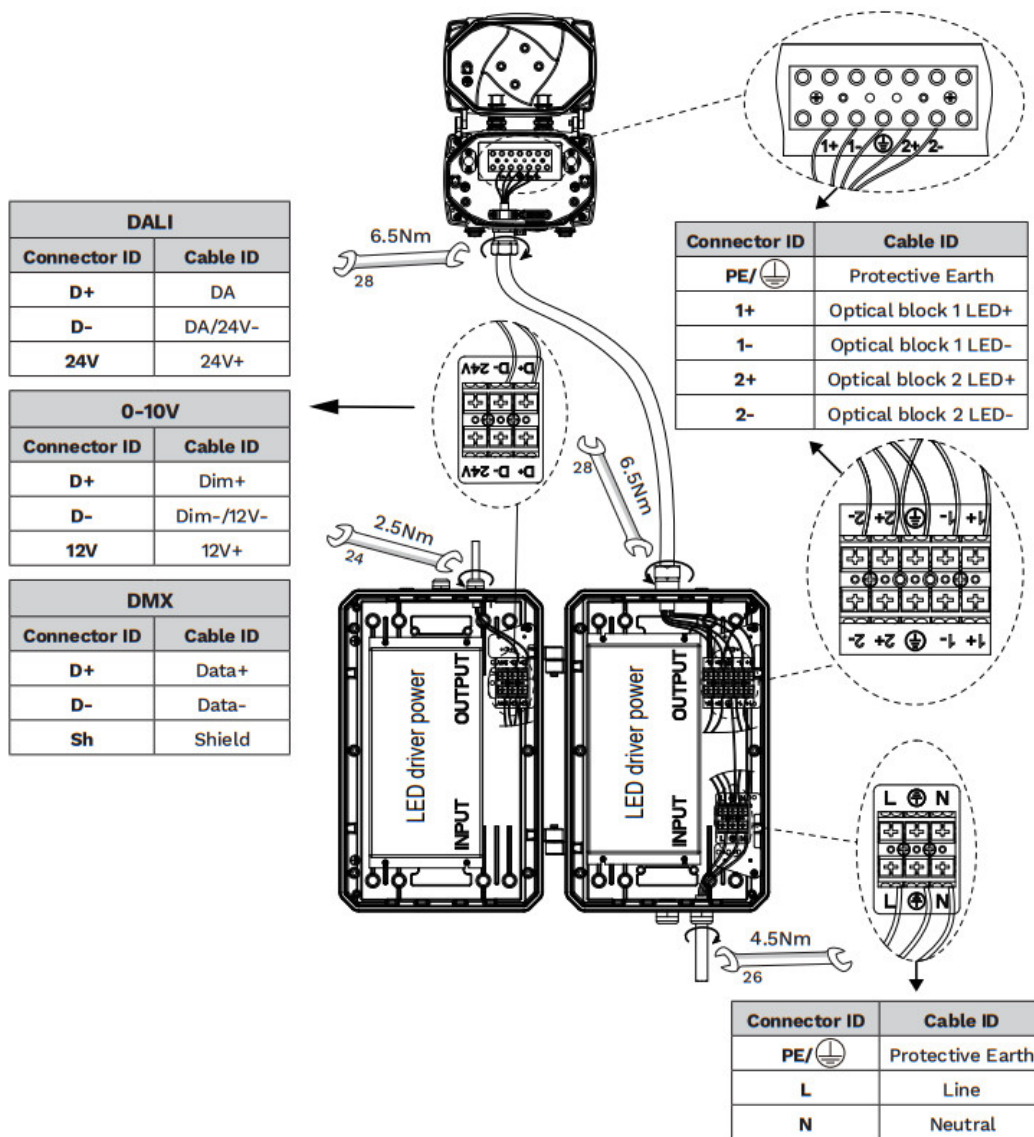

AC and CONTROL cables must be connected by the installer!

Connection	Cable gland	Recommended cable type
Control signal	PG16(Ø5-Ø7.5/Ø7.5-Ø10)	H05RN-F, 2 x 1-1.5mm
AC INPUT	PG20(Ø6-Ø10/Ø10-Ø14)	H07RN-F, 3 x 1.5-4mm
DC OUTPUT	PG20(Ø6-Ø10/Ø10-Ø14)	H05RN-F, 5 x 1.0mm <sup>2</sup> H07RN-F, 5 x 1.5mm <sup>2</sup>

5. Close junction box and gear box

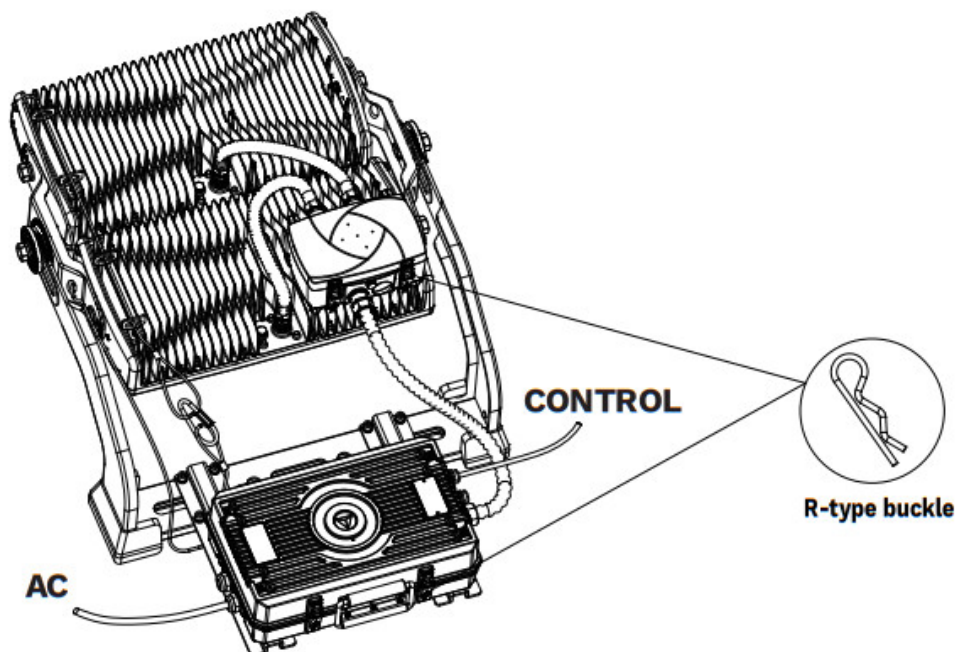

Close the cover of the junction box and gear box, and put the R-type buckles back on both.  
 1.5m metal tube and DC cable provided for junction box – gearbox connection.

## RECOMMENDATIONS

### 1. Surrounding distances

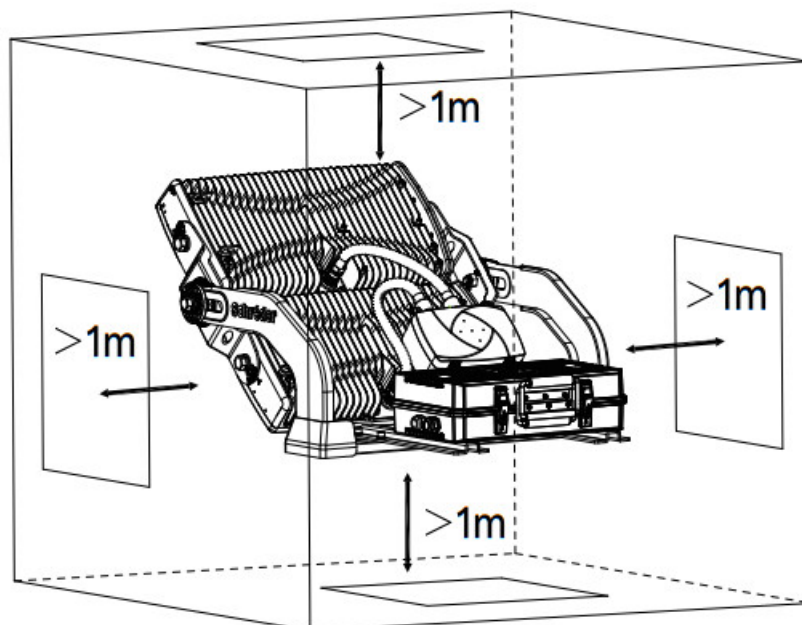

At least 1 meter distance should be kept from surrounding walls, floor, and ceiling for all types of mounting/inclination.

### 2. Maximum number of luminaires per MCB

Product	Driver	MCB B type						
		B10	B13	B16	B20	B25	B32	B40
BRITELINE GEN2 2 @20V	EUM-680MG/BG	0	1	1	1	2	2	3
BRITELINE GEN2 2 @480V	ESM-680MG/BG	1	1	1	2	2	3	4
Product	Driver	MCB C type						
		C10	13	16	C20	C25	C32	C40
BRITELINE GEN2 2 @220V	EUM-680MG/BG	0	1	1	1	2	2	3
BRITELINE GEN2 2 @480V	ESM-680MG/BG	1	2	2	3	4	5	7

## AIMING DEVICE

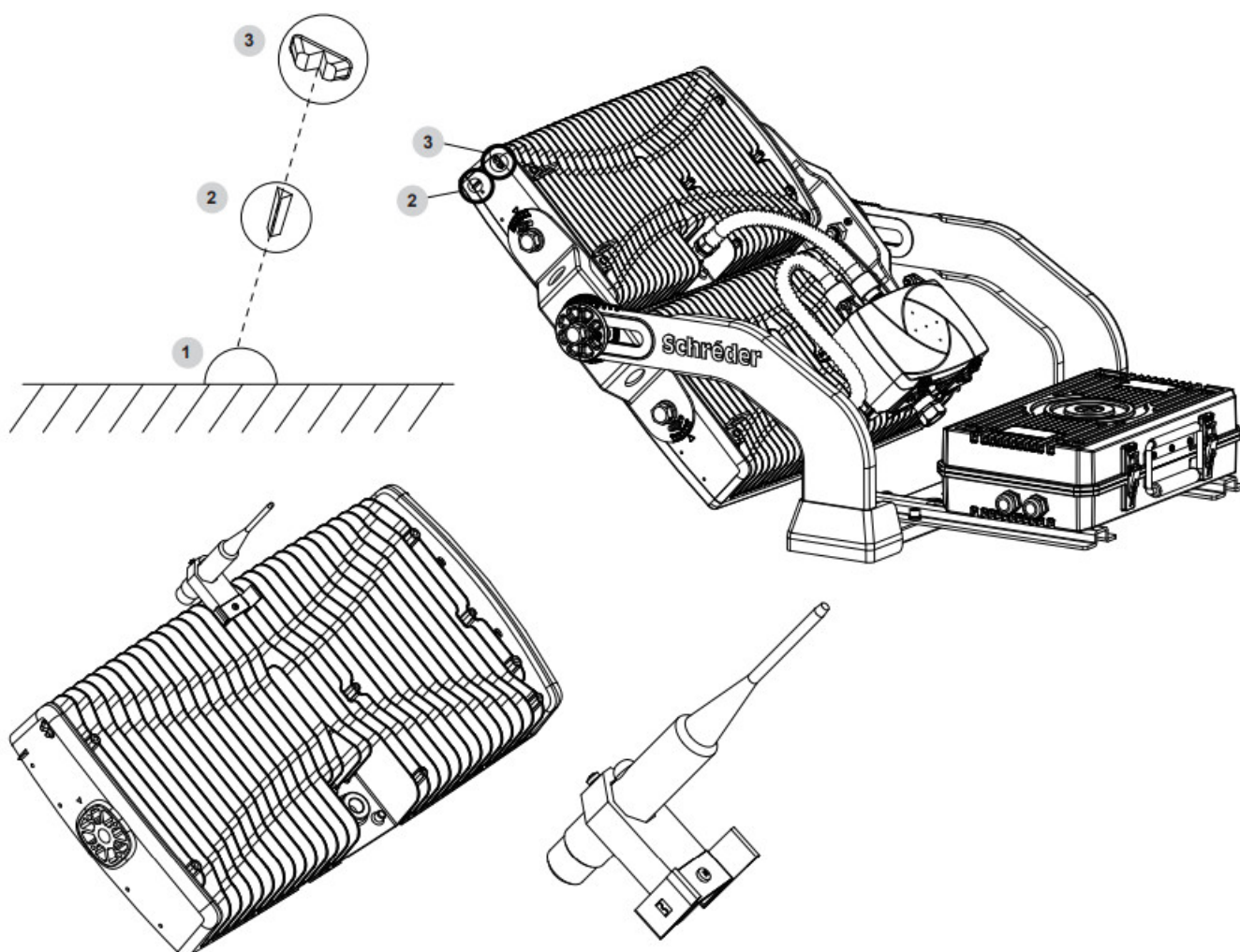

The small blocks on the side of the optical block assure the installation of the built-in aiming device. The external aiming device position 1 needs to be aligned with positions 2 and 3.

## ACCESSORIES – HOOD

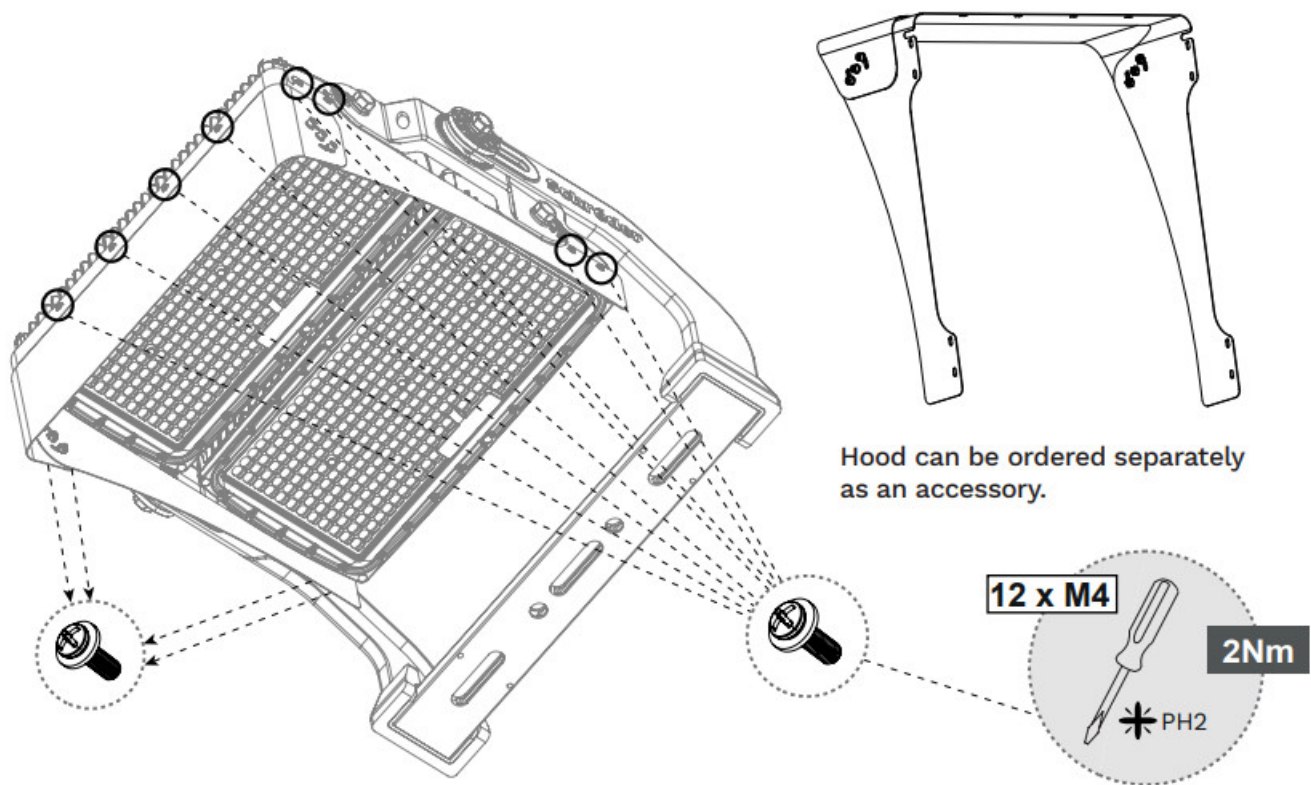

## SAFETY INSTRUCTIONS

The light source contained in this luminaire shall only be replaced by the manufacturer or his service agent or a similar qualified person. Always switch off the power prior to installation, maintenance or repair activities.

### RISK GROUP 2 –

**CAUTION!** Hazardous optical radiation may be emitted from this product. Do not stare at the luminaire when operating as it may be harmful to the eyes. The luminaire should be positioned so that prolonged staring at the luminaire at a distance of less than 0.2m is not expected.

This product contains a light source of an energy efficiency class G or higher.

In case of PVC insulated mains cable, the installer **MUST** ensure that the **WHOLE** cable is protected against climatic conditions, especially UV rays and rain, by making sure that the cable is contained inside the luminaire and pole.

Y-connection: In case of damage to the wire, it has to be replaced only by the manufacturer, distributor or by an expert, to avoid risks.

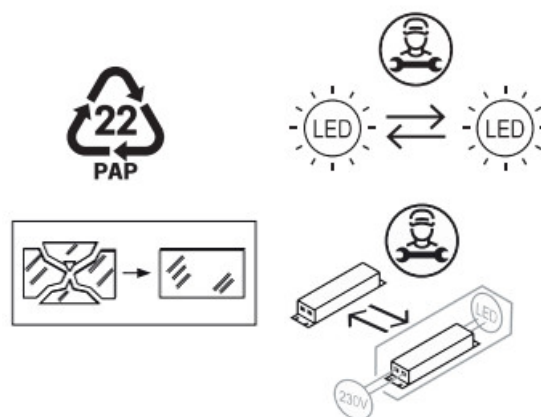

### Risk Group

IEC/EN 62471 Photobiological Safety

Assessment based on IEC/TR 62778, Cmax



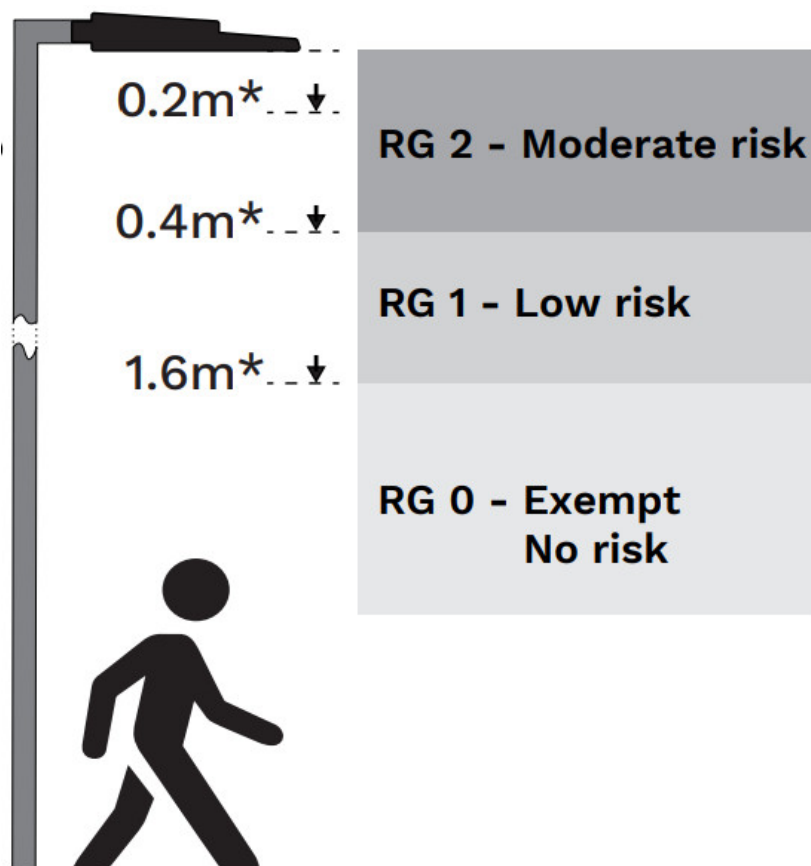

# Schröder

Copyright © Schröder S.A. 2023 – Executive Publisher: Stéphane Halleux – B-4000 Liège, Rue de Mons 3 (Belgium)

The information, descriptions and illustrations herein are only of an indicative nature and subject to changes without notice

[www.schreder.com](http://www.schreder.com)

Rev C | 08-2023

## Documents / Resources

	<p><a href="#">Schröder BRITELINE GEN2 2 External Version Versatile and Efficient Lighting</a> [pdf] Instruction Manual</p> <p>BRITELINE GEN2 2 External Version Versatile and Efficient Lighting, BRITELINE GEN2 2, External Version Versatile and Efficient Lighting, Version Versatile and Efficient Lighting, Efficient Lighting, Lighting</p>
---	--