



Schneider Electric HMISTM6 Basic HMI Gateway Box For Faceless User Guide

[Home](#) » [Schneider Electric](#) » Schneider Electric HMISTM6 Basic HMI Gateway Box For Faceless User Guide 

Contents

- [1 Schneider Electric HMISTM6 Basic HMI Gateway Box For Faceless](#)
- [2 Product Information](#)
- [3 Introduction](#)
- [4 Package Contents](#)
- [5 Parts Identification](#)
- [6 General Specifications](#)
- [7 Installation](#)
- [8 Wiring](#)
- [9 Precautions](#)
- [10 Contacts](#)
- [11 Documents / Resources](#)
 - [11.1 References](#)



Schneider Electric HMISTM6 Basic HMI Gateway Box For Faceless



Product Information

The HMISTM6BOX is an operator terminal used for controlling electrical equipment. It is part of the Harmony STM6 series and is manufactured by Schneider Electric.

Product Specifications

- **Part Number:** HMISTM6BOX
- **Status LED:** Indicates the status of the terminal
- **Bumper:** Provides protection for the terminal
- **USB (Type A) interface:** Allows for connection to external devices

For more detailed information about the product, please refer to the Harmony STM6 User Manual. The manual can be accessed by scanning the QR code attached to the product or by visiting the Schneider Electric website.

Introduction

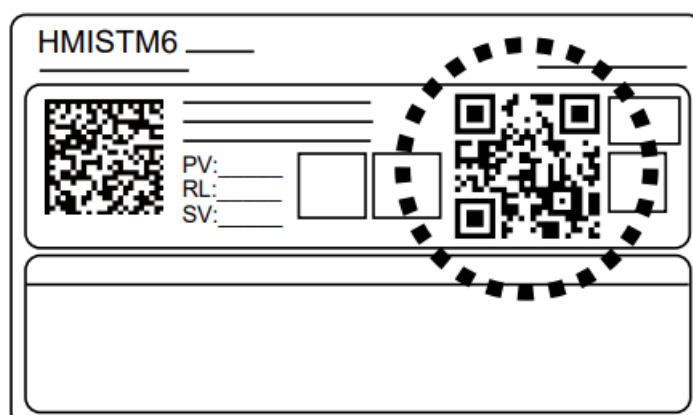

This product is an operator terminal used for machines or system automation. For product usage, you must have detailed information from the Harmony STM6 User Manual. You can see the manual by scanning the QR code attached to the product, or from our website (see below).

NOTE: Electrical equipment should be installed, operated, serviced, and maintained only by qualified personnel. No responsibility is assumed by Schneider Electric nor any of its affiliates or subsidiaries (hereinafter, referred to as Schneider Electric) for any consequences arising out of the use of this material. If the equipment is used in a manner not specified by the manufacturer, the protection provided by the equipment may be impaired.

DANGER: HAZARD OF ELECTRIC SHOCK, EXPLOSION OR ARC FLASH

- Remove all power from the device before removing any covers or elements of the system, and prior to installing or removing any accessories, hardware, or cables.
- Unplug the power cable from both this product and the power supply prior to installing or removing the product.
- Always use a properly rated voltage sensing device to confirm power is off where and when indicated.
- Replace and secure all covers or elements of the system before applying power to this product.
- Use only the specified voltage when operating this product.
- Since this product is not equipped with a power switch, be sure to connect a power switch to the power supply.
- Be sure to ground this product's FG terminal.

Failure to follow these instructions will result in death or serious injury.

DANGER: ELECTRIC SHOCK AND FIRE

When using the SG terminal of the serial interface to connect an external device to this product:

- Verify that a ground loop is not created when you set up the system.
- Connect the SG terminal to remote equipment when the external device is not isolated.
- Connect the SG terminal to a known reliable ground connection to reduce the risk of damaging the circuit.
- Failure to follow these instructions will result in death or serious injury.

WARNING: POTENTIAL FOR EXPLOSION

- Do not use this product in hazardous environments or locations other than Class I, Division 2, Groups A, B, C, and D.
- Substitution of any component may impair suitability for Class I, Division 2.
- Do not connect or disconnect this product unless power has been switched off or the area is known to be non-hazardous.
- Do not attempt to install, operate, modify, maintain, service, or otherwise alter this product except as permitted in this manual. Unpermitted actions may impair the suitability of this product for Class I, Division 2 operation.
- Use only non-incendive USB devices.
- Confirm that the USB cable has been attached with the USB cable clamp before using the USB interface.
- Use the USB (micro-B) interface for temporary connection only during maintenance and setup of the device.
- Do not use the USB (micro-B) interface in hazardous locations.

Failure to follow these instructions can result in death, serious injury, or equipment damage.

Package Contents

Please confirm that the following items listed are present. If you find anything damaged or missing, please contact your local distributor.

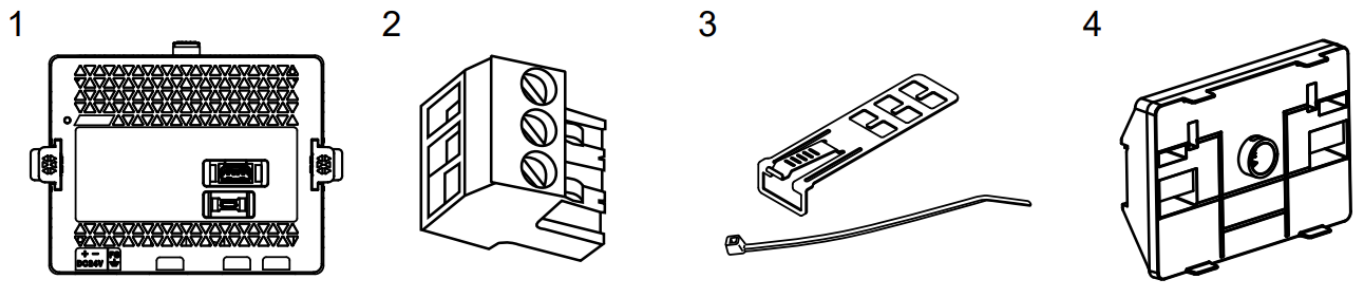

- 1. Rear module x 1
- 2. DC power supply connector x 1
- 3. USB clamp Type A (1 port) x 1 set (1 clip and 1 tie)
- 4. Rear module installation adapter x 1
- 5. Quick reference guide (this guide) x 1

Part Numbers

	Part number*1
Harmony STM6	HMISTM6BOX

All part numbers may be followed by any letter or number.

Parts Identification

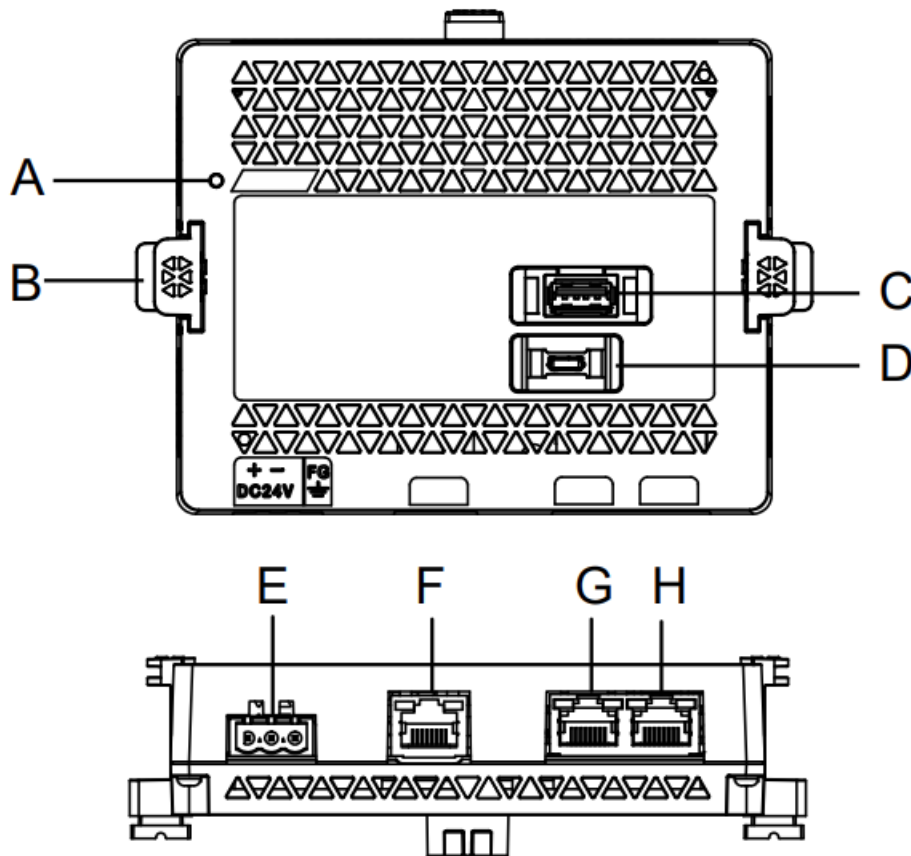

- **A:** Status LED
- **B:** Bumper
- **C:** USB (Type A) interface
- **D:** USB (micro-B) interface
- **E:** Power plug connector
- **F:** Serial interface (COM1)
- **G:** Ethernet interface (ETH1)
- **H:** Ethernet interface (ETH2)

NOTE

- Use only the SELV (Safety Extra-Low Voltage) circuit to connect the serial, USB and Ethernet interfaces.
- The serial interface is not isolated.
- The SG (signal ground) and FG (functional ground) terminals of serial interfaces are connected inside this product.

Status LED

- After power is turned on, normal status indication by the LED is: red light > flashing orange > green light.
- For other LED indications, refer to the Harmony STM6 Hardware Manual.

General Specifications

Rated input voltage	24 Vdc
Input voltage limits	19.2. 28.8 Vdc
Power consumption (max.)	6.8 W
Ambient air temperature	0...60 °C (32...140 °F)
Ambient air and storage humidity (non condensing, wet bulb temperature 39 °C [102.2 °F] or less)	10%...90% RH
Pollution degree	2
Atmospheric pressure (operating altitude: 2,000 m [6,561 ft] or lower)	800...1,114 hPa

Installation

Installation Requirement

Be aware of the following when building this product into an end-use product:

- Install this product in an enclosure with mechanical rigidity.
- This product is not designed for outdoor use. UL certification obtained is for indoor use only.
- This equipment is an open-type device and is meant to be installed in an enclosure suitable for the environment. Install in an enclosure where the equipment is inaccessible without the use of tools.

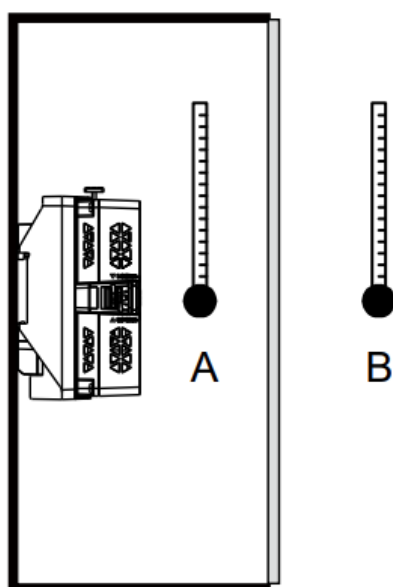

- **A:** Internal temperature
- **B:** External temperature

Dimensions

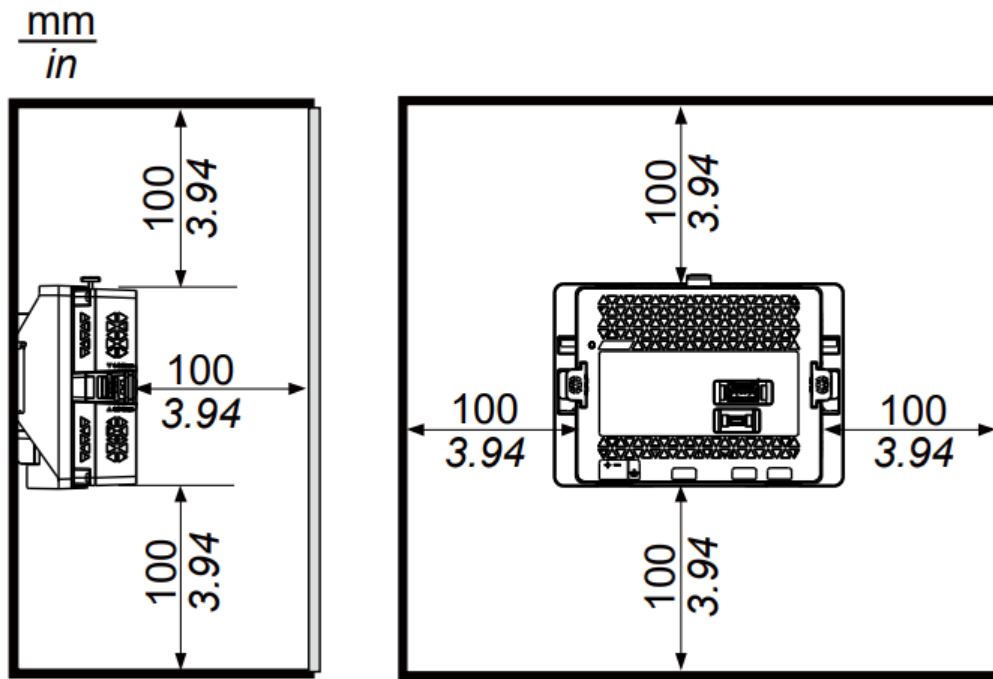

NOTE

- Check that the installation wall or cabinet surface is flat, in good condition and has no jagged edges. Metal reinforcing strips may be attached to the inside of the wall, near the installation location, to increase its rigidity.
- Depending on the wall or cabinet's material and design, the installation surface may need to be strengthened.
- Depending on the material and design of the wall or casing, the installation surface may need to be strengthened. Especially when installing this product in a place where high levels of vibration are expected, your design should give due consideration to the weight of this product.
- The wall or cabinet must be designed to avoid any induced vibration resonance on the rear module exceeding an amplitude factor of 10 and to avoid any induced permanent vibration resonance.
- Check that the ambient air temperature and the ambient humidity are within their specified ranges. When installing this product in a cabinet or enclosure, the ambient air temperature is the cabinet's or enclosure's internal and external temperature.
- Be sure that heat from surrounding equipment does not cause this product to exceed its standard operating temperature.

Installing on DIN Rail

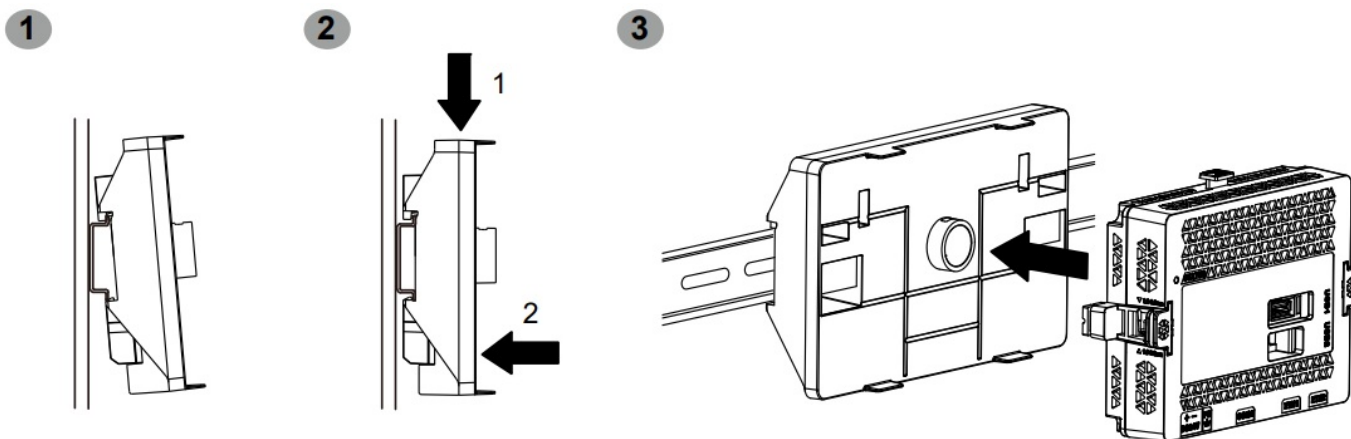

1. Position the top groove of the rear module installation adapter on the top edge of the DIN rail.
2. Push down on the adapter until the bottom groove of the mounting adapter fits under the DIN rail.
3. Insert and push the rear module to the adapter straight in until it locks into place.

Removing from DIN Rail

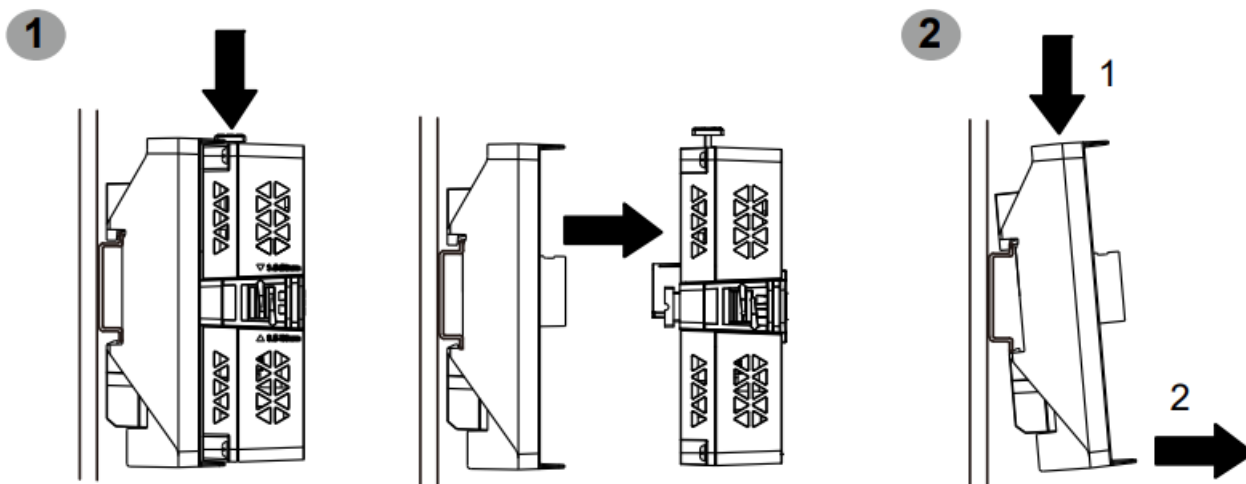

1. Push and hold the button at the top of the rear module, and pull the rear module straight out.
2. Push down on the rear module mounting adapter and unhook the bottom part of the adapter from the DIN rail.

Attaching USB Cable Clamp (Type A)

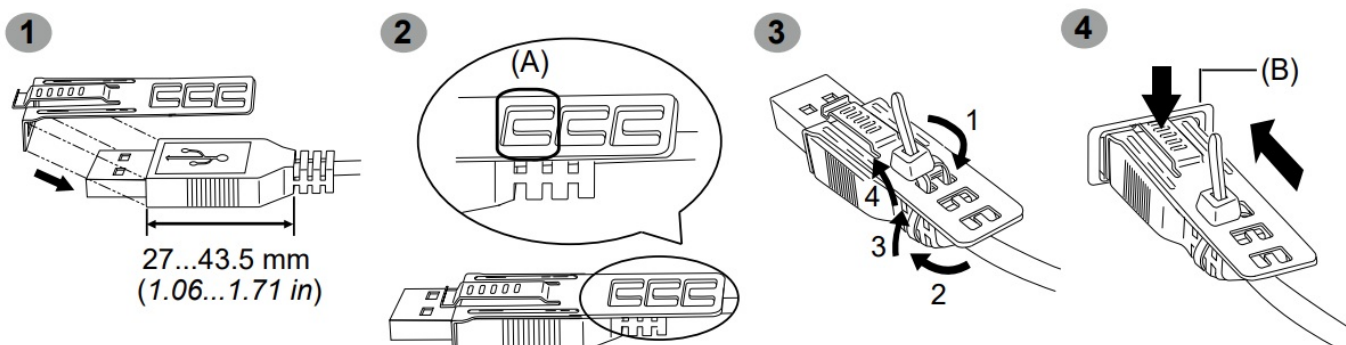

- (A) Pass the tie through the hole.

- **(B)** USB (Type A) port

Wiring

- Make sure the ground wire is either the same or heavier gauge than the power wires.
- Do not use aluminum wires in the power supply power cord.
- If the ends of the individual wires are not twisted correctly, the wires may create a short circuit.
- The conductor type is solid or stranded wire.
- Use copper wire rated for 75 °C (167°F) or higher.
- Use UL Listed power source with LPS (Limited Power Source) or Class 2 output.
- UL listed cables have been investigated for wiring use inside of the installation panel or service access area only.

Power cord diameter

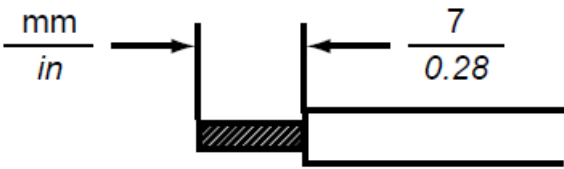
Power cord diameter	0.75...2.5 mm2 (18...13 AWG)
Conductor type	Solid or stranded wire
Conductor length	<div> <div>mm</div> <div>in</div> <div> <div>→</div> <div>←</div> <div> <div>7</div> <div>0.28</div> </div> </div>  </div>

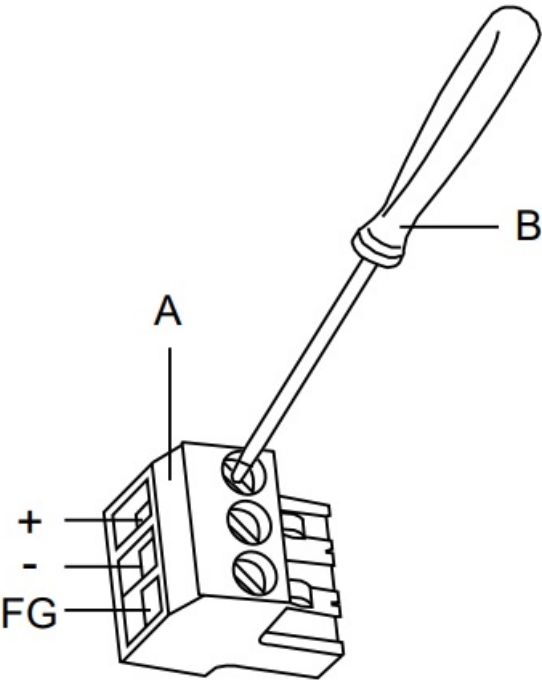

- A:** Part number: XBTZGPWS1
- B:** Recommended driver: Flat screwdriver (size 0.6 x 3.5)

+	24 Vdc
–	0 Vdc
FG	Grounded terminal

NOTE

- The necessary torque is 0.56 N•m (5 lb-in).
- Do not solder the cable connection.
- Connect the grounded terminal properly to the ground.

Precautions

- After checking the wiring route carefully, use this product with FG connected to ground.

Grounding

Functional grounding: Grounding resistance of 100 Ω or less and a wire of 2 mm² (AWG 14) or thicker, or your country's applicable standard (SG and FG are connected inside the product).

UKCA, EAC, Chinese RoHS

(This information is essential for China RoHS.)

 Part Name	Hazardous Substances					
	(Pb)	(Hg)	(Cd)	(Cr (VI))	(PBB)	(PBDE)
Metal parts	○	○	○	○	○	○
Plastic parts	○	○	○	○	○	○
Electronic	×	○	○	○	○	○
Contacts	○	○	○	○	○	○
Cables & cabling accessories	○	○	○	○	○	○
This table is made according to SJ/T 11364. ○ : Indicates that the concentration of hazardous substance in all of the homogeneous materials for this part is below the limit as stipulated in GB/T 26572. ×: Indicates that concentration of hazardous substance in at least one of the homogeneous materials used for this part is above the limit as stipulated in GB/T 26572.						

Contacts

UK Representative

- Schneider Electric Limited

- Stafford Park 5, Telford, TF3 3BL, United Kingdom

Manufacturer

- Schneider Electric Industries SAS
- 35 rue Joseph Monier, Rueil Malmaison 92500

Authorized distributor in the Russian Federation:

JSC "Schneider Electric"

- **Address:** Russia, 127018, Moscow, ul. Dvintsev, d. 12, building 1
- **Phone:** +7 (495) 777 99 90
- **Fax:** +7 (495) 777 99 92

Official supplier in the Republic of Kazakhstan:

LLP "Schneider Electric"

- **Address:** Republic of Kazakhstan, Almaty, Dostyk ave., "Ken Dala" Business Center, 5th floor.
- **Phone:** +7 (727) 357 23 57 Fax: +7 (727) 357 24 39

Scan



- www.se.com

The information in this document is subject to change without notice.
Copyright © 2021.12 Schneider Electric. All Rights Reserved.

Documents / Resources



[Schneider Electric HMISTM6 Basic HMI Gateway Box For Faceless](#) [pdf] User Guide
HMISTM6 Basic HMI Gateway Box For Faceless, HMISTM6, Basic HMI Gateway Box For Faceless, Gateway Box For Faceless, Faceless

References

-  [Schneider Electric Global | Global Specialist in Energy Management and Automation](#)

Manuals+.