



Schneider Electric ATV630D22N4 Variable Speed Drive Instructions

[Home](#) » [Schneider Electric](#) » Schneider Electric ATV630D22N4 Variable Speed Drive Instructions 

Contents

- [1 Schneider Electric ATV630D22N4 Variable Speed Drive](#)
- [2 Introduction and Scope](#)
- [3 Safety Information](#)
- [4 End of Life Instructions](#)
- [5 Product Description](#)
- [6 Documents / Resources](#)
 - [6.1 References](#)
- [7 Related Posts](#)



Schneider Electric ATV630D22N4 Variable Speed Drive



Introduction and Scope

Legal Information	This product family is in the scope of European Union directive 2012/19/EU on Waste Electrical and Electronic Equipment (WEEE). This product may only be dismantled/disassembled and disposed of by appropriately trained persons and in compliance with all applicable regulations.	
Purpose	This document is intended for use by professional end of life recyclers or waste treatment facilities. It provides the basic information for proper end-of-life treatment of product components and materials.	
In case of special transportation: transportation method	No special transportation.	
Recyclability potential	77%	Based on "ECO'DEEE recyclability and recoverability calculation method" (version V1, 20 Sep. 2008 presented to the French Agency for Environment and Energy Management: ADEME).

Safety Information

The information provided in this document assumes that the product is completely de-energized and uninstalled (refer to the instructions provided in the appropriate product manuals). Dismantling/disassembling the product may entail hazards caused by, for example, sharp edges, chemical aggression or ejected parts.

WARNING

HAZARD DUE TO INSUFFICIENT PROTECTION

- Implement all safety measures required by the applicable regulations and by the processes used to dismantle/disassemble and dispose of the product.
- Use all necessary personal protective equipment such as gloves and goggles
- Failure to follow these instructions can result in death or serious injury.

End of Life Instructions

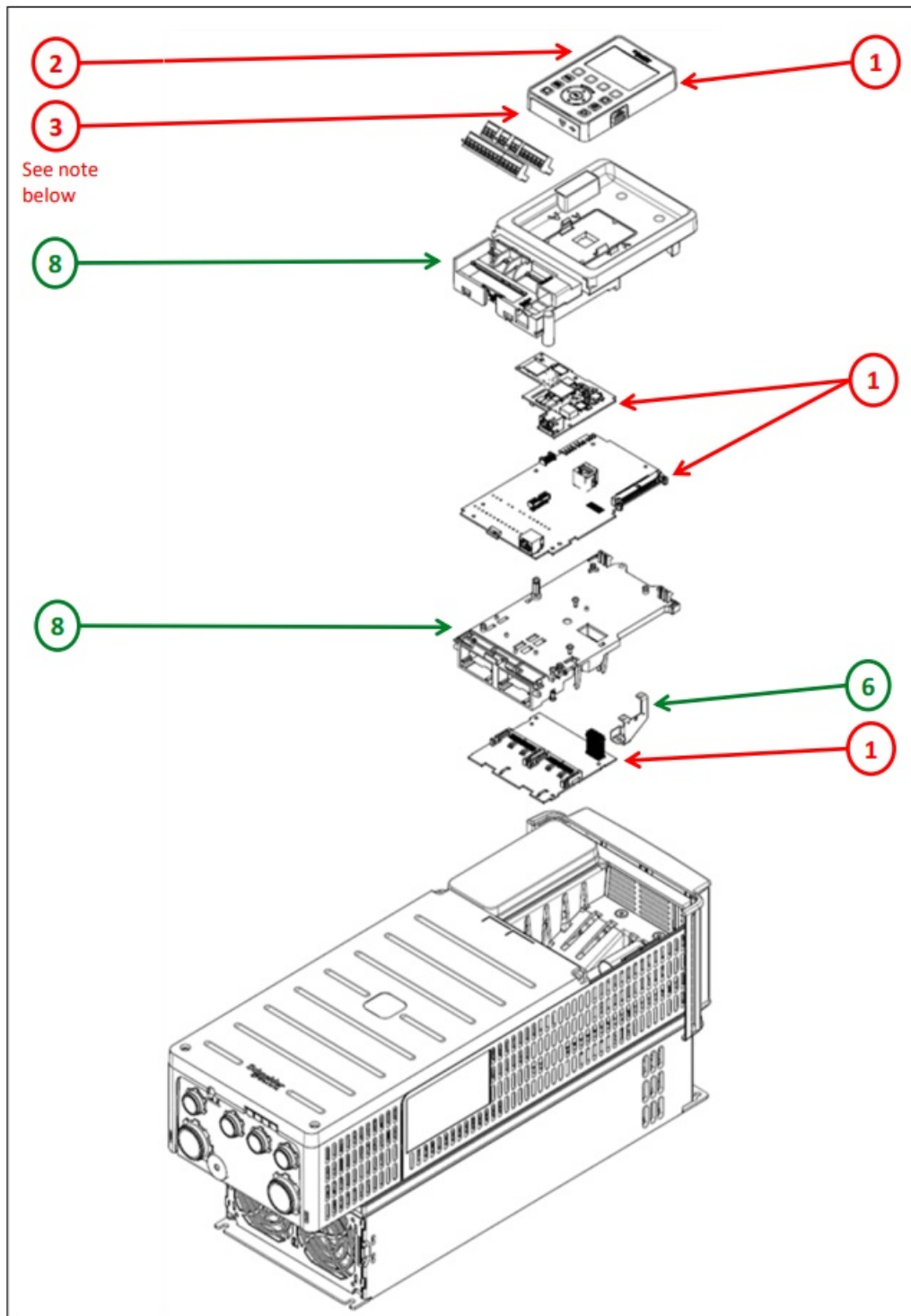

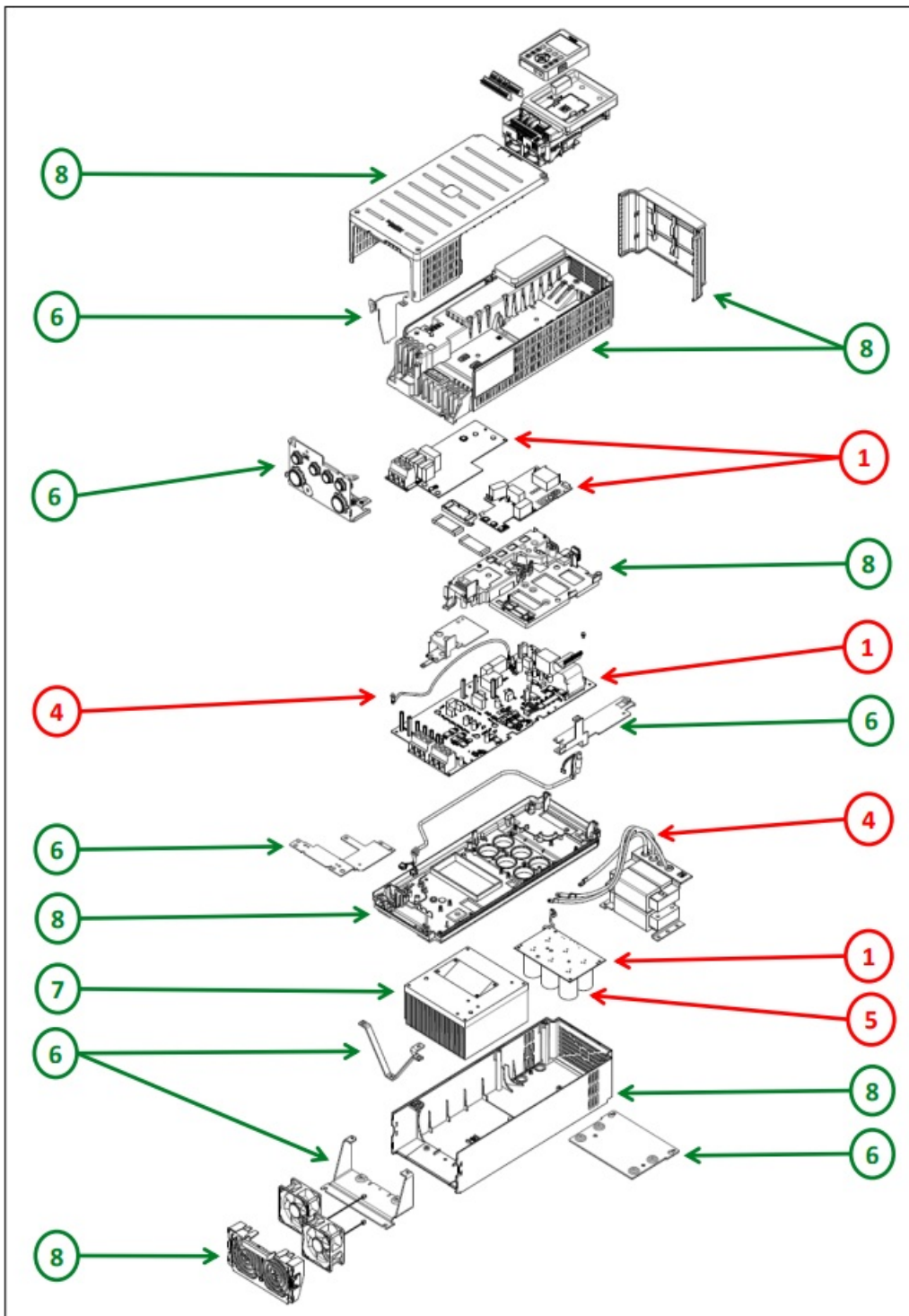

*Coin
battery
inside*

Recommendation	Number on drawing	Component / Material	Weight (in g)	Comment
To be depolluted	1	Electronic Board (Power and Communication) > 10cm ²	1721	
To be depolluted	2	LCD and all those back-lighted with gas discharge lamps	25	
To be depolluted	3	Other battery	2,9	Lithium content: 0,07 g
To be depolluted	4	Cable (high current)	550	
To be depolluted	5	Electrolyte capacitors which size: height > 25 mm, diameter > 25 mm or proportionately similar volume	525	
To be depolluted	6	Steel	1820	Bar, Baseplate
To be dismantled	7	Aluminium	2484	Heatsink
To be dismantled	8	PC, ABS-PC, PA, PA6, HDPE, SAN with or without additive, PP+EPDM and PP	3296	Housing, Support, Cover, Chassis
Other			4036,1	

Product Description

Manufacturer identification	Schneider Electric Industries SAS
Brand name	Schneider Electric
Representative product	VARIABLE SPEED DRIVE ATV630 IP21 22KW 400V/480V - ATV630D22N4
Description of the product	The main function of the Altivar Process product range is the speed control and variation of a synchronous, asynchronous or reluctance electric motor for fluid management and industrial applications.
Description of the range	This range consists of products Altivar 630, Altivar 930 and Altivar 955 with ratings from 7.5 to 11 kW for operation on 200V/240V and ratings from 15 to 22 kW for operation on 400V/480V, 3-phase supplies IP21/UL type 1.
Total representative product mass	14,46 kg
Representative product dimensions	211mm x 546mm x 232mm
Accessories	No accessories needed.
Date of information release	11/2021



- Schneider Electric Industries SAS
- Country Customer Care Center <http://www.se.com/contact>

Documents / Resources

	Schneider Electric ATV630D22N4 Variable Speed Drive [pdf] Instructions ATV630D22N4, Variable Speed Drive
---	---

References

- [Schneider Electric Global | Global Specialist in Energy Management and Automation](#)

-  [Schneider Electric Global | Global Specialist in Energy Management and Automation](#)
-  [Our offices around the world](#)

Manuals+.