



## Keypad Entry with Built-in Alarm FE576 Installation Instructions

[Home](#) » [Schlage](#) » Keypad Entry with Built-in Alarm FE576 Installation Instructions 



24046435



### Contents

- [1 Keypad Entry with Built-in Alarm](#)
  - [1.1 Installation Instructions](#)
    - [1.1.1 Model FE576](#)
- [2 Related Posts](#)

## Keypad Entry with Built-in Alarm

### Installation Instructions

Model FE576

## Tools Needed

- Phillips screwdriver

## Optional Tools

- Tape Measure
- Pencil
- Flathead Screwdriver
- Wood Block
- Hamme

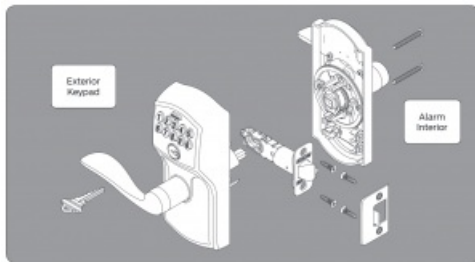

Exterior Keypad, Alarm Interior

## Optional Latch Faceplate



## Batteries

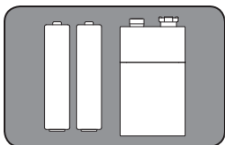

## Pin Wrench

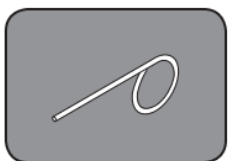

## ⚠ Important Notes ⚠

- DO NOT use a power drill for installation!
- Use a screwdriver to remove product from packaging.

- Install and test lock with door open to avoid being locked out.

### 1. Check Dimensions.

If door dimensions do not match, go to [www.schlage.com](http://www.schlage.com) for drilling instructions

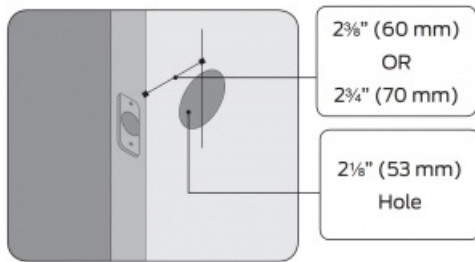

### 2. Install strike onto door jamb.

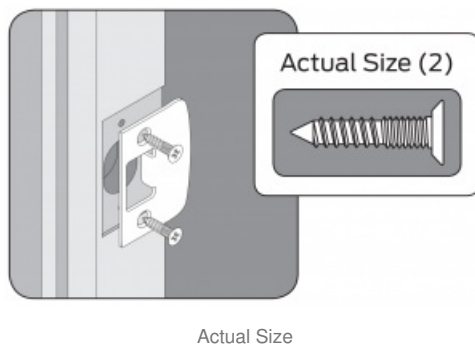

### 3. Change faceplate, if necessary.

Choose the drawing that matches your door edge. If the hole has no mortise, change to the circular faceplate.

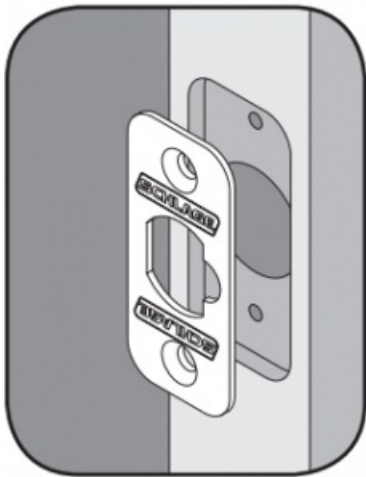

No change necessary.

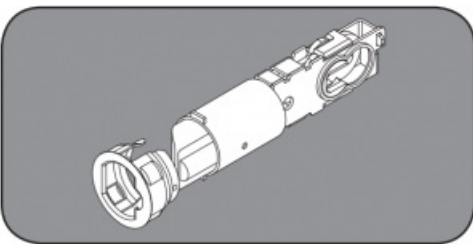
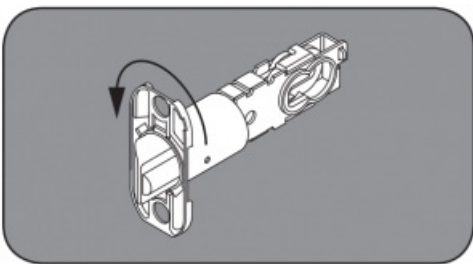
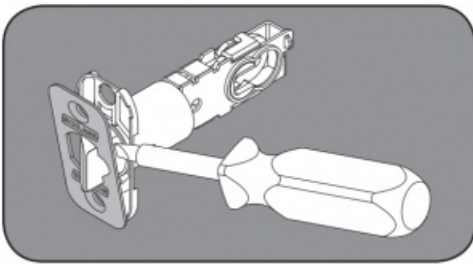
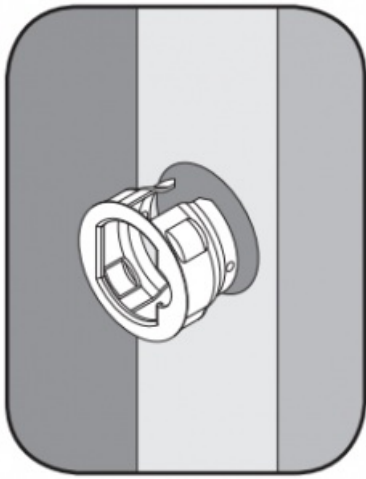

#### 4. Install Latch.

Make sure latch angle faces door jamb.

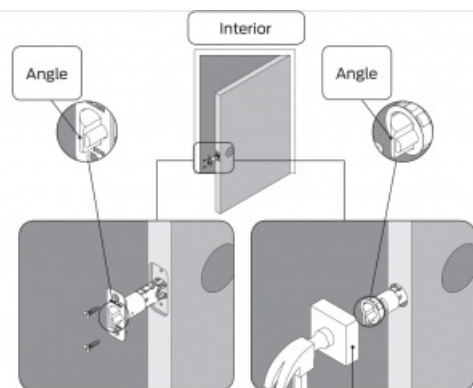

Wood Block (not included)

Actual Size (2)

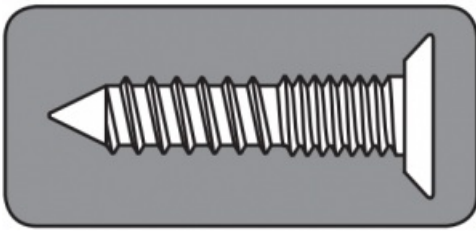

5. Install 9V battery into Keypad Exterior.

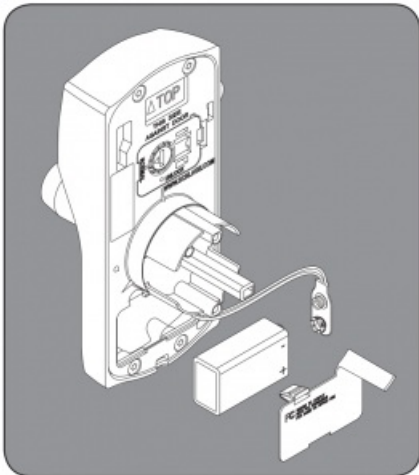

6. Install AAA batteries into Alarm Interior.

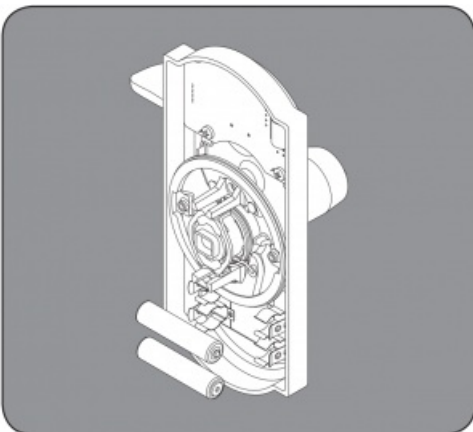

7. Install Keypad Exterior.

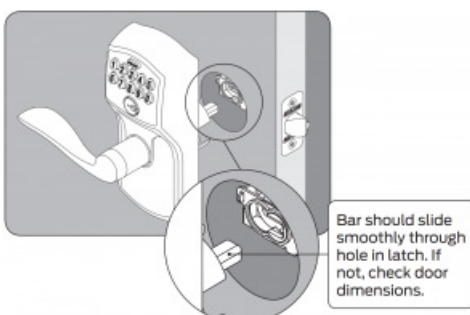

Bar should slide smoothly through hole in latch. If not, check door dimensions.

## 8. If needed, switch levers.

Correct

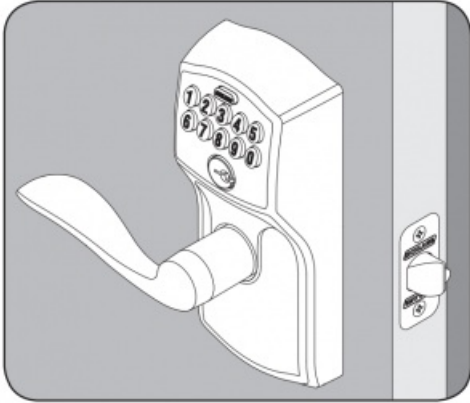

No change necessary

Incorrect

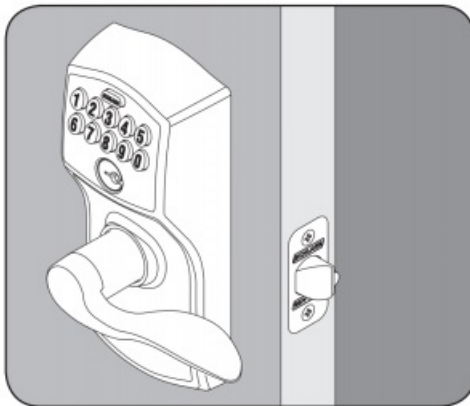

a. For the Keypad Exterior, insert the pin wrench into the hole in the lever. Push in and hold.

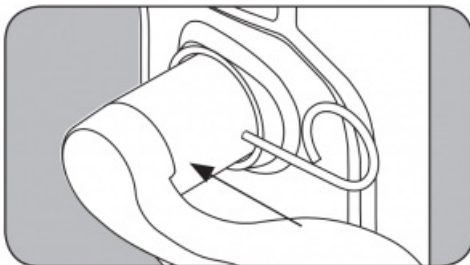

b. Pull the lever off.

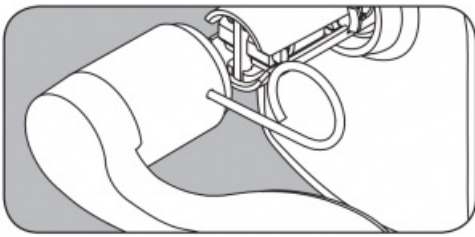

c. Repeat steps a and b to remove the lever from the Alarm Interior.

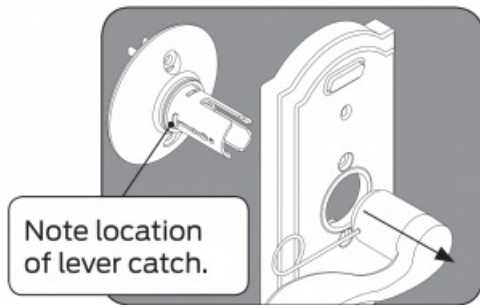

Note location of lever catch.

d. Rotate the chassis so lever catch is on the other side. Then use the lever from the Keypad Exterior to reassemble the Alarm Interior.

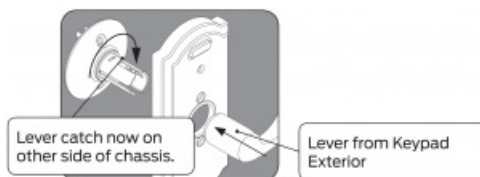

Lever catch now on other side of chassis. , Lever from Keypad Exterior

e. Put the lever from the Alarm Interior on the Keypad Exterior.



Lever from Alarm Interior

9. Install inside lever.

Make sure lock is straight before tightening screws.

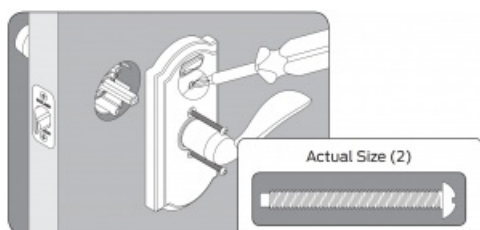

Actual Size

10. Test outside entry.



Check with door open!

1. Find User Code A on the yellow sticker on the included Programming Guide.
2. Enter User Code A (four digits) into the keypad.
3. Rotate and then release lever.

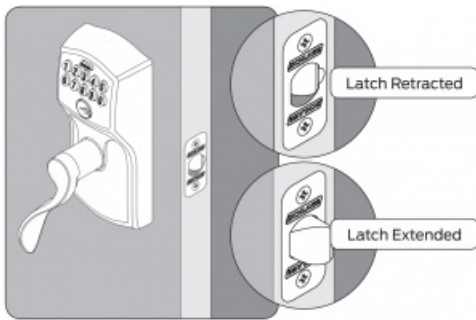

Latch Retracted, Latch Extended

Did latch retract and then extend?

**Yes.** Lock is installed correctly.

**No.** Latch retracted but did not extend (latch bound). Check step 7.

**No.** Nothing happened. Check step 3.

11. Turn the alarm on.

Press the inside Schlage button for 5 seconds, until any light flashes around the Schlage button. See the included User's Guide for detailed instructions.

12. If desired, program user codes and change alarm settings.

See the included User Guide's for detailed instructions.

### **Lifetime Limited Mechanical and Finish Warranty and 1-Year Limited Electronics Warranty**

Subject to the terms and conditions of this warranty, Schlage extends a lifetime limited mechanical and finish warranty and a one-year limited electronics warranty to the original consumer user ("Original User") of our Schlage brand product ("Product") against defects in material and workmanship, as long as the Original User occupies the residential premises upon which the Product was originally installed.

**What Schlage will do:** Upon return of the defective Product to Schlage, Schlage's sole obligation, at its option, is to either repair or replace the Product, or refund the original purchase price in exchange for the Product.

**Original User:** This warranty only applies to the Original User of Products. This warranty is not transferable.

**What is not covered:** The following costs, expenses and damages are not covered by the provisions of this

limited Warranty: (i) labor costs including, but not limited to, such costs as the removal and reinstallation of Product; (ii) shipping and freight expenses required to return Product to Schlage; and (iii) any other incidental, consequential, indirect, special and/or punitive damages, whether based on contract, warranty, tort (including, but not limited to, strict liability or negligence), patent infringement, or otherwise, even if advised of the possibility of such damages. Some local laws do not allow the exclusion or limitation of incidental or consequential damages,



so the above exclusion or limitation may not apply to you.

The provisions of this warranty do not apply to Products: (i) used in commercial applications; (ii) used in common area applications; (iii) used for purposes for which they are not designed or intended; (iv) which have been subjected to alteration, abuse, misuse, negligence or accident; (v) which have been improperly stored, installed, maintained or operated; (vi) which have been used in violation of written instructions provided by Schlage; (vii) which have been subjected to improper temperature, humidity or other environmental conditions; or (viii) which, based on Schlage's examination, do not disclose to Schlage's satisfaction non-conformance to the warranty. Additionally, this warranty DOES NOT COVER scratches, abrasions, or deterioration due to the use of paints, solvents or other chemicals.

Exclusions: Oil Rubbed Bronze finish (613) is designed to improve over time and change in appearance, creating a living finish through daily use and thus, finish discoloration is not applicable to the above warranty.

Additional terms: Schlage does not authorize any person to create for it any obligation or liability in connection with the Product. Schlage's maximum liability hereunder is limited to the original purchase price of the Product. No action arising out of any claimed breach of this warranty by Schlage may be brought by the Original User more than one (1) year after the cause of action has arisen.

How local law applies: This warranty gives you specific legal rights, and you may also have other rights as otherwise permitted by law. If this Product is considered a consumer product, please be advised that some local laws do not allow limitations on incidental or consequential damages or how long an implied warranty lasts, so that the above limitations may not fully apply. Refer to your local laws for your specific rights under this warranty.

Guaranteed Fit Program: Schlage products are designed to fit standard residential door preparations and retrofit existing tubular locks. Note: Mortise locks and preparations are not considered standard and are not guaranteed under this program. During the initial installation, if there is a problem with the Product's performance, the Original User may simply contact Schlage Customer Service at 888-805-9837 in the U.S. and Canada or 800-506-7866 in Mexico for assistance.

Program and warranty claims: If you encounter a residential door preparation or fit issue under the Guaranteed Fit Program or have a claim under this warranty, please contact Schlage Customer Service for repair, replacement or refund of the original purchase price in exchange for the return of the Product to Schlage.



Register your product at [registtermyschlage.com](https://registtermyschlage.com) or scan the code with your smartphone. Download app at [scanlife.com](https://scanlife.com)



Keypad Entry with Built-in Alarm FE576 Installation Instructions – [Optimized PDF](#)  
Keypad Entry with Built-in Alarm FE576 Installation Instructions – [Original PDF](#)

[Manuals+](#)