



SCHLAGE 801  
Series Local and  
Remote  
Monitoring Station



# SCHLAGE 801 Series Local and Remote Monitoring Station Installation Guide

[Home](#) » [Schlage](#) » SCHLAGE 801 Series Local and Remote Monitoring Station Installation Guide 

## Contents

- [1 SCHLAGE 801 Series Local and Remote Monitoring Station](#)
- [2 Specifications](#)
- [3 Description of Operation](#)
- [4 M490DEP](#)
- [5 Documents / Resources](#)
  - [5.1 References](#)
- [6 Related Posts](#)



**SCHLAGE 801 Series Local and Remote Monitoring Station**



## Dimension

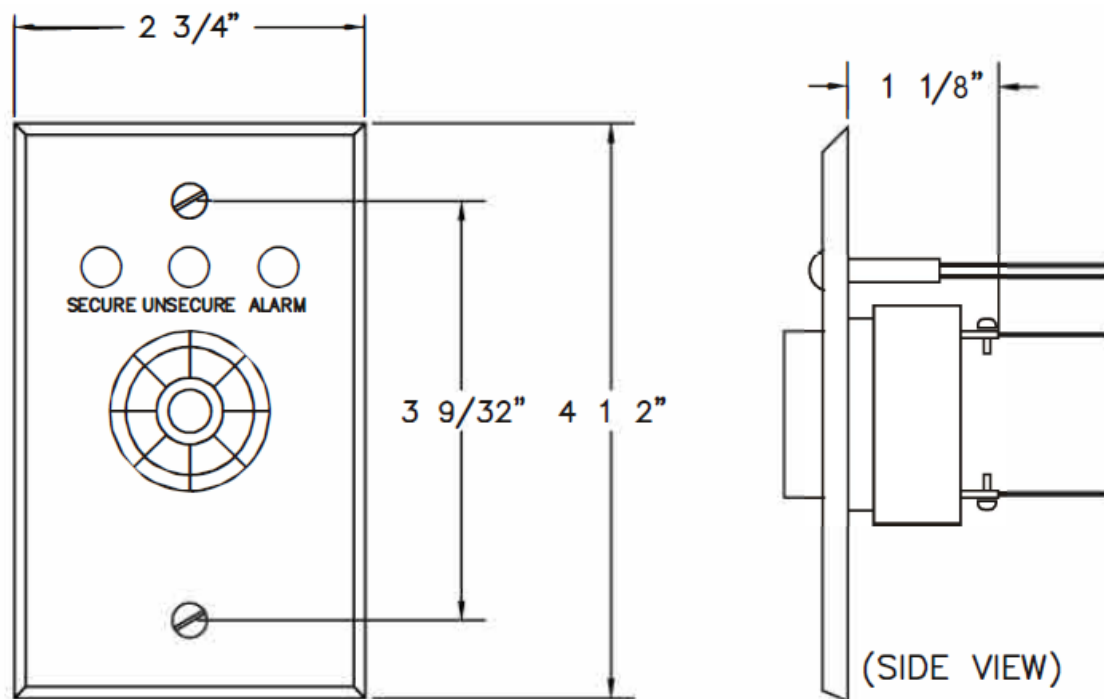

## Specifications

### Audible

- Input Req: 10-28VDC/3-14mA
- Rated: 70dB@ 2ft @28VDC

### Hook-Up Leads:

- (4) 24 AWG – 6" long

- BLK (C) – Common
- RED (U) – Unsecured
- RED (S) – Secure
- RED (A) – Alarm

#### **LED Indicators:**

- Input Req: 10-28VDC/3-14mA ea.
  - Secure – Green
  - Unsecured – Red
  - Alarm – Yellow
- Touch Entry Leads:
  - 2 Conductor, 22 AWG., 1ft White and Black



#### **IMPORTANT NOTE**

Unit must be equipped with MBS option for LEDs to work.

#### **Description**

Provides local signal to assure users that a delayed egress system is functional (code requirement). Includes audible and visual indication of lock status and delay activation. Mounts in standard single gang electrical box.

#### **Description of Operation**

The 801 is wired to a magnetic lock delayed egress system as shown on wiring diagram (page 2).

**The following is an operation sequence from normal (secure) condition – through an unauthorized egress attempt – to system reset:**

#### **Condition:**

- Door closed and secure
- Unauthorized egress attempt
- After 15 (or 30) second delay
- System reset
- Legal release

#### **801 Status**

- Alarm Silent – Green LED on
- Alarm Sounds – Green & Red LED on
- Alarm Sounding – Yellow & Red LED on
- Alarm Silent – Green LED on
- Alarm Silent – Red LED on

#### **M490DEP**

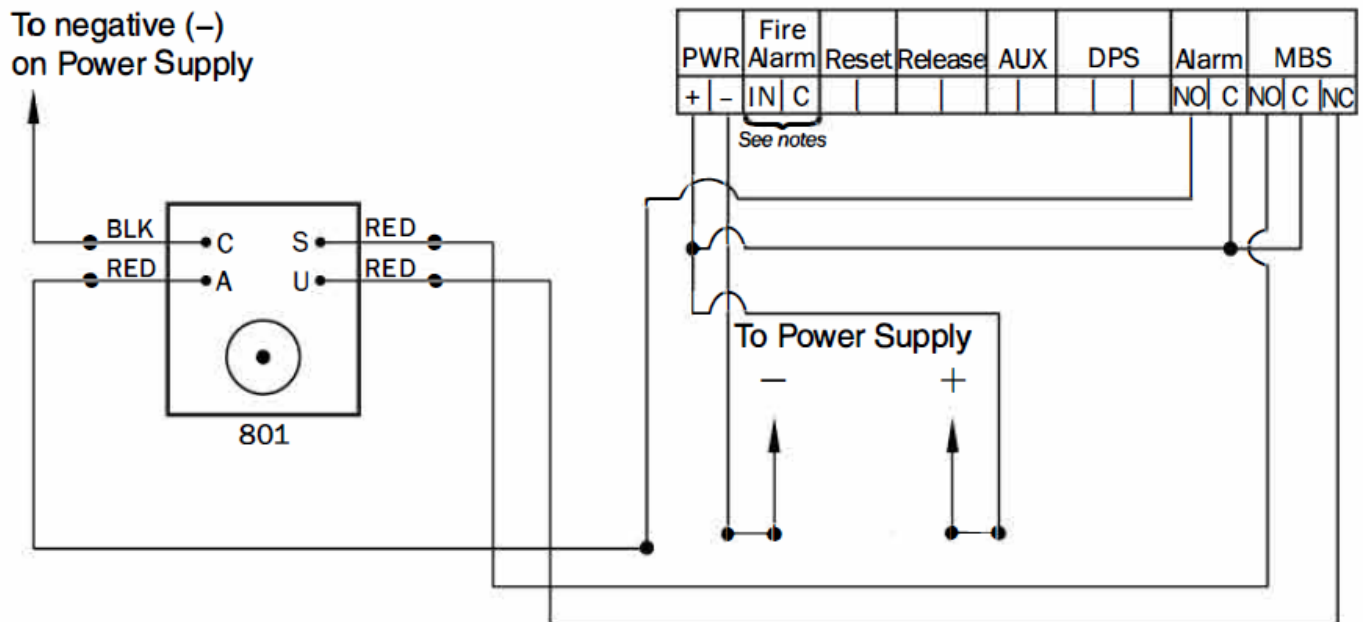

## NOTES:

### Fire alarm connection:

For direct connection, fire alarm terminals connect to N.C. Dry Output Contacts (open on alarm). Conductor count to mag changes to four (4). If power supply output is controlled by fire alarm, place jumper between fire alarm terminals.

## Customer Service

- 1-877-671-7011
- [www.allegion.com/us](http://www.allegion.com/us)

©Allegion 2017  
Printed in U.S.A.  
24480857 Rev. 08/17-c

## Documents / Resources

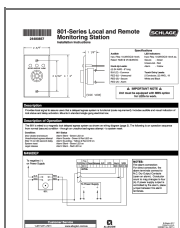

[SCHLAGE 801 Series Local and Remote Monitoring Station](#) [pdf] Installation Guide  
801 Series, 801 Series Local and Remote Monitoring Station, Local and Remote Monitoring Station, Remote Monitoring Station, Monitoring Station, Station

## References

- [User Manual](#)

[Manuals+](#), [Privacy Policy](#)

This website is an independent publication and is neither affiliated with nor endorsed by any of the trademark owners. The "Bluetooth®" word mark and logos are registered trademarks owned by Bluetooth SIG, Inc. The "Wi-Fi®" word mark and logos are registered trademarks owned by the Wi-Fi Alliance. Any use of these marks on this website does not imply any affiliation with or endorsement.