



scheppach TIGER 2500 Wet Grinding Machine Instruction Manual

[Home](#) » [Scheppach](#) » scheppach TIGER 2500 Wet Grinding Machine Instruction Manual 



TIGER 2500

Wet Grinding Machine

Translation from the original instruction manual



Art. N^o
5903202901
AusgabeN^o
5903202850
Rev.N^o
07/08/2017

Contents

- 1 TIGER 2500 Wet Grinding Machine
- 2 General Notes
- 3 Safety Instructions
- 4 Assembly
- 5 Working Instructions
- 6 Special accessories
- 7 Wiring diagram
- 8 Documents / Resources
 - 8.1 References
- 9 Related Posts

TIGER 2500 Wet Grinding Machine

Fig. 1

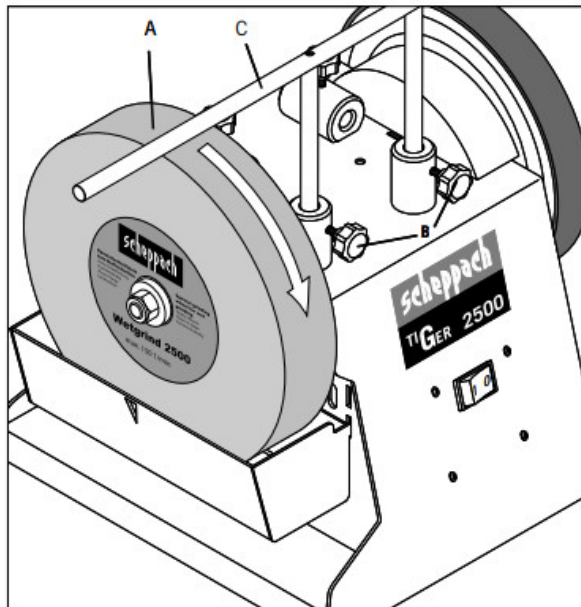

Fig. 4

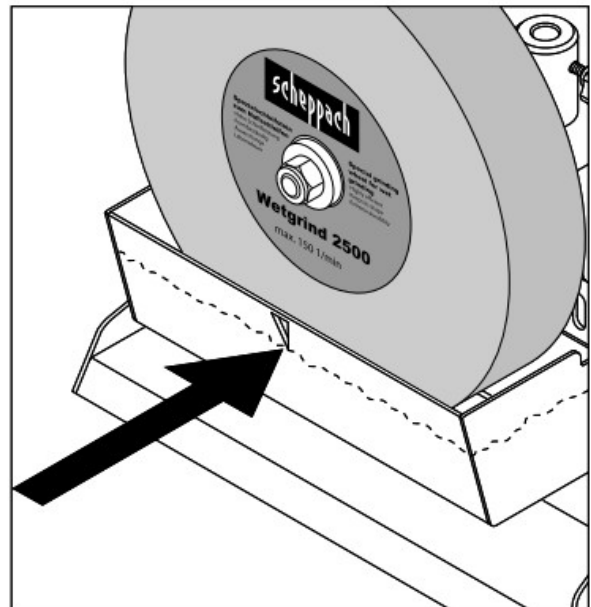

Fig. 2

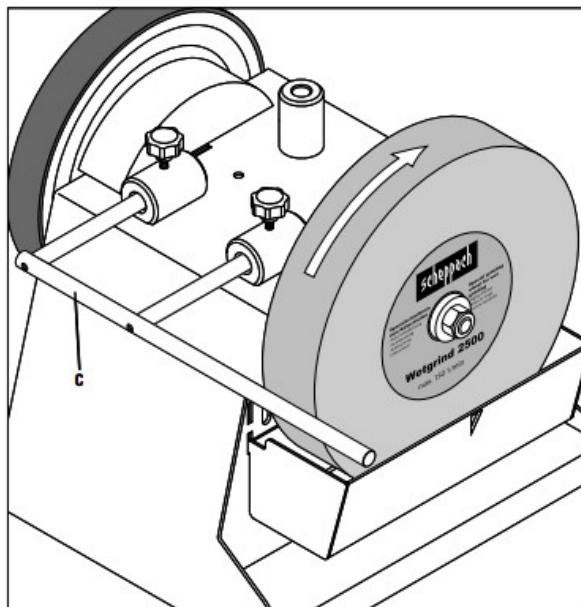

Fig. 5

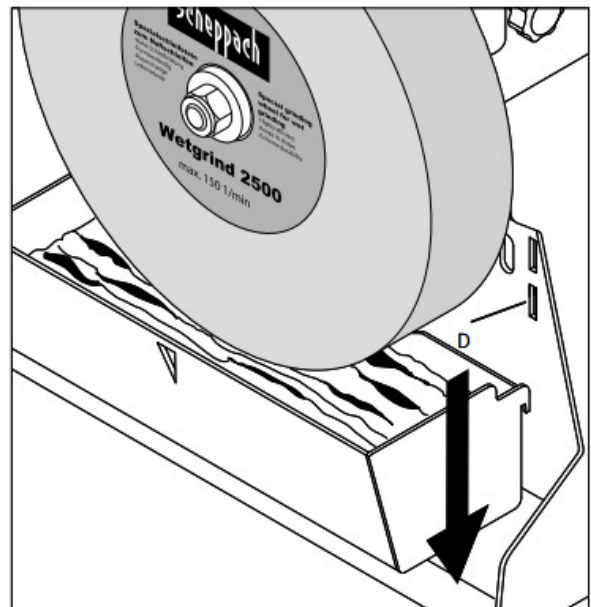

Fig. 6

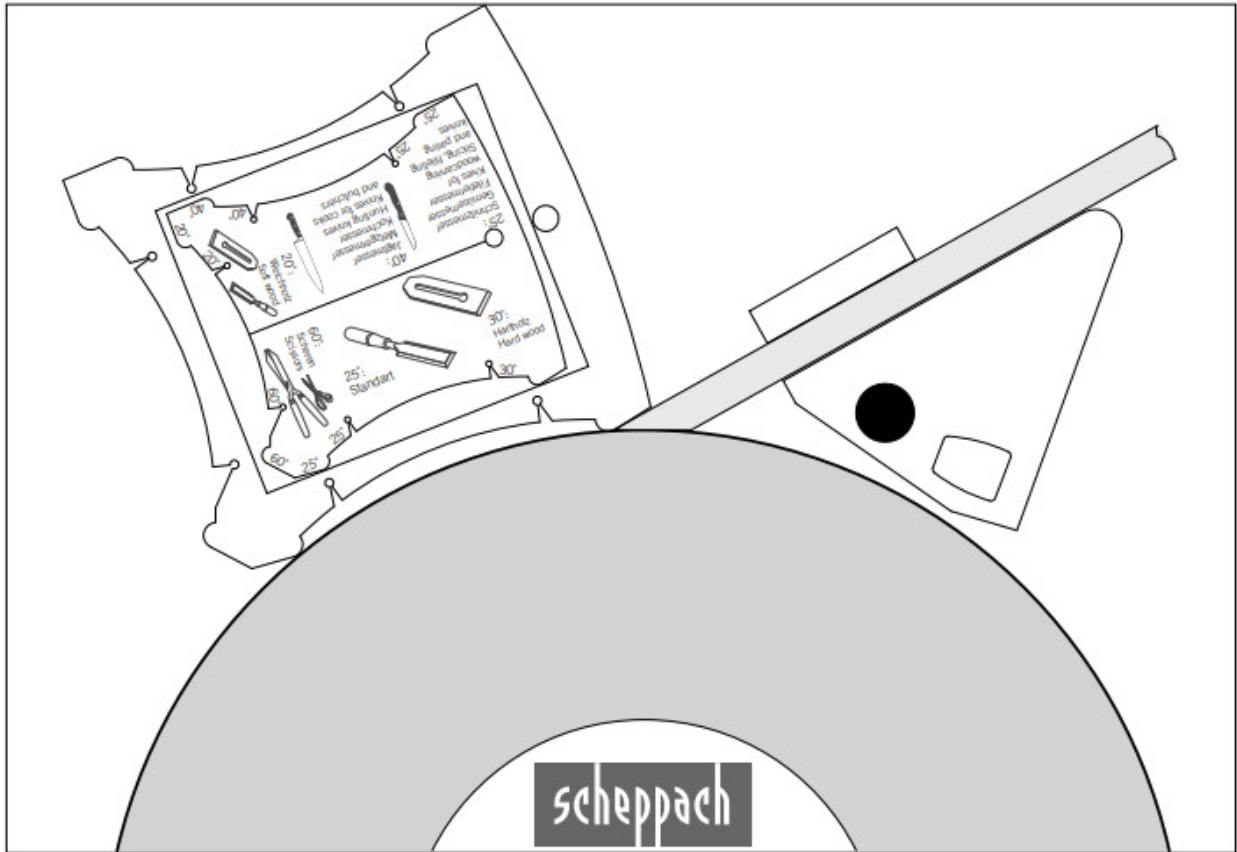

Fig. 7

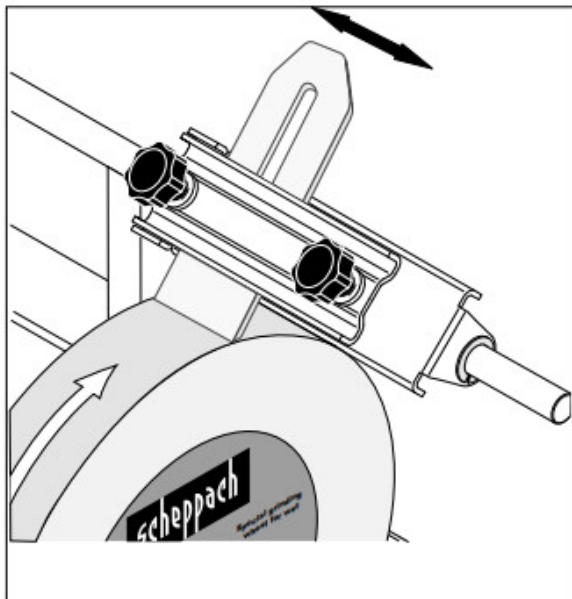
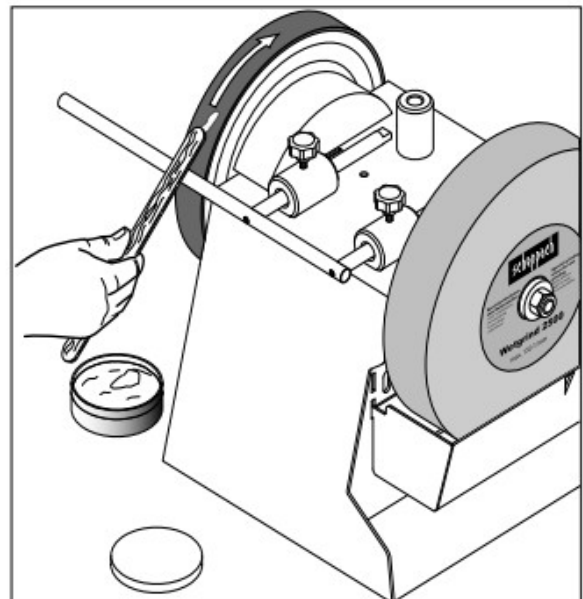

Fig. 8



Caution – Read the operating instructions to reduce the risk of injury!



Wear safety goggles!

Manufacturer:

Scheppach
Fabrikation von Holzbearbeitungsmaschinen GmbH
Günzburger Straße 69
D-89335 Ichenhausen / BRD

Dear customer,

we wish you a pleasant and successful working experience with your new scheppach wet grinding machine. According to the applicable product liability law, the manufacturer of this device is not liable for damages that arise on or in connection with this device in the case of:

- improper handling
- non-compliance with the instructions for use
- repairs by a third party, nonauthorized skilled workers
- installation and replacement of non-original spare parts
- improper use
- failures of the electrical system due to the non-compliance with the electrical specifications and the VDE 0100, DIN 57113 / VDE 0113 regulations

Recommendations:

Read the entire text of the operating instructions prior to the assembly and operation of the device. These operating instructions are intended to make it easier for you to get familiar with your device and utilize it's intended possibilities of use. The operating instructions contain important notes on how to work safely, properly, and economically with your machine and how to avoid dangers, save repair costs, reduce downtime, and increase the reliability and working life of the machine. In addition to the safety regulations contained herein, you must in any case comply with the applicable regulations of your country with respect to the operation of the machine. Put the operating instructions in a clear plastic folder to protect them from dirt and humidity, and store them near the machine. The instructions must be read and carefully observed by each operator prior to starting the work. Only persons who have been trained in the use of the machine and have been informed of the related dangers and risks are allowed to use the machine. The required minimum age must be met. In addition to the safety notes contained in the present operating instructions and the special regulations of your country, the generally recognized technical rules for the operation of woodworking machines must be observed.

General Notes

- When you unpack the device, check all parts for possible transport damages. In case of complaints, the supplier is to be informed immediately.
- Complaints received at a later date will not be acknowledged.
- Check the delivery for completeness.
- Read the operating instructions to make yourself familiar with the device prior to using it.
- Use only original parts for accessories as well as for wearing and spare parts. Spare parts are available from your specialized dealer.
- Specify our part numbers as well as the type and year of construction of the device in your orders.

TIGER 2500

Scope of delivery	
	Grinding stone
	Universal holder

	Abrasive paste
	Angle measurer 250
	Leather honing disc
	Operating instructions
Specifications	
Dimensions LxWxH mm	320 x 325 x 335
Tool rest ø the mm	12
Grinding stone ø mm	250
Idle-running speed – grinding stone 1/min.	90
Cutting speed m/sec.	1,2
Weight kg	16,3
Drive	
Motor V/Hz	230 — 240 / 50
Input P1 W	200
Output P2 W	120
Motor speed 1/min.	1400
Operating mode	S1 100 %
Current rating A	1,0

Subject to technical modifications!!

Safety Instructions

Information relating to your safety is highlighted with this symbol in the present operating instructions. 

Operators' Training

- Pass the safety instructions to all persons working with the machine.
- The operator must be at least 18 years old. Trainees must be at least 16 years old but are only allowed to use the machine under supervision.
- Persons operating the machine must not be distracted.
- Keep away children from the machine if it is connected to the mains.
- Always wear tight clothes. Remove jewelry, rings, and wrist watches.
- Observe all safety instructions and warnings on the machine and maintain them in a readable state.
- Be careful when working with the machine: the rotating grinding tool may cause injuries to fingers and hands.

Stability

- Make sure the machine is installed on firm ground with sufficient stability.
- Make sure the workplace is sufficiently illuminated.

Mains Connection of the Machine

- Check the main connecting lines. Do not use defective lines. See the electrical connection.
- Pay attention to the direction of rotation of the motor and the tools. See the electrical connection.
- Installations, repair, and maintenance work relating to the electric installation may only be performed by specialists.
- Turn off the machine before you repair failures. Disconnect the mains plug.
- Turn off the motor when you leave the workplace. Disconnect the mains plug.
- Disconnect the machine from any external energy supply also in case of only moving the machine to another, nearby location! Properly reconnect the machine to the mains before you turn it on again!

Setup and Adjustment of the Machine

- Only perform retooling, measuring, and cleaning work when the motor is turned off. Disconnect the mains plug, and wait until the rotating tool stands still.
- All protection and safety devices must be immediately reinstalled once the repair and maintenance work is completed.

Proper Use

- The grinding machine has been exclusively designed for grinding steel using the offered tool (no hard alloy).
- The machine meets the currently valid EU machine directive.

- The machine has been designed for a one-shift operation, operating factor S1/100 %.
- Observe all safety instructions and warnings on the device.
- Make sure that all safety instructions and warnings on the machine always are in a readable state.
- Only use the machine if it is in a technically faultless state. Pay attention to the intended use, safety, and dangers, and comply with the operating instructions! Immediately repair (or have repaired) failures that may affect safety.
- The safety, working, and maintenance instructions and the dimensions set forth in the specifications must be observed.
- The applicable regulations for the prevention of accidents and other, generally recognized safety rules must be observed.
- The machine may only be used, maintained, or repaired by trained persons who are familiar with the machine and have been informed about the dangers. Unauthorized modifications of the machine exclude the liability of the manufacturer for damages resulting from the modifications.
- The machine may only be used with the original accessories and original tools of the manufacturer.
- Any other use is considered to be not intended. The manufacturer excludes any liability for resulting damages, the risk is exclusively borne by the user.
- for use in commercial, trade, or industrial applications. Our warranty will be voided if the equipment is used in commercial, trade, or industrial businesses or for equivalent purposes.

Warning!

This electric tool generates an electromagnetic field during operation. This field can impair active or passive medical implants under certain conditions. In order to prevent the risk of serious or deadly injuries, we recommend that persons with medical implants consult with their physician and the manufacturer of the medical implant prior to operating the electric tool.

Residual Risks

The machine has been constructed according to the state of the art and the recognized safety rules. Nevertheless, single residual risks may occur during the operation.

- The rotating grinding wheel may cause injuries to fingers and hands.
- The danger is caused by electric current if inappropriate electrical connecting lines are used.
- Furthermore, nonobvious residual risks may exist in spite of all measures taken.
- Residual risks can be minimized by carefully observing the safety instructions and the intended use as well as the entire operating instructions.

Assembly

Assemble the grinding stone (A) and the star knob (B) as shown in fig. 1.

Then place the workpiece surface (C) into the bracing element and secure it, using the help of the star knobs (see fig. 1)

The water tank should be hooked into its port (D) (see fig. 5).

Installation and Adjustment

Please make sure that your grinding machine is installed in an upright and stable manner on firm ground with sufficient illumination.

The machine has no front or rear side. You can alternatively grind with or against the direction of rotation.

Electrical Connection

The installed electric motor is connected and is ready to work.

The connection complies with the relevant VDE and DIN regulations.

The connection to the mains supply on the customer side and the used extension line must meet these regulations or the provisions of the local power supply company.

Defective Electric Connection Lines

Often, insulation damages occur on electrical connection lines. The possible causes are:

- Drag marks if connection lines are led through window or door clearances.
- Kinks due to improper attachment or routing of the connection line.
- Cuts are caused by running over the connection line.
- Insulation damages are caused by pulling the connection line out of the wall socket.
- Fissures are caused by the aging of the insulation. Such defective electrical connection lines must not be used and are, due to the insulation damages, life-threatening!

Regularly check the electrical connection lines for damages. Please make sure that the connection lines are disconnected from the mains supply during the check. Electrical connection lines must meet the applicable VDE and DIN regulations and the provisions of the local power supply company. Only use connection lines labeled with H07RN. The labeling of the connection cable with the type specification is required.

A.C. Motor

- The supply voltage must be 220÷240 V/50 Hz.
- Extension lines up to a length of 25 m must have a minimum cross-section of 1.5 mm², and lines with a length exceeding 25 m must have a minimum cross-section of 2.5 mm².
- The mains connection is protected with a maximum of 16 A.

Connections and repairs of the electrical equipment may only be performed by an electrician.

If you have further questions, please specify the following:

- Motor manufacturer and type
- Kind of current of the motor
- Data from the machine-type plate
- Data on the electric control

If you return the motor, always return the complete drive unit with the electric control.

Working Instructions

The direction of Grinding (Fig. 1, Fig. 2)

It mainly depends on your requirements whether you want to work with or against the direction of grinding. If you want to quickly remove large quantities of steel (e.g. from very old, rusty tools) or if you want to grind coarse tools, such as axes, it is recommended to work against the direction of grinding. If you want to grind more precisely, we recommend to work with the direction of grinding. This applies, for example, to carving tools and knives. Please note that the grinding process is slowed down if you work with the direction of rotation.

Please check before each operation whether the surface of the grinding stone is even. To do so, lower the universal support onto the stone and turn it manually by 360°. If required, trim uneven material using the 250 trimming device.

Upon the time of delivery, the TiGer provides of even surfaces.

Water Reservoir (Fig. 3, Fig. 4)

Fill the water reservoir with water up to the marking. The grinding stone becomes saturated with water. Refill water, if required. Do not grind without water.

Once the grinding process is completed, lower the water reservoir to prevent the grinding stone from being in the water for an extended period of time.

Empty the water reservoir regularly. Otherwise, particles of steel and trimmed stone will accumulate and compress in the reservoir.

Expert tip: Such precipitations can be avoided if you place a magnet into the water.

Angle Measurer (Fig. 5)

Measure the angle of the grinding bezel by comparing the cutting edge to the notches. Then, you set the determined angle at the device by changing the height of the universal support. To do so, perform the following steps: First, clamp the tool into the device and insert the device on the universal support.

Then, hold the angle measure with the desired angle at the tooltip. Now, adjust the height of the universal support in such a manner that the front end of the angle measurer straight borders the grinding stone. Please make sure that the angle measure is always in alignment with the tooltip.

Note: The values indicated on the angle measurer are only standard values. Of course, you can change these values according to your requirements.

Grinding (Fig. 6)

Expert tip: New tools still show traces of the production process. You can substantially increase the lifetime of your tools if you grind them on both sides of the cutting edge before the first application. You simply grind the back side in the free-handed mode on the vertical of the grinding stone, and the front side is as follows.

After you have set the angle, insert the tool mounted in the device on the universal support, turn on the motor, and start the grinding process. Press the tool evenly onto the grinding stone near the cutting edge, and move it crosswise across the stone. Please make sure that at least half the width of the cutting edge comes into contact with the grinding stone at any time to avoid damage to the stone.

To achieve finer grinding results, prepare the stone using the Stone preparer. Thereby you increase the graining from 250 to approximately 1000. The SP is available as an accessory from your scheppach dealer.

Sharpening (Fig. 7)

Never sharpen against the direction of grinding! Otherwise, the tool will cut into the leather!

Impregnate the leather disc using weak machine oil. Then apply an abrasive paste on the leather disc. Turn on the device, and distribute the abrasive paste by pressing the ground tool with circular movements on the wheel. These preparations are sufficient for five to ten tools. Then, you start again with a new layer of machine oil, followed by new abrasive paste. These measures increase the lifetime of the leather and the quality of your tools.

Expert tip: You can work in the free-handed mode for the trimming itself. You achieve a more precise result if you keep the tool in the device in the position in which you ground the tool.

Special accessories

Stone preparer, order no. 8949 0707

Change the graining of your TiGer within seconds from 250 to 1000 and vice versa!

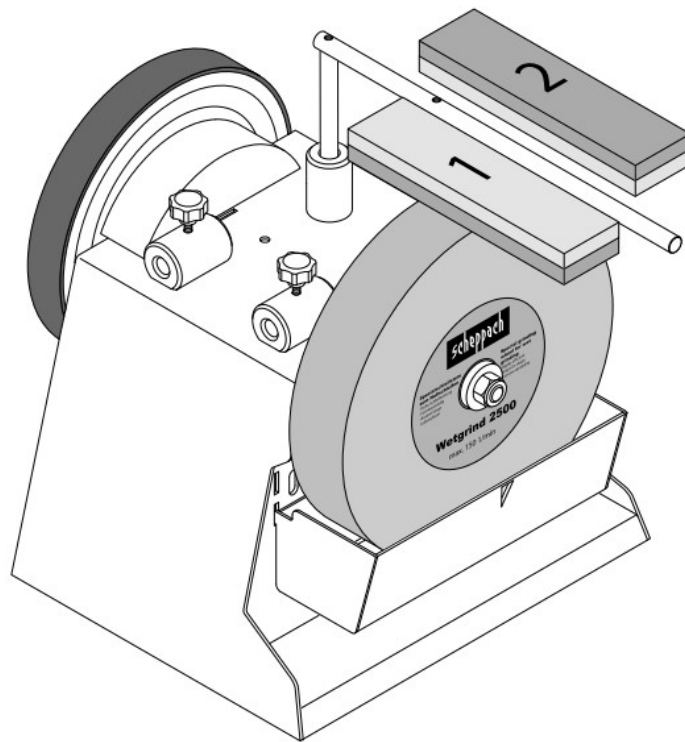

Device for tubes and gouges (with 100) 55, order no. 8949 0706
 You can equip finger-shaped tools with a unique sharpness!
 Device for small knives 60, order no. 8949 0708

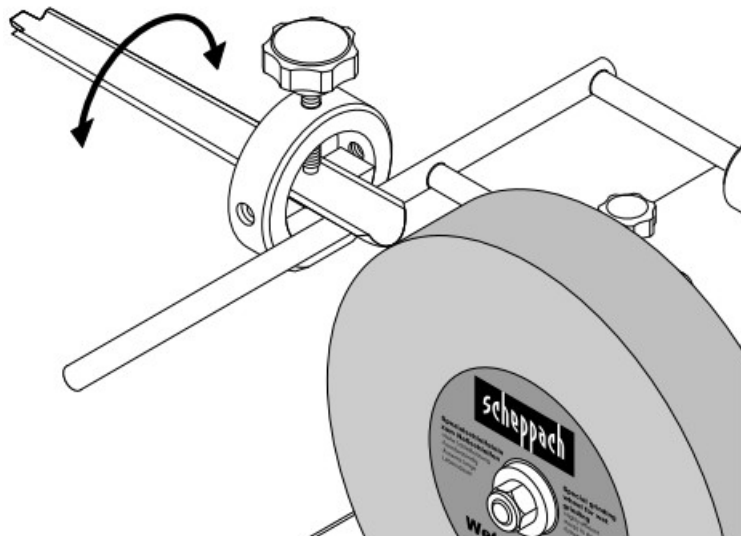

Device for large knives 120, order no. 8949 0709
 This way it's pure fun to work in the kitchen!

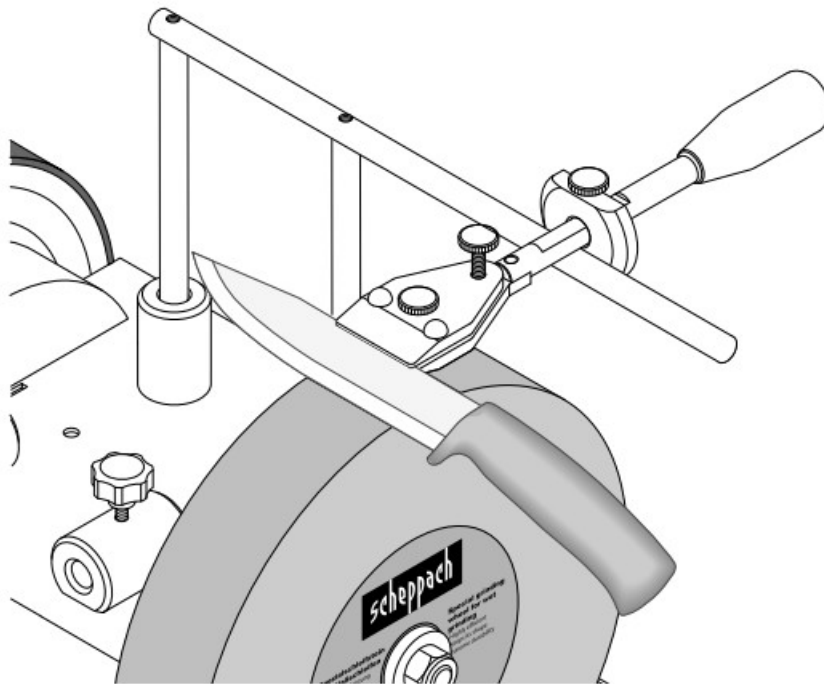

Device for scissors (with 100) 160, order no. 8949 0710

Now you can easily sharpen all kinds of scissors – whether for paper, cloth, or gardening!

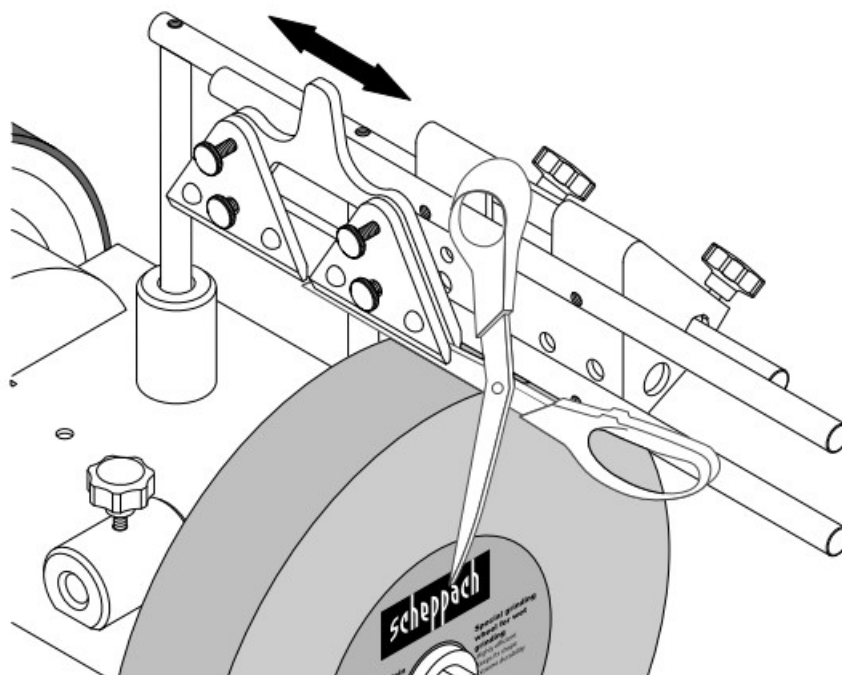

Device for axes 40, order no. 8949 0712

Cut firewood as fast as ever before there is no need for huge machines.

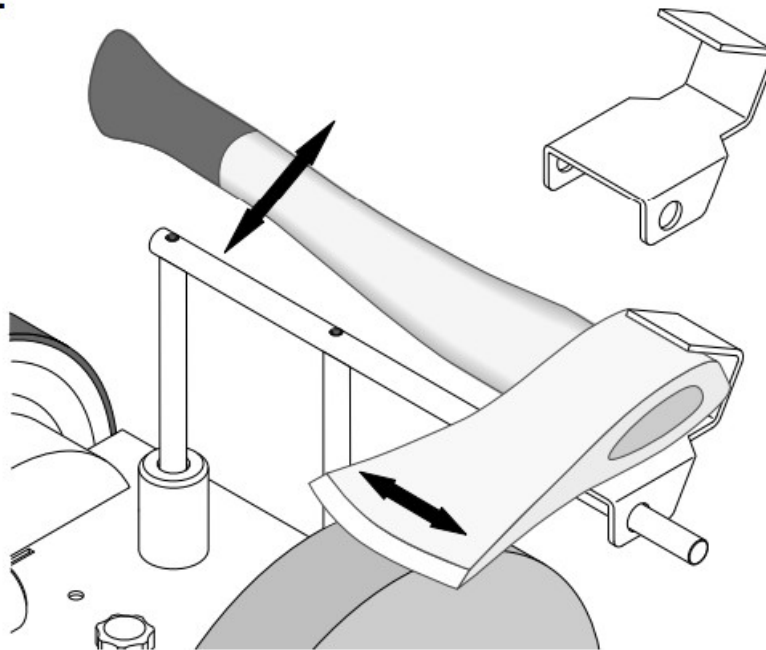

Trimming device, order no. 8949 0713

Trimmed within seconds, and you can also polish unpolished metal!

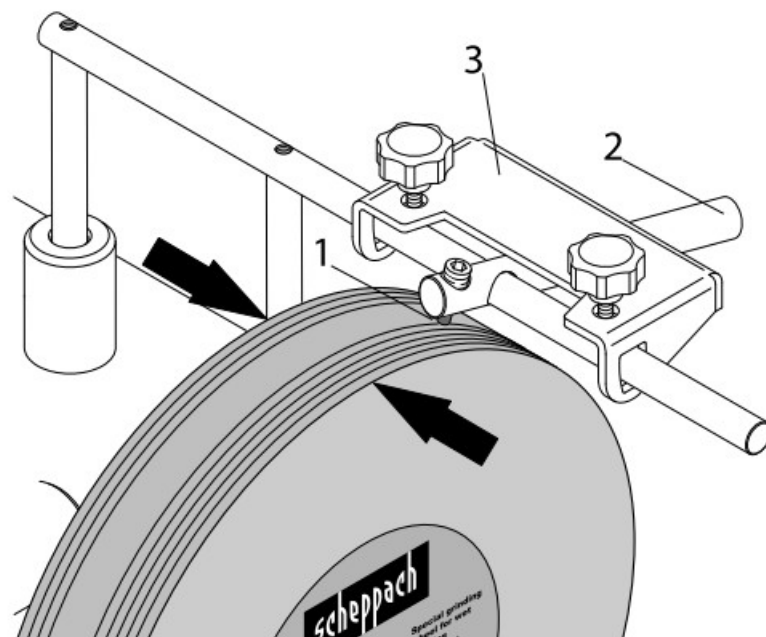

Spare cutting edge, order no. 8949 0714 Just in case.

Leather honing disc, profiled, order no. 8949 0705 For the inner side of finger-shaped tools.

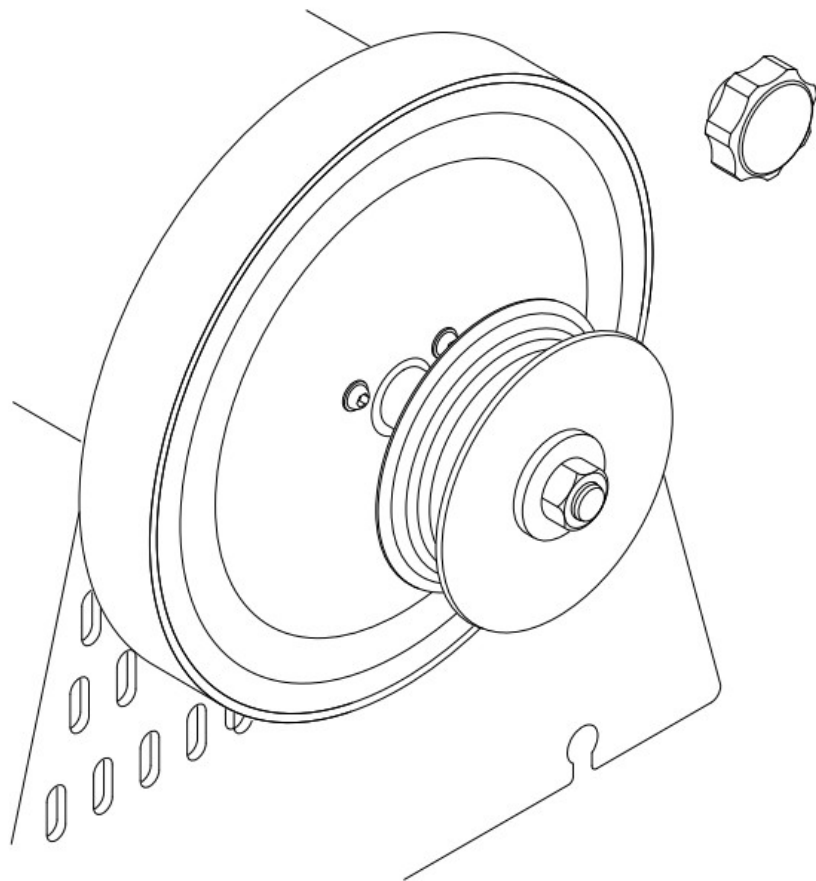

Service Information

Please note that the following parts of this product are subject to normal or natural wear and that the following parts are therefore also required for use as consumables. Wear parts*: grinding medium, Carbon brushes, sharpening wheel, angle gauge, v-belt

* Not necessarily included in the scope of delivery!

Wiring diagram

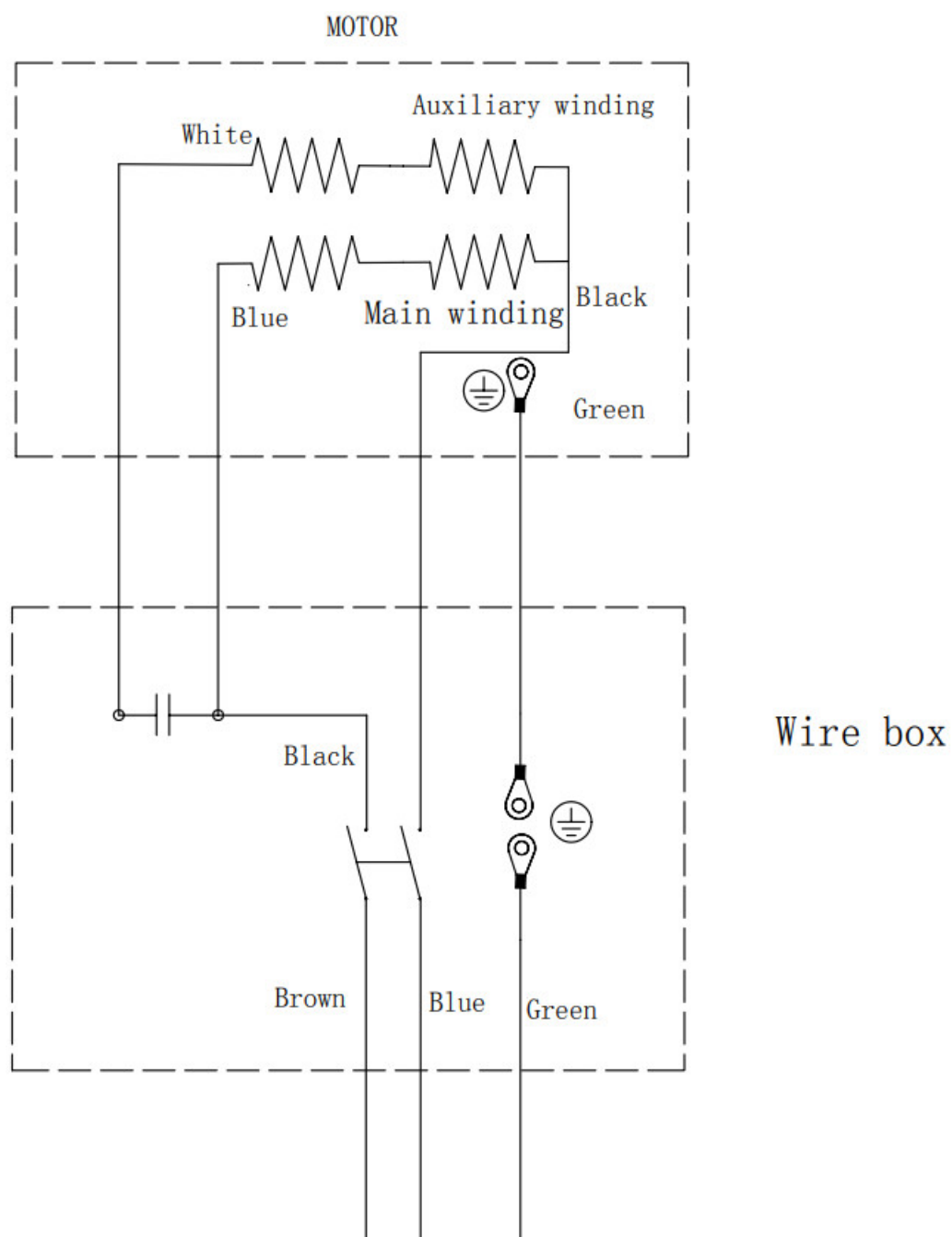

TiGer 2500

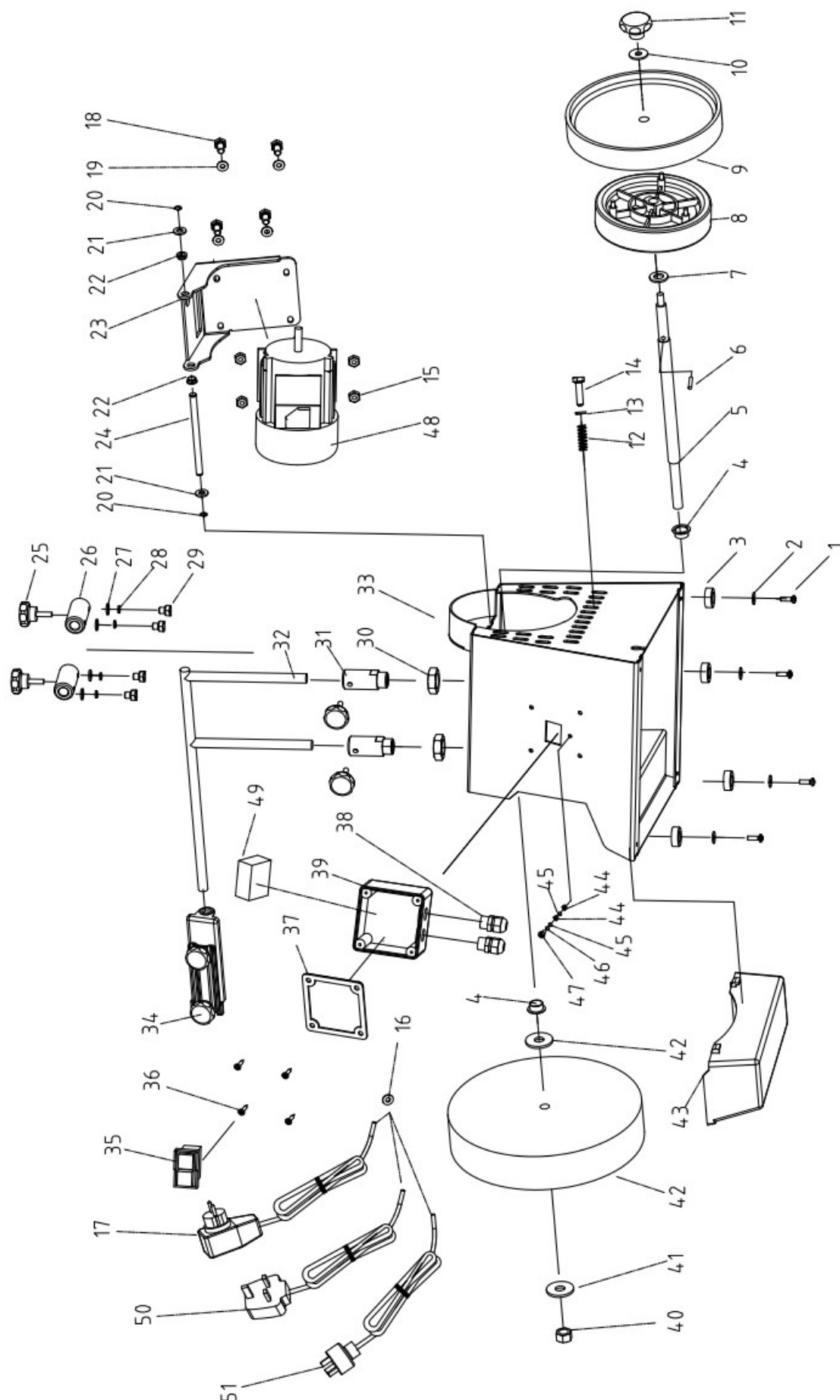

Only for EU countries.

Do not dispose of electric tools together with household waste material!

In observance of European directive 2012/19/EC on waste electrical and electronic equipment and its implementation in accordance with national law, electric tools that have reached the end of their life must be collected separately and returned to an environmentally compatible recycling facility.



Konformitätserklärung

Hereby declares the following conformity under the EU Directive and standards for the following article
Nassschleifmaschine TIGER 2500

<input type="checkbox"/> 2009/105/EC <input type="checkbox"/> <input checked="" type="checkbox"/>	<input type="checkbox"/> 89/686/EC_96/58/EC
<input checked="" type="checkbox"/> 2014/35/EU	<input checked="" type="checkbox"/> 2006/42/EC
<input type="checkbox"/> 2006/28/EC	Annex IV
<input type="checkbox"/> 2005/32/EC	Notified Body:
<input checked="" type="checkbox"/> 2014/30/EU	Notified Body No.:
<input type="checkbox"/> 2004/22/EC	Reg. No.:
<input type="checkbox"/> 1999/5/EC	<input type="checkbox"/> 2000/14/EC_2005/88/EC
<input type="checkbox"/> 97/23/EC	Annex V
<input type="checkbox"/> 90/396/EC	Annex VI
<input type="checkbox"/> 2011/65/EU	Noise: measured LWA
	= xx dB(A); guaranteed LWA
	= xx dB(A)
	Notified Body:
	Notified Body No.:
	<input type="checkbox"/> 2004/26/EC
	Emission. No:

Standard references: EN 61029-1; EN 61029-2-4
Ichenhausen, den 17.02.2017

Unterschrift / Markus Bindhammer / Technical Director

Art.-No. 5903202901

Subject to change without notice

Documents register: Stefan Hartinger

Günzburger Str. 69, D-89335 Ichenhausen

Apparent defects must be notified within 8 days from the receipt of the goods. Otherwise, the buyer's rights of claim due to such defects are invalidated. We guarantee our machines in case of proper treatment for the time of the statutory warranty period from delivery in such a way that we replace any machine part free of charge which provably becomes unusable due to faulty material or defects of fabrication within such period of time. With respect to parts not manufactured by us, we only warrant insofar as we are entitled to warranty claims against the upstream suppliers. The costs for the installation of the new parts shall be borne by the buyer. The cancellation of the sale or the reduction of the purchase price as well as any other claims for damages shall be excluded.

Scheppach Fabrikation von Holzbearbeitungsmaschinen GmbH
Günzburger Str. 69
D-89335 Ichenhausen
www.scheppach.com

Documents / Resources



[scheppach TIGER 2500 Wet Grinding Machine](#) [pdf] Instruction Manual
5903202901, TIGER 2500 Wet Grinding Machine, TIGER 2500, Wet Grinding Machine, Grinding Machine, Machine

References

- [scheppach | scheppach](#)