



# Scheppach SG3500i Inverter Gasoline Power Generator Instruction Manual

[Home](#) » [Scheppach](#) » Scheppach SG3500i Inverter Gasoline Power Generator Instruction Manual 



Art.Nº  
5906230903  
AusgabeNº  
5906230903\_0001  
Rev.Nº  
23/12/2022



## Contents

- [1 SG3500i Inverter Gasoline Power Generator](#)
- [2 Explanation of the symbols on the device](#)
- [3 Introduction](#)
- [4 Device description \(Fig. 1 – 14\)](#)
- [5 Scope of delivery \(Fig. 4\)](#)
- [6 Proper use](#)
- [7 General safety instructions](#)
- [8 Technical data](#)
- [9 Unpacking](#)
- [10 Documents / Resources](#)

**SG3500i Inverter Gasoline Power Generator**



**SG3500i**  
**Inverter generator**  
**Translation of original instruction manual**



<https://www.scheppach.com/de/service>

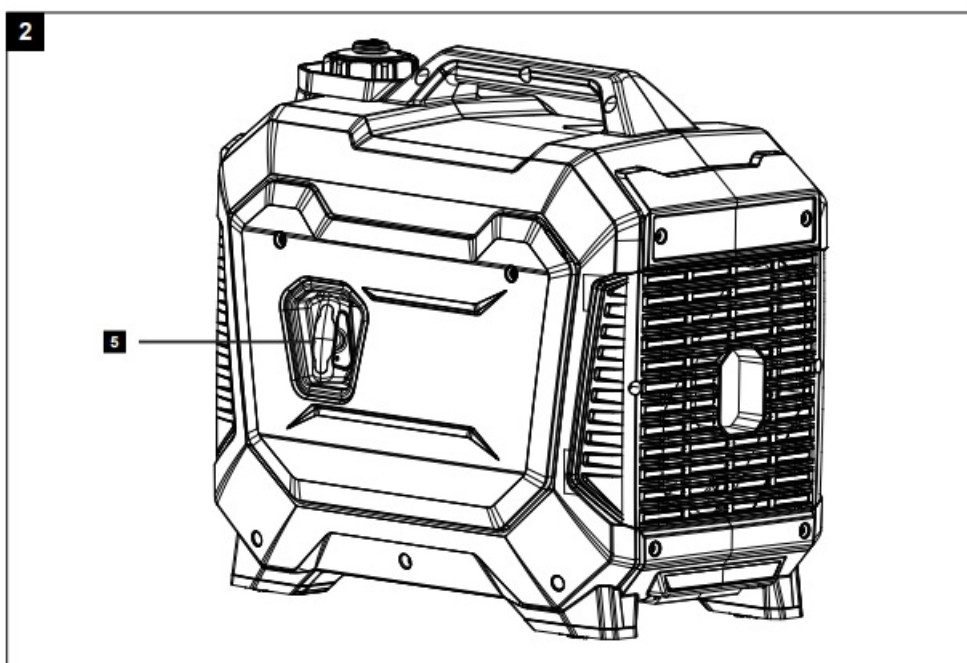
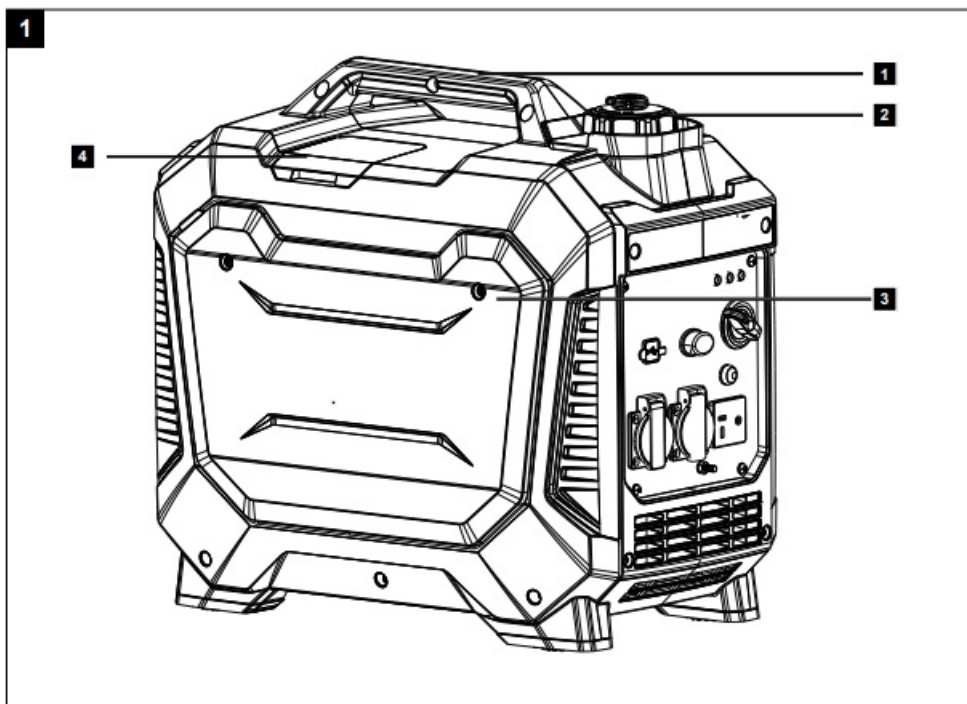

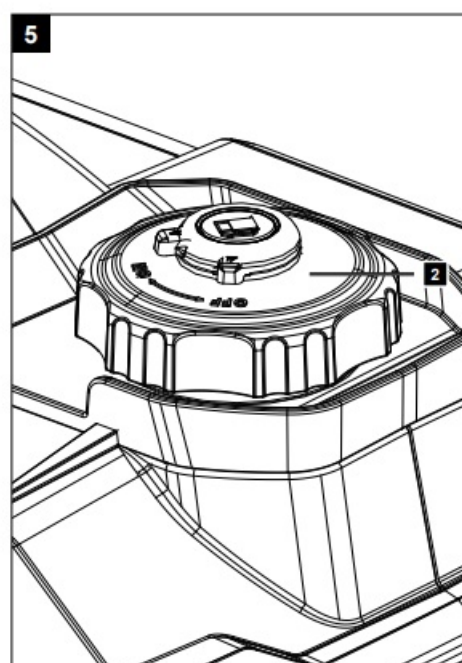
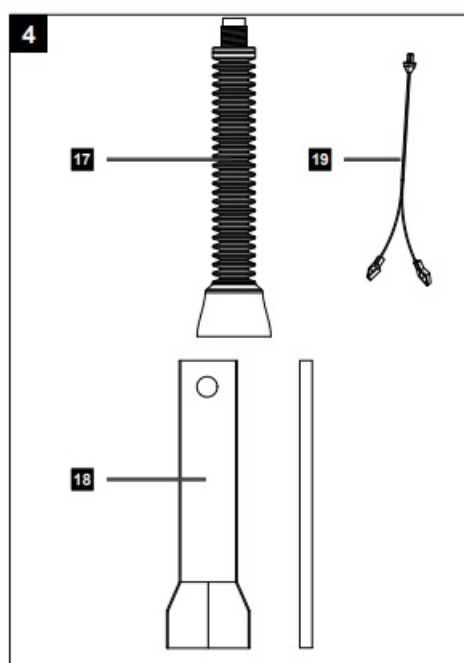
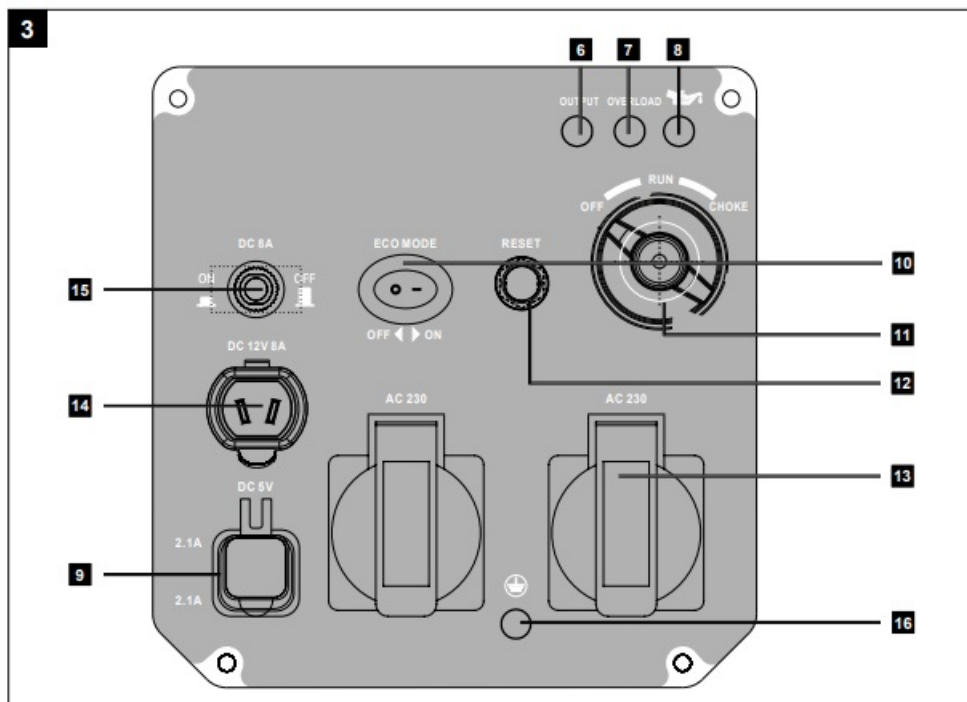

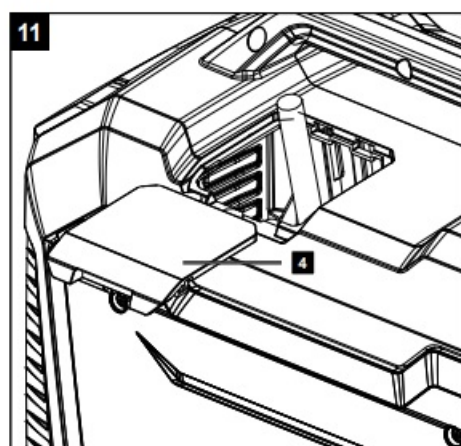
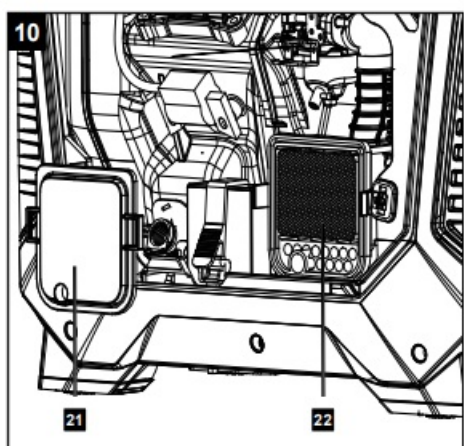
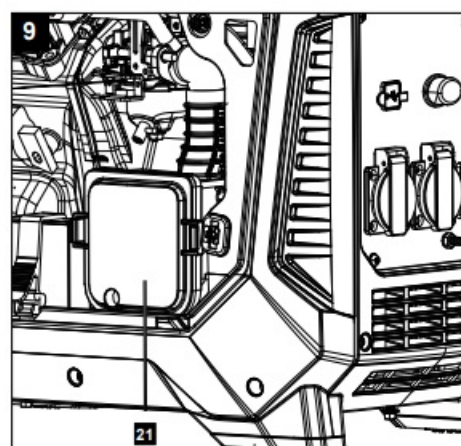
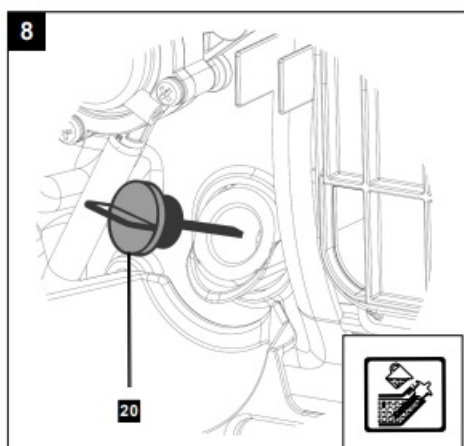
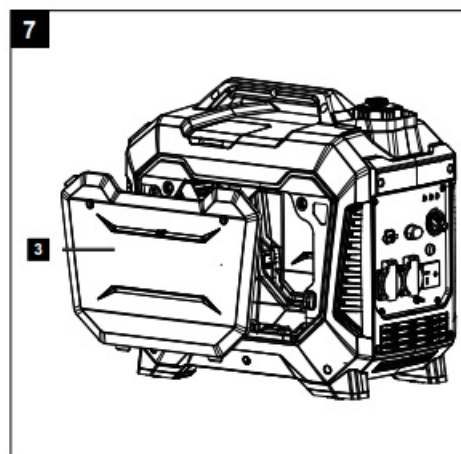
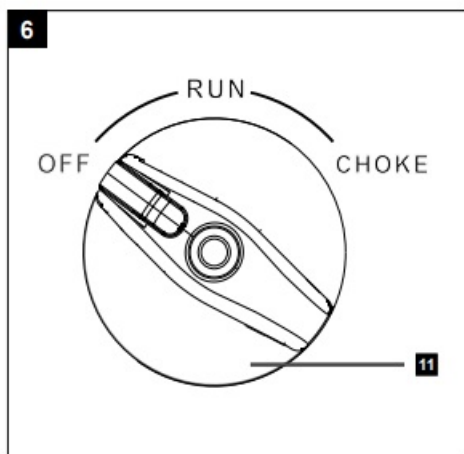

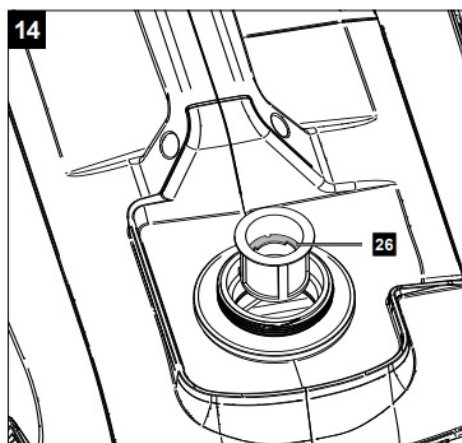
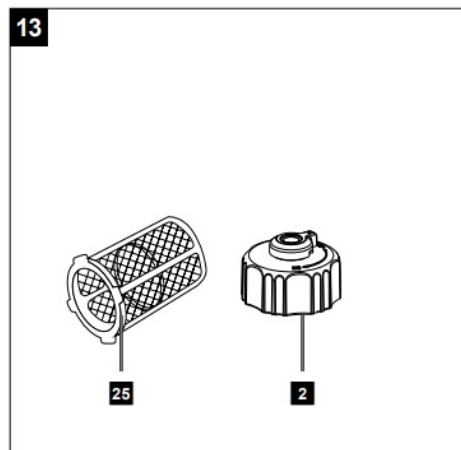
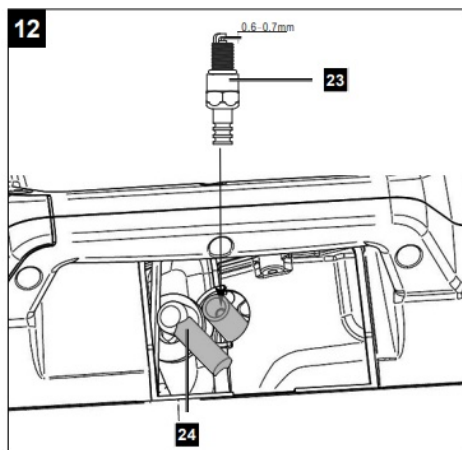













## Explanation of the symbols on the device

Symbols are used in this manual to draw your attention to potential hazards. The safety symbols and the accompanying explanations must be fully understood. The warnings themselves will not rectify a hazard and cannot replace proper accident prevention measures.

	Attention! Failure to observe the safety signs and warning information affixed to the machine and failure to observe the safety and operating instructions can result in serious injury or even death.
	Warning – read the instruction manual to reduce the risk of injury.
	Wear hearing protection. Excessive noise can result in a loss of hearing.
	Wear work gloves!
	Do not expose the device to rain.

	Naked flames or smoking near the device is strictly prohibited!
	Warning – Hot parts!
	Warning against electrical voltage.
	Make sure that other persons maintain a sufficient safety distance. Keep uninvolved persons away from the device. Attention: hot surface! Danger of burning.
	Before carrying out any cleaning or maintenance work, switch off the engine and remove the spark plug connector from the spark plug.
	Danger of poisoning! Only use the device outdoors and never in closed or poorly ventilated rooms.
	Sparks are produced when the engine is started. These can ignite nearby flammable gases.
	Read the whole text of the operating instructions through carefully before start up!
	Important. Always switch off the engine before refuelling. Do not refill during operation.
	Be very careful when dealing with fuels and lubricants!
	Checking the oil level
	The product complies with the applicable European directives.
 <b>Attention!</b>	We have marked points in these operating instructions that impact your safety with this symbol.

## Introduction

### Manufacturer:

Scheppach GmbH  
Günzburger Straße 69  
D-89335 Ichenhausen

### Dear Customer,

We hope your new tool brings you much enjoyment and success.

**Note:**

In accordance with the applicable product liability laws, the manufacturer of this device assumes no liability for damage to the device or caused by the device arising from:

- Improper handling,
- Failure to comply with the operating instructions.
- Repairs carried out by third parties, unauthorised specialists.
- Installing and replacing non-original spare parts,
- Application other than specified.
- Failures of the electrical system in the event of the electrical regulations and VDE provisions 0100, DIN 57113 / VDE 0113 not being observed.

**Note:**

Read through the complete text in the operating manual before installing and commissioning the device.

This operating manual should help you to familiarise yourself with your device and to use it for its intended purpose. The operating manual includes important instructions for safe, proper and economic operation of the device, for avoiding danger, for minimising repair costs and downtimes, and for increasing the reliability and extending the service life of the device.

In addition to the safety instructions in this operating manual, you must also observe the regulations applicable to the operation of the device in your country. Keep the operating manual at the device, in a plastic sleeve, protected from dirt and moisture. They must be read and carefully observed by all operating personnel before starting the work. The device may only be used by personnel who have been trained to use it and who have been instructed with respect to the associated hazards. The required minimum age must be observed.

In addition to the safety instructions in this operating manual and the separate regulations of your country, the generally recognised technical rules relating to the operation of such machines must also be observed.

We accept no liability for accidents or damage that occur due to a failure to observe this manual and the safety instructions.

**Device description (Fig. 1 – 14)**

1. Carrying handle	10. Energy-saving switch (ECO)	19. 12V cable
2. Tank cover	11. On/off switch with choke	20. Oil dipstick
3. Engine cover	12. "RESET" button	21. Air filter cover
4. Spark plug cover	13. 230 V~ socket (2x)	22. Air filter
5. Pull starter	14. 12 V DC connection	23. Spark plug
6. Operating display	15. 12V DC safety trigger	24. Spark plug connector
7. Overload indicator	16. Earthing screw	25. Fuel filter insert
8. Oil warning indicator	17. Funnel	26. Fill level marking
9. USB – connection (2x)	18. Spark plug wrench	

**Scope of delivery (Fig. 4)**

- Power generator/inverter
- Funnel (17)
- Spark plug wrench (18)
- 12 V cable (19)
- Operating manual

**Proper use**

The power generator is suitable for devices that are intended to operate on a 230 V AC or 12 V DC voltage source.

With household devices and electronic devices, please check the suitability according to the respective manufacturer's specifications.

**Attention!** The power generator must not be connected to the mains supply as a domestic emergency power supply. It can cause damage to the power generator or other electrical devices.

The machine may only be used in the intended manner. Any use beyond this is improper. The user/operator, not the manufacturer, is responsible for damages or injuries of any type resulting from this. An element of the intended use is also the observance of the safety instructions, as well as the assembly instructions and operating information in the operating manual.

Persons who operate and maintain the machine must be familiar with it and must be informed about potential dangers. In addition, the applicable accident prevention regulations must be strictly observed. Other general occupational health and safety-related rules and regulations must be observed.

The liability of the manufacturer and resulting damages are excluded in the event of modifications of the machine.

Please note that our equipment was not designed with the intention of use for commercial or industrial purposes.

We assume no guarantee if the device is used in commercial or industrial applications, or for equivalent work.

## General safety instructions

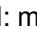
We have marked points in the operating manual that impact your safety with this symbol:  m

Furthermore, the operating manual contains other important text sections that are marked with the word "ATTENTION!".



### Attention!

When using equipment, several safety warnings must be observed to prevent injuries and damage. For this reason, please carefully read this operating manual /safety instructions. If the device is handed over to another person, hand over the operating and safety instructions with it. We accept no liability for accidents or damage that occur due to a failure to observe this manual and the safety instructions.



### DANGER

A failure to observe these instructions poses an extreme danger of death or the risk of life-threatening injuries.



### WARNING

A failure to observe these instructions poses a danger of death or the risk of serious injuries.



### CAUTION

A failure to observe these instructions poses a minor to moderate danger of injury.

### NOTE!

A failure to observe these instructions poses a risk of damage to the engine or other property.

1. It is prohibited to make any modifications to the power generator.
2. The manufacturer's preset speed must not be changed. Power generators or connected devices may be damaged.
3. Danger of poisoning! Exhaust gases, fuel and lubricants are poisonous, exhaust gases may not be inhaled.
4. Fire risk! Petrol and fuel vapours are highly flammable and explosive.
5. Motor exhaust gases are toxic. The power generator must not be operated in unventilated rooms. If the generator is to be operated in well-ventilated rooms, the exhaust gases must be discharged directly outside via an exhaust gas hose. Additional requirements for protection against fire and explosion must also be observed.

Toxic exhaust gases can also escape when operating an exhaust hose. Because of the risk of fire, the exhaust hose must never be directed at flammable materials.

6. Never operate the power generator in rooms with highly flammable substances.
7. Hot surfaces! Danger of burning, do not touch suction system and drive unit.
8. Do not touch any mechanically moving or hot parts. Do not remove any protective covers.
9. Protective equipment! Use suitable hearing protection when you are near the device.
10. Only original parts may be used for maintenance and accessories.
11. Repair and adjustment work may only be carried out by authorised specialist personnel.
12. Protect yourself from electrical hazards.
13. Never touch the power generator with wet hands.
14. Only use approved and appropriately identified extension cables for use outdoors (H07RN).
15. If extension leads or mobile distribution networks are used, the resistance value must not exceed  $\Omega$ . As a guideline value, the total length of lines for a cross-section of 1.5 mm<sup>2</sup> should not exceed 60 m, and for a cross-section of 2.5 mm<sup>2</sup>, 100 m should not be exceeded.
16. Never operate the power generator during rain or snowfall.
17. Always switch off the engine during transport and refuelling.
18. Fuel is combustible and highly flammable. Do not fuel the unit during operation. Do not fuel the unit when someone is smoking or near open flames. Do not spill any fuel.
19. Do not refuel or empty the tank near open light, fire or flying sparks. Smoking prohibited!
20. Do not use the power generator in a thunderstorm.
  - Danger of lightning strike!
21. Give the power generator a secure, level place. Turning and tilting or changing location during operation are forbidden.
22. Place the power generator at least 1 m away from walls or connected devices.
23. Children must be protected by ensuring that they stay a safe distance away from the inverter power generator.
24. Some parts of the reciprocating internal combustion motor are hot and may cause burns. The warnings on the generator must be observed.
25. Values specified in the technical data under sound power level (LWA) and sound pressure level (LpA) represent emission levels and are not necessarily safe working levels. Since there is a correlation between emission and exposure levels, it cannot be reliably used to determine any additional precautionary measures that may be required.

Factors influencing the current exposure level of the worker include the characteristics of the workspace, other noise sources, airborne noise, etc., such as the number of machines and other adjacent processes and the length of time an operator is exposed to the noise. The permitted exposure level may also vary from country to country. Nevertheless, this information will enable the operator of the machine to make a better assessment of the risks and hazards. If necessary, acoustical measurements should be taken after installation to determine the sound pressure level.
26. Warning! Comply with the electrical safety regulations applicable to the place where the inverter power generators are used.
27. Warning! Consider the requirements and precautionary measures in case of re-supply of a system by inverter power generators depending on the protective measures of this system and the applicable directives.
28. Inverter power generators should only be used up to their rated power under the rated ambient conditions. If the inverter power generator is used in conditions that do not comply with the reference conditions according to ISO 8528-8:2016, 7.1, and if the cooling of the engine or generator is impaired, e.g. as a result of operation in

restricted areas, a reduction in power is required.

29. Due to high mechanical loads, only durable rubber hose lines (according to IEC 60245-4) or equivalent equipment should be used.
30. Observe the electrical safety regulations applicable to the place where the power generator/inverter is used.
31. Consider the requirements and precautionary measures in case of re-supply of a system by inverter power generators depending on the protective measures of this system and the applicable directives.

## **Electrical safety**

1. Prior to use, the generator and its electrical equipment (including lines and plug connectors) should be checked to ensure that there are no defects.
2. The power generating unit must not be connected to another power source such as the power supply of energy supply companies. In special cases where a reserve connection to existing electrical systems is provided, this must only be carried out by a qualified electrician who will take into account the differences between the operated equipment using the public mains and operation of the power generating unit. According to this part of ISO 8528, the differences in the operating manual must be specified.
3. Protection against electric shocks depends on the circuit breakers which are matched precisely to the power generating unit. If a circuit breaker must be replaced, this should be done using a circuit breaker with the same rating and performance characteristics.

**Warning!** This power tool generates an electromagnetic field during operation. This field can impair active or passive medical implants under certain conditions. In order to prevent the risk of serious or deadly injuries, we recommend that persons with medical implants consult with their physician and the manufacturer of the medical implant prior to operating the power tool.

**ATTENTION:** Use only E10 unleaded petrol as fuel.



### **Use of petrol**



**Danger to life!** Petrol is toxic and highly flammable.

- Only store petrol in containers (canisters) designed and tested for this purpose. The tank caps must always be properly screwed on and tightened. Defective caps must be replaced for safety reasons.
- Keep petrol away from sparks, open flames, permanent flames, heat sources and other sources of ignition. Do not smoke!
- Refuel outdoors only and do not smoke while refuelling.
- Before refuelling, switch off the combustion engine and let it cool down.
- Petrol must be filled before starting the combustion engine. While the combustion engine runs or if the machine is hot, the fuel cap must not be opened and petrol must not be filled.
- Open the fuel cap carefully and slowly. Wait for the pressure to equalise and only then remove the tank cover completely.
- Use a suitable funnel or filler pipe for refuelling so that no fuel can spill onto the combustion engine and housing or lawn.
- Do not overfill the fuel tank!
- To leave room for the fuel to expand, never fill the fuel tank beyond the lower edge of the filling nozzle. Observe

additional information in the combustion engine user manual.

- If petrol has overflowed, do not start the combustion engine until the petrol-contaminated area has been cleaned. Avoid starting the engine until the fuel vapours have evaporated (wipe dry).
- Always wipe up spilled fuel immediately.
- If petrol has got on clothing, it must be changed.
- The tank cover must be properly screwed on and tightened after each refuelling operation. The device must not be put into operation without the original tank cover screwed on.
- For safety reasons, check fuel line, fuel tank, fuel cap and connections regularly for damage, ageing (brittleness), tight fit and leaks and replace if necessary.
- Only empty the tank outdoors.
- Never use beverage bottles or similar to dispose of or store operating materials, such as fuel. People, especially children, could be tempted to drink from it.
- Never store the device with petrol in the tank inside a building. Any fuel vapours produced can come into contact with naked flames or sparks and ignite.
- Do not place the device and fuel tank near heaters, radiant heaters, welding machines or other sources of heat.

### **Risk of explosion!**

If a defect is detected on the tank, the tank cover or on fuel-carrying parts (fuel lines) during operation, the combustion engine must be switched off immediately.

Then consult a specialist dealer.

### **Risk of explosion!**

If a defect is detected on the tank, the tank cover or on fuel-carrying parts (fuel lines) during operation, the combustion engine must be switched off immediately.

Then consult a specialist dealer.

### **Residual risks**

The electric tool has been built according to state-of-the-art and the recognised technical safety rules.

However, individual residual risks can arise during operation.

- Health hazard due to electrical power, with the use of improper electrical connection cables.
- Furthermore, despite all precautions having been met, some non-obvious residual risks may still remain.
- Residual risks can be minimised if the “Safety information” and the “Proper use” together with the operating manual as a whole are observed.
- Avoid accidental start-ups of the power generator.
- Use the device in the way that is recommended in this operating manual. This is how to ensure that your power generator provides optimum performance.

### **Technical data**

Power generator	Digital inverter
Protection category	IP23M
Continuous output P <sub>n</sub> (COP) (230 V) (S1)	3.0 kW
Max. power P <sub>max</sub> (230 V) (S2 5min)	3.2 kW
Max. power P <sub>peak</sub> (230 V) (S2 2s)	3.5 kW
Rated voltage U <sub>n</sub>	230 V~
Rated current I <sub>n</sub>	2 x 13 A (230 V~)
Rated current I <sub>n</sub>	8.0 A (12 V)
Rated current I <sub>n</sub>	2 x 2.1 A (USB)
Frequency F <sub>n</sub>	50 Hz
Performance class	G1
Active power factor $\phi$	1
Quality class	A
Drive motor type	4-stroke 1 cylinder air-cooled
Displacement	141 cm
Max. power (engine)	3
Fuel	3.6 kW / 4.8 PS
Tank contents	Super E10 petrol
Engine oil type	6.3 l
Oil volume (approx.)	15W40
Consumption at full load	400 ml
Max. temperature.	1.78 l/h
Max. altitude	40 °C
(above mean sea level)	1000 m
Spark plug	A7RTC

### Technical changes reserved!

Operating mode S1 (continuous operation)

The machine may be operated continuously with the specified power.

Operating mode S2 (short-term operation)

The machine may only be operated at maximum or peak power for a brief time.

### Noise and vibration



**Warning:** Noise can have serious effects on your health. If the machine noise exceeds 85 dB, please wear suitable hearing protection.

**Information on noise level per EN ISO 3744:1995, ISO 8528-10:1998**

**Noise data**

Sound power level LWA	96 dB
Sound pressure level LpA	74.6 dB
Uncertainty Kwa/pA	1.5 dB

## Unpacking

- Open the packaging and carefully remove the device.
- Remove the packaging material, as well as the packaging and transport safety devices (if present).
- Check whether the scope of delivery is complete.
- Check the device and accessory parts for transport damage. In the event of complaints the carrier must be informed immediately. Later claims will not be recognised.
- If possible, keep the packaging until the expiry of the warranty period.
- Familiarize yourself with the device by means of the operating manual before using for the first time.
- With accessories as well as wearing parts and spare parts use only original parts. Spare parts can be obtained from your specialist dealer.
- When ordering please provide our article number as well as type and year of manufacture for your equipment.

### **WARNING!**

The device and the packaging material are not children's toys! Do not let children play with plastic bags, films or small parts! There is a danger of choking or suffocating!



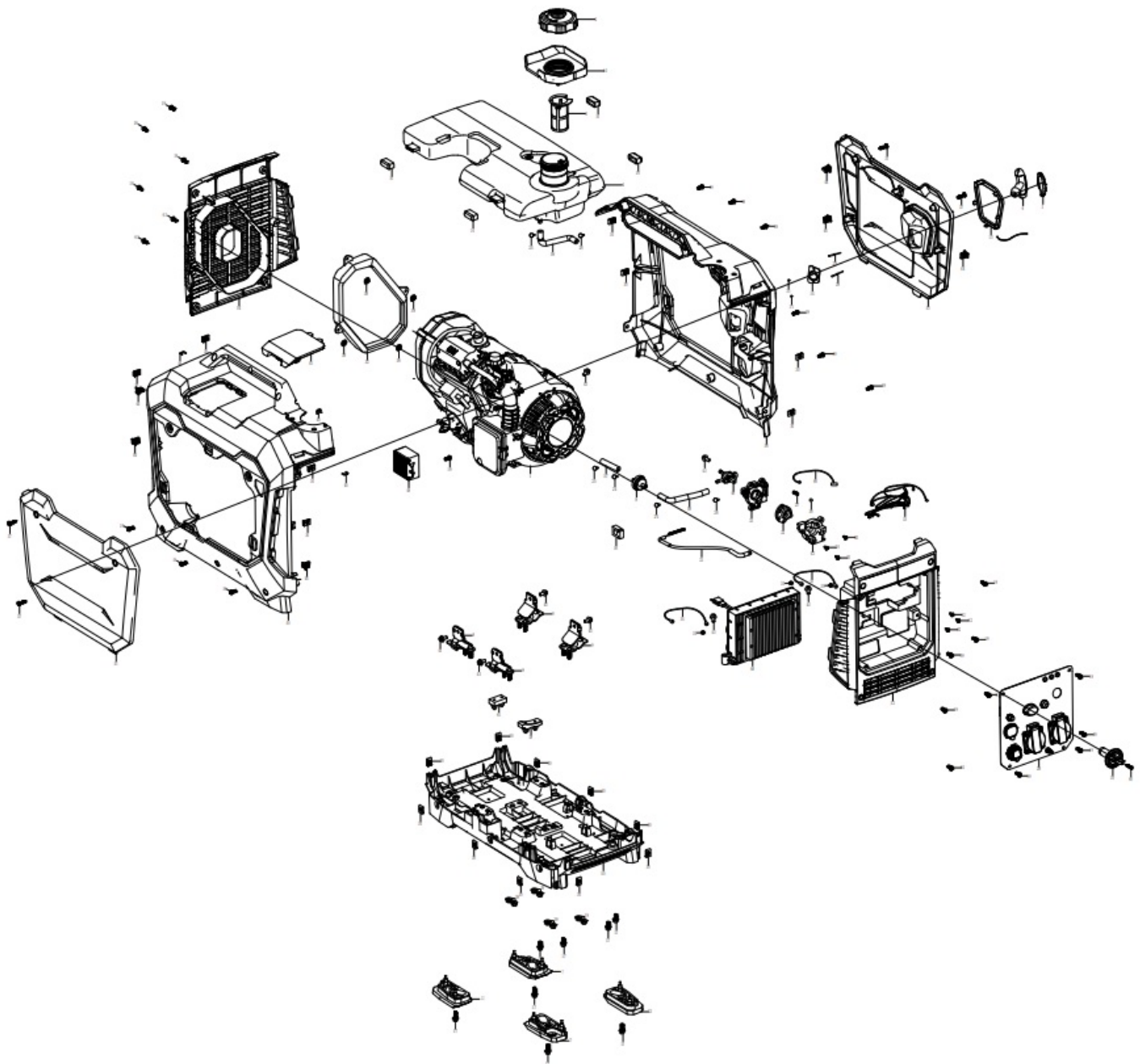

*i. V. Andreas Reh*

Signature

Head of Project Management

Documents / Resources



[Scheppach SG3500i Inverter Gasoline Power Generator](#) [pdf] Instruction Manual  
 SG3500i Inverter Gasoline Power Generator, SG3500i, Inverter Gasoline Power Generator, Gasoline Power Generator, Power Generator, Generator