



scheppach SG2500i Inverter Power Generator Instruction Manual

[Home](#) » [Scheppach](#) » **scheppach SG2500i Inverter Power Generator Instruction Manual** 

Contents

- [1 scheppach SG2500i Inverter Power Generator](#)
- [2 Specifications](#)
- [3 Product Usage Instructions:](#)
- [4 FAQ](#)
- [5 Explanation of the symbols on the equipment](#)
- [6 Introduction](#)
- [7 \\$Device description \(Fig. 1 – 3\)](#)
- [8 Scope of delivery](#)
- [9 Intended use](#)
- [10 Safety information](#)
- [11 Technical data](#)
- [12 Unpacking](#)
- [13 Before starting up](#)
- [14 Operation](#)
- [15 Maintenance](#)
- [16 Storage](#)
- [17 Transport](#)
- [18 Disposal and recycling](#)
- [19 Troubleshooting](#)
- [20 EXPLODED VIEW](#)
- [21 CE Declaration of Conformity](#)
- [22 Warranty](#)
- [23 Documents / Resources](#)
 - [23.1 References](#)





Specifications

- **Manufacturer:** Scheppach
- **Model:** SG2500i
- **Type:** Inverter Power Generator
- **Rated Power:** 1600W (continuous), 2000W (peak)
- **Voltage:** 230V
- **Current:** 6.95A
- **Frequency:** 50Hz
- **Engine Type:** 4-stroke, 1-cylinder
- **Fuel Type:** Unleaded (E5)
- **Fuel Tank Capacity:** 4.1 liters
- **Oil Type:** 10W30 / 15W40, 350ml
- **Operating Mode:** Continuous (S1)
- **IP Rating:** IP23M

Product Usage Instructions:

Unpacking:

Ensure that all transportation locks are removed and keep them out of reach of children.

Pre-Operation Check:

Ensure the fuel tank is filled at least halfway (4.1 liters capacity).

Starting the Generator:

Move the Choke lever from “CHOKE” to “RUN” position after approximately 15-30 seconds.

Operating Indicators:

The operational indicator light will be active when the engine is running.

Fuel Efficiency:

To reduce fuel consumption during idle, switch the Energy Saving switch to the “ON” position.

Maintenance:

Regularly check and change the spark plug when necessary.

Storage:

After draining the fuel, start the machine before storing it.

FAQ

- **What should I do if the generator does not start?**







Check the fuel level, spark plug, and air filter. Ensure proper choke position and try again.



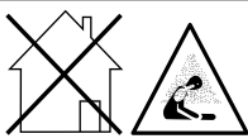

- **How often should I change the oil?**

It is recommended to change the oil after every 50 hours of operation or as per the manufacturer's guidelines.

Explanation of the symbols on the equipment

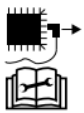
The use of symbols in this manual is intended to draw your attention to possible risks. The safety symbols and the explanations that accompany them must be perfectly understood. The warnings in themselves do not remove the risks and cannot replace correct actions for preventing accidents.

	Read operator manual. Before any use, refer to the corresponding section in this user manual.
	Important. Hot parts. Keep your distance.
	Important. Switch off the engine before refuelling. Not refuel when operating.
	Important. Exhaust gas is poisonous, do not operate in an unventilated area.
	Wear hearing protection. Wear protective gloves.
	Beware of electrical voltage!
	Take care when handling fuel and lubricants!

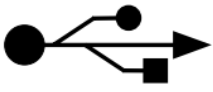
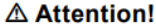
	Remove the ignition cable before all maintenance work, and read the instructions for use.
	Don't expose to rain.
	Starting engine creates sparking. Sparking can ignite nearby flammable gases.
	Strictly no naked flames or smoking near the appliance!
	USB - port
 Attention!	In this operating manual, we have used this sign to mark all sections that concern your safety.

Introduction

Manufacturer:

- Scheppach GmbH
- Günzburger Straße 69
- D-89335 Ichenhausen

Dear customer,

We hope you have a lot of fun and success using your new machine.

Note:

According to the applicable product liability laws, the manufacturer of the device does not assume liability for damages to the product or damages caused by the product that occurs due to:

- improper handling,
- noncompliance of the operating instructions,
- repairs by third parties, not by authorized service technicians,
- installation and replacement of non-original spare parts,
- non-intended use,

We recommend:

- That you read through the entire operating instructions before putting the machine into operation.
- These operating instructions are to assist you in get-ting to know your machine and utilize its proper applications.
- The operating instructions contain important notes on how you work with the machine safely, expertly, and economically, and how you can avoid hazards, save re-pair costs, reduce downtime and increase the reliability and service life of the machine.
- In addition to the safety requirements contained in these operating instructions, you must be careful to ob-serve your country's applicable regulations.

- The operating instructions must always be near the machine. Put them in a plastic folder to protect them from dirt and humidity. They must be read by every operator before beginning work and observed conscientiously. Only persons who have been trained in the use of the machine and have been informed of the various dangers may work with the machine. The required minimum age must be observed.
- In addition to the safety requirements in these operating instructions and your country's applicable regulations, you should observe the generally recognized technical rules concerning the operation of identically constructed devices.
- We accept no liability for accidents or damage that occur due to a failure to observe this manual and the safety instructions.

Device description (Fig. 1 – 3)

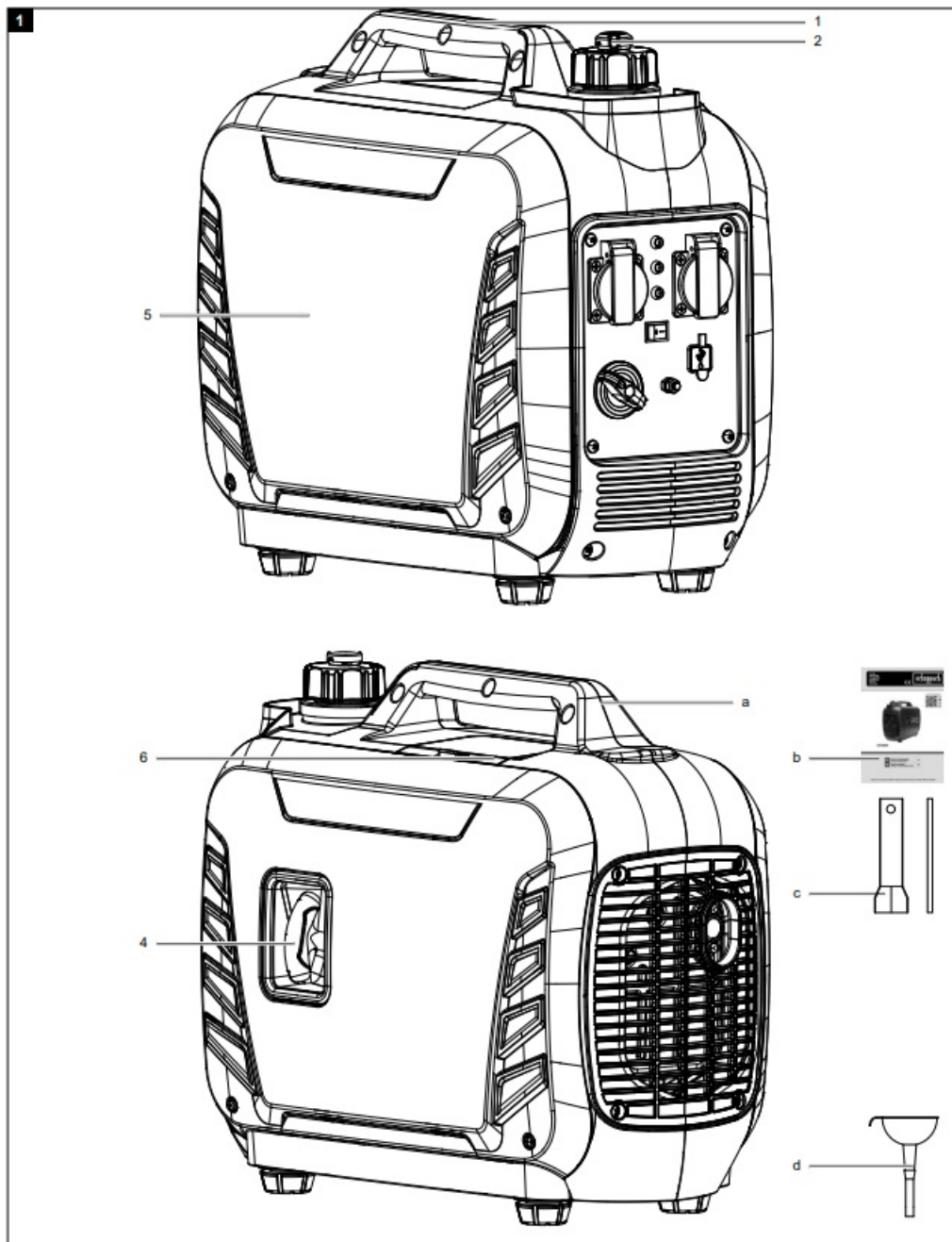

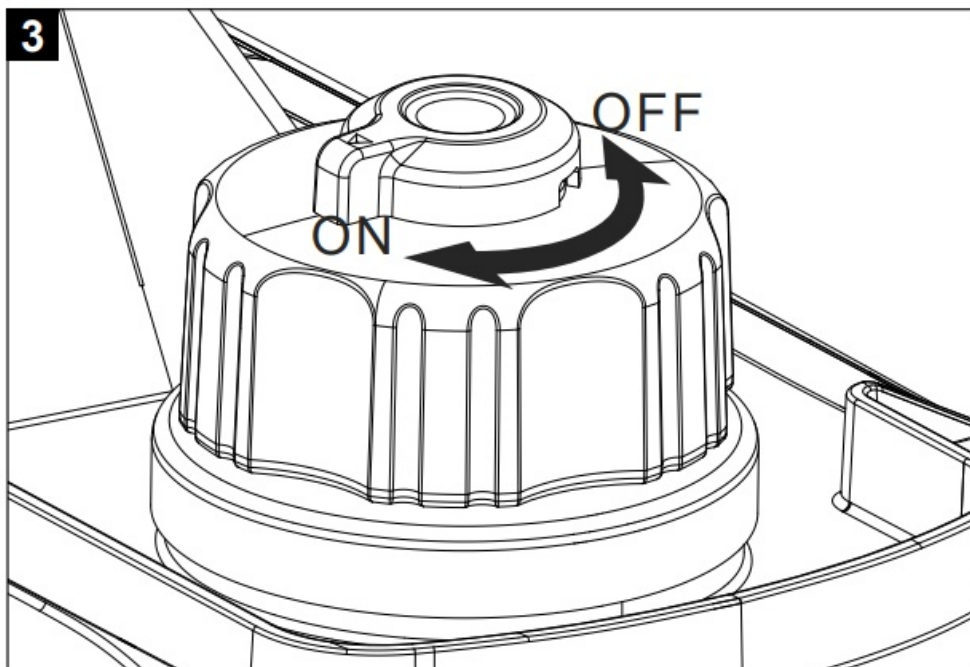
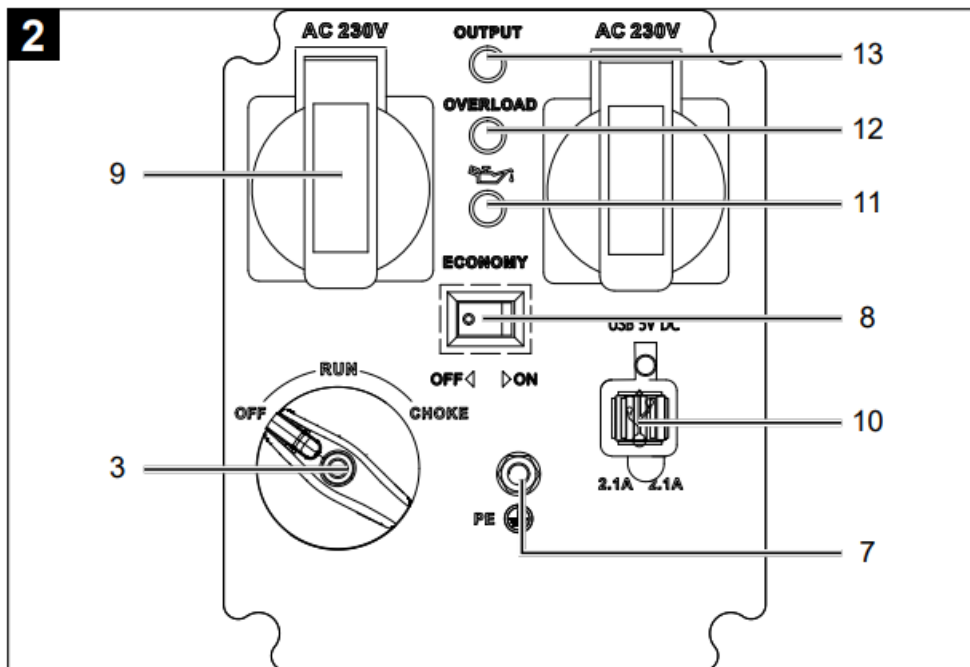

1. Carrying handle
2. Fuel tank cap with ventilation
3. On / Off switch with choke
4. Starter pull cord
5. Engine cover
6. Spark plug cover
7. Earthing connection
8. Energy saving switch
9. 230 V ~ – socket outlets (2x)
10. USB – port (2x)
11. Oil warning display
12. Overload display
13. Operating display

- A Oil filler plug
- B Air filter cover
- C Air filter
- D Spark plug

Scope of delivery

- SG2500i
- manual
- spark plug wrench
- funnel

Intended use

- The device is designed for applications operated with a 230 V alternating current source.
 - Be sure to observe the restrictions in the safety instructions.
 - The generator is intended to provide electric power tools and light sources with electricity. When using the device with household appliances, please check their suitability in accordance with the relevant manufacturer's instructions.
 - In case of doubt, ask an authorized dealer of the respective equipment.
 - This generator is only intended for the operation of electrical devices which maximum power lies within the performance indications of the generator. A higher inrush current of inductive consumers must be considered.
- Inverter
- The inverter generator generates electricity in a whole new way. With a small, multipole winding in the inside the produced voltage is converted via electronic first into DC voltage afterwards into alternating voltage with a clean sinus wave. With this clean sinus wave it is possible to operate electrical devices without damaging them.
 - The machine is to be used only for its prescribed purpose. Any other use is deemed to be a case of misuse. The user / operator and not the manufacturer will be liable for any damage or injuries of any kind caused as a result of this.
 - Please note that our equipment has not been designed for use in commercial, trade or industrial applications. Our warranty will be voided if the equipment is used in commercial, trade or industrial businesses or for equivalent purposes.

Safety information

- These operating instructions provide places concerning your safety which are marked with this indication: m
- Furthermore this manual contains other important sections which are marked with the word "ATTENTION!".

- **Attention!**

While using the machine some safety precautions must be observed to prevent injuries and damage. Read the directions with due care. If you give the equipment to any other person, give them these operating instructions as well. We assume no liability for injuries or damages which are a result of non-compliance of this manual and its safety notes.

- **DANGER**

Failure to follow these instructions may cause serious danger to life or danger of fatal injuries.

- **WARNING**

Failure to follow these instructions may cause danger to life or danger of serious injuries.

- **CAUTION**

Failure to follow these instructions may cause light to medium risk of injury.

- **NOTE**

Failure to follow these instructions may cause danger of damage of the engine or other property values.

General safety informations

1. Keep your work area tidy

Disorder in the work area can lead to accidents.

2. Take environmental influences into account

- Never work with the machine in enclosed rooms or in rooms with poor ventilation. If the motor runs toxic gases are generated. These gases can be odourless and invisible.
- Do not expose the device to rain.
- Do not use electric tools in a damp or wet environment.
- Take care on your secure footing on uneven ground
- Make sure that the work area is well illuminated.
- Never use the machine in highly flammable vegetation or where fire and explosion hazards exist.
- Provide a fire extinguisher in drought conditions (fire hazard).

3. Keep other persons away

Do not allow other persons to work with the device especially children and young people.

4. Securely store unused electric tools

Unused tools should be stored in a dry, elevated or closed location out of the reach of children.

5. Do not overload your device

They work better and more safely in the specified output range.

6. Work in full consciousness

Do not work with the device when you are under the influence of alcohol, drugs, medication or other substances which might compromise the vision, dexterity and judgment.

7. Use the device for its prescribed purpose

Any other use than intended is deemed to be a case of misuse.

Safety notices for handling flammable fuels

1. **WARNING!**: Petrol is highly flammable:

2. Store fuel in containers specifically designed for this purpose

3. Refill the gasoline tank only outdoors and do not smoke meanwhile.

4. Add fuel before starting the engine. Never remove the cap of fuel tank or add petrol while the engine is running or when the engine is hot.

5. If petrol is spilled, do not attempt to start the engine but move the machine away from the area of spillage and avoid creating any source of ignition until petrol vapours have dissipated. Replace all fuel tank and container caps securely.

Adding fuel

- Always switch off the engine before refuelling.

Attention! Always open the fuel filler cap carefully to decompose slowly the excess pressure.

- Whilst working with the machine high temperatures can attain on the case. Allow the engine to cool before refuelling.

Attention! In case of insufficient cooling of the machine the fuel may ignite and lead to serious burns during refuelling.

- Make sure not to fill the tank with too much fuel. Immediately remove the fuel and clean the machine when spilling fuel.
- Always close the screw plug on the fuel tank in order to avoid loosening which may occur by vibrations when using the machine.

- **DANGER**

- Never refuel the engine nearby open flames.
- Additional safety instructions while handling with combustion engines

- **DANGER**

Combustion engines constitute a special danger during operation and refuelling. Always read and note the warnings. Failure to do so can lead to serious or even deadly injuries.

1. No changes may be made to the generator.
2. **Attention!**
Danger of poisoning, Emissions, fuels and lubricants are toxic. Emissions shall not be inhaled.
3. **Attention!**
Risk of burns. Do not touch the exhaust system or drive unit.
4. Never operate the machine in non ventilated rooms or in a highly inflammable environment. If you intend to operate the machine in rooms with good ventilation, the exhaust gases must be channelled directly outdoors through an exhaust hose. **Attention!** Toxic exhaust gases can escape despite the exhaust hose. Due to the fire hazard, never direct the exhaust hose towards inflammable materials.
5. **Risk of explosion!**
Never operate the machine in rooms with combustible materials.
6. The speed preset by the manufacturer is not allowed to be changed. The machine or connected equipment may be damaged.
7. Place the generator at least 1m away from walls and equipment connected to them.
8. Place the generator in a secure, level position. Do not turn, tip or change the generator's position while it is working.
9. Never touch the generator with wet hands.
10. Guard against electric danger.
11. When working outdoors, use only extension cables that are approved for outdoor use and which are marked accordingly (H07RN).
12. The overall length of the extension cables used is not allowed to exceed 1,5 mm² for 50 m and 2,5 mm² for 100 m.
13. Repairs and adjustment work may only be carried out by authorized trained personnel.
14. Do not touch any mechanically driven or hot parts. Do not remove the safety guards.
15. The values quoted in the technical data under sound power level (LWA) and sound pressure level (LpA) are emission values and not necessarily reliable workplace values. As there is a correlation between

emission and immission levels, the values cannot be taken to reliably determine the possible need for additional precautions. Factors influencing the current immission level of the user/operator include the properties of the work area, other sound sources etc., e.g. the number of machines and other neighboring processes, and the time span over which the user/operator is subjected to the noise. Also, the permitted immission level can vary from country to country. Nevertheless, this information makes it possible for the user to be able to make a better assessment of the dangers and risks involved.

16. Never use a faulty or damaged electrical equipment (this also applies to extension cables and plug connections).
17. Never put any items into the ventilation openings. This applies even when the generator is switched off. Non-observance may lead to injury, or damage to the generator.
18. Generating sets may only be loaded up to their rated power under the rated ambient condition. If generating set use is under conditions which do not conform to the reference conditions as stipulated in ISO 8528-8 and if cooling of the engine or alternator is impaired, e.g. as a result of operation in restricted areas, a reduction in power is necessary.
19. It is necessary reduction in power due to use in higher temperatures, altitudes and humidity as below conditions.
 - **Max. Working temperature:** 40 °C
 - **Max. Altitudes:** 1000 m
 - **Max. Humidity:** 90 %
20. Keep the generator free of oil, dirt and other impurities.
21. Ensure the sound absorber and air filter work properly. These parts serve as flame protection in case of misfire.
22. Before connecting electric leads, the appliance must reach its full speed. Disconnect leads before switching off the motor.
23. To prevent injury by electric shock, ensure the fuel tank is not completely empty while electric leads are connected.
24. The load must not exceed the power marked on the rating label of the generator. Overloading may result in damage to, or a shorter life of the appliance.
25. Do not connect the appliance to household outlets. The generating set must not be connected to other power sources, such as the power company supply mains. In special cases where stand-by connection to existing electrical systems is intended, it shall only be performed by a qualified electrician who has to consider the differences between operating equipment using the public electrical supply network and operating the generating set.
26. **Stop the engine:**
 - whenever you leave the machine
 - before refuelling

Warning! This electric tool generates an electromagnetic field during operation. This field can impair active or passive medical implants under certain conditions. In order to prevent the risk of serious or deadly injuries, we recommend that persons with medical implants consult with their physician and the manufacturer of the medical implant prior to operating the electric tool.

Safety information service/ maintenance

1. Only original parts may be used for maintenance and accessories.

2. Replace faulty silencers.
3. Before using, always visually inspect to see that the tools are not worn or damaged. Replace worn or damaged elements and bolts. Keep all nuts, bolts and screws tight to be sure the equipment is in safe working condition.
4. Regularly check for leakage or traces of abrasion in the fuel system, such as porous pipes, loose or missing clamps and damage to the tank or tank cap. Before use all defects must be repaired.
5. Before checking or adjusting the generator or the motor, the ignition plug and the ignition wire re-spectively must be removed to prevent acciden-tal starting.

WARNING!

1. Improper maintenance or ignoring/ not rectifying a problem during the operation may become a source of danger. Operate your machine only if regularly main-tained. Only in this way you can assume that your de-vice is
 2. operating safe, economical and without mal-functions.
 3. Do not clean, maintain, setup or repair the ma-chine whilst running. Moving parts may cause se-rious injuries.
 4. Do not use fuel or other flammable solvents to clean the equipment.

WARNING! Vapours of fuels and solvents may ex-plode.

1. Reaffix the security and safety equipment after repara-tion and mai
2. ntenance work.
3. Keep the machine in safe work condition. Especially check the fuel system for tightness.

WARNING!

- Improper maintenance or ignoring/ not rectifying a problem during the operation may become a source of danger. Operate your machine only if regularly main-tained. Only in this way you can assume that your de-vice is
 - operating safe, economical and without mal-functions.
 - Do not clean, maintain, setup or repair the ma-chine whilst running. Moving parts may cause se-rious injuries.
 - Do not use fuel or other flammable solvents to clean the equipment.

WARNING! Vapours of fuels and solvents may ex-plode.

- Reaffix the security and safety equipment after repara-tion and maintenance work.
- Keep the machine in safe work condition. Especially check the fuel system for tightness.
- Always remove any dirt from the cooling fins of the en-gine.
- Residual risks and accident prevention standards
- Neglect of ergonomic principles
- Negligent handling of personal protective equip-ment (PPE)
- Negligent handling or omission of the personal protec-tive equipment may cause serious injuries.
- Wear prescribed personal protection equipment.
- Human behaviour, misbehaviour
- For any work be fully concentrated.
- Residual risks – Cannot be entirely excluded.

Electrical residual risks

Electrical contact

- Touching the spark plug may cause an electrical shock.
- Never touch the spark plug while the engine is running.
- Thermal residual risks burns, chilblains
- Touching of the exhaust/ case may cause burns.
 - allow motor driven machines to cool.

Danger from noise hearing damage

- Prolonged unprotected work with the device may cause hearing damage.
Always wear ear-muffs.
- Danger caused by materials and other substances Contact, inhalation
- The emissions of the machine may cause damages to health.
Only use the motor driven machine outdoors

Fire, explosion

Fuel is flammable.

During work and refuelling smoking and open flames are prohibited.

In case of emergency

In case of a possibly occurring accident take the necessary first aid steps as appropriate and obtain qualified medical aid as quickly as possible.

If you obtain aid please give the following information:

1. Where did it happen
2. What happened
3. How many injured
4. Type of injury
5. Who is reporting!

Technical data

- **Generator** Digital Inverter
- **IP class** IP23M
- **Continuous power** P_{nenn} (S1)
- **(230 V)** 1600 W
- **Maximum power** P_{max}
- **(S2 2 min) (230 V)** 2000 W
- **Rated voltage** U_{nenn} 2 x 230 V~
- **Rated current** I_{nenn} 6,95 A (230 V)
- **Frequency** f_{nenn} 50 Hz
- **Drive engine design** 4 stroke 1 cylinder air cooled
- **Displacement** 79 cm³
- **Maximum power (motor)** 2,2 kW / 3 PS
- **Fuel unleaded** (E5)

- **Tank capacity** 4,1 l
- **Type of motor oil** 10W30 / 15W40
- **Amount of oil (approx.)** 350 ml
- **Consumption at full load** 1,269 l/h
- **Weight** 17,5 kg
- **Temperature max** 40 °C
- **Max. altitude** 1000 m
- **Spark plug** A7RTC

Operating mode S1 (continuous operation)

The machine can be continuously operated with the quoted power output.

Operating mode S2 (temporary operation)

The machine may be temporarily operated with the quoted power output. Afterwards the machine must be stopped for a while to prevent it from overheating.

Information concerning noise emission measured according to relevant standards:

- **Sound pressure** $L_{pA} = 71,6 \text{ dB(A)}$
- **Sound power** $L_{wA} = 91,6 \text{ dB(A)}$
- **Uncertainty** $K_{pA} = 1,13 \text{ dB}$

Wear ear-muffs.

The impact of noise can cause damage to hearing.

Unpacking

- Open the packaging and remove the device care-fully.
- Remove the packaging material as well as the pack-aging and transport bracing (if available).
- Check that the delivery is complete.
- Check the device and accessory parts for transport damage. In the event of complaints the carrier must be informed immediately. Later claims will not be recognised. If possible, store the packaging until the warranty period has expired.
- Familiarise yourself with the product by means of the operating instructions before using for the first time.
- With accessories as well as wearing parts and re-placement parts use only original parts. Replace-ment parts can be obtained from your dealer.
- When ordering please provide our article number as well as type and year of manufacture for your equip-ment.

WARNING!

Danger of swallowing and choking! Packaging ma-terial, packaging and transport safety devices are not toys for children. Plastic bags, foils and small parts can be swallowed and cause suffocation. Keep packaging material, packaging and transport safety devices away from children.

Before starting up

ATTENTION!

Always check before starting the engine:

- Check the fuel level and top it up if necessary – the tank should be at least half filled
- Make sure that the generator has sufficient ventilation
- Make sure that the ignition cable is secured to the spark plug
- Disconnect possibly connected electrical device from the generator
- Condition of the air filter
- Condition of the fuel lines
- The external bolt connections for tightness

Attention! Fill the oil before first use.

- Before each use, check the oil level with the engine switched off and on a level surface. Use the highest quality four-stroke oil or an HD oil with the same level of quality.
- SAE 10W-30 is recommended for general use at all temperatures.

Checking the oil level, fig. 6

- Remove the engine cover (Fig. 5)
- Remove the oil filler cap (A) and wipe the dipstick clean.
- Check the oil level by inserting the dipstick into the fill-ing nozzle without screwing the cap on.
- If the oil level is too low, refill with the recommended oil up to the lower rim of the oil filling nozzle.

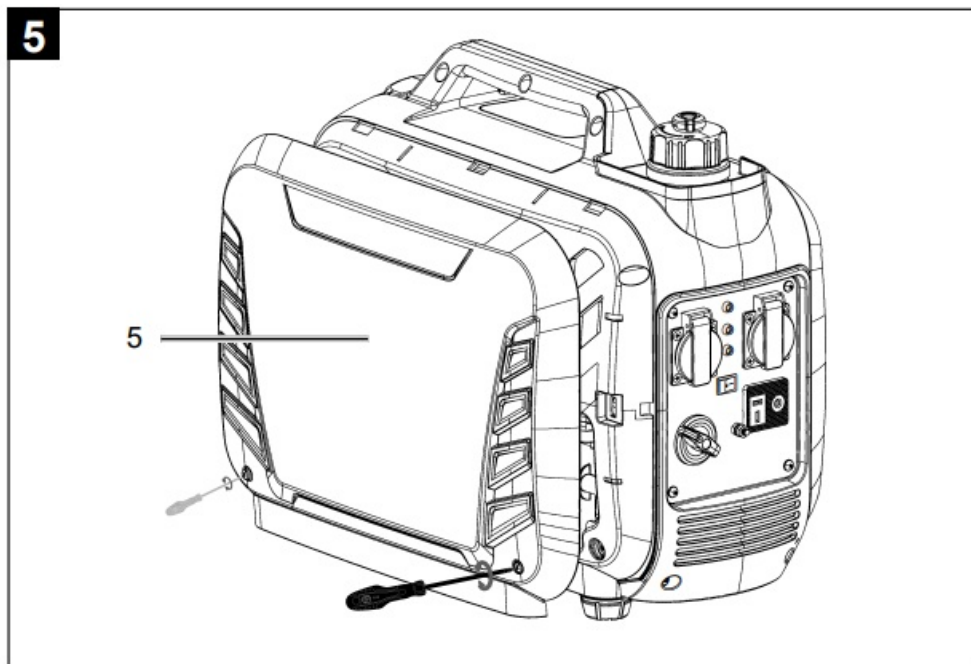

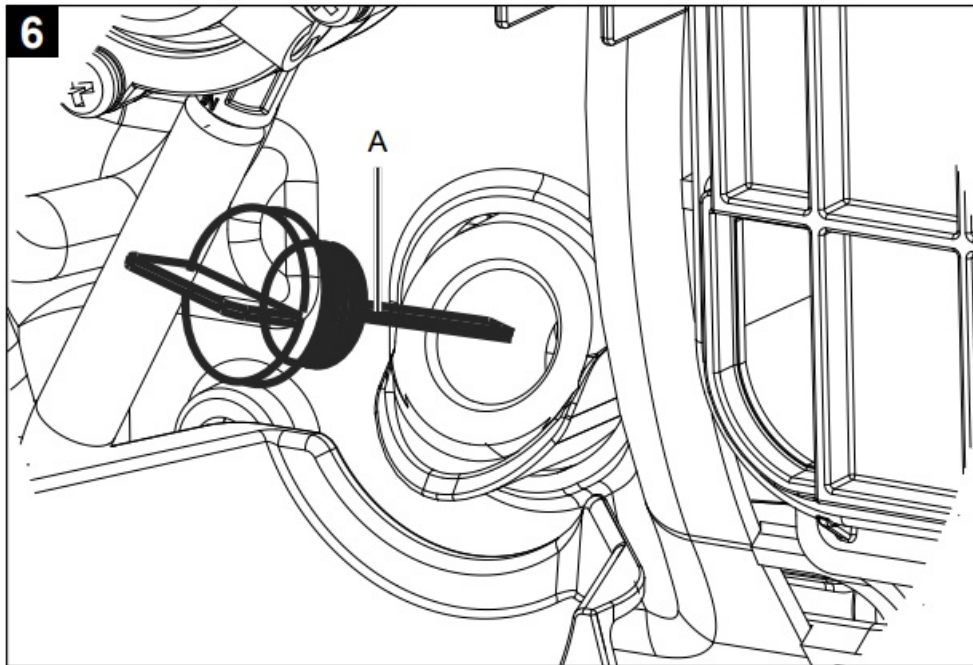

Filling with fuel

- To refuel – cap (2) open counter clockwise.
- Fill fuel tank in
- Closing tank – tank cap (2) clockwise.

Recommended fuel

- Unleaded regular gasoline with a research octane number of 91 or higher is required for this engine. Use only fresh and clean fuel.
- Water or impurities in the petrol damage the fuel system.

Tank volume: 4,1 litre

Refuel in a well-ventilated area with the stopped engine. If the engine has been running, allow it to cool first. Never refuel the engine inside a building where gasoline fumes may reach flames or sparks. Petrol is highly flammable and explosive. You can get burns or other serious injuries when handling fuel.

- Switch off the engine and keep it away from heat, sparks and flames.
- Refuelling only outdoors.
- Immediately clean up spilled petrol.

Operation

Starting the engine

- Vent the tank lid to „ON“ position (Fig. 3)
- Set the on/off switch to the “RUN” position (Fig. 4).

• In “warm” condition

Starting the engine with the recoil starter; therefore tighten handle sharply. Attach the recoil starter gently and slowly by hand in the original position. If the engine hasn't started yet, tighten the handle further.(Fig. 1 Pos. 4)

• In “cold” condition

- Set the on/off switch to the “CHOKE” position (Fig. 4).
- Starting the motor with the recoil starter; therefore tighten handle sharply. Attach the recoil starter gently and slowly by hand in the original position. If the engine hasn’t started yet, tighten the handle further. (Fig. 5)

Note:

When the engine is started the first time, several attempts are necessary for starting up to transport the fuel from the tank to the engine.

After starting the engine (after approx. 15-30 s), move the on/off switch (3) from the “CHOKE” position to the “RUN” position. (Fig. 4)

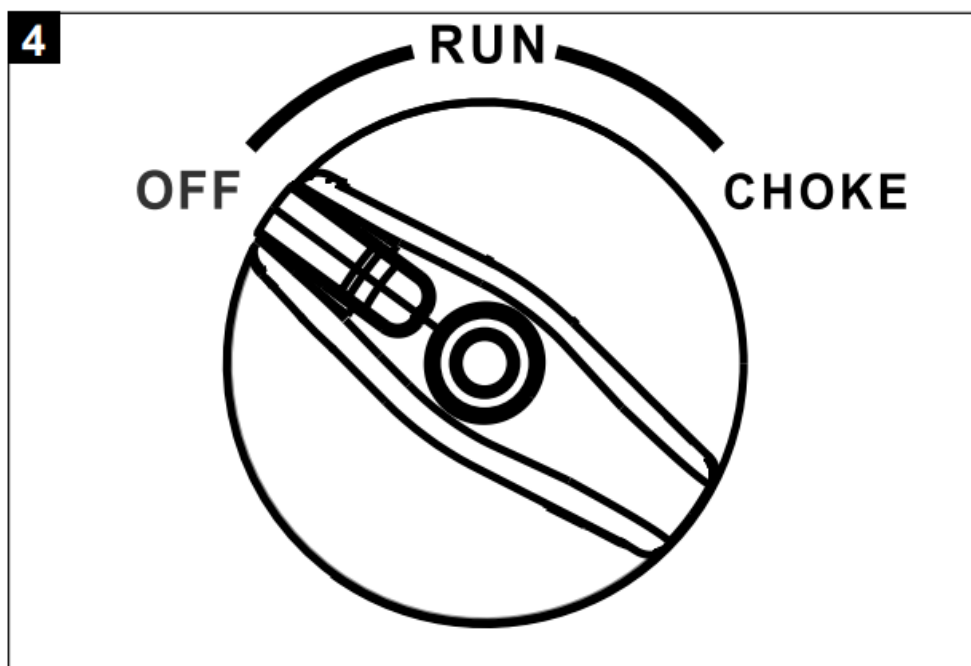
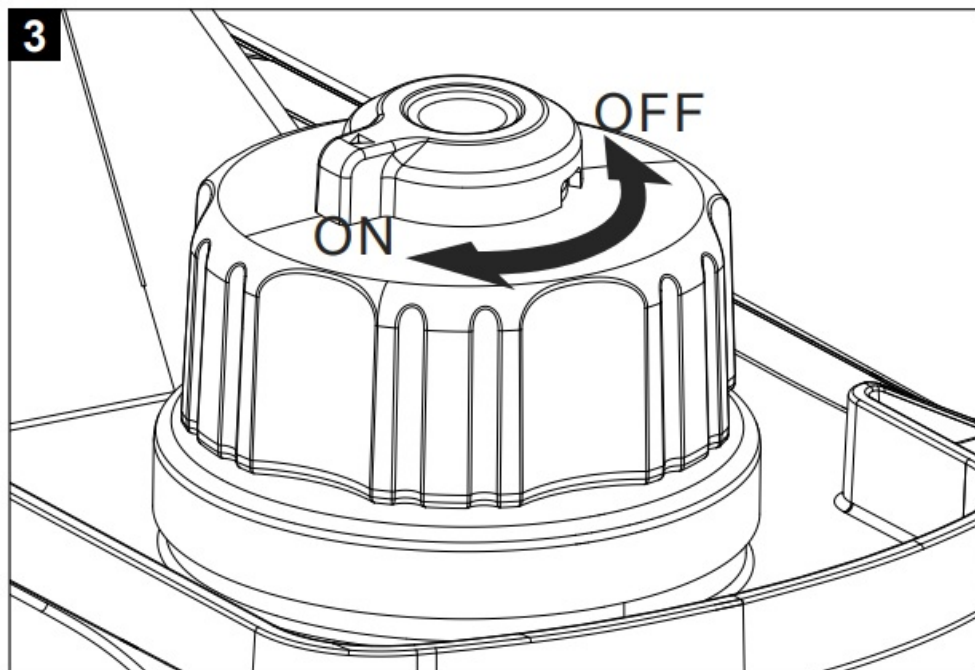

Switching off the engine

- Let the generator run briefly without load before you turn it off, so that the aggregate can “recooling”
- Set the on/off switch to the “OFF” position (Fig. 4).

Oil warning light (11)

Display is active at low oil level and deactivated when sufficient oil level.

Overload indicator (12)

- Overload protection is active at too high a power take-off – Turns off 230 V sockets (9).
- Turn off the unit (see section 9.2).
- Connected devices from separate generator. The unit (see section 9.1).

Operating display (13)

Power indicator active – when the engine is running.

Energy saving switch (9)

Reduce fuel consumption / idle – Energy saving switch “ON” position.

Electrical safety

- Electrical cables and attached devices must be defect free.
- Never connect the generator to the mains (power point).
- Keep the cables as short as possible.

Connecting to earth (fig. 2)

The housing can be connected to earth to discharge static electricity. To do this, connect one end of a cable to the earthing connection (7) on the generator and the other end to an external ground (z. B. for example to an earthing rod).

USB port

This generator is equipped with two USB ports. These can be used to charge smartphones.

Maintenance**WARNING**

- Carry out maintenance work only with the stopped engine.
- Pull the spark plug cap from the spark plug

Oil change

Change the engine oil after 25 operating hours, then after 50 hours or every three months. The engine oil change should take place when the engine is at operating temperature.

- When changing the oil, have a non-leaking container available.
- Remove the engine cover (Fig. 5 Pos. 5)
- Open the oil filler plug (Fig. 6 Pos. A)
- Drain the old oil into a suitable container by tilting the generator.
- Fill the engine oil to the upper mark of the dipstick using the oil-filling container.
- Dispose of the oil in accordance with stipulations. Take the old oil to a collection point. Most petrol stations,

garages or recycling centres take back old oil free of charge.

Air filter

Frequently cleaning of the air filter prevents carburetor malfunction.

Clean the air filter and change air filter inserts

- The air filter should be cleaned every 30 hours.
- Remove the engine cover (Fig. 5 Pos. 5)
- Remove the air filter cover (Fig. 8 Pos. B)
- Remove the air filter (Fig. 8 Pos. C)
- Clean the filter elements with soapy water. After rinse the filter elements with clear water and allow to dry thoroughly before refitting.
- Reassemble in reverse order

WARNING

NEVER use gasoline or cleaning solvents with a low flash point to clean the air filter element. A fire or explosion could result.

Note

Never run the engine without or with a damaged air filter. Dirt gets so into the engine, causing serious engine damage can occur. In this case, seller, and manufacturer disassociate from any warranty.

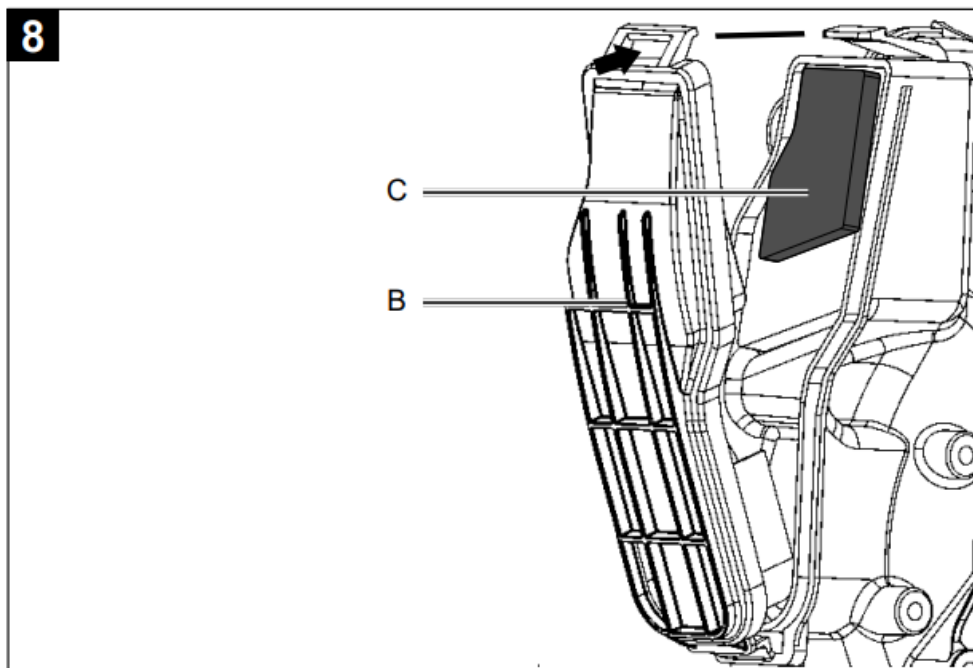

Check, clean and replace spark plug

Check the spark plug after 10 hours on dirt and grime. If necessary, clean it with a copper wire brush. Maintenance the spark plug after 50 hours of operation

- Open the spark plug cover (Fig. 9)
- Remove the ignition cable with plug. (Fig. 9 Pos. D)
- Remove any dirt from the base of the spark plug.
- Use the enclosed spark plug wrench to remove the spark plug.
- Check the spark plug visually. Remove any debris with a wire brush.

- Look for discoloration on the top of the spark plug. By default, the color should be bright.
- Check the spark plug gap. An acceptable gap width is 0.6 to 0.7 mm (Fig. 11)
- Remove the spark plug carefully by hand.
- If the plug has been inserted, tighten them with a spark plug wrench.
- Attach the spark plug wire with connector on the spark plug.

NOTE

A loose spark plug can overheat and damage the engine. And over tightening the spark plug can damage the threads in the cylinder head.

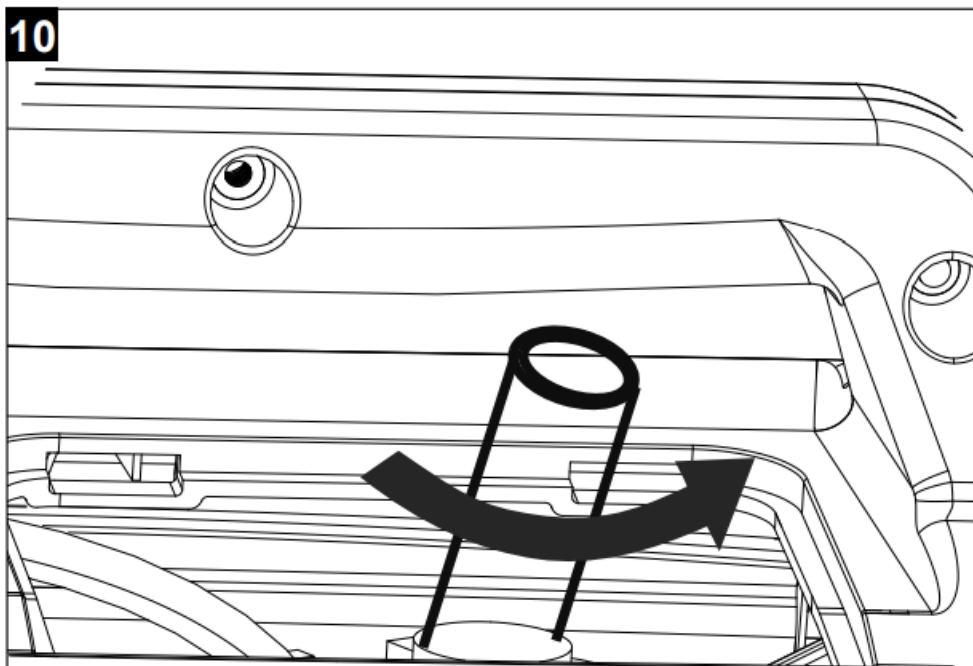
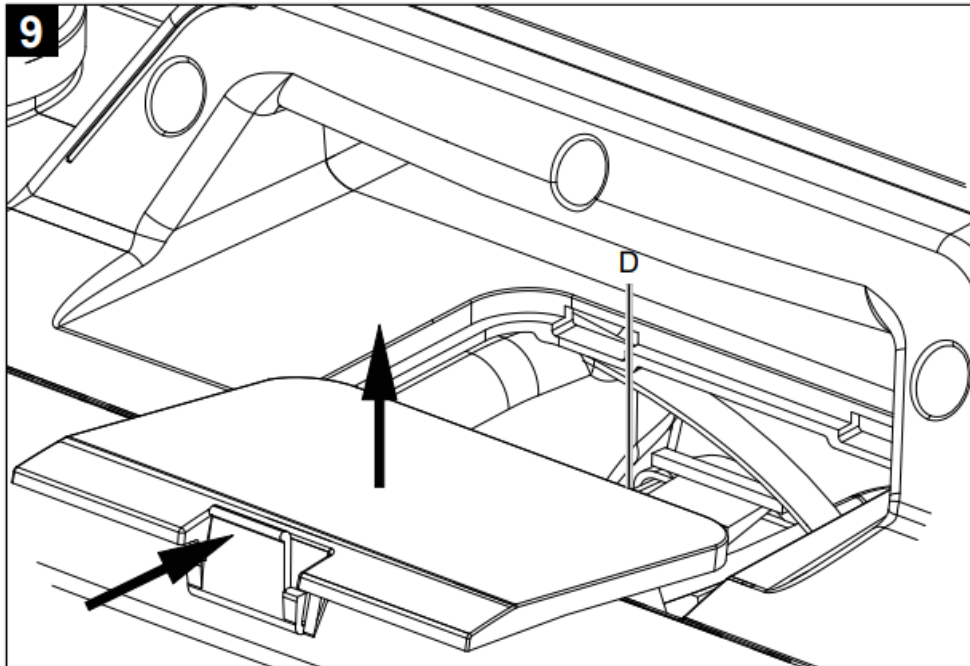

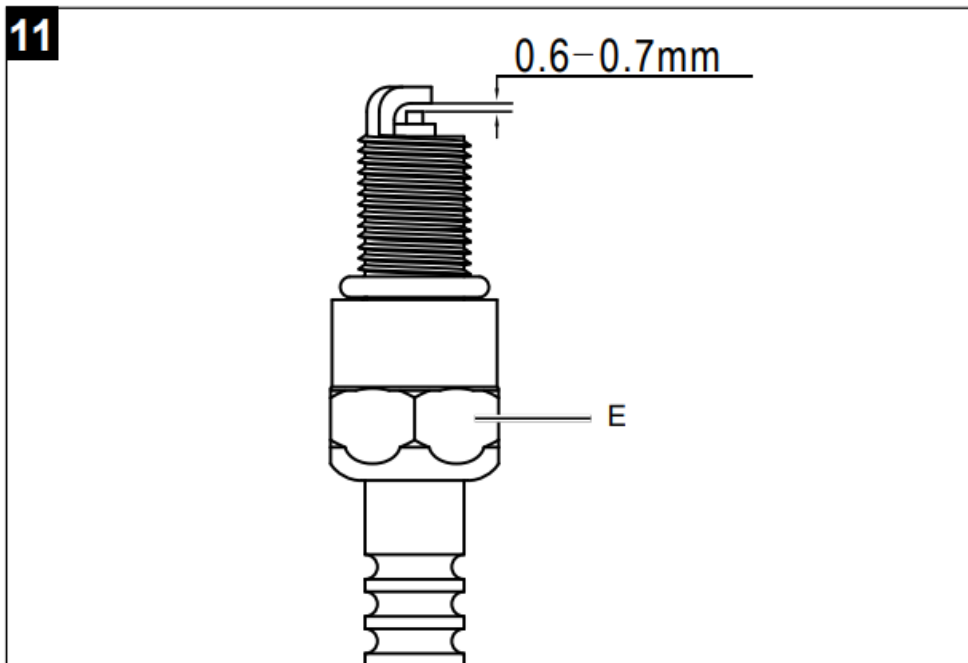
11

Service information

Please note that the following parts of this product are subject to normal or natural wear and that the following parts are therefore also required for use as consumables.

Wear parts*: spark plug

Not necessarily included in the scope of delivery! Spare parts and accessories can be obtained from our service centre. To do this, scan the QR code on the cover page.

Cleaning

- Keep all safety devices, air vents and the motor housing free of dirt and dust. Wipe the equipment with a clean cloth or clean it with compressed air at low pressure.
- We recommend that you clean your device after each use.
- Clean the unit regularly with a damp cloth and some soft soap. Do not use cleaning agents or solvents; they may damage the plastic parts of the appliance. Make sure that no water can get inside the unit.

Storage

1. Perform all general maintenance, which are in the User's Guide in the Maintenance section.
2. Let the fuel out of the tank (Use a commercially plastic fuel pump from the hardware store).
3. After the fuel is drained, start the machine.
4. Let the machine in idle speed running until it stops. That cleans the carburetor from the remaining fuel.
5. Let the machine cool down. (about 5 minutes)
6. Remove the spark plug.
7. Fill a small amount of 2-stroke engine oil into the firing chamber. Pull out several times the starter cord gently to wet the internal components with the oil.
8. Replace the spark plug.
9. Clean the outer casing of the machine.
10. Keep the machine on a cold, dry place out of reach of ignition sources and flammable substances.

Recommissioning

1. Remove the spark plug.
2. Pull the starter rope out several times. It cleans the firing chamber of oil residues.
3. Clean the spark plug contacts or install a new spark plug.
4. Fill the tank.

Transport

WARNING

Let the engine cool down before transporting the machine or storing indoors to avoid burns or fire hazards. If you want to transport the unit empty the fuel tank before. Clean the unit with a brush or a broom of coarse dirt.

Disposal and recycling

- The equipment is supplied in packaging to prevent it from being damaged in transit. The raw materials in this packaging can be reused or recycled. The equipment and its accessories are made of various types of material, such as metal and plastic. Defective components must be disposed of as special waste. Ask your dealer or your local council.

Old devices must not be disposed of with household waste!

- This symbol indicates that this product must not be disposed of together with domestic waste in compliance with the Directive (2012/19/EU) pertaining to waste electrical and electronic equipment (WEEE). This product must be disposed of at a designated collection point. This can occur, for example, by handing it in at an authorised collecting point for the recycling of waste electrical and electronic equipment. Improper handling of waste equipment may have negative consequences for the environment and human health due to potentially hazardous substances that are often contained in electrical and electronic equipment. By properly disposing of this product, you are also contributing to the effective use of natural resources. You can obtain information on collection points for waste equipment from your municipal administration, public waste disposal authority, an authorised body for the disposal of waste electrical and electronic equipment or your waste disposal company.

Troubleshooting

Fault	Possible cause	Remedy
Engine does not start	dirty spark plug	Clean the spark plug, or replace. Electrode spacing 0,6 mm
	no fuel	Refill fuel
Generator has too little or no voltage	Controller or capacitor defective	Contact your dealer
	Air filter dirty	Clean or replace the filter

EXPLODED VIEW

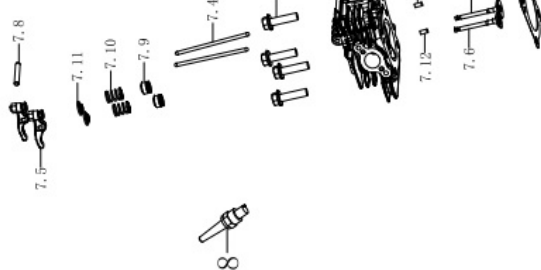
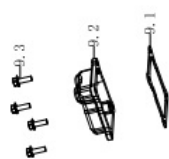
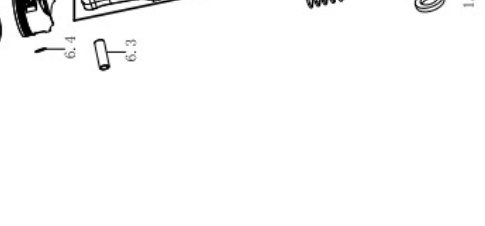
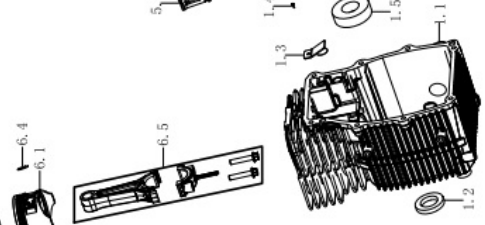
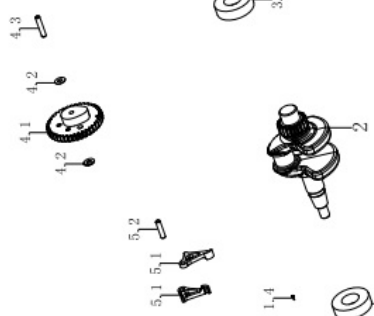
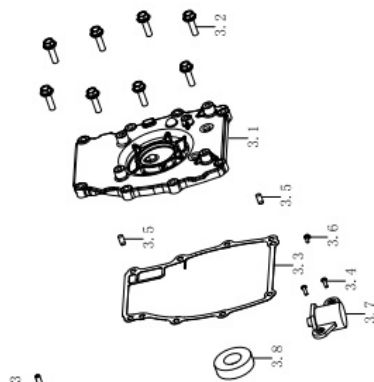
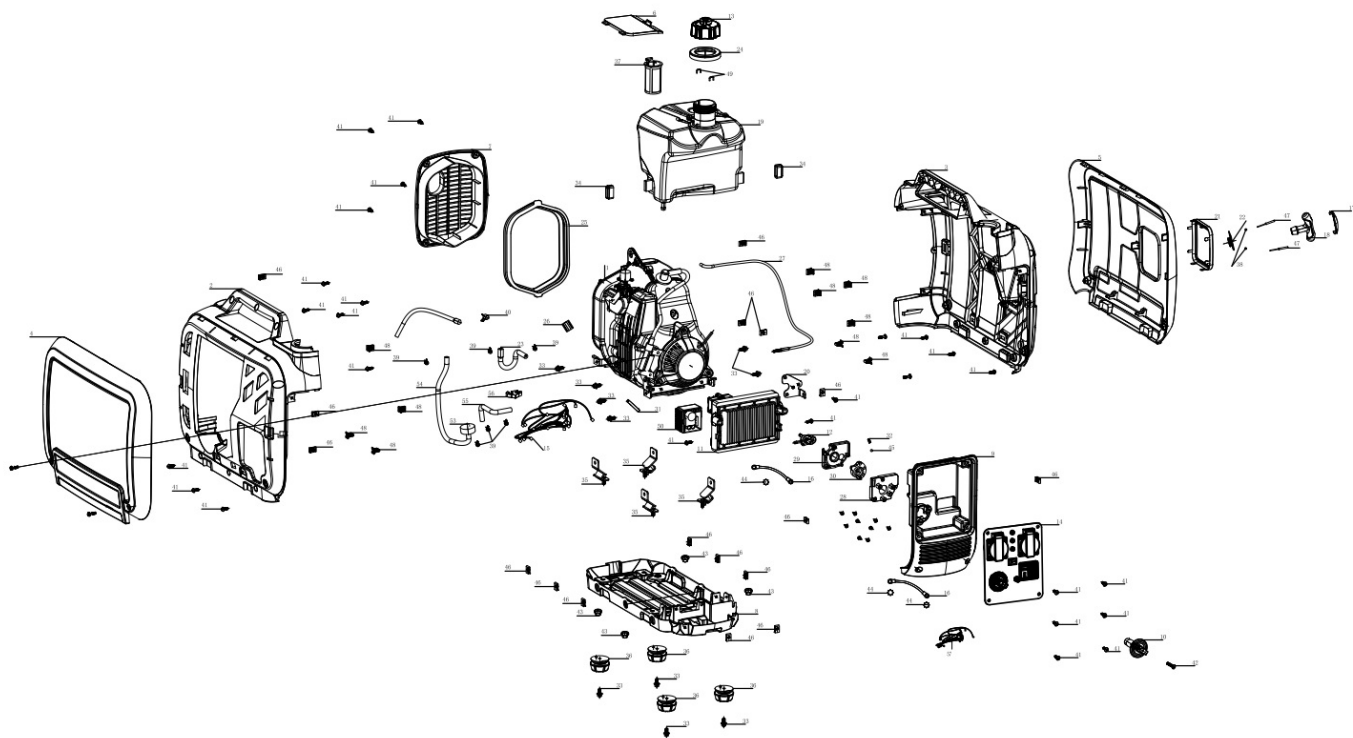



CE Declaration of Conformity

Scheppach GmbH, Günzburger Str. 69, D-89335 Ichenhausen

DE	erklärt folgende Konformität gemäß EU-Richtlinie und Normen für den Artikel	LV	apliecina šādu saskaņā ar ES direktīvu atbilstības un standartu šādu rakstu
GB	hereby declares the following conformity under the EU Directive and standards for the following article	FI	vakuuttaa täten, että seuraava tuote täyttää alla esitetyt EU-direktiivit ja standardit
EE	kinnitab järgmist vastavus vastavalt ELi direktiivi ja standardite järgmist artiklinumbrit	SE	försäkrar härmed följande överensstämmelse enligt EU-direktiv och standarder för följande artikeln
LT	pareiškia, taip atitiktis pagal ES direktyvos ir standartai šį straipsnį	DK	erklærer hermed, at følgende produkt er i overensstemmelse med nedenstående EUDirektiver og standarder

Marke / Brand / Marque:

Art.-Bezeichnung:

Article name:

Nom d'article:

Art.-Nr. / Art. no.: / N° d'ident.:

SCHEPPACH**INVERTER-STROMERZEUGER - SG2500I****INVERTER POWER GENERATOR - SG2500I****GROUPE ÉLECTROGÈNE INVERTER - SG2500I****5906226901**

<input type="checkbox"/> 2014/29/EU	<input type="checkbox"/> 2004/22/EC	<input type="checkbox"/> 89/686/EC_96/58/EC	<input checked="" type="checkbox"/> 2000/14/EC_2005/88/EC
<input type="checkbox"/> 2014/35/EU	<input type="checkbox"/> 2014/68/EU	<input type="checkbox"/> 90/396/EC	Annex V
<input checked="" type="checkbox"/> 2014/30/EU	<input checked="" type="checkbox"/> 2011/65/EU*		Annex VI Noise: measured L_{WA} = 91,6 dB(A); guaranteed L_{WA} = 93 dB(A) dB(A) P = xx KW; L/Ø = cm Notified Body: Notified Body No.:
<input checked="" type="checkbox"/> 2006/42/EC			<input checked="" type="checkbox"/> 2010/26/EC Emission. No: e24*2016/1628*2018/989SHB2/P*0438*01
Annex IV Notified Body: Notified Body No.: Certificate No.:			

Standard references

This declaration of conformity is issued under the sole responsibility of the manufacturer

The object of the declaration described above fulfils the regulations of the directive 2011/65/EU of the European Parliament and Council from 8th June 2011, on the restriction of the use of certain hazardous substances in electrical and electronic equipment.

Ichenhausen, den 28.02.2022

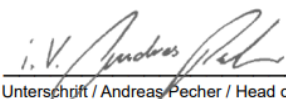
Unterschrift / Andreas Pecher / Head of Project Management

First CE: 2021**Subject to change without notice****Documents registrar: Viktor Härtl****Günzburger Str. 69, D-89335 Ichenhausen****Warranty**

Apparent defects must be notified within 8 days from the receipt of the goods. Otherwise, the buyer's rights of claim due to such defects are invalidated. We guarantee for our machines in case of proper treatment for the time of the statutory warranty period from delivery in such a way that we replace any machine part free of charge which provably becomes unusable due to faulty material or defects of fabrication within such period of time. With respect to parts not manufactured by us we only warrant insofar as we are entitled to warranty claims against the upstream suppliers. The costs for the installation of the new parts shall be borne by the buyer. The cancellation of sale or the reduction of purchase price as well as any other claims for damages shall be excluded.

Documents / Resources



[scheppach SG2500i Inverter Power Generator](#) [pdf] Instruction Manual
SG2500i Inverter Power Generator, SG2500i, Inverter Power Generator, Power Generator, Generator

References

- [🔗 scheppach | scheppach](#)
- [🔗 Kontakt & Service | scheppach | scheppach](#)
- [User Manual](#)

[Manuals+](#), [Privacy Policy](#)

This website is an independent publication and is neither affiliated with nor endorsed by any of the trademark owners. The "Bluetooth®" word mark and logos are registered trademarks owned by Bluetooth SIG, Inc. The "Wi-Fi®" word mark and logos are registered trademarks owned by the Wi-Fi Alliance. Any use of these marks on this website does not imply any affiliation with or endorsement.