



Scheppach HS720 Rocking Log Saw Instruction Manual

[Home](#) » [Scheppach](#) » Scheppach HS720 Rocking Log Saw Instruction Manual 

Contents

- [1 Scheppach HS720 Rocking Log Saw](#)
- [2 Product Usage Instructions](#)
- [3 Introduction](#)
- [4 Safety instructions](#)
- [5 Safe use of fuel](#)
- [6 Operator training](#)
- [7 Technical data](#)
- [8 Scope of delivery](#)
- [9 Assembly](#)
- [10 Setup and calibration](#)
- [11 Transporting the machine](#)
- [12 Electrical connection test](#)
- [13 Change of direction of rotation](#)
- [14 Commissioning](#)
- [15 Maintenance and service](#)
- [16 Clean the air filter](#)
- [17 Tension the drive belt](#)
- [18 When do I change the engine oil?](#)
- [19 Saw blade replacement](#)
- [20 Troubleshooting](#)
- [21 Disposal and recycling](#)
- [22 Warranty](#)
- [23 Documents / Resources](#)
 - [23.1 References](#)
- [24 Related Posts](#)





Product Information:

- Product Name: Rocking log saw
- Model Numbers: HS720, HS720B, HS720VL
- Article Numbers: 5905109901, 5905109902, 5905109903, 39051109954
- Release Number: 5905109901_Master Rev.Nº 07.11.2022
- Languages: German (D), English (GB), French (FR), Slovak (SK), Czech (CZ), Hungarian (HU), Slovenian (SI), Italian (IT), Danish (DK)
- Contents: Safety instructions, Technical specifications, Assembly and installation, Operation, Maintenance

Product Usage Instructions

1. Ensure compliance with electrical regulations and standards such as VDE Bestimmungen 0100, DIN 57113/VDE0113.
2. Read and follow the safety instructions provided in the manual.
3. Operate the log saw safely and responsibly.
4. Handle fuel with care and follow safety precautions.
5. Be aware of any remaining risks and take necessary precautions.
6. Wear safety shoes and protective goggles while operating the log saw.
7. Train operators on the safe use and maintenance of the log saw.
8. Review the technical specifications of the product.
9. Check the included components in the package.
10. Follow the assembly instructions provided.
11. Properly position and adjust the log saw.
12. Use the transport handle to lift and move the machine.
13. Follow the electrical connection instructions for electric models.

14. For gasoline models, use unleaded gasoline with a maximum of 5% bioethanol content. Refer to the included manual for the gasoline engine.
15. Follow the startup procedure for the engine, including turning on the fuel valve, adjusting the choke lever, and pulling the recoil starter grip.
16. Use the log saw with the protective cage and secure the logs with the locking lever.
17. Perform regular maintenance and inspections, including cleaning the air filter and tensioning the drive belt.
18. Clean or replace the air filter after 50 operating hours.
19. Be cautious when removing or installing the drive belt to avoid finger injuries.

Introduction

Manufacturer:
Scheppach GmbH
Günzburger Straße 69
D-89335 Ichenhausen

Dear customer,

We hope your new firewood circular saw brings you much enjoyment and success.

NOTE:

In accordance with the applicable product liability laws, the manufacturer of this device assumes no liability for damage to the device or caused by the device arising from:

- Improper handling.
- Failure to comply with the operating instructions.
- Repairs carried out by third parties, unauthorised specialists.
- Installing and replacing “non-original spare parts”.
- Application other than specified.
- Failures of the electrical system in the event of the electrical regulations and VDE provisions 0100, DIN 57113 / VDE0113 not being observed.

Our recommendation to you:

Read the whole text of the operating instructions before assembly and start up.

These operating instructions should help to familiarise you with the machine and to use it for its intended purpose. The operating instructions include important instructions for the safe, proper and economic operation of the machine, for avoiding danger, for minimising repair costs and downtimes and for increasing the reliability and extending the service life of the machine.

In addition to the safety instructions in these operating instructions, you must also observe the regulations applicable to the operation of the machine in your country.

Keep the operating instructions safely at the machine in a plastic sleeve, protected from dirt and moisture. They must be read and carefully observed by all operating personnel before starting the work. The machine may only be used by personnel who have been trained to use it and who have been instructed with respect to the associated hazards. The required minimum age must be observed. In addition to the safety instructions in these operating instructions and the separate regulations of your country, the generally recognised technical rules relating to the operation of woodworking machines must also be observed.

We accept no liability for accidents or damage that occur due to a failure to observe this manual and the safety instructions.

General information

- After unpacking check all parts, including the scope of delivery, for transport damage. In the event of complaints the carrier and manufacturer must be informed immediately.
- Later claims will not be recognised.
- Familiarise yourself with the product by means of the operating instructions before using for the first time.
- With accessories as well as wearing parts and replacement parts use only original spare parts.
Spare parts can be obtained from your specialist dealer.
- When ordering please provide the article number as well as type and year of manufacture for your equipment.

Safety instructions

- We have marked points in these operating instructions that impact your safety with this symbol: m
- Observe all of these notes before and while working with the saw.
- Store these safety instructions safely.
- Unused devices should be stored in a dry, locked place and out of reach of children.
- Keep tools sharp and clean in order to be able to work better and more safely.
- Pay attention to what you are doing. Remain sensible when working. Do not use the tool when you are fatigued.
- Do not use any tools on which the switch cannot be switched on and off.
- **Warning!** The use of other insertion tools and other accessories can entail a danger of injury.
- **Warning:** Pull out the mains plug or spark plug connector before undertaking any maintenance work described in this manual.
- Pass the safety instructions on to all persons who work on the machine.
- Caution! There is a danger of injury to hands and fingers from the rotating saw blade.
- Do not expose the saw to rain and do not use the machine in a damp or wet environment.
- Ensure good lighting.
- Do not use in the vicinity of combustible fluids or gases.
- Wear suitable work clothing! Loose clothing or jewellery can be caught by the rotating saw blade.
- When working outdoors, anti-slip footwear is recommended.
- Tie long hair back in a hair net.
- Avoid abnormal posture.
- The operating personnel must be at least 16 years of age.
- Keep children away from the device with the engine running.
- Keep the workplace free of wood debris and parts lying around.
- Disorder in the work area can lead to accidents.
- Do not allow other persons, especially children, to touch the tool. Keep such persons away from the workplace.
- Personnel working on the machine must not be distracted.
- Observe the direction of rotation of the engine and saw blade. Only use saw blades whose maximum permissible speed is not less than the maximum spindle speed of the circular saw and the material to be cut.
- Under no circumstances should the saw blades be braked by pushing against the side after switching off the drive.
- Only install saw blades that are well sharpened, free of cracks and not deformed.
- Only use saw blades recommended by the manufacturer and which comply with EN 847-1.
- Faulty saw blades must be replaced immediately.

- Do not use saw blades that do not correspond to the characteristics specified in these usage instructions.
 - Safety equipment on the machine must not be disassembled or made unusable.
 - Replace worn table or swivel frame insert.
 - Working position always to the side of the saw blade.
 - Do not load the machine so much that it comes to a standstill.
 - Make sure that cut-off pieces of wood are not caught by the sprocket of the saw blade and flung away.
 - Never remove loose splinters, chips or jammed wood pieces from the running saw blade.
 - To rectify faults or remove jammed pieces of wood, switch the machine off. – Pull out mains/ or spark plug connector –
 - If the sawing gap has increased due to wear, replace the swivel frame or table inlay. Switch off the machine and disconnect the mains plug or spark plug connector.
 - Only carry out modifications, adjustment, measuring and cleaning work when the engine is switched off.
 - Pull out mains/ or spark plug connector –
 - Before switching on, make sure that keys and adjusting tools are removed.
 - Switch off the engine and pull out the mains plug or spark plug connector when leaving the work station.
 - All protection and safety equipment must be reassembled immediately after repair or maintenance work is completed.
 - The safety, operating and maintenance information of the manufacturer, as well as the dimensions specified in the technical data, must be observed.
 - The relevant accident prevention regulations and the other generally accepted safety rules must be observed.
 - Make sure that you have secure footing and always maintain your balance.
 - Check the electric tool for potential damage!
 - Protective devices or other parts with minor damage must be carefully inspected to ensure that they function correctly and as intended prior to continued use of the tool.
 - Check whether the moving parts function faultlessly and do not jam or whether parts are damaged. All parts must be correctly mounted and all conditions must be fulfilled to ensure fault-free operation of the tool.
 - Damaged protective devices and parts must be repaired properly or replaced by a recognised specialist workshop unless otherwise specified in the usage instructions.
 - This tool conforms to the applicable safety regulations.
- Repairs may only be performed by a specialist using original spare parts. Otherwise accidents could occur.
- If necessary, wear suitable personal protective equipment. This could include:
 - Hearing protection to prevent the risk of developing hearing loss;
 - Respiratory protection to avoid the risk of inhaling damaging dust.
 - Wear gloves when handling saw blades and rough materials. Saw blades must be carried in a container whenever practical.
 - The operator must be informed about the conditions that affect the noise levels (e.g. saw blades designed to reduce noise, care of saw blade and machine).
 - Faults in the machine, including the guards and the saw blade, must be reported to the person responsible for safety as soon as they are discovered.
 - When transporting the machine, use only the transport devices and never use the guards for handling and transport.
 - All operators must be adequately trained in the use, setting and operation of the machine.
 - Do not saw any material to be cut that contain foreign bodies such as wires, cables or cords.

- Only use sharp saw blades.

Warning! This power tool generates an electromagnetic field during operation. This field can impair active or passive medical implants under certain conditions. In order to prevent the risk of serious or deadly injuries, we recommend that persons with medical implants consult with their physician and the manufacturer of the medical implant prior to operating the power tool.

Proper use

The firewood circular saw is designed exclusively with the offered tool for machining wood.

The machine complies with the applicable EC machinery directive.

- The swivel log saw is designed as a one-man operating station and is only to be used outdoors.
- The swivel log saw is a transportable circular saw.
It can only be used for cross-cutting firewood with feed rocker according to technical data.
- The saw is designed exclusively for cross-cutting firewood with a maximum length of 1 m.
- Regardless of the wood diameter, only one workpiece may be placed on the swivel frame.
- Observe all safety and danger notices on the machine and keep them complete and in legible condition.
- The working area and surroundings of the machine must be kept free of disruptive foreign bodies in order to prevent accidents.
- Basically, the timbers to be cut must be free of foreign bodies such as nails and screws.
- Only use the machine when in a technically faultless condition, appropriately and in compliance with the operating instructions and with full knowledge of safety and hazards. In particular, rectify malfunctions that could impair safety immediately (or commission rectification works accordingly).
- The manufacturer's safety, operating and maintenance specifications as well as the dimensions given in the technical data must be observed.
- The applicable accident prevention regulations and the other generally accepted safety rules must be complied with.
- The machine may only be used, maintained or repaired by persons who are familiar with it and have been informed of the dangers. Any liability of the manufacturer for damages resulting from arbitrary changes to the machine is excluded.
- The machine may only be operated with original accessories and original tools from the manufacturer.
- Any use beyond this is improper use. The manufacturer is not responsible for the resulting damages; the user solely bears the risk.
- Only use saw blades that comply with the European standard DIN EN 847-1.
- Ensure adequate lighting.
- Make sure that the machine is stable on solid ground during assembly.
- The area around the machine must be free of trip hazards.
- The machine may only be operated outdoors without extraction.

Please observe that our equipment was not designed with the intention of use for commercial or industrial purposes. We assume no guarantee if the equipment is used in commercial or industrial applications, or for equivalent work.

Safe use of fuel

- To avoid personal injury or material damage, take extra care when handling fuel.

- Fuel is extremely flammable, the vapours are explosive.
- Avoid smoking cigarettes, cigars or pipes in the work area and extinguish all possible sources of fire.
- Only use approved fuel tanks.
- Never open the tank cover or add fuel to the engine when the engine is running.
- The engine must be cooled down before refuelling.
- Never refuel the device indoors.
- Never store the device or the fuel tank near open flames or possible sources of sparks.
- Never fill fuel tanks inside a vehicle, on a truck or trailer with a cover.
- Always place the canister on solid ground at a safe distance from the vehicle for refilling.
- If fuel is splashed on your clothes, please change immediately.
- Do not overfill the fuel tank.
- Close the fuel tank and fuel container carefully.
- If the fuel tank needs to be emptied, this must be done outdoors.
- Never transport the saw with the engine running.
- Never refuel the device in enclosed spaces.
- Before switching on the engine, you must clean the tank and the device of petrol residues.
- Heated petrol expands. Do not fill the fuel tank to the brim, but leave some space so that warm petrol can expand.
- The fuel cap has a ventilation slot for the escape of fuel vapours.
- Always use an original tank cover.
- Failure to observe the petrol safety instructions can trigger fires and explosions, it can cause serious injuries and damage the device and other people's property.
- Filling petrol into a running or hot engine can trigger an explosion.
- Before refilling with petrol, always switch off the engine and let it cool down for a few minutes.
- Remove wood chippings and other debris from the device. Keep the device clean to increase its performance.
- The engine, transmission and exhaust get very hot in a few minutes when the engine is running. Do not touch these parts of the device under any circumstances.
- Before servicing the device, you must first switch off the engine and allow the engine and transmission to cool down.
- Remember, exhaust fumes are dangerous. Never switch on the device in enclosed spaces.
- Dispose of used engine oil in accordance with local regulations.
- Switch off the engine immediately if you notice any unusual noises or vibrations.
- Unusual noises or vibrations are usually warnings of major problems.

5. m Residual risks

The machine has been built according to the state-of-the-art and the recognised technical safety requirements. However, individual residual risks can arise during operation.

- Danger of injury for fingers and hands due to the rotating saw blade with improper guiding of the workpiece.
- Risk to health from wood dust or wood chippings.
- Wearing personal protective equipment such as protective goggles and dust masks is mandatory.
- Risk to health due to noise. The permissible noise level is exceeded during operations. It is essential that personal protective equipment, such as hearing protection, is worn.
- Hazard due to electrical power with the use of improper electrical connection cables.
- Furthermore, despite all precautions having been met, some non-obvious residual risks may still remain.
- Residual risks can be minimised if the "Safety instructions" and "Proper use" are observed along with the whole

of the operating instructions.

- Injuries due to defective saw blade. Check the integrity of the saw blade regularly and before each use.
- When using special accessories, the operating instructions enclosed with the special accessories must be observed and read carefully.

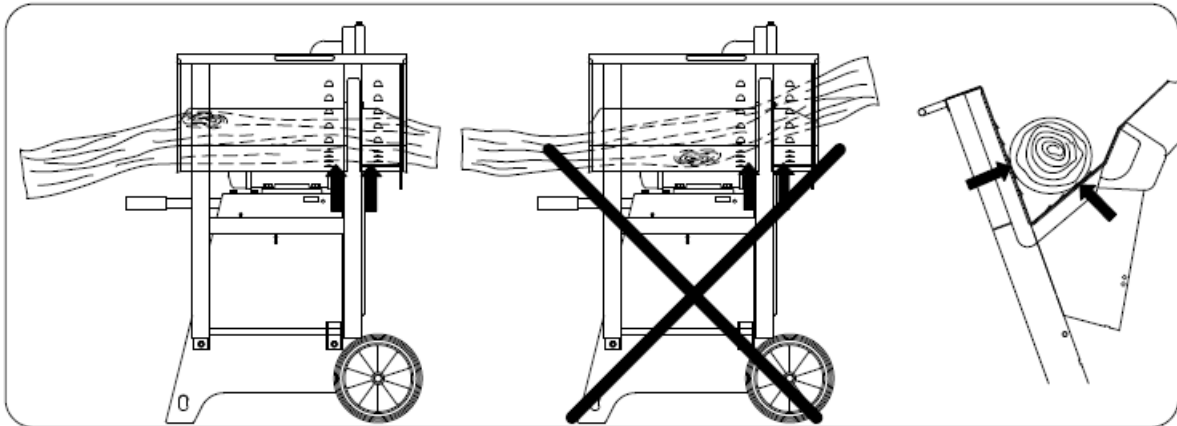

Attention: Danger of accidents!

The wood must always rest on both sides of the saw blade in the prism of the swivel frame. (see arrows)

	Attention: Danger of accidents! Wear safety gloves.		Attention: Danger of accidents! Wear hearing protection. Wear eye protection.
	Attention: Danger of accidents! Read the operating manual before commissioning		Attention! Tool continues to run after power disconnected! Disconnect the device from the power supply before carrying out any maintenance, cleaning or repair work! For machines equipped with a combustion engine, remove the spark plug connector!

Operator training

- Pass the safety instructions on to all persons who work on the machine.
- The operating personnel must be at least 18 years of age. Trainees must be at least 16 years of age and may only work on the machine under supervision.
- Personnel working on the machine must not be distracted.
- Keep children away from the mains-connected machine.
- Wear close-fitting clothing. Remove jewellery, rings and watches.
- Ensure that all of the safety information and danger notices on the machine are in legible condition.
- Caution when working: Danger of injury for fingers and hands due to the rotating cutting tool.
- Regular breaks must be taken during operation.
- Safety shoes and protective clothing must be worn during operation.

Technical data

		HS 720 / HS720 VL	HS 720	HS 720B
Article number		5905109901/ 39051109954	5905109902	5905109903
Dimensions				
Overall length	mm	1270		
Overall width	mm	730		
Overall height	mm	1130		
Swivel frame support	mm	670		
Saw blade ø	mm	700		
Engine idle speed	1/min	1380	1400	1400
Cutting speed Saw blade	m/sec	52	52	52
Weight	kg	95	89,5	114
Drive				
Motor	V/Hz	220 – 240 / 50	380 – 420 / 50	Petrol
Rated input P1	kW	3,0	4,5	
Power output P2	kW	2,1	3,4	9 kW / 12.2 HP
Operating mode		S2 / 15 min	S6 / 20%	
Nominal current	A	13	10	
Work data				
Log cutting height	max. mm	240		
	min. mm	60		
Reversible cut	max. mm	250		
Firewood	max. mm	370 x 240		
Technical changes reserved!				

Noise data

The noise level defined in EN 23746 and EN 31202 respectively (correction factor k3 calculated in accordance with Appendix A.2 of EN 31204) for the noise emission values determined for workplace noise level reflect the workplace conditions defined in ISO 7904 Appendix A.

Sound power level in dB	
Idle LWA / Machining LWA	105 / 107
Sound pressure level at workstation in dB	
Idle LqAeq / Machining LqAeq	95 / 97

The stipulated values are emission values and so do not necessarily represent safe work station values. Although there is a correlation between emission levels and exposure levels, it is not possible to reliably determine whether additional precautionary measures will be required or not based on this. Factors which influence the actual exposure level present on working site include the nature of the working area, other noise sources e.g. the number of machines and neighbouring processes. The permissible working values can vary from country to country. However, the information should enable the operator to evaluate the hazards and risks.

Scope of delivery

- Swivel log saw
- Allen key or open-end spanner
- Locking pin
- Operating instructions

ATTENTION!

The device and the packaging are not children's toys! Do not let children play with plastic bags, films or small parts! There is a danger of choking or suffocating!

Assembly

The machine is delivered fully assembled and ready for immediate use.

Setup and calibration

- Make sure that the machine is stable on solid ground during assembly.
- The workplace must be well lit.
- The area around the machine must be free of trip hazards.

Transporting the machine

Swivel frame lock

- To transport the swivel log saw, latch the swivel lock in position (1).
- Transport the swivel log saw by the handle (2).
- When transporting the rocking frame circular saw with petrol engine, insert the transport handle (3) through 2 loops and, for safety, slightly turn it, and lift and transport it using the transport handle.

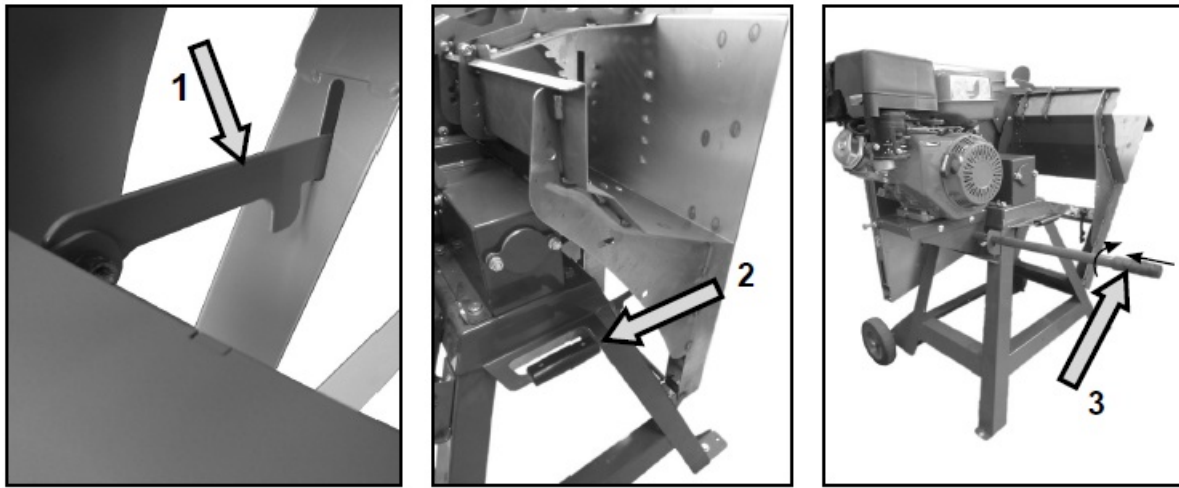

Electrical connection

- The electrical motor installed is connected and ready for operation. The connection complies with the applicable VDE and DIN provisions. The customer's mains power connection as well as the extension lead used must also comply with these regulations and the local regulations.
- Check the electrical connection cables for damage regularly. Ensure that the connection cables are disconnected from electrical power when checking for damage.
- Electrical connection cables must comply with the applicable VDE and DIN provisions. Only use connection cables with the marking "H 07 RN".
- The printing of the type designation on the cable is mandatory.

Damaged electrical connection cables

Insulation damage often occurs on electrical connection lines.

Causes are:

- Pressure points, where connection cables are passed through windows or doors.
- Kinks where the connection cables have been improperly fastened or routed.
- Places where the connection cables have been cut due to being driven over.
- Insulation damage due to being ripped out of the wall outlet.
- Cracks due to the insulation ageing.
- Such damaged electrical connection cables must not be used and are life-threatening due to insulation damage! 3-phase motor 400 V / 50 Hz
- Mains voltage 400 Volt / 50 Hz.
- Mains power connection and extension leads must be 5-core = 3 P + N + SL. – (3/N/PE).
- Extension cables must have a minimum cross section of 1.5 mm² (≤ 25m).
- Extension cables must have a minimum cross section of 2.5 mm² (> 25m).

The mains power connection is protected with a 16 A slow-blow fuse. The RCD circuit breaker must have a 30 mA trip rating.

When connecting to the mains or in the event of the machine being moved to another location, the turning direction must be checked. It may be necessary to change the polarity.

Turn the pole changing device in the device connector.

Motor braking device

- The brake brakes the drive motor of the sawing shaft within 10 s.
- The electric braking is interrupted after max. 14 s.
- If the braking process takes longer than 10 s, the machine must no longer be operated because the brake is defective. It is essential to disconnect the machine from the power supply. Only a qualified electrician may be assigned with troubleshooting.

Operating mode / duty cycle

The electric motor is designed for operating mode S6 – 20 %.

S6 = Continuous operation with intermittent load 20% = Based on 10 min: 2min. Load; 8min. Idle mode.

If the engine is overloaded, it switches off automatically because a thermostat protects the motor from overloading. After a cool-down period (time varies) the motor can be switched back on again.

Electrical connection test

- Switch on the machine at the operating switch; the saw shaft starts running.

Attention!

Check direction of rotation

- The direction of rotation of 3-phase motors must be checked when they are connected for the first time or if they are relocated. If necessary the polarity must be changed with the phase inverter (Fig. A)
- When switching off, the sawing shaft is braked within 10s.

Change of direction of rotation

Fig. A

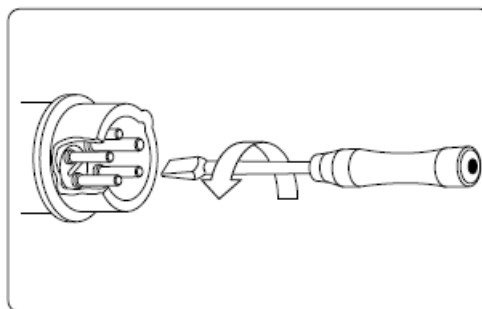

- Extension leads up to 25 m long must have a minimum cross section of 1.5 mm², and over 25 m long must have a minimum cross section of 2.5 mm².
- The mains power connection is protected with a 16

A slow-blow fuse.

- The RCD circuit breaker must have a 30 mA trip rating.

Connections and repair work on the electrical equipment may only be carried out by an electrician.

Please provide the following information in the event of any enquiries:

- Engine manufacturer; engine type
- Type of current for the motor
- Machine data – type plate
- Electrical control data

When returning the engine always send in the complete drive unit with electrical control. m

Petrol engine

Engine oil

m The oil has been drained for transport. If the oil tray is not filled with engine oil before the engine is started, this will result in permanent damage to the engine and a loss of the engine warranty.

Topping up with fuel

WARNING

Petrol is highly flammable:

- Only store petrol in the designated containers.
- Only fuel the unit outdoors and do not smoke when filling.
- Petrol must be filled before starting the engine.

While the engine runs or if the engine is hot, the tank plug must not be opened and petrol must not be filled.

- If petrol overflows, no attempts should be made to start the engine. Instead, the machine must be removed from the area contaminated with petrol. Do not try to start the engine until the petrol vapours have evaporated.
- For safety reasons, petrol tank and other tank caps must be replaced if damaged.
- Never store petrol near a source of sparks. Always use a tested canister. Keep petrol away from children.
- Replace defective silencers.
- Open the petrol cap and fill the fuel tank with petrol up to the lower point of the tank cover.
- Use a funnel and measuring container for filling. Do not overfill the tank.
- Only use fresh, clean, unleaded fuel.
- Never mix oil with petrol.
- Purchase fuel in quantities that can be used within 30 days to ensure that the fuel is fresh.

Attention: Use standard unleaded petrol with max. 5% bioethanol component.

WARNING

Always only use a safety petrol canister. Do not smoke when filling petrol. Remove any oil or petrol residues. Switch the engine off before filling petrol and let the engine cool for several minutes. Please also read the enclosed operating manual for the petrol engine!

Commissioning

- Observe the safety instructions before the commissioning.
- All safety devices and aids must be installed.
- Check the swivel frame; it must return to the starting position by itself. Check that the saw blade is properly seated and that the running direction is correct.
- Function test before starting work.
- To start up the saw, press the on/off switch.

- The saw is designed exclusively for cross-cutting firewood with a maximum length of 1 metre.
- Regardless of the wood diameter, only one piece with a min. Ø 60 mm may be placed on the swivel frame.
- With both hands on the handle, swivel the swivel frame towards the saw blade.
- Then bring the swivel frame into the starting position.
- The wood to be sawn must not be fixed by hand.
- After the saw has come to a complete standstill, pull out the mains or spark plug connector.
- Only carry out modifications, setting, measuring and cleaning work when the engine is switched off. Wait until the rotating tool has come to a standstill and remove the mains plug / spark plug connector.

Starting the engine

Follow the procedure below for cold starting:

1. Turn the fuel valve (B) to the right to the open position.
2. Turn the choke lever (A) on the engine fully to the left, to the “ON” position.
3. Set the throttle lever (C) to the half-open position.
4. Turn the ignition switch (E) to ON.
5. Pull the recoil starter handle (D) slowly several times so that the petrol flows into the carburettor. Then hold the recoil starter handle (D) and pull the cord out a little until you feel resistance. Then pull the cord out in one quick movement and let the cord wind up again slowly. Do not let the cord recoil. If necessary, pull the recoil starter handle (D) several times until the engine starts.
6. Let the engine warm up for a few seconds. Then gradually move the choke lever (A) to the right to the “OPEN” position.

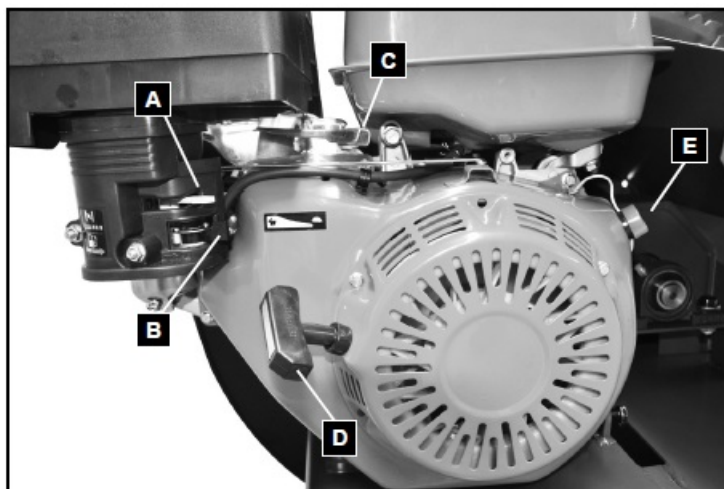

Restarting an engine that is already warm from previous operation does not normally require the use of the choke.

1. Turn the fuel valve (B) to the right to the open position.
2. Set the throttle lever (C) to the half-open position.
3. Turn the ignition switch (E) to ON.
4. Then hold the recoil starter handle (D) and pull the cord out a little until you feel resistance. Then pull out the recoil starter handle (D) in one quick movement and let the cord wind up again slowly. Do not allow the recoil starter handle (D) to recoil.

After the engine has started, move the throttle lever (C) to the full throttle position so that the saw blade can reach its maximum speed.

End of work

- Slowly move the throttle (C) to the stop position.
- Close the fuel shut-off valve (B).
- Observe general maintenance information.
- Bring the swivel frame to the transport position and secure it with the swivel frame lock.

The HS720/HS720B provides maximum safety thanks to its enclosed sawing area.

Prior to commissioning the device for the first time:

Remove the cable ties from the tension spring. Open the protective cover (1) and mount the tension springs as displayed in the image.



Handling the protection cage

- Open the protective cover (1).
- Insert the material to be cut.
- Close the protective cover (1).
- Swivel the rocking frame (2) with hand grip (A) or (B) to the saw blade and saw through the material to be cut.
- Swivel the rocking frame (2) back and open the protective cover.
- Add more material to be cut and close the protective cover again.

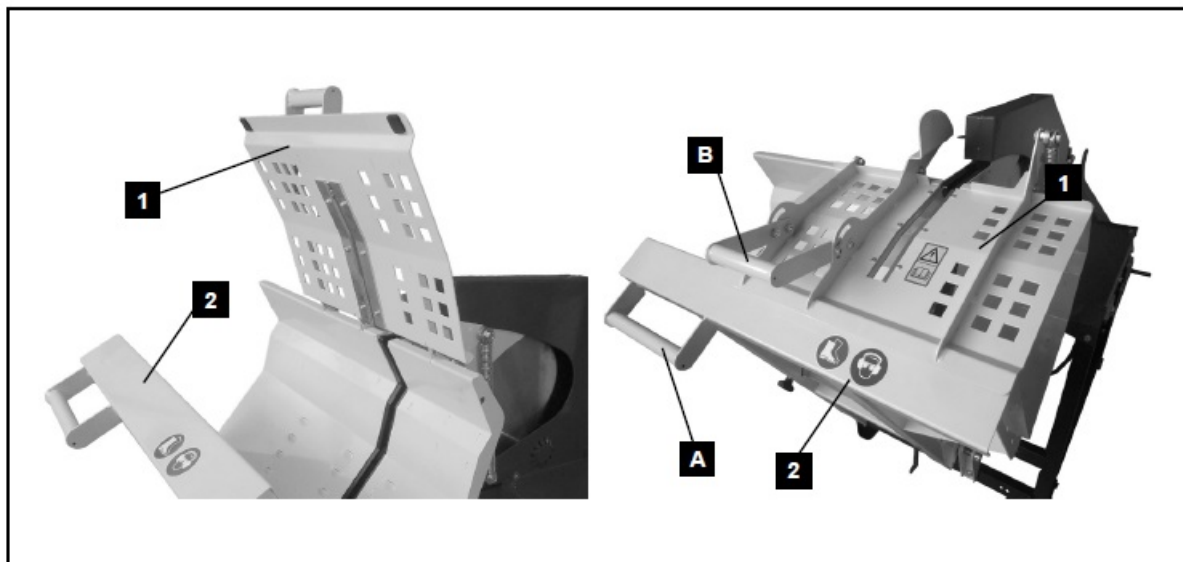

Sawing operation

1. After the machine has been switched on, wait until the saw blade has reached full speed.
2. Place the wood in the swivel frame.
3. Hold the handle of the swivel frame with both hands and guide it evenly towards the saw blade.
4. Only apply enough pressure on the swivel frame when sawing so that the speed of the saw blade does not drop.
5. Remove the sawn wood from the swivel frame after it has returned to its original position and the saw blade is covered.

Now place the next piece of wood on.

Attention!

- Do not leave the machine unattended during operation
- Switch the machine off when stopping work and remove the mains plug or spark plug connector.

End of work

- Switch off the drive motor with the On/Off switch.
- Wait until the saw blade has come to a complete stop.
- Re-fit the mains plug/spark plug connector.
- Observe general maintenance information.
- Bring the swivel frame to the transport position and secure it with the swivel frame lock.

Maintenance and service

Only carry out maintenance, modification, adjustment and cleaning work when the engine is switched off and the mains or spark plug connector is disconnected.

- Keep the instructions with the machine.
- Keep the machine clean.
- Wear safety goggles when cleaning.

Before starting the maintenance or checks, clean the work area and have suitable tools at hand and in good condition.

The time intervals relate to normal operating conditions. If the machine is subjected to heavier loads, these times must be reduced accordingly.

Clean the machine cladding, panels and control levers with a soft, dry cloth or a cloth that has been slightly moistened with neutral cleaning agent. Do not use any solvents such as alcohol or petrol as these may damage the surfaces.

Keep oils and lubricants out of reach of unauthorised persons. Read through the instructions on the containers carefully and follow them closely. Avoid direct contact with the skin and wash off thoroughly after use.

Check all safety devices after all maintenance or cleaning work.

Servicing

Switch the engine off and let it cool down. Re-fit the mains plug/spark plug connector.

Check the general condition of the machine. Check for loose screws, misalignment or jamming of moving parts,

part

breakages and other conditions that could impair safe operation.

Remove all foreign objects and other materials that have collected on the saw blade and on the unit. Clean the machine after every use. Then use a high-quality, low-viscosity machine oil to lubricate all moving parts.

- Never use a high-pressure cleaner to clean your machine. Water can penetrate sealed areas of the machine and the transmission housing and cause damage to spindles, gear wheels, bearings or the engine. The use of high-pressure cleaners shortens the service life and reduces the ease of maintenance.

Experienced craftsmen can carry out small repairs on the machine themselves.

- Check the saw blade at regular intervals. Use only saw blades that are well sharpened, free of cracks and not deformed.

Only use tools that comply with the European standard DIN EN 847-1.

- Replace worn swivel frame bearings immediately.
- Check all safety devices after all maintenance or cleaning work.
- Check that no tools or miscellaneous parts are on or in the machine before putting it back into operation.
- Remove any sawdust accumulations that may arise at the discharge.

Service information

With this product, it is necessary to note that the following parts are subject to natural or usage-related wear, or that the following parts are required as consumables.

Wearing parts*: Saw blade; swivel frame inserts may not be included in the scope of supply! Spare parts and accessories can be obtained from our Service Centre. To do this, scan the QR code on the cover page.

Clean the air filter

Clean the air filter after 50 operating hours. If it is already worn out, replace it.

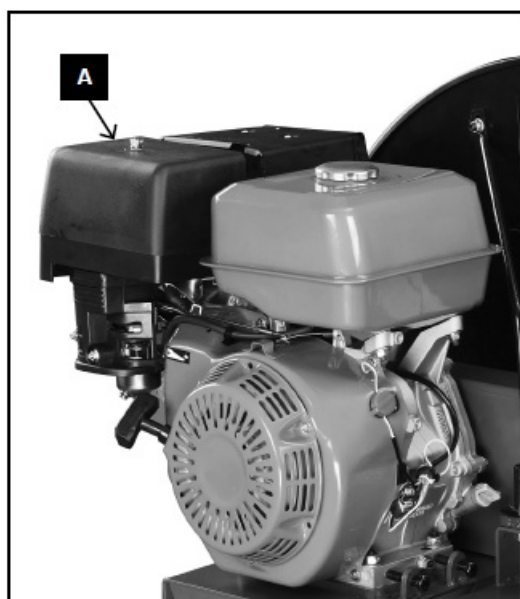

1. Remove the air filter housing (A).
2. Remove the foam filter.

3. Wash it with detergent and water and dry it thoroughly with a clean cloth.
4. Wet the foam filter with clean engine oil.
5. Then squeeze the air filter thoroughly in a clean, absorbent cloth to remove the excess oil.
6. Reinsert the air filter.
7. Refit the air filter cover.

Tension the drive belt

- Switch off the engine.
- The engine must have cooled down.
- Remove the belt guard to gain access to the belt.
- Loosen the 4 screws (A) under the motor plate on both sides.
- Loosen the counternut (B).
- Using the clamp screw (C), tighten the drive belt if the belt gives more than 10-15 mm (when pressing your thumb on it).
- Tighten the lock nut (B) and the 4 screws (A) again.
- Attach the belt guard again.

When you remove or attach the drive belt, make sure that your fingers do not get caught between the belt and the pulley.

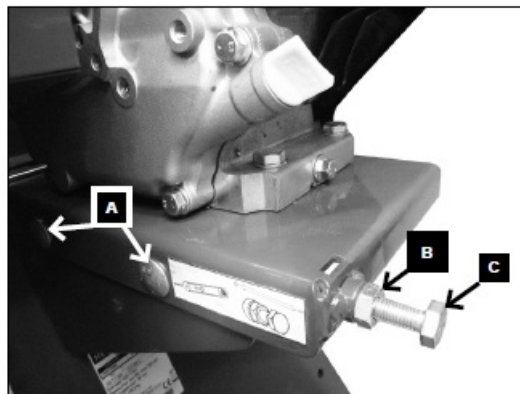

When do I change the engine oil?

The oil must be replaced every 50 operating hours whilst the engine is off and in warm condition. To do so, it may be necessary to let the engine run briefly.

Place a suitable collecting container with min. 1 litre volume under the oil drain screw (A).

First open the oil drain screw (A) and then the oil filling nozzle (B) and drain off all the engine oil using a suitable hose or pipe.

Close the oil drain screw (A) again and fill 0.6 litres of fresh engine oil into the oil filling nozzle (B).

Then check the oil level using the oil dipstick (B) and correct the oil level if necessary.

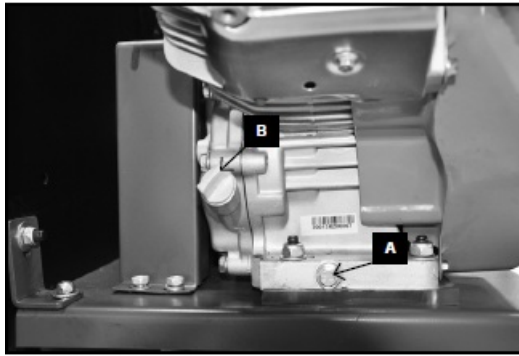

Recommended engine oil

SAE 10W-30 or 10W-40 (depending on the operating temperature).

Saw blade replacement

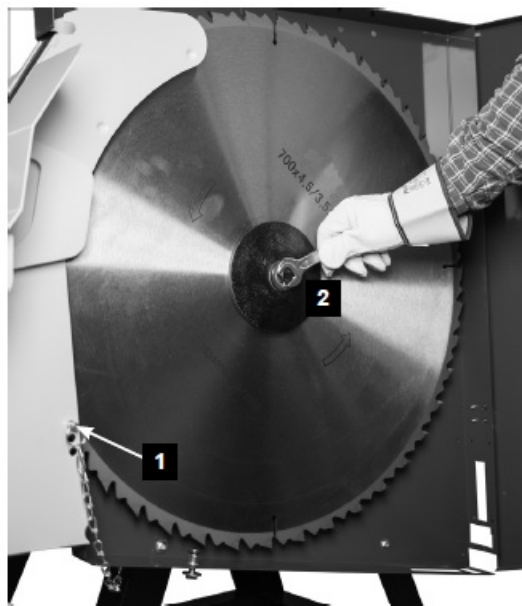

Wait until stationary and allow to cool down. Pull out the mains plug or disconnect the spark plug connector!

- The saw blade can only be replaced in the firewood cutting position.
- Loosen the top and bottom screws on the protective cover approx. 5 mm and open the protective cover.
- To lock the saw blade into place, insert the locking pin (1) through the corresponding opening on the saw blade guard. To do this, insert the pin completely and straight into the hole. Use the corresponding hole (depending on the saw blade type) so that the pin is at the lowest point (bottom of the tooth).
- Loosen the saw blade with the supplied open-end spanner / Allen wrench (2).
- Remove saw blade flange and saw blade
- Insert the new saw blade.
- Mount the saw blade flange again and tighten the clamp screw.
- Remove the locking pin.

Attention! When inserting the saw blade, make sure the running direction is correct!

Troubleshooting

Fault	Possible cause	Remedy
The saw does not brake when switching the machine off	1. Mechanical brake is defective	1. Have the brake replaced
Saw blade is loose after the motor is switched off	1. Fixing nut not tight enough	1. Tighten fixing nut; right-hand thread
Burnt areas on the cutting surface	1. Blunt saw blade 2. Incorrect saw blade	1. Sharpen, replace saw blade 2. Replace saw blade
Engine does not start	1. Spark plug cable unplugged. 2. No fuel or old fuel. 3. Choke not in open position. 4. Fuel line clogged. 5. Contaminated spark plug. 6. Engine flooded. 7. Engine oil level low	1. Re-connect the spark plug cable to the spark plug. 2. Fill with clean, fresh petrol. 3. The throttle must be positioned in the choke position during cold starting. 4. Clean the fuel line. 5. Clean, set gap or replace. 6. Wait a few minutes before restarting, but do not allow the engine to prime. 7. The oil monitor prevents the engine from starting if the oil level is too low; check the oil level.
Engine runs erratically.	1. Spark plug cable loose. 2. Engine runs with CHOKE. 3. Fuel line clogged or old fuel. 4. Ventilation blocked. 5. Water or contamination in the fuel system. 6. Contaminated air filter. 7. Incorrect carburettor setting.	1. Connect and fasten the spark plug cable. 2. Set the choker-arm to OFF. 3. Clean the fuel line. Fill the tank with clean, fresh petrol. 4. Clean the de-aerator. 5. Empty the tank. Fill the tank with fresh fuel. 6. Clean or replace the air filter. 7. Contact the service department
Motor is overheated	1. Engine oil level low. 2. Contaminated air filter. 3. Airflow restricted. 4. Carburettor not adjusted correctly.	1. Fill crankcase with correct oil. 2. Clean the air filter. 3. Remove and clean the housing. 4. Contact the service department

Engine does not start.	1. Mains fuse blown 2. Extension cable defective 3. Connection to the motor or switch not OK 4. Motor or switch faulty	1. Check mains fuse. 2. Replace the extension lead. 3. Have this checked by an electrician. 4. Have this checked by an electrician.
Incorrect motor rotational direction	1. Capacitor defective 2. Incorrect polarity / Incorrect connection	1. Have this checked by an electrician 2. Change direction of rotation with phase inverter / Have an electrician change the polarity of the wall plug.
Motor not supplying power, fuse tripping	1. Cross section of the extension lead insufficient. 2. Overload due to blunt saw blade	1. see "Electrical connection" 2. Replacing the saw blade
Burnt areas on the cutting surface	1. Blunt saw blade 2. Incorrect saw blade	1. Sharpen/replace saw blade 2. Replace saw blade

Electrical maintenance work may only be carried out by a qualified electrician!

Disposal and recycling

Notes for packaging

The packaging materials are recyclable. Please dispose of packaging in an environmentally friendly manner. Notes on the electrical and electronic equipment act [ElektroG] Waste electrical and electronic equipment does not belong in household waste, but must be collected and disposed of separately!

- Used batteries or rechargeable batteries that are not installed permanently in the old appliance must be removed non-destructively before disposal.
Their disposal is regulated by the battery law.
- Owners or users of electrical and electronic devices are legally obliged to return them after use.
- The end user is responsible for deleting their personal data from the old device being disposed of!
- The symbol of the crossed-out dustbin means that waste electrical and electronic equipment must not be disposed of with household waste.
- Waste electrical and electronic equipment can be handed in free of charge at the following places:
 - Public disposal or collection points (e.g. municipal works yards)
 - Points of sale of electrical appliances (stationary and online), provided that dealers are obliged to take them back or offer to do so voluntarily.
 - Up to three waste electrical devices per type of device, with an edge length of no more than 25 centimetres, can be returned free of charge to the manufacturer without prior purchase of a new device from the manufacturer or taken to another authorised collection point in your vicinity.
 - Further supplementary take-back conditions of the manufacturers and distributors can be obtained from

the respective customer service.

- If the manufacturer delivers a new electrical appliance to a private household, the manufacturer can arrange for the free collection of the old electrical appliance upon request from the end user. Please contact the manufacturer's customer service for this.
- These statements only apply to devices installed and sold in the countries of the European Union and which are subject to the European Directive 2012/19/EU. In countries outside the European Union, different regulations may apply to the disposal of waste electrical and electronic equipment.

hereby declares the following conformity under the EU Directive and standards for the following article

Warranty

Apparent defects must be notified within 8 days from the receipt of the goods. Otherwise, the buyer's rights of claim due to such defects are invalidated. We guarantee for our machines in case of proper treatment for the time of the statutory warranty period from delivery in such a way that we replace any machine part free of charge which provably becomes unusable due to faulty material or defects of fabrication within such period of time. With respect to parts not manufactured by us we only warrant insofar as we are entitled to warranty claims against the upstream suppliers. The costs for the installation of the new parts shall be borne by the buyer. The cancellation of sale or the reduction of purchase price as well as any other claims for damages shall be excluded.

www.scheppach.com

Documents / Resources

	<p>Scheppach HS720 Rocking Log Saw [pdf] Instruction Manual HS720, HS720B, HS720VL, HS720 Rocking Log Saw, Rocking Log Saw, Log Saw, Saw</p>
---	--

References

- [🔗 scheppach | scheppach](#)
- [🔗 Kontakt & Service | scheppach | scheppach](#)