



# scheppach HL1020 Log Splitter Instruction Manual

[Home](#) » [Scheppach](#) » [scheppach HL1020 Log Splitter Instruction Manual](#) 

## Contents

- 1 [scheppach HL1020 Log Splitter](#)
- 2 [Instruction](#)
- 3 [Introduction](#)
- 4 [Device description](#)
- 5 [Scope of delivery](#)
- 6 [Intended use](#)
- 7 [Safety notes](#)
- 8 [Additional safety instructions](#)
- 9 [Technical data](#)
- 10 [Unpacking](#)
- 11 [Attachment / Before starting the equipment](#)
  - 11.1 [Mount \(14\) wheels \(fig. 2\)](#)
  - 11.2 [Mount \(2\) controller handles \(fig. 3\)](#)
  - 11.3 [Mount \(12\) holder arm \(fig. 4\)](#)
  - 11.4 [Mount \(6\) holder arm for trunk lifter \(fig. 5\)](#)
  - 11.5 [Mount \(5\) trunk lifter \(fig. 6\)](#)
  - 11.6 [Putting the splitter into the work position](#)
- 12 [Initial operation](#)
- 13 [Electrical connection](#)
- 14 [Cleaning](#)
- 15 [Transport](#)
- 16 [Storage](#)
- 17 [Maintenance](#)
- 18 [Disposal and recycling](#)
- 19 [Troubleshooting](#)
- 20 [Documents / Resources](#)
  - 20.1 [References](#)
- 21 [Related Posts](#)



## **scheppach HL1020 Log Splitter**



## **Instruction**

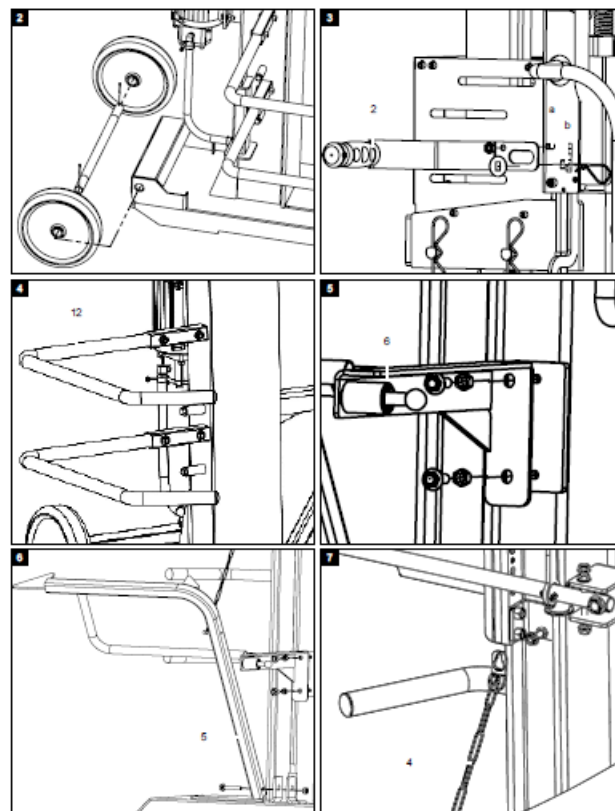
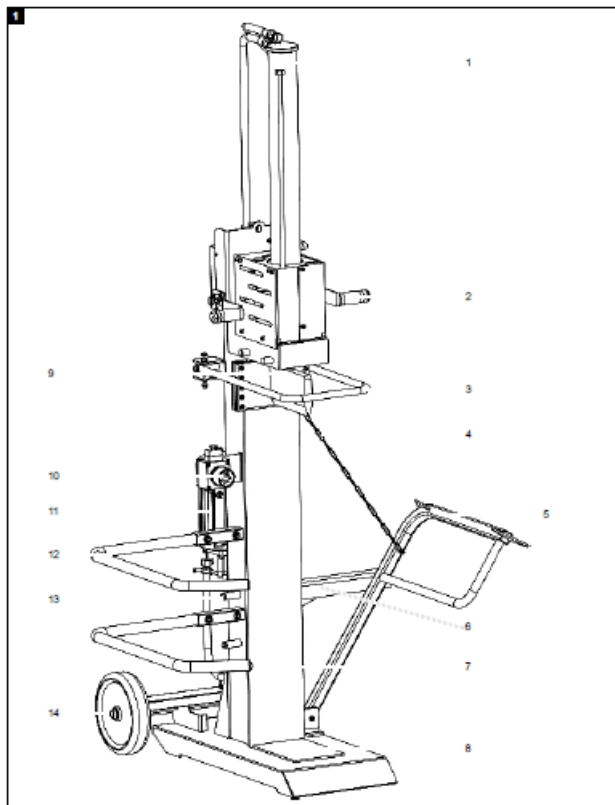

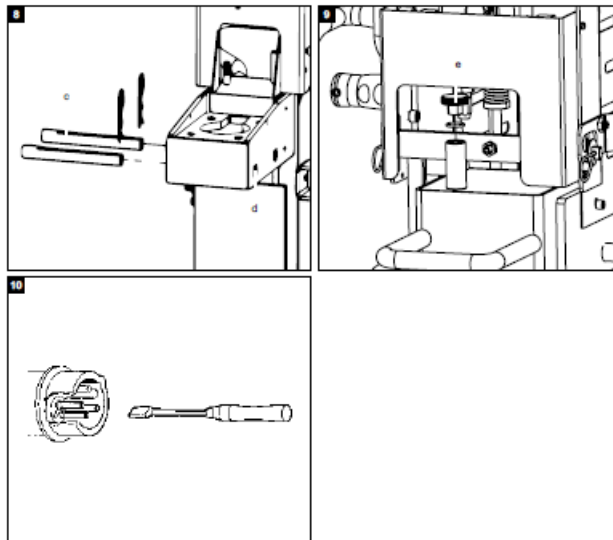

## Introduction

### Dear Customer,

We hope your new tool brings you much enjoyment and success.

### Note:

According to the applicable product liability laws, the manufacturer of the device does not assume liability for damages to the product or damages caused by the product that occurs due to:

- Improper handling,
- Non-compliance of the operating instructions,
- Repairs by third parties, not by authorized service technicians,
- Installation and replacement of non-original spare parts,
- Application other than specified,
- A breakdown of the electrical system that occurs due to the non-compliance of the electric regulations and VDE regulations 0100, DIN 57113 /VDE0113.

### We recommend:

Read through the complete text in the operating instructions before installing and commissioning the device. The operating instructions are intended to help the user to become familiar with the machine and take advantage of its application possibilities in accordance with the recommendations. The operating instructions contain important information on how to operate the machine safely, professionally and economically, how to avoid danger, costly repairs, reduce downtimes and how to increase reliability and service life of the machine.

In addition to the safety regulations in the operating instructions, you have to meet the applicable regulations that apply for the operation of the machine in your country. Keep the operating instructions package with the machine at all times and store it in a plastic cover to protect it from dirt and moisture. Read the instruction manual each time before operating the machine and carefully follow its information. The machine can only be operated by persons who were instructed concerning the operation of the machine and who are informed about the associated dangers. The minimum age requirement must be complied with.

In addition to the safety instructions in this operating manual and the separate regulations of your country, the generally recognised technical rules for operating woodworking machines must also be observed. We accept no liability for accidents or damage that occur due to a failure to observe this manual and the safety instructions.

## Device description

1. Cylinder
2. Operating handle

3. Return bracket
4. Chain
5. Log lifter
6. Holder arm for trunk lifter
7. Housing
8. Work table
9. Splitting wedge
10. Combination switch/plug
11. Motor
12. Supporting arm
13. Oil level window
14. Transport wheels

### **Scope of delivery**

- A. Splitter
- B. Supporting arm
- C. Log lifter
- D. Holder arm for trunk lifter
- E. Enclosed accessories bag
- F. Operating manual

### **Intended use**

The equipment is to be used only for its prescribed purpose. Any other use is deemed to be a case of misuse. The user / operator and not the manufacturer will be liable for any damage or injuries of any kind caused as a result of this.

The equipment is to be operated only with suitable saw blades. It is prohibited to use any type of cut-ting-off wheel.

To use the equipment properly you must also observe the safety information, the assembly instructions and the operating instructions to be found in this manual.

All persons who use and service the equipment have to be acquainted with this manual and must be in-formed about the equipment's potential hazards.

It is also imperative to observe the accident prevention regulations in force in your area. The same applies for the general rules of health and safety at work. The manufacturer will not be liable for any changes made to the equipment nor for any damage resulting from such changes.

- The hydraulic log splitter can only be used in a vertical position. Logs may only be split along the direction of the fiber. Log dimensions are:  
Log lengths 106 cm Ø min. 10 cm, max. 40 cm
- Never split logs in horizontal position or against the direction of the fiber.
- Observe the safety, working, and maintenance instructions of the manufacturer, as well as the dimensions given in the chapter Technical data.
- The applicable accident prevention regulations as well as all generally recognized safety rules must be adhered to.
- Only persons who have been trained in the use of the machine and have been informed of the various dangers may work with the machine and service or repair it. Arbitrary modifications of the machine re-lease the

manufacturer from any responsibility for resulting damage.

- The machine may only be used with original accessories and original tools of the manufacturer.
- Any other use exceeds authorization. The manufacturer is not responsible for any damages resulting from unauthorized use; risk is the sole responsibility of the operator.

The machine may be operated only with original parts and original accessories of the manufacturer.

The safety, work and maintenance instructions of the manufacturer as well as the dimensions indicated in the Technical Data section must be adhered to.

Please note that our equipment has not been de-signed for use in commercial, trade or industrial applications. Our warranty will be voided if the equipment is used in commercial, trade or industrial businesses or for equivalent purposes.

## **Safety notes**

**WARNING:** When you use electric machines, al-ways observe the following safety instructions in order to reduce the risk of fire, electric shock, and injuries.

Please read all the instructions before you work with this machine.

- Observe all safety notes and warnings attached to the machine.
- See to it that safety instructions and warnings attached to the machine are always complete and perfectly legible.
- Protection and safety devices on the machine may not be removed or made useless.
- Protection and safety devices on the machine may not be removed or made useless.
- Check electrical connection leads. Do not use any faulty connection leads.
- Before putting into operation check the correct function of the two-hand control.
- Operating personnel must be at least 18 years of age. Trainees must be at least 16 years of age, but may only operate the machine under adult super-vision.
- Wear working gloves when working.
- Children may not work with this device.
- Where work and safety gloves, safety glasses, close-fitting work clothes, and hearing protection (PPE) while working.
- Caution when working: There is a danger to fingers and hands from the splitting tool.
- Use adequate supports when splitting heavy or bulky logs.
- Before starting any conversion, setting, cleaning, maintenance or repair work, always switch off the machine and disconnect the plug from the power supply.
- Connections, repairs, or servicing work on the elec-trical equipment may only be carried out by an elec-trician.
- All protection and safety devices must be replaced after completing repair and maintenance proce-dures.
- When leaving the work place, switch off the ma-chine and disconnect the plug from the power sup-ply.
- During splitting, the properties of the wood (e.g. growths, trunk slices of irregular shape, etc.) can re-sult in hazards like ejecting parts, splitter blocking, and crushing.

## **Additional safety instructions**

- The log splitter may only be operated by one per-son.
- Wear protective gear like safety goggles or other eye protection, gloves, safety shoes etc. to protect yourself from possible injuries.

- Never split logs containing nails, wire, or other foreign objects.
- Already split wood and wood chips can be dangerous. You can stumble, slip or fall down. Keep the working area tidy.
- While the machine is switched on, never put your hands on moving parts of the machine.
- Only split logs with a maximum length of 106 cm.

**Warning!** This electric tool generates an electromagnetic field during operation. This field can impair active or passive medical implants under certain conditions. In order to prevent the risk of serious or deadly injuries, we recommend that persons with medical implants consult with their physician and the manufacturer of the medical implant prior to operating the electric tool.

### **Remaining hazards**

The machine has been built using modern technology in accordance with recognized safety rules. Some remaining hazards, however, may still exist.

- The splitting tool can cause injuries to fingers and hands if the wood is incorrectly guided or support-ed.
- Thrown pieces can lead to injury if the work piece is not correctly placed or held.
- Injury through electric current if incorrect electric connection leads are used.
- Even when all safety measures are taken, some remaining hazards which are not yet evident may still be present.
- Remaining hazards can be minimized by following the safety instructions as well as the instructions in the chapter Authorized use and in the entire operating manual.
- Health hazard due to electrical power, with the use of improper electrical connection cables.
- Release the handle button and switch off the machine prior to any operations.
- Avoid accidental starts of the machine: Do not press the start button while inserting the plug into the socket.
- Use the tools recommended in this manual to obtain the best results from your machine.
- Always keep hands away from the work area when the machine is running.

### **Technical data**

- Drive E-motor
- Motor V/Hz 230V / 50Hz
- Input P1 W 3700
- Output P2 W 2700
- Operating mode S6 40%
- Motorspeed min-1 2800
- Phase inverter yes
- Dimensions D/W/H 1030 x 990 x 2370 mm
- Log length 1060 mm
- Power max. tons\* 10
- Piston stroke 860 mm
- Forward speed cm/s 6
- Return speed cm/s 7
- Oil quantity l 9
- Weight kg 168

## Unpacking

Open the packaging and remove the device carefully. Remove the packaging material as well as the packaging and transport bracing (if available).

Check that the delivery is complete.

Check the device and accessory parts for transport damage.

In case of complaints the dealer must be informed immediately. Subsequent complaints will not be accepted.

If possible, store the packaging until the warranty period has expired.

Read the operating manual to make yourself familiar with the device prior to using it.

Only use original parts for accessories as well as for wearing and spare parts. Spare parts are available from your specialized dealer.

Specify our part numbers as well as the type and year of construction of the device in your orders.

## ATTENTION

The device and packaging materials are not toys! Children must not be allowed to play with plastic bags, film and small parts! There is a risk of swallowing and suffocation!

## Attachment / Before starting the equipment

### Mount (14) wheels (fig. 2)

Slide the wheel axle through the drilled hole on the bottom, rear end of the splitter.

Now insert the wheels on the wheel axle and fasten them with two splints.

### Mount (2) controller handles (fig. 3)

Insert the controller arm with slotted hole onto the rocker switch (b) and the drilled hole onto the threaded rod (a).

Secure the controller arm with a washer and fasten it with a spring splint pin on the rocker switch and a self-locking nut on the threaded rod.

Now fasten the other control arm on the other side in accordance with the method described

### Mount (12) holder arm (fig. 4)

Insert both holder arms into the rectangular steel tubes, which are located on the left side of the splitter. Fasten the holder arms with two M10 x 45 mm hexagon screws and self/locking nuts each.

### Mount (6) holder arm for trunk lifter (fig. 5)

Fasten the holder arm with two hexagonal screws (M10 x 25) on the frame, but do not tension the screws tightly yet. (more at 9.5)

### Mount (5) trunk lifter (fig. 6)

Fasten the trunk lifter with a hexagon screw (M10 x 55) and a self-locking nut between both of the brackets, which are located on the right, lower end of the splitter.

Next, align the holder arm (6) on the trunk lifter. A gap of approx. 0.5 – 1 mm must be present between the holder arm and trunk lifter.

Next, cut in the chain (4) on the splitting blade. (fig. 7)

## Putting the splitter into the work position

Connect the splitter to the mains power. Be aware of the motor's direction of rotation.

Lower both controller handles until the cylinder is present above the drilled holes (d) is located in the upper



position. Insert both shafts into the drilled holes and secure them with spring pins. Then bring the splitting blade to the top position and remove the support. You must store the support safely because it is needed every time the splitter is transported.

### **IMPORTANT!**

You must fully assemble the appliance before using it for the first time!

## **Initial operation**

Make sure the machine is completely and expertly assembled. Check before every use:

- The connection cables for any defective spots (cracks, cuts etc.).
- The machine for any possible damage.
- The firm seat of all bolts.
- The hydraulic system for leakage.
- The oil level.

### **Checking the oil level (fig. 9)**

The hydraulic unit is a closed system with oil tank, oil pump and control valve. Check the oil level regularly before every use. Too low an oil level can damage the oil pump. The level of oil must be checked when the riving knife is pulled back. If the oil level is at the lower notch, then the oil level is at a minimum. Should this be the case, oil must be immediately added. The upper notch indicates the maximum oil level. The machine must be on level ground. Screw in the oil dip-stick fully, to measure the oil level.

### **E- Motor**

Check the running direction of the motor. If the splitting arm is not in the top position, bring the splitting blade in the top position, using the return bracket or handles. If the splitting arm is already in the top position, activate the splitting mechanism by moving both levers down. This will move the splitting arm down. 22 | GB If the splitting blade does not move despite activation of the handles or return bracket, immediately turn off the machine. Turn the pole reversing unit in the plug-in module (Fig. 10) to change the rotational direction of the motor.

Never let the motor run in the wrong direction! This will inevitably destroy the pump system and no warranty claim can be made.

### **Functional test**

Test the function before every use.

Push both handles towards below.	Splitting knife goes down to approx. 20 cm above the table.
Let one handle loose, then the other.	Splitting knife stops in the desired position.

### **Warning!**

Loosen the filling screw (d) before commissioning.

Never forget to loosen the filling screw! Otherwise, the air in the system will constantly be compressed and decompressed with the result that the seals of the hydraulic circuit will be destroyed and the wood splitter can no longer be used. In this case, the seller and the manufacturer will not be liable to warranty services.

### **Switching on and off (10)**

Press the green button for switching on.

Press the red button for switching off.

**Note:** Check the function of the ON/OFF unit before every use by switching on and off once.

Restarting safety in case of current interruption (no-volt release).

In case of current failure, inadvertent pulling of the plug, or a defective fuse, the machine is switched off automatically.

For switching on again, press anew the green button of the switch unit.

## **Splitting**

- If the outside temperature is below 5°C, let the machine run idle for about 5 minutes so the hydraulic system reaches its operating temperature. Place the log under the splitting blade vertically. Caution: The splitting blade is very sharp. Risk of injury!
- When you push both operating levers down, the splitting blade goes down and splits the wood.
- Only ever split logs that have been sawn off straight.
- Split the log vertically.
- Never split it lying down or diagonally to the grain!
- Wear suitable gloves and safety boots when splitting wood.
- Split very misshapen logs from the edge. Caution: During splitting, some logs can be under significant tension and suddenly break.
- Force jammed logs out by applying pressure in the splitting direction or by raising the riving knife. In this case, only push the handles up, do not use the return bracket. Caution: Risk of injury

## **Operating the log lifter (5)**

General information about the log lifter:

- For safety reasons, the log lifter chain may only be hung on the splitting blade with the last link.
- Ensure that nobody else is within the working environment of the log lifter.

## **Operating the log lifter:**

- Loosen the log lifter restraining the lifting tube can move freely.
- Move the splitting blade so far down that the log lifter lifting tube lies on the ground.
- Now align the log, push it against the retention thorn and split it (see: Operating instructions).
- Then remove the split wood and move the riving knife and therefore the log lifter back down.
- Now you can roll a new log onto the log lifter.

## **Resetting the log lifter**

This is used as a second guard arm when not using the trunk lifter. For this, the arm is moved up until it locks in. Transport position of the log lifter:

- Using your hand, move the log lifter up until it locks in position.

Comply with these notices to ensure quick and safe work.

## **Electrical connection**

The electrical motor installed is connected and ready for operation. The connection complies with the applicable VDE and DIN provisions.

The customer's mains connection as well as the extension cable used must also comply with these regulations.

Damaged electrical connection cable

The insulation on electrical connection cables is often damaged.

This may have the following causes:

- Passage points, where connection cables are passed through windows or doors.
- Kinks where the connection cable has been improperly fastened or routed.
- Places where the connection cables have been cut due to being driven over.
- Insulation damage due to being ripped out of the wall outlet.
- Cracks due to the insulation ageing.

Such damaged electrical connection cables must not be used and are life-threatening due to the insulation damage.

Check the electrical connection cables for damage regularly. Make sure that the connection cable does not hang on the power network during the inspection.

Electrical connection cables must comply with the applicable VDE and DIN provisions. Only use connection cables with the marking „H07RN“.

The printing of the type designation on the connection cable is mandatory.

For single-phase AC motors, we recommend a fuse rating of 16A (C) or 16A (K) for machines with a high starting current (starting from 3000 watts)!

Three-phase motor 400 V / 50 Hz

Mains voltage 400 V / 50 Hz

Mains voltage and extension cables must be 5-lead (3P + N + SL (3/N/PE)). Extension cables must have a minimum cross-section of 1.5 mm<sup>2</sup>. Mains fuse protection is 16 A maximum.

When connecting to the mains or relocating the machine, check the direction of rotation (swap polarity in the wall socket if necessary). Turn pole inverter in the machine socket.

## **Cleaning**

### **Attention!**

Pull out the power plug before carrying out any cleaning work on the equipment.

We recommend that you clean the equipment immediately after you use it.

Clean the equipment regularly with a damp cloth and some soft soap. Do not use cleaning agents or solvents; these may be aggressive to the plastic parts in the equipment. Ensure that no water can get into the interior of the equipment.

## **Transport**

Before transporting the kindling splitter, ensure it is in the transport position. To do this, lower the riving knife until it rests on the metal support. Next, remove both shafts and allow the cylinder to move down-

wards finally. You can set the splitter onto a palette

with the help of a crane, but never lift the splitter by the splitting blade. The top part of the splitter features an eyelet, where the crane hook may be engaged.

## **Storage**

Store the device and its accessories in a dark, dry and frost-proof place that is inaccessible to children. The optimum storage temperature is between 5 and 30°C.

Cover the electrical tool in order to protect it from dust and moisture.

Store the operating manual with the electrical tool.

## **Maintenance**

### **Attention!**

Pull out the power plug before carrying out any maintenance work on the equipment. Make sure that the drive shaft is not connected to the traction unit.

When must the oil be changed?

First oil change after 50 operating hours, then every 250 operating hours.

### **Oil change**

Position the kindling splitter on a slightly raised sur-

face (e.g. euro pallet). Place a sufficiently large container (at least 15 litres) under the drain plug on the splitting column. Open the drain plug and carefully let the oil run into the container.

Open the filling screw on the top of the splitting column so the oil can drain more easily. Re-place the drain plug and its seal and tighten it.

Pour in fresh hydraulic oil (Contents: see Technical data) and check the oil level with the dipstick. After changing the oil, operate the kindling splitter a few times without actually splitting.

Warning! Ensure that no debris gets into the oil container.

Dispose of the used oil in a correct manner at a public collection facility. It is prohibited to drop old oil on the ground or to mix it with waste.

We recommend oil from the HLP 32 range.

### **Hydraulic system**

The hydraulic unit is a closed system with oil tank, oil pump and control valve. 24 | GB The system is complete when the machine is delivered, and may not be changed or manipulated.

### **Connections and repairs**

Connections and repairs of electrical equipment may only be carried out by an electrician.

**ATTENTION !** Observe the correct direction of rotation when inserting the saw blade.

Please provide the following information in the event of any enquiries:

- Type of current for the motor
- Machine data – type plate
- Machine data – type plate

### **Service information**

Please note that the following parts of this product are subject to normal or natural wear and that the following parts are therefore also required for use as consumables.

Wear parts\*: hydraulic oil, splitting wedge, Transmission oil

\* Not necessarily included in the scope of delivery!

### **Disposal and recycling**

The equipment is supplied in packaging to prevent it from being damaged in transit. The raw materials in this packaging can be reused or recycled. The equipment and its accessories are made of various types of material, such as metal and plastic.

Defective components must be disposed of as special waste. Ask your dealer or your local council.

Old devices must not be disposed of with household waste!

This symbol indicates that this product must not be disposed of together with domestic waste in compliance with the Directive (2012/19/EU) pertaining to waste electrical and electronic equipment (WEEE). This product must be disposed of at a designated collection point. This can occur, for example, by handing it in at an authorized collecting point for the recycling of waste electrical and electronic equipment. Improper handling of waste equipment may have negative consequences for the environment and human health due to potentially hazardous substances that are often contained in electrical and electronic equipment. By properly disposing of this product, you are also contributing to the effective use of natural resources. You can obtain information on collection points for waste equipment from your municipal administration, public waste disposal authority, an authorized body for the disposal of waste electrical and electronic equipment or your waste disposal company.

## Troubleshooting

The table below contains a list of error symptoms and explains what you can do to solve the problem if your tool fails to work properly. If the problem persists after working through the list, please contact your nearest service workshop.

Malfunction	Possible cause	Remedy
The hydraulic pump does not start	No electric power	Check cable for electric power
	Thermal switch of motor cut off	Engage thermal switch inside the motor casing again
The column does not move down	Low oil level	Check oil level and refill
	One of the levers not connected	Check fixing of lever
	Dirt in the rails	Clean the column
Motor starts but column does not move down	Wrong turning direction of 3-phase motor	Check turning direction of motor and change

## Documents / Resources

	<p><a href="#">scheppach HL1020 Log Splitter</a> [pdf] Instruction Manual HL1020 Log Splitter, HL1020, Log Splitter, Splitter</p>
---	---

## References

-  [scheppach | scheppach](#)