



scheppach Compact 8t Meter Log Splitter With Swivel Table Instruction Manual

[Home](#) » [Scheppach](#) 

Contents

- [1 scheppach Compact 8t Meter Log Splitter With Swivel Table](#)
- [2 Product Information](#)
- [3 Product Usage Instructions](#)
- [4 Introduction](#)
- [5 Device description](#)
- [6 Scope of delivery](#)
- [7 Proper use](#)
- [8 General safety information](#)
- [9 Technical data](#)
- [10 Unpacking](#)
- [11 Assembly / Before commissioning](#)
- [12 Startup](#)
- [13 Working instructions](#)
- [14 Maintenance and repairs](#)
- [15 Transport](#)
- [16 Electrical connection](#)
- [17 Disposal and recycling](#)
- [18 Troubleshooting](#)
- [19 Documents / Resources](#)
 - [19.1 References](#)



scheppach Compact 8t Meter Log Splitter With Swivel Table



Product Information

The product is a log splitter with the model numbers Art. № 5905419901, 5905419902, 5905423901, and 5905423902. It is available in Compact 8t and Compact 10t variants. The product comes with an original instruction manual in German, English, Slovak, Polish, Croatian, and Slovenian languages. It has a total of 19 parts that are shown in various figures in the manual.















Product Usage Instructions







1. Before using the machine, read the instruction manual carefully.
2. Wear safety shoes, work gloves, and a protective helmet while operating the log splitter.
3. Smoking is strictly prohibited in the working area.
4. Familiarize yourself with the two-hand lever operation before starting the machine.
5. Check the motor's rotating direction before using the machine.
6. Refer to the table of contents to find the specific information you require from the manual.
7. The product comes with 2x oil bottles. Use them before starting the machine.
8. Follow the instructions given in section 8 for assembly and pre-operation checks.
9. Refer to section 9 for instructions on starting and operating the log splitter.
10. Follow the work guidelines given in section 10 to ensure the safe and efficient use of the machine.
11. Refer to section 11 for maintenance and repair instructions.

12. Section 12 provides guidelines for storing the product when not in use.
13. Refer to section 13 for information on transporting the machine.
14. Section 14 provides instructions for connecting the machine to an electrical source.

Explanation of the symbols on the device

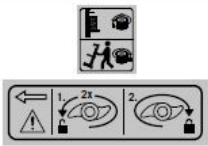
Symbols are used in this manual to draw your attention to potential hazards. The safety symbols and the accompanying explanations must be fully understood. The warnings themselves will not rectify a hazard and cannot replace proper accident prevention measures.

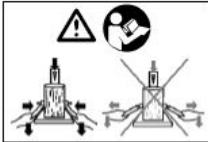
	Read the handbook before commissioning
	Use safety shoes
	Use work gloves
	Use hearing protection and safety goggles
	Use safety helmet
	No access for unauthorised persons
	No smoking in the work area
	Do not let hydraulic oil run onto the floor
	Keep the work area orderly! Disorder can lead to accidents!
	If a crane is used, place the lifting belt around the housing. Never lift the firewood splitter by the handle. (see Fig. 16) 16)
	Dispose of the used oil properly (waste oil collection point on site). Dumping used oil in the soil or mixing it with waste is prohibited.
	Removing or modifying protective or safety equipment is prohibited.
	Only the operator may stand in the working area of the machine. Keep uninvolved persons as well as pets and livestock away from the danger zone (minimum distance 5 m).
	Do not remove jammed trunks with your hands.
	Attention! Before starting repair, maintenance and cleaning work, switch off the engine and unplug the mains plug.

	Cutting and crushing hazard; never touch hazardous areas when the splitting blade is moving.
	High voltage, risk of death!
	The machine may only be operated by one person!
	Before starting work, loosen the bleeder screw by approx. 2 turns. Close before transport.
	Caution! Moving tools!
	Do not transport the device lying on its side!
	Familiarise yourself with the two-hand lever operation before commissioning the machine! Read the usage instructions carefully.
	Direction of rotation of the motor

Introduction

Manufacturer:

- Scheppach GmbH
- Günzburger Straße 69
- D-89335 Ichenhausen

Dear Customer

- We hope your new tool brings you much enjoyment and success.

Note:

In accordance with the applicable product liability laws, the manufacturer of this device assumes no liability for damage to the device or caused by the device arising from:

- Improper handling,
- Non-compliance with the operating manual,
- Repairs carried out by third parties, unauthorized specialists.
- Installing and replacing non-original spare parts
- Application other than specified
- Failure of the electrical system in the event of the electrical regulations and VDE provisions 0100, DIN 13 / VDE0113 not being observed

Please consider:

- Read through the complete text in the operating manual before installing and commissioning the device. The operating manual is intended to help the user to become familiar with the machine and take advantage of its application possibilities in accordance with the recommendations.
- The operating manual includes important instructions for safe, proper, and economical operation of the device, for avoiding danger, for minimizing repair costs and downtimes, and for increasing the reliability and extending the service life of the device.
- In addition to the safety instructions in this operating manual, you must also observe the regulations applicable to the operation of the device in your country. Keep the operating manual package with the machine at all times and store it in a plastic cover to protect it from dirt and moisture.
- They must be read and carefully observed by all operating personnel before starting the work.
- The device may only be used by personnel who have been trained to use it and who have been instructed with respect to the associated hazards.
- The required minimum age must be observed.

In addition to the safety instructions in this operating manual and the separate regulations of your country, the generally recognized technical rules relating to the operation of such machines must also be observed. We accept no liability for accidents or damage that occur due to a failure to observe this manual and the safety instructions.

Device description

1. Handle
2. Riving knife
3. Splitting column
4. Retaining claw
5. Hoop guard
6. Control arm
7. Handle guard
8. Control lever
9. Swivel table
10. Locking hooks
11. Supports
 - **a.** M10x25 hexagonal bolt
12. Ventilation cap
13. Base plate
14. Wheels
 - **a.** Wheel axle
 - **b.** Washer
 - **c.** Safety cap
 - **d.** Split pin
15. Switch and connector
16. M10x60 hexagonal bolt with washer and hexagonal nut
 - **16a.** Stroke setting bar
17. Motor

- **a.** Cotter pin
- **b.** Retaining bolt
- **c.** Rocker switch
- **d.** Stop screw
- **e.** Locking screw (stroke setting bar)
- **f.** Cap nut (stroke setting bar)
- **A.** Pre-assembled device unit
- **B.** Control arms right/left
- **C.** Operating manual

Only for compact 10t

18. Stop lever

19. Trunk lifter

- **a.** M12x70 hexagonal bolt with washer and hexagonal- on nut

20. Chain

21. Locking lever

- **a.** M10x55 hexagonal bolts with hexagonal nut 21b. Grid

22. Chain hook

- M12x35 hexagonal bolts with washer and hexagonal- onal nut

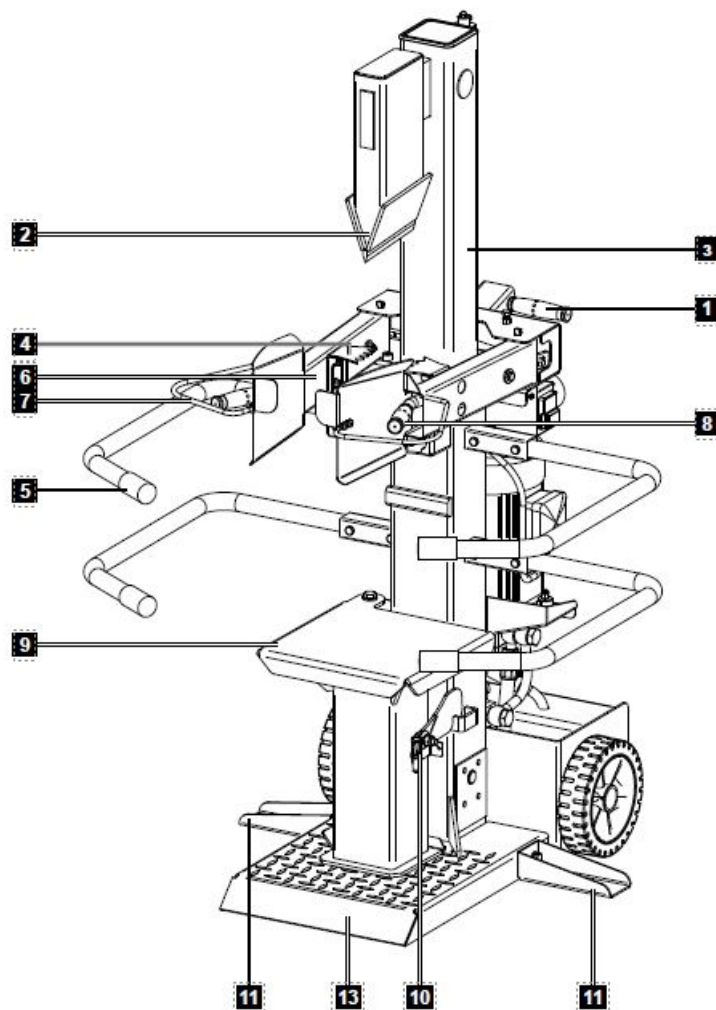

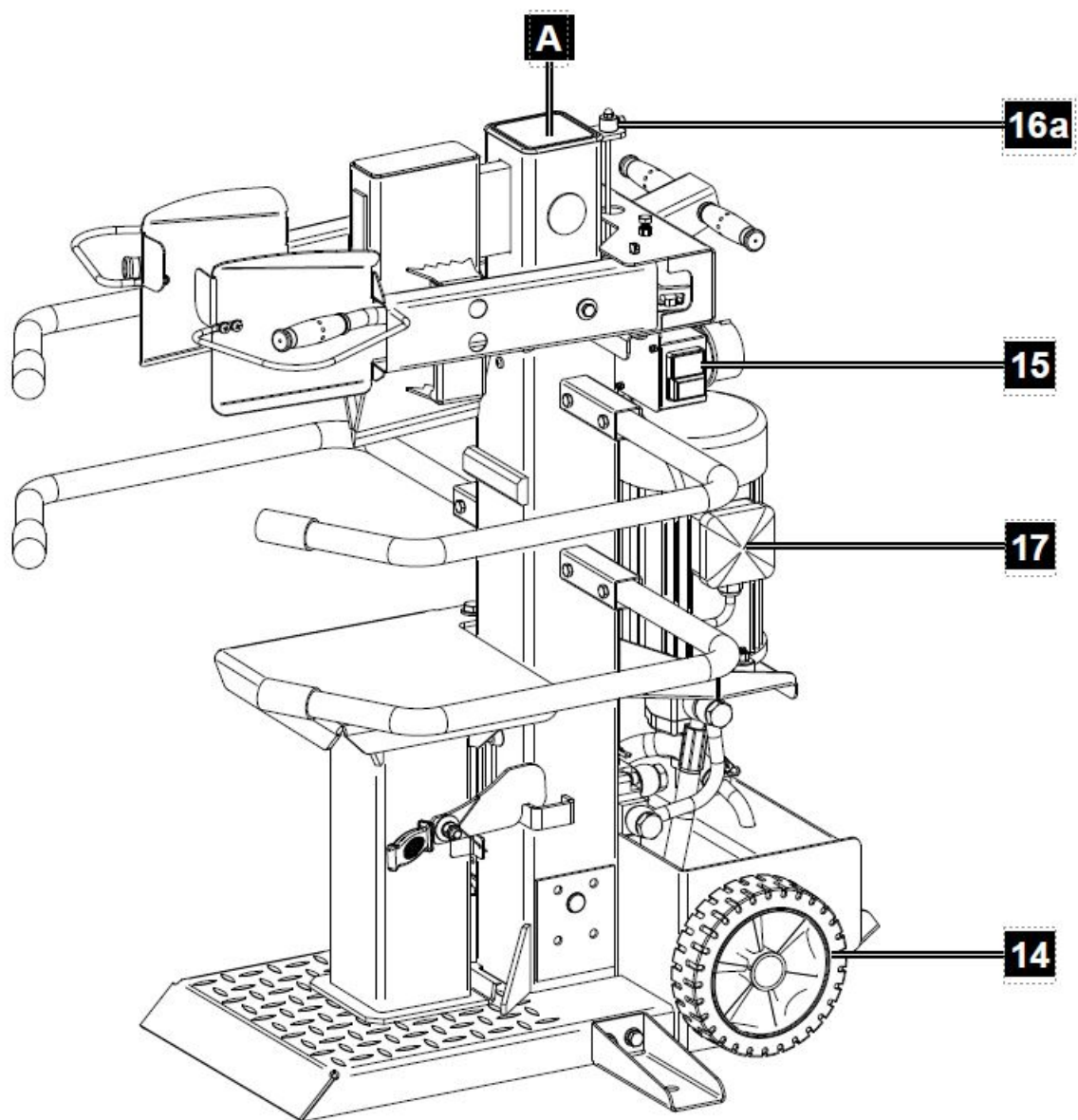

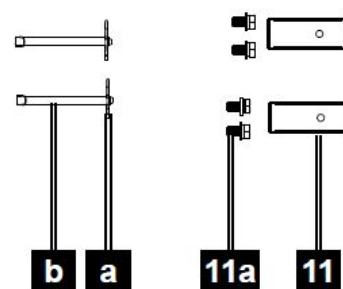
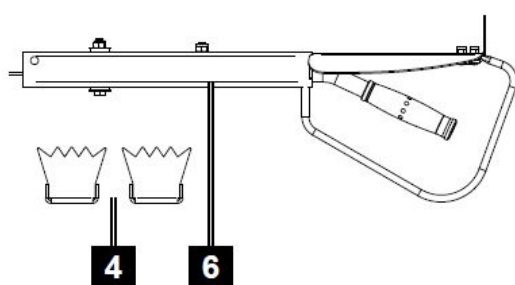
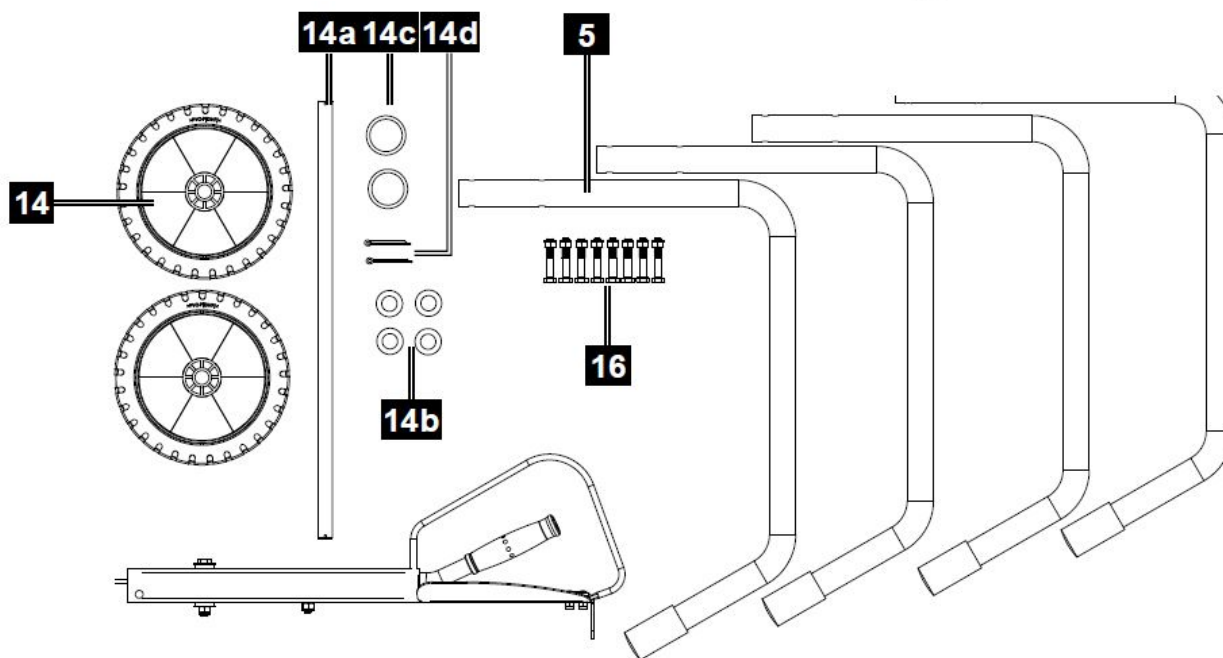
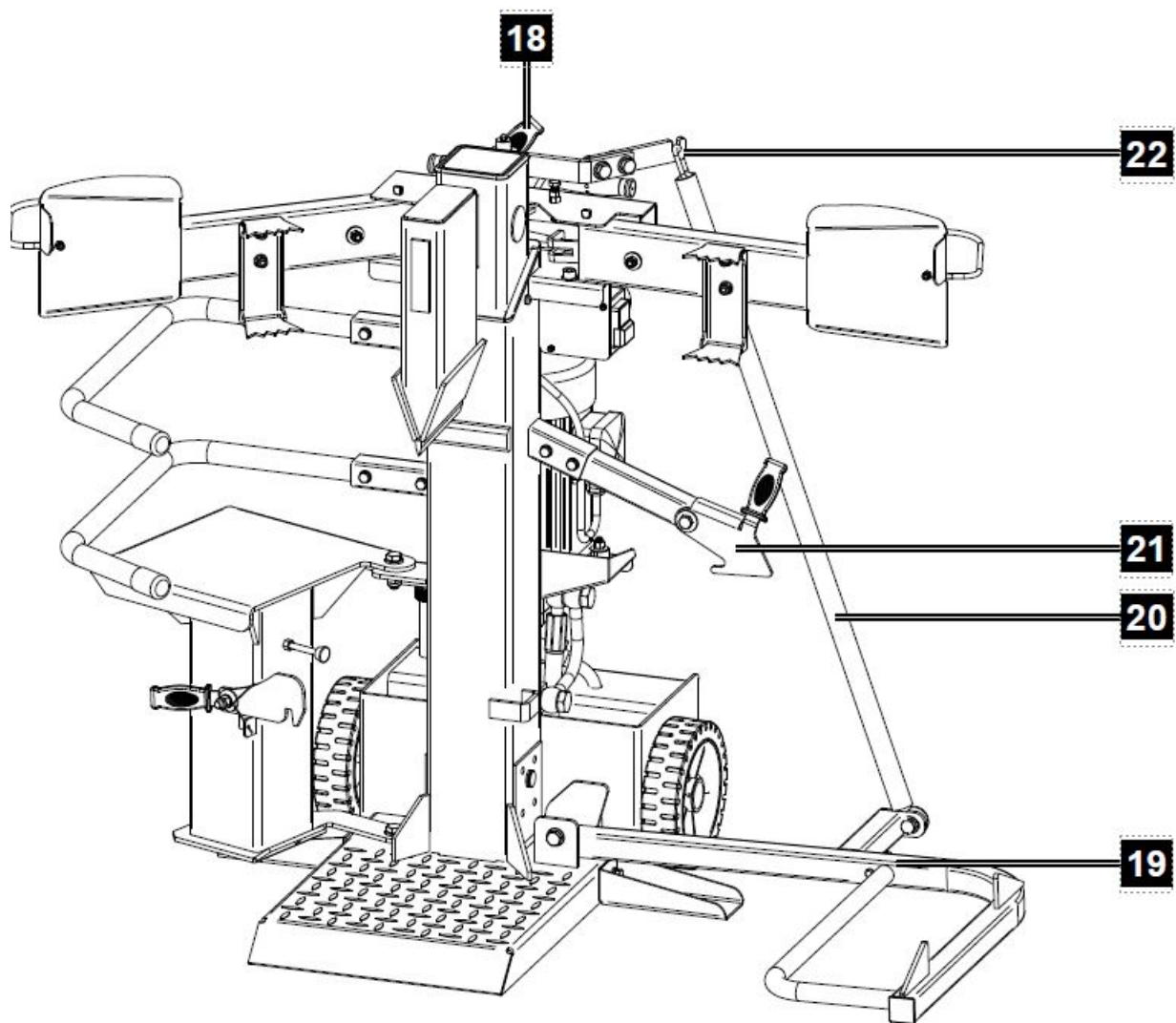

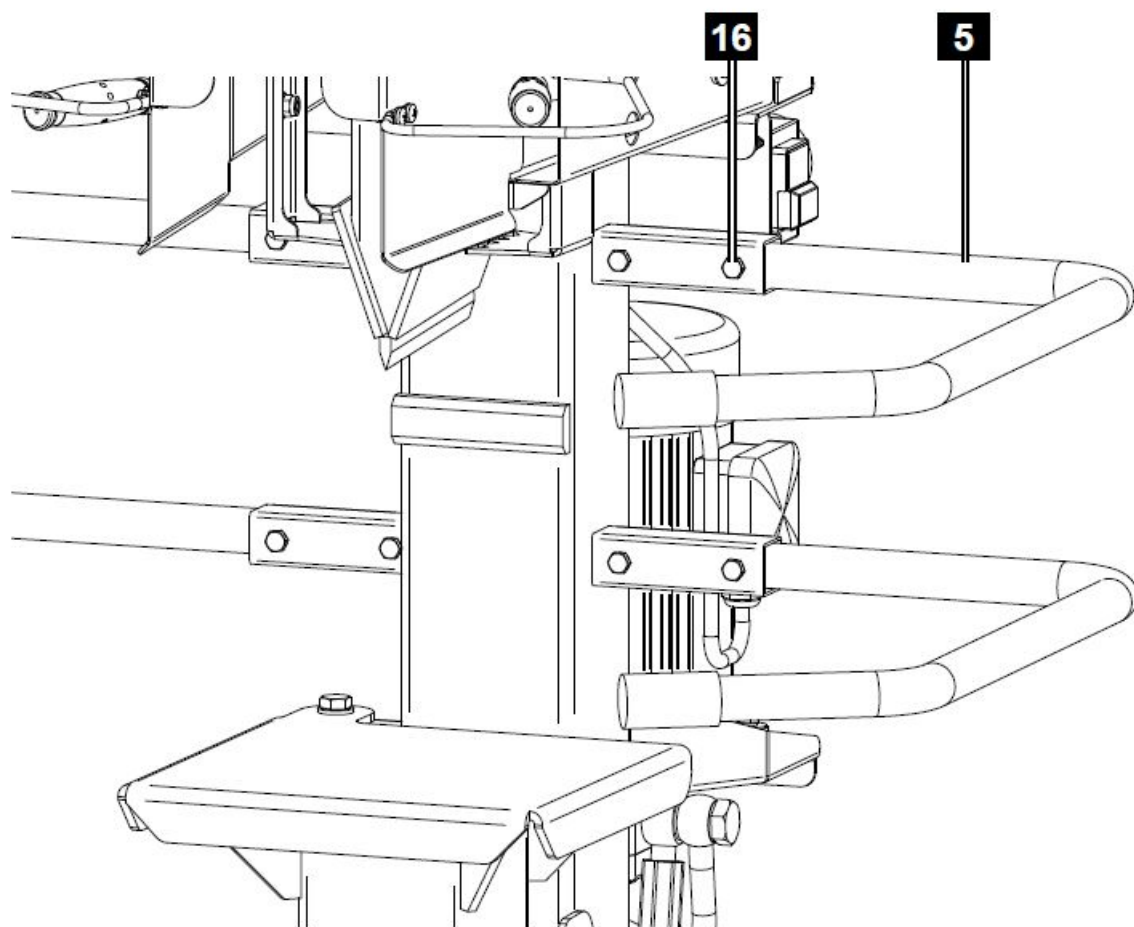
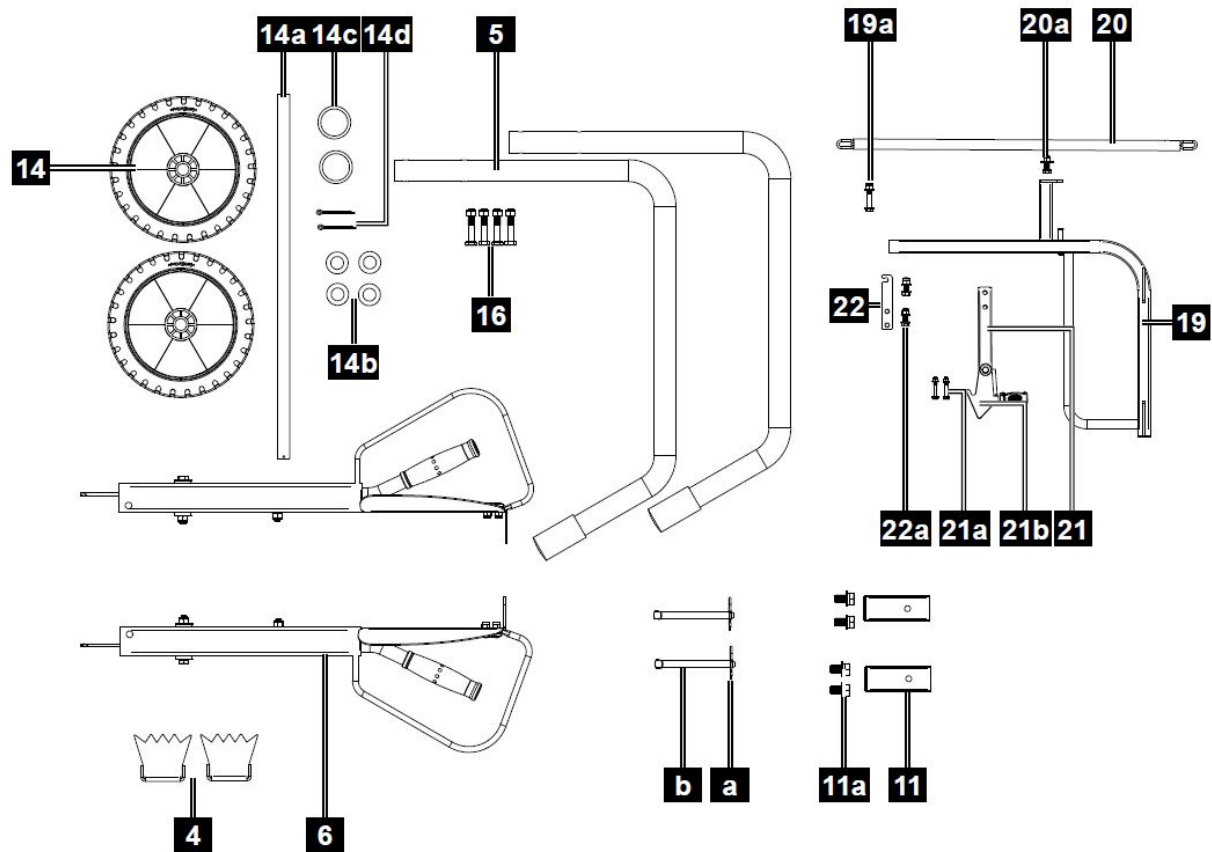

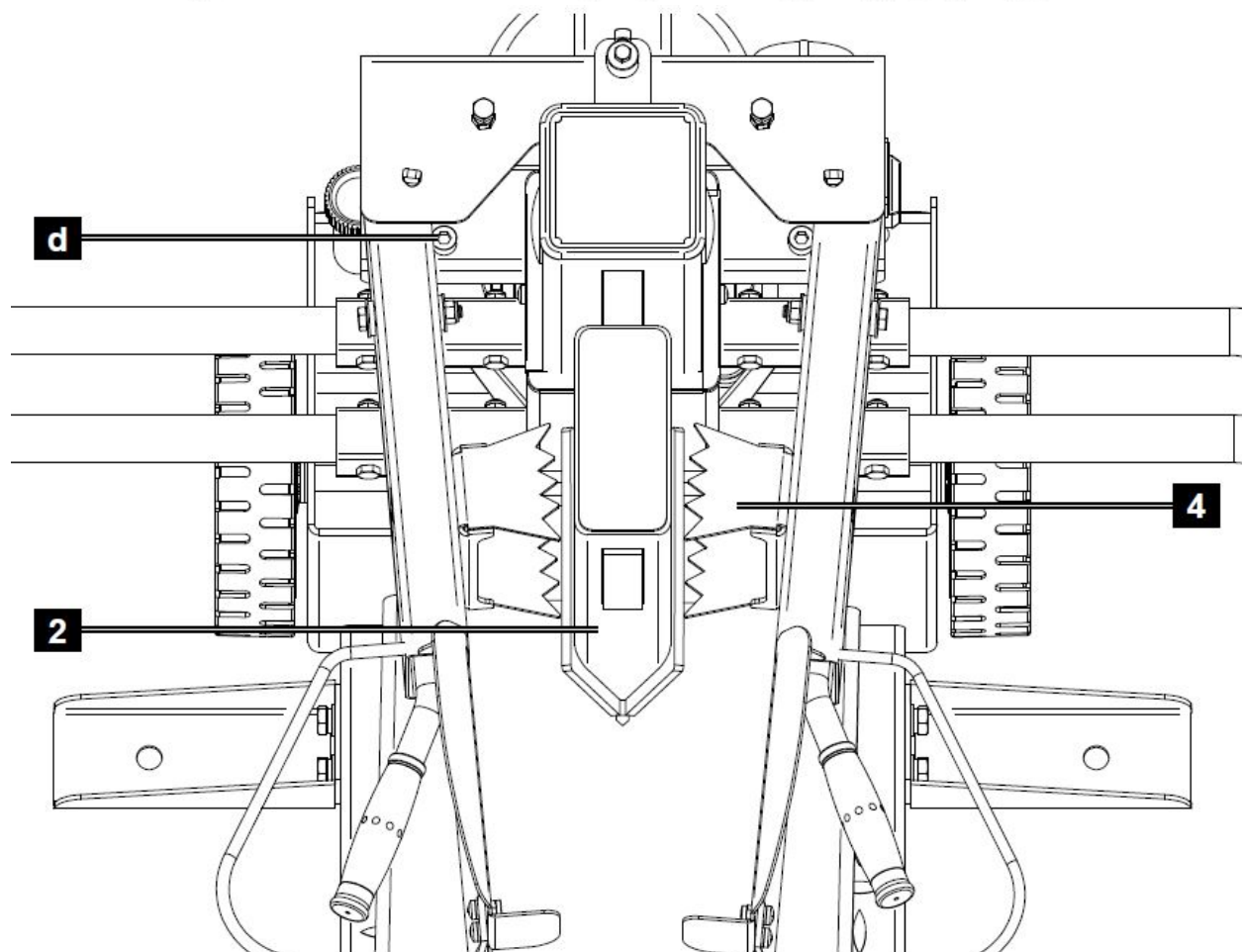
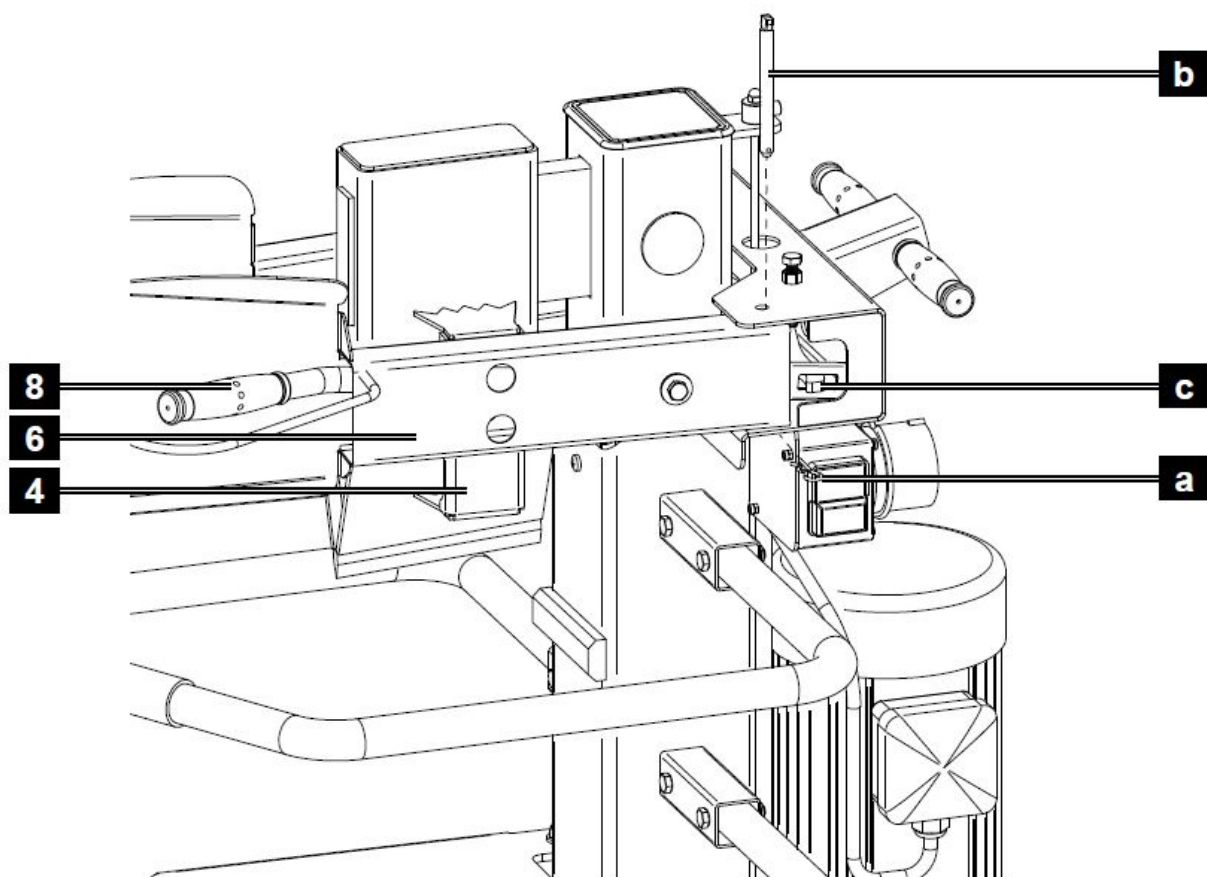

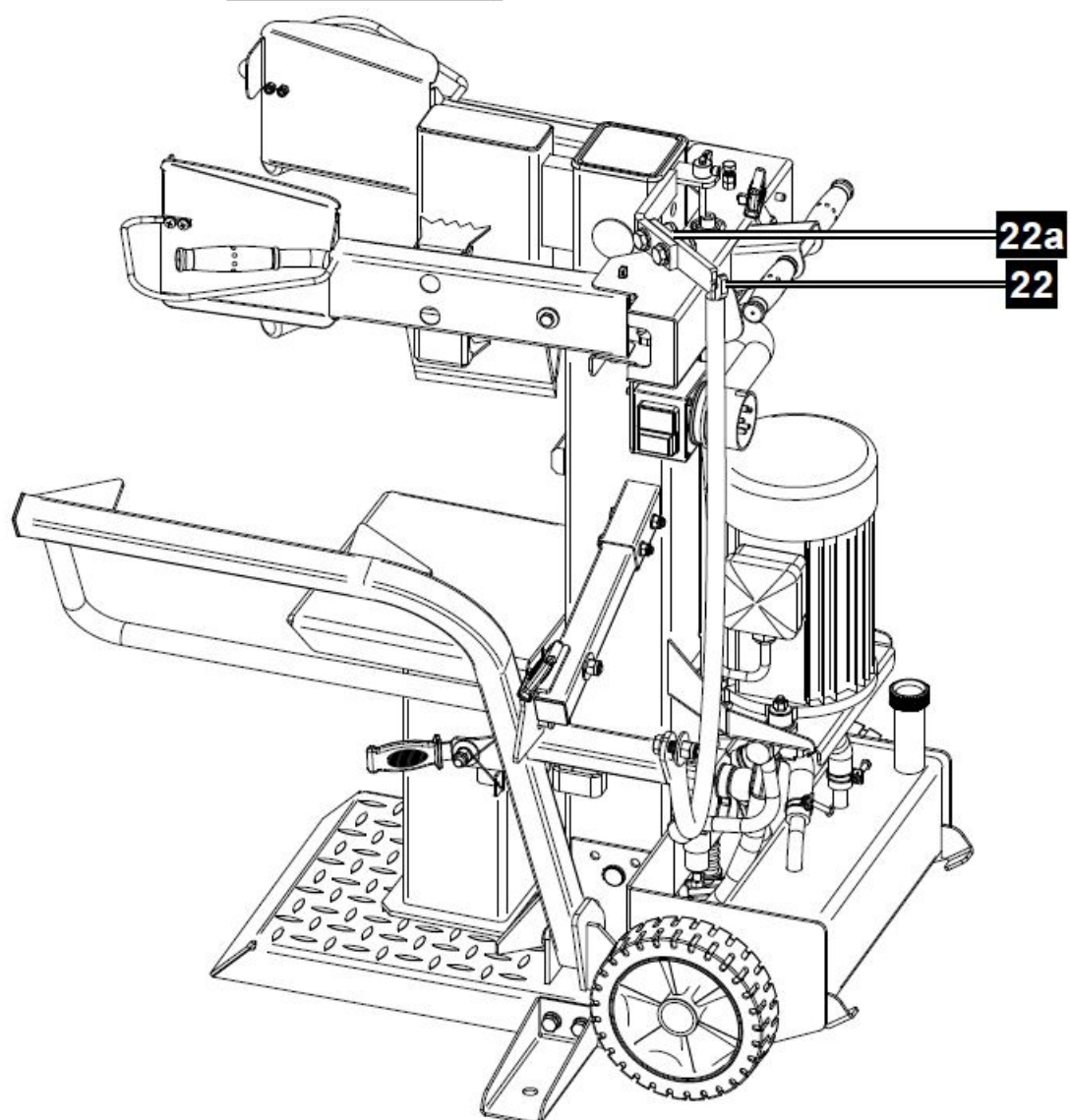
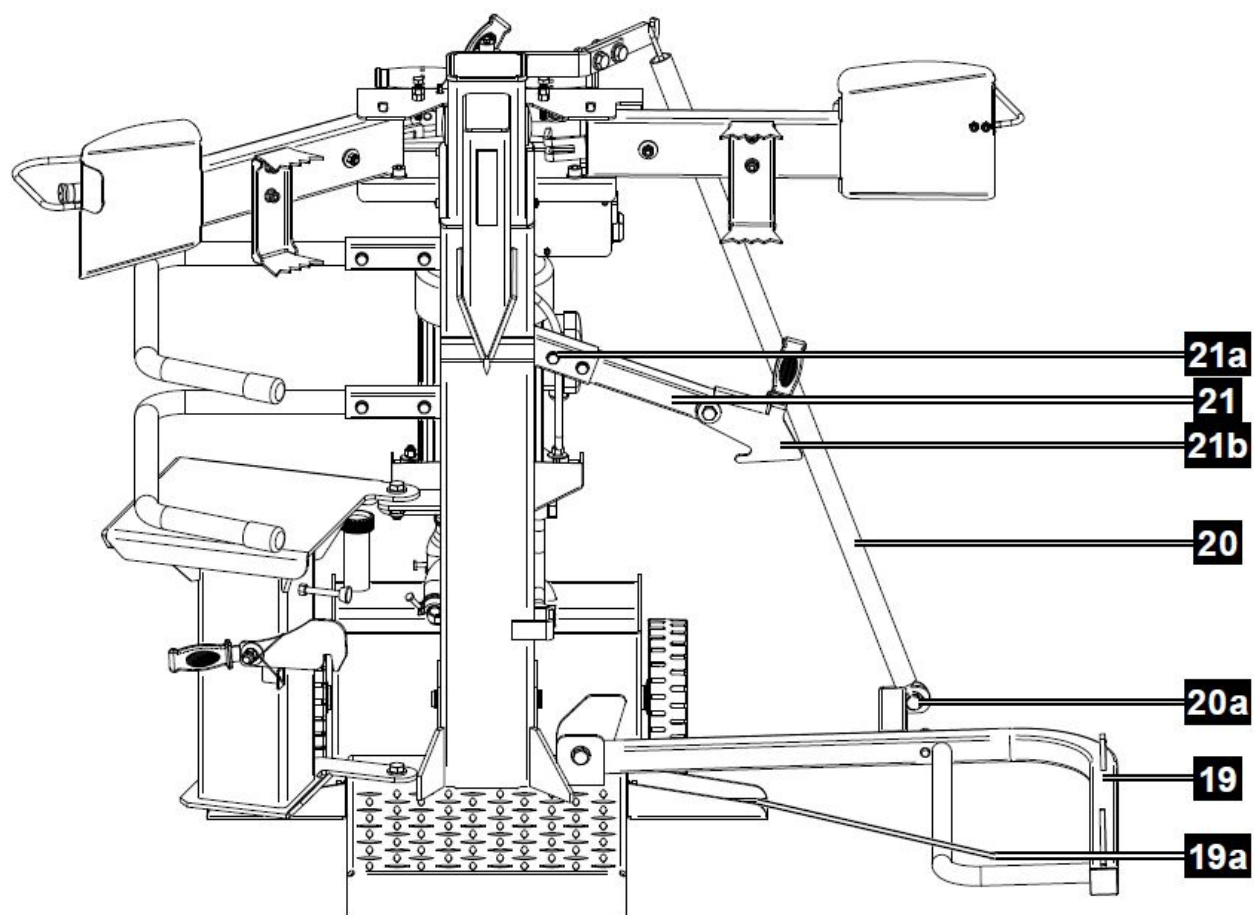

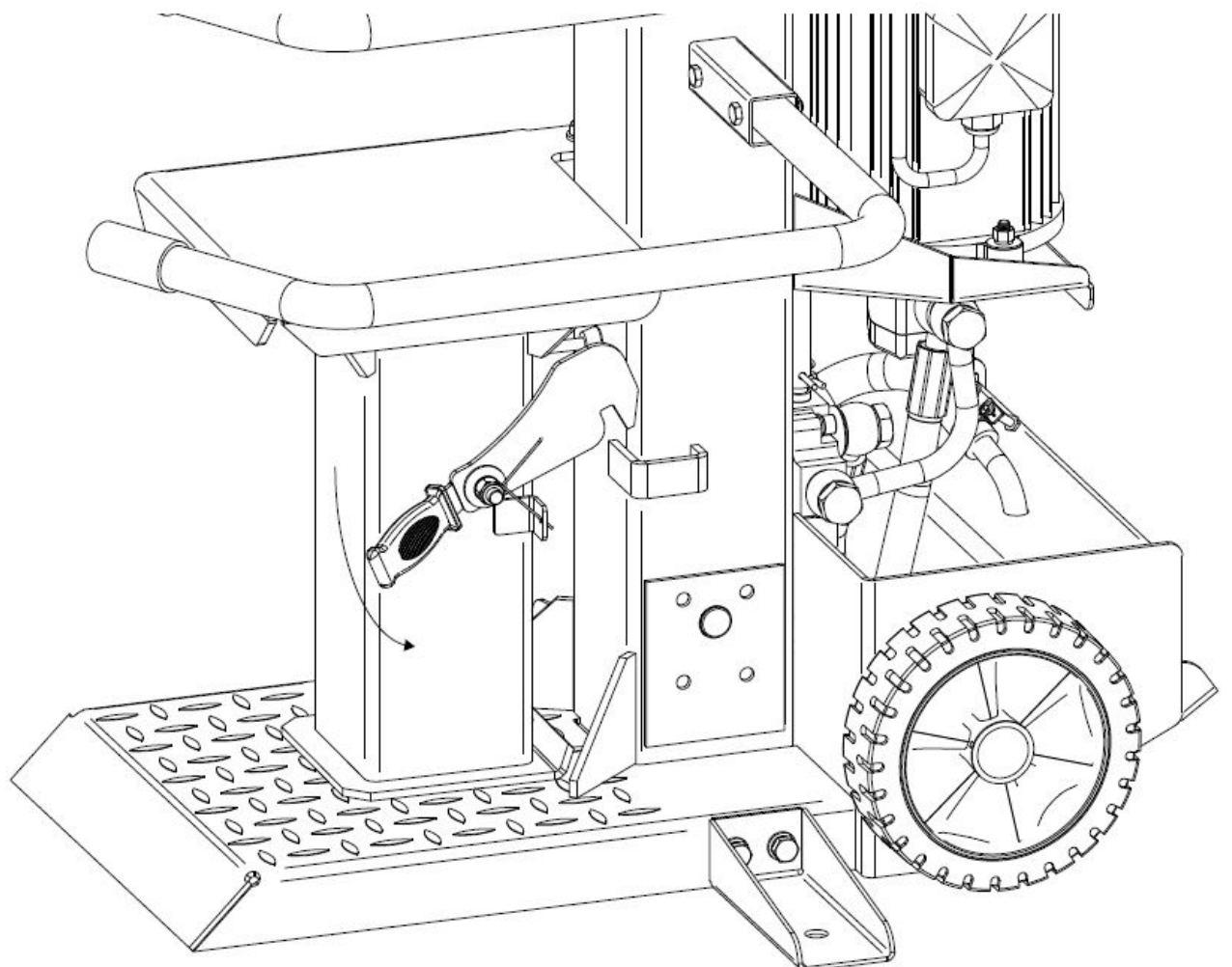
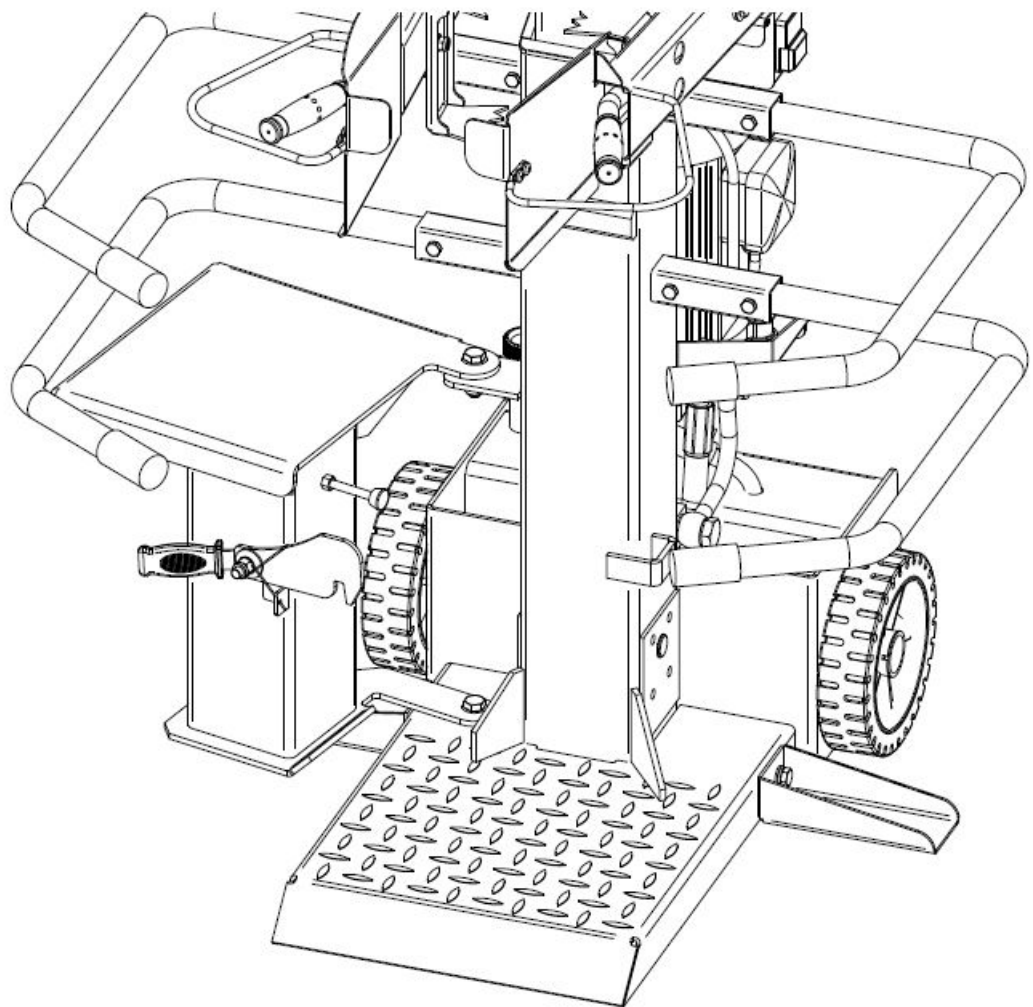

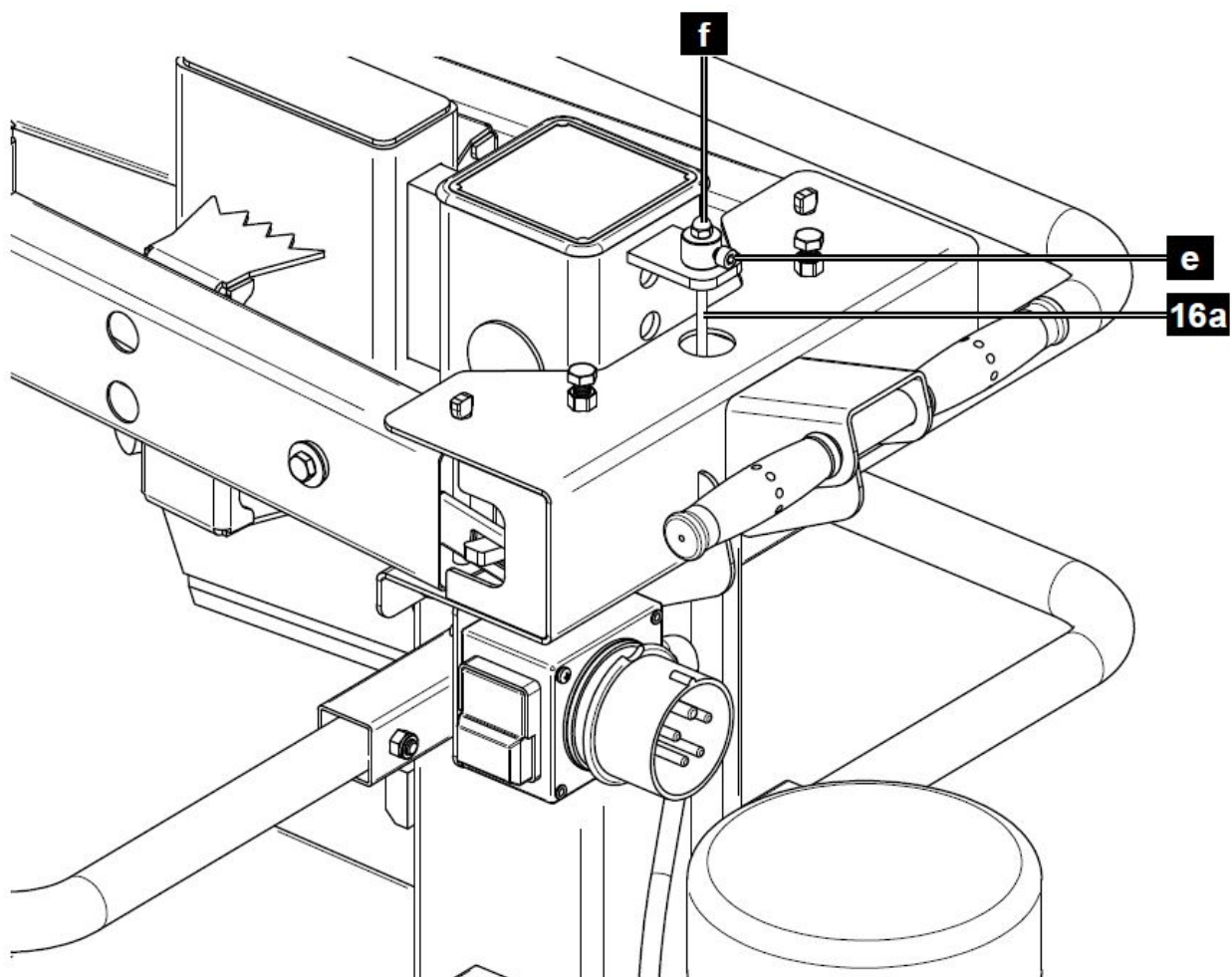

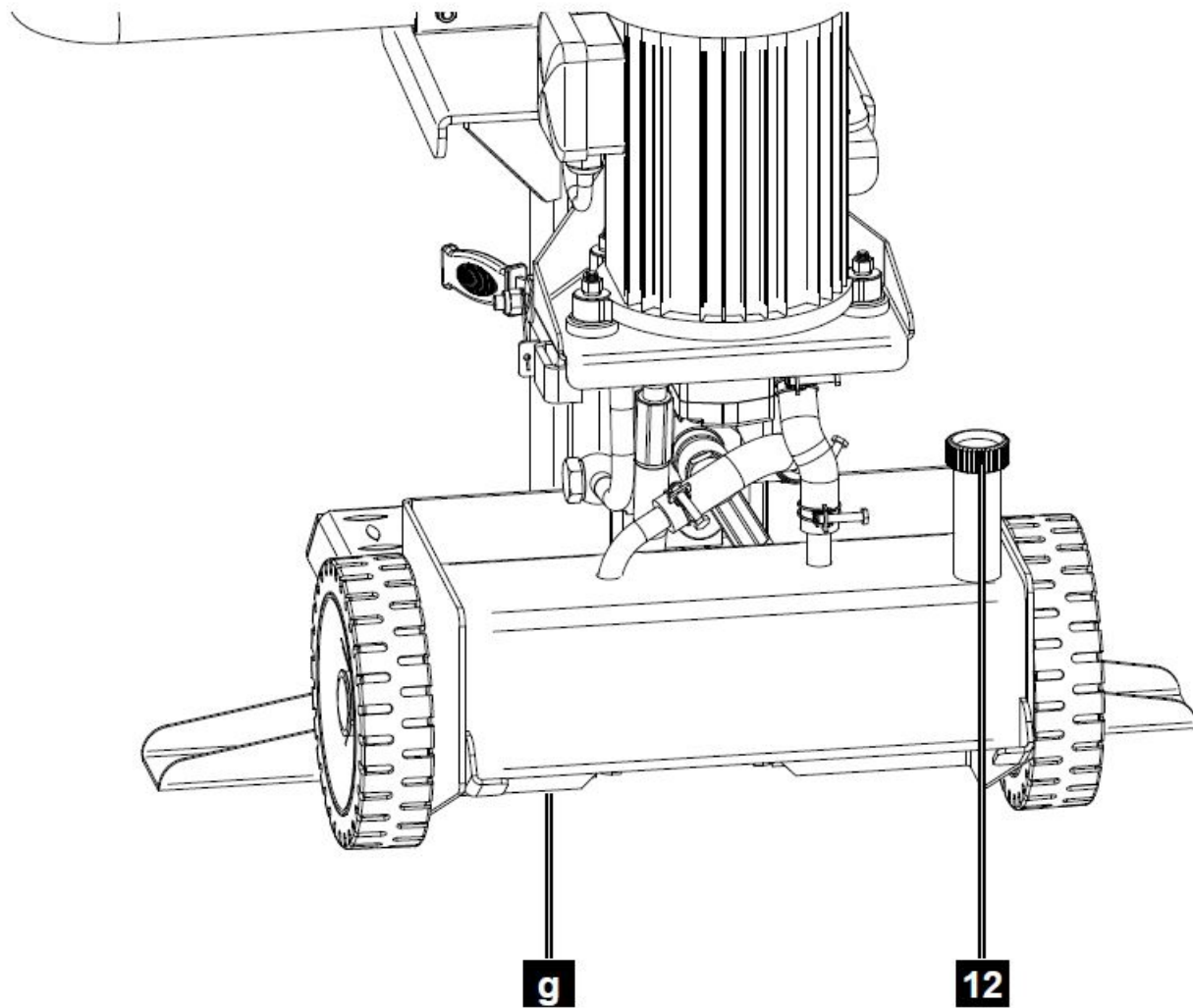

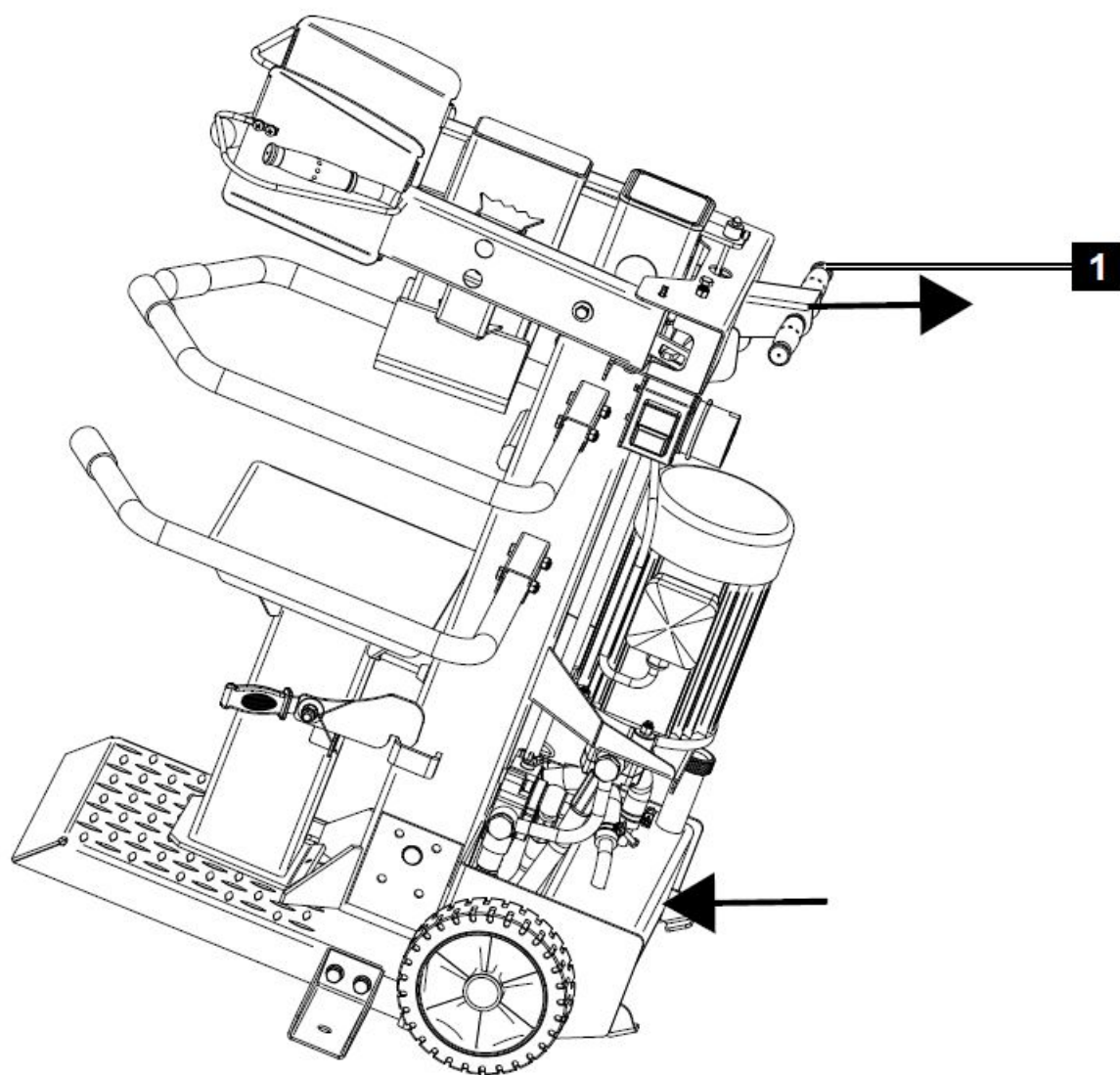

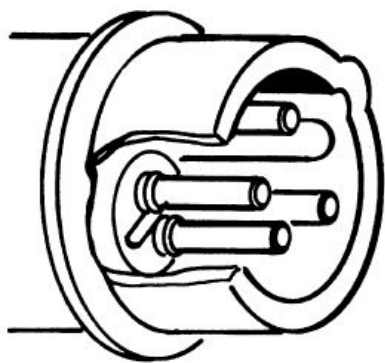
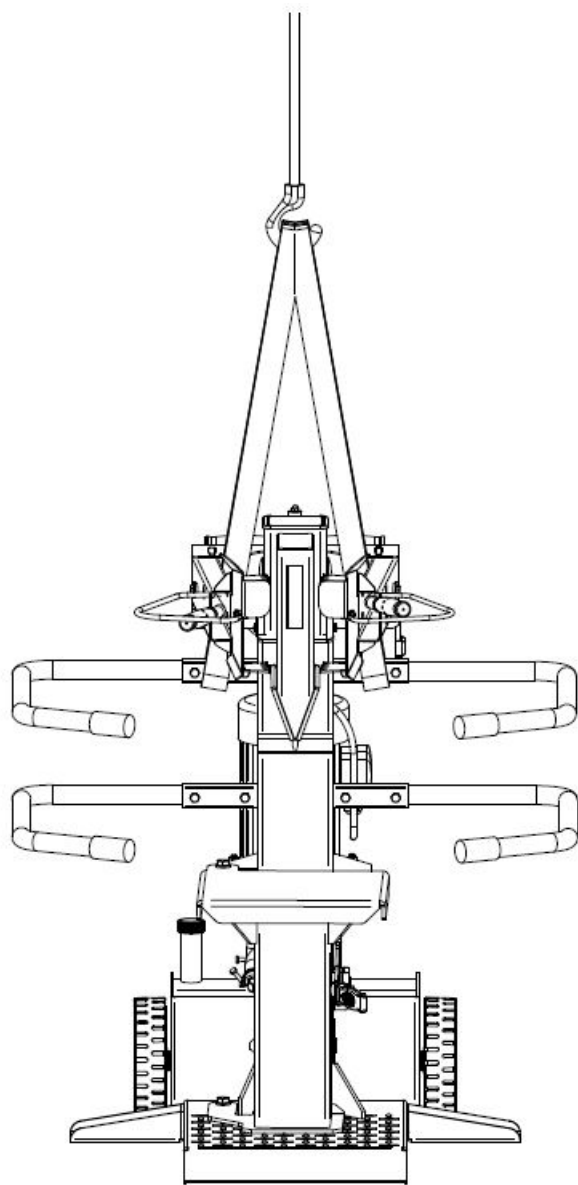

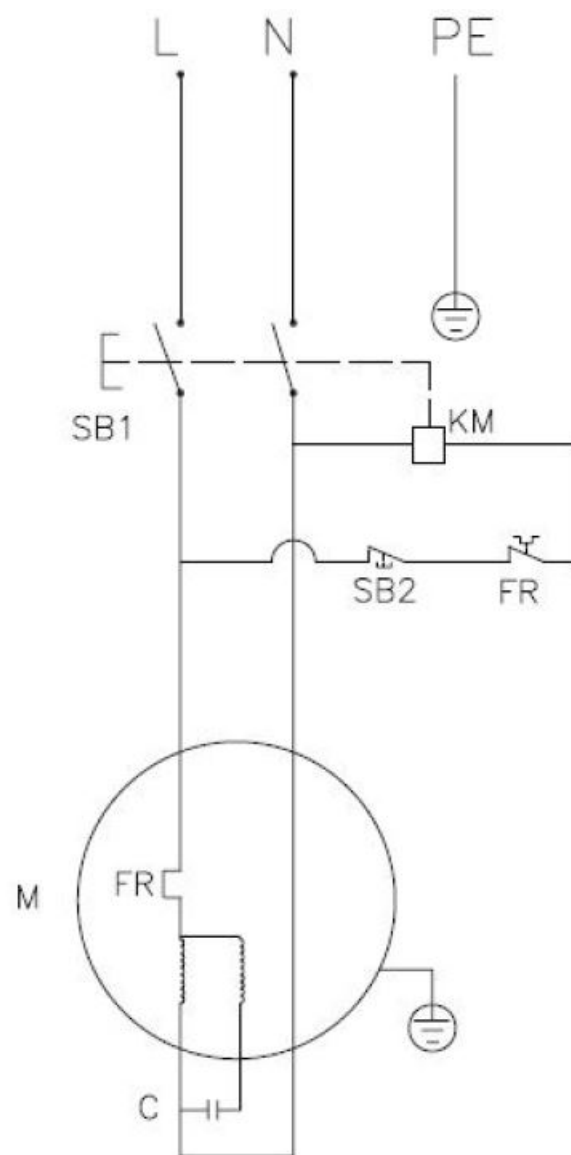

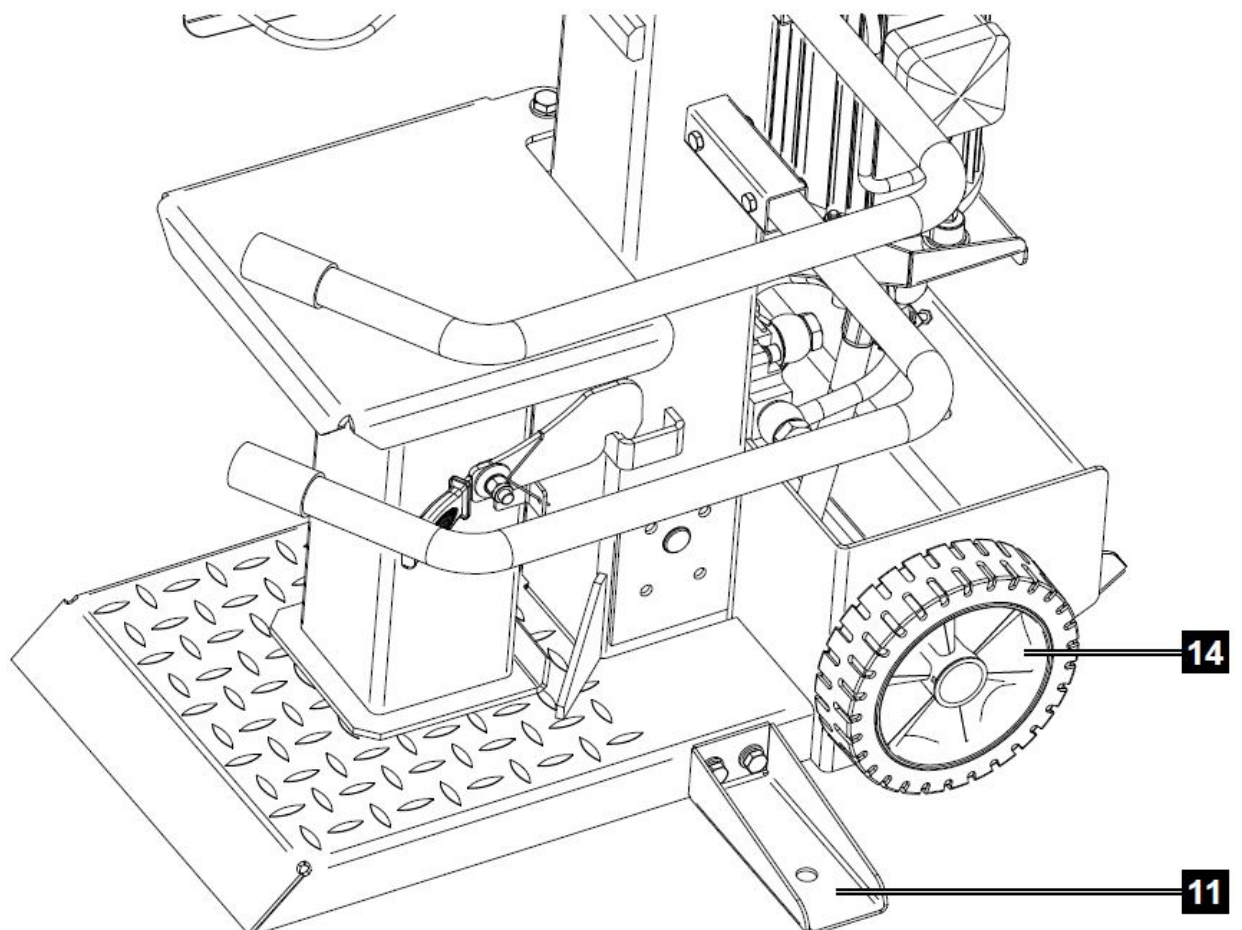
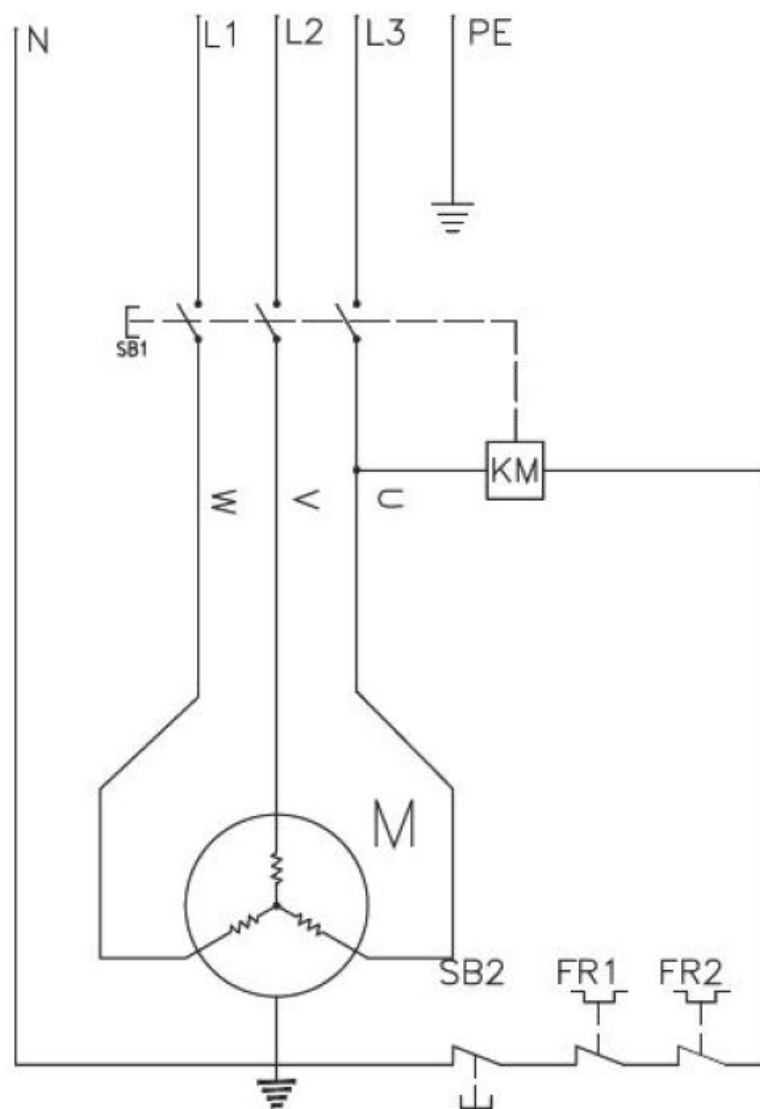

Scope of delivery

- Hydraulic log splitter (1x)
- Small parts/enclosed accessories bag (1x)
- Control arms (2x)
- Wheel axle (1x)
- Wheels (2x)
- Nozzle (2x)
- Operating manual (1x)

Only for compact 8t

- Hoop guard with assembly material (4x)

Only for compact 10t

- Hoop guard with assembly material (2x)
- Chain hook
- Trunk lifter
- Chain
- Locking lever

Proper use

The log splitter is designed exclusively for chopping firewood in the direction of the grain. Taking into account the technical data and safety instructions. When splitting, make absolutely sure that the wood to be split only rests on the checker plate of the floor plate or on the checker plate of the splitting table. The hydraulic log splitter can only be used for standing operations. Timbers may only be split standing in the direction of the grain. The dimensions of the timbers to be split:

- Max. timber length 107 cm
- **Compact 8t:** Ø min. 8 cm, max. 35 cm
- **Compact 10t:** Ø min. 8 cm, max. 38 cm

Never split wood lying down or against the grain.

- The machine may only be used in the intended manner. Any use beyond this is improper.
- The user/operator, not the manufacturer, is responsible for damages or injuries of any type resulting from this.
- An element of the intended use is also the observance of the safety instructions, as well as the assembly instructions and operating information in the operating manual.
- Persons who operate and maintain the machine must be familiar with the manual and must be informed about potential dangers.
- In addition, the applicable accident prevention regulations must be strictly observed.
- Other general occupational health and safety-related rules and regulations must be observed.
- The liability of the manufacturer and resulting damages are excluded in the event of modifications to the

machine.

Despite use as intended, specific risk factors cannot be entirely eliminated. Due to the design and layout of the machine, the following risks remain:

- Dry and seasoned wood can explode during the splitting process and injure the operator in the face. Please wear appropriate protective clothing!
- Pieces of wood that are produced during a splitting process can fall down and injure the feet of the person working.
- During the splitting process, bruising or severing of body parts may occur due to the lowering of the hydraulic blade.
- There is a danger of knotty logs becoming jammed during the splitting process. Please note that the wood is under a lot of tension when it is removed and your fingers can be crushed in the split crack.
- Attention! As a rule, only split pieces of wood that have been cut off at right angles! Pieces of wood cut at an angle can slip away during the splitting process! This can result in injuries!
- Please observe that our equipment was not designed with the intention of use for commercial or industrial purposes. We assume no guarantee if the equipment is used in commercial or industrial applications, or for equivalent work.

General safety information

We have marked points in these operating instructions that impact your safety with this symbol: m

General safety information

- Before using the machine, the usage and maintenance manual must be read in full.
- Safety shoes must always be worn to ensure protection against the risk of trunks falling on feet.
- Work gloves must always be worn to protect the hands against chips and fragments that may occur during work.
- Safety goggles or visors must always be worn to protect the eyes against chips and fragments that may occur during work.
- It is prohibited to remove or modify protective or safety equipment.
- Apart from the operator, it is forbidden to stand within the working radius of the machine. No other person or animal may be present within a 5 meter radius of the machine.
- The discharging of waste oil into the environment is prohibited. The oil must be disposed of in accordance with the legal requirements of the country in which the operation takes place.

Cutting or crushing hazard to hands:

- Never touch dangerous areas while the wedge is moving.

Warning!:

- Never remove a trunk that is caught in the wedge by hand.

Warning!:

- Disconnect the mains plug before undertaking any maintenance work described in this manual.

Warning!:

- Voltage as specified on the type plate.
- Store these instructions safely!

Work area safety

- Keep your work area clean and tidy. Disorganized and unlit work areas can result in accidents.
- Do not work with the device in explosive environments where flammable liquids, gases or specks of dust may be located. Power tools create sparks that may ignite dust or fumes.
- Keep children and other people away while using the electric tool. Distractions may cause you to lose control of the device.

Electrical safety

Attention! The following basic safety measures must be observed when using power tools for protection against electric shock, and the risk of injury and fire. Read all these notices before using the power tool and store the safety instructions well for later reference.

- The device connecting plug must match the socket. Never modify the plug in any way. Do not use any adapter plugs with earthed devices. Unmodified plugs and matching outlets will reduce risk of electric shock.
- Avoid body contact with earthed or grounded surfaces, such as pipes, radiators, ranges and refrigerators. There is an increased risk of electric shock if your body is earthed or grounded.
- Keep the device away from rain and moisture. Water entering a power tool will increase the risk of electric shock.
- Do not use the cable for another purpose, for example, carrying or hanging the device or pulling the plug out of the socket. Keep the cable away from heat, oil, sharp edges or moving device parts. Damaged or coiled cables increase the risk of an electric shock.
- If you work with an electric tool outdoors, only use extension cables that are also permitted for outdoor use. Using an extension cable permitted for outdoor use reduces the risk of an electric shock.
- Connect the electric tool to the mains via a socket outlet with a maximum fuse rating of 16A. We recommend the installation of a residual current device with a nominal tripping current of no more than 30 mA. Seek advice from your electrical installer.

Personal safety

- Stay alert, watch what you are doing and use common sense when operating a power tool. Do not use the device while tired or under the influence of drugs, alcohol or medication.
- A moment of carelessness while operating the electrical device may result in serious personal injury.
- Use personal protective equipment. Always wear eye protection. Protective equipment such as a dust mask, non-skid safety shoes, hard hat or hearing protection used for appropriate conditions will reduce personal injuries.
- Wear hearing protection. Excessive noise can result in a loss of hearing.
- Wear a dust protection mask. When machining wood and other materials, harmful dust may be generated. Do

not machine material containing asbestos!

- Wear eye protection. Sparks created during work or fragments, chippings and dust ejected by the device can cause sight loss.
- Prevent unintentional starting. Make sure that the switch is in the "OFF" position before inserting the plug into the socket.
- Keeping your finger on the switch or having the device switched on when you connect it to the power supply may result in accidents.
- Remove any adjusting key or spanner before turning the device on. A tool or spanner that is located in a rotating device part may result in injuries.
- Do not overestimate yourself. Keep proper footing and balance at all times. This enables better control of the device in unexpected situations.
- Dress properly. Do not wear loose clothing or jewellery. Keep hair, clothing and gloves away from moving parts. Loose clothes, jewellery or long hair can be caught in moving parts.

Careful handling and use of electric tools

- Do not overload your tool. Use the correct electric tool for your application. The correct power tool will do the job better and safer at the rate for which it was designed.
- Do not use the power tool if the switch does not turn it on and off. Any electric tool that cannot be controlled with the switch is dangerous and must be repaired.
- Remove the plug from the socket before setting the device, changing accessories or putting the device away. These precautionary measures will prevent the device from starting unintentionally.
- Store idle power tools out of the reach of children and Do not let people use the device if they are not familiar with it or if they have not read these instructions. Power tools are dangerous in the hands of untrained users.
- Maintain your device with care. Check for misalignment or binding of moving parts, breakage of parts and any other condition that may affect the device's operation. Have damaged parts repaired before using the device.
- Many accidents are caused by poorly maintained power tools. Always keep your cutting tools sharp and clean. Properly maintained cutting tools with sharp cutting edges are less likely to bind and are easier to control.
- Use electric tools, insert tools, etc. according to these instructions and as prescribed for that particular type of equipment. taking into account the working conditions and the work to be performed.
- Use of the power tool for operations different from those intended could result in a hazardous situation.

Service

- Only have your device repaired by qualified specialists and only with original spare parts. This ensures that safety of the device is maintained.

Warning!

This power tool generates an electromagnetic field during operation. This field can impair active or passive medical implants under certain conditions. In order to prevent the risk of serious or deadly injuries, we recommend that persons with medical implants consult with their physician and the manufacturer of the medical implant prior to operating the power tool. Special safety instructions for log splitters

Caution!

Moving machine parts. Do not reach into the splitting area.

WARNING!

The use of this powerful device may cause particular hazards. Take special care to keep yourself and those

around you safe. Basic safety precautions must always be followed to reduce the risk of injury and danger. The machine may only be operated by one operator.

- Never attempt to split trunks larger than the recommended trunk capacity.
- Trunks must not contain nails or wires that can fly out or damage the machine.
- The trunks must be cut flat at the end and all branches must be removed from the trunk.
- Always split the wood in the direction of its grain. Do not bring in and split wood across the splitter, as this can damage the splitter.
- The operator must operate the machine control with both hands without using any other contraption to replace the control unit.
- The machine may only be operated by adults who have read the operating manual before operating it. No one may use this machine without having read the manual.
- Never split two trunks at the same time in one operation, as wood can fly out, which is dangerous.
- Never add or replace wood during operation as this is very dangerous.
- While the machine is working, people and animals must be kept away from the log splitter within a radius of at least 5 metres.
- Never modify or work without the log splitter's protective devices.
- Never force the log splitter to split excessively hard wood with cylinder pressure for more than 5 seconds. Overheated oil under pressure can damage the machine. Stop the machine and after turning the trunk 90° try to split the trunk again. If the wood still cannot be split, it means that the hardness of the wood exceeds the capacity of the machine and it must be sorted out so that the log splitter is not damaged.
- Never leave the machine running unattended. Stop the machine and disconnect it from the mains when you are not working.
- Do not operate the machine near natural gas, petrol gutters or other flammable materials.
- Never open the control box or the engine cover. If necessary, contact a qualified electrician.
- Ensure that the machine and cables never come into contact with water.
- Handle the mains cable with care and do not jerk or yank the power cable to unplug it. Keep the cables away from excessive heat, oil and sharp objects.
- Please note the temperature conditions at work. Extremely low and extremely high ambient temperatures can lead to malfunctions.
- First-time users should receive practical instruction in the use of the log splitter from an experienced operator and practice working under supervision first.

Check before working

- whether all functions of the device are working properly
- whether all safety devices are working properly (two-hand safety switch, emergency stop switch)
- whether the device can be switched off properly
- whether the device is correctly adjusted (trunk bed, trunk holding claws, riving knife height) Always keep the working area free of obstructions when working (e.g. pieces of wood).

Special warnings when operating the log splitter

Particular hazards may occur when operating this powerful device. Take special care to keep yourself and those around you safe.

Hydraulics

Never operate this device if there is a hydraulic fluid hazard. Check for leaks in the hydraulics before using the splitter. Make sure that the device and your work area are clean and free from oil stains. Hydraulic fluid can cause hazards as you may slip and fall, your hands may slip when using the machine or there may be a fire hazard.

Electrical safety

- Never operate this device in the presence of an electrical hazard. Never operate an electrical device in humid conditions.
- Never operate this device with an unsuitable power cord or extension lead.
- Never operate this device unless you are connected to a properly earthed outlet that provides power as labeled and is protected by a fuse.

Mechanical hazards

Splitting wood causes particular mechanical hazards.

- Never operate this device unless you are wearing proper protective gloves, steel-toed shoes and approved eye protection.
- Beware of fragments that may occur; avoid puncture injuries and possible seizing of the device.
- Never try to split trunks that are too long or too small and do not fit properly into the device.
- Never attempt to split trunks that contain nails, wire or other objects.
- Clean up when working; accumulated split wood and wood chippings can create a hazardous working environment. Never continue working in a crowded work environment where you can slip, trip or fall.
- Keep onlookers away from the device and never allow unauthorized persons to operate the device.

Residual risks

The machine has been built according to state-of-the-art and recognized technical safety requirements. However, individual residual risks can arise during operation.

- The danger of injury for fingers and hands from the splitting tool in the event of improper guiding or support of the wood.
- Injuries due to the workpiece being ejected at high speed due to improper holding or guiding.
- Hazard due to electrical power with the use of improper electrical connection cables.
- Hazard due to special properties of the wood (knots, uneven shape, etc.)
- Health hazards due to electrical power, with the use of improper electrical connection cables.
- Before performing setting or maintenance work, release the start button and pull out the power plug.
- Furthermore, despite all precautions having been met, some non-obvious residual risks may still remain.
- Residual risks can be minimized if the "Safety information" and the "Proper use" together with the operating manual as a whole are observed.
- Avoid accidental starting of the machine: the operating button may not be pressed when inserting the plug into an outlet.
- Keep your hands away from the work area, when the machine is in operation.

Technical data

Compact 8t

Dimensions D/W/H	850/900/990	
Swivel table height mm	390	
Working height mm	920	
Wood length cm	750/1070	
Max. power t*	7,95	
	400V	230V
Feed speed cm/s	5,4	3,1
Return speed cm/s	24	15,5
Oil quantity l	4,8	
Weight kg	126	125
Drive		
Motor V/Hz	400/50	230/50
Rated input P1 W	3500	3150
Power output P2 kW	2500	2300
Operating mode	S6 40% **	
Speed 1/min	2800	

Technical changes reserved!

- The maximum achievable splitting force is dependent on the resistance of the log and can differ due to variable contributing factors on the hydraulic system.
- Operating mode S6, uninterrupted, periodic operation

Unpacking

- Open the packaging and carefully remove the device.
- Remove the packaging material, as well as the packaging and transport safety devices (if present).
- Check whether the scope of delivery is complete.
- Check the device and accessory parts for transport damage. In the event of complaints the carrier must be informed immediately. Later claims will not be recognised.
- If possible, keep the packaging until the expiry of the warranty period.
- Familiarise yourself with the product by means of the operating manual before using for the first time.
- With accessories as well as wearing parts and re-placement parts use only original parts. Replacement parts can be obtained from your dealer.
- When ordering please provide our article number as well as type and year of manufacture for your product.

WARNING!

Danger of choking and suffocating!

The packaging material, packaging and transport safety devices are not children's toys. Plastic bags, foils and small parts can be swallowed and lead to choking.

- Keep packaging material, packaging and transport safety devices away from children.

Assembly / Before commissioning

Attention!

Always make sure the device is fully assembled before commissioning! Your log splitter is not completely assembled for packaging reasons. Fitting the wheels, see Fig. 4 and Fig. 19

- Insert the wheel axle (14a) through the holes.
- Mount one washer (14b) on each side, then the wheel (14).
- Mount one washer (14b) on each side, then the split pin (14d).
- Push the safety caps (14c) on each side.

Fitting control arms, Fig. 7

- Pull out the cotter pin (a) and remove the retaining bolt (b)
- Grease the sheet metal lugs at the top and bottom
- Insert the control arms (6). At the same time, insert the rocker switch (c) through the slot in the control lever (8).
- Insert the retaining bolt (b) through the metal plates and the control arms (6)
- Secure the retaining bolt (b) at the bottom again with the cotter pin (a)
- Hold both fillister head screws of the retaining claw (4) using two fingers so that they do not fall into the tube and remove the nuts, then fit the retaining claw to the control arms (6) with the long side facing down.
- Fig. 7a Adjust the stop screws (d) on both sides so that the retaining claws (4) do not touch the riving knife (2)

Fitting nozzles, Fig. 19

- Take the nozzles (11) and fix them to the base plate on both sides with the M10x25 hexagonal bolts (11a) and washer.

Fitting the protective bracket, Fig. 6

- Connect the protective bracket (5) into the holder
- Connect the hexagonal bolt M10x60 through the hole, use a washer on both sides and tighten the hexagonal nut (16) well
- Fit all the protective brackets in the same way

Mounting the chain hooks Fig. 9

- Mount the chain hook (22) onto the holder on the splitting column (3) using the M12x35 hexagonal bolts with washer and hexagonal nut (22a)

Mounting the trunk lifter, Fig. 8

- Mount the trunk lifter (19) onto the holder on the base plate using the M12x70 hexagonal bolts with a washer and hexagonal nut (19a). The hexagonal nut must be on the right side in the direction of the wheels.
- Attach the chain (20) onto the bracket on the outside using the M10x30 hexagonal bolts with a washer and hexagonal nut (20a). Only unscrew the hexagonal nut enough so that the chain (20) can move freely. Attention! The chain (20) must turn smoothly on the screw!

Mounting the locking lever Fig. 8

- Insert the locking lever (21) into the holder, use a washer on the left and right, and the M10x55 hexagonal bolts with hexagonal nuts (21a) and tighten.
- Check the ease of movement of the grid (21b)!

Startup

Attention!

Always make sure the device is fully assembled before commissioning! Make sure that the machine is installed completely and properly. Before each use, always check:

- the connection cables for defective areas (cracks, cuts, and the like),
- the machine for possible damage,
- whether all screws are tightened,
- the hydraulic oil for leaks and
- The oil level

Environmental conditions

The machine should operate in the following environmental conditions:

	Minimum	Maximum	Recommended
Temperature	5 °C	40°C	16°C
Humidity		95%	70%

When working below 5° C, the machine should be idled for approx. 15 minutes to allow the hydraulic oil to warm up. AC motors 230V should have a temperature between 5°C – 10°C when starting at low outdoor temperatures, as the starting current increases at low temperatures and the circuit breaker can be triggered.

- The main's power connection is protected with a 16A slow-blow fuse.
- The "RCD circuit breaker" must have a 30mA trip rating

Setting up

Prepare the workplace where the machine is to be located. Create enough space to allow safe, trouble-free working. The machine is designed to work on level surfaces and must be set-up in a stable position on level, solid ground.

Ventilating, Fig. 13

Ventilate the hydraulic system before starting the splitter.

- Loosen the breather cap (12) several turns so that air can escape from the oil tank.
- Leave the cap open during operation.
- Before you move the splitter, close the cap again, since oil can run out otherwise. If the hydraulic system is not vented, the trapped air will damage the seals and thus the splitter!

Switching on/off, Fig. 14

- Press the green button to switch on.
- Press the red button to switch off.

Note:

- Before each use, check the function of the on-off unit by switching it on and off again once.

Restart protection in case of power interruption (zero-voltage trigger)

- In the event of a power failure, unintentional removal of the plug or a defective fuse, the device switches off automatically.
- To switch on again, press the green button on the switching unit again.

End of work

- Move the splitting blade to the lower position.
- Release one control arm.
- Switch off the device and disconnect the mains plug.
- Close the bleeder screw.
- Protect the machine from wetness!
- Observe general maintenance information.

Working instructions

Stroke limitation for short wood, Fig. 12

- Move the riving knife (2) into the desired position.
- Release the control lever (8).
- Switch off the motor (17) with the switch (15).
- Now release the second control lever (8).
- Loosen the locking screw (e).
- Guide the stroke setting bar (16a) with the cap nut (f) upwards until the stroke setting bar (16a) is stopped on the stop.
- Retighten the locking screw (e).
- Engage the control lever (8). Make sure that the riving knife (2) does not move upwards uncontrollably when

the motor (17) is switched on.

- Switch on the motor (17) with the switch (15).
- Actuate both control levers (8) in order to move the riving knife (2) downwards.
- Now release both control levers (8) and check the top position of the riving knife (2).

Functional check

Carry out a functional check before every use.

Action	Result
Push both control levers down.	Riving knife moves down.
Release one control lever at a time	Riving knife remains in the selected position.
Release both control levers	Riving knife returns to the upper position.

An oil level check must be carried out before each use, see chapter "Maintenance"!

Splitting

- Place the wood on the base plate and hold it with the two retaining claws (4) on the control arms (6), and place the piece of wood in the middle of the riving knife (2), press the control levers (6) down, as soon as the riving knife (2) penetrates the wood, move the control arms (6) approx. 2 cm away from the wood, while pressing the control levers (8) down at the same time. This prevents damage to the retaining claws (4)!
- Move the riving knife (2) down until the wood is split, if the wood is not completely split during the first splitting stroke, slowly release both control levers (8) and carefully move the riving knife (2) with wood upwards to the end position. Then swivel table (9) Fig. 10 by hand or foot until the locking hook (10) Fig. 1 engages. Now carry out a second splitting stroke until the wood is completely split and remove the logs, then swivel the swivel table away again with your foot or hand Fig.7

Operation of the trunk lifter (only for compact 10t) General information about the trunk lifter:

- The chain (20) of the trunk lifter (19) may only be attached to the chain hook (22) using the last link for safety reasons.
- Ensure that no other people are present in the work-ing range of the trunk lifter (19).

Operation of the trunk lifter (19):

- Loosen the locking lever (21b) of the trunk lifter (19) so that the lifting tube of the trunk lifter (19) can move freely.
- Move the riving knife (2) down until the lifting tube of the trunk lifter (19) lies completely on the floor.

- In this position, you can roll the trunk to the split onto the lifting tube of the trunk lifter (19). The trunk must lie in the area between the two fixings.
- Push the stop lever (18) to the right and allow the riving knife (2) to move upwards slowly.
- The trunk lifter (19) moves upwards and positions the trunk on the base plate (13).
- Now align the trunk to the centre of the riving knife and split it. (see “Splitting” working instruction)
- Then remove the split wood and a new trunk can be split using the described method.

Caution!

Do not stand in the working range of the trunk lifter (19)! Risk of injury!

Resetting the trunk lifter (19):

- This is used as a second guard arm when not using the trunk lifter (19). To do this, the lifting tube is raised until it engages on the locking lever (21b).

Transport position of the trunk lifter (19):

- Guide the trunk lifter (19) up by hand until it latches into place.

Caution!

Do not stand in the working range of the trunk lifter (19). Risk of injury!

General working notes

Attention!

- Always keep the base plate clean so that the swivel table (9) can engage securely!
- Only split logs that have been sawn off straight.
- Split the wood horizontally.
- Never split wood lying down or crosswise.
- Wear suitable gloves when splitting wood.

Accident prevention standards

- The machine may only be operated by qualified personnel who are fully familiar with the contents of this manual.
- Before commissioning, one must check the integrity and perfect functionality of the safety devices.
- Before commissioning, you should also familiarise yourself with the machine's control mechanisms by following the usage instructions.
- The specified capacity of the machine must not be exceeded. Under no circumstances must the machine be used for any other purpose than intended.
- In accordance with the laws of the country in which the machine is used, personnel must wear the work clothes also specified here, avoiding loose, flapping garments, belts, rings and chains; long hair is tied up if possible.
- If possible, the workplace should always be tidy and clean and the tools, accessories and spanners should be within reach.
- Make sure that the machine is never connected to the mains when cleaning or maintaining it.
- It is strictly forbidden to operate the machine without safety equipment or with the safety mechanisms switched off.

- It is strictly forbidden to remove or modify the safety equipment.
- No maintenance or adjustment should be carried out before reading this manual carefully.
- The regular maintenance schedule given here must be followed both for safety reasons and for efficient operation of the machine.
- The safety labels must always be clean, legible and closely observed to avoid accidents; if the labels are damaged, lost or belong to parts that have been replaced, they must be replaced with new original labels to be requested from the manufacturer and placed in the prescribed position.
- Powder-type fire extinguishing agents must be used for fires. Fires on the system must not be extinguished with water jets due to the risk of short circuits.
- If the fire cannot be extinguished immediately, watch out for leaking liquids.
- In the event of a prolonged fire, the oil tank or the pressurised pipes may explode: care must therefore be taken not to come into contact with the leaking liquids.

Maintenance and repairs

Only carry out modifications, adjustments and cleaning work when the engine is switched off.

Pull out the mains plug.

Experienced craftsmen can carry out small repairs on the machine themselves.

Repair and maintenance work on the electrical system may only be carried out by qualified electricians. All protective and safety equipment must be reassembled immediately after repair, maintenance is completed.

Our recommendation to you:

Clean the machine thoroughly after each use!

- Riving knife
 - The riving knife is a wearing part that should be reground or replaced with a new riving knife if necessary.
- Two-hand protective guard
 - The combined retaining and control device must remain smooth-running. Lubricate with a few drops of oil as required.
- Moving parts
 - Keep the riving knife guides clean. (remove fouling, wood chips, bark, etc.)
 - Lubricate slide rails with spray oil or grease.
- Check the hydraulic oil level.
 - Check hydraulic connections and screw connections for tightness and wear. Tighten the screw connections if necessary. die Schraubverbindungen nachziehen.

Check the oil level

The hydraulic system is a closed system with an oil tank, oil pump and control valve. Check the lubricating oil level regularly before commissioning. An oil level that is too low can damage the oil pump.

Note:

The oil level must be checked with the splitting blade retracted. The oil dipstick is located on the base frame in the breather cap (12) (Fig. 13) and is provided with 2 notches. 13) und ist mit 2 Kerben versehen. If the oil level lies at the bottom notch then this is the minimum oil level. If this is the case, the oil must be topped up immediately. The top notch indicates the maximum oil level.

The splitting column must be retracted before the check, the machine must be level.

When do I change the oil?

First oil change after 50 operating hours, then every 500 operating hours.

Replacing (Fig. 13)

- Fully retract the splitting column.
- Place a receptacle with at least 7 l capacity under the splitter.
- Loosen the breather cap (12)
- Open the drain plug (g) at the bottom of the oil tank so that the oil can run out.
- Close the drain plug (g) again and tighten it well.
- Refill with 4.8 l of new hydraulic oil using a clean funnel.
- Screw the breather cap (12) back on.

Dispose of the used oil properly at a local used oil collection point. Dumping used oil in the soil or mixing it with waste is prohibited.

We recommend the following hydraulic oils:

- Aral Vitam gf 22
- BP Energol HLP-HM 22
- Mobil DTE 11
- Shell Tellus 22
- or equivalent.

Do not use other types of oil!

- The use of other oils affects the function of the hydraulic cylinder.

Splitter spar

- The spar of the splitter must be lightly greased before commissioning. This process must be repeated every 5 operating hours. Apply grease or spray oil lightly. The spar must not run dry.

Hydraulic system

- The hydraulic system is a closed system with an oil tank, oil pump and control valve.
- The factory-completed system must not be changed or manipulated.

Check the oil level regularly.

- An oil level that is too low will damage the oil pump. Regularly check hydraulic connections and screw connections for leaks – retighten if necessary.
- Before starting the maintenance or checks, clean the work area and have suitable tools at hand and in good condition.
- The time intervals cited here relate to normal operating conditions. If the machine is subjected to heavier loads, these times must be reduced accordingly.
- Clean the machine cladding, panels and control levers with a soft, dry cloth or a cloth that has been slightly moistened with neutral cleaning agent. Do not use any solvents such as alcohol or petrol as these may damage the surfaces.
- Keep oils and lubricants out of reach of unauthorised persons. Read through the instructions on the containers carefully and follow them closely. Avoid direct contact with the skin and wash off thoroughly after use.

Service information

- With this product, it is necessary to note that the following parts are subject to natural or usage-related wear, or that the following parts are required as consumables. Wearing parts*: Riving knife, riving knife/riving spar guides, hydraulic oil
- may not be included in the scope of supply!
- Spare parts and accessories can be obtained from our service centre. To do this, scan the QR code on the cover page.

Storage

- Store the device and its accessories in a dark, dry and frost-free place that is inaccessible to children. The optimum storage temperature lies between 5 and 30 °C. Store the power tool in its original packaging. Cover the electric tool to protect it from dust or moisture. Store the operating
- manual with the power tool.

Transport

Transport by hand, Fig. 15

- To transport the log splitter, the riving knife (2) must be moved all the way down. Tilt the splitter slightly with the handle (1) and support with the foot until the machine tilts onto the wheels and can thus be moved away.

Transport by crane (Fig 16 and 16a):

Never lift on the riving knife!

Compact 8t (Fig. 16)

- Attach the straps on both sides to the upper bracket of the guardrails. Then carefully lift the machine!

Compact 10t (Fig. 16a)

Attach the belts to the holder on the left of the upper hoop guard and to the holder on the right of the locking lever. Then carefully lift the machine.

Electrical connection

The electrical motor installed is connected and ready for operation. The connection complies with the applicable VDE and DIN provisions. The customer's mains connection as well as the extension cable used must also comply with these regulations.

- The product fulfils the requirements of EN 61000-3-11 and may only be used at the following connection points: This means that use of the product at any freely selectable connection points is not allowed.
- Given unfavourable conditions in the power supply the product can cause the voltage to fluctuate temporarily.

- The product is intended exclusively for use at connection points which
 - **a)** do not exceed a maximum permitted mains impedance “Z” ($Z_{\max} = 0.382 \Omega$), or
 - **b)** have a continuous current carrying capacity of the mains of at least 100 A per phase.
- As the user, you are required to ensure, in consultation with your electric power company if necessary, that the connection point at which you wish to operate the product meets one of the two requirements,
 - **a)** or **b)**, named above.

Important information

In the event of overloading, the motor will switch itself off. After a cool-down period (time varies) the motor can be switched back on again.

Damaged electrical connection cable

The insulation on electrical connection cables is often damaged.

This may have the following causes:

- Pressure points, where connection cables are passed through windows or doors.
- Kinks where the connection cable has been improperly fastened or routed.
- Places where the connection cables have been cut due to being driven over.
- Insulation damage due to being ripped out of the wall outlet.
- Cracks due to the insulation aging. Such damaged electrical connection cables must not be used and are life-threatening due to the insulation damage.

Check the electrical connection cables for damage regularly. Ensure that the connection cables are disconnected from electrical power when checking for damage.

Electrical connection cables must comply with the applicable VDE and DIN provisions. Only use connection cables with designation H05VV-F. The printing of the type designation on the connection cable is mandatory. The mains power connection must be protected with a max. 16 A slow-blow fuse.

Three-phase motor 400 V / 50 Hz (Fig. 17)

Mains voltage 400 V / 50 Hz.

Mains power connection and extension leads must be 5-core = 3 P + N + SL. – (3/N/PE).

AC motor 230V / 50Hz

Mains voltage 230V / 50Hz

Extension cables must have a minimum cross section of 1.5 mm². When connecting to the mains or in the event of the machine being moved to another location, the turning direction must be checked. It may be necessary to change the polarity. Rotate the pole-changing device (400V) in the unit plug. (Fig. 17) Connections and repair work on the electrical equipment may only be carried out by electricians. Please provide the following information in the event of any enquiries:

- Type of current for the motor
- Data of machine type plate
- Motor data – type plate

Disposal and recycling

The device is supplied in packaging to avoid transport damages. This packaging is raw material and can thus be used again or can be reintegrated into the raw material cycle. The device and its accessories are made of different materials, such as metals and plastics. Take defective components to special waste disposal sites. Check with your specialist dealer or municipal administration!

Old devices must not be disposed of with house-hold waste!

This symbol indicates that this product must not be disposed of together with domestic waste in compliance with the Directive (2012/19/EU) pertaining to waste electrical and electronic equipment (WEEE). This product must be

handed over at the intended collection point. This can be done, for example, by returning it when purchasing a similar product or delivering it to an authorised collection point for the recycling of old electrical and electronic devices. Improper handling of waste equipment may have negative consequences for the environment and human health due to potentially hazardous substances that are often contained in electrical and electronic equipment. By properly disposing of this product, you are also contributing to the effective use of natural resources. You can obtain information on collection points for waste equipment from your municipal administration, public waste disposal authority, an authorised body for the disposal of waste electrical and electronic equipment or your waste disposal company.

Dismantling and disposal

The machine does not contain any substances that are harmful to health or the environment, as it has been constructed from materials that are fully recyclable or can be disposed of in the normal way. For disposal, contact specialised companies or qualified personnel who are aware of the possible risks, have read these instructions for use and follow them carefully. When the machine has reached the end of its service life, proceed as follows, observing all specified accident prevention standards:

- interrupt the energy supply (electrical or PTO),
- remove all power cables and hand them over to a specialised collection point by following the regulations in force in the country.
- Empty the oil tank, deposit the oil in tight receptacles at a collection point by following the regulations in force in each country.
- Dispose of all other machine parts to a scrap collection point by following the regulations in force in the country.

Make sure that each machine part is disposed of by following the regulations in force in the country.

Troubleshooting

The following table shows fault symptoms and describes remedial measures in the event of your machine failing to work properly. If you cannot localise and rectify the problem with this, please contact your service workshop.

Fault	Possible cause	Remedy	Danger level
The hydraulic pump does not start	Voltage absent	Check whether the lines have power supply	Danger of electric shock T his operation must be carried out by a maintenance electrician.
The thermal switch of the motor has switched off	Turn the thermal switch inside the motor housing back on		
The column does not move downwards	Low oil level	Check the oil level and top up	Danger of pollution This operation can be carried out by the machine operator.
	One of the levers is not connected	Check the fastening of the levers	Danger of cuts This operation can be carried out by the machine operator.
	Dirt on the rails	Clean the column	
Engine (400V) starts, but the column does not move downwards	Wrong direction of rotation of the motor with three-phase current	Check and change the direction of rotation of the engine	
Engine (230V) does not start	If the temperature is too low, the starting current is too high, the circuit breaker has tripped	The temperature for starting the motor should be 5°C – 10°C. Use a 16A slow-blow circuit breaker at the mains power connection.	

Maintenance and repairs

All maintenance tasks must be performed by qualified personnel in strict observance of the present usage instructions. Before any maintenance measure, one must take all possible precautionary measures, switch off the engine and disconnect the power supply (if necessary, unplug it). Attach a sign to the machine that explains the failure situation: “Machine out of order for maintenance: It is prohibited for unauthorized persons to be at the machine and to start it up.”

Documents / Resources

	<p>scheppach Compact 8t Meter Log Splitter With Swivel Table [pdf] Instruction Manual Compact 8t Meter Log Splitter With Swivel Table, Compact 8t, Meter Log Splitter With Swivel Table, Splitter With Swivel Table, Swivel Table, Table</p>
---	--

References

- [!\[\]\(1207edb9a08751d3d55970560645ed23_img.jpg\) scheppach | scheppach](#)
- [!\[\]\(d7a34a706cfa4ef37c62a369101e1b36_img.jpg\) Kontakt & Service | scheppach | scheppach](#)

Manuals+.