



scheppach Air Force 5 Portable Compressor Instruction Manual

[Home](#) » [Scheppach](#) » **scheppach Air Force 5 Portable Compressor Instruction Manual** 

scheppach Air Force 5 Portable Compressor



Contents

- 1 Figures**
- 2 Parts**
- 3 Explanation of the symbols on the equipment**
- 4 Introduction**
 - 4.1 Manufacturer**
- 5 Device description**
- 6 Scope of Delivery**
- 7 Intended use**
- 8 Safety information**
 - 8.1 General power tool safety warnings**
 - 8.2 Work area safety**
 - 8.3 Electrical safety**
 - 8.4 Personal safety**
 - 8.5 Power tool use and care**
 - 8.6 Service**
 - 8.7 Safety information for compressors**
- 9 Technical data**
 - 9.1 Noise data**
- 10 Residual risks**
- 11 Unpacking**
- 12 Before starting the equipment**
- 13 Attachment and operation**
 - 13.1 Mains connection**
 - 13.2 ON/OFF switch (fig. 1)**
 - 13.3 Commissioning (Fig. 1)**
 - 13.4 Setting the pressure (Fig. 1)**
 - 13.5 Establishing connections (fig. 2 – 4)**
- 14 Electrical connection**
 - 14.1 AC motor**
- 15 Cleaning, maintenance, and storage**
 - 15.1 Cleaning**
 - 15.2 Storage (fig. 2, 3)**
 - 15.3 Service information**
- 16 Disposal and recycling**
- 17 Troubleshooting**
- 18 EC Declaration of Conformity**
- 19 Standard references:**
- 20 Warranty GB**
- 21 Documents / Resources**
 - 21.1 References**
- 22 Related Posts**

Figures

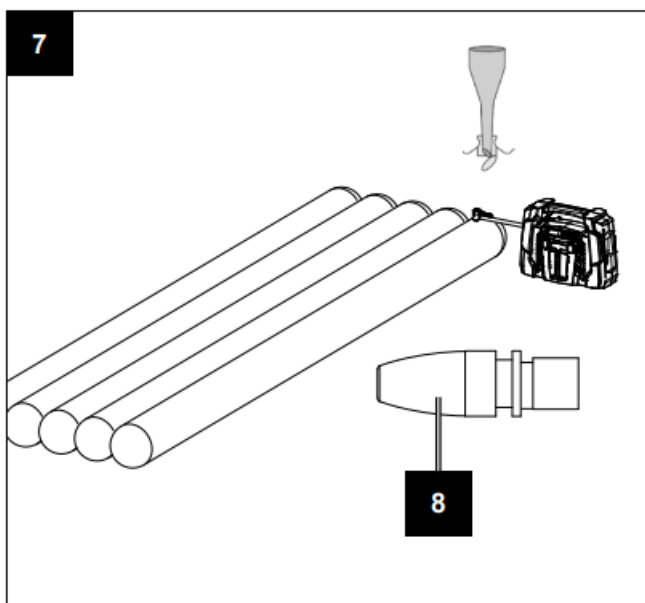
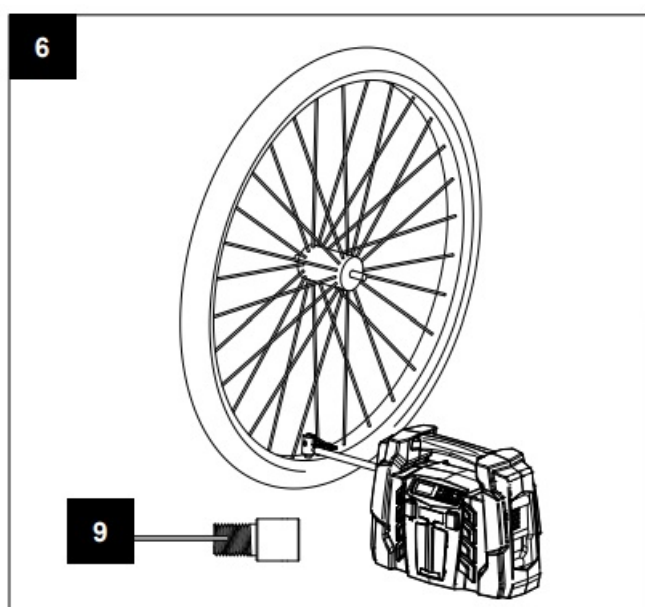
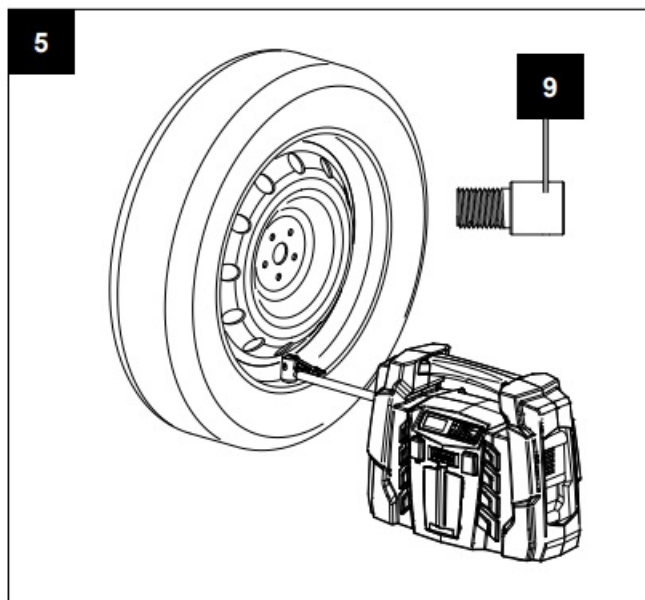

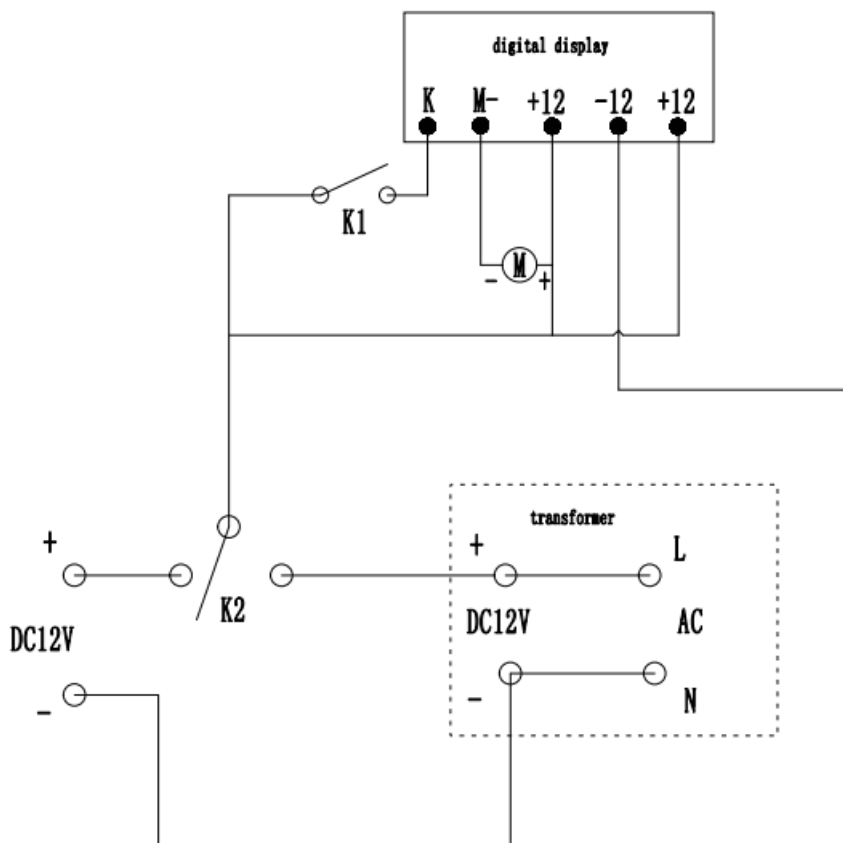
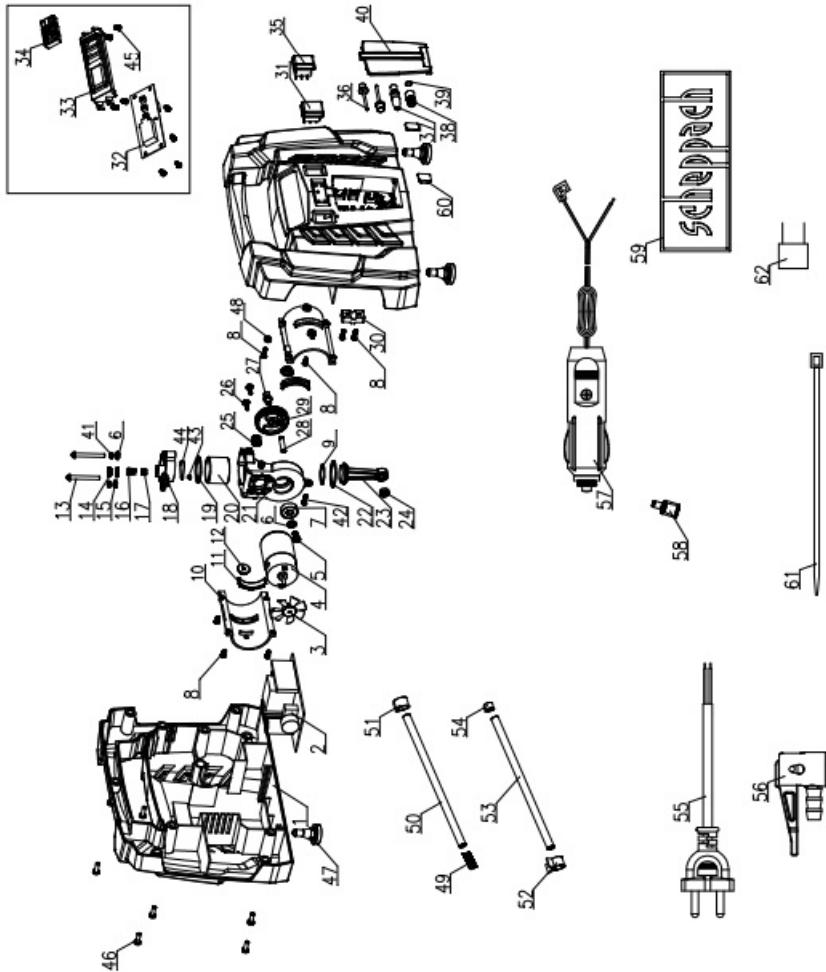

Parts



Explanation of the symbols on the equipment

Symbols are used in this manual to draw your attention to potential hazards. The safety symbols and the accompanying explanations must be fully understood. The warnings themselves will not rectify a hazard and cannot replace proper accident prevention measures

	Read instruction manual and safety instructions before starting up and pay attention!
	Wear respiratory protection.
	Wear safety goggles!
	Wear ear-muffs. The impact of noise can cause damage to hearing.
	Beware of hot parts!
	Beware of electrical voltage!
	Warning! The unit is equipped with an automatic start control. Keep others away from the work area of the device!
	Do not expose the machine to rain. The device may only be stationed, stored and operated in dry ambient conditions
	Sound power level specified in dB

	Protection class II
	Can be used for pumping up tyres.
	The product complies with the applicable European directives.

Introduction

Manufacturer

Scheppach GmbH
Günzburger Straße 69
D-89335 Ichenhausen

Dear customer,

we hope your new tool brings you much enjoyment and success.

Note:

According to the applicable product liability laws, the manufacturer of the device does not assume liability for damages to the product or damages caused by the product that occurs due to:

- Improper handling,
- Non-compliance of the operating instructions,
- Repairs by third parties, not by authorized service technicians,
- Installation and replacement of non-original spare parts,
- Application other than specified,
- A breakdown of the electrical system that occurs due to the non-compliance of the electric regulations and VDE regulations 0100, DIN 57113 / VDE0113.

We recommend:

Read through the complete text in the operating instructions before installing and commissioning the device. The operating instructions are intended to help the user to become familiar with the machine and take advantage of its application possibilities in accordance with the recommendations.

The operating instructions contain important information on how to operate the machine safely, professionally and economically, how to avoid danger, costly repairs, reduce downtimes and how to increase reliability and service life of the machine.

In addition to the safety regulations in the operating instructions, you have to meet the applicable regulations that apply for the operation of the machine in your country. Keep the operating instructions package with the machine at all times and store it in a plastic cover to protect it from dirt and moisture. Read the instruction manual each time before operating the machine and carefully follow its information. The machine can only be operated by persons who were instructed concerning the operation of the machine and who are informed about the associated dangers. The minimum age requirement must be complied with.

In addition to the safety notices contained in this operating manual and the particular instructions for your country, the generally recognized technical regulations for the operation of identical devices must be complied with. We accept no liability for damage or accidents which arise due to non-observance of these instructions and the safety information.

Device description

1. Transport handle
2. Display
3. + Button (press to increase)
4. Unit button
5. – Button (press to decrease)
6. ON/OFF switch
7. Ball needle
8. Conical adapter (Swimming accessories)
9. Adapter for tyre valves
10. Adapter storage compartment
11. AC/DC selector switch
12. Storage compartment for the power cable
13. Power cord
14. Compressed air hose with valve adapter
15. 12V connection socket
16. Compressed air hose / connection cable storage compartment

1

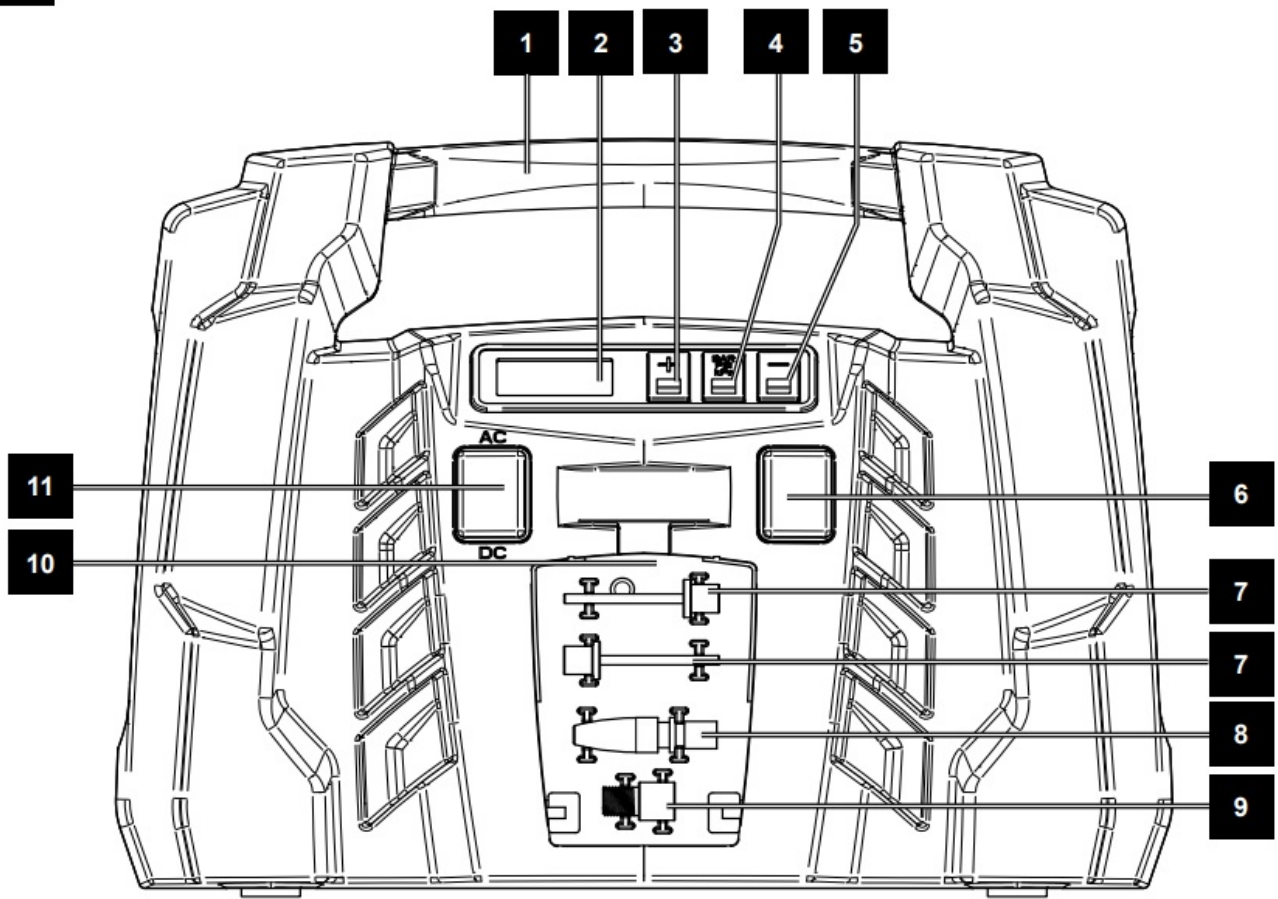

2

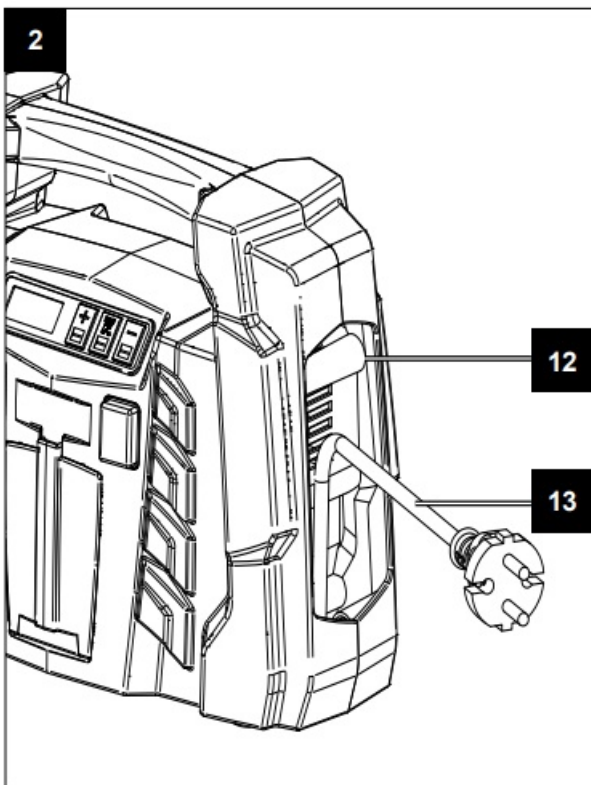

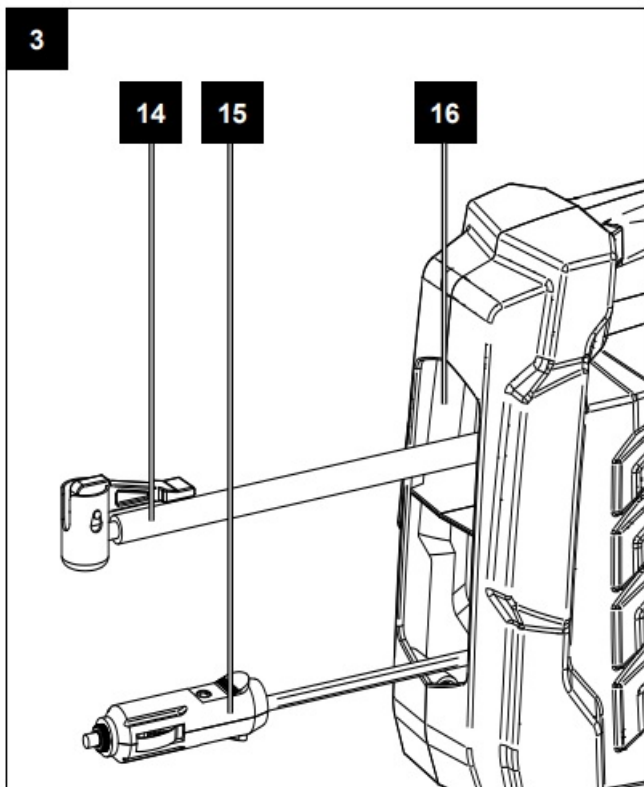

Scope of Delivery

- Compressor
- Ball needle (2x)
- Conical adapter (Swimming accessories)
- Adapter for tyre valves
- Operating manual

Intended use

This device is intended for inflating car, motorcycle and bicycle tires as well as sports balls, water balls, air mattresses and other similar items.

The unit can be used in mains operation with the mains cable, or by connecting to the 12V socket (car cigarette lighter).

This device is not suitable for tires with very large volumes, such as truck or tractor tires for example.

The compressor may only be operated in a dry and well ventilated indoor space.

The equipment is to be used only for its prescribed purpose. Any other use is deemed to be a case of misuse.

The user / operator and not the manufacturer will be liable for any damage or injuries of any kind caused as a result of this.

Please note that our equipment has not been designed for use in commercial, trade or industrial applications. Our warranty will be voided if the equipment is used in commercial, trade or industrial businesses or for equivalent purposes.

Safety information

General power tool safety warnings



WARNING Read all safety warnings, instructions, illustrations and specifications provided with this power tool. Failure to follow all instructions listed below may result in electric shock, fire and/or serious injury. **Save all warnings and instructions for future reference.**

The term “power tool” in the warnings refers to your mains-operated (corded) power tool or battery-operated (cordless) power tool.

Work area safety

a. Keep work area clean and well lit.

Cluttered or dark areas invite accidents.

b. Do not operate power tools in explosive atmospheres, such as in the presence of flammable liquids, gases or dust.

Power tools create sparks which may ignite the dust or fumes.

c. Keep children and bystanders away while operating a power tool.

Distractions can cause you to lose control.

Electrical safety

a. Power tool plugs must match the outlet.

Never modify the plug in any way. Do not use any adapter plugs with earthed (grounded) power tools. Unmodified plugs and matching outlets will reduce risk of electric shock.

b. Avoid body contact with earthed or grounded surfaces, such as pipes, radiators, ranges and refrigerators. There is an increased risk of electric shock if your body is earthed or grounded.

c. Do not expose power tools to rain or wet conditions.

Water entering a power tool will increase the risk of electric shock.

d. Do not abuse the cord. Never use the cord for carrying, pulling or unplugging the power tool.

Keep cord away from heat, oil, sharp edges or moving parts. Damaged or entangled cords increase the risk of electric shock.

e. When operating a power tool outdoors, use an extension cord suitable for outdoor use.

Use of a cord suitable for outdoor use reduces the risk of electric shock.

f. If operating a power tool in a damp location is unavoidable, use a residual current device (RCD) protected supply.

Use of an RCD reduces the risk of electric shock.

Personal safety

a. Stay alert, watch what you are doing and use common sense when operating a power tool. Do not use a power tool while you are tired or under the influence of drugs, alcohol or medication.

A moment of inattention while operating power tools may result in serious personal injury.

b. Use personal protective equipment. Always wear eye protection.

Protective equipment such as a dust mask, nonskid safety shoes, hard hat or hearing protection used for appropriate conditions will reduce personal injuries.

3. Prevent unintentional starting. Ensure the switch is in the off-position before connecting to power source and/or battery pack, picking up or carrying the tool.

Carrying power tools with your finger on the switch or energising power tools that have the switch on invites accidents.

d. Remove any adjusting key or wrench before turning the power tool on.

A wrench or a key left attached to a rotating part of the power tool may result in personal injury.

e. Do not overreach.

Keep proper footing and balance at all times. This enables better control of the power tool in unexpected situations.

f. Dress properly. Do not wear loose clothing or jewellery. Keep your hair and clothing away from moving parts.

Loose clothes, jewellery or long hair can be caught in moving parts.

g. If devices are provided for the connection of dust extraction and collection facilities, ensure these are connected and properly used.

Use of dust collection can reduce dust-related hazards.

h. Do not let familiarity gained from frequent use of tools allow you to become complacent and ignore tool safety principles.

A careless action can cause severe injury within a fraction of a second.

Power tool use and care

a. Do not force the power tool.

Use the correct power tool for your application. The correct power tool will do the job better and safer at the rate for which it was designed.

b. Do not use the power tool if the switch does not turn it on and off. Any power tool that cannot be controlled with the switch is dangerous and must be repaired.

c. Disconnect the plug from the power source and/or remove the battery pack, if detachable, from the power tool before making any adjustments, changing accessories, or storing power tools.

Such preventive safety measures reduce the risk of starting the power tool accidentally.

d. Keep unused electric tools out of the reach of children.

Do not let people use the electric tool who are not familiar with it or who have not read these instructions. Electric tools are dangerous if they are used by inexperienced people.

e. Maintain power tools and accessories.

Check for misalignment or binding of moving parts, breakage of parts and any other condition that may affect the power tool's operation. If damaged, have the power tool repaired before use. Many accidents are caused by poorly maintained power tools.

f. Keep cutting tools sharp and clean. Properly maintained cutting tools with sharp cutting edges are less likely to bind and are easier to control.

g. Use electric tools, insertion tools, etc. according to these instructions.

Take the working conditions and the activity to be carried out into consideration. Using electric tools for applications other than the intended uses can lead to dangerous situations.

h. Keep handles and grasping surfaces dry, clean and free from oil and grease.

Slippery handles and grasping surfaces do not allow for safe handling and control of the tool in unexpected situations.

Service

a. Have your power tool serviced by a qualified repair person using only identical replacement parts.

This will ensure that the safety of the power tool is maintained.

Safety information for compressors



Attention! The following basic safety actions must be taken when using this compressor in order to protect the user from electric shocks and the risk of injury and fire. Read and follow these instructions before using the equipment.

Safe work

1. Keep the work area orderly

– Disorder in the work area can lead to accidents.

2. Take environmental influences into account

– Do not expose power tools to rain.

- Do not use electric tools in a damp or wet environment. There is a risk of electric shock!
 - Make sure that the work area is well-illuminated.
 - Do not use power tools where there is a risk of fire or explosion.
3. Protect yourself from electric shock
 - Avoid physical contact with earthed parts (e. g. pipes, radiators, electric ranges, cooling units).
 4. Keep away from children!
 - Do not allow other persons to touch the equipment or cable, keep them away from your work area.
 5. Securely store unused electric tools
 - Unused power tools should be stored in a dry, elevated or closed location out of the reach of children.
 6. Do not overload your power tool
 - They work better and more safely in the specified output range.
 7. Dress properly
 - Do not wear wide clothing or jewellery, which can become entangled in moving parts.
 - Rubber gloves and anti-slip footwear are recommended when working outdoors.
 - Tie long hair back in a hair net.
 8. Do not use the cable for purposes for which it is not intended
 - Do not use the cable to pull the plug out of the outlet. Protect the cable from heat, oil and sharp edges.
 9. Take care of your tools
 - Keep your compressor clean in order to work well and safely.
 - Follow the maintenance instructions.
 - Check the connection cable of the power tool regularly and have it replaced by a recognised specialist when damaged.
 - Check extension cables regularly and replace them when damaged.
 10. Pull the connector out of the socket
 - When the electric tool is not in use or prior to maintenance and when replacing tools such as saw blades, bits, milling heads.
 11. Avoid inadvertent starting
 - Make sure that the switch is switched off when plugging the plug into an outlet.
 12. Use extension cables for outdoors
 - Only use approved and appropriately identified extension cables for use outdoors.
 - Only use cable reels in the unrolled state.
 13. Always remain attentive
 - Pay attention to what you are doing. Remain sensible when working. Do not use the power tool when you are distracted.
 14. Check the power tool for potential damage
 - Protective devices or other parts with minor damage must be carefully inspected to ensure that they function correctly and as intended prior to continued use of the electric tool.
 - Check whether the moving parts function faultlessly and do not jam or whether parts are damaged. All parts must be correctly mounted and all conditions must be fulfilled to ensure fault free operation of the electric tool.
 - Damaged protective devices and parts must be properly repaired or replaced by a recognised workshop, insofar as nothing different is specified in the operating manual.
 - Damaged switches must be replaced at a customer service workshop.
 - Do not use any faulty or damaged connection cables.
 - Do not use any electric tool on which the switch cannot be switched on and off.

15. Have your power tool repaired by a qualified electrician
 - This electric tool conforms to the applicable safety regulations. Repairs may only be performed by an electrician using original spare parts. Otherwise accidents can occur.
16. Attention!
 - For your own safety, only use accessories and additional equipment that are indicated in the operating manual or have been recommended or indicated by the manufacturer. Use of other tools or accessories that those recommended in the operating manual or in the catalogue could represent a personal danger to you.
17. Noise
 - Wear hearing protection when using the compressor.
18. Replacing the connection line
 - If the connection line is damaged, it must be replaced by the manufacturer or an electrician to avoid danger. There is a risk of electric shock.
19. Filling tyres
 - Directly after inflating tyres, check the pressure with a suitable pressure gauge, for example at your filling station.
20. Street-legal compressors in construction site operation
 - Ensure that all hoses and fixtures are suitable for the maximum permissible working pressure of the compressor.
21. Set-up location
 - Only set up the compressor on a flat surface.
22. In case of pressures above 7 bar, it is recommended to equip supply hoses with a safety cable (e. g. a wire rope).
23. Avoid over-stressing the piping system by using flexible hose connections to prevent kinking.
24. Use a residual current circuit breaker with a trigger current of 30 mA or less. Using a residual current circuit breaker reduces the risk of an electric shock.



WARNING! This electric tool generates an electromagnetic field during operation. This field can impair active or passive medical implants under certain conditions. In order to prevent the risk of serious or deadly injuries, we recommend that persons with medical implants consult with their physician and the manufacturer of the medical implant prior to operating the electric tool.

Technical data

AC mains power connection	220-240 V~ 50 Hz
DC connection	12 V
Motor rating W	max. 150
Operating mode*	S3 25%
Compressor speed	4200 min ⁻¹
Operating pressure	ca. 8 bar
Theoretical intake capacity l/min	ca. 36,5
Effective output rate at 1 bar	ca. 18 l/min
Protection type	IP30
Protection class	II
Weight in kg	1,6
AC cable length	1,8 m
DC cable length	4 m
Hose length	600 mm

Subject to technical modifications!

*S3 25% = periodical intermediate duty with a duty cycle of 25% (2.5 min based on a 10 minute period)
The noise emission values were measured in accordance with EN ISO 3744.

Wear hearing protection.

The effects of noise can cause a loss of hearing.

Noise data



Warning: Noise can have serious effects on your health. If the machine noise exceeds 85 dB, please wear suitable hearing protection.

Sound power level LwA	90 dB
Sound pressure level LpA	75,9 dB
Uncertainty KwA/pA	2,36 / 3 dB

Residual risks

Comply with the stipulated maintenance and safety instructions in the operating instructions. Remain attentive at all times when working and keep third parties at a safe distance from your work area.

Even when the device is being used properly, there will always be certain residual hazards that cannot be completely ruled out. The following potential hazards can arise due to the type and design of the device:

- Unintentional starting up of the product.
- Damage to hearing if the stipulated hearing protection is not worn.
- Dirt particles, dust etc. can get into the eyes or face despite wearing safety goggles.
- Inhaling swirled up particles.

Unpacking



ATTENTION!

The device and packaging materials are not toys! Children must not be allowed to play with plastic bags, film and small parts! There is a risk of swallowing and suffocation!

- Open the packaging and remove the device carefully.
- Remove the packaging material as well as the packaging and transport bracing (if available).
- Check that the delivery is complete.
- Check the device and accessory parts for transport damage.
- If possible, store the packaging until the warranty period has expired.

Before starting the equipment

- Before you connect the equipment to the mains supply make sure that the data on the rating plate are identical to the mains data.
- Check the equipment for damage which may have occurred in transit. Report any damage immediately to the transport company which was used to deliver the compressor.
- Install the compressor near the point of consumption.
- Avoid long air lines and supply lines (extension cables).
- Make sure that the intake air is dry and dust-free.
- Do not install the compressor in a damp or wet room.
- The compressor may only be used in suitable rooms (with good ventilation and an ambient temperature from +5 °C to 40 °C). There must be no dust, acids, vapors, explosive gases or inflammable gases in the room.
- The compressor is designed to be used in dry rooms. It is prohibited to use the compressor in areas where

work is conducted with sprayed water.

- The compressor may only be used outdoor briefly when the ambient conditions are dry.
- The compressor must always be kept dry and must not be left outdoors after work is complete.

Attachment and operation

Mains connection

- The compressor can be connected to any 220 – 240 V~ / 50 Hz shock-proof socket which is protected by a 15 A fuse.
- Before you use the machine, make sure that the mains voltage is the same as the operating voltage (see the rating plate).
- Long supply cables, extensions, cable reels etc. cause a drop in voltage and can impede motor startup.
- At low temperatures below +5°C, sluggishness may make starting difficult or impossible.

ON/OFF switch (fig. 1)

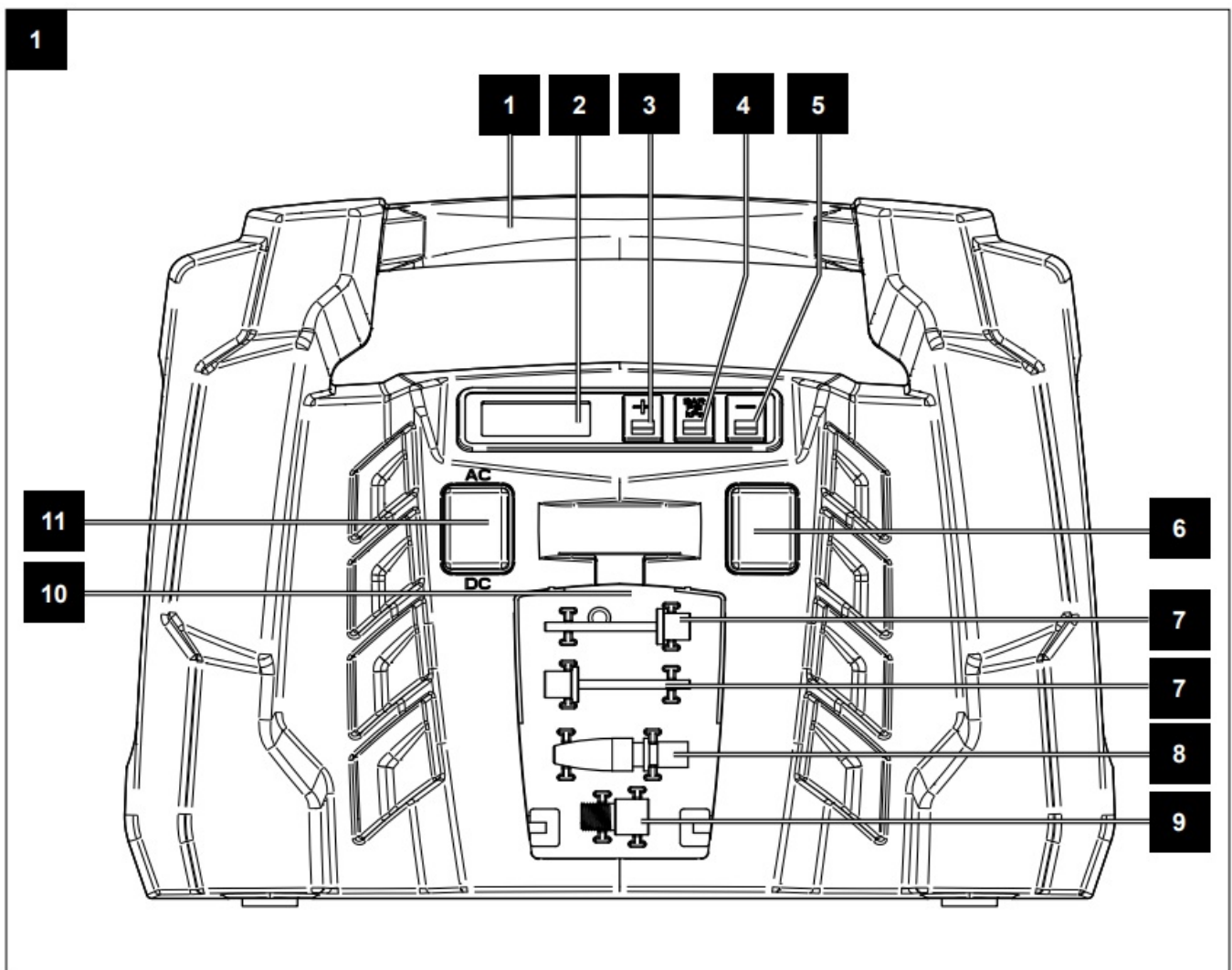

- To switch on the compressor, press the button (6) on position I.
- To switch off the compressor, press the button (6) on position 0.

Commissioning (Fig. 1)

1. Connect the adapter of the compressed air hose to the object you wish to inflate.
2. Use one of the adapters (7, 8, 9) as and when required and as described in 10.5.1.
3. The display (2) now shows how much pressure is currently in your item.

Setting the pressure (Fig. 1)

- The unit of the displayed pressure can be selected with the button (4). The pressure can be displayed in units of [bar], [PSI] or [kPa].
- You can set the pressure with buttons (3) and (5). Up to max. 8 bar is possible.
- The button (5) allows the desired pressure to be reduced.
- The button (3) allows the desired pressure to be increased.
- Switch the device on as described in 10.2. The compressor will then pump until the preset pressure on the display is reached, then it will switch off.

Establishing connections (fig. 2 – 4)



Attention! Switch the device off for this.

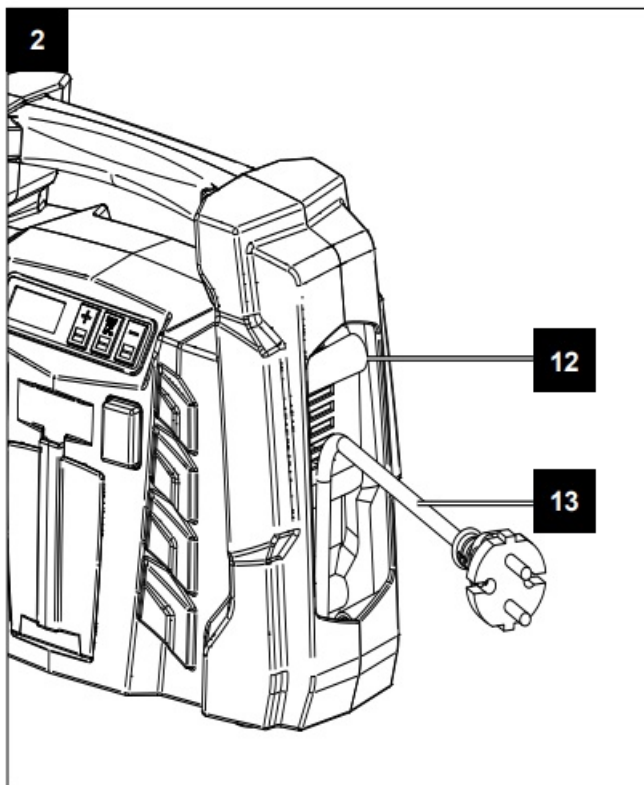

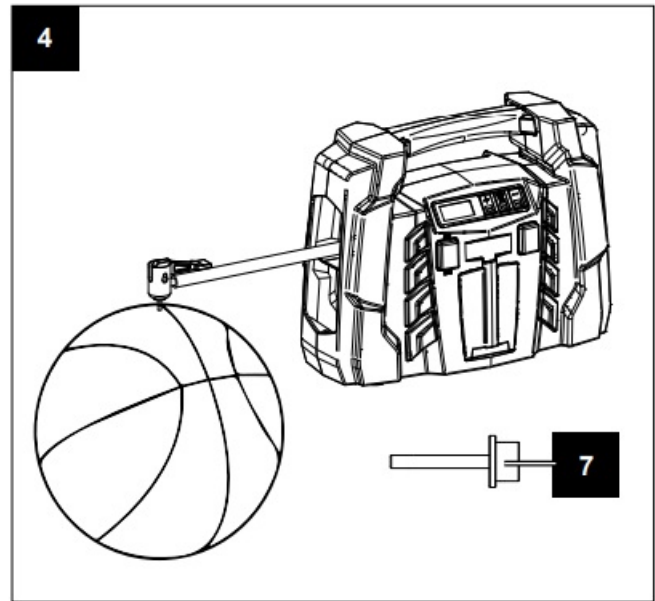
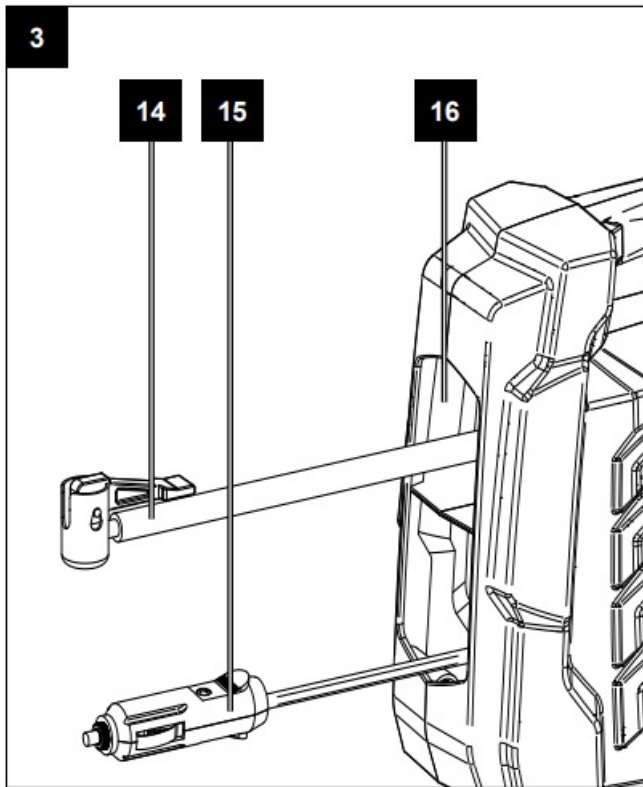

Using the adapter set

The adapter set enables the following additional capabilities:

- Pumping up balls with the help of the ball needle (7).
- The tyre valve adapter (9) enables bicycle tyres and car tyres to be inflated.
- Filling pools, air mattresses, boats or similar swimming accessories is also possible with the help of the additional conical adapter (8).

Warning! Observe the information supplied by the tire manufacturer and the vehicle manufacturer relating to the recommended tire pressure.

Warning! This equipment is not calibrated! For a calibrated measurement value, check the actual tire pressure using a calibrated meter after you have inflated the tires yourself, e.g. at a petrol station.

12V socket (Fig. 8)

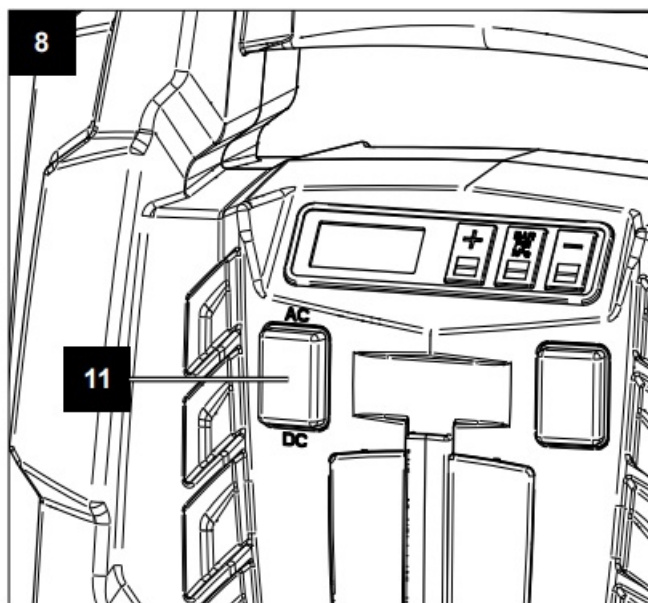

1. Press the selector switch (11) to switch between 220-240 V AC and 12V DC.
2. AC switch up: Device will be supplied with power via the mains cable.
3. DC switch down: Device will now be supplied with DC power via the 12V connection cable.
4. The compressor can be connected to a 12V socket in the car. To do so, plug the connector **(15)** into your car's socket.

Electrical connection

The electrical motor installed is connected and ready for operation. The connection complies with the applicable VDE and DIN provisions. The customer's mains connection as well as the extension cable used must also comply with these regulations.

When working with spray attachments and during temporary use outdoors, the device must be connected to a residual current circuit breaker with a trigger current of 30 mA or less.

Damaged electrical connection cable

The insulation on electrical connection cables is often damaged. This may have the following causes:

- Passage points, where connection cables are passed through windows or doors.
- Kinks where the connection cable has been improperly fastened or routed.
- Places where the connection cables have been cut due to being driven over.
- Insulation damage due to being ripped out of the wall outlet.
- Cracks due to the insulation ageing.

Such damaged electrical connection cables must not be used and are life-threatening due to the insulation damage.

Check the electrical connection cables for damage regularly. Make sure that the connection cable does not hang on the power network during the inspection.

Electrical connection cables must comply with the applicable VDE and DIN provisions. Only use connection cables with the marking „H05VV-F“.

The printing of the type designation on the connection cable is mandatory.

AC motor

- The mains voltage must be 220 – 240 V~
- Extension cables up to 25 m long must have a cross-section of 1.5 mm².

Connection type Y

If the mains connection cable of this device is damaged, it must be replaced by the manufacturer, their service department or a similarly qualified person to avoid dangers.

Connections and repairs of electrical equipment may only be carried out by an electrician.

Please provide the following information in the event of any enquiries:

- Type of current for the motor
- Machine data – type plate
- Motor data – type plate

Cleaning, maintenance, and storage



Important!

Pull out the power plug before doing any cleaning and maintenance work on the equipment. Risk of injury from electric shock!



Important!

Wait until the equipment has cooled down completely! Risk of burns!



Important!

Always depressurize the equipment before carrying out any cleaning and maintenance work! Risk of injury!

Cleaning

- Keep the equipment free of dirt and dust as far as possible. Wipe the equipment with a clean cloth or blow it down with compressed air at low pressure.
- We recommend that you clean the equipment immediately after you use it.
- Clean the equipment regularly with a damp cloth and some soft soap. Do not use cleaning agents or solvents; these may be aggressive to the plastic parts in the equipment. Ensure that no water can get into the interior of the equipment.
- You must disconnect the hose and any spraying tools from the compressor before cleaning. Do not clean the compressor with water, solvents or the like.

Storage (fig. 2, 3)



Important!

Pull out the mains plug. Switch off the compressor and make sure that it is secured in such a way that it cannot be started up again by any unauthorized person.



Important!

Store the compressor only in a dry location which is not accessible to unauthorized persons.

- The mains cable **(13)** can be stowed in the storage compartment **(12)** on the right side.
- The compressed air hose **(14)** and the connection cable **(15)** can be stowed in the storage compartment **(16)** on the left side.

Transport (fig. 1)

The unit can be transported with the handle **(1)**.

Service information

Please note that the following parts of this product are subject to normal or natural wear and that the following parts are therefore also required for use as consumables. Wear parts*: belt, coupling

* Not necessarily included in the scope of delivery!

Spare parts and accessories can be obtained from our service centre. To do this, scan the QR code on the cover page.

Disposal and recycling

Notes for packaging



The packaging materials are recyclable. Please dispose of packaging in an environmentally friendly manner.

Notes on the electrical and electronic equipment act [ElektroG]



Waste electrical and electronic equipment does not belong in household waste, but must be collected and disposed of separately!

- Used batteries or rechargeable batteries that are not installed permanently in the old appliance must be removed non-destructively before disposal. Their disposal is regulated by the battery law.
- Owners or users of electrical and electronic devices are legally obliged to return them after use.
- The end user is responsible for deleting their personal data from the old device being disposed of!
- The symbol of the crossed-out dustbin means that waste electrical and electronic equipment must not be disposed of with household waste.
- Waste electrical and electronic equipment can be handed in free of charge at the following places:
 - Public disposal or collection points (e.g. municipal works yards)
 - Points of sale of electrical appliances (stationary and online), provided that dealers are obliged to take

them back or offer to do so voluntarily.

- Up to three waste electrical devices per type of device, with an edge length of no more than 25 centimetres, can be returned free of charge to the manufacturer without prior purchase of a new device from the manufacturer or taken to another authorised collection point in your vicinity.
- Further supplementary take-back conditions of the manufacturers and distributors can be obtained from the respective customer service.
- If the manufacturer delivers a new electrical appliance to a private household, the manufacturer can arrange for the free collection of the old electrical appliance upon request from the end user. Please contact the manufacturer's customer service for this.
- These statements only apply to devices installed and sold in the countries of the European Union and which are subject to the European Directive 2012/19/EU. In countries outside the European Union, different regulations may apply to the disposal of waste electrical and electronic equipment.

Troubleshooting

Fault	Possible cause	Remedy
The compressor does not start.	No supply voltage.	Check cable, power plug, fuse and socket.
	Insufficient supply voltage	Avoid extension cables that are too long. Use extension cables with sufficient wire cross-section.
	Outside temperature is too low	Do not operate below +5° C outside temperature.
	Motor is overheated.	Allow the motor to cool down. If necessary, eliminate the cause of overheating.
The compressor starts but there is no pressure.	The non-return valve leaks.	Replace non-return valve
	The seals are damaged.	Check seals, have broken seals replaced at a specialist workshop
Compressor running, pressure shown on the display, but tools are not running.	The hose connections have a leak.	Check compressed air hose and tools, replace if necessary.

EC Declaration of Conformity



hereby declares the following conformity under the EU Directive and standards for the following article

Brand	SCHEPPACH
Art	MOBILER KOMPRESSOR – AIR FORCE 5
Article name	PORTABLE COMPRESSOR – AIR FORCE 5 COMPRESSEUR PORTATIF – AIR FORCE 5
Art. no	5906142901

	2014/29/EU
	2014/35/EU
x	2014/30/EU
x	2006/42/EG
	2004/22/EG
x	2014/68/EU
x	2011/65/EU*
	89/686/EWG_96/58/EG
	90/396/EWG
x	2000/14/EG_2005/88/EG
	Annex V
x	Annex VI Noise: measured LWA = 87 dB; guaranteed LWA = 90 dB P = xx K W; L/Ø = cm Notified Body: Intertek Testing Services Shanghai, Building No. 86, 1198 Qinzhou Road (North), Shanghai 200233, China Notified Body No. : 0012
	Annex IV Notified Body: Notified Body No.: Certificate No.:
	2016/1628/EU

Standard references:

EN 1012-1: 2010; EN 62841-1: 2015; EN 55014-1:2017+A11:2020; EN 55014-2: 2015; EN IEC 61000-3-2:2019; EN 61000-3-3:2013+A1:2019; EN 50498:2010

This declaration of conformity is issued under the sole responsibility of the manufacturer.

The object of the declaration described above fulfils the regulations of the directive 2011/65/EU of the European Parliament and Council from 8th June 2011, on the restriction of the use of certain hazardous substances in electrical and electronic equipment.

chenhausen, 08.12.2022

i. V. Andreas Pecher

Signature / Andreas Pecher / Head of Project Management

Warranty GB

Apparent defects must be notified within 8 days from the receipt of the goods. Otherwise, the buyer's rights of claim due to such defects are invalidated. We guarantee for our machines in case of proper treatment for the time of the statutory warranty period from delivery in such a way that we replace any machine part free of charge which provably becomes unusable due to faulty material or defects of fabrication within such period of time. With respect to parts not manufactured by us we only warrant insofar as we are entitled to warranty claims against the upstream suppliers. The costs for the installation of the new parts shall be borne by the buyer. The cancellation of sale or the reduction of purchase price as well as any other claims for damages shall be excluded.



www.scheppach.com



Documents / Resources

	<p>scheppach Air Force 5 Portable Compressor [pdf] Instruction Manual Air Force 5 Portable Compressor, Air Force 5, Portable Compressor, Compressor</p>
--	---

References

- [\[f\] scheppach | scheppach](#)
- [\[f\] Kontakt & Service | scheppach | scheppach](#)

