

[Skip to content](#)

**Manuals+**

User Manuals Simplified.

## scheppach Air Case Compact Compressor Instruction Manual

[Home](#) » [Scheppach](#) » scheppach Air Case Compact Compressor Instruction Manual

scheppach Air Case Compact Compressor



Only for EU countries. Do not dispose of electric tools together with household waste material! In observance of European directive 2012/19/EU on wasted electrical and electronic equipment and its implementation in accordance with national law, electric tools that have reached the end of their life must be collected separately and returned to an environmentally compatible recycling facility.

Contents [hide](#)

[1 Explanation of the symbols on the equipment](#)

[2 Introduction](#)

[2.1 MANUFACTURER:](#)

[2.2 DEAR CUSTOMER,](#)

[3 Device description](#)

[4 Unpacking](#)

[5 Intended use](#)

[6 Safety information](#)

[6.1 Safe work](#)

[6.2 ADDITIONAL SAFETY INSTRUCTIONS](#)

[6.3 Safety information for paint spraying](#)

[6.4 Operating pressure vessels](#)

[6.5 Safety instructions for accessories](#)

[7 Technical data](#)

[8 Before starting the equipment](#)

[9 Attachment and operation](#)

[9.1 Mains connection](#)

[9.2 ON/OFF switch \(fig. 1\)](#)

[9.3 Setting the pressure \(Fig. 1\)](#)

[9.4 Setting the pressure switch](#)  
[10 Electrical connection](#)  
[10.1 Damaged electrical connection cable](#)  
[10.2 AC motor](#)  
[11 Cleaning, maintenance, and storage](#)  
[11.1 Cleaning](#)  
[11.2 Maintenance work on the pressure vessel/condensed water \(Fig. 1/2\)](#)  
[11.3 Safety valve \(Fig. 2/Pos. 12\)](#)  
[11.4 Storage](#)  
[11.5 Releasing excess pressure](#)  
[11.6 Storage power cord, hose and accessories \(Fig. 3/4\)](#)  
[12 Disposal and recycling](#)  
[13 Troubleshooting](#)  
[14 Warranty](#)  
[15 Documents / Resources](#)  
[15.1 References](#)  
[16 Related Posts](#)

## Explanation of the symbols on the equipment



Read and follow the operating and safety instructions before you start working with this power tool.



Wear ear-muffs. The impact of noise can cause damage to hearing.



Beware of hot parts!

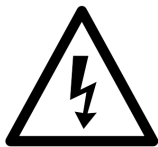

Beware of electrical voltage!



Warning! The unit is equipped with an automatic start control. Keep others away from the work area of the device!

## Introduction

### MANUFACTURER:

**scheppach**  
Fabrikation von Holzbearbeitungsmaschinen GmbH Günzburger Straße 69 D-89335 Ichenhausen

### DEAR CUSTOMER,

we hope your new tool brings you much enjoyment and success.

### NOTE:

According to the applicable product liability laws, the manufacturer of the device does not assume liability for damages to the product or damages caused by the product that occurs due to:

- Improper handling,
- Non-compliance of the operating instructions,
- Repairs by third parties, not by authorized service technicians,
- Installation and replacement of non-original spare parts,
- Application other than specified,
- A breakdown of the electrical system that occurs due to the non-compliance of the electric regulations and VDE regulations 0100, DIN 57113 / VDE0113.

### WE RECOMMEND:

Read through the complete text in the operating instructions before installing and commissioning the device. The operating instructions are intended to help the user to become familiar with the machine and take advantage of its application possibilities in accordance with the recommendations. The operating instructions contain important information on how to operate the machine safely, professionally and economically, how to avoid danger, costly repairs, reduce downtimes and how to increase reliability and service life of the machine.

In addition to the safety regulations in the operating instructions, you have to meet the applicable regulations that apply for the operation of the machine in your country. Keep the operating instructions package with the machine at all times and store it in a plastic cover to protect it from dirt and moisture. Read the instruction manual each time before operating the machine and carefully follow its information. The machine can only be operated by persons who were instructed concerning the operation of the machine and who are informed about the associated dangers. The minimum age requirement must be complied with. In addition to the safety notices contained in this operating manual and the particular instructions for your country, the generally recognised technical regulations for the operation of identical devices must be complied with.

## Device description

1

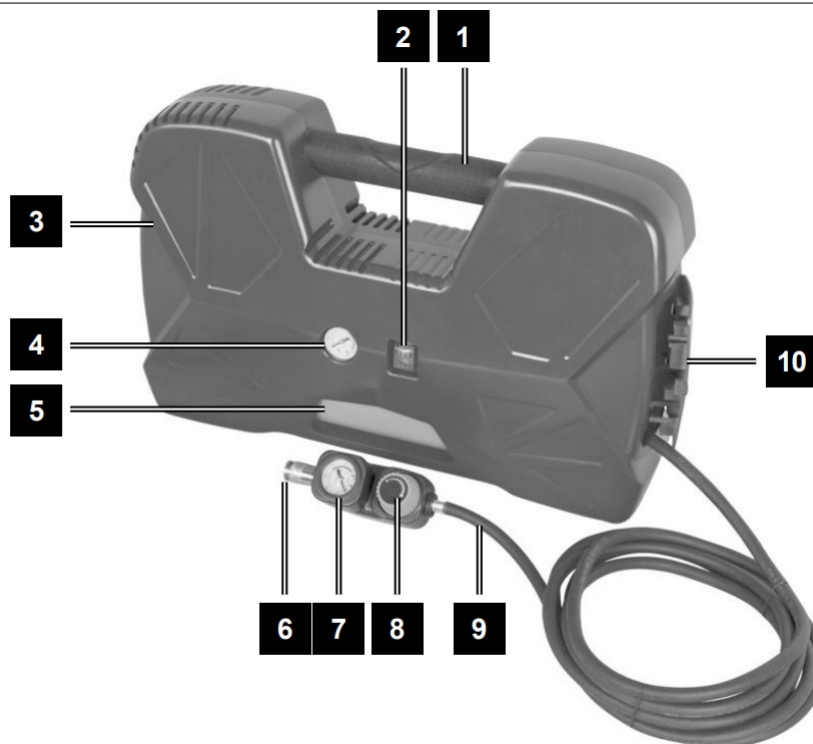

2

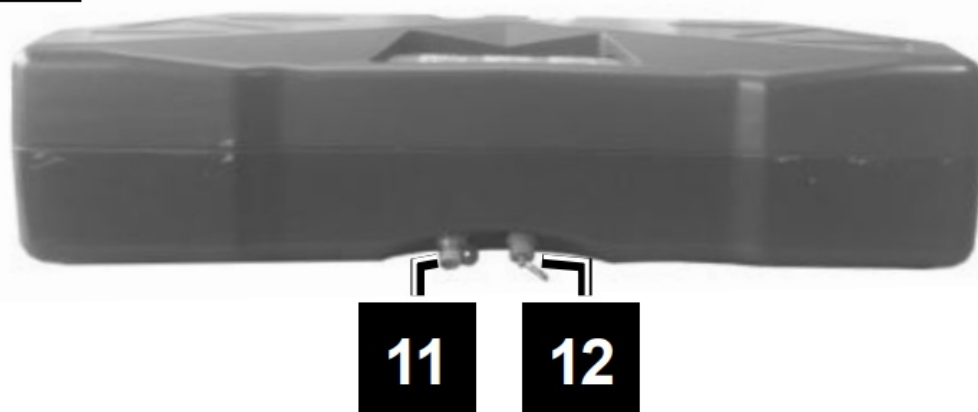

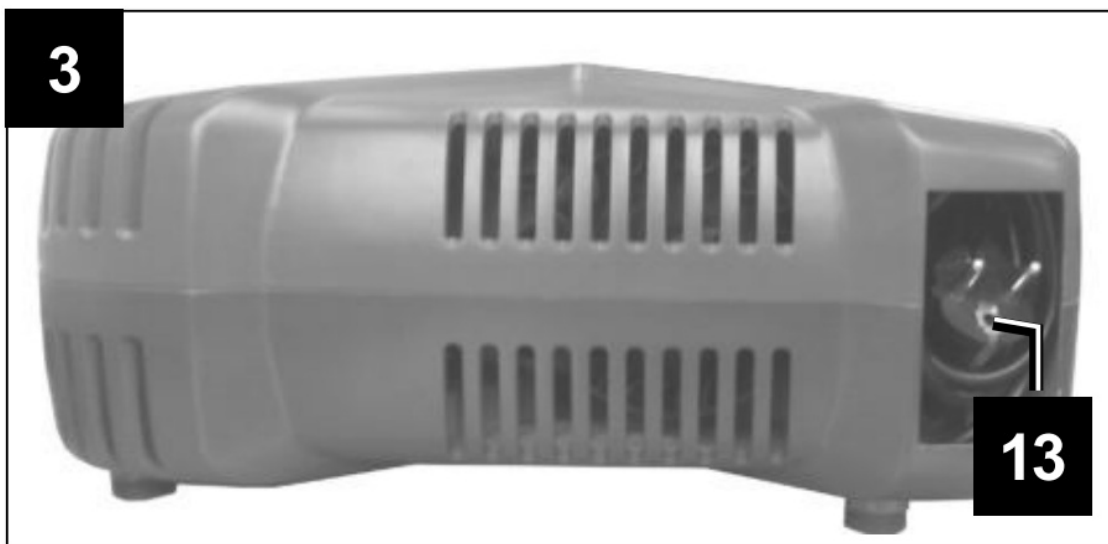
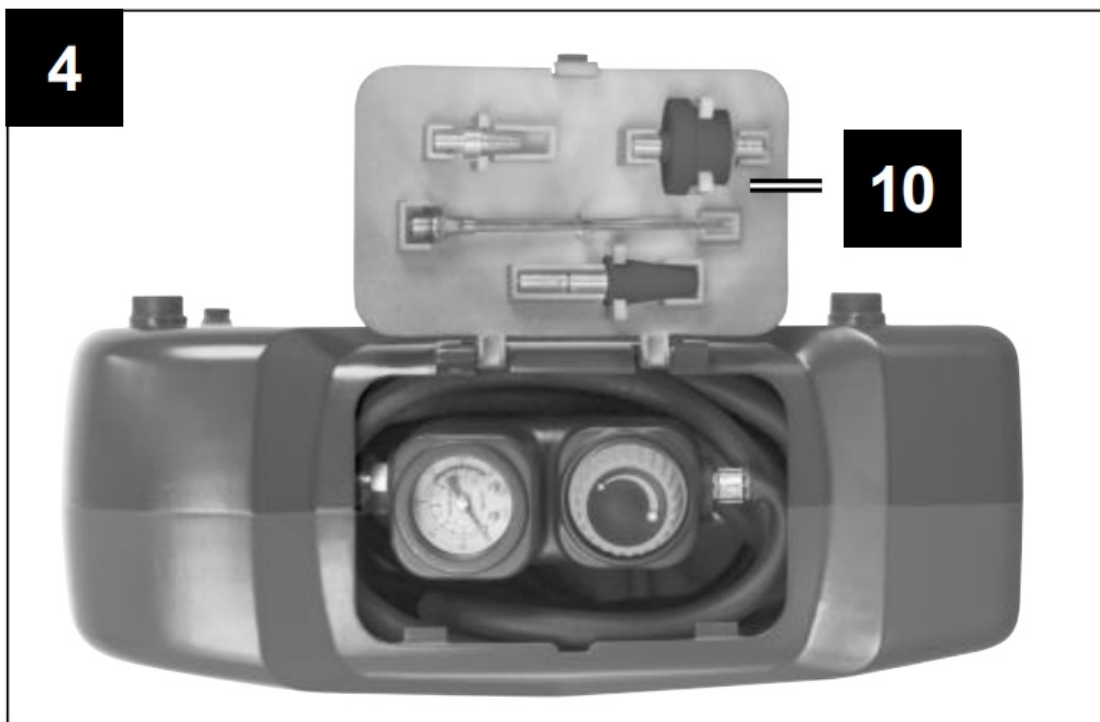

1. Transport handle
2. ON/OFF switch
3. Compressor housing
4. Pressure gauge (for reading the preset vessel pressure)
5. Pressure vessel
6. Quick-lock coupling (regulated compressed air)
7. Pressure gauge (for reading the set pressure)
8. Pressure regulator
9. Pressure hose
10. Toolcover
11. Drain plug for condensation water
12. Safety valve
13. Power cord

### Unpacking

- Open the packaging and remove the device carefully.
- Remove the packaging material as well as the packing and transport bracing (if available).
- Check that the delivery is complete.
- Check the device and accessory parts for transport damage.
- If possible, store the packaging until the warranty period has expired.

**⚠ ATTENTION!** The device and packaging materials are not toys! Children must not be allowed to play with plastic bags, film and small parts! There is a risk of swallowing and suffocation!

### Intended use

The compressor is designed to generate compressed air for compressed-air driven tools which can be driven with an air volume of up to approx. 180 l/min (e.g. tire inflator, blow-out pistol and paint spray gun). Due to the limited air output it is not possible to use the compressor to drive tools with very high air consumption (for example orbital sanders, rod grinders and hammer screwdrivers).

The equipment is to be used only for its prescribed purpose. Any other use is deemed to be a case of misuse. The user / operator and not the manufacturer will be liable for any damage or injuries of any kind caused as a result of this.

Please note that our equipment has not been designed for use in commercial, trade or industrial applications. Our warranty will be voided if the equipment is used in commercial, trade or

industrial businesses or for equivalent purposes.

## Safety information

 **Attention!** The following basic safety measures must be observed when using electric tools for protection against electric shock, and the risk of injury and fire. Read all these notices before using the electric tool and keep the safety instructions for later reference.

**Attention!** The following basic safety actions must be taken when using this compressor in order to protect the user from electric shocks and the risk of injury and fire. Read and follow these instructions before using the equipment.

### Safe work

1. Keep the work area orderly
  - Disorder in the work area can lead to accidents.
2. Take environmental influences into account
  - Do not expose electric tools to rain.
  - Do not use electric tools in a damp or wet environment. There is a risk of electric shock!
  - Make sure that the work area is well-illuminated.
  - Do not use electric tools where there is a risk of fire or explosion.
3. Protect yourself from electric shock
  - Avoid physical contact with earthed parts (e.g. pipes, radiators, electric ranges, cooling units).
4. Keep children away
  - Do not allow other persons to touch the equipment or cable, keep them away from your work area.
5. Securely store unused electric tools
  - Unused electric tools should be stored in a dry, elevated or closed location out of the reach of children.
6. Do not overload your electric tool
  - They work better and more safely in the specified output range.
7. Wear suitable clothing
  - Do not wear wide clothing or jewellery, which can become entangled in moving parts.
  - Rubber gloves and non-slip shoes are recommended when working outdoors.
  - Tie long hair back in a hair net.
8. Do not use the cable for purposes for which it is not intended
  - Do not use the cable to pull the plug out of the outlet. Protect the cable from heat, oil and sharp edges.
9. Take care of your tools
  - Keep your compressor clean in order to work well and safely.
  - Follow the maintenance instructions.
  - Check the connection cable of the electric tool regularly and have it replaced by a recognised specialist when damaged.
  - Check extension cables regularly and replace them when damaged.
10. Pull the plug out of the outlet
  - During non-use of the electric tool or prior to maintenance and when replacing tools such as saw blades, bits, milling heads.
11. Avoid inadvertent starting
  - Make sure that the switch is switched off when plugging the plug into an outlet.
12. Use extension cables for outdoors
  - Only use approved and appropriately identified extension cables for use outdoors.
  - Only use cable reels in the unrolled state.
13. Remain attentive
  - Pay attention to what you are doing. Remain sensible when working. Do not use the electric tool when you are distracted.
14. Check the electric tool for potential damage
  - Protective devices and other parts must be carefully inspected to ensure that they are fault-free and function as intended prior to continued use of the electric tool.
  - Check whether the moving parts function faultlessly and do not jam or whether parts are damaged. All parts must be correctly mounted and all conditions must be fulfilled to ensure fault-free operation of the electric tool.
  - Damaged protective devices and parts must be properly repaired or replaced by a recognised workshop, insofar as nothing different is specified in the operating manual.
  - Damaged switches must be replaced at a customer service workshop.
  - Do not use any faulty or damaged connection cables.
  - Do not use any electric tool on which the switch cannot be switched on and off.
15. Have your electric tool repaired by a qualified electrician
  - This electric tool conforms to the applicable safety regulations. Repairs may only be performed by an electrician using original spare parts. Otherwise accidents can occur.
16. Important!
  - For your own safety you must only use the accessories and additional units listed in the operating instructions or recommended or specified by the manufacturer. The use of mounted tools or accessories other than those recommended in the operating instructions or catalog may place your personal safety at risk.
17. Noise
  - Wear ear muffs when you use the compressor.
18. Replacing the power cable
  - To prevent hazards, leave the replacement of damaged power cables strictly to the manufacturer or a qualified electrician. There is a risk of electric shock!
19. Inflating tires
  - Directly after inflating tires, check the pressure with a suitable pressure gauge, for example at your filling station.
20. Roadworthy compressors for building site operations
  - Make sure that all lines and fittings are suitable for the maximum permissible operating pressure of the compressor.
21. Place of installation
  - Set up the compressor on an even surface.

### ADDITIONAL SAFETY INSTRUCTIONS

#### Safety instructions for working with compressed air and blasting guns

- The compressor pump and lines can become very hot during operation. Touching these parts will burn you.
- The air which is sucked in by the compressor must be kept free of impurities that could cause fires or explosions in the compressor pump.
- When releasing the hose coupling, hold the hose coupling piece with your hand. This way, you can protect yourself against injury from the rebounding hose.
- Wear safety goggles when working with the blowout pistol. Foreign bodies or blown off parts can easily cause injuries.
- Do not blow at people with the blow-out pistol and do not clean clothes while being worn. Risk of injury!

#### Safety information for paint spraying

- Do not process any paints or solvents with a flash point below 55° C. There is a risk of explosion!
- Do not heat up paints or solvents. There is a risk of explosion!
- If hazardous liquids are processed, wear protective filter units (face guards). Also, adhere to the safety information provided by the manufacturers of such liquids.
- The details and designations of the Ordinance on Hazardous Substances, which are displayed on the outer packaging of the processed material, must be observed.
- Additional protective measures are to be undertaken if necessary, particularly the wearing of suitable clothing and masks.
- Do not smoke during the spraying process and/or in the work area. There is a risk of explosion! Paint vapors are easily combustible.
- Never set up or operate the equipment in the vicinity of a fire place, open lights or sparking machines.
- Do not store or eat food and drink in the work area. Paint vapors are harmful to your health.
- The work area must exceed 30 m<sup>3</sup> and sufficient ventilation must be ensured during spraying and drying. Do not spray against the wind. Always adhere to the regulations of the local police authority when spraying combustible or hazardous materials.

- Do not process media such as white spirit, butyl alcohol and methylene chloride with the PVC pressure hose. These media will destroy the pressure hose.

#### Operating pressure vessels

- You must keep your pressure vessel in good working order, operate the vessel correctly, monitor the vessel, carry out necessary maintenance and repair work immediately and meet the relevant safety precautions.
- The supervisory authority may enforce essential control measures in individual cases.
- A pressure vessel is not allowed to be used if it has faults or deficiencies that can endanger workers or third parties.
- Check the pressure vessel for signs of rust and damage each time before using. Do not use the compressor with a damaged or rusty pressure vessel. If you discover any damage, then please contact the customer service workshop.

#### Safety instructions for accessories

- **Check the air pressure with a suitable manometer after filling.**
- **RISK OF FIRE, EXPLOSION AND DAMAGE TO HEALTH!** The device must be used in well-ventilated areas
- **DANGER OF INJURY!** Never exceed the maximum allowable working air pressure of 8 bar. Use a pressure reducer to set the working air
- **RISK OF RECOIL FORCES!** High working pressures can give rise to recoil forces that under certain conditions can result in danger from continuous
- **DANGER OF INJURY! IMPROPER USE!** Never point the device at people or
- **DANGER OF INJURY!** Never use oxygen or other combustible gas as the energy
- **DANGER OF INJURY! First disconnect the hose from the compressed air source and only then disconnect the compressed air supply hose from the device.** This will ensure that the compressed air supply hose does not wave around or recoil in an uncontrolled
- **For your own safety, wear suitable personal protective**
- **Keep children and other people away while you are operating the device.** Distractions can cause you to lose control of the
- Disconnect the device from the compressed air source before carrying out any repairs or maintenance of the device or moving it to another
- When removing the hose coupling, hold the hose tightly in your hand to avoid injury caused by the hose shooting
- **Look out for damage on the device.** Check the device for damage before bringing it into use. Do not use the device if you discover an
- Do not kink the device's hose, otherwise you may damage
- **NOTE!** Observe the safety advice provided by the manufacturer of your inflatable
- Do not remove rating plates or labels – they are safety-relevant parts of the
- If you are inexperienced in the use of this type of device, you should seek out information or training to learn how to handle it safely.

#### Do not lose these safety instructions

#### Technical data

Mains connection	230 V~ 50 Hz
Motor rating W	max. 1100
Operating mode	S1
Compressor speed min-1	3750 min-1
Pressure vessel capacity (in liters)	2
Operating pressure	approx. 8 bar
Theoretical intake capacity (l/min)	approx. 180
sound power level LWA	95 dB(A)
uncertainty KWA	3 dB
Protection type	IP20
Weight of the unit in kg	8

The noise emission values were measured in accordance with EN ISO 3744.

#### Wear hearing protection.

The effects of noise can cause a loss of hearing.

#### Before starting the equipment

Before you connect the equipment to the mains supply make sure that the data on the rating plate are identical to the mains data.

- Check the equipment for damage which may have occurred in transit. Report any damage immediately to the transport company which was used to deliver the compressor.
- Install the compressor near the point of consumption. - Avoid long air lines and supply lines (extension cables).
- Make sure that the intake air is dry and dustfree.
- Do not install the compressor in a damp or wet room.
- The compressor may only be used in suitable rooms (with good ventilation and an ambient temperature from +5 °C to 40 °C). There must be no dust, acids, vapors, explosive gases or inflammable gases in the room.
- The compressor is designed to be used in dry rooms. It is prohibited to use the compressor in areas where work is conducted with sprayed water.

#### Attachment and operation



**Important!**  
You must fully assemble the appliance before using it for the first time!

#### Mains connection

- The compressor is equipped with a mains cable with shock-proof plug. This can be connected to any 230/240 V~ 50 Hz shock-proof socket which is protected by a 16 A fuse.
- Before you use the machine, make sure that the mains voltage is the same as the operating voltage (see the rating plate).
- Long supply cables, extensions, cable reels etc. cause a drop in voltage and can impede motor startup.
- At low temperatures below +5°C, sluggishness may make starting difficult or impossible.

#### ON/OFF switch (fig. 1)

- To switch on the compressor, press the button (2) on position I.
- To switch off the compressor, press the button (2) on position 0.

#### Setting the pressure (Fig. 1)

- Use the pressure regulator (8) to set the pressure on the pressure gauge (7).
- The set pressure can be drawn from the quicklock coupling (6).
- The vessel pressure can be read off the pressure gauge (4).

#### Setting the pressure switch

- The pressure switch is set at the factory.  
Cut-in pressure approx. 6 bar.  
Cut-out pressure approx. 8 bar.

 **Important!** The accessories used must be adapted to the maximum allowable pressure of the mobile compressor  
Use pressure hoses with safety cable (eg wire rope)

## Electrical connection

The electrical motor installed is connected and ready for operation. The connection complies with the applicable VDE and DIN provisions.  
The customer's mains connection as well as the extension cable used must also comply with these regulations.

### Damaged electrical connection cable

The insulation on electrical connection cables is often damaged.  
This may have the following causes:

- Passage points, where connection cables are passed through windows or doors.
- Kinks where the connection cable has been improperly fastened or routed.
- Places where the connection cables have been cut due to being driven over.
- Insulation damage due to being ripped out of the wall outlet.
- Cracks due to the insulation ageing.

Such damaged electrical connection cables must not be used and are life-threatening due to the insulation damage. Check the electrical connection cables for damage regularly. Make sure that the connection cable does not hang on the power network during the inspection. Electrical connection cables must comply with the applicable VDE and DIN provisions. Only use connection cables with the marking „H05VV-F“.

The printing of the type designation on the connection cable is mandatory.

### AC motor

- The mains voltage must be 230 V~
- Extension cables up to 25 m long must have a cross-section of 1.5 mm<sup>2</sup>.
- Connections and repairs of electrical equipment may only be carried out by an electrician.

Please provide the following information in the event of any enquiries:

- Type of current for the motor
- Machine data – type plate
- Machine data – type plate

## Cleaning, maintenance, and storage

 **Important!**  
Pull out the power plug before doing any cleaning and maintenance work on the equipment. Risk of injury from electric shock!

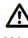
 **Important!**  
Wait until the equipment has cooled down completely! Risk of burns!

 **Important!**  
Always depressurize the equipment before carrying out any cleaning and maintenance work! Risk of injury!

### Cleaning

- Keep the equipment free of dirt and dust as far as possible. Wipe the equipment with a clean cloth or blow it down with compressed air at low pressure.
- We recommend that you clean the equipment immediately after you use it.
- Clean the equipment regularly with a damp cloth and some soft soap. Do not use cleaning agents or solvents; these may be aggressive to the plastic parts in the equipment. Ensure that no water can get into the interior of the equipment.
- You must disconnect the hose and any spraying tools from the compressor before cleaning. Do not clean the compressor with water, solvents or the like.

### Maintenance work on the pressure vessel/condensed water (Fig. 1/2)

 **Important!**  
**To ensure a long service life of the pressure vessel (5), drain off the condensed water by opening the drain valve (11) each time after using.**  
Release the vessel pressure first. Open the drain screw by turning counter-clockwise (looking at the screw from the bottom of the compressor) so that all the condensed water can run out of the pressure vessel. Then close the drain screw again (turn it clockwise). Check the pressure vessel for signs of rust and damage each time before using.

Do not use the compressor with a damaged or rusty pressure vessel. If you discover any damage, then please contact the customer service workshop.

### Safety valve (Fig. 2/Pos. 12)

The safety valve (12) has been set for the highest permitted pressure of the pressure vessel. It is prohibited to adjust the safety valve or remove its seal. Actuate the safety valve from time to time to ensure that it works when required. Pull the ring with sufficient force until you can hear the compressed air being released. Then release the ring again.

### Storage

 **Important!**  
**Pull out the mains plug and ventilate the equipment and all connected pneumatic tools. Switch off the compressor and make sure that it is secured in such a way that it cannot be started up again by any unauthorized person.**

**Important!** Store the compressor only in a dry location which is not accessible to unauthorized persons. Always store upright, never tilted!

### Releasing excess pressure

Release the excess pressure by switching off the compressor and using the compressed air which is still left in the pressure vessel, e.g. with a compressed air tool running in idle mode or with a blow-out pistol.

### Storage power cord, hose and accessories (Fig. 3/4)

- The power cord can be stored sideways of the compressor.
- The air hose can be stored in the tool compartment.
- On the inside of the tool compartment (10) can be stored accessories.

## Disposal and recycling

The equipment is supplied in packaging to prevent it from being damaged in transit. The raw materials in this packaging can be reused or recycled. The equipment and its accessories are made of various types of material, such as metal and plastic. Defective components must be disposed of as special waste. Ask your dealer or your local council.



Troubleshooting

Fault	Possible cause	Remedy
The compressor does not start.	<ul style="list-style-type: none"><li>No supply voltage.</li><li>Insuffi cient supply voltage</li><li>Outside temperature is too low.</li><li>Motor is overheated.</li></ul>	<ul style="list-style-type: none"><li>No supply voltage.</li><li>Insuffi cient supply voltage.</li><li>Outside temperature is too low</li><li>Motor is overheated.</li></ul>
The compressor starts but there is no pressure.	<ul style="list-style-type: none"><li>The non-return valve leaks</li><li>The seals are damaged</li><li>The drain plug for condensation water leaks.</li></ul>	<ul style="list-style-type: none"><li>The non-return valve leaks</li><li>The seals are damaged.</li><li>The drain plug for condensation water leaks.</li></ul>
The compressor starts, pressure is shown on the pressure gauge, but the tools do not start.	<ul style="list-style-type: none"><li>The hose connections have a leak.</li><li>A quick-lock coupling has a leak.</li><li>Insuffi cient pressure set on the pressure regulator.</li></ul>	<ul style="list-style-type: none"><li>The hose connections have a leak.</li><li>A quick-lock coupling has a leak.</li><li>Insuffi cient pressure set on the pressure regulator.</li></ul>

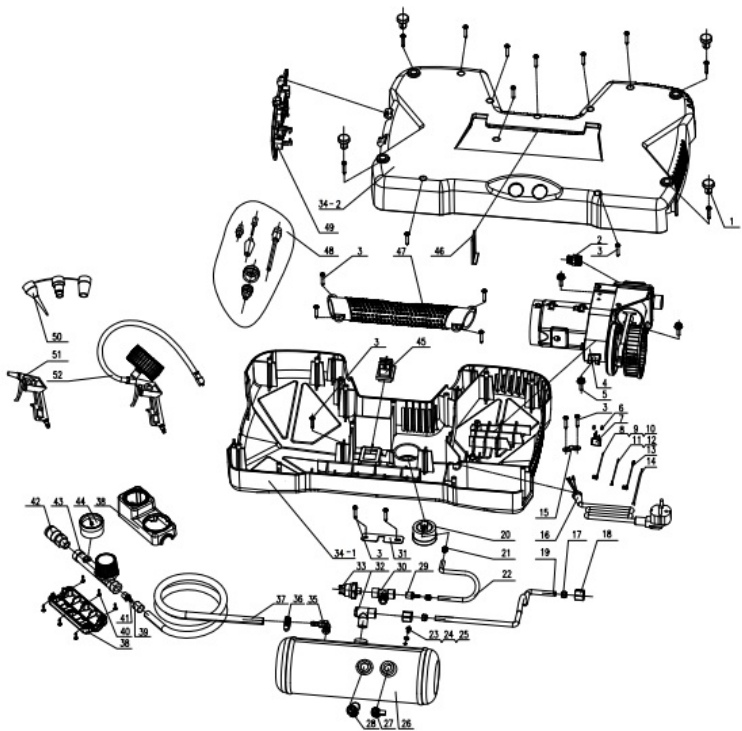
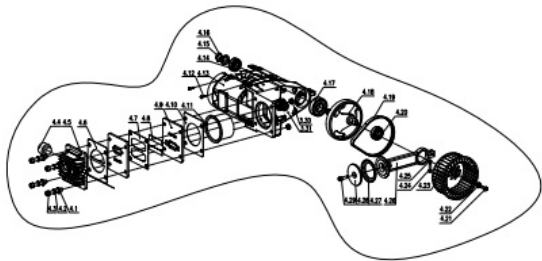
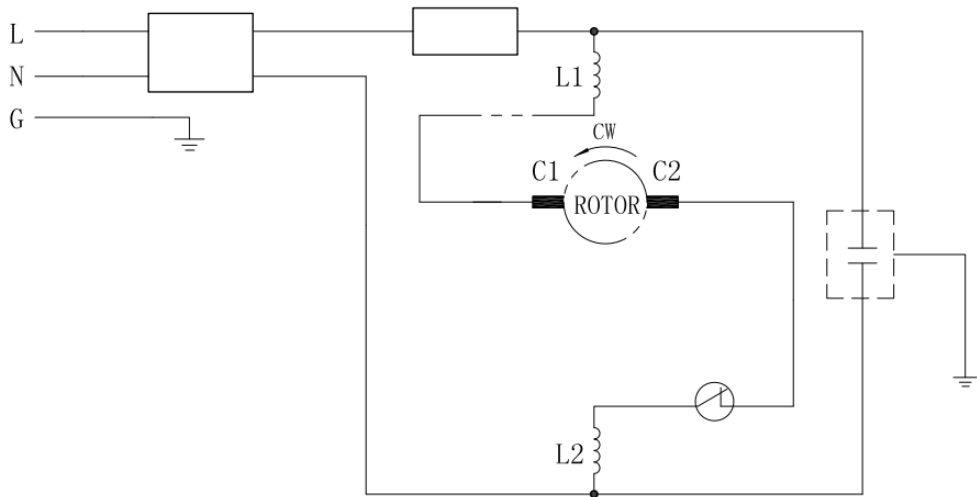

Warranty

Apparent defects must be notified within 8 days from the receipt of the goods. Otherwise, the buyerís rights of claim due to such defects are invalidated. We guarantee for our machines in case of proper treatment for the time of the statutory warranty period from delivery in such a way that we replace any machine part free of charge which provably becomes unusable due to faulty material or defects of fabrication within such period of time. With respect to parts not manufactured by us we only warrant insofar as we are entitled to warranty claims against the upstream suppliers. The costs for the installation of the new parts shall be borne by the buyer. The cancellation of sale or the reduction of purchase price as well as any other claims for damages shall be excluded.





Documents / Resources



[scheppach Air Case Compact Compressor](#) [pdf] Instruction Manual  
Air Case, Compact Compressor, Compressor, Air Case

References

- [🔗 scheppach | scheppach](#)

Manuals+.

- [home](#)
- [privacy](#)