



Schelinger G8-1P Overcurrent Circuit Breaker Installation Guide

[Home](#) » [Schelinger](#) » Schelinger G8-1P Overcurrent Circuit Breaker Installation Guide 

Schelinger G8-1P Overcurrent Circuit Breaker Installation Guide



Contents

[1 Installation instructions](#)

[2 Dimension](#)

[3 Instructions](#)

[4 Documents / Resources](#)

[4.1 References](#)

[5 Related Posts](#)

Installation instructions

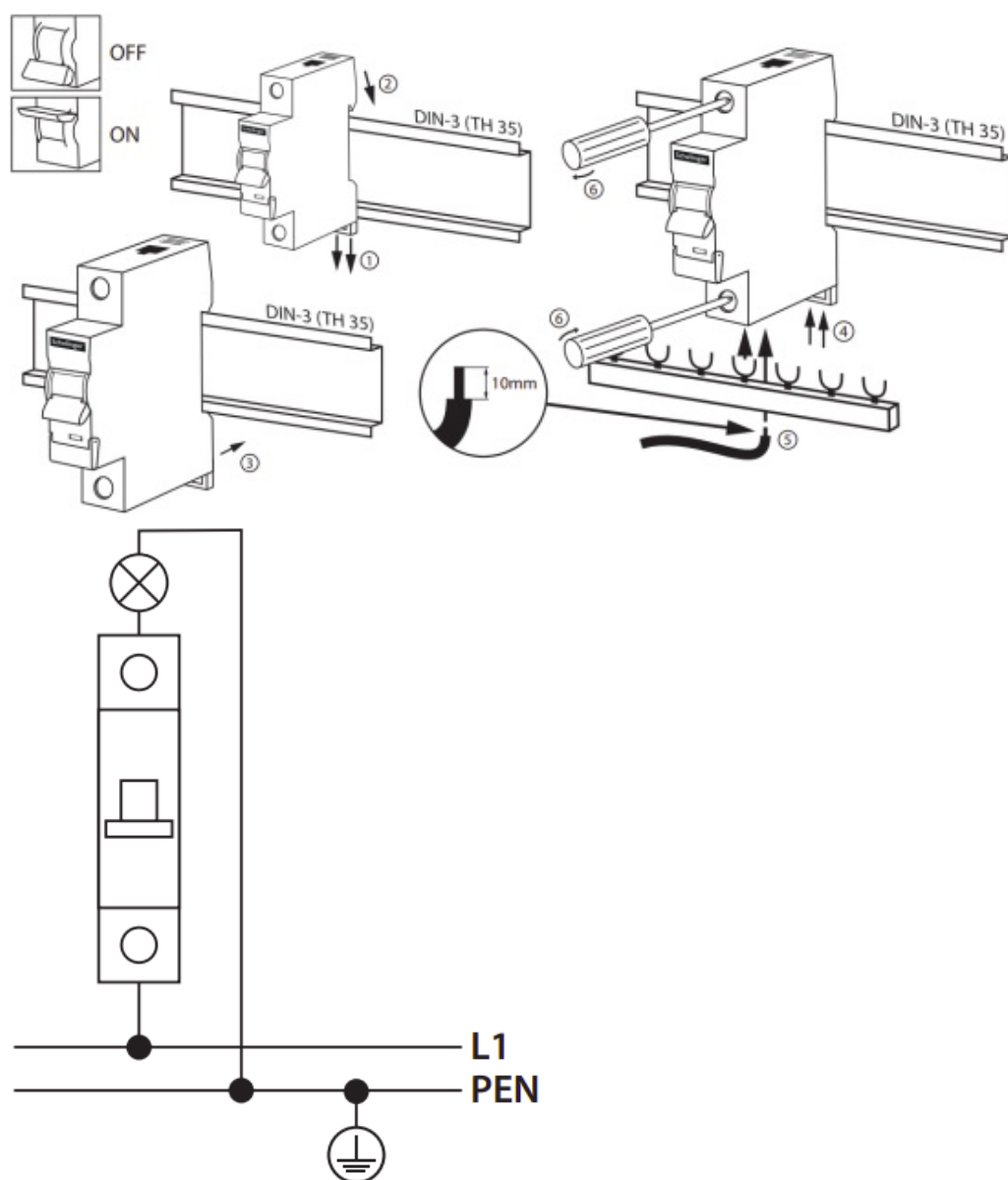

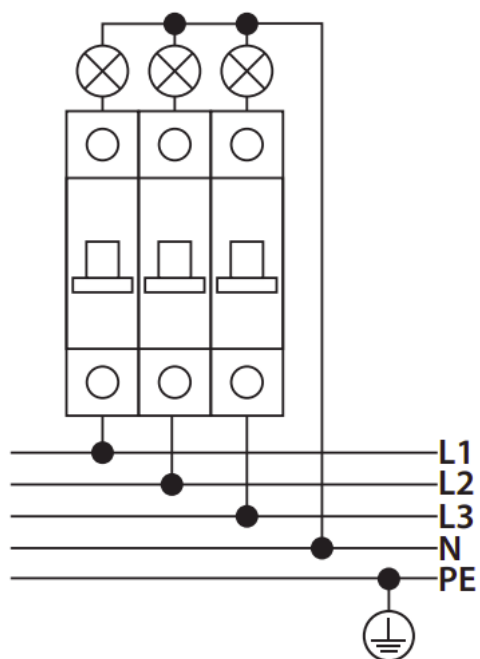
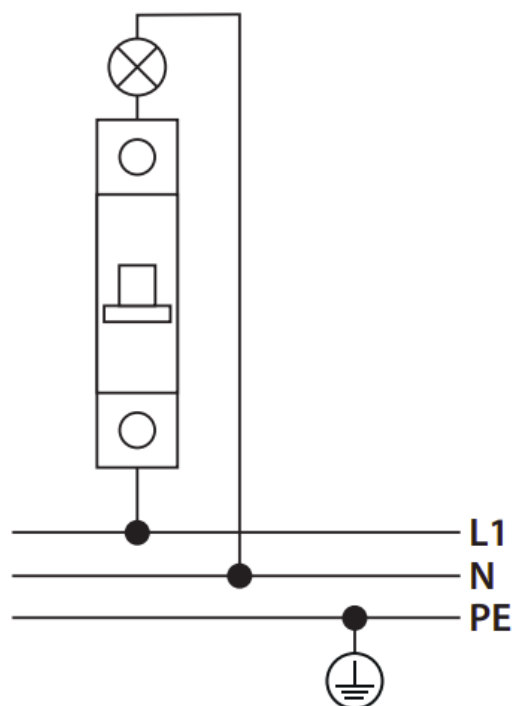
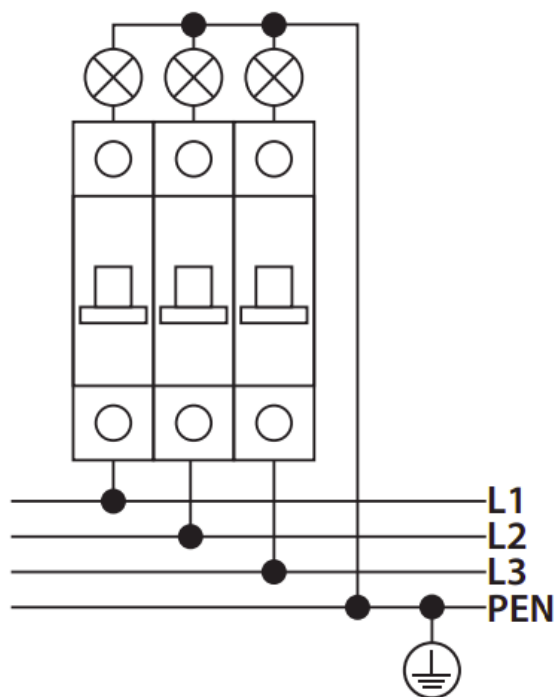



Waste electrical products should not be disposed with household waste. Please recycle where facilities exist. Check with Your Local Authority or retailer for recycling advice.

Dimension

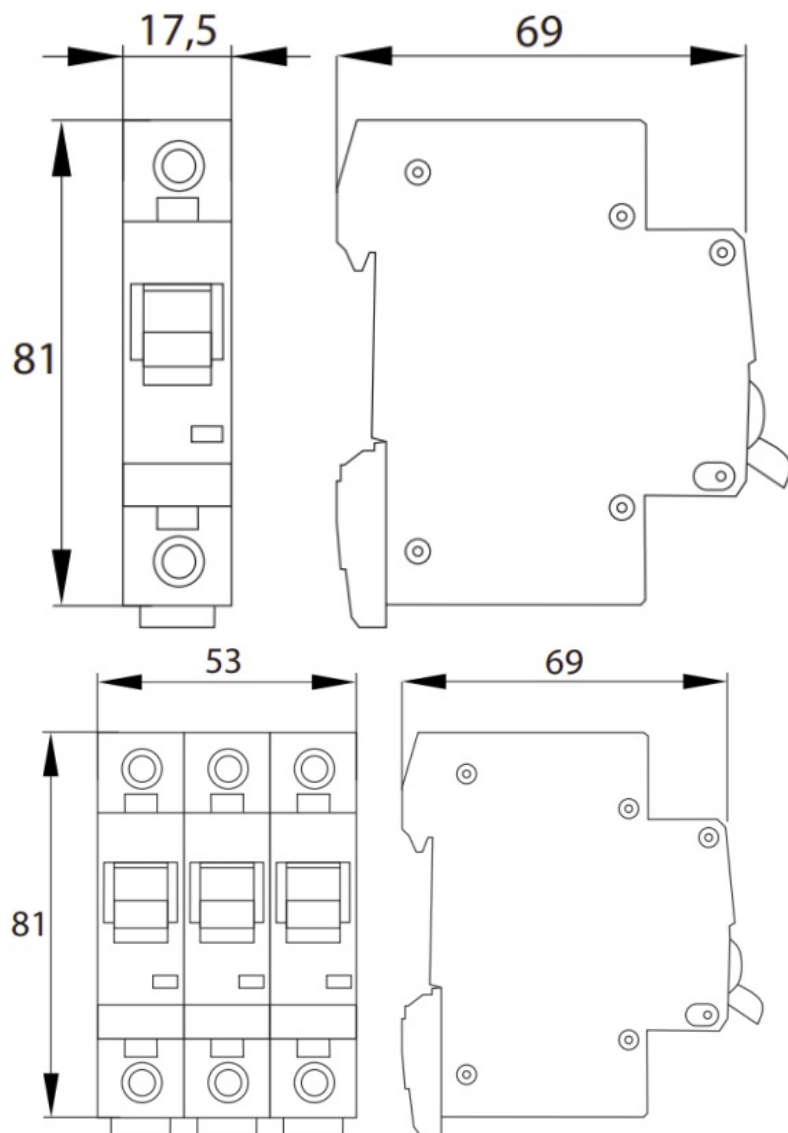

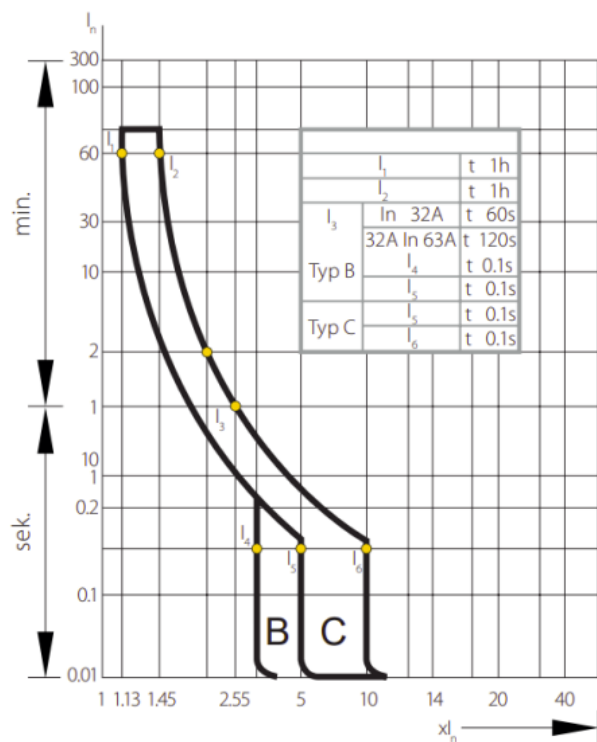

Instructions

1

U_n
 1P: 230/400V~
 50/60Hz
 3P: 400V~
 50/60Hz

2

G8-1P-B: B
 G8-3P-B: B
 G8-1P-C: C
 G8-3P-C: C

3

I_n

2 ÷ 63A

4

I_{cn}

6000A

5

3

6

IP20

7



10000x

8

U_i
400V

9

U_{imp}
4kV

10

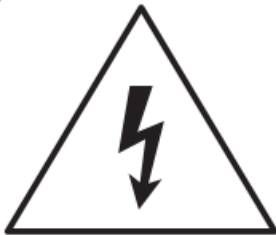

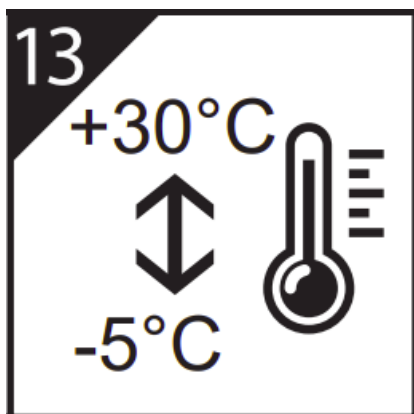

1. Rated voltage, frequency.
2. Work characteristics.
3. Rated current.
4. Rated short circuit breaking capacity.
5. Energy restriction class.
6. International Protection Rating.
7. Mechanical strength.
8. Rated insulation voltage.
9. Rated surge voltage.
10. Caution, risk of electric shock.
11. For internal use.
12. Terminal capacity.
13. Working temperature.

Security

Before mounting, read the instructions and disconnect the power supply.

Installation should be performed by a qualified user authorized to mount electrical devices depending on the

applicable regulations in a given country, in accordance with the mounting diagram. Modifications to the product may cause threat and loss of warranty. Use protection against frost when working below 0 ° C.

Maintenance

All maintenance work should be carried out after disconnecting the power supply. The product temperature may rise to an elevated value. Before commencing maintenance, make sure that the product temperature is safe to make it. Guarantee unrestricted air supply, do not cover the product. Use dry and delicate materials for cleaning. Do not use chemical agents. Product not adapted to work in an environment with unfavorable conditions, i.e. high dustiness / humidity, water, explosive zones, vibrations, chemical fumes.

Recommendations

Failure to follow the instructions in the manual may result in a fire, electric shock, burns or other damage. Bemko sp. O.o. is not responsible for failure to comply with the above recommendations. We also reserve the right to make changes to the manual – the current version is available at www.bemko.eu.

Bemko Sp. z o.o.
ul. Bocznicowa 13
05-850
www.schelinger.eu

Schelinger

Documents / Resources

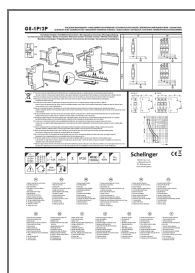

[Schelinger G8-1P Overcurrent Circuit Breaker](#) [pdf] Installation Guide
G8-1P, G8-3P, G8-1P Overcurrent Circuit Breaker, G8-1P, Overcurrent Circuit Breaker, Circuit B reaker, Breaker

References

- [🌐 One moment, please...](#)
- [📄 One moment, please...](#)
- [User Manual](#)

[Manuals+](#), [Privacy Policy](#)

This website is an independent publication and is neither affiliated with nor endorsed by any of the trademark owners. The "Bluetooth®" word mark and logos are registered trademarks owned by Bluetooth SIG, Inc. The "Wi-Fi®" word mark and logos are registered trademarks owned by the Wi-Fi Alliance. Any use of these marks on this website does not imply any affiliation with or endorsement.