



scentify V2 Home Plug-In Diffuser User Manual

[Home](#) » [scentify](#) » scentify V2 Home Plug-In Diffuser User Manual 

scentify

MANUA
HOME PLUG-IN
DIFFUSER”
LOVE AT FIRST SCENT



Contents

- 1 V2 Home Plug-In Diffuser
- 2 CONCENTRATION AND CONSUMPTION
- 3 GETTING SET UP
- 4 OPERATIONS
- 5 TROUBLESHOOTING
- 6 Documents / Resources
 - 6.1 References

V2 Home Plug-In Diffuser



CONNECTING TO APP

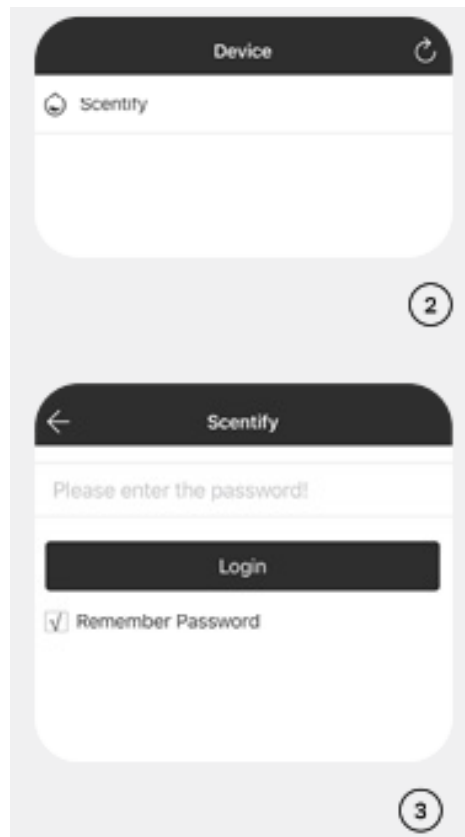

1. Open the “Google Play” store or *App Store” on your smartphone, search for the Scantily app and download.
NOTE: Make sure the Bluetooth and Location function of your mobile phone s turned “ON”.
2. Open the Scantily app on your smartphone and select your device.
3. Enter the default password 8888 and press Login.

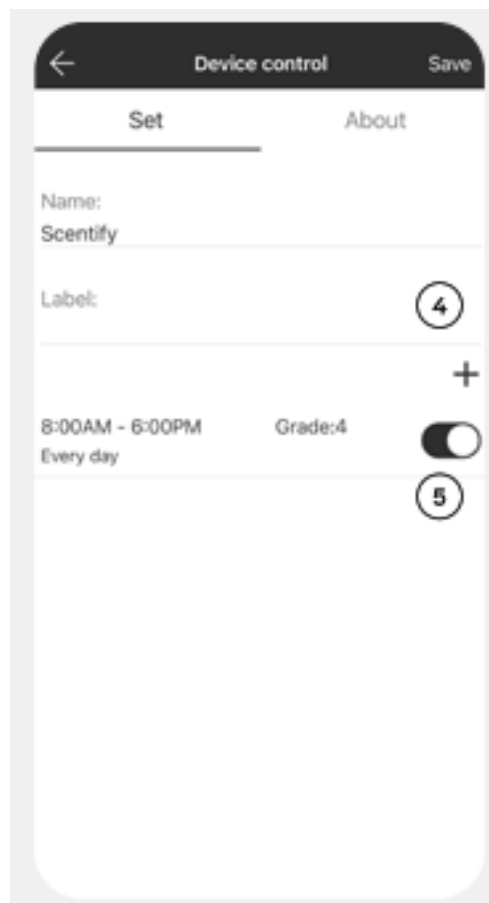

On the Device Control page;

4. You can change your device name and label information of your scent machine.

NOTE: Press the “Save” button at the top right corner of the screen after each change.

5. Press the schedule you would like to edit.

NOTE: You can set up to 5 different schedules by pressing the + button. To delete a schedule, swipe left. Press the toggle button to turn on/off any schedule.

The screenshot displays the 'Working period setting' interface with the following components:

- Header:** A back arrow, the title 'Working period setting', a '10' indicator, and a 'Save' button.
- Time Selection:** Two columns for 'Start working time' and 'Stop working time'. Each column has a scrollable list of times (6:59, 7:00 AM, 8:01 PM, 10:59 AM, 11:00 PM, 12:01 PM) and a '12' indicator.
- Repeat Section:** A 'Repeat' label followed by seven day buttons (Mon, Tue, Wed, Thur, Fri, Sat, Sun). A '7' indicator points to the 'Wed' button.
- Intensity Control:** A 'Grade' section with a checked checkbox, a '8' indicator, a minus button, the number '4', and a plus button.
- Custom Section:** A 'Custom' checkbox with a '9' indicator.
- Time Settings:** Two columns for 'Spray Time' and 'Pause Time'. The 'Spray Time' column shows '5 Seconds' and '6' indicator. The 'Pause Time' column shows '4 Minutes' and '5' indicator.

On the *Working period setting* page;

6. Set the hours of the day you want your diffuser to run by scrolling the *Start working time* and “Stop working time”.
7. Select the days of the week you want your diffuser to run (all days are pre-selected).
8. Press + or – to increase or decrease the preset intensity grades (1-4). See chart for details
9. check (N the custom box to create a custom Intensity and scroll scroll the “Spray Time ”and“ Stop M€

NOTE: Press the *Save” button to update the EEERER

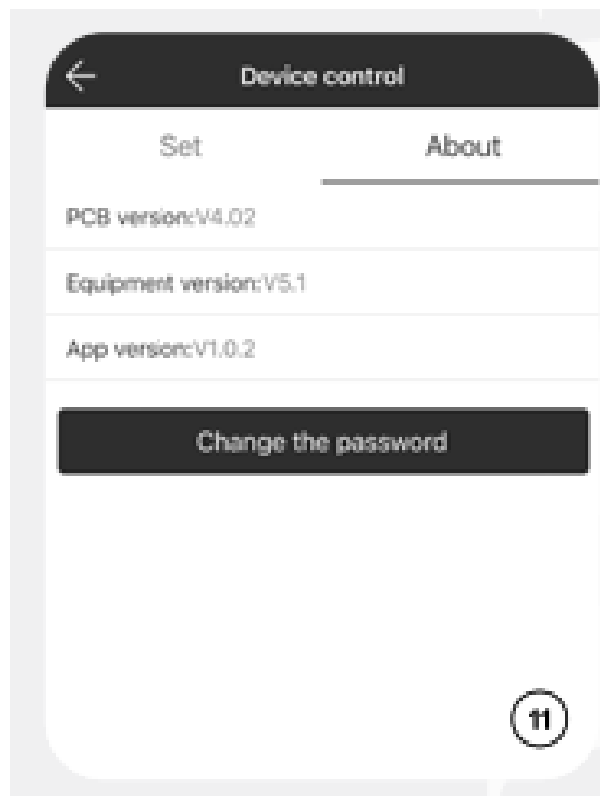

10. You can change the default password by pressing on the “About” tab, in the -Device control” page.

CONCENTRATION AND CONSUMPTION

Grade	G1 ?	G2 ??	G3 ???	G4 ???? ?
Pausing time	360	270	180	90
Consumption (mi/r)	0.07	0.10	0.14	0.26

NOTES:

1. The working time for each grade is 155
2. Different oils may vary with above times.

PLEASE READ BEFORE USE

Do not pour oil into bottom cup.
Always keep upright.
Tilting machine will cause damage.

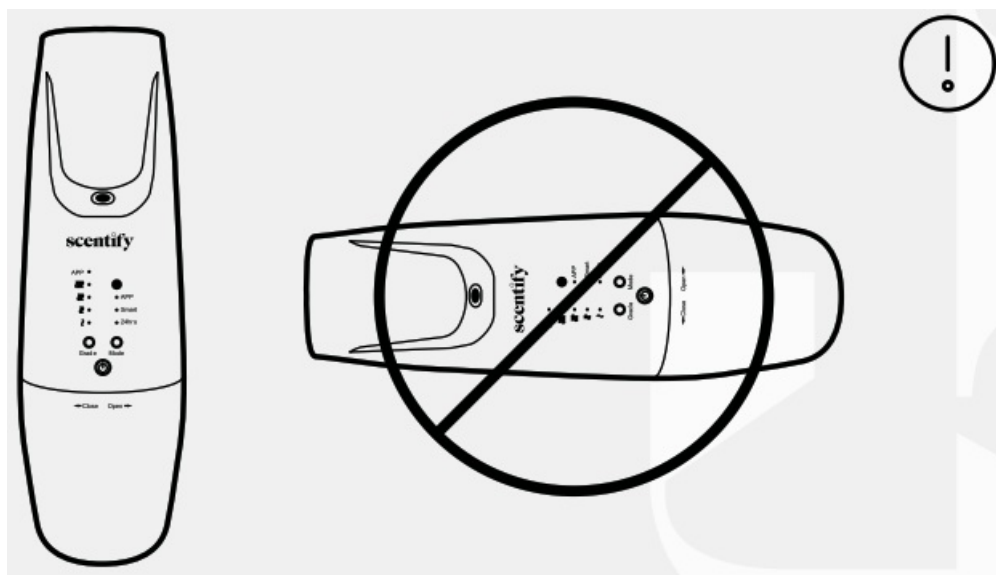

GETTING SET UP

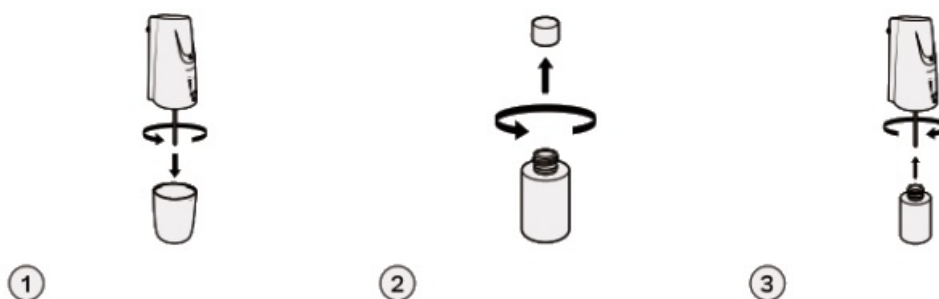

1. Unscrew the bottom cover.
2. Unscrew bottle cap to fill with desired oil fragrance.
3. Guide tube into the bot-tel, and screw bottle into base of the diffuser unit.

NOTE: There is a filter in the tube, do not remove.

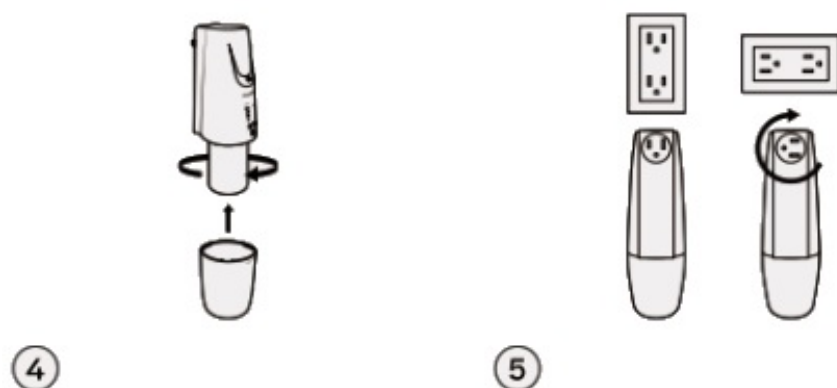

4. Screw bottom cover onto the base of the diffuser unit.
5. Plug in unit to outlet. Make sure that unit is always upright to avoid leakage. Rotate plug prongs if necessary.

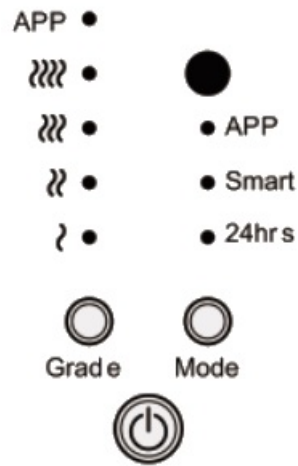

OPERATIONS

APP Custom app setting

Preset to Spray time: 15 seconds

Pause time: 10 minutes

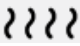
 Spray time: 15 seconds

Pause time: 1.5minute

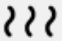
 Spray time: 15 seconds

Pause time: 3 minutes.

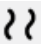
 Spray time: 15 seconds

Pause time:4.5minutes

 Spray time: 15 seconds

Pause time: 6 minutes.

 Grade =Strength

APP Custom app setting

Preset to8:00am – 8:00pm

smart Works with daylight or artificial light

2ahes Works 24 hours

 Mode = Hours

 **POWER ON/OFF**

Hold for 2 seconds

 **WARNINGS**

Always keep the diffuser upright.

Tilted or angled will cause o to overflow and damage the diffuser.

EQUIPMENT CLEANING

1. Fill the bottle with water and vinegar or rubbing alcohol.
2. Let the diffuser run for about 5 minutes.
3. Drain the diffuser bottle completely.
4. Using a cotton swab dipped in vinegar, clean the tight spots and corners of the diffuser to make sure that no spots are. left dirty.

MAINTENANCE & STORAGE

- Always turn off or unplug the diffuser when not in use.

- Remove the bottle of when storing or transporting the diffuser.
- Store the diffuser in a dry and clean place.

TROUBLESHOOTING

Problem	Solution
No Diffusion	<ul style="list-style-type: none"> – Check if the power is ON or OFF. – Check oil leveling bottle – Check app settings or switch to button settings. – Follow cleaning instructions above.
Oil Leaking	<ul style="list-style-type: none"> – Check if bottle is screwed in tightly.

FCC Statement

This equipment has been tested and found to comply with the limits for a Class B digital device, pursuant to part 15 of the FCC Rules. These limits are designed to provide reasonable protection against harmful interference in a residential installation. This equipment generates, uses and can radiate radio frequency energy and, if not installed and used in accordance with the instructions, may cause harmful interference to radio communications. However, there is no guarantee that interference will not occur in a particular installation. If this equipment does cause harmful interference to radio or television reception, which can be determined by turning the equipment off and on, the user is encouraged to try to correct the interference by one or more of the following measures:

- Reorient or relocate the receiving antenna.
- Increase the separation between the equipment and receiver.
- Connect the equipment into an outlet on a circuit different from that to which the receiver is connected.
- Consult the dealer or an experienced radio/TV technician for help.

Caution: Any changes or modifications to this device not explicitly approved by manufacturer could void your authority to operate this equipment.

This device complies with part 15 of the FCC Rules. Operation is subject to the following two conditions:

1. This device may not cause harmful interference, and
2. this device must accept any interference received, including interference that may cause undesired operation.

RF Exposure Information

This equipment complies with FCC radiation exposure limits set forth for an uncontrolled environment. This equipment should be installed and operated with minimum distance 20cm between the radiator and your body.

scntify

@ scntifynyc
scntifyhome.com

Documents / Resources

	<p>scentify V2 Home Plug-In Diffuser [pdf] User Manual 2BBB5-SCENTIFY, 2BBB5SCENTIFY, V2 Home Plug-In Diffuser, V2, Home Plug-In Diffuser, Plug-In Diffuser, Diffuser</p>
-----------------------------------------------------------------------------------	-----------------------------------------------------------------------------------------------------------------------------------------------------------------------------------------------

References

- [User Manual](#)