



SCANSTRUT DS30-SL Starlink Cable Seal Installation Guide

September 3,
2025

Contents [[hide](#)]

- [1 SCANSTRUT DS30-SL Starlink Cable Seal Installation Guide](#)
- [2 SCANSTRUT DS30-SL Starlink Cable](#)
- [3 Key Features & Description](#)
- [4 Installation Steps](#)
- [5 Specifications](#)
- [6 Product Usage Instructions](#)
- [7 FAQ](#)
- [8 Read More About This Manual & Download PDF:](#)
- [9 Documents / Resources](#)
 - [9.1 References](#)

SCANSTRUT DS30-SL Starlink Cable Seal Installation Guide



SCANSTRUT DS30-SL Starlink Cable

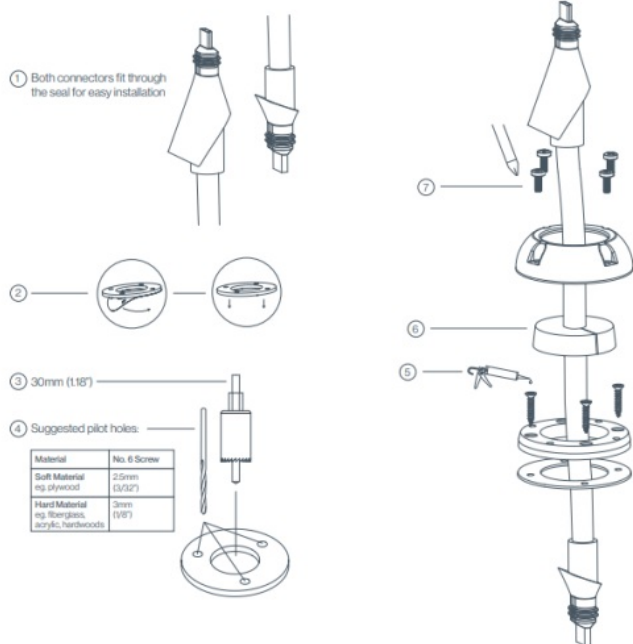

Key Features & Description

- Specifically engineered for Starlink (Gen3 standard, Enterprise, and Mini units)
- Supports cable diameters from 4mm to 6mm (0.16"—0.24") and connectors up to Ø16mm (0.63")
- Made with high-impact UV-stable plastic and includes 316 stainless steel fixings plus a waterproof 3M gasket for durability in harsh environments.
- Rated IP68 waterproof, meaning it's designed for full water immersion and dust

sealing.

- Features a dome-shaped (aesthetic and robust) profile that increases impact resistance and sheds water more effectively.
- Split bung design allows installation without removing cable connectors—especially useful for retrofits or field installs.
- Includes three sealing bungs: one blank, one for 4mm, and one for 6mm, plus a self-drill bung option for customization.

Tools You'll Need

- Drill and appropriate drill bits
- Screwdriver
- Seaant (marine-grade or outdoor-rated)
- Pencil/marker
- Optional: Freezer (if customizing the bung)

Installation Steps

Choose the Location

- Select a flat, clean surface for mounting the seal.
- Ensure it's near where the Starlink cable enters (e.g., RV roof, boat deck, van wall, etc.).

Mark the Hole

- Use the base of the DS16-SL as a template.
- Mark the center hole (for the cable) and the screw holes.

Drill the Holes

- Drill a hole for the cable based on your cable's size (usually 16mm max for Starlink).

- Drill pilot holes for the mounting screws.

Select and Prepare the Bung

- Pick one of the included sealing bungs: 4mm, 6mm, or blank.
- If using the blank one, **freeze** it for 10–15 minutes and drill it to the exact cable size while cold (helps prevent tearing).

Insert the Cable

- Use the **split bung design** to insert the cable **without removing the connector**.
- Wrap the split bung around the cable.

Assemble the Seal

- Place the gasket under the base.
- Insert the bung into the top dome piece.
- Route the cable through the center hole and assemble the dome on top.

Apply Sealant (Optional but Recommended)

- Apply marine sealant or silicone around the cable entry hole and screw holes to ensure full waterproofing.

Secure the Seal

- Align the seal with the holes.
- Use the included 316 stainless screws and captive nuts to secure everything in place.
- Tighten evenly to compress the gasket for a watertight seal.

Check for Water Resistance

- Ensure there are no gaps.
- Test with a gentle water spray or wait for natural exposure.

Specifications

- **A:** 39mm / 1.18 inches
- **B:** 16mm / 0.63 inches
- **C:** 36.5mm / 1.44 inches
- **D:** 19mm / 0.75 inches

Product Usage Instructions

STARLINK Compatibility

This product is compatible with various STARLINK systems:

- High Performance / Flat Performance (Gen 1)
- High Performance / Standard Performance (Gen 2)
- Standard Enterprise (Gen 3) / Enterprise Mini

DS16-SL / DS16-SL-BLK

No specific information is available for this model.

DS30-SL / DS30-SL-BLK

No specific information is available for this model.

FAQ

What is the TEC-006889?

The TEC-006889 is a unique identifier for the product.

Read More About This Manual & Download PDF:

Documents / Resources

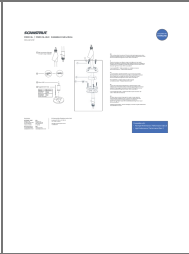
| | |
|--|--|
|  | <p>SCANSTRUT DS30-SL Starlink Cable Seal [pdf] Installation Guide</p> <p>DS30-SL, DS30-SL-BLK, DS30-SL Starlink Cable Seal, DS30-SL, Starlink Cable Seal, Cable Seal, Seal</p> |
|--|--|

References

- [User Manual](#)

SCANSTRUT

Cable Seal, DS30-SL, DS30-SL Starlink Cable Seal, DS30-SL-BLK, SCANSTRUT, SEAL, Starlink Cable Seal

Leave a comment

Your email address will not be published. Required fields are marked *

Comment *

Name

Email

Website

☐ Save my name, email, and website in this browser for the next time I comment.

Post Comment

Search:

e.g. whirlpool wrf535swhz

Search

[Manuals+](#) | [Upload](#) | [Deep Search](#) | [Privacy Policy](#) | [@manuals.plus](#) | [YouTube](#)

This website is an independent publication and is neither affiliated with nor endorsed by any of the trademark owners. The "Bluetooth®" word mark and logos are registered trademarks owned by Bluetooth SIG, Inc. The "Wi-Fi®" word mark and logos are registered trademarks owned by the Wi-Fi Alliance. Any use of these marks on this website does not imply any affiliation with or endorsement.