



SCANGRIP 03.6105C Tower 5 Connect Instructions

[Home](#) » [SCANGRIP](#) » SCANGRIP 03.6105C Tower 5 Connect Instructions 

Contents

- [1 SCANGRIP 03.6105C Tower 5 Connect](#)
- [2 Accessories](#)
- [3 WARNING](#)
- [4 BATTERY COMPLIANCE](#)
- [5 Quick closing](#)
- [6 FEATURE](#)
- [7 MANUFACTURER'S WARRANTY](#)
- [8 Documents / Resources](#)
 - [8.1 References](#)
- [9 Related Posts](#)



SCANGRIP 03.6105C Tower 5 Connect



Accessories



POWER SUPPLY
03.6123C



CAS BATTERY
18V 5.2 Ah
03.6121



CAS CHARGER
03.6122

- **POWER SUPPLY**
03.6123C
- **CAS BATTERY**
18V 5.2 Ah 03.6121
- **CAS CHARGER**
03.6122

SCANGRIP CONNECTORs for 18V battery packs

- **BOSCH** – 03.6140C
- **BOSCH GREEN** – 03.6141C
- **DEWALT** – 03.6142C
- **EINHELL** – 03.6143C
- **FEIN** – 03.6144C
- **FESTOOL** – 03.6153C
- **FLEX** – 03.6145C
- **HAZET** – 03.6146C
- **HIKOKI** – 03.6147C
- **INGERSOLL** – 03.6152C
- **MAKITA** – 03.6148C
- **MILWAUKEE** – 03.6149C
- **RIDGID** – 03.6154C
- **SNAP-ON** – 03.6151C

WARNING

- Always respect applicable legislation for working with electrical equipment in order to reduce the risk of accidents.
- Avoid looking directly into the beam of light, as this will result in dazzling.
- Do not use the lamp near a naked flame.
- The light source of this luminaire is not replaceable; when the light source reaches its end of life the whole luminaire shall be replaced

BATTERY COMPLIANCE

- The work light is designed to be used with 18V Metabo CAS batteries.
- The lamp is also compatible with 3rd party 18V batteries by using the SCANGRIP CONNECT system.
- It is possible to use a SCANGRIP POWER SUPPLY instead of a battery.

Discarded electrical products must not be disposed of together with household waste. Please use recycling facilities. Ask your local authority or retailer for advice on recycling.

Quick closing

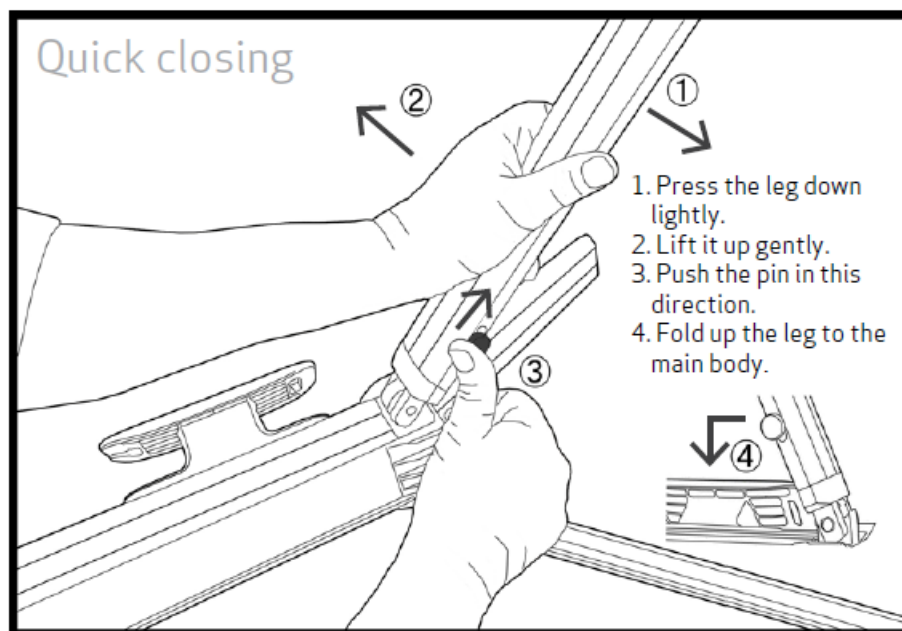

FEATURE

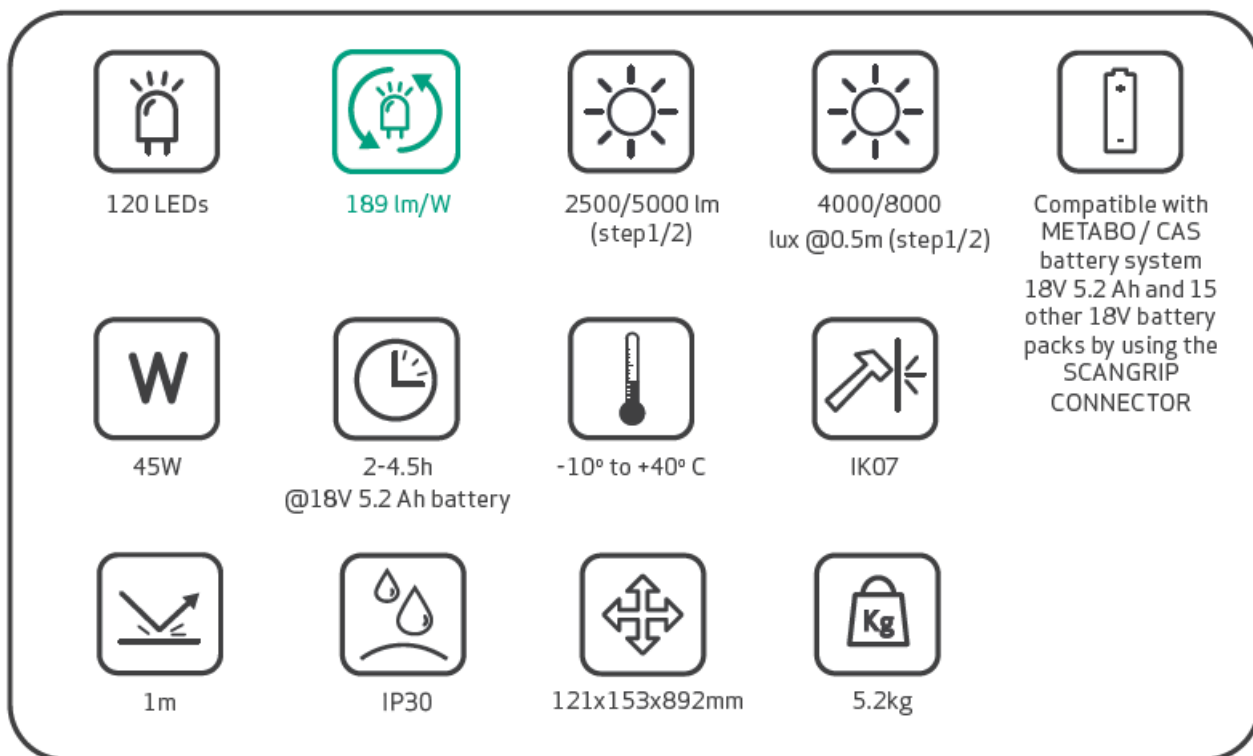

MANUFACTURER'S WARRANTY

Information for customers in Australia and New Zealand only

This SCANGRIP product is guaranteed for a period of 2 (two) years from date of purchase. This guarantee shall become invalid if the product has been misused, tampered with or accidentally damaged. If the product is defective, we undertake to repair or replace the product or any part of it that is defective; or wholly or partly recompense you if they are defective. This guarantee is in addition to other rights and remedies available to consumers, all of which are given by us to you if you are a consumer. Our goods come with guarantees that cannot be excluded under the Australian or New Zealand Consumer Law. You are entitled to a replacement or refund for a major failure and for compensation for any other reasonably foreseeable loss or damage. You are also entitled to have the goods repaired or replaced if the goods fail to be of acceptable quality and the failure does not amount to a major failure. If you wish to make claim, please return this product to the original place of purchase together with your purchase receipt or go to our website www.scangrip.com and fill out the claim form.



[SCANGRIP.COM](http://www.scangrip.com)

Documents / Resources

 The diagram shows a SCANGRIP Tower 5 Connect, a tall, adjustable work light stand. It features a central vertical pole with multiple horizontal arms extending from it. The top arm holds a large, rectangular light fixture. The stand has a base with four legs for stability. A small inset shows a close-up of the light fixture's controls and mounting bracket. The SCANGRIP logo is visible in the top left corner of the diagram.	<p>SCANGRIP 03.6105C Tower 5 Connect [pdf] Instructions 03.6105C Tower 5 Connect, 03.6105C, Tower 5 Connect</p>
--	---

References

- [Europe’s leading manufacturer of LED work lights](#)
- [Europe’s leading manufacturer of LED work lights](#)