



# SCANCOOL DKS 142 BE Display Cooler User Manual

[Home](#) » [SCANCOOL](#) » SCANCOOL DKS 142 BE Display Cooler User Manual 

## Contents

- 1 SCANCOOL DKS 142 BE Display Cooler
- 2 DISPOSAL OF OLD REFRIGERATORS
- 3 SAFETY INSTRUCTIONS & WARNINGS
- 4 SPECIFICATIONS
- 5 REVERSING THE DOOR HINGE
- 6 BASIC OPERATION
- 7 DEFROSTING AND CLEANING
- 8 TROUBLESHOOTING
- 9 Warranty
- 10 EU DECLARATION OF CONFORMITY
- 11 Documents / Resources
  - 11.1 References
- 12 Related Posts

# SCANCOOL

**SCANCOOL DKS 142 BE Display Cooler**



Thank you for buying this Cooler. It has been designed and manufactured for many years of trouble-free service. Operation is very simple, but please take a few minutes to read this booklet. It contains important safety information, and tips to ensure you receive the best possible service from your Cooler. This appliance is intended to be used exclusively for the storage of drinks.

**WARNING: RISK OF ELECTRICAL SHOCK HAZARD**

This unit must be earthed. If the power cable is damaged, it must be replaced by a qualified engineer to avoid shock hazard. DO NOT ATTEMPT TO SERVICE THE ITEM

**YOURSELF.**

Ensure that the appliance is properly earthed. Stop using the appliance immediately if electric shock is felt when touching the Cooler.

**DISPOSAL OF OLD REFRIGERATORS**

- BE SURE TO MAKE ANY LOCKS UNUSABLE. IF POSSIBLE, REMOVE THE DOOR(S) AND DISCARD SEPARATELY.
- WARNING – CHEMICAL HAZARD: DO NOT ALLOW CHILDREN TO PLAY WITH THE OLD APPLIANCE. CONTACT YOUR LOCAL
- AUTHORITY FOR PROPER DISPOSAL PROCEDURES.
- Before disposing of an old appliance, please make sure it is switched off and safe. Unplug the appliance and break any locks in order to avoid children becoming trapped.
- Please note: the cooling system contains gases and refrigerants which require specialist waste disposal. The valuable materials contained in a refrigerator can be recycled.

- Contact your local waste disposal depot for proper disposal of an old appliance and contact your local authority or dealer if you have any questions.
- Please ensure the pipework of your cooler is not damaged prior to disposal.
- You can contribute to environmental awareness by insisting on an appropriate non-polluting method of disposal.

## **DISPOSAL OF PACKAGING**

- All the packaging materials with your Cooler may be disposed of without danger to the environment.
- The cardboard may be broken or cut into smaller pieces and given to a waste paper disposal service. The wrapping foil is made of polyethylene. The
- polyethylene pads and stuffing contain no fluorochloric hydrocarbons. All these valuable materials may be taken to a waste collecting depot and used
- again after adequate recycling.
- Consult your local authority for the name and address of the waste paper disposal services nearest to you.

## **SAFETY INSTRUCTIONS & WARNINGS**

- Before switching on your Cooler, read the information in this User Guide carefully. The User Guide contains important observations relating to the
- assembly, operation and maintenance of the appliance.
- Please keep this booklet in a safe place for future reference. If you ever sell this unit, hand this User Guide to the new owner.
- The manufacturer does not accept responsibility for any damages that may arise due to non-observation of these instructions.
- Connection and installation of the unit is to be carried out in strict compliance with the relative instructions in this User Guide.
- For safety, the appliance must be properly earthed in accordance with specifications.
- Always remember to unplug the appliance before cleaning. Never unplug your Cooler by pulling on the power cable. Always grip plug firmly and pull straight out from the socket.
- All electrical repairs must be carried out by qualified engineers. Inadequate repairs may be dangerous.

## **DANGER OF FERMENTATION:**

- Keep alcoholic beverages in airtight bottles or containers and always store in an upright position.
- Do not damage any parts of the appliance which carry refrigerant by piercing, perforating, crushing, twisting or scraping. If the refrigerant comes into contact with the eyes, it may cause serious eye injury.
- Do not obstruct or cover the ventilation aperture.
- Do not allow children to play with your Cooler, or to sit on it or hang onto the door.
- This appliance is not intended for use by persons (including children) with reduced physical, sensory or mental capabilities, or lack of experience and knowledge, unless they have been given supervision or instruction concerning use of the appliance by a person responsible for their safety.

## **SPECIFICATIONS**

- This appliance is designed as a cooler for drinks, NOT food stuffs.
- It is intended strictly for domestic use.
- The refrigerating circuit is leak-proof.

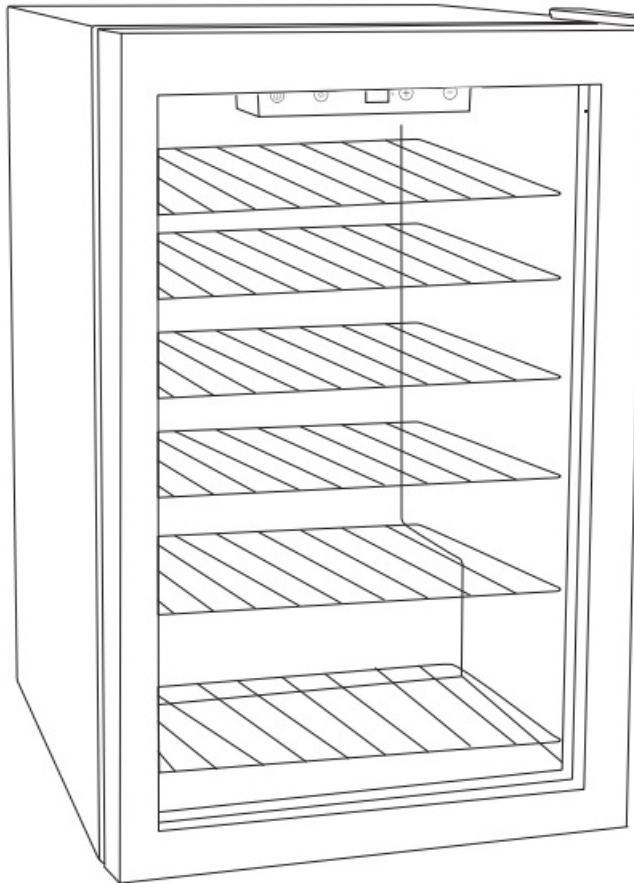

## REVERSING THE DOOR HINGE

The door can be opened from left to right and vice versa. Should you wish to change the opening direction, please follow these in-structions.

**Note:** all parts removed should be kept safely. You will require these for the reinstallation of the door.

- Remove the two screws (1) that hold the upper hinge (5)(right side) to the frame.
- Lift the door off and place on a padded surface to prevent scratching.
- Remove the blanking plug (8) from the hole in the upper left corner of the door and transfer it to the uncovered hole on the upper right corner. Press firmly to secure it.
- Remove the two screws (6) that hold the lower hinge (2)
- Remove the adjustable front left foot and transfer it to the other side.
- Remove the bolt pin(7) from the lower hinge (2) and reverse the direction of the lower hinge. Secure the lower hinge (2) to the left side of the lower frame with the two screws (6) Re-insert the bolt pin (7). Set the door into position, making sure it is seated comfortably onto the lower hinge (2).
- Holding the door closed, secure the upper hinge (5) into the top frame with the two screws (1). Check the door is level and tighten the screws firmly.

**Fig 1** Position of components prior to reversal of the door hinge.

**Fig 2** Position of components after reversal of the door hinge.

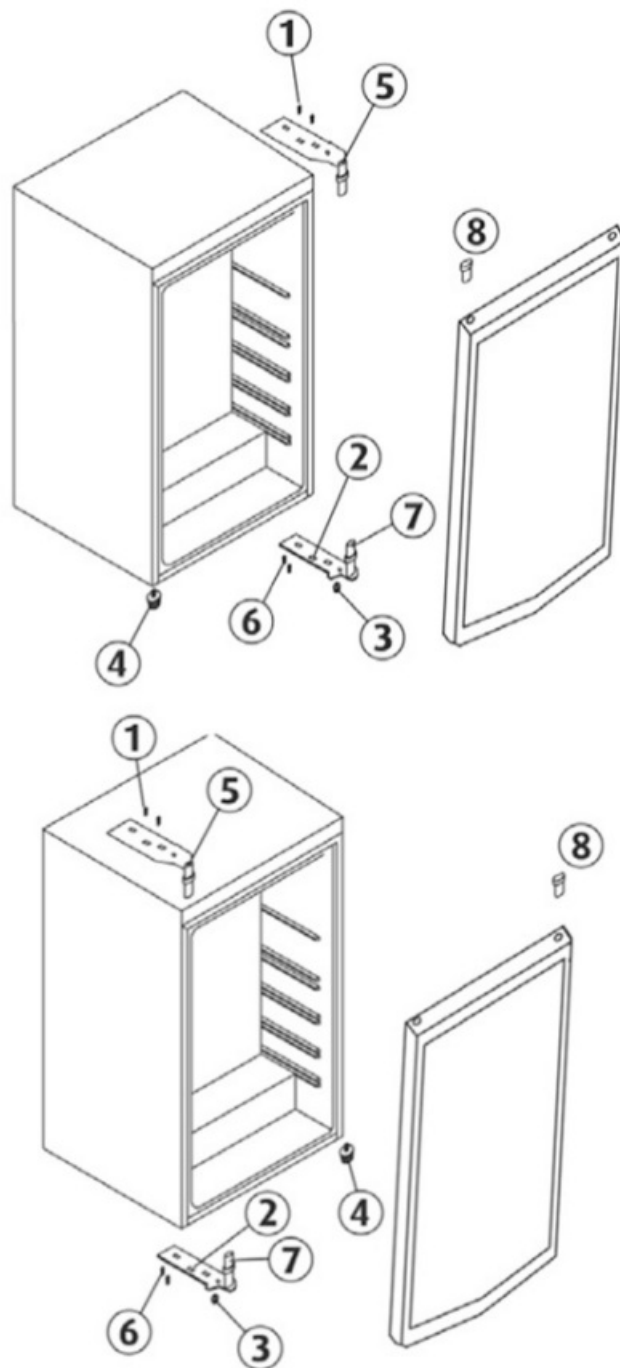

## BEFORE USING FOR THE FIRST TIME

- The appliance may be placed with its rear panel at a distance of at least 10 cm away from the wall to allow air circulation.
- Your Cooler should be placed on flat and firm surface for quieter operation.
- Do not expose the appliance to direct sunlight or a heat source such as ovens, radiators, heaters, etc.
- Do not under any circumstances place heated beverages in your Cooler.
- Do not open the door more often than necessary to lessen the escape of cold air.
- For better air circulation, do not overfill the unit.
- Adjust the temperature regulator according to the amount of product and the ambient temperature.

## BASIC OPERATION

Your Cooler must stand on an even surface. If the appliance is to be placed on carpet or delicate floors, support it

with a wooden board underneath. Be aware that placing the appliance on carpet may mean that heat from the compressor may cause the carpet to fade. Be aware that humidity can cause water damage.

1. Clean the inner compartment.
2. Plug in your Cooler.
3. The first time you turn the unit on, set the thermostat, situated at the back of the unit, to the max. position "5".
4. After 20 minutes, adjust the temperature control setting to "3". This setting should be correct for home use.
5. To turn the unit off, disconnect the plug from the mains supply.

NOTE: If the unit is unplugged or power lost, you must wait 3 to 5 minutes before restarting. If you attempt to restart the unit before this delay, the unit will not start.

### ADJUST OPERATING TEMPERATURE

Please there are two options: 1. Wine Cooler mode and 2. Beverage Cooler mode. Please push "+" and "LED" at the same time for 6 seconds to switch between the two modes.

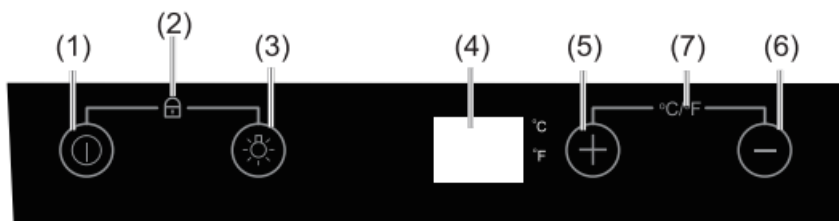

1. Press and hold to turn the Power ON and OFF
2. Press and hold (1) and (3) simultaneously to Unlock and Lock the Control Panel
3. Turns the Interior Light ON and OFF
4. Displays the Temperature
5. Increases Set Temperature 1°C with Each Push
6. Decreases Set Temperature 1°C with Each Push
7. Press and hold (5) and (6) simultaneously to Alter the Temperature Display to Fahrenheit or Celsius.

### WARNING

If temperature selector is set to too low a setting, drinks become frozen. In extreme circumstances, glass bottles may even break. Always exercise caution when setting the temperature.

- Do not place heavy items (more than 20kg) on top of the Cooler.
- Do not place any items on top of the Cooler which may fall off when the door is opened.
- After the appliance has been unplugged, leave for three minutes before plugging it in again.

### When not in use

If the unit is not being used for long periods:

- Unplug your Cooler.
- Clean and dry the inside of the appliance. Leave the door slightly open to allow it to dry completely.
- A cooler which is unused without being cleaned may start to smell musty or develop mildew.

### DEFROSTING AND CLEANING

#### Defrosting

The surface of the evaporator ices up when the refrigerator is working. This is an entirely normal part of operation. If the frost layer is more than 3mm thick, the cooler must be de-frosted and cleaned to avoid unnecessary energy consumption and inefficient operation.

1. Remove all items inside and unplug the unit.
2. After defrosting, reset the temperature selector to original position.

## **Cleaning**

1. Unplug your Cooler.
2. Wash the interior with warm water and neutral detergent.
3. Dry all surfaces thoroughly.

Note: Do not use abrasive cleaners!

To ensure efficient operation the back and bottom of the cooler should be cleaned thoroughly. Use mild soapy water to clean the door seal.

### **4. Moving your Cooler**

- Unplug the appliance
- Remove all items inside

Note: Never hold the appliance by the door.

### **5. Power Failure**

If a power cut occurs, do not open the door more often than necessary in order to conserve cold air.

## **TROUBLESHOOTING**

Before returning your Cooler to the store, check the following points; you may be able to solve any problem yourself.

### **Not Cooling**

- Check power cable is connected and fuse is intact.
- Wrong temperature selected. Adjust setting on controller to position shown (see page 10).
- Cooler is overfilled.
- Appliance exposed to direct sunlight or a heat source.
- Door is opened too often.

### **Unusual noises or noisy operation**

- Appliance is not on a level, firm surface or may be touching other items.
- Note: It is normal to hear refrigerant flowing as the compressor stops and starts.

### **Outer surfaces are wet**

Water source or leak too near the appliance – dry surfaces thoroughly and move the appliance.

### **Inner surfaces are wet**

- Door opened too often or kept open too often.
- Make sure that the door seals properly.

Warranty

This Cooler is guaranteed to be free from defects in parts and manufacture for 12 months from date of purchase, provided that the unit is used under the normal operating conditions shown within the manual. Your attention is drawn to the following: This warranty is available only to the original purchaser and is not transferable. Your normal consumer rights are not affected. If service is required, DO NOT ATTEMPT TO REPAIR UNIT YOURSELF. Please return unit to store. Proof of purchase will be required for any warranty claims. You must retain your original receipt. If service under warranty is required, you will be required to pro-duce this. Please also retain the original packaging should the unit need to be returned.

**Please note:** As part of our policy of continuous product im-provement, the manufacturer reserves the right to amend speci-fications without notice.

Light source energy class

- Lamp type: LED light. Energy efficiency level: /
- Light source in this product is replaceable only by a professional

Access to professional repair, such as internet webpages, addresses, contact details.

Model no: DKS 142 BE

Address	Scandomestic A/S
Contact Number	7242 5571
Website	Scandomestic.dk
QR code	618395
Relevant information for ordering spare parts, directly or through other c hannels provided by the manufacturer, importer or authorised representative;	Scandomestic A/S
The minimum period during which spare parts, necessary for the repair of the  appliance, are available;	8 years
Instruction on how to find the model information in the product database, as defined in Regulation (EU) 2019/2024 by means of a weblink that link s to the model information as stored in the product database or a link to t he product database and information on how to find the model  identifier on the product.)	<a href="http://www.scandomestic.dk">www.scandomestic.dk</a>

**Note:** The address or contact phone number of the service site is subject to change without prior notice. Please confirm whether the service station is a directly affiliated one of our company when requiring services.

EU DECLARATION OF CONFORMITY



Model number (unique identification of the product):	DKS 142 BE
Name and address of the manufacturer or his authorised representative:	Scandomestic A/S Linåvej 20 8600 Silkeborg Denmark
This declaration of conformity is issued under the sole responsibility of the manufacturer (or installer):	Scandomestic A/S Linåvej 20 8600 Silkeborg Denmark
Object of the declaration (identification of product allowing traceability. It may include a colour image of sufficient clarity to enable the identification of the product, where appropriate.)  Product: Commercial cooler Brand: Scancool  Colour: Black  Model name: DKS 142 BE	
The object of the declaration described in point 4 is in conformity with the relevant Union harmonisation legislation:	EN 61000-3-2
References to the relevant harmonised standards used, or references to the specifications in relation to which conformity is declared:	2011/65/EU, 2015/863, 1907/2006, 2014/35/EU, EN 60335-1: 2012 + A11:2014 + A13: 2017 + A1: 2019 + A14: 2019 + A2: 2019, EN 60335-2-24:  2010 + A1: 2019 + A2: 2019, EN 62233: 2008, IEC  60335-2-24:2010, AMD1:2012, AMD2:2017, IEC  60335-1:2010, COR1:2010, COR2:2010, AMD1:2013, COR1:2014, AMD2:2016, COR1:2016, 2019/2024, 2009/125/EC, 2019/2018, 2017/1369, EN 16902-2016, 1935/2004, Machine directive 2006/42/EC
Where applicable: the notified body ... (name, number)... performed ... (description of intervention)... and issued the certificate:	RoHS 2011/65/EU + 2015/863
Additional information:	The appliance is intended exclusively for storing  beverages

<p>DKS 142 BE</p> <p>Bedienungsanleitung User manual Användningsanvisning</p> <p>SCANCOOL</p>	<p><a href="#">SCANCOOL DKS 142 BE Display Cooler</a> [pdf] User Manual</p> <p>DKS 142 BE Display Cooler, DKS 142 BE, DKS 142 BE Cooler, Display Cooler, Cooler</p>
---	---

References

- [Scandomestic | Scandomestic.dk](#)
- [Scandomestic | scandomestic.dk](#)