



[Home](#) » [saxby lighting](#) » **Saxby lighting 114573 Bulkhead 2 In 1 MW Sensor Instruction Manual** 

Contents [[hide](#)]

- [1 Saxby lighting 114573 Bulkhead 2 In 1 MW Sensor](#)
- [2 Product Information](#)
- [3 Product Usage Instructions](#)
- [4 Dimensions](#)
- [5 Installation Procedure](#)
- [6 CONTACT](#)
- [7 Frequently Asked Questions](#)
- [8 Documents / Resources](#)
 - [8.1 References](#)



Saxby lighting 114573 Bulkhead 2 In 1 MW Sensor



Product Information

Specifications:

- Product Name: Bulkhead 2-in-1 MW Sensor
- Model Number: 114573
- Manufacturer: UK Manufacturer – BH17 7BY, EU Manufacturer – Brilliant AG, Brilliantstrasse 1, D-27442 Gnarrenburg
- Website: www.saxbylighting.com

Product Usage Instructions

Unpacking and Inspection:

Upon receiving the product, carefully unpack and inspect for any isible damage. If any damage is found, contact customer support immediately.

Installation:

Follow the installation instructions provided in the manual. Ensure the product is installed securely and according to the recommended guidelines to prevent any

accidents.

Operation:

Before using the product, make sure to read the user manual thoroughly. Follow the operating instructions to ensure safe and satisfactory operation of the Bulkhead 2-in-1 MW Sensor.

Maintenance:

Regularly inspect the product for any signs of wear or damage.

Clean the sensor periodically to maintain its functionality. Refer to the manual for specific maintenance instructions.

Bulkhead 2-in-1 MW Sensor

114573

Thank you for purchasing this product. Please read the instructions carefully before use to ensure safe and satisfactory operation of this product. Please retain these instructions for future reference.

- Max Load 20W (LED)
- Operating Temp -20°C – +40°C
- Connection Type Quick Connector
- Sensor Type Microwave
- Mounting Height 6m Max.
- Control Type ON/OFF/STEP-DIM



Dimensions

Description	L (mm)	W (mm)	H (mm)	Weight
Plug & Play MW Sensor (For Bulkheads)	50	27	23	30g

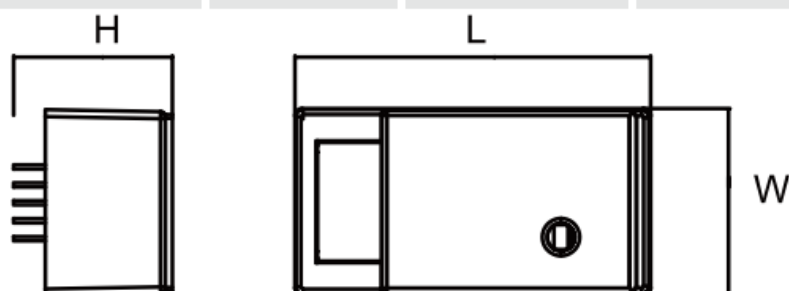

WARNING: Risk of electric shock!

- Isolate the mains power before proceeding.
- Turn off the mains power before performing inspections, installation, or removal
- Verify that the supply voltage is correct by comparing it with the luminaire label information

- It is the responsibility of the installer to ensure installation is suitable for the total load of the product(s). The supply cable, fuses/circuit breakers must be correctly rated for the electrical load and considering for any transient inrush currents that may occur.
- Do not perform insulation strength or resistance tests on installed products. connected



Installation Procedure

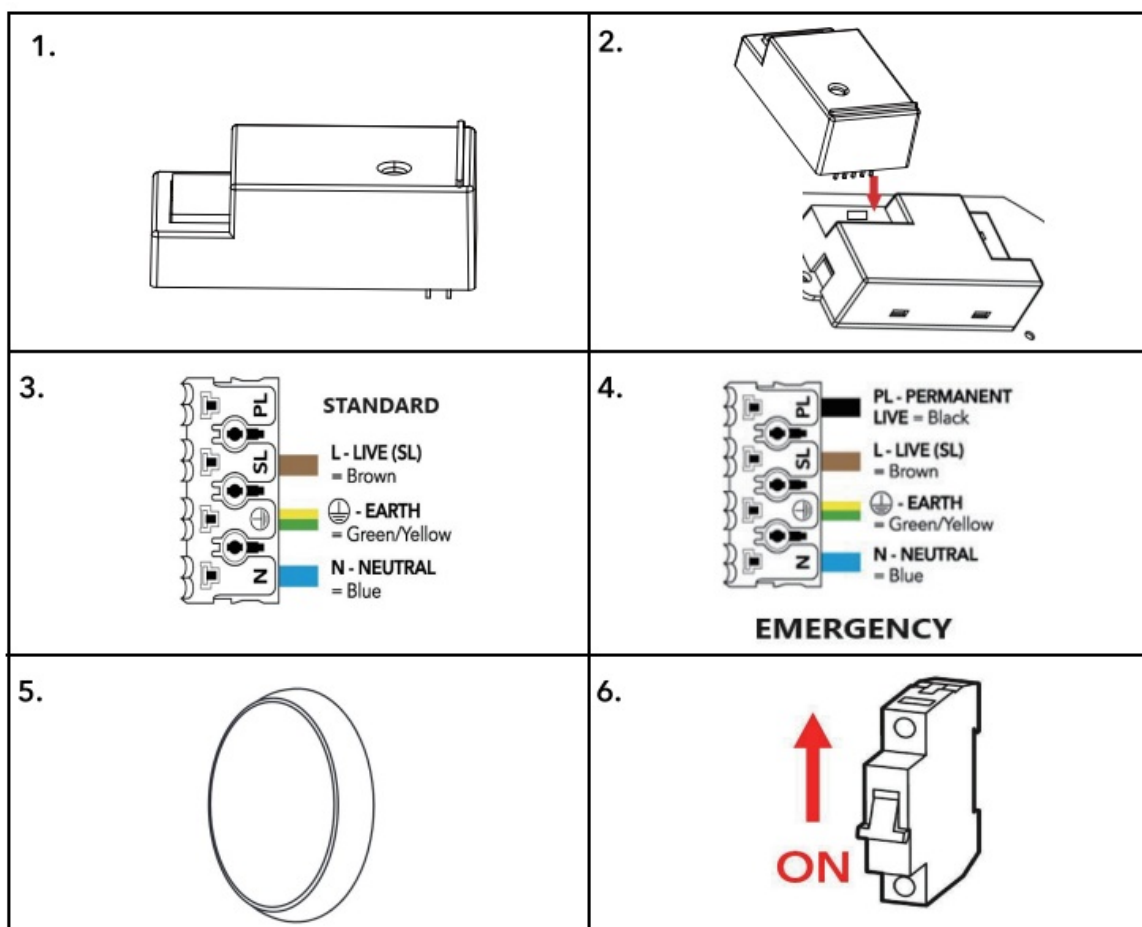

Daylight Sensor			Sensitivity			Times & Standby					
1	2	Lux Level	3	4	Detection area	5	6	7	Hold Time	Standby Time	Standby Dim-Level
-	-	Disable	-	-	100%	-	-	-	5s	0	0%
ON	-	50Lux	ON	-	75%	-	ON	ON	1min	0	0%
-	ON	25Lux	-	ON	50%	ON	ON	ON	10min	0	0%
ON	ON	2Lux	ON	ON	25%	-	-	ON	30s	1min	20%
						ON	-	-	30s	10min	20%
						ON	-	ON	1min	5min	20%
						-	ON	-	3min	10min	20%
						ON	ON	-	3min	Permanent	20%

Default Setting: Daylight sensor disabled; Sensitivity 100%; Hold time 5s; Standby 0%

CONTACT

V1 26/08/2024

UK Manufacturer: BH17 7BY

EU Manufacturer: Brilliant AG,

Brilliantstrasse 1, D-27442 Gnarrenburg

www.saxbylighting.com

Frequently Asked Questions

- **Q:** Can the sensor be adjusted for sensitivity?
 - **A:** Yes, the sensor sensitivity can be adjusted according to your needs. Refer to the user manual for detailed instructions on adjusting the sensitivity settings.
- **Q:** Is the product suitable for outdoor use?
 - **A:** Yes, the Bulkhead 2-in-1 MW Sensor is designed for outdoor use. However, ensure it is installed in a suitable location protected from direct exposure to harsh weather conditions.
- **Q:** How can I reset the sensor if it malfunctions?
 - **A:** To reset the sensor, follow the reset procedure outlined in the user manual. Typically, this involves turning off the power source for a few seconds and then turning it back

Documents / Resources

	Saxby lighting 114573 Bulkhead 2 In 1 MW Sensor [pdf] Instruction Manual 114573 Bulkhead 2 In 1 MW Sensor, 114573, Bulkhead 2 In 1 MW Sensor, Sensor
-----------------------------------------------------------------------------------	-------------------------------------------------------------------------------------------------------------------------------------------------------------------------

References

- [User Manual](#)

114573, 114573 Bulkhead 2 In 1 MW Sensor, Bulkhead 2 In 1 MW Sensor, saxby lighting, saxby lighting Sensor

Leave a comment

Your email address will not be published. Required fields are marked *

Comment *

Name

Email

Website

☐ Save my name, email, and website in this browser for the next time I comment.

Post Comment

Search:

e.g. whirlpool wrf535swhz

Search

[Manuals+](#) | [Upload](#) | [Deep Search](#) | [Privacy Policy](#) | [@manuals.plus](#) | [YouTube](#)

This website is an independent publication and is neither affiliated with nor endorsed by any of the trademark owners. The "Bluetooth®" word mark and logos are registered trademarks owned by Bluetooth SIG, Inc. The "Wi-Fi®" word mark and logos are registered trademarks owned by the Wi-Fi Alliance. Any use of these marks on this website does not imply any affiliation with or endorsement.