



sauermann KT220 Class 220 Temperature Data Loggers User Guide

[Home](#) » [sauermann](#) » sauermann KT220 Class 220 Temperature Data Loggers User Guide

Contents [[hide](#)]

- 1 sauermann KT220 Class 220 Temperature Data Loggers
- 2 INTRODUCTION
- 3 Product Usage Instructions
- 4 Quick start guide
- 5 Display
- 6 Dimensions (mm)
- 7 Connections
- 8 Recorder function
- 9 Mounting
- 10 Accessories
- 11 Documents / Resources
 - 11.1 References
- 12 Related Posts



sauermann KT220 Class 220 Temperature Data Loggers



INTRODUCTION

The Kistock data loggers are used to measure various parameters such as temperature, humidity, current, voltage, electrical pulses, liquid pressure and light. The KT220 and KH220 models come with an internal sensor for measuring temperature and humidity, but an additional external humidity probe is also available as an option. The KTT220 model has two thermocouple inputs for measuring temperature. The device has a display that shows the measured values, and it also indicates the channel number being measured. The device has a recording function that allows the user to record and monitor the measured values in real time. The device also has a magnetic mounting that allows for easy installation.

Product Usage Instructions

1. Connect the device to a power source using the micro-USB connector.
2. If using the KT220 or KH220 models, connect the universal probe to the device. If using the KTT220 model, connect the thermocouple probes to the device.
3. The device will display the measured values for each channel number being measured.
4. The device will also indicate if the dataset is finished or if it is currently being recorded. The device will flash if the dataset has not started or if it is almost full.
5. The device has a recording function that can be used to record and monitor the measured values in real time. To use this function, define a record interval for when the readings are beyond the setpoints.
6. The device has a magnetic mounting that can be used to fix it easily to a wall.
7. Refer to the datasheet for more information about available accessories.
8. When cleaning the device, avoid using aggressive solvents or cleaning products containing formalin.
9. Always use the device in accordance with its intended use and within the parameters described in the technical features to ensure its protection.

Quick start guide

Reference	Parameters
KT 220	Temperature, humidity, current, voltage, electrical pulses, liquid pressure
KH 220	Temperature, humidity (internal sensor, an additional external humidity probe is available as an option), current, voltage, electrical pulses, liquid pressure, light
KTT 220	Temperature

Operating temperature, protection of the instruments and information about storage and the battery

- **Operating temperature***: KT220: from -40 to +70 °C; KH220, KTT220: from -20 to +70 °C
- **KT220**: IP65; KH220: IP20; KTT220: IP54*
- **Storage temperature**: from -40 to +85 °C

Battery power supply: 1x AA lithium 3.6 V battery

Display

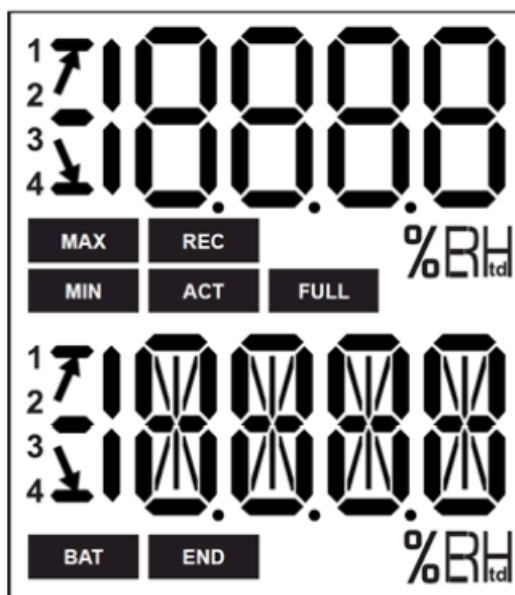

END • DATASET is finished.

REC • Indicates that one value is being recorded.

It flashes: the DATASET did not start already.

FULL

- Flashing slowly: DATASET is between 80 and 90 % of the storage capacity. Flashing quickly: DATASET is between 90 and 100 % of the storage capacity. Constant: storage capacity full.

BAT • Constant: indicates that the batteries have to be replaced.

1 2 • Indicates the channel number which is measuring.

3 4 • Screen actualisation of measured values.

ACT • The displayed values are the maximum/minimum values recorded for the channels displayed.

MIN • Indication of the direction of exceeding the threshold in the recorded measurement.

MAX • C: Temperature in °Celsius.



• F: Temperature in °Fahrenheit
%HR: Relative humidity (KH 220)

Dimensions (mm)

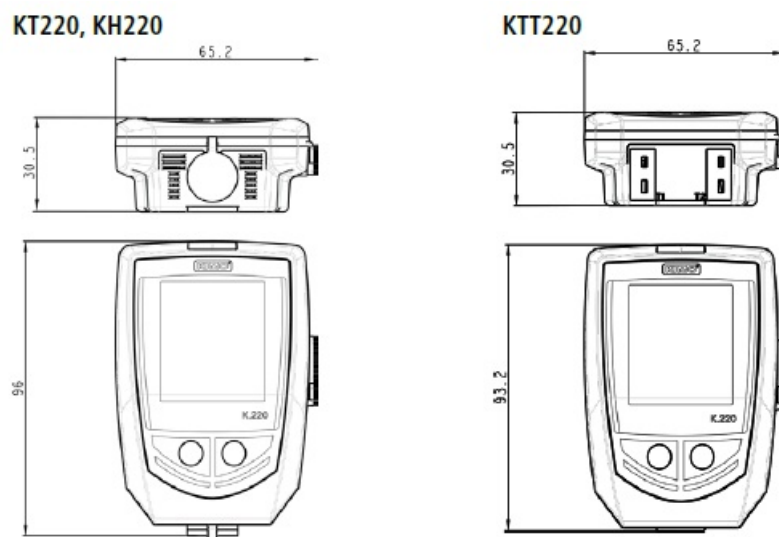

Connections

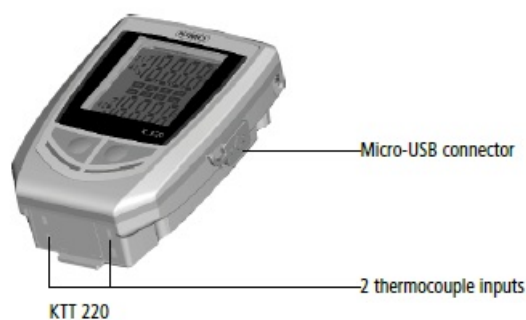

Recorder function

Five recording modes

KISTOCK can record in 5 different ways:

- "Immediate" mode records values according to a predefined interval.
- "Minimum", "Maximum" and "Average" record automatically the calculation of minimum, maximum or average of measured values during an interval of recording. "Monitoring" mode allows to get an accurate history report during error events to help troubleshooting, without stopping the measurement logging. To proceed this way, you just have to define :
 - a record interval to be used whilst the readings are beyond the setpoints

- a record interval for the values measured during each reading beyond the setpoints
- Furthermore, you can also let your KISTOCK record non-stop ("loop" recording option).

Four types of dataset start:

Once your recording mode has been set, you can launch your dataset:

- With a delayed start (with predefined date and time)
- With the software
- With push-button
- With "Online" option. In this case, your datasets are directly sent, saved and displayed on your PC in real time.

Six types of dataset stop

You can stop your dataset:

- According to a date and time (if it was started the same way)
- According to a period
- According to a predefined number of recording points
- Once the storage capacity is full
- With "Stop" option of the software
- By holding "OK" key during 5 seconds, if this function has been previously activated by the software

Mounting

The KT 220, KH 220 and KTT 220 KISTOCK have a magnetic mounting, so you can fix it easily.



Dimensions of the wall mount (mm)

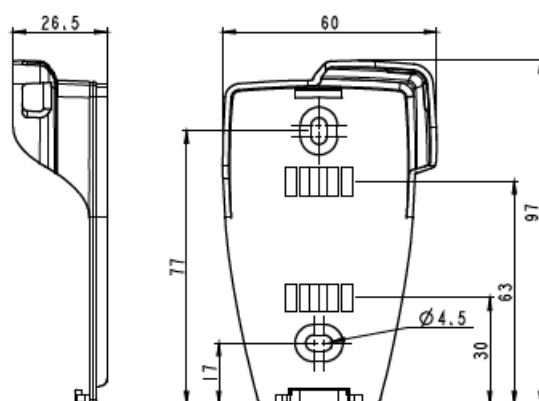

Accessories

Please refer to the data sheet to get more information about available accessories.

- **Maintenance:** please avoid any aggressive solvent. Please protect the device from any cleaning product containing formalin, that may be used for cleaning rooms or ducts.
- **Precautions for use:** please always use the device in accordance with its intended use and within parameters described in the technical features in order not to compromise the protection ensured by the device.

Download the full manual



Customer service portal

- Use our Customer service portal to contact us
- QSG – Kistock classe 220 – 07/10/2022 – Non-contractual document – We reserve the right to modify the characteristics of our products without prior notice.
- www.sauermanngroup.com
- Points de collecte sur www.quefairedemesdechets.fr

Documents / Resources

	<p>sauermann KT220 Class 220 Temperature Data Loggers [pdf] User Guide KT220, KH220, KTT220, KT220 Class 220 Temperature Data Loggers, Class 220 Temperature Data Loggers, 220 Temperature Data Loggers, Data Loggers, Loggers</p>
---	--

References

- [Services - Homepage](#)
- [Manufacturer of Condensate Pumps and Measuring Instruments | Sauermann group](#)