



## Satel PRF-LCD-A2 Wireless Keypad User Manual

[Home](#) » [Satel](#) » Satel PRF-LCD-A2 Wireless Keypad User Manual 



### Contents

- [1 PRF-LCD-A2 Wireless Keypad](#)
- [2 Documents / Resources](#)
  - [2.1 References](#)
- [3 Related Posts](#)

### PRF-LCD-A2 Wireless Keypad

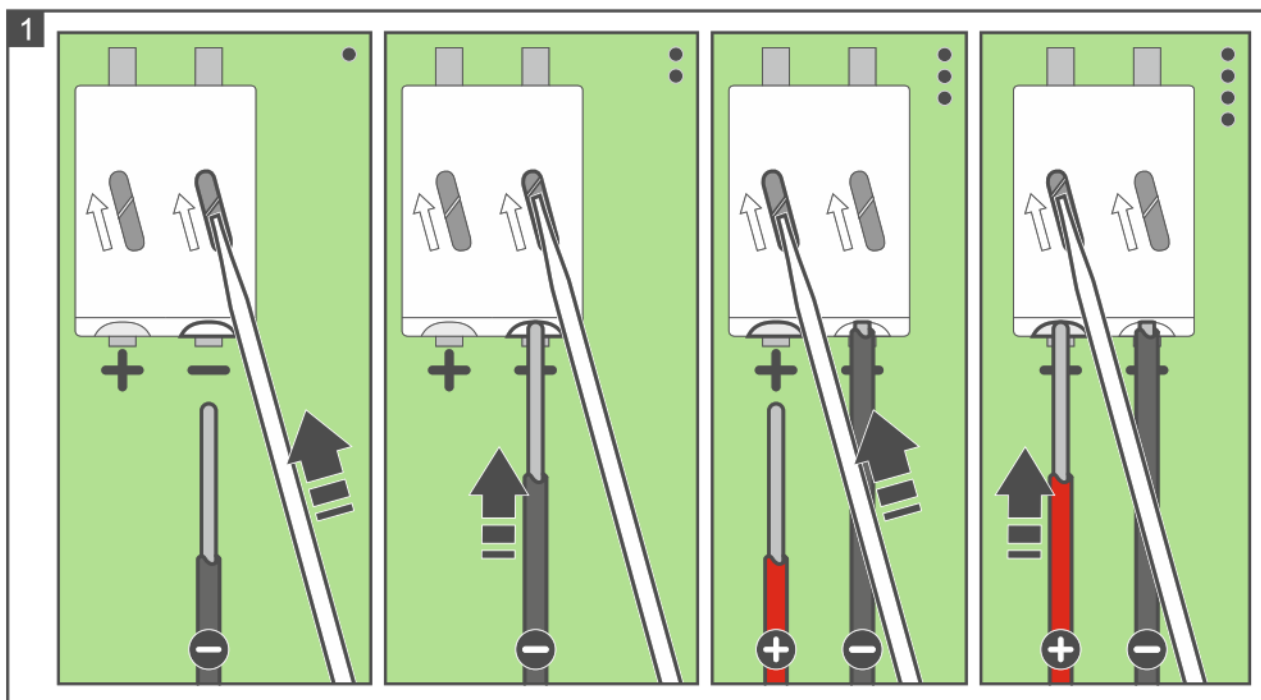

Full manual is available on [www.satel.pl](http://www.satel.pl). Scan the QR code to go to our website and download the manual.



<https://qr.satel.pl/p8C8r>

**⚠ The device should be installed by qualified personnel.**  
**Before installation, please read the full manual thoroughly.**  
**Changes, modifications or repairs not authorized by the manufacturer shall void your rights under the warranty.**  
**Disconnect power before making any electrical connections.**  
**There is a danger of battery explosion when using a different battery than recommended by the manufacturer, or handling the battery improperly. Do not crush the battery, cut it or expose it to high temperatures (throw it into the fire, put it in the oven, etc.).**  
**Do not expose the battery to very low pressure due to the risk of battery explosion or leakage of flammable liquid or gas.**  
**Be particularly careful during installation and replacement of the battery. The manufacturer is not liable for the consequences of incorrect installation of the battery.**  
**The used batteries must not be discarded, but should be disposed of in accordance with the existing rules for environment protection.**

The keypad is designed for indoor installation. The place of installation should be readily accessible to the system users. When selecting the installation location, take into account the communication range of the ABAX 2/ABAX system.

1. Open the keypad enclosure.
2. Install the batteries and add the keypad to the wireless system (see full manual).

3. Put the cover on the catches and snap the enclosure shut.
4. Place the keypad in the location intended for its installation.



If you want to hold the keypad in your hand, grab the device from its left side (on its right side, there is the antenna, which must not be covered).

5. Check the level of signal received from the keypad by the ABAX 2/ABAX controller. If the signal level is lower than 40%, select another place for installation. Sometimes, it is sufficient to shift the device ten or twenty centimetres.



The ARF-200 tester makes it possible to check the radio signal strength at the place of future installation without having to put the keypad there.

6. Open the keypad enclosure.
7. Place the enclosure base against the wall and mark location of the mounting holes.
8. Drill the holes in the wall for wall plugs (anchors).
9. If the APS-055 power supply is to be used as the external power source, run the power wires through the opening in the enclosure base. Use flexible wires with a cross-section of 0.5-0.75 m<sup>2</sup>.
10. Using wall plugs (anchors) and screws, secure the enclosure base to the wall. Select wall plugs specifically intended for the mounting surface (different for concrete or brick wall, different for plaster wall, etc.). When installed, the device must withstand a pull-off force of at least 50 N.
11. If the APS-055 power supply is to be used, connect the power wires to the “+” and “-” terminals (see Fig. 1). Use a 1.8 mm fathead screwdriver.
12. Put the cover on the catches and snap the enclosure shut.
13. Lock the cover using screw(s).

**Hereby, SATEL sp. z o.o. declares that the radio equipment type INT-KWRL2/PRF-LCD-A2/VERSA-KWRL2 is in compliance with Directive 2014/53/EU. The full text of the EU declaration of conformity is available at the following internet address: [www.satel.pl/ce](http://www.satel.pl/ce)**



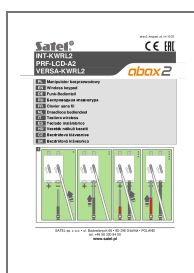

**SATEL sp. z o.o.**  
ul. Budowlanych 66  
80-298 Gdańsk  
POLAND  
tel. +48 58 320 94 00  
[www.satel.pl](http://www.satel.pl)

## Documents / Resources



[Satel PRF-LCD-A2 Wireless Keypad](#) [pdf] User Manual  
PRF-LCD-A2 Wireless Keypad, PRF-LCD-A2, Wireless Keypad, Keypad

## References

-  [satel.eu/ce](https://satel.eu/ce)
-  [SATEL – Inteligentne systemy alarmowe](#)
-  [satel.pl/ce](https://satel.pl/ce)

Manuals+.