



SATECHI USB4 6-In-1 Multiport Adapter User Guide

[Home](#) » [SATECHI](#) » SATECHI USB4 6-In-1 Multiport Adapter User Guide 

Contents

- [1 SATECHI USB4 6-In-1 Multiport Adapter](#)
- [2 Product Information](#)
- [3 Product Usage Instructions](#)
- [4 INSTALLATION INSTRUCTION](#)
- [5 Documents / Resources](#)

S A T E C H I

SATECHI USB4 6-In-1 Multiport Adapter



Product Information

The USB4 6-IN-1 Multiport Adapter is a versatile device that allows you to expand the connectivity options of your USB-C-enabled device. It offers multiple ports for charging, data transfer, video output, Ethernet connection, and audio input/output.

- **USB-C PD Port:** This port supports charging your device with a power output of up to 100W. It also allows for

data transfer at a speed of up to 10Gbps. Please note that approximately 15W is used for the operation of the adapter, and video output is not supported through this port.

- USB-A and USB-C Data Ports: These ports enable high-speed data transfer at up to 10Gbps. However, they do not support charging or CD readers, including Apple SuperDrive.
- Gigabit Ethernet Port: Connect an Ethernet cable to this port to enjoy a fast and reliable internet connection with speeds of up to 2.5Gbit.
- 3.5mm Audio Jack: This jack supports both audio input and output. On macOS, you may need to manually connect it during the initial setup by going to System Preferences > Sound > Output/Input > USB PnP Audio Device.

Product Usage Instructions

1. Connect the USB4 6-IN-1 Multiport Adapter to a USB-C port on your device.
2. If you want to charge your device, use the USB-C PD port on the adapter. It supports power delivery of up to 100W. You can also transfer data at a speed of up to 10Gbps through this port.
3. If you need to transfer data, use either the USB-A or USB-C data ports on the adapter. These ports support data transfer at a speed of up to 10Gbps. Please note that these ports do not support charging or CD readers.
4. If you want to connect to the internet using an Ethernet cable, plug it into the Gigabit Ethernet port on the adapter. This port offers speeds of up to 2.5Gbit for a stable and fast connection.
5. If you wish to use the audio input/output feature, connect your headphones, microphone, or speakers to the 3.5mm audio jack on the adapter. On macOS, you may need to manually select the USB PnP Audio Device in System Preferences for proper audio functionality.

INSTALLATION INSTRUCTION

1. Connect the adapter to a USB-C port on your device.
2. Use the HDMI port to output 8K HDMI to an external monitor or display – up to 60Hz. Computer, cable and monitor need to support 8K macOS supports up to 4K at 60Hz

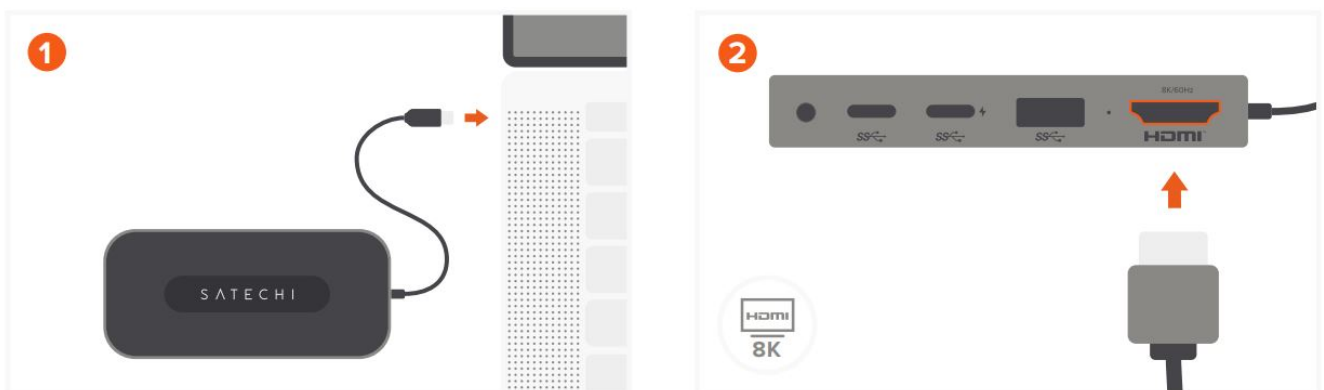

3. Use the USB-C PD port to charge your device up to 100W and use data transfer up to 10Gbps. ~15W is used for the adapter's operation Video output not supported
4. USB-A and USB-C data ports allows for transfer data at up to 10Gbps speed. Does not support charging or CD readers, including Apple SuperDrive

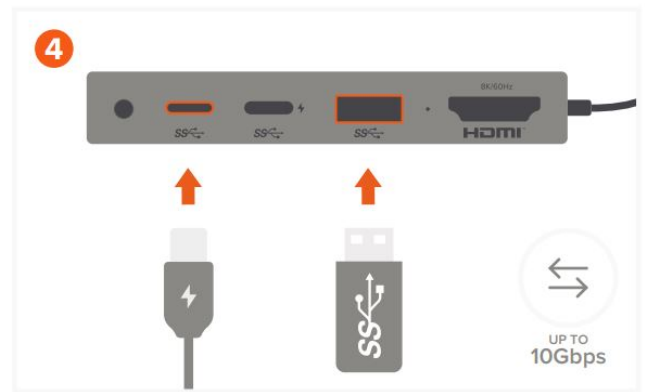
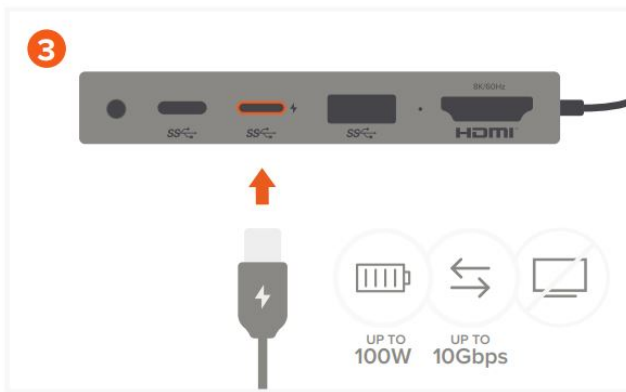

5. Connect an Ethernet cable to the adapter's Gigabit Ethernet port with up to 2.5Gbit.
6. The 3.5mm audio jack supports input/output. It may need to be connected manually during the initial connection setup on macOS by going to (System Preferences > Sound > Output/ Input > USB PnP Audio Device)

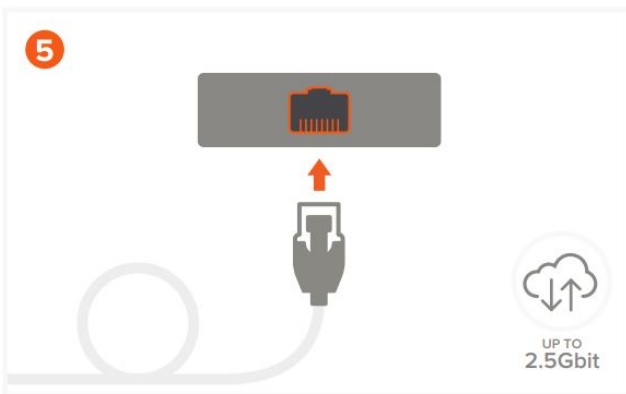

Documents / Resources

	<p>SATECHI USB4 6-In-1 Multiport Adapter [pdf] User Guide</p> <p>USB4 6-In-1 Multiport Adapter, USB4, 6-In-1 Multiport Adapter, Multiport Adapter, Adapter</p>
---	--