



SATECHI USB-C Hybrid Multiport Adapter Instruction Manual

[Home](#) » [SATECHI](#) » SATECHI USB-C Hybrid Multiport Adapter Instruction Manual 

Contents

- [1 SATECHI USB-C Hybrid Multiport Adapter](#)
- [2 INSTRUCTIONAL GUIDE](#)
- [3 Documents / Resources](#)
- [4 Related Posts](#)

S A T E C H I

SATECHI USB-C Hybrid Multiport Adapter



INSTRUCTIONAL GUIDE

1. To install the SSD, slide off the backside cover on the adapter.

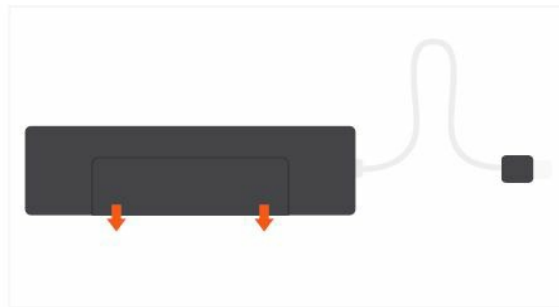

2. Remove the screw and position it in the notch on the opposite side of the pins.

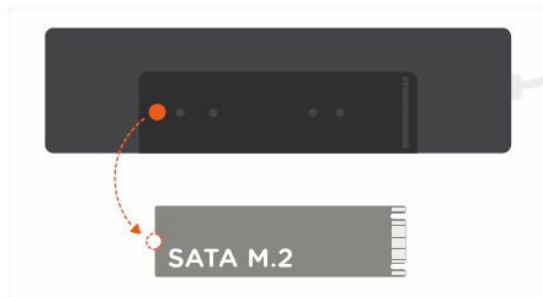

3. Insert the SSD (not included) faceup with the pins aligned and push down on the screw to secure it into place.
Supports SATA M.2 SSD only, does not work with Nvme



4. Once the SSD is secured, slide the cover back onto the adapter.



5. Connect the adapter to a USB-C port on your host device.



6. Use the USB-C PD port to charge your device up to 100W.
~15W is used for the adapter's operation



7. Use the HDMI port to output 4K HDMI to an external monitor or display – up to 60Hz.
Requires a direct HDMI-HDMI connection

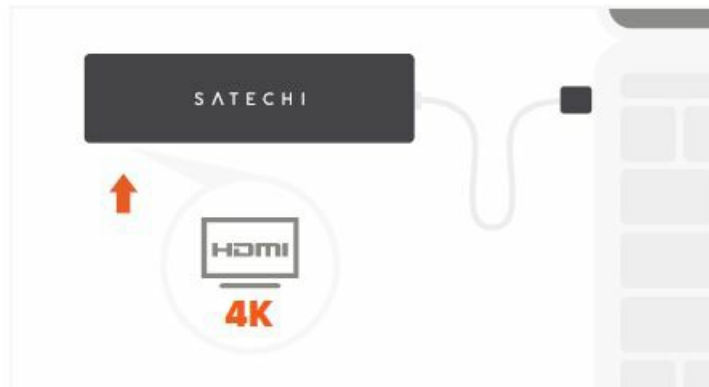

8. Use the USB-A data ports to connect two USB devices – up to 5 Gbps. Does not support charging or CD readers, including Apple SuperDrive



Documents / Resources

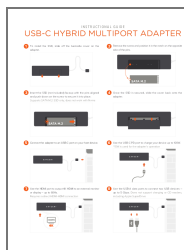

[SATECHI USB-C Hybrid Multiport Adapter](#) [pdf] Instruction Manual
USB-C Hybrid Multiport Adapter, USB-C Multiport Adapter, Hybrid Multiport Adapter, Multiport Adapter, Hybrid Adapter, Adapter