



# SATECHI SM3 Mechanical Backlit Bluetooth Keyboard User Guide

[Home](#) » [SATECHI](#) » SATECHI SM3 Mechanical Backlit Bluetooth Keyboard User Guide 

## SATECHI SM3 Mechanical Backlit Bluetooth Keyboard User Guide



### Contents

- [1 Product Using Instructions:](#)
- [2 Documents / Resources](#)
  - [2.1 References](#)
- [3 Related Posts](#)

### Product Using Instructions:

1. Turn on the keyboard by moving the switch on the top of the keyboard to the “on” position.

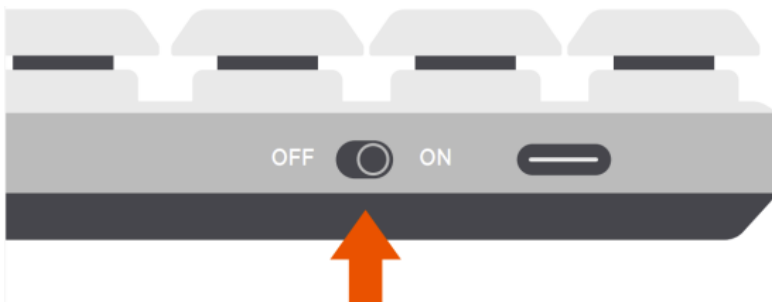

2. Press and hold one of the Bluetooth pairing keys for ~3 seconds, until the LED begins to blink.



3. Select “Slim SM3 Keyboard” or “Bluetooth Device” in the host device’s Bluetooth settings to complete the pairing process. Repeat the process to connect up to two devices via Bluetooth.



4. Connect the included 2.4GHz USB-A wireless receiver to an available USB-A port on your computer, adapter, hub, or dock.

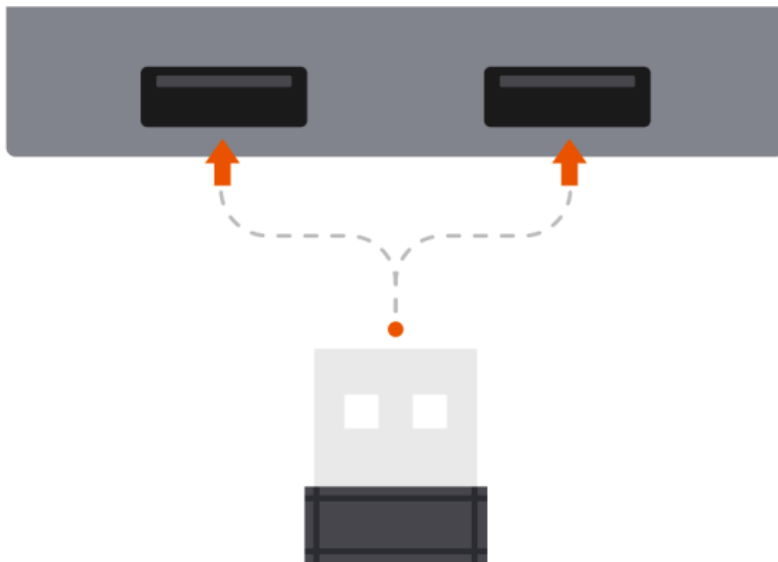

5. Press and hold the USB Receiver key for ~3 seconds to connect your keyboard to the host device via USB-A receiver.

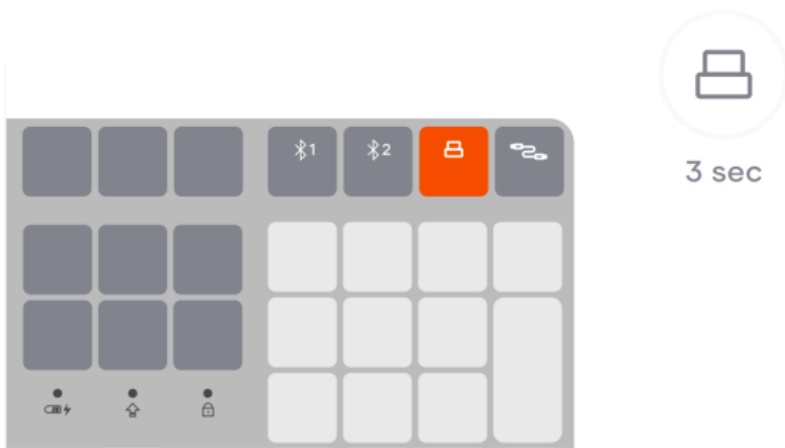

6. To use the keyboard in wired mode connect the included cable, press and hold the wired mode key to switch the keyboard into wired mode connection.

When in wired mode the keyboard will also charge and remain powered on.



7. To recharge, connect the included USB-C power cable to the USB-C port on the keyboard, the charging LED will illuminate.

Charge for 2-3 hours or until the LED turns off.



8. Press "FN + Esc" to activate the function key lock and swap between the Media and Function keys (F1-F12). Esc key will continue to flash when function lock is enabled.

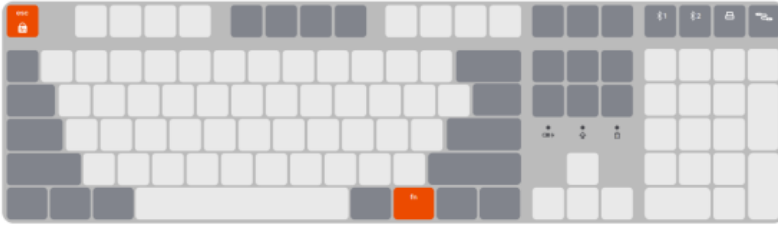
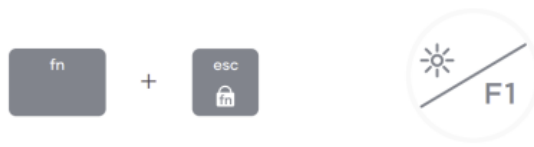

9. Press “FN + O” to switch the keyboard to macOS functions.

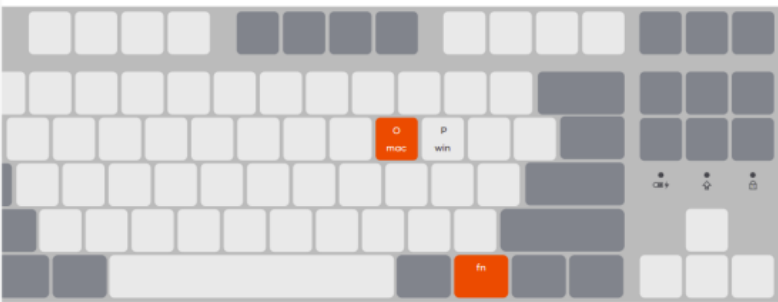

10. Press “FN + P” to switch the keyboard to Windows functions.



11. Num Lock is only active when in Windows mode and paired with a Windows device.

When Num lock is enabled the LED will illuminate.

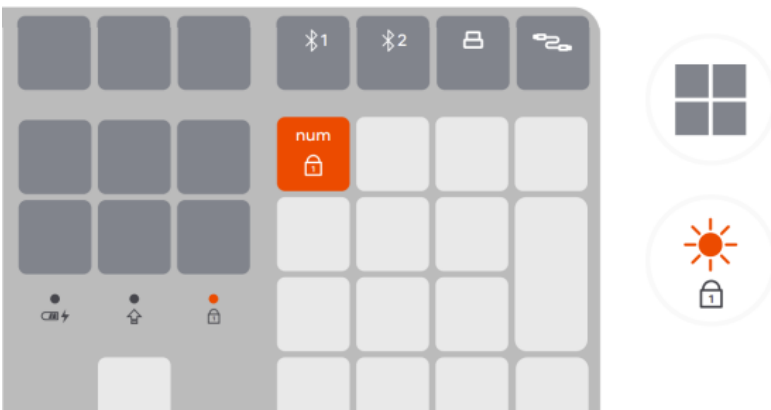

12. When Caps Lock is enabled the Blue LED will illuminate.



13. With a wireless connection, after 1 minute of inactivity, the backlight will turn off. After 30 minutes, the keyboard will enter sleep mode to help conserve battery life. Press any key to wake and the keyboard will automatically reconnect.

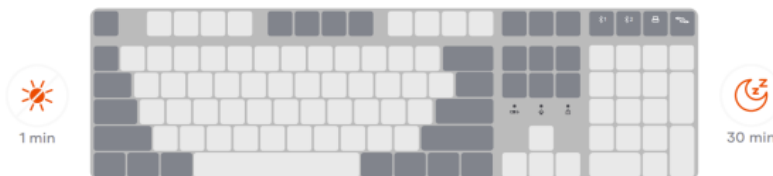

14. When using with Windows you can swap the both OPT, and both CMD keys with the included Win & Alt keys. Lift the macOS keycaps straight up and push Windows keycaps down into place. Switches are not hot-swappable.

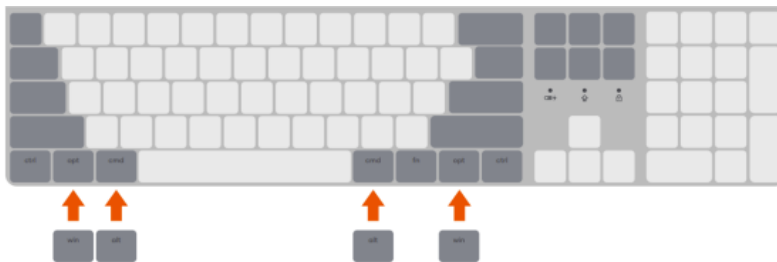

15. To reset all device connections press FN + Del + End.



## Documents / Resources

	<p><a href="#">SATECHI SM3 Mechanical Backlit Bluetooth Keyboard</a> [pdf] User Guide  SM3, SM3 Mechanical Backlit Bluetooth Keyboard, Mechanical Backlit Bluetooth Keyboard, Backlit Bluetooth Keyboard, Bluetooth Keyboard</p>
--	--

## References

- [User Manual](#)

This website is an independent publication and is neither affiliated with nor endorsed by any of the trademark owners. The "Bluetooth®" word mark and logos are registered trademarks owned by Bluetooth SIG, Inc. The "Wi-Fi®" word mark and logos are registered trademarks owned by the Wi-Fi Alliance. Any use of these marks on this website does not imply any affiliation with or endorsement.