



SATCO 62-1680 LED Disk Light with Occupancy Sensor Instruction Manual

[Home](#) » [SATCO](#) » SATCO 62-1680 LED Disk Light with Occupancy Sensor Instruction Manual 



**7" & 10" LED DISK LIGHTS
WITH OCCUPANCY SENSOR
Models: 62-1680, 62-1681**

Contents

- [1 INSTALLATION AND SAFETY INSTRUCTIONS](#)
- [2 HARDWARE INCLUDED](#)
- [3 OCCUPANCY SENSOR OPERATION](#)
- [4 INSTALLATION](#)
- [5 ELECTRICAL CONNECTION](#)
- [6 Documents / Resources](#)
 - [6.1 References](#)
- [7 Related Posts](#)

INSTALLATION AND SAFETY INSTRUCTIONS

IMPORTANT: Read before installing fixture. Retain for future reference.

WARNING: Risk of Fire or Electric Shock

- Disconnect power before installation or maintenance of the fixture.
- This product must be installed in accordance with applicable installation codes by a person familiar with mentioned above codes and hazards involved. These fixtures are designed to meet the latest NEC requirements and are listed in full compliance with UL 1598.

- Supply wires must be rated minimum 90°C. If uncertain consult an electrician.
- The product is purposed for interior use only, suitable for wet locations.
- Protect the product against direct contact with water.
- Assemble the product only with the use of parts provided and the housing; improper assembly may result in device failing which could damage the product, personal property or cause injury.
- **CAUTION:** When handling the fixture, do not apply pressure to the LEDs. Hold the fixture by the base only.

Cleaning

Clean with a soft or damp cloth, make sure the power is OFF.

Do not clean with liquids or abrasives.

5-Year Limited Warranty

The purchased product is covered with a 5-year warranty in respect of any defect in material or workmanship after purchase date.

Satco shall bear no responsibility on account of guarantee, as well as shall bear no liability for any faults, in case of improper operation, use negligence, accident or exposure to natural hazard, or excessive use over the limits specified for the unit, or if any unauthorized alteration or repair followed.

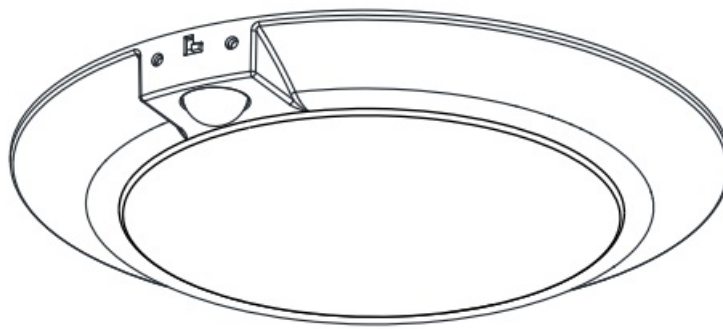

62-1680 = 7" (177.8mm)
with Occupancy Sensor
62-1681 = 10" (254mm)
with Occupancy Sensor

HARDWARE INCLUDED



Wire Connector
Qty: 3



Junction Box Screw
Qty: 2 + 2 Extra



7" (177.8mm)



10" (254mm)

Crossbar
Qty: 1

OCCUPANCY SENSOR OPERATION

There are 3 sensor settings on the side. Use a flat screwdriver to adjust.

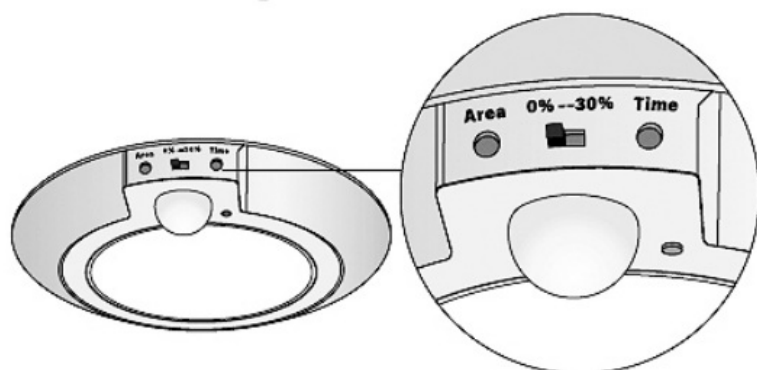



Area **0% – 30%** **Time**



max. 20ft



0- 5 mins.

 <p>max. 20ft</p>	<p>1. Area: Sensor activation area can be set for a diameter of 0ft to a maximum of 20ft.</p>
 <p>Night time</p>	<p>2. 0% – 30% The fixture can be set at default brightness of 0% (not lit in OFF condition) or 30% (maintain 30% of full output in OFF condition).</p>
 <p>0-5mins</p>	<p>3. Time: Time options from 0 to 5 minutes for ON time after activation.</p>

INSTALLATION

NOTE: Shut OFF the power at the circuit breaker and remove existing fixture, including the mounting hardware. Carefully unpack your new fixture and lay out all the parts on a clear area. Be careful not to lose any small parts necessary for installation.

1. Twist lens cover counter-clockwise to remove from Disk Light.
2. Select color temperature using the switch. See Figure 1.

FIGURE 1

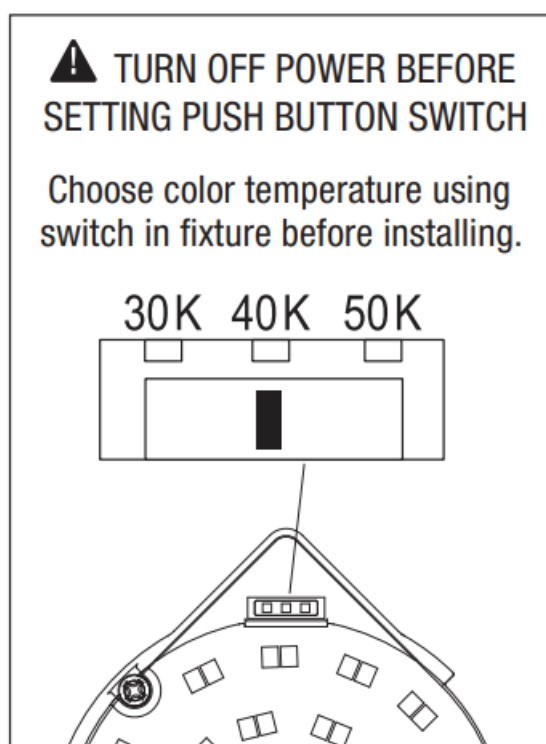

3. Secure Crossbar to the Junction Box using Junction Box Screws. The side of the mounting plate marked "GND" must face out.
4. Place the Disk Light over the Crossbar and secure with Mounting Screws through canopy Keyholes. Make sure Disk Light is flush to the ceiling. See Figure 2.

FIGURE 2 62-1680 = 7" LED DISK LIGHT W/OCC

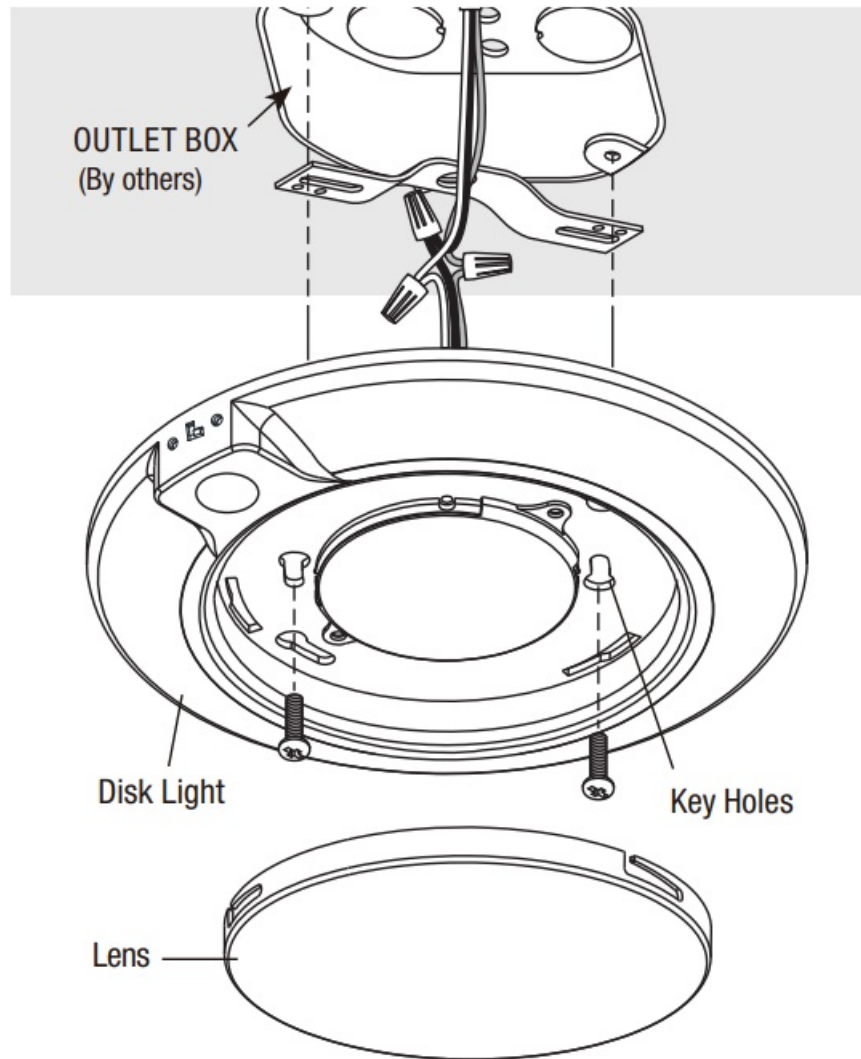

5. Replace the lens back onto the Disk Light by turning clockwise.

ELECTRICAL CONNECTION

Connect the fixture input wires to Junction Box wires as shown in the Wiring Diagram, making sure all wire connectors are secure. If the Junction Box has a Ground Wire (Green or Bare Copper), connect the fixture's Ground Wire to it. After wires are connected, tuck them carefully inside the Junction Box.

62-1681 = 10" LED DISK LIGHT W/OCC

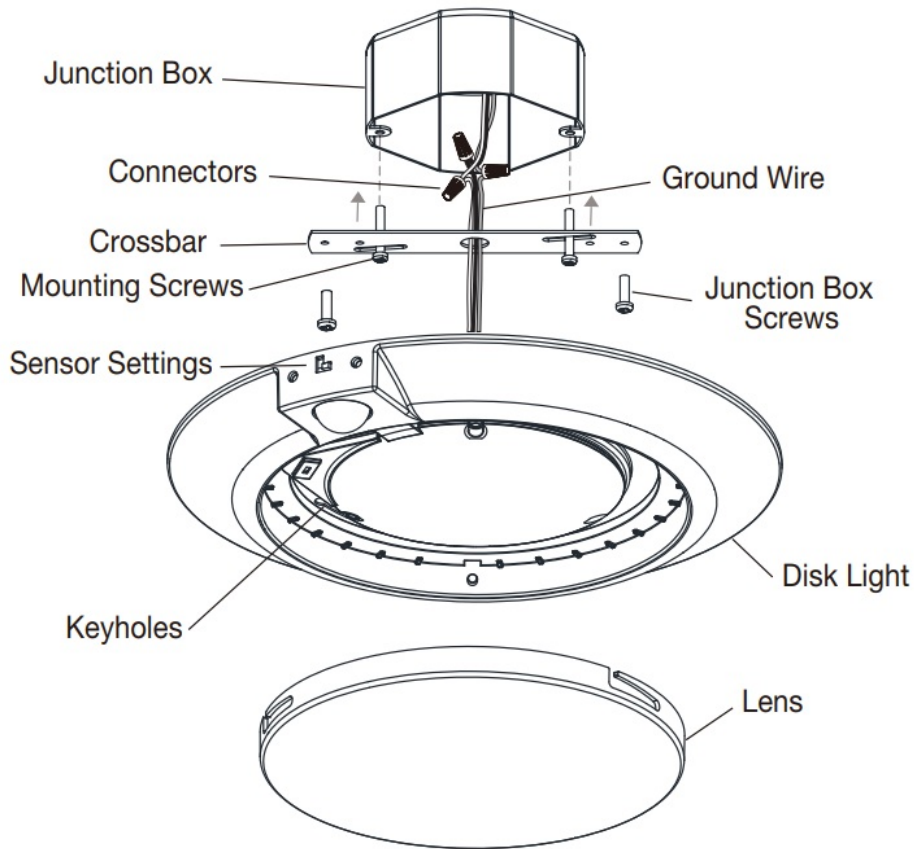

WIRING DIAGRAM



Fixture Wires

Black or
Smooth

House Wires

Black
(Hot)

Fixture Wires

White or
Ribbed

House Wires

White
(Neutral)

Fixture Wires

Bare wire
(Ground)

House Wires

Green or Bare Copper
(Ground)



Satco Products, Inc.
Brentwood, NY 11717

SALE on SATCO at www.BulbAmerica.com

take additional 5% Off with coupon code 5PDF

© Copyright 2022 Satco Products, Inc. 1/22, v1.1

	<p>SATCO 62-1680 LED Disk Light with Occupancy Sensor [pdf] Instruction Manual 62-1680, 62-1681, LED Disk Light with Occupancy Sensor, 62-1680 LED Disk Light with Occupancy Sensor, LED Disk Light, Disk Light</p>
--	--

References

- 🇺🇸 [Light Bulbs, Fixtures, LED Lighting, More - BulbAmerica](#)