



Saramonic SR-MV2000W Wired/Wireless Dual-Function Microphone User Manual

[Home](#) » [Saramonic](#) » Saramonic SR-MV2000W Wired/Wireless Dual-Function Microphone User Manual 



Wired/Wireless Dual-Function Microphone
SR-MV2000W
User Manual



Product Structure

TX

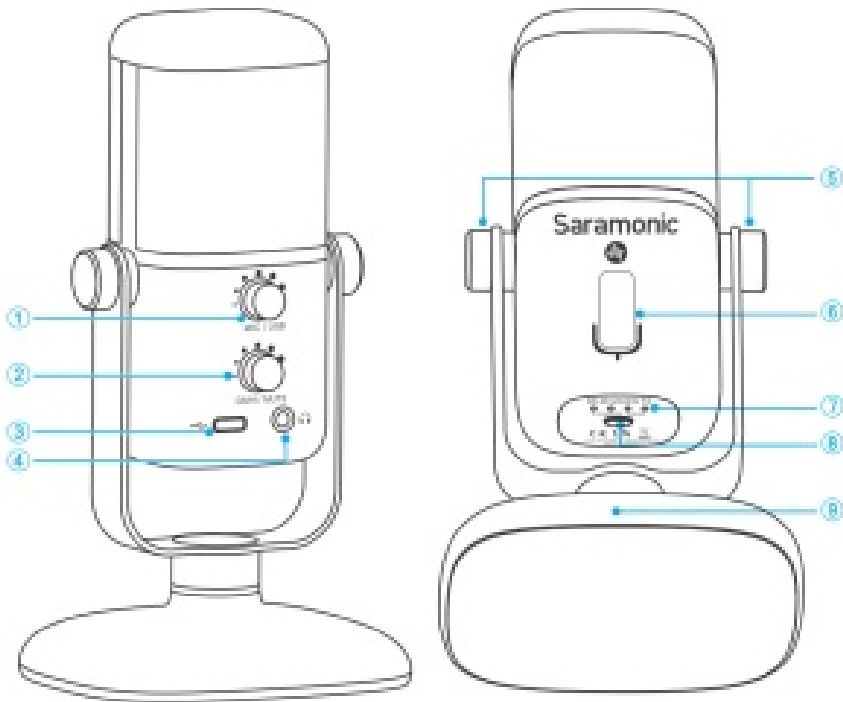

<div>① Headphone volume control</div> <div>② Gain/mute control</div> <div>③ Type-C port</div> <div>④ 3.5mm headphone jack</div>	<div>⑤ Locking knob</div> <div>⑥ Smart LED indicator</div> <div>⑦ Battery level indicator</div> <div>⑧ Power/pair button</div> <div>⑨ Mic stand</div>
---	---

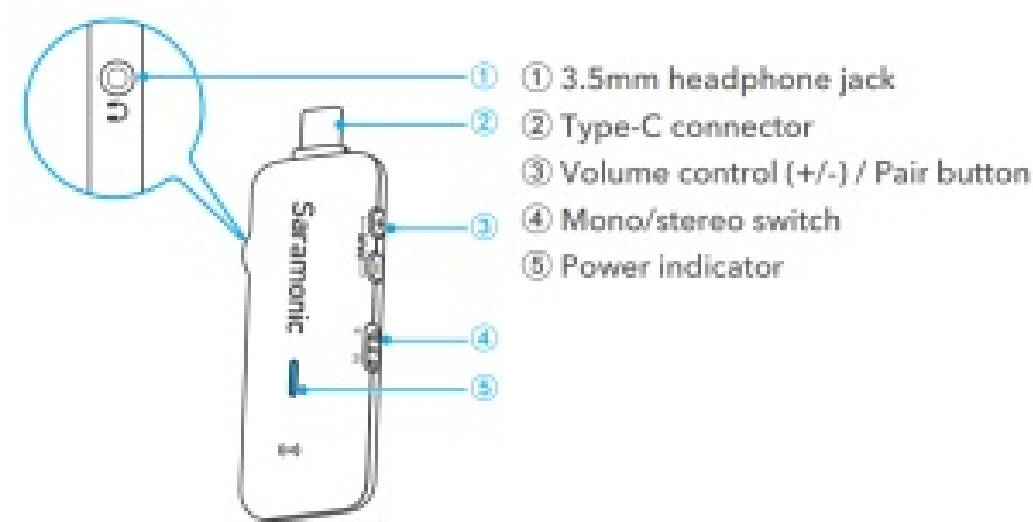

Contents

- 1 Accessories
- 2 Functions
- 3 Angle Adjustment
- 4 Battery Charging
- 5 Operation Guide
- 6 Specifications
- 7 Packing List
- 8 Polar Pattern
- 9 Frequency Response
- 10 Documents / Resources
- 11 Related Posts

Accessories

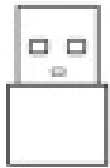

Type-C female to
USB-A male adapter



3/8'' to 5/8''
screw adapter

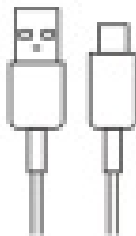

USB-A to
Type-C cable

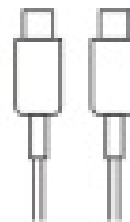

Type-C to
Type-C cable

Functions

1. Magnetic Base

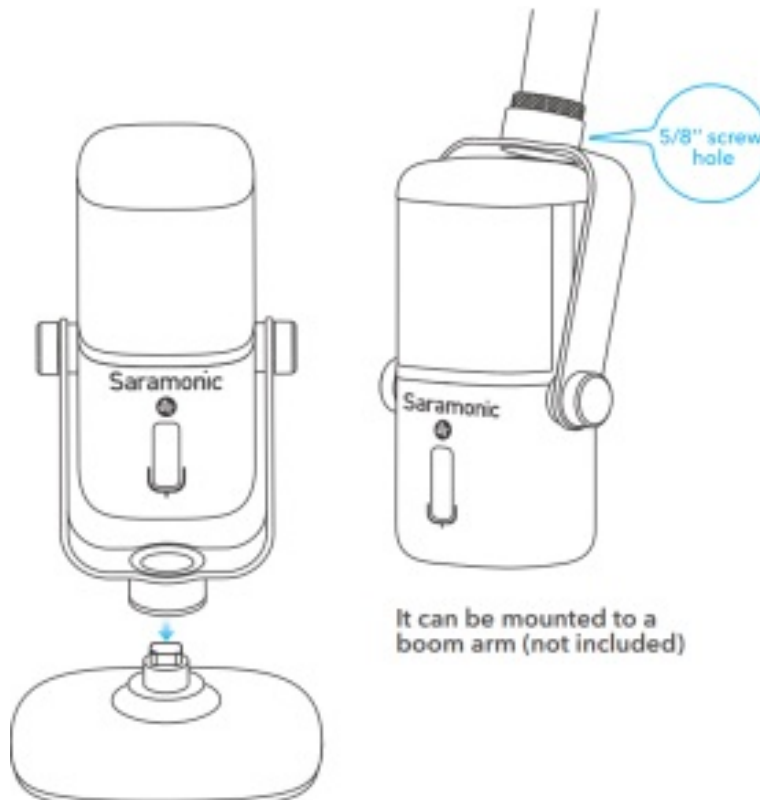

It can be mounted to a boom arm (not included)

Angle Adjustment

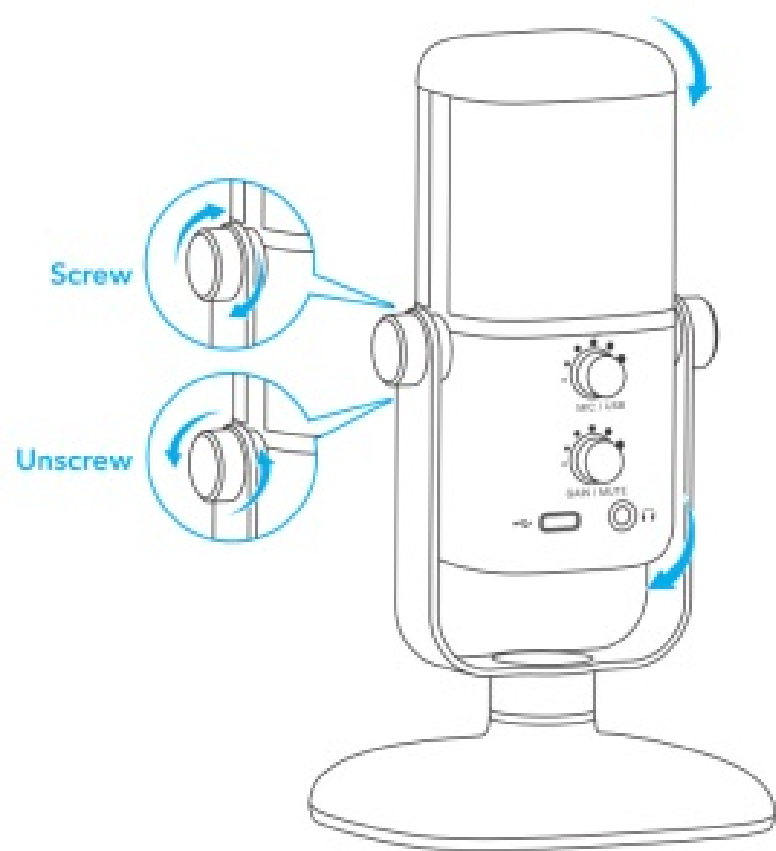

Battery Charging

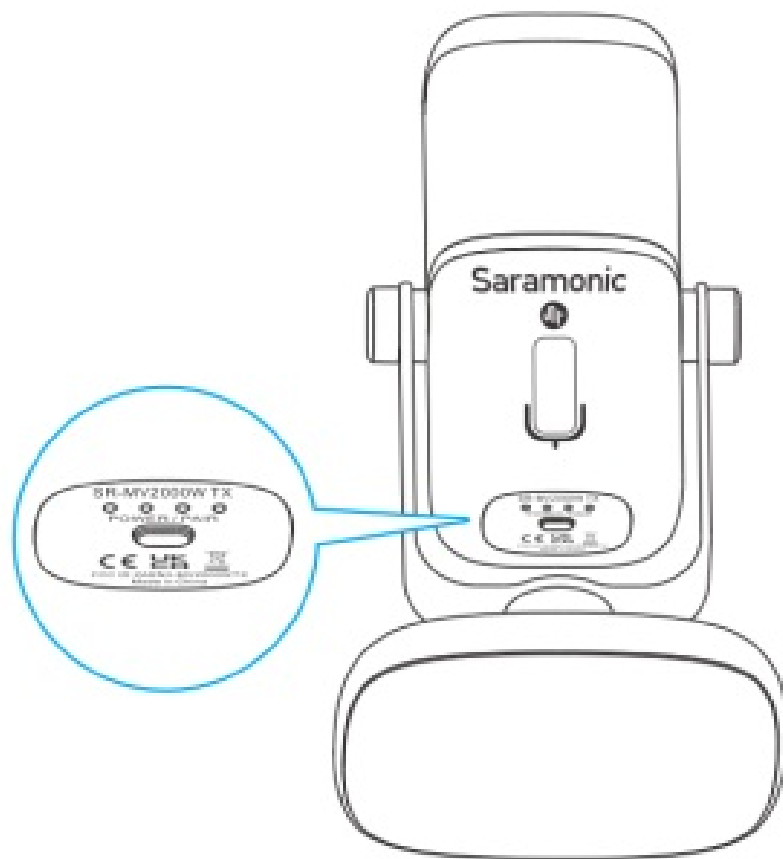

Indicator	Status
☀️☀️☀️☀️	Charging (breathing white light)
⦿⦿⦿⦿	Full charged
⦿⦿⦿●	Current battery level (75% power)
⦿●●●	Low battery (25% power)



Operation Guide

A – Wired Operation

1. Connect the microphone to your smartphone/computer

Devices	Smartphone	Computer
Connection	Type-C to Type-C cable; Type-C to Lightning cable (not included)	USB-A to Type-C cable
System Requirements	Android/iOS devices	 Windows 7/10  Mac OS 10.12 or later



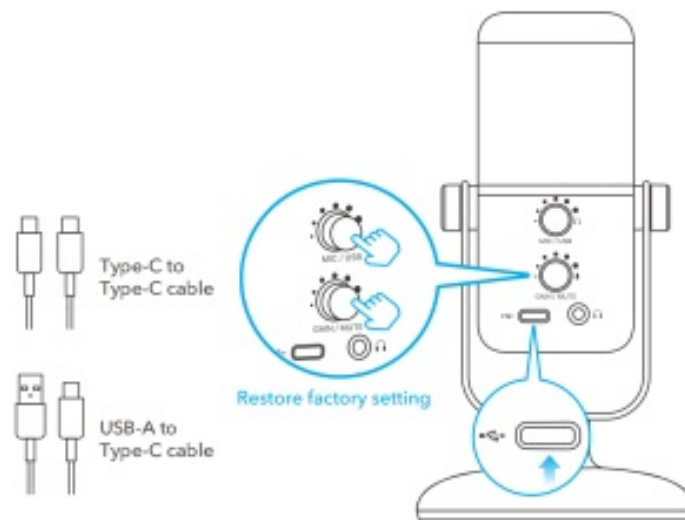

Note:

1. SR-MV2000W is also compatible with iOS devices. The Type-C to Lightning adapter cable is not included. Please purchase it separately if needed.
2. For optimum sound, please press and hold the volume control and gain control knobs simultaneously to restore the factory setting. The indicator will turn red and blink three times.

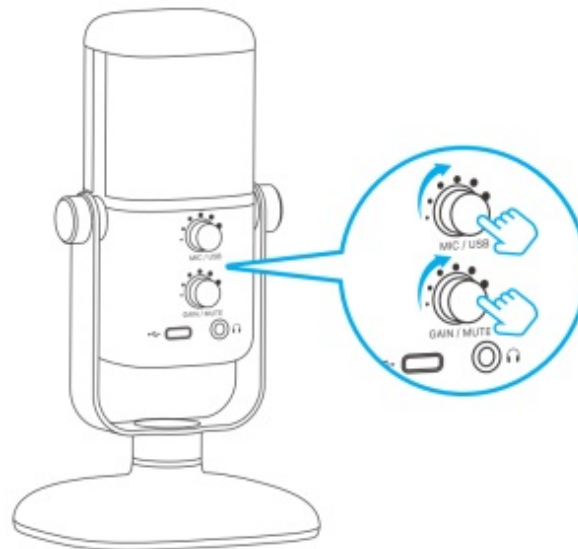

2. Adjust the knobs according to your needs



	Direct/Playback Monitoring	Gain/M
Control Button	 <p>MIC / USB</p>	
Smart LED Indicator Color	 <p>MIC (Direct monitoring)</p>  <p>USB (Playback monitoring)</p>	 
Operating	Press the button to switch between direct and playback monitoring; Turn the knob to adjust the headphone volume.	Press t gains f

B – Wireless Operation

1. Turn on the transmitter

Note: When using the wired function, short press the power button to enable the wireless function simultaneously. Press and hold the power button

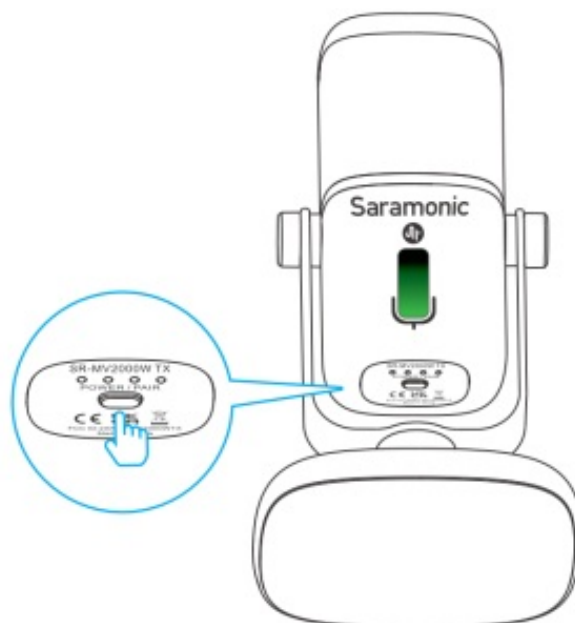

3. TX & RX Pairing TX

Status	Indicator light color
Unpaired	green light flashes in cycle
Pairing	green light flashes rapidly
Paired Successfully	solid green light

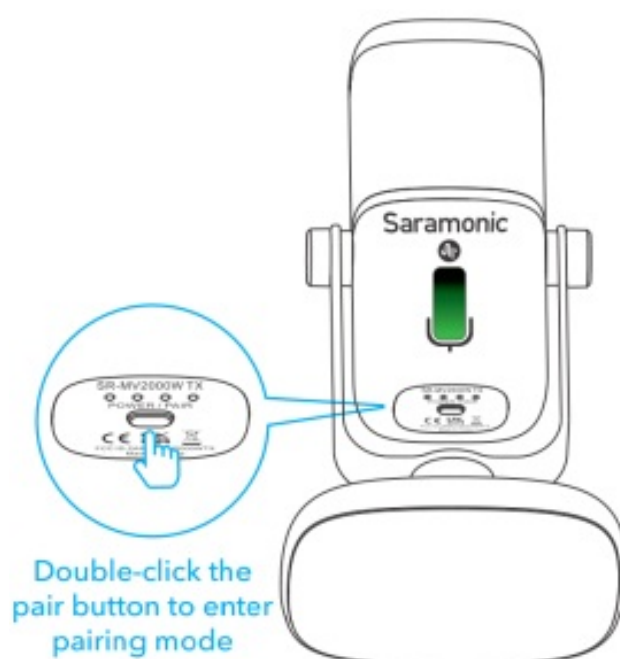

2. Connect the receiver to an external device

- ①. Connect to a Type-C device
- ②. Connect to a USB-A device

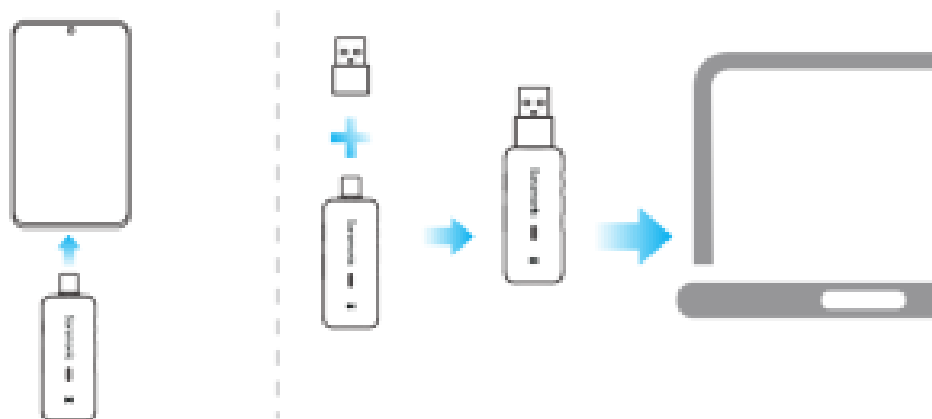

RX



Press + and – buttons simultaneously to enter pairing mode, TX and RX will be successfully paired within 10s.

Status	Indicator light color
Unpaired	green light flashes in cycle
Pairing	green light flashes rapidly
Paired Successfully	solid green light

Specifications

Wired Operation

Mic Capsule	14mm Electret Condenser Capsule
Polar Pattern	Cardioid
Frequency Response	20Hz-20kHz
Sensitivity	-36dB (0dB=1V/Pa, 1kHz1Pa)
Signal-to-Noise Ratio	80dB
Maximum SPL	120dB
Sampling Rate	48kHz
Bit Rate	16bit/24bit
Mic Gain	0~54dB
Working Voltage	5V110mA
Audio Output Connector	3.5mm Headphone Jack, Type-C Port
Operating Temperature	0°Cto50°C
Storage Temperature	-20°Cto+55°C

Wireless Operation

Mic Capsule	14mm Electret Condenser Capsule
Polar Pattern	Cardioid
Frequency Response	35Hz-18kHz
Sensitivity	-36dB (0dB=1V/Pa, 1kHz1Pa)
Signal-to-Noise Ratio	80dB
Maximum SPL	120dB
Transmission Type	2.4GHz
Modulation	GFSK
Antenna	Dipole Antenna
Operating Range	60m (Outdoors without obstacles)
Distortion	<0.05%
Battery Life	6 hours
Charging Time	1.5 hours
Battery Capacity	850mAh
Dimensions	TX: 165×78.6×90mm RX: 71.6×27.1×10.55mm
Weight	TX: 359g RX: 12.5g

Packing List

- SR-MV2000W Microphone×1
- Wireless Receiver×1
- Type-C Female to USB-A Male Adapter×1
- 3/8" to 5/8" Screw Adapter×1
- 6.6'(2m) USB-A to Type-C Cable×1
- 6.6'(2m) Type-C to Type-C Cable×1

Polar Pattern

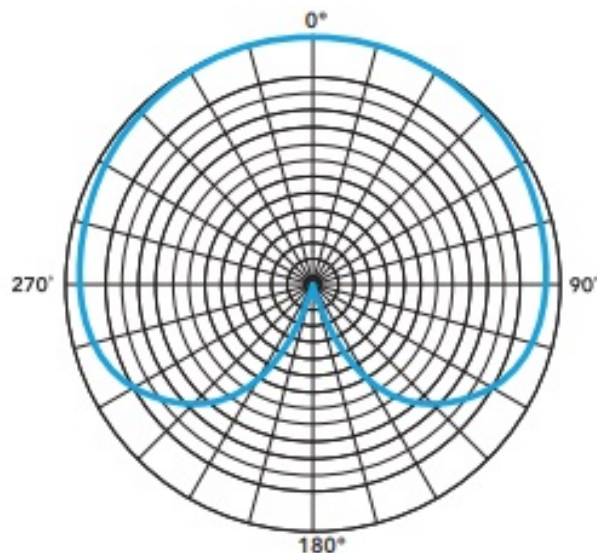

Frequency Response

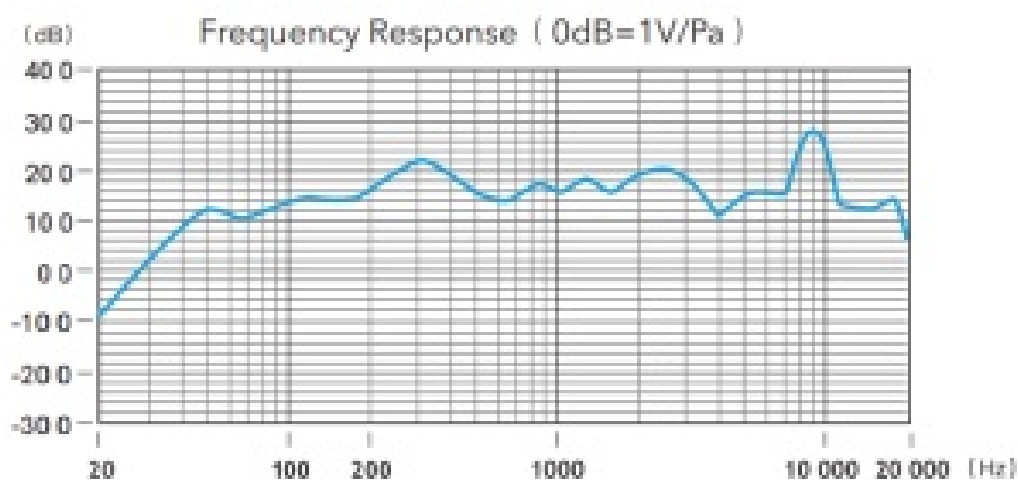

For a better recording experience, the application SmartRecorder is recommended.

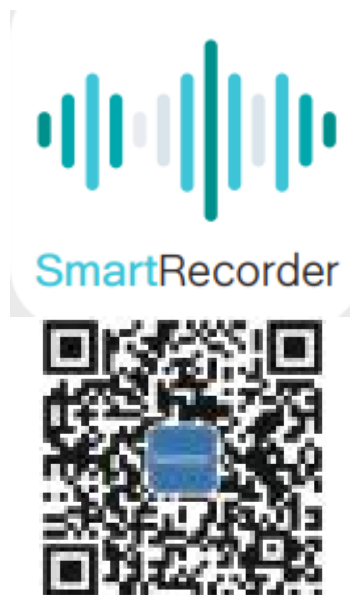

Scan the QR code and follow us
Shenzhen Jiayz Photo Industrial., Ltd
A16 Building, Intelligent Terminal Industrial Park of Silicon Valley
Power, Guanlan, Longhua District, Shenzhen, China
400-613-1096
www.saramonic.com

FCC Caution:

Any changes or modifications not expressly approved by the party responsible for compliance could void the user’s authority to operate the equipment.

This device complies with part 15 of the FCC Rules. Operation is subject to the following two conditions:

- (1) This device may not cause harmful interference, and (2) this device must accept any interference received, including interference that may cause undesired operation.

IMPORTANT NOTE:



Note: This equipment has been tested and found to comply with the limits for a Class B digital device, pursuant to part 15 of the FCC Rules. These limits are designed to provide reasonable protection against harmful interference in a residential installation. This equipment generates, uses and can radiate radio frequency energy and, if not installed and used in accordance with the instructions, may cause harmful interference to radio communications. However, there is no guarantee that interference will not occur in a particular installation. If this equipment does cause harmful interference to radio or television reception, which can be determined by turning the equipment off and on, the user is encouraged to try to correct the interference by one or more of the following measures:

- Reorient or relocate the receiving antenna.
- Increase the separation between the equipment and receiver.
- Connect the equipment into an outlet on a circuit different from that to which the receiver is connected.
- Consult the dealer or an experienced radio/TV technician for help.

FCC Radiation Exposure Statement:

This equipment complies with FCC radiation exposure limits set forth for an uncontrolled environment.

Documents / Resources

	Saramonic SR-MV2000W Wired/Wireless Dual-Function Microphone [pdf] User Manual MV2000WTX, 2ARN3-MV2000WTX, 2ARN3MV2000WTX, SR-MV2000W Wired, Wireless Dual I-Function Microphone, Dual-Function Microphone, Microphone
	Saramonic SR-MV2000W Wired/Wireless Dual-Function Microphone [pdf] User Manual SR-MV2000W Wired Wireless Dual-Function Microphone, SR-MV2000W, Wired Wireless Dual -Function Microphone