



# SANYOUCHEG R13 LED Lamp App User Guide

[Home](#) » [SANYOUCHEG](#) » SANYOUCHEG R13 LED Lamp App User Guide 

## Contents

- 1 SANYOUCHEG R13 LED Lamp App
- 2 Product Information
- 3 Product Usage Instructions
- 4 FCC Warning Statement
- 5 FAQ
- 6 Documents / Resources
  - 6.1 References

# SANYOUCHEG

SANYOUCHEG R13 LED Lamp App



## Product Information

### Specifications

- Compatible with Android and Apple iOS systems
- LED APP iOS
- LED APP RGB

### Product Usage Instructions

#### Downloading and Connecting the LED Lamp App

Use your mobile phone to scan the QR code to download the LED Lamp app. The app is compatible with Android and Apple iOS systems.

LED APP iOS



#### Connecting the Projection Lamp to the App

Connect the projection lamp to the power supply and turn it on. Open the LED Lamp app and swipe down on the blank area of the home page to search for available devices.

LED APP RGB

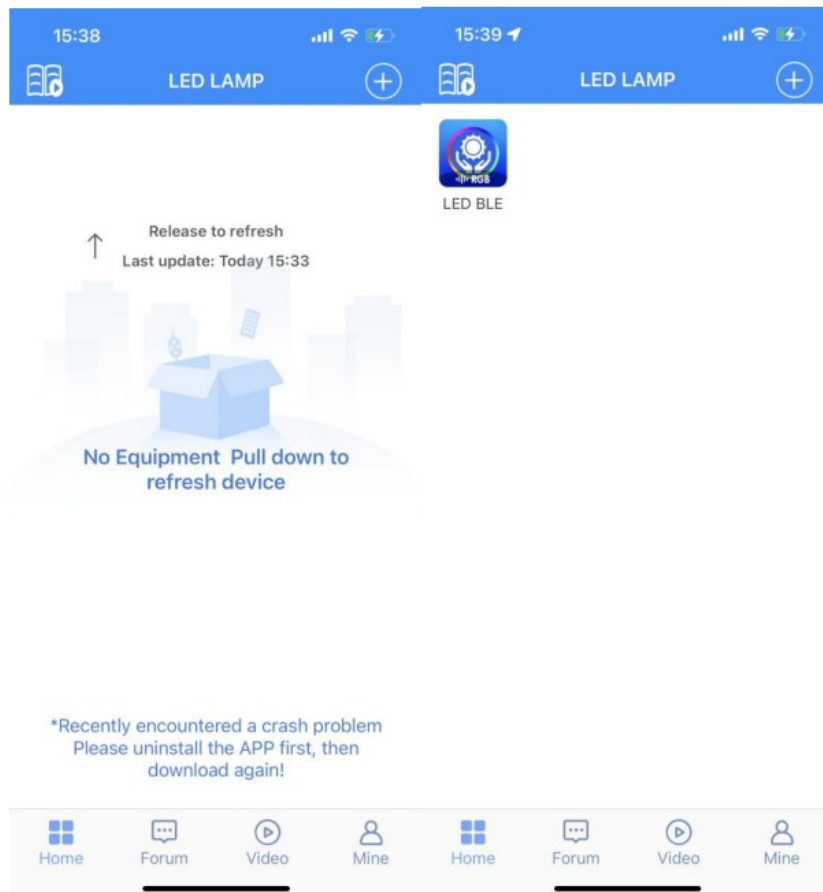

## Controlling the RGB Color and Brightness

Click on the LED BLE icon to enter the control page. The number 1 will appear in the marked position to indicate that the device has been successfully connected. On this page, you can adjust the color and brightness of the lamp as desired.

RGB LED BLE 1

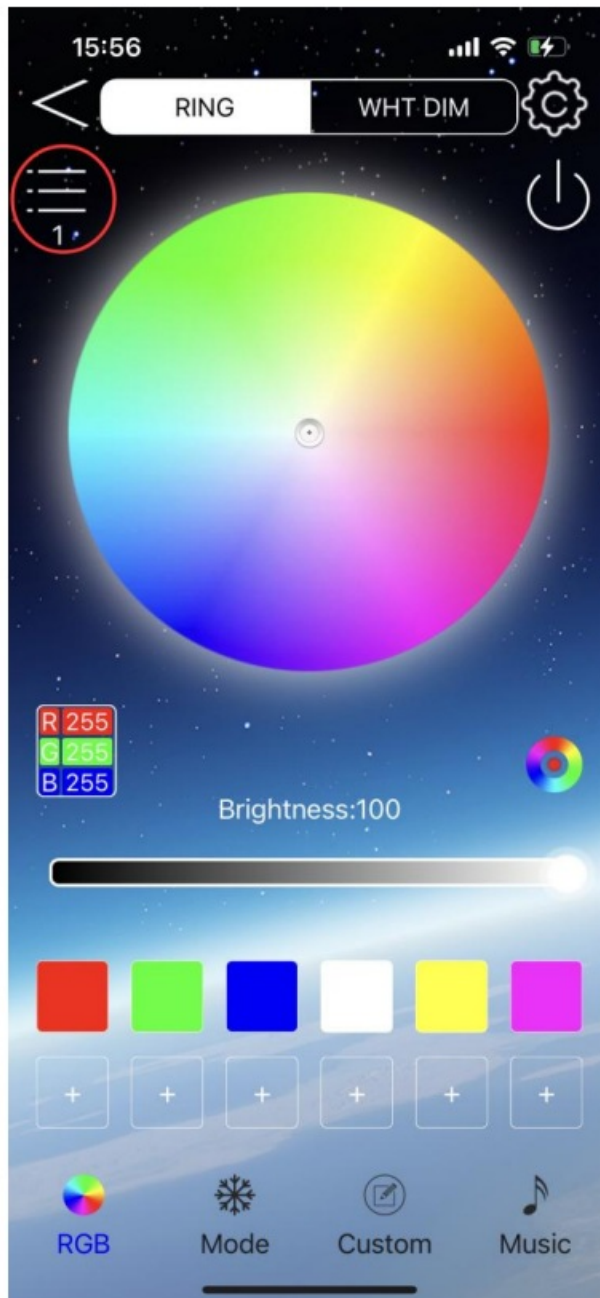

## Selecting the Lighting Mode

On the control page, you can select the lighting mode by clicking on the Mode option. By clicking on the + symbol, you can set the parameters of different lighting modes.

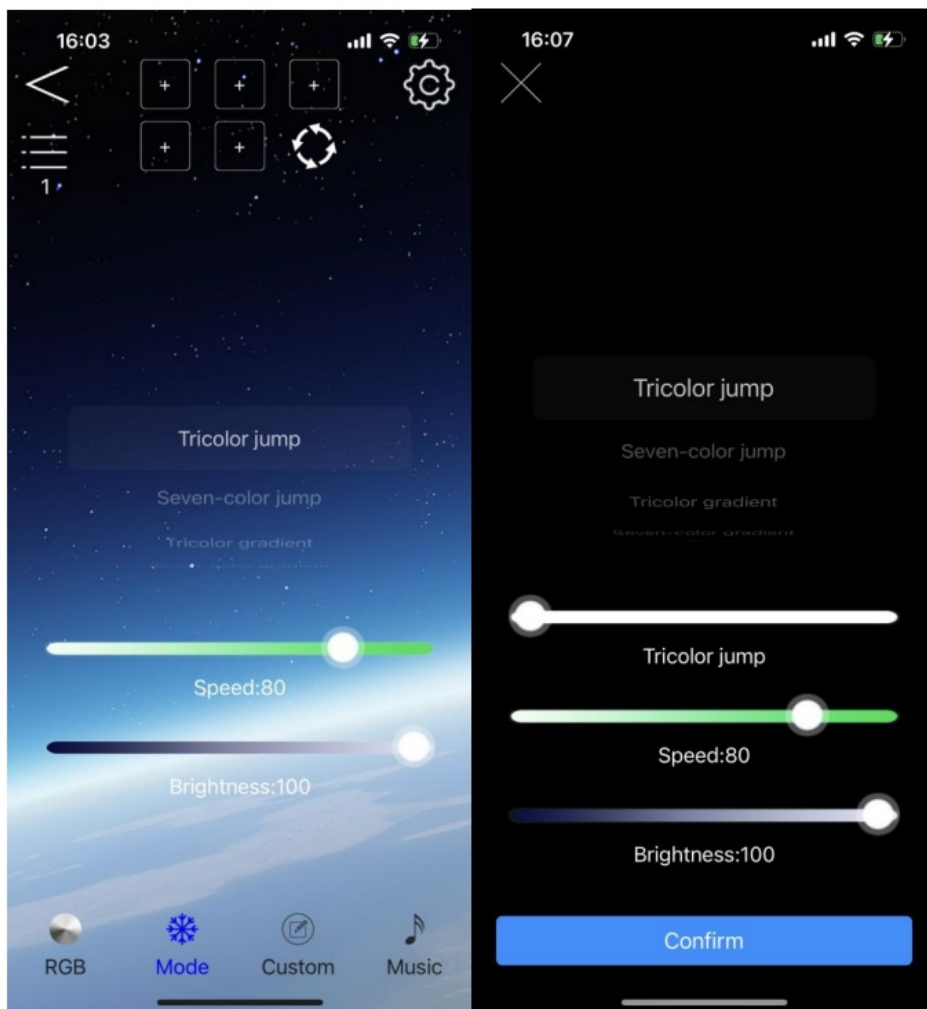

## Customizing the Lighting Effects

On the control page, you can customize the color, speed, and brightness of the lamp by clicking on the Custom option. To delete a color, long-press on the color block. To add a new color, click on the + symbol and select a color.

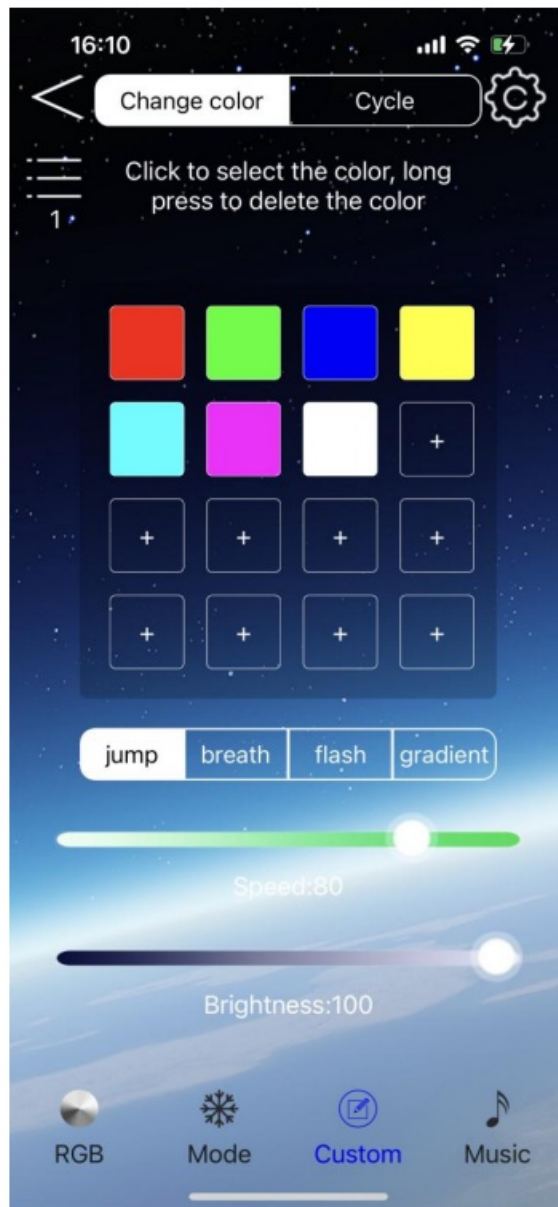

### Synchronizing the Lighting with Music

On the control page, you can activate the music mode. The lamp's lighting effects will change in sync with the rhythm of external sounds or music playing on your phone.

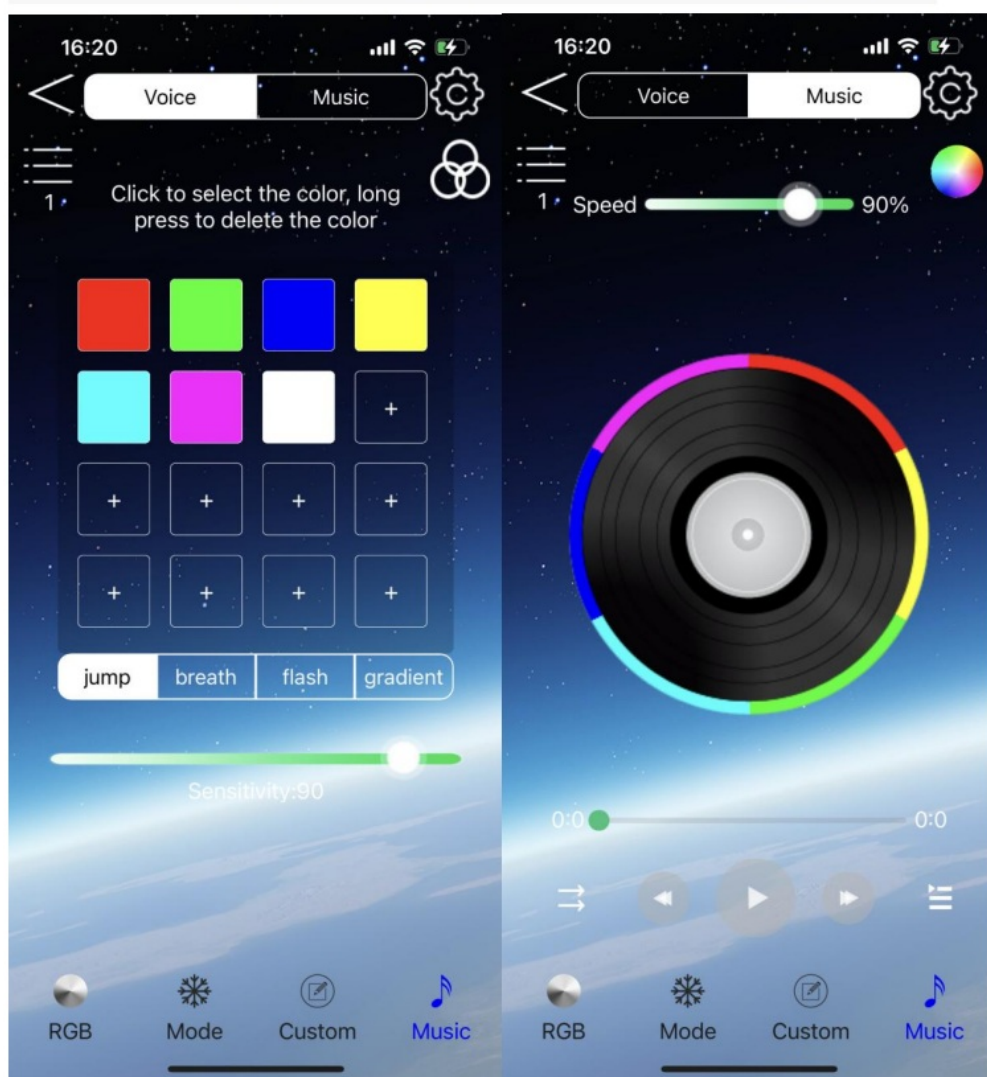

## FCC Warning Statement

Changes or modifications to this unit not expressly approved by the party responsible for compliance could void the user's authority to operate the equipment. This equipment has been tested and found to comply with the limits for a Class B digital device, pursuant to Part 15 of the FCC Rules. These limits are designed to provide reasonable protection against harmful interference in a residential installation. This equipment generates, uses, and can radiate radio frequency energy and, if not installed and used in accordance with the instructions, may cause harmful interference to radiocommunications. However, there is no guarantee that interference will not occur in a particular installation. If this equipment does cause harmful interference to radio or television reception, which can be determined by turning the equipment off and on, the user is encouraged to try to correct the interference by one or more of the following measures:

- Reorient or relocate the receiving antenna. – Increase the separation between the equipment and receiver.
- Connect the equipment to an outlet on a circuit different from that to which the receiver is connected.
- Consult the dealer or an experienced radio/TV technician for help.

This device complies with Part 15 of the FCC Rules. Operation is subject to the following two conditions: (1) this device may not cause harmful interference, and (2) this device must accept any interference received, including interference that may cause undesired operation.

## FCC Radiation Exposure Statement

The device has been evaluated to meet general RF exposure requirements. The device can be used in portable

exposure conditions without restriction.

## FAQ

### Q: What do I do if the device causes interference to radio or television reception?

A: If this equipment does cause harmful interference to radio or television reception, try the following measures to correct the interference:

- Reorient or relocate the receiving antenna.
- Increase the separation between the equipment and receiver.
- Connect the equipment into an outlet on a circuit different from that to which the receiver is connected.
- Consult the dealer or an experienced radio/TV technician for help.

### Q: Does the device comply with FCC regulations?

A: Yes, this device complies with Part 15 of the FCC Rules. It may not cause harmful interference and must accept any interference received, including interference that may cause undesired operation.

### Q: Can the device be used in portable exposure conditions?

A: Yes, the device has been evaluated to meet general RF exposure requirements and can be used in portable exposure conditions without restriction.

---

## Documents / Resources

<p>01</p>  <p>Download and install the "SANYOUCHENG" app. Use your mobile phone to scan the QR code to download the "SANYOUCHENG" app. The app is compatible with Android and Apple iOS systems. (SANYOUCHENG R13 LED Lamp App) (SANYOUCHENG R13 LED Lamp App)</p>	<p><a href="#">SANYOUCHENG R13 LED Lamp App [pdf] User Guide</a> R13, 2BELI-R13, 2BELIR13, R13 LED Lamp App, LED Lamp App, Lamp App, App</p>
---	--

## References

- [User Manual](#)

[Manuals+](#), [Privacy Policy](#)

This website is an independent publication and is neither affiliated with nor endorsed by any of the trademark owners. The "Bluetooth®" word mark and logos are registered trademarks owned by Bluetooth SIG, Inc. The "Wi-Fi®" word mark and logos are registered trademarks owned by the Wi-Fi Alliance. Any use of these marks on this website does not imply any affiliation with or endorsement.