



SANREMO CONNECTED_Web App User Manual

[Home](#) » [SANREMO](#) » SANREMO CONNECTED_Web App User Manual 

Contents

- 1 [SANREMO CONNECTED_Web App](#)
- 2 [Product Information](#)
- 3 [Product Usage Instructions](#)
- 4 [How To Use](#)
- 5 [CONNECT THE MACHINE TO THE HOME WI-FI NETWORK](#)
- 6 [Communicate with WiFi Module in 3 different modes](#)
- 7 [CREATING A CLOUD ACCOUNT](#)
- 8 [TROUBLESHOOTING](#)
- 9 [Documents / Resources](#)
 - 9.1 [References](#)
- 10 [Related Posts](#)

SANREMO

SANREMO CONNECTED_Web App



Product Information

The product is equipped with a WiFi module that allows for wireless connectivity and communication. The WiFi module enables firmware updates and various features through the Sanremo Connector App. There are three different modes of communication available, including direct point-to-point connection with a mobile device or PC, connection through a home router, and connection with a cloud account. The encryption mode for the WiFi module depends on the working mode set by the router used and can support WPA/WPA2/WPA3.

To utilize the WiFi module and access its features, it is necessary to install a label on the back side of the drip tray. After updating the firmware, the WiFi module needs to be connected to a router to enable OTA (Over-The-Air) updates. The Sanremo Connector App can be downloaded and installed from the Google Play Store or Apple Store.

Product Usage Instructions

1. Check if the label is installed on the back side of the drip tray to ensure recognition of the WiFi-equipped product.
2. Using your mobile phone, connect directly to the WiFi network generated by the module. The network name and password can be found on the label or in the user menu -> WiFi section.
3. Open the Sanremo Connector App, which will display a blank page with the YOU logo and a red WiFi status bar. Tap on the bar to access the WiFi configuration page.
4. In the Sanremo Connector App, go to the WiFi menu and click on "Change WiFi Network" in the red box. Scan for available WiFi networks, select the desired network, and enter the password. If the connection is successful, the status bar at the top will change from red to green. Once connected to the chosen WiFi network, deactivate the WiFi connection between your smartphone and the machine while keeping your device's data connection active.
5. There are three different modes of communication with the WiFi module:
 - Direct point-to-point connection: Connect your mobile device or PC directly to the machine. This allows for local communication but does not support OTA firmware updates. The WiFi status bar will be red.
 - Point-to-point connection through a home router: Connect both your mobile device or PC and the

machine to a home router. This allows for local communication and OTA firmware updates if the router has an active web connection. The WiFi status bar will be green.

- Cloud account connection: Create a cloud account using the Sanremo Connector App. This enables local communication and communication from anywhere. The encryption mode depends on the working mode set by the router used.

6. To create a cloud account, open the Sanremo Connector App and press the “Access Cloud” button. If you haven’t already created an account, you can do so by visiting the web application at <https://cloudwinet.it> and clicking on the “Register Your Account Now” link.

How To Use

To recognize YOU equipped with wifi module (from November 2022), double check if installed this label on the back side of drip tray.



After firmware update (power board 1.38, display 1,37), is necessary to connect the WiFi module to a router to enable OTA update of module. Download and install the Sanremo Connector App from the google play store or apple store, before using it follow the steps below

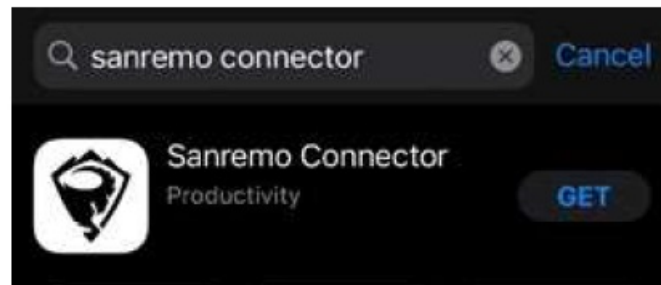
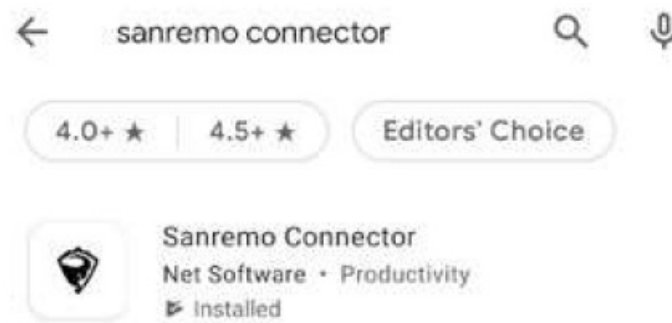

Using your mobile phone, connect directly your mobile to WiFi network generate by the module: net generated and password are visible in the label (scan the QR code the immediately get all the information) or search all the info in user menu->WiFi.



NOTE

If you cannot access/download the Sanremo connector app, connect to the machine wi- fi network (see connection page 2, point-to- point connection) and then open a new page in your smartphone's web browser and type in the following ip address: 192.168.10.1

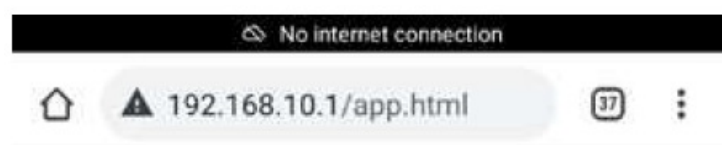

ATTENTION:

NO MORE THAN N°2 USERS CAN BE CONNECTED AT THE SAME TIME USING 'PIN TO PIN' CONNECTION MODE.

Open the Sanremo Connector App:

you will see a blank page with YOU logo and red WiFi status bar:

- Tap on the bar to jump in configuration page for WiFi.

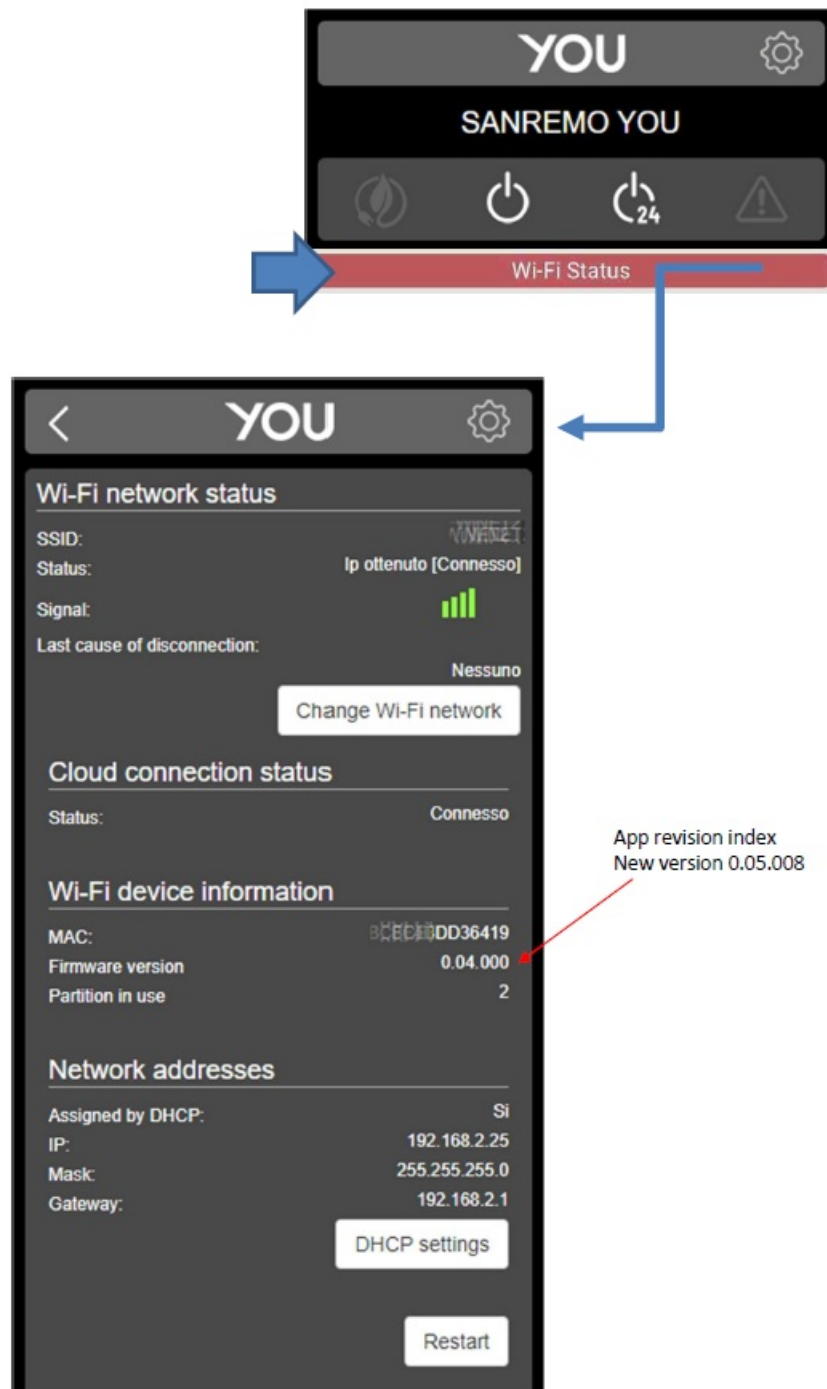

CONNECT THE MACHINE TO THE HOME WI-FI NETWORK



ONCE YOU HAVE SUCCESSFULLY CONNECTED TO THE CHOSEN WI-FI NETWORK, DEACTIVATE THE WI-FI CONNECTION BETWEEN YOUR SMARTPHONE AND THE MACHINE, WHILE KEEPING YOUR DEVICE'S DATA CONNECTION ACTIVE.

SCAN THE WI-FI NETWORKS USING THE APPROPRIATE COMMAND, SELECT THE DESIRED NETWORK AND ENTER THE PASSWORD.

IF THE CONNECTION IS SUCCESSFUL, THE STATUS BAR AT THE TOP WILL CHANGE FROM RED TO GREEN.

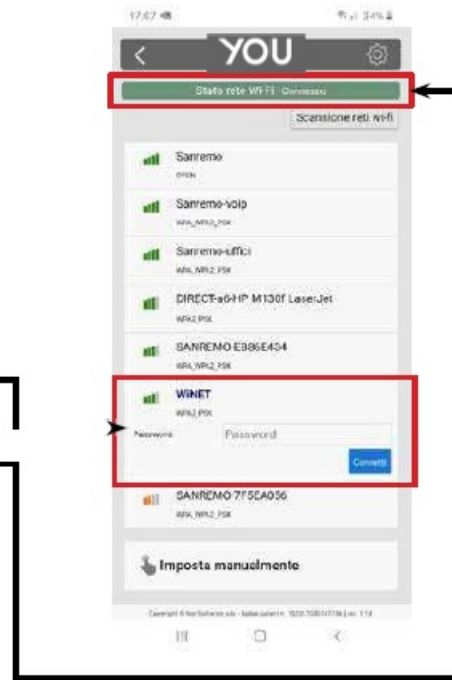

Communicate with WiFi Module in 3 different modes

Basically is possible to communicate with WiFi Module in 3 different modes:

1. Directly, POINT-TO-POINT using direct connection with mobile/table/PC and machine.
 - Is a local communication.
 - Communication is possible but WiFi module can't download it's own firmware updates (OTA function); WiFi status BAR is red (no connection to web).
 - Communication is still local; Encryption mode for this connection is WPA2.

Wi-Fi Status



2. Directly, POINT-TO-POINT using connection with mobile/table/PC and machine, but both connected to home router.

Advantage:

- Use directly the Sanremo Connector App without connecting your mobile to the machine as done in option #1.
- If router is connected to an active web connection, OTA firmware updates for the WiFi already works (green bar status) without creating a Cloud account.

Communication is still local; Encryption mode is an “open key” for the WiFi module; it's related to working mode set by the router used. For this type of connection, module support WPA/WPA2/WPA3.

Wi-Fi Status - Connected



3. With a CLOUD ACCOUNT; allow local communication and from everywhere. Encryption mode is an “open key” for the WiFi module; it’s related to working mode set by the router used. For this type of connection, module support WPA/WPA2/WPA3.



CREATING A CLOUD ACCOUNT

ENTER THE SANREMO CONNECTOR APP AND PRESS THE “ACCESS CLOUD” BUTTON.

ENTER THE SANREMO CONNECTOR APP AND PRESS THE “ACCESS CLOUD” BUTTON.

Sanremo

RIPETI RICERCA

SCANSIONA QR CODE

ACCEDI AL CLOUD

Nome utente
Username

Password
Password

☐ Ricordami [Recupera password](#)

Accedi

Non sei ancora registrato? [Registra ora il tuo account](#)

☒ **Acconsento al trattamento dei miei dati personali**

Registra

IF YOU HAVE NOT ALREADY CREATED AN ACCOUNT, YOU CAN CREATE ONE BY CONNECTING TO THE WEB APPLICATION AT [HTTPS://CLOUDWINET.IT](https://cloudwinet.it) AND CLICKING ON THE “REGISTER YOUR ACCOUNT NOW” LINK.

ENTER ALL YOUR DETAILS IN THE SPACES PROVIDED ON THE NEW ACCOUNT REGISTRATION PAGE.

TICK THE BOX FOR ACCEPTANCE OF THE PROCESSING OF PERSONAL DATA. WHEN YOU HAVE COMPLETED ENTERING ALL YOUR DETAILS, CLICK ON THE “REGISTER” BUTTON.

- IF THERE ARE NO ERRORS IN THE DETAILS YOU HAVE ENTERED, THE CLOUD SYSTEM WILL SEND YOU AN EMAIL WITH A LINK TO ACTIVATE THE ACCOUNT YOU HAVE JUST CREATED.
- OPEN THE PROGRAM THAT MANAGES YOUR E-MAIL AND THE MESSAGE RECEIVED, THEN CLICK ON THE “ACTIVATE” LINK.

- ACTIVATION OF THE ACCOUNT THROUGH THE LINK IN THE EMAIL WILL LOG YOU IN TO THE RESERVED AREA OF THE ACCOUNT.
- REGISTRATION OF A WI-FI DEVICE IS ONLY ALLOWED AFTER LOGGING IN TO THE CLOUD SYSTEM, USING YOUR PERSONAL LOGIN INFORMATION.
- THE WEB PAGE PROPOSED BY THE CLOUD SYSTEM, IMMEDIATELY AFTER LOGGING IN, CONTAINS THE LIST OF YOUR REGISTERED WI-FI DEVICES (EMPTY LIST IF NO DEVICE HAS BEEN REGISTERED BEFORE) AND A BUTTON ALLOWING THE REGISTRATION OF A NEW DEVICE.
- CLICK ON THE “REGISTER A NEW DEVICE” BUTTON.
- ENTER THE REQUIRED DATA SHOWN ON THE LABEL OF THE WI-FI DEVICE;
- CLICK ON THE “NEXT” BUTTON;

CLICK ON THE “REGISTER A NEW DEVICE” BUTTON.

ENTER THE REQUIRED DATA SHOWN ON THE LABEL OF THE WI-FI DEVICE;

CLICK ON THE “NEXT” BUTTON;

Registra un nuovo dispositivo

Step 1

Identificativo MAC:

Codice di registrazione:

Avanti

MAC: [redacted]
WPA: [redacted]
Reg Code: [redacted]
Fr. range: 2412+2484 MHz
5V---; 170 mA - max 1 W
SN: [redacted]
Net Software s.r.l.s

- ENTER THE SERIAL NUMBER OF THE MACHINE TO WHICH THE WI-FI MODULE IS CONNECTED.
- NO CHECK IS MADE ON THE VERIFICATION OF THE SERIAL NUMBER, BUT IT COULD BE USEFUL IN CASE OF REMOTE ASSISTANCE.
- IN THE NAME FIELD ENTER A NAME OF YOUR CHOICE TO BE ASSIGNED TO THE PRODUCT CONNECTED ONLINE. FOLLOW THE STEPS INDICATED UNTIL REGISTRATION IS COMPLETE. COMPLETE STEP 3 BY
- ENTERING YOUR DETAILS AND CLICK ON NEXT
- THE WINDOW AT THE SIDE DISPLAYS THE DEVICES ASSOCIATED WITH THE ACCOUNT JUST CREATED; EACH ACCOUNT CAN ALSO BE ASSOCIATED WITH SEVERAL MACHINES ACCESSIBLE VIA THE SAME APP.



CLICK ON THE ICON TO ACCESS ONE OF THEM AND GO DIRECTLY TO THE SANREMO CONNECTOR APP

Registra un nuovo dispositivo

Step 2

Matricola:

▶ 123456789

Nome associato al dispositivo:

▶ Demo

Nome associato al prodotto che verrà mostrato nell'elenco dei propri dispositivi

Avanti

sanremo.cloudwinet.it/Application/Use

SANREMO
COFFEE MACHINES

I miei dispositivi

Cube_lab

MAC: E09806B12794

Fw. Ver.: offline

WPA: ADFF1243

Codice di registrazione: 109984

Codice assistenza: 000000

Matricola: 000452

ID: 000452

Registra un nuovo dispositivo

THE ICON HAS A WHITE BACKGROUND WHEN THE MACHINE IS NOT ACCESSIBLE (e.g. HOME WI-FI MODULE OFF OR NOT WORKING OR MACHINE NOT PLUGGED IN), A GREEN BACKGROUND WHEN THE MACHINE IS CONNECTED TO THE WI-FI NETWORK.

ATTENTION:

A MULTIPLE NUMBER OF USERS CAN BE CONNECTED AT THE SAME TIME TO THE MACHINE BUT MUST BE USED THE SAME ACCOUNT. MACHINE CAN'T BE ASSOCIATED TO DIFFERENT USERS' ACCOUNT.

TROUBLESHOOTING

Connection with your router does not work? Double check the password used to connect to your router; password has to be:

- Minimum length of 8 characters, max 64.
- Alphanumeric
- Can use these special characters

`^[a-zA-Z0-9_!\-\'#\$. \%& \@\!+|=|<|>|*|{|}|~|\^|\`|\£|?]{8,48}$`

Homepage

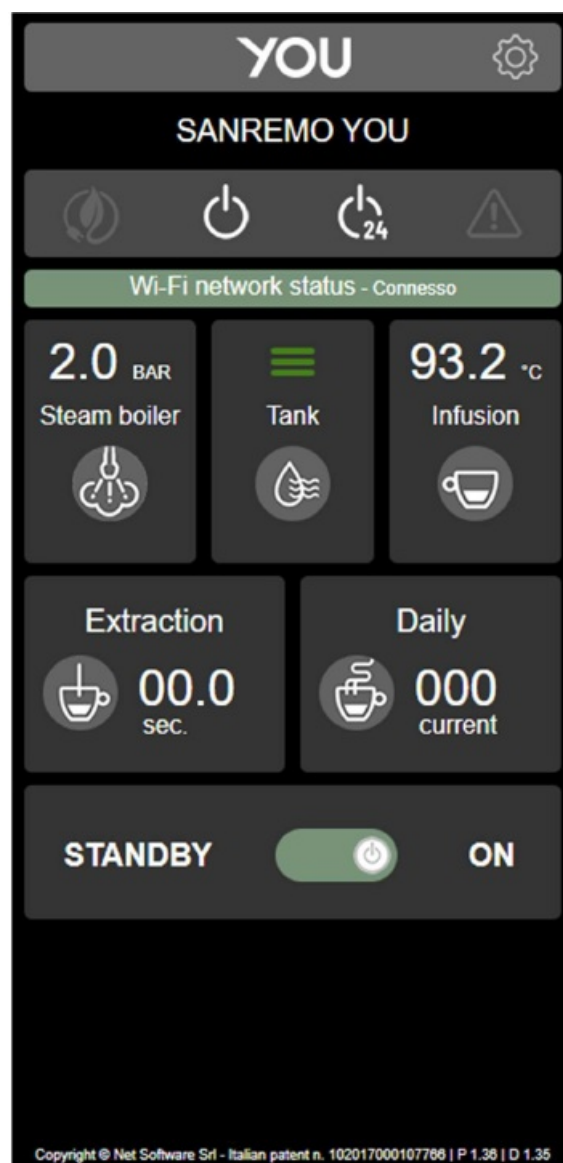

Menu

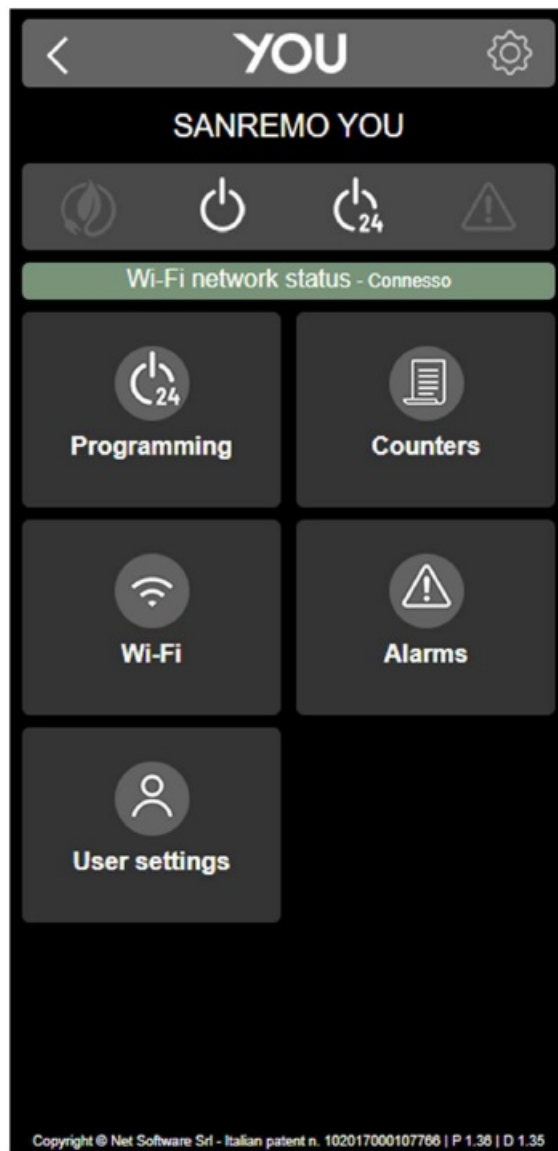

SANREMO S.R.L.,

Via Bortolan 52, 301050 Vascon di Carbonera (TV), ITALIA, tel +39 0422 448900, fax +39 0422 448935, p.iva /c.f. 03239750262, www.sanremomachines.com info@sanremomachines.com.

Documents / Resources

	<p>SANREMO CONNECTED_Web App [pdf] User Manual CONNECTED_Web, App, CONNECTED_Web App</p>
---	--

References

- [Home - Sanremo Coffee Machines](#)
- [WiNET IoT Dashboard](#)