



SanJie B0BRQ9TPZR WiFi Smart Wireless Caregiver Pager Call Button System Instruction Manual

[Home](#) » [SanJie](#) » SanJie B0BRQ9TPZR WiFi Smart Wireless Caregiver Pager Call Button System Instruction Manual 

SanJie B0BRQ9TPZR WiFi Smart Wireless Caregiver Pager Call Button System Instruction Manual



Contents

- 1 Appearance Introduction
- 2 BUTTON
- 3 Power On
- 4 How to Pair the SOS Button with Receiver
- 5 Test If The Pairing Is Successful.
- 6 Connect with Mobile App
- 7 Connect the Receiver to APP
- 8 Connect the SOS Button to APP
- 9 APP Notification Setting
- 10 APP Operation
 - 10.1 Steps to Remove Alarm
 - 10.2 Mutiple People Sharing
- 11 Steps to Set Alarm Ringtone
- 12 Steps to Set Alarm Time
- 13 Steps to Set Alarm Volume
- 14 Steps to Set Brightness
- 15 Delete SOS Button
- 16 Clear all accessories
- 17 Unbind mobile APP
- 18 Installation
 - 18.1 Receiver Installation
- 19 SOS Button Battery Change
- 20 Notes
- 21 Specification
- 22 Q&A
- 23 Q: Does the Recever need to plug in USB power cable all the time?
- 24 What f the SOS Button cannot make the Receiver alarm?
- 25 What if the Receiver cannot connect to smartphone?
- 26 can I take the SOS Button outside?
 - 26.1 Attention
 - 26.2 After sales service
 - 26.3 Documents / Resources
 - 26.4 Related Posts

Appearance Introduction

Receiver

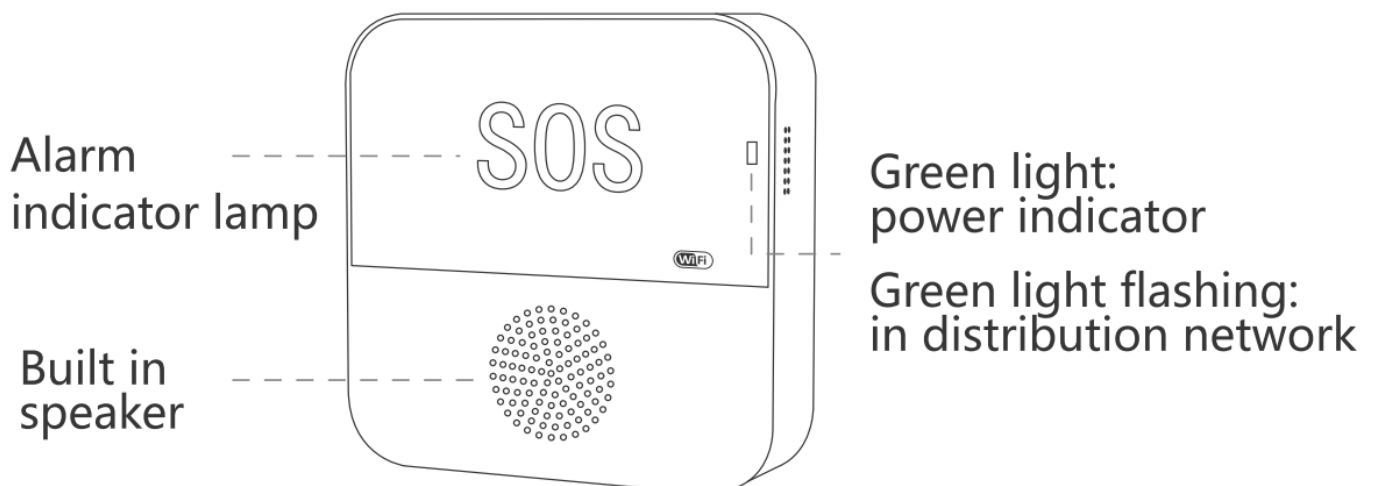

A Short press for 1 second—Pairing with SOS Button.

B Long press for 6 seconds—distribution network (Pairing with Smartphone P APP)

Long press for 6 seconds--distribution network
(Pairing with Smartphone APP)

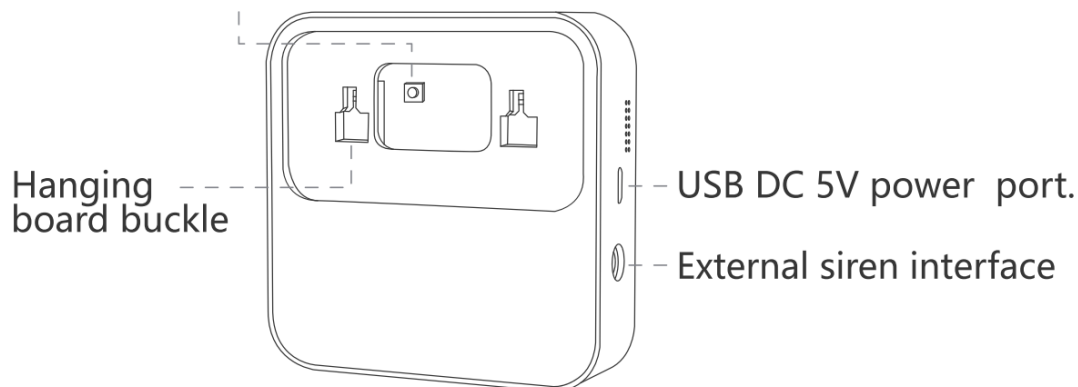

BUTTON

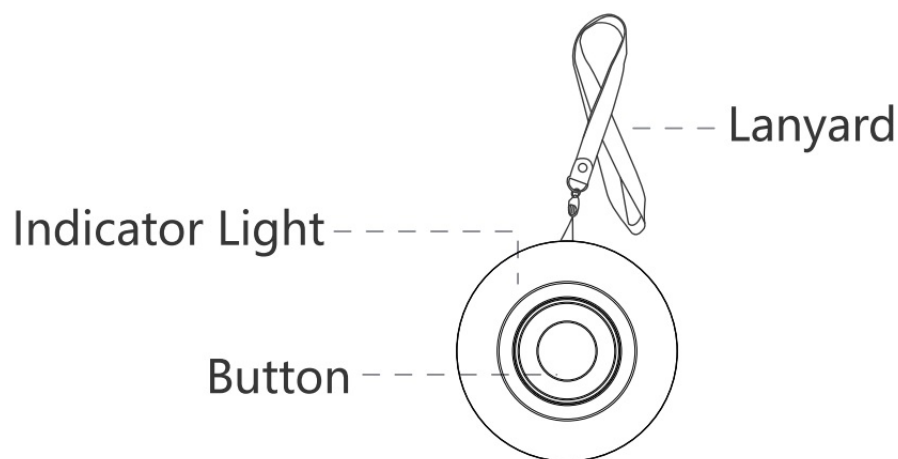

Power On

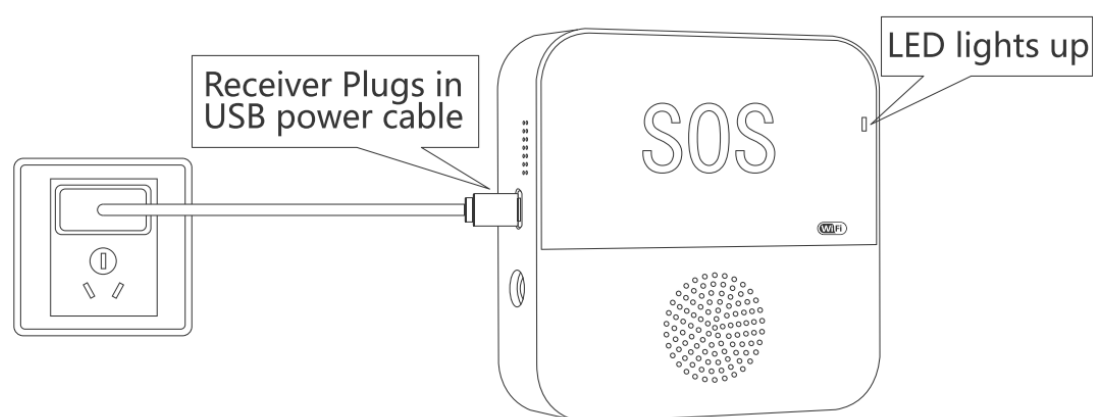

Receiver Pairs with SOS Button

! SOS Button before leaving factory, QC needs it with Receiver to test whether it is valid, so if the Button has been paired, it can be used. If the SOS Button doesn't work, please pair the SOS Button with Receiver.

How to Pair the SOS Button with Receiver

1. Short press the key in the back of the Receiver, and the Receiver will *beep* and last 15 seconds.

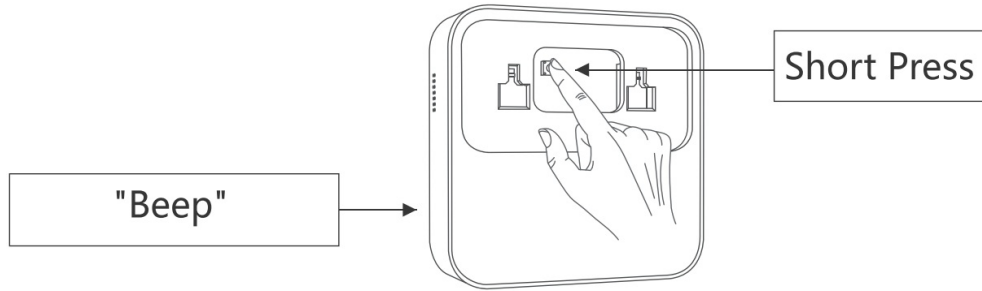

2. Short press the SOS Button, and the Receiver will stop "beep" after successful pairing.



Test If The Pairing Is Successful.

1. SOS Button needs to be used within 230ft/70m range of the Receiver.

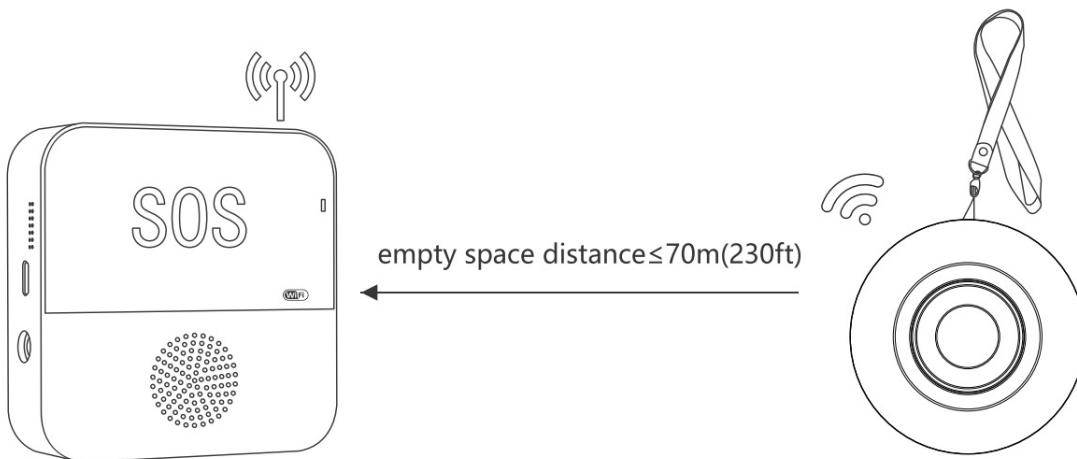
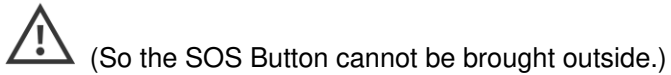

2. Press the SOS Button



3. Receiver Alarms

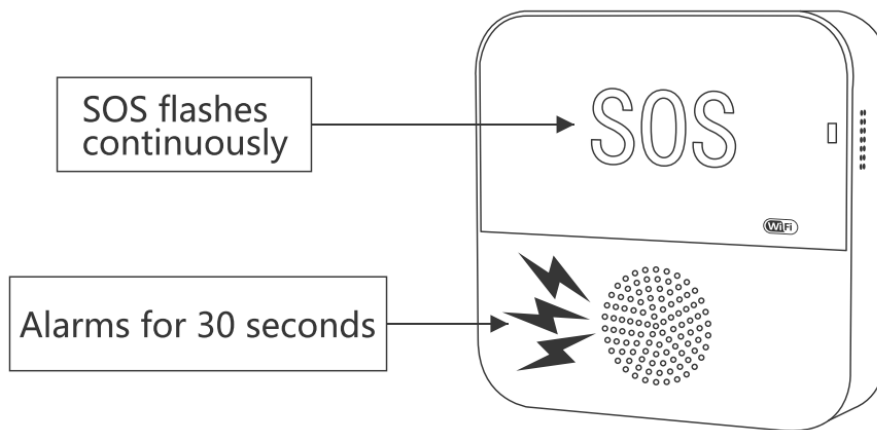

Connect with Mobile App

Tuya Smart



Smart Life



- Scan the QR code to download the APP.
- Please go to the application market to search for “Tuya Smart” or “Smart Life”.

Notes On Distribution Network

Wi-fi Frequency

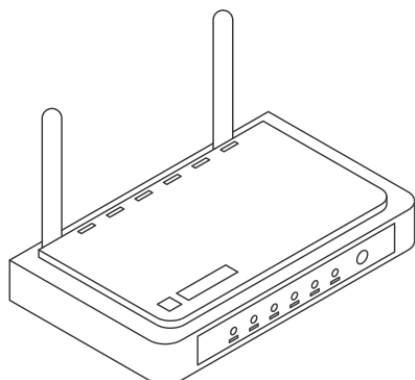

support [EZ11H
No Support [EiE3

The distance between the Receiver and WiFi Signal needs to be less than 20m/66ft (the closer the better)

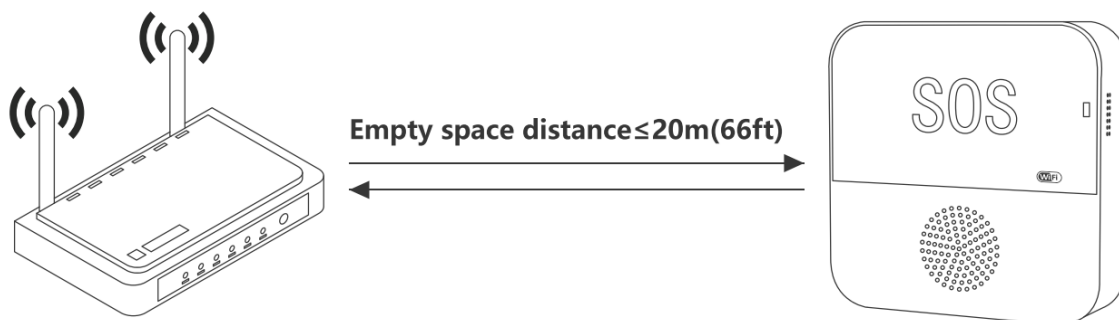

The distance varies with the environment. /A If the Receiver is too far from the router, it will not be able to connect to the smartphone.

Connect the Receiver to APP



Both APPs are similar in use, just choose one of them

1. Cell phone connected to Wii24GHz WirFi), and turn on Bluetooth

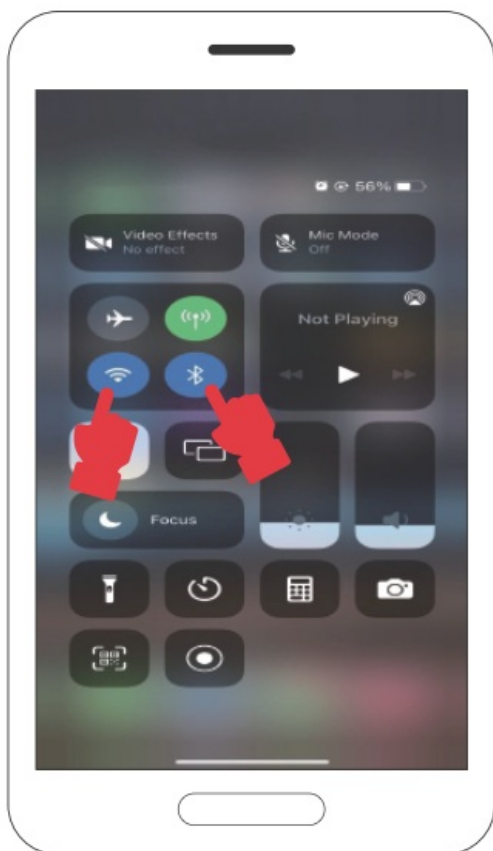

a Long press the key in the back of the Receiver for 6 seconds to enter distribution network.

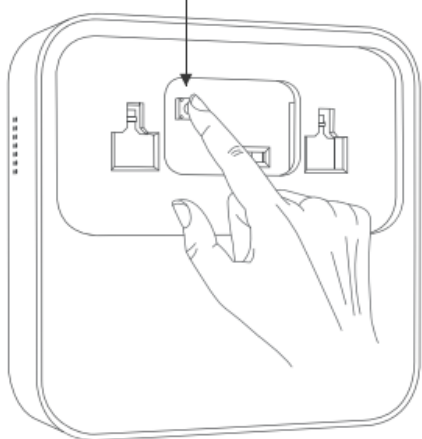

b The green light flashes continuously.

- 2.
3. Open APP, click *Add Device*

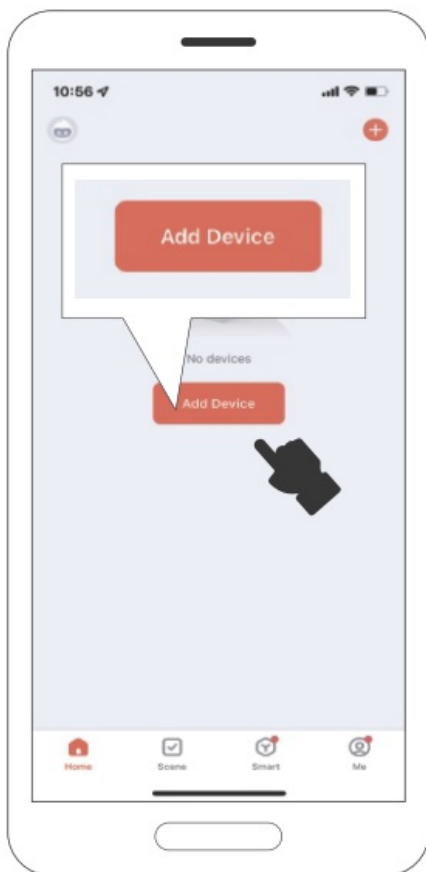

4. Click *Add” after the device is automatically discovered.

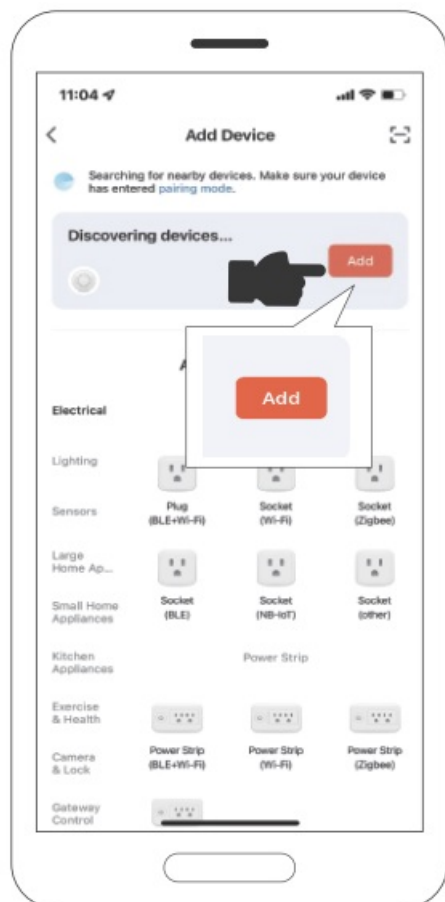

5. Confirm WiFi's name and password, and click “Next”

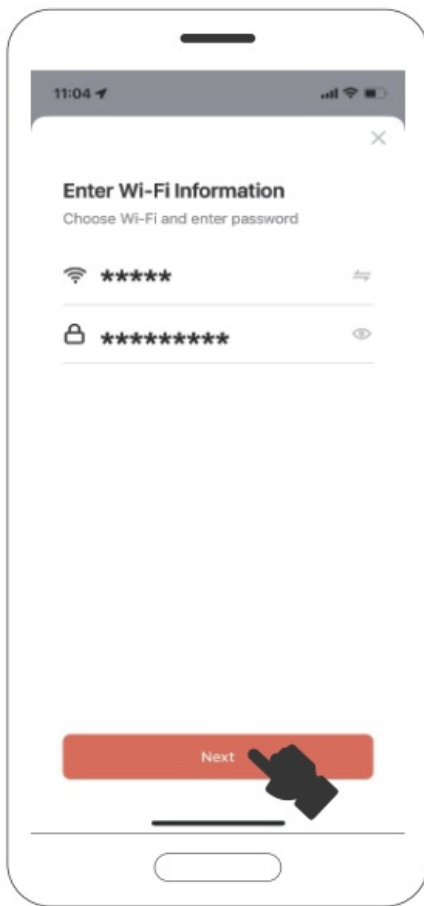

6. Wait for a successful connection.

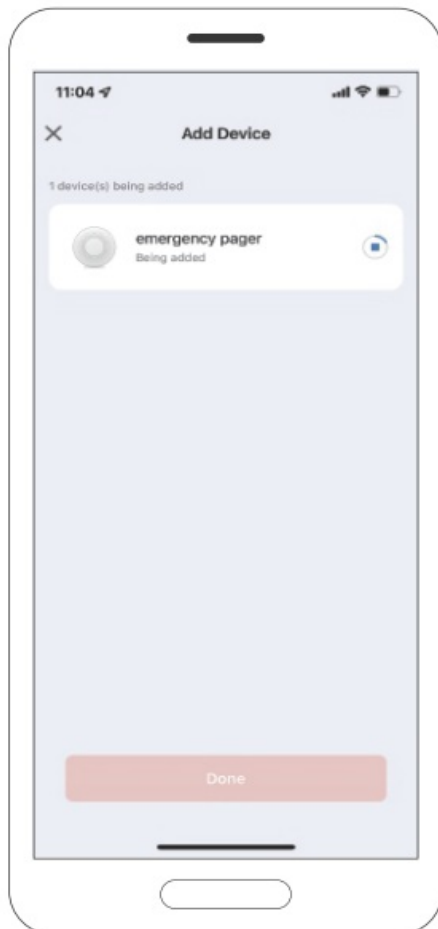

7. Click "Done".

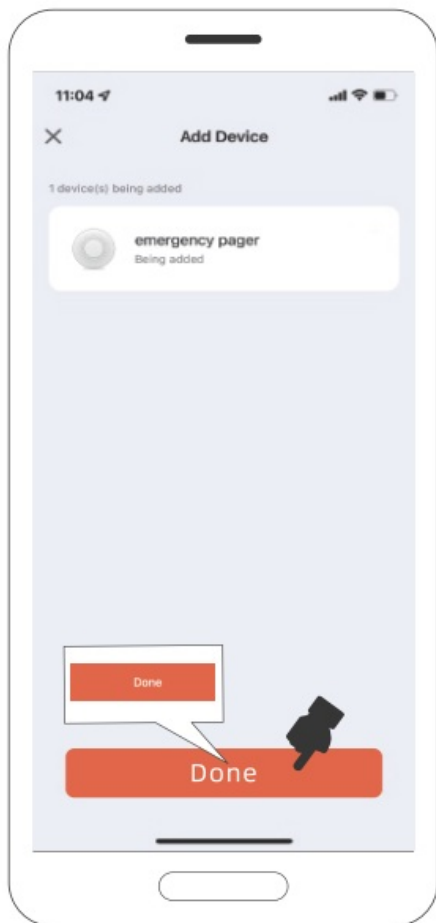

8. Receiver's page in the APP.

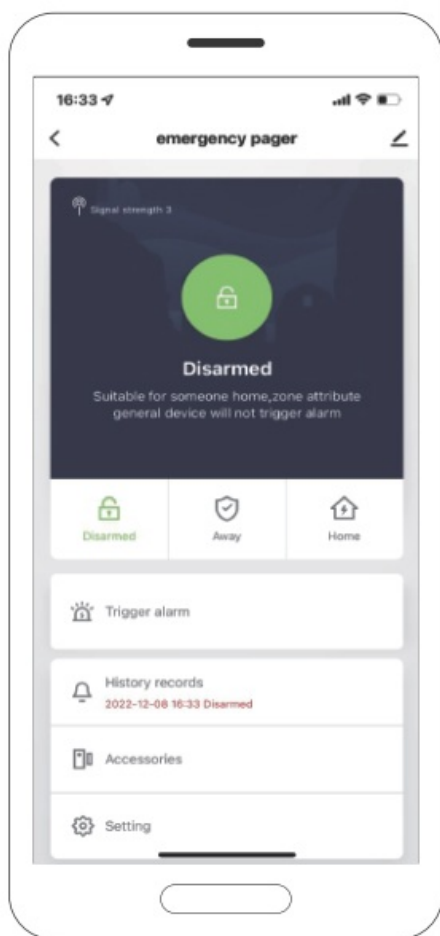

Connect the SOS Button to APP

1. At the bottom of the Receiver's page in the APP, Click *Accessories".

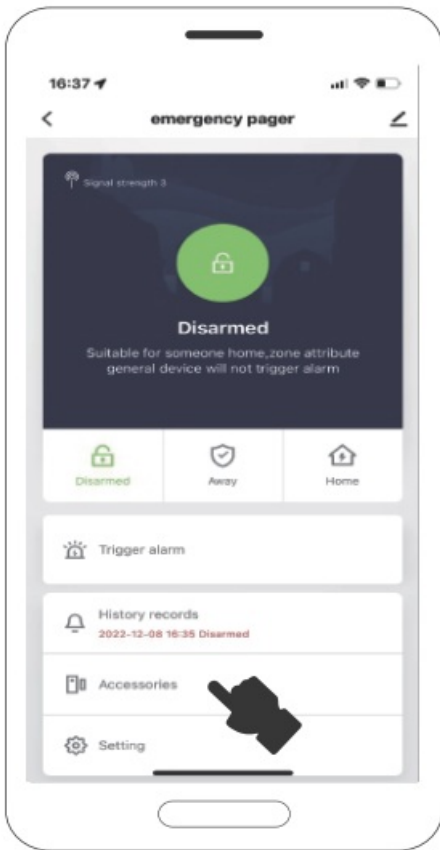

2. Click"+“in the upper right corner.

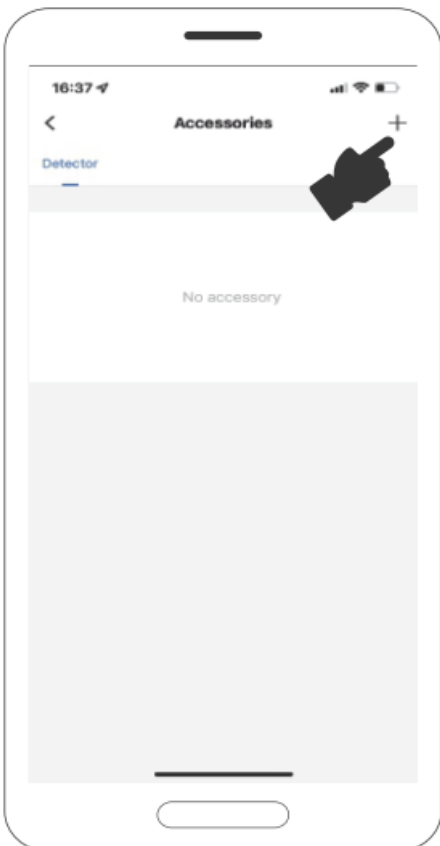

3. After the Receiver is "beep", please short press the \$8% button.

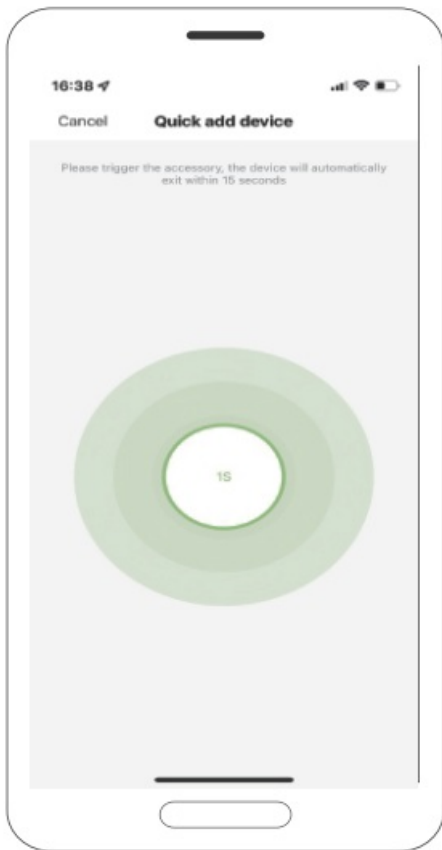

4. Wait for a successful connection, click “Confirm”.



5. side to the Left.

6. click delete

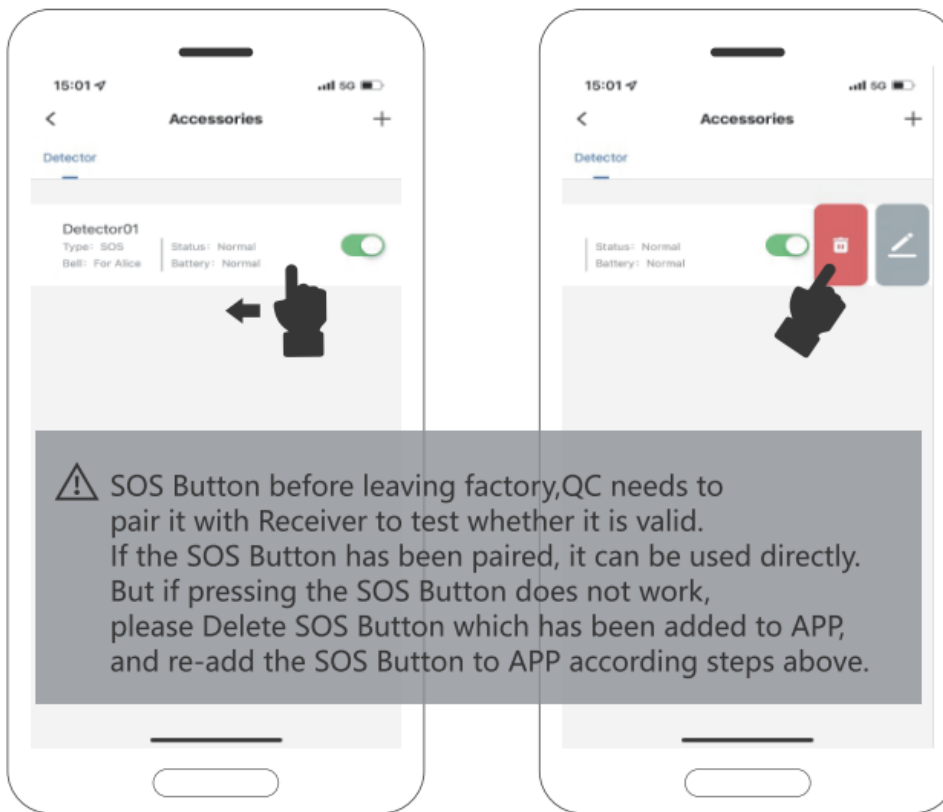

APP Notification Setting

1. Click Me and click  in the upper right corner.

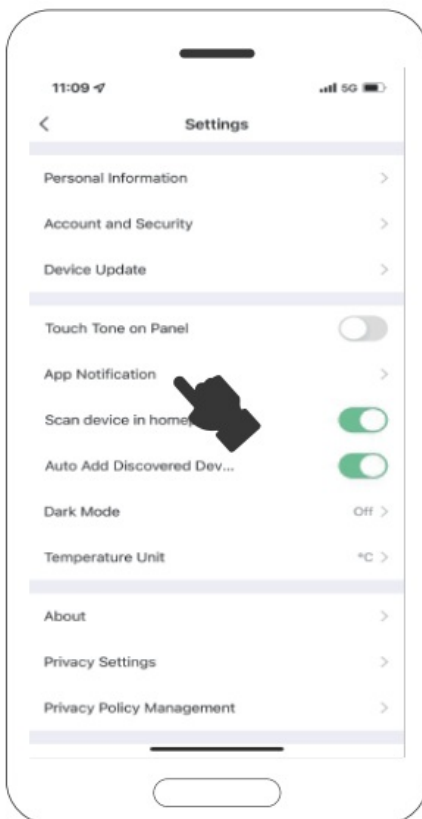

2. Click App Notification.

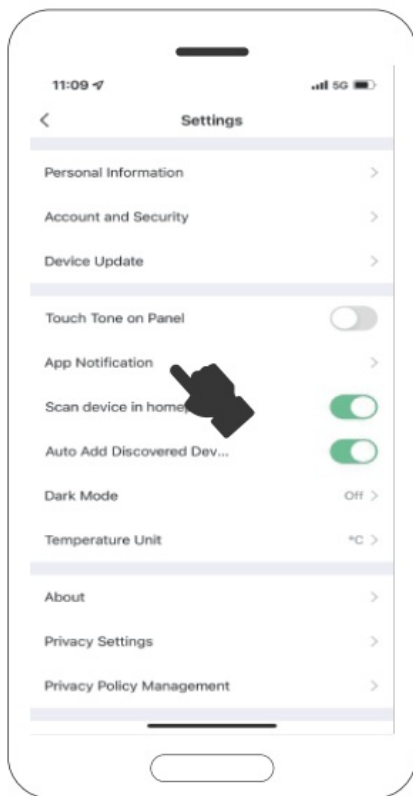

3. Click “Notifcatons”.

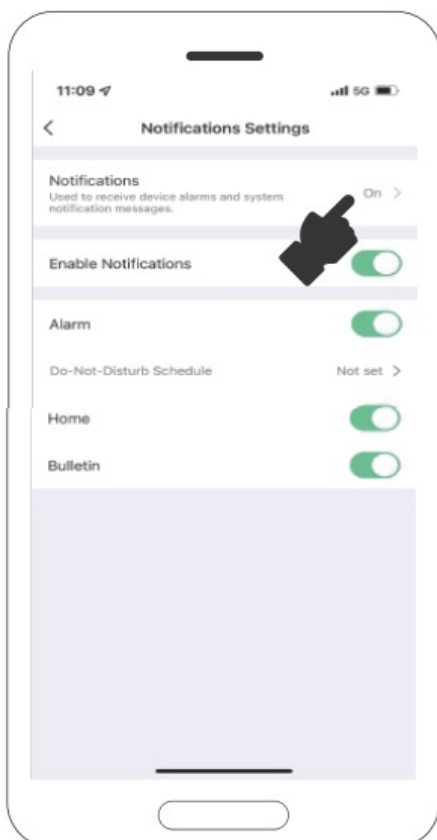

4. Turn on Bluetooth and Local Network, and i “Notincations™-

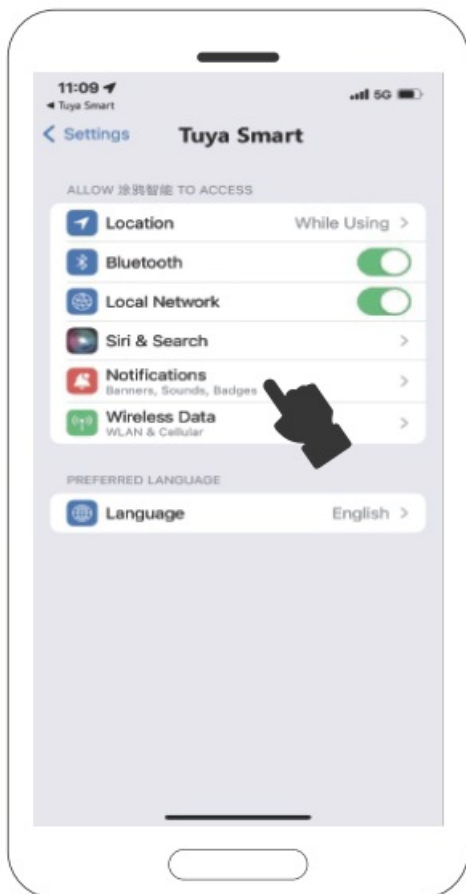

5. Tumon "Allow Notiicatoms", "Sounds" ne-Badges'. and choase Alerts ways you like

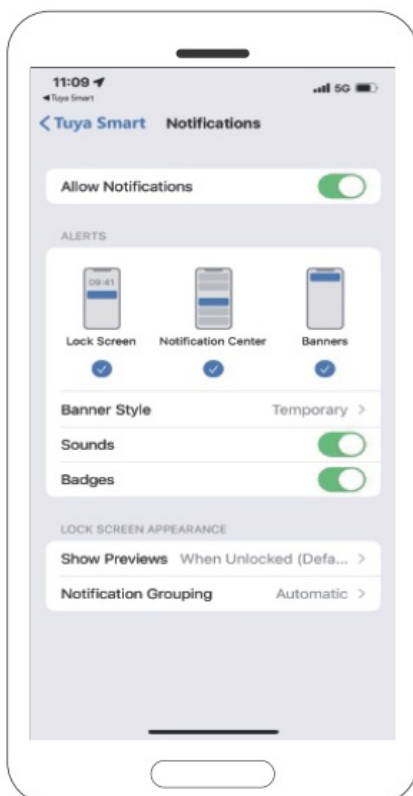

If your phone is in Silent mode, your phone will not ring alert when the SOS button is pressed. So you need to turn on Ring mode on your phone so that your phone have a ring alert when receive alert.

APP Operation

Steps to Remove Alarm

1. Press SOS Button



2. Receiver Alarms

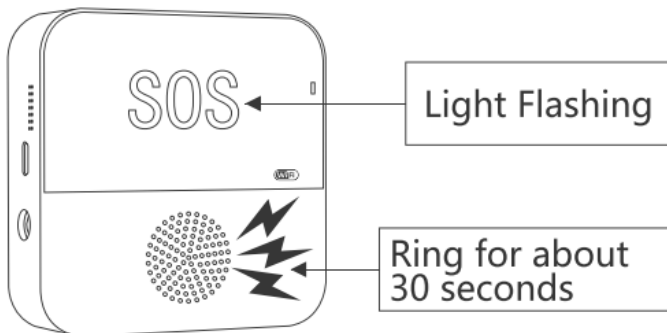

3. Click "Alarm remove"

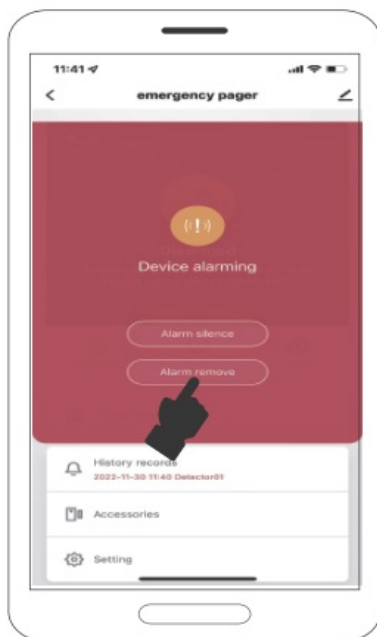

Mutiple People Sharing

1. Click "  " on the upper right corner of the Receiver's page in the APP.

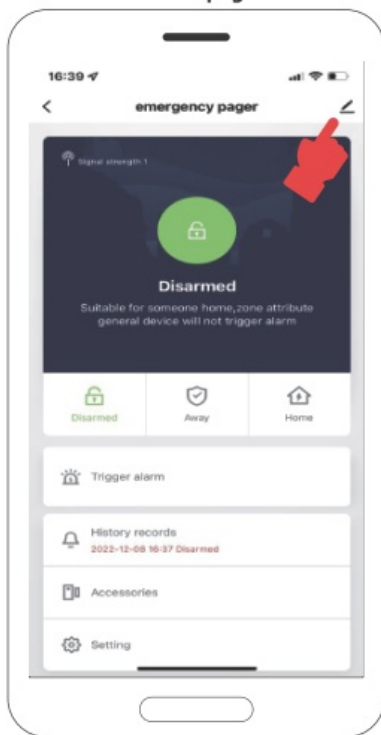

2. Click "Share (@Click" Device ice"

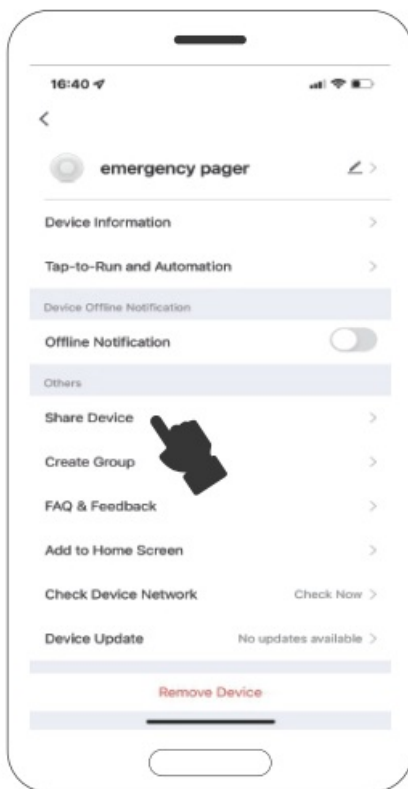

3. Click "Add Sharing"

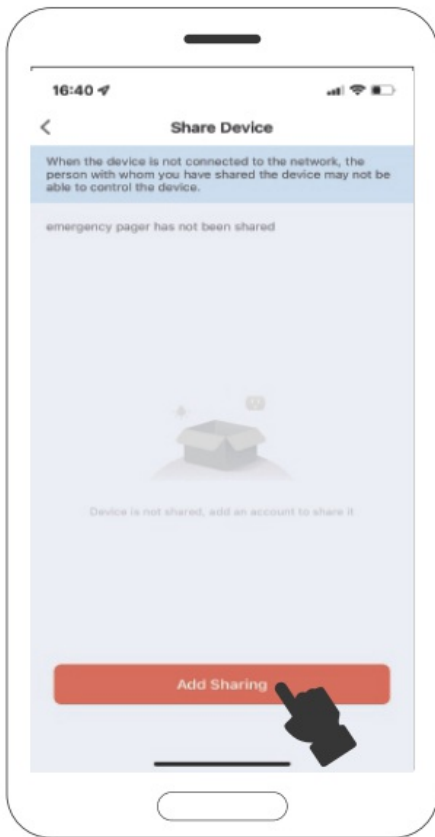

4. Select sharing ways

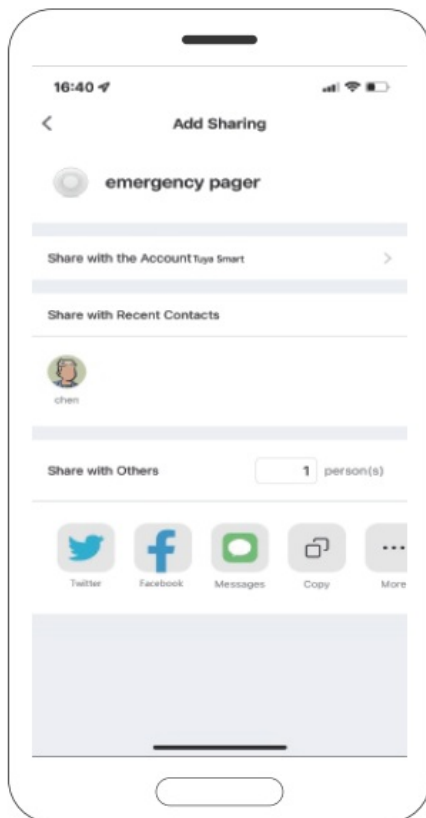

Steps to Set Alarm Ringtone

1. At the bottom of the receiver 's page in the APP click Accessories.

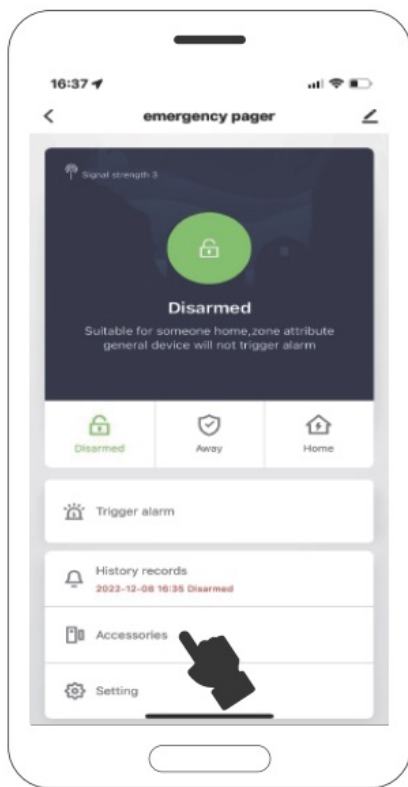

2. Click "Dectector01"

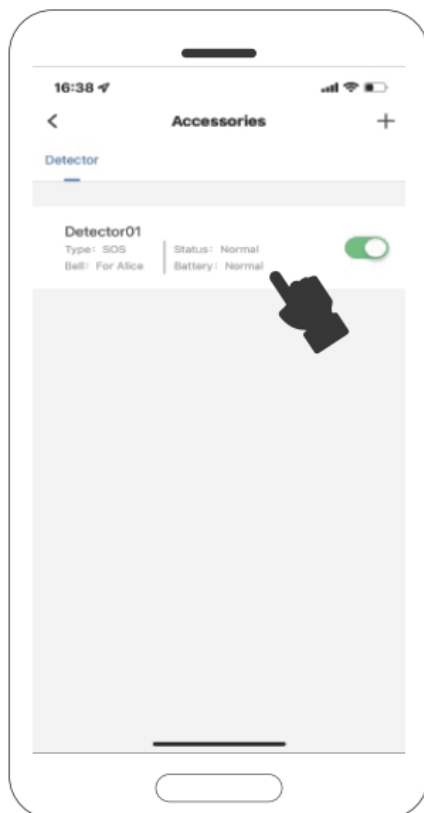

3. Click "alarm ringtone".

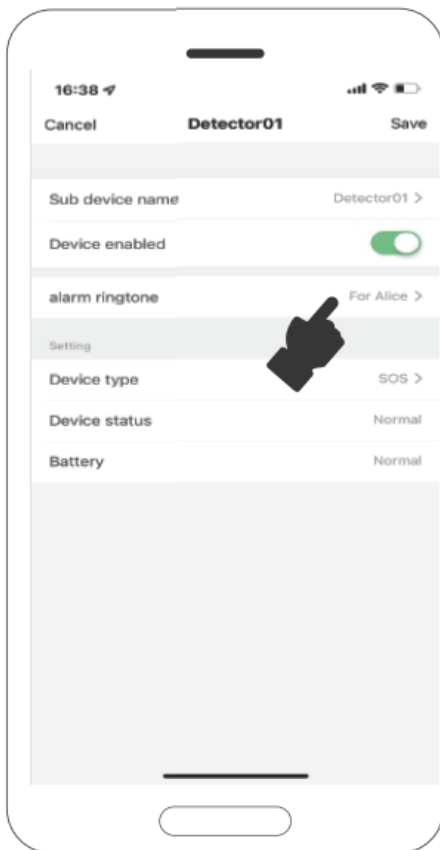

4. Choose your favorite ringtone

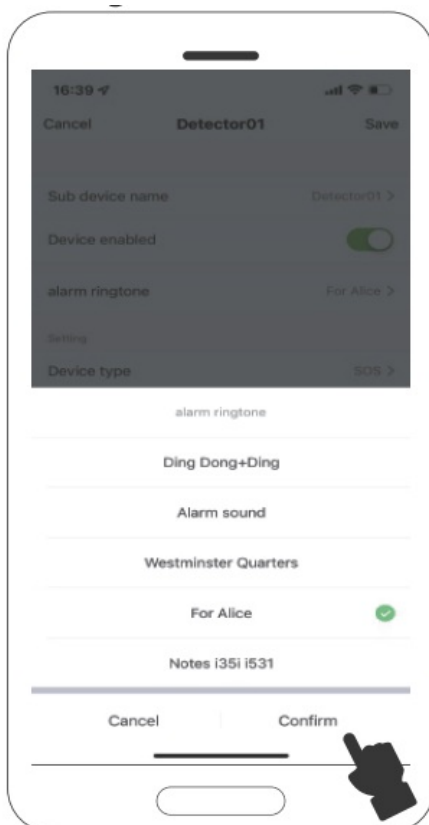

5. Click "Save"

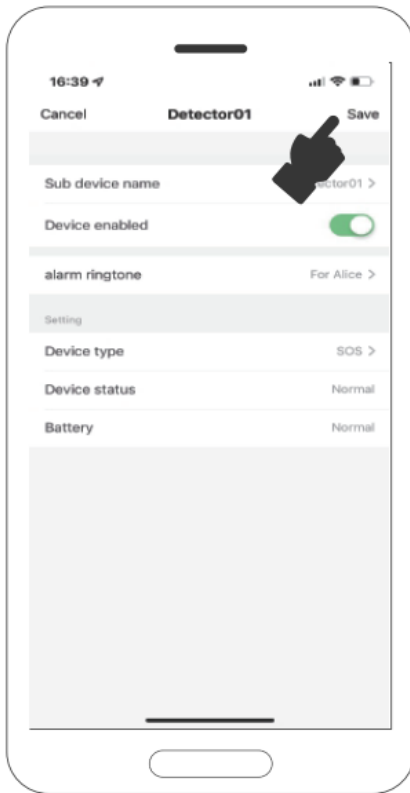

Steps to Set Alarm Time

1. At the bottom of the Receiver's page in the APP Click Setting.

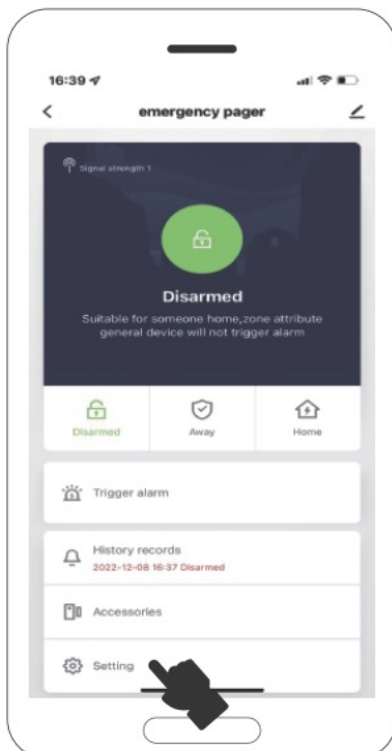

2. Click "Alarm time".

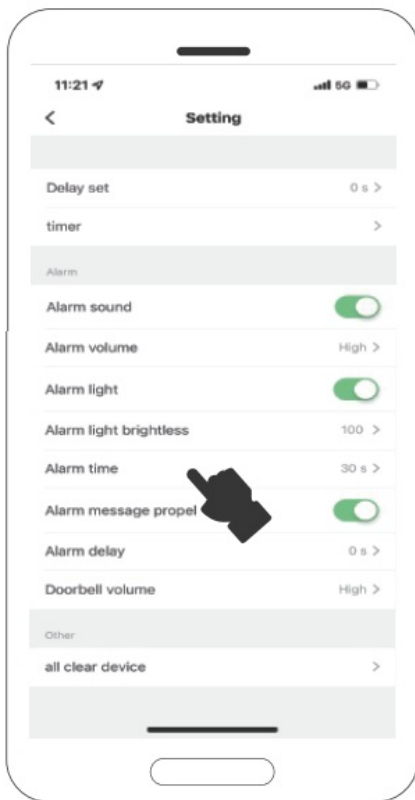

3. Choose the alarm duration according to your needs and click Confirm.

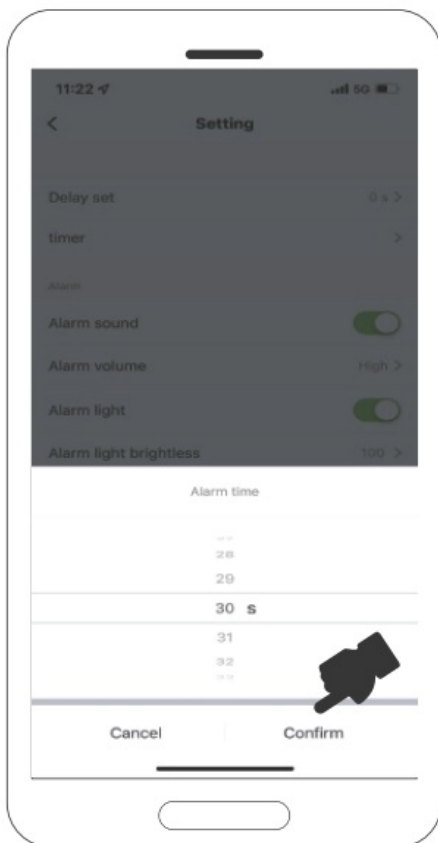

Steps to Set Alarm Volume

1. At the bottom of the Receiver's page in the APP Click Setting.

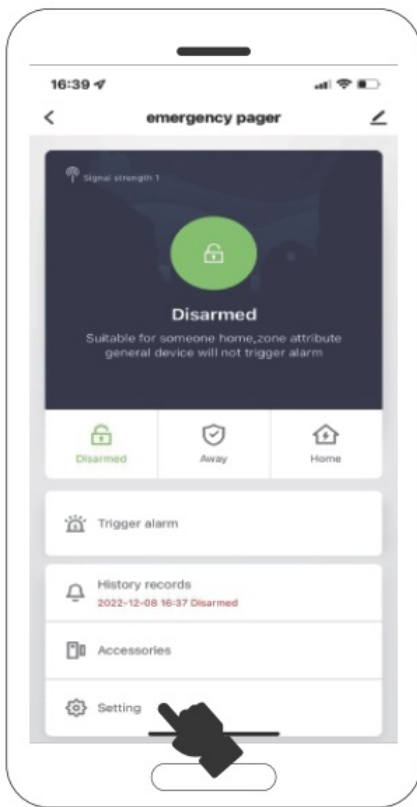

2. click "Alarm volume".

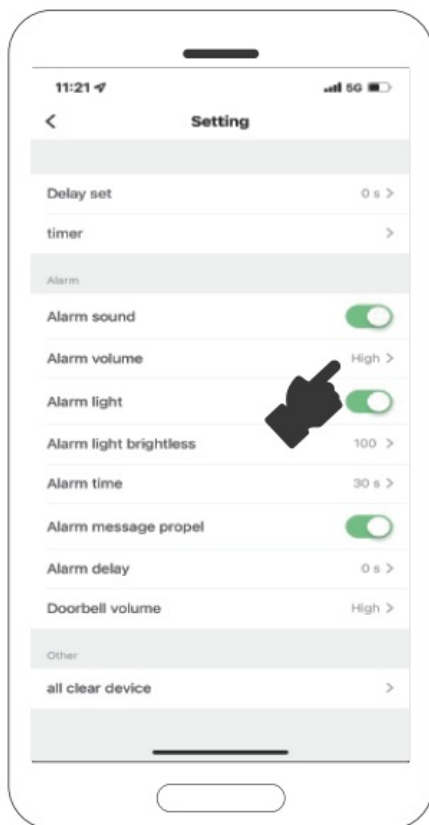

3. Choose the alarm volume level according to your needs and clicks confirm.

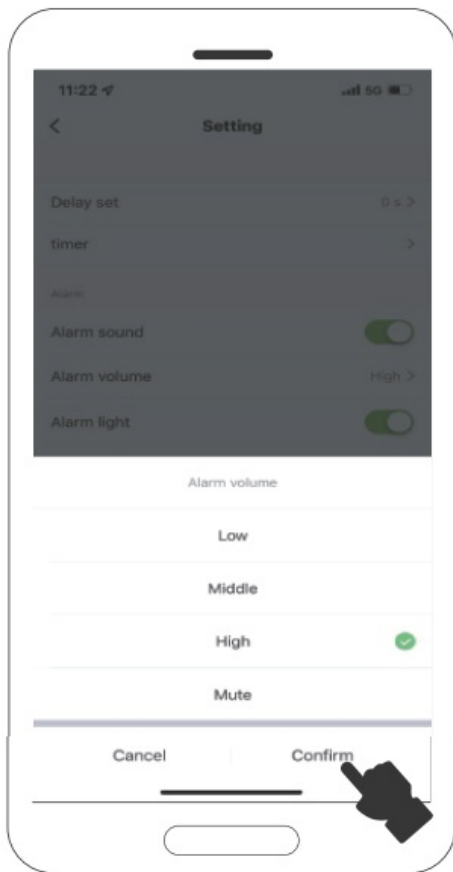

Steps to Set Brightness

1. At the bottom of the Receiver's page in the APP Click Setting.

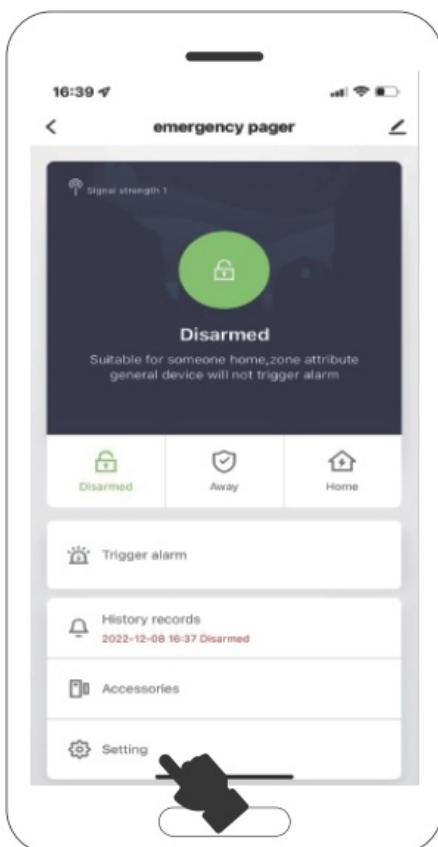

2. Click Alarm Light Brightness.

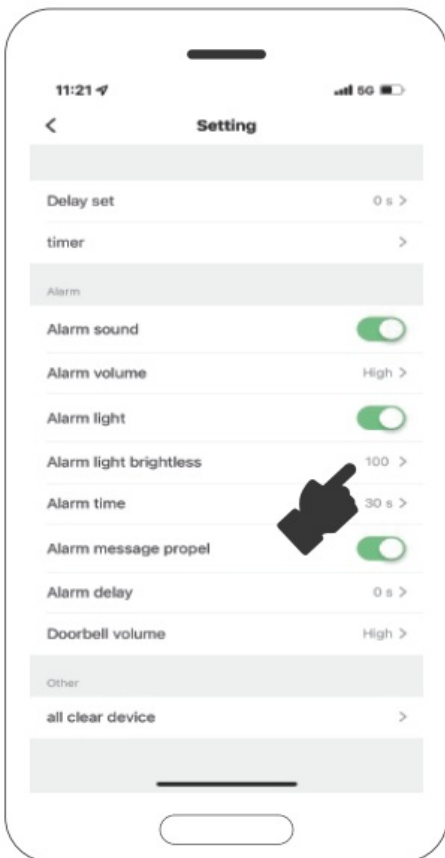

3. Choose the brightness level according to your needs, and check Confirm.

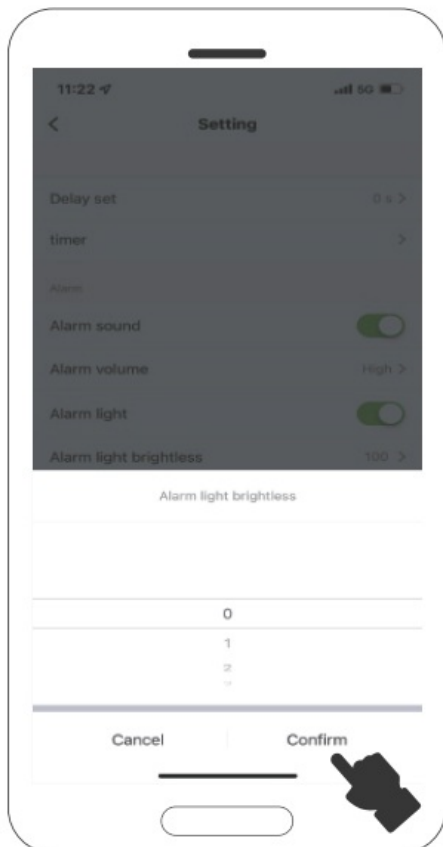

Delete SOS Button

1. At the bottom of the Receiver's page in the APP Click Accessories.

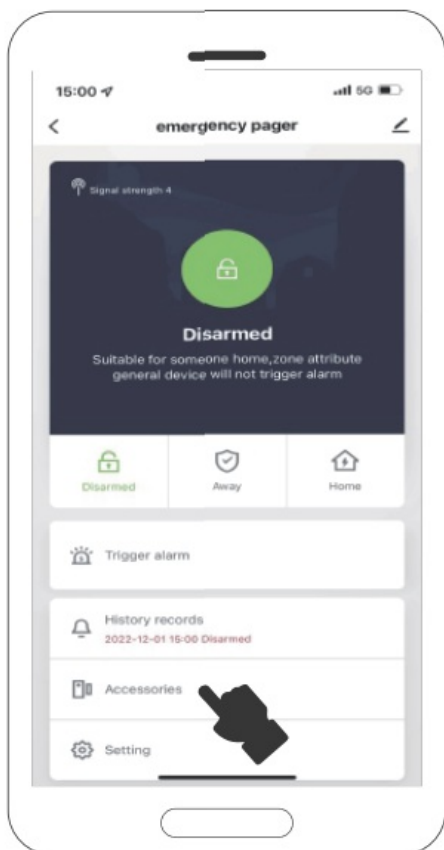

2. Slide to the left.

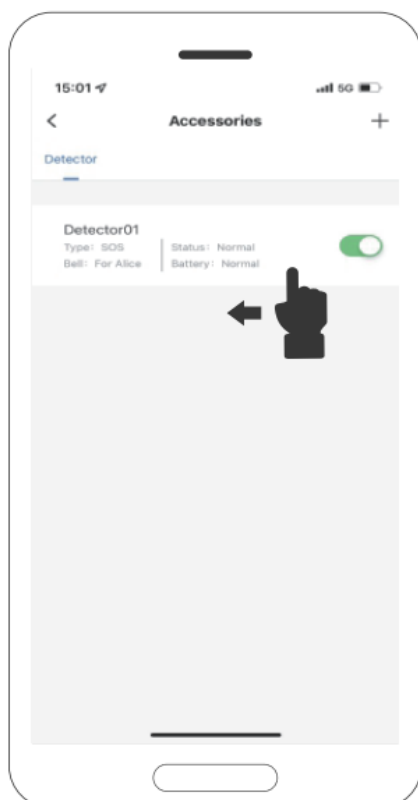

3. Click Delete.

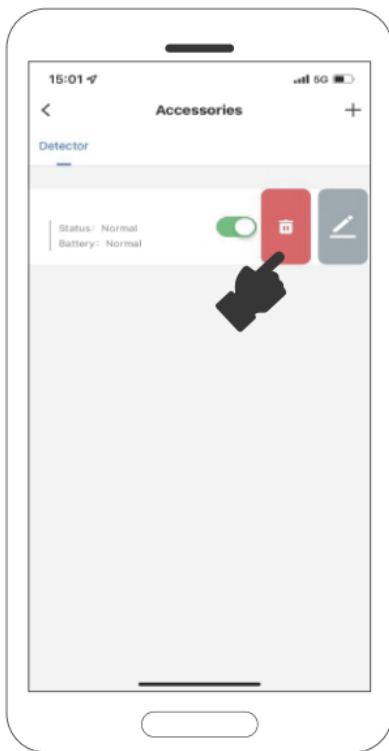

4. Click “Confirm”

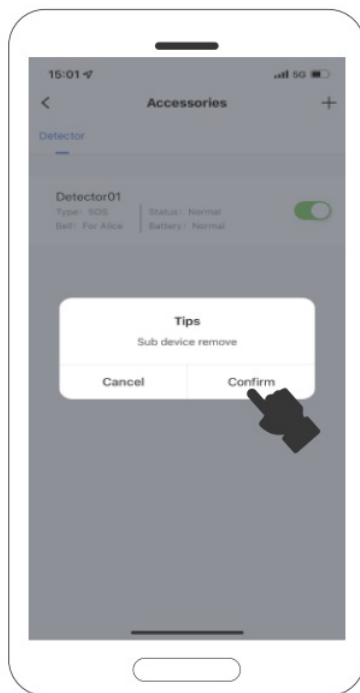

Clear all accessories

1. At the bottom of the Receiver's page in the APP Click Setting.

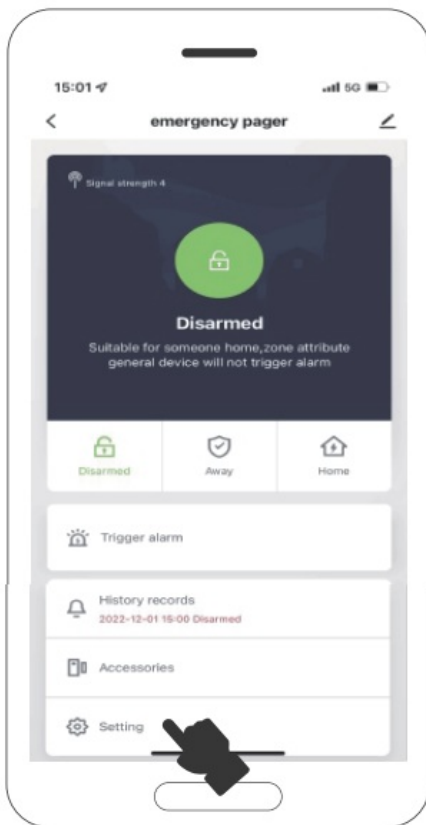

2. Click All clear device.

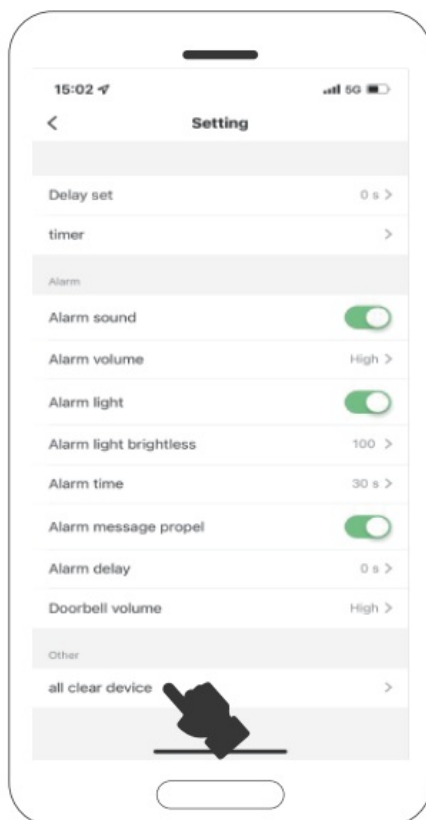

3. click“ Confirm”

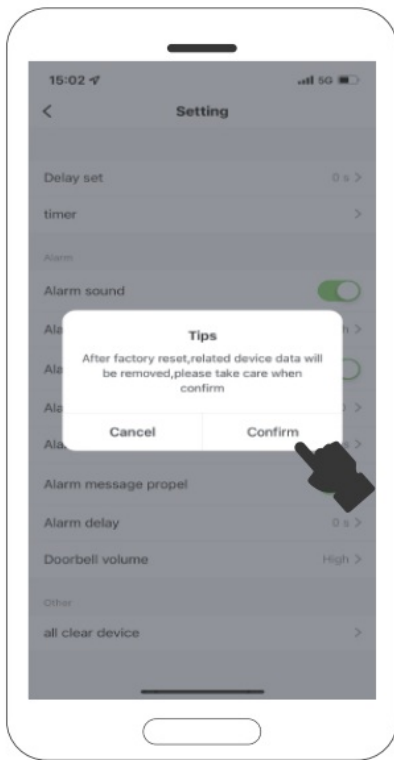

Unbind mobile APP

1. Click on the upper right corner of the receiver's page in the APP

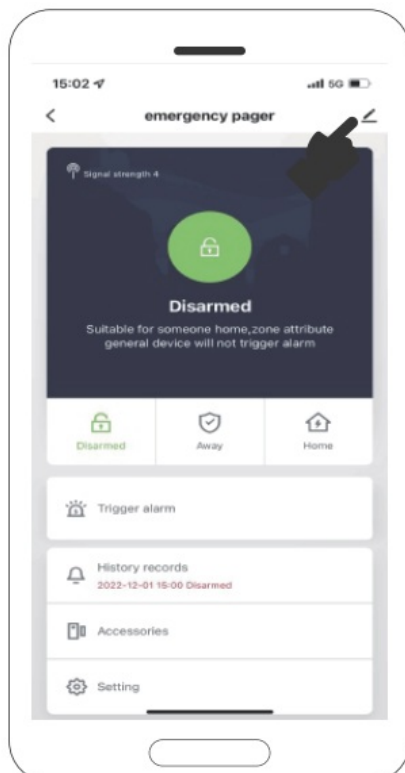

2. click "Remove Device".

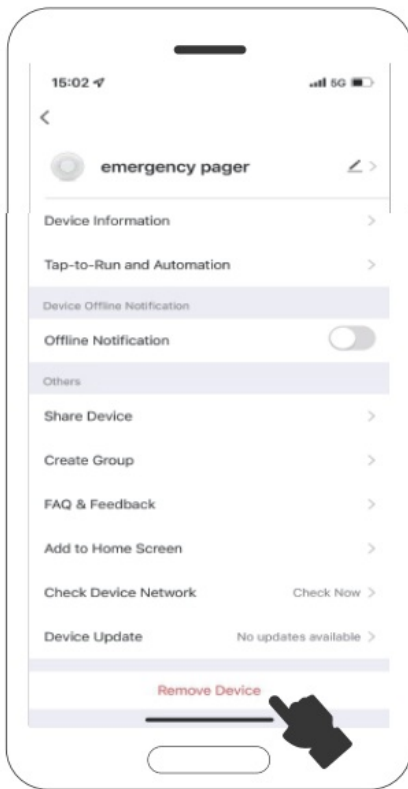

Installation

Receiver Installation

1. Installation Distance

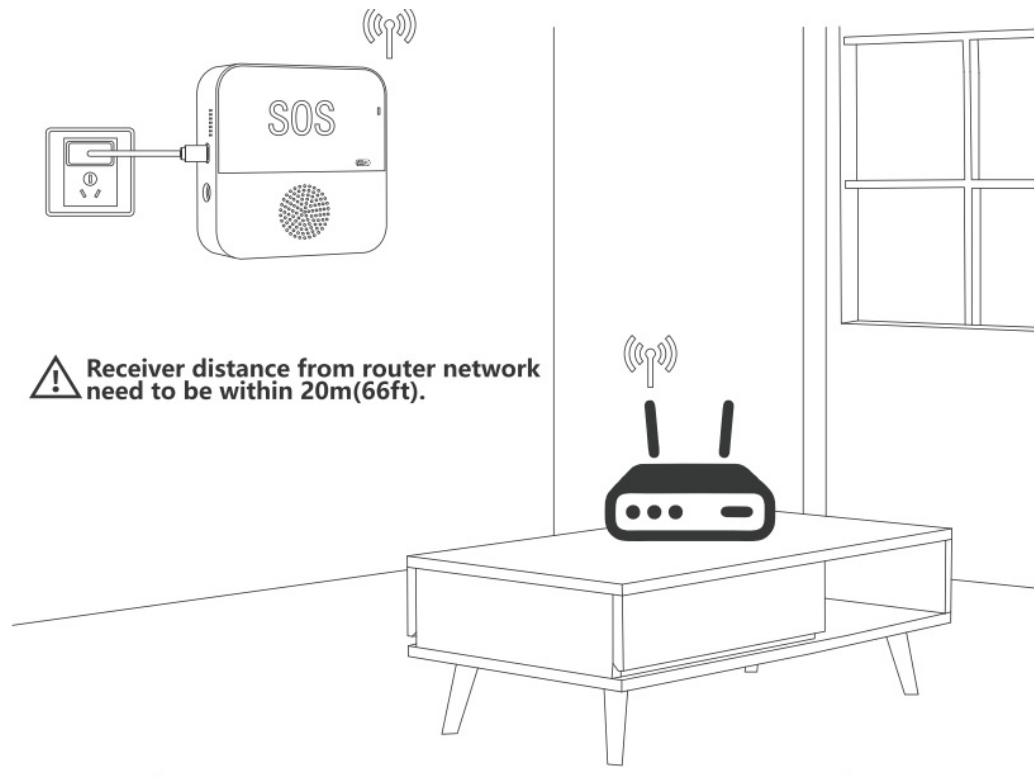

! AP' Function can not be used if the Receiver Was not connected with AP via WiFL

2. 2 ways to place

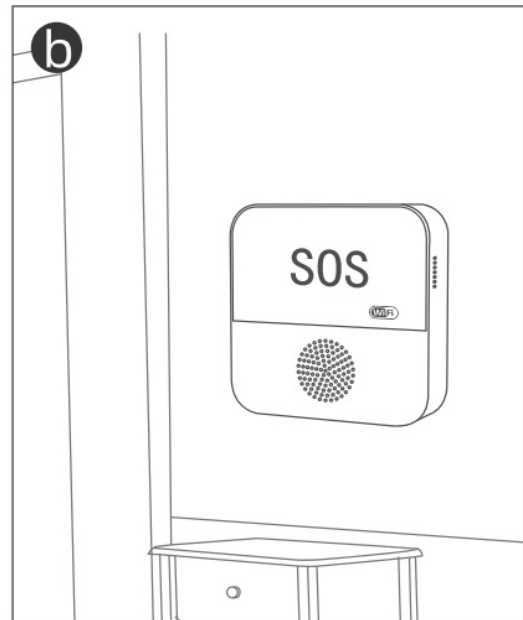

3. Wall-mounted installation steps

A Mark the wall with 2 mountin holes locations, and drill 2 wall plugs in 2 holes

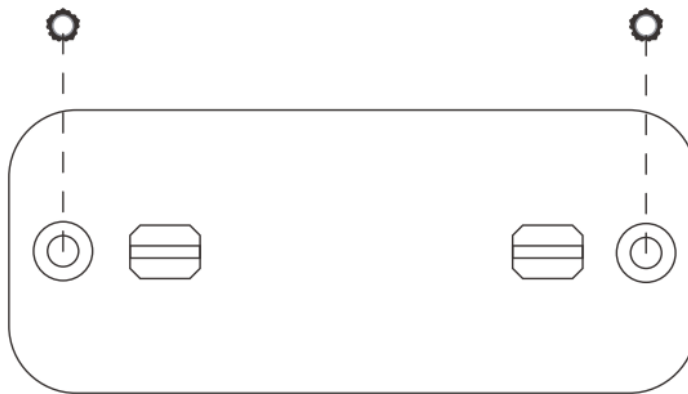

B Use a Phillips screwdriver to twist in 2 screws in 2 holes in clockwise direction

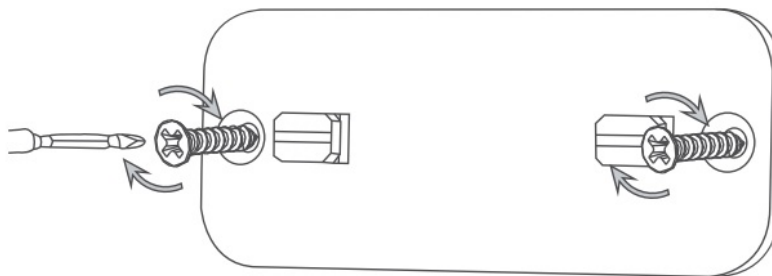

C Turn down the Receiver corresponding to the hanging plate Buckle.

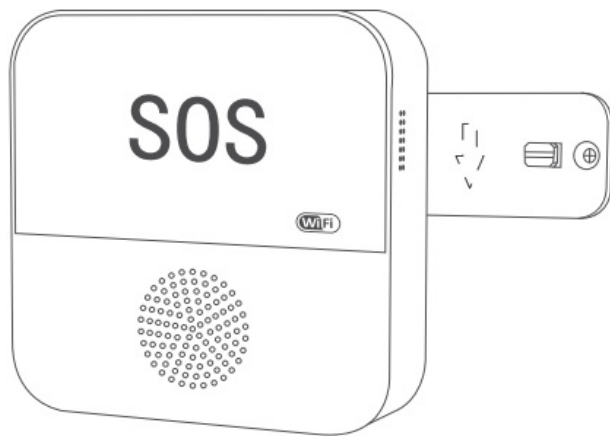

D Receiver plugs in USB power cable.

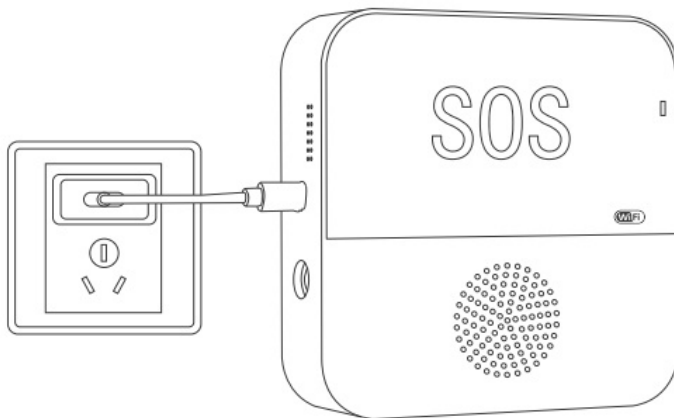

SOS Button Battery Change



Phone Alert

You need to open the notification switch on TUYA APP and your phone settings so that your phone can receive the alarm message and sound the alert.

Notes

1. The distance between the Receiver and WiFi Signal needs to be less than 20m/66ft (the closer the better).

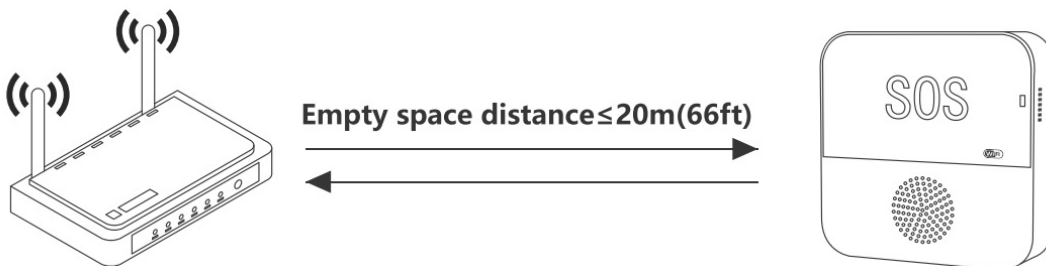

2. SOS Button needs to use within 70m(230ft) range of the Receiver.

⚠️ so the 50 Button cannot be brought outside.

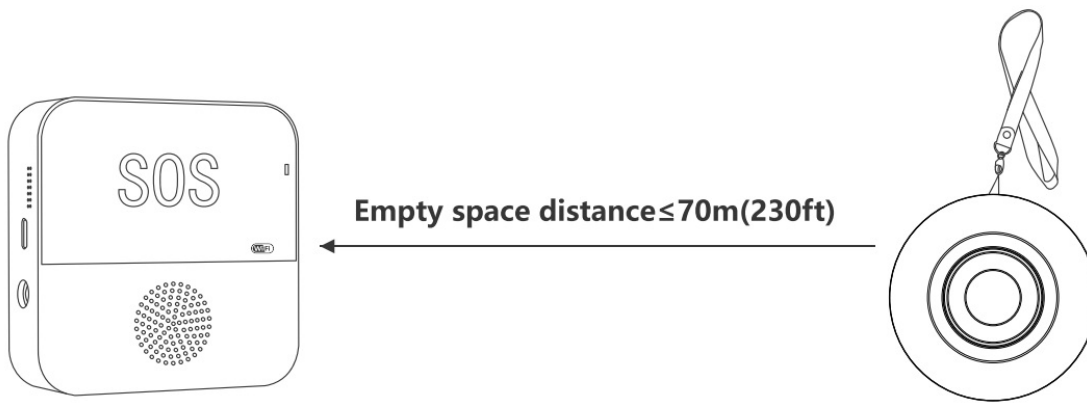

Specification

- **Operating voltage:** 5V
- **Static current:** 260mA
- **Alarm current:** <200mA
- **Wireless frequency:** 433.92MHz
- **Wi-Fi:** IEEE 802.11 b/g/n 2.4G
- **Working temperature:** -10°C~50°C

Q&A

Q: Does the Receiver need to plug in USB power cable all the time?

Yes.

What if the SOS Button cannot make the Receiver alarm?

1. Please check the SOS Button to see if it has been paired with the Receiver successfully. 2. Please check if the SOS Button is still powered (Press the SOS Button to see if it can light up) 3. Please make sure the SOS Button use within 230ft/70m range of the Receiver

What if the Receiver cannot connect to smartphone?

1. Please make sure the smartphone and Receiver are in the same WiFi Network 2. The distance between the Receiver and WiFi Signal needs to be less than 66ft/20m (the closer the better) 3. Please check if the Wifi frequency is 24GHz Wi-Fi.

can I take the SOS Button outside?

No, SOS Button need to be use within 230ft/70m range of the Receiver, and the Receiver need to be placed within 66ft/20m range of the Receiver (the closer the better)

Attention

Dear Customer: Thank you very much for buying our WIFI wireless pager. Since this is a WiFi-connected smart product, its operating speed is related to the stability of your home wireless network, as well as the stability of your cell phone's wireless signal. When the network is stable, press and hold the SOS Button, the Receiver will immediately alarm and send a signal to the cell phone TUYA APP. When the network state is not stable, the Receiver may not receive the signal and can not alarm. At this time, you can press the SOS Button several times until the Receiver alarms. As long as the Receiver has issued an alarm sound, it will send a signal to the cell phone TUYA APP; the phone will receive an alert message. "This is our new product, we are very concerned about our user experience, we hope to do better, so that more customers are satisfied with our products. If you have any questions, please feel free to contact us via Amazon email and we will definitely provide a satisfactory answer."

After sales service

Service Guarantee We provide 30 days return service. Our product manuals have detailed operating instructions to help you better use our products. You can also watch the operation video in the product page, or contact us to get the operation video. If you have any questions, you can contact us through Amazon email, we will definitely provide you with satisfactory after-sales service.

Documents / Resources

	SanJie B0BRQ9TPZR WiFi Smart Wireless Caregiver Pager Call Button System [pdf] Instruction Manual B0BRQ9TPZR WiFi Smart Wireless Caregiver Pager Call Button System, B0BRQ9TPZR, WiFi Smart Wireless Caregiver Pager Call Button System, Caregiver Pager Call Button System, Pager Call Button System, Call Button System
---	--