



Sandstrom SMWLHYP15 Long Life Hyper Scroll Mouse with Bluetrace Instruction Manual

[Home](#) » [Sandstrom](#) » Sandstrom SMWLHYP15 Long Life Hyper Scroll Mouse with Bluetrace Instruction Manual



Contents

- [1 Sandstrom SMWLHYP15 Long Life Hyper Scroll Mouse with Bluetrace](#)
- [2 Safety Warnings](#)
- [3 Product Overview](#)
- [4 Installing the Batteries](#)
- [5 Specifications](#)
- [6 Documents / Resources](#)
- [7 Related Posts](#)

Sandstrøm

Sandstrom SMWLHYP15 Long Life Hyper Scroll Mouse with Bluetrace



Safety Warnings

Optical: Never point the optical sensor towards the face, particularly the eyes, to avoid possible injury. While the mouse is in use, the optical light is visible to the naked eye. Avoid looking directly into the emitter hole while the mouse is active.

Wireless Devices:

- Before boarding any aircraft or packing a wireless device in luggage that will be checked in, remove the batteries from the wireless device.
- Wireless devices can transmit radio frequency (RF) energy, whenever batteries are installed and the wireless device is turned on (If it has an On/Off switch).

Battery-Powered Devices:

- Improper use of batteries may result in battery fluid leakage, overheating, or explosion.
- Released battery fluid is corrosive and may be toxic. It can cause skin and eye burns, and is harmful if swallowed.

To Reduce the Risk of Injury:

- Keep batteries out of the reach of children.
- Do not heat, open, puncture, mutilate, or dispose of batteries in fire.
- Do not mix new and old batteries or batteries of different types.
- Do not allow metal objects to touch the battery terminals on the device; they can become hot and cause burns.

Thank you for purchasing your new Mouse. We recommend that you spend some time reading this instruction manual in order that you fully understand all the operational features it offers. You will also find some hints and tips to help you resolve any issues. Read all the safety instructions carefully before use and keep this instruction manual for future reference.

Unpacking

Remove all items from the packaging. Retain the packaging. If you dispose of it please do so according to local regulations.

The following items are included:

- Main Unit (with Nano Dongle)
- AA Size Battery x 2
- Instruction Manual

Product Overview

Top View

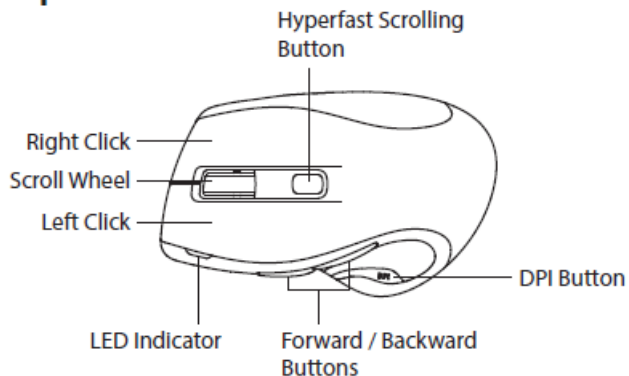

Bottom View

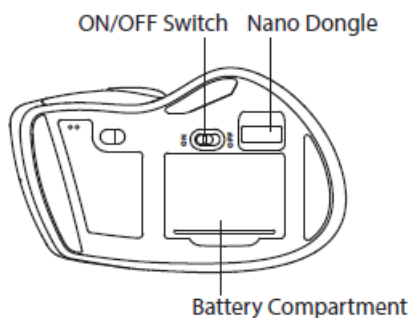

System Requirements

- Operating Systems: Microsoft® Windows®7 / 8 / 10 MAC® OS X
- Hardware: 1 available USB port

Installing the Batteries

When battery is low, the LED indicator will flash.

1. Lift the battery cover up.
2. Insert 2 x AA battery.
3. Close the battery cover.



Please ensure the batteries' polarities (+ / -) match the battery compartment's polarities.

Connecting the Nano Dongle

Remove the Nano Dongle from the mouse and then plug the Nano Dongle directly into your computer's USB port.

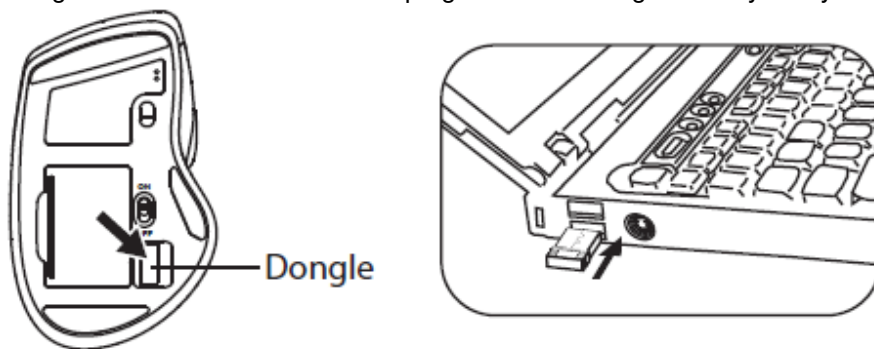

Activating the Wireless Mouse

Switch the ON/OFF button to power on the mouse and then the mouse will automatically connect to the Nano Dongle plugged into your computer.

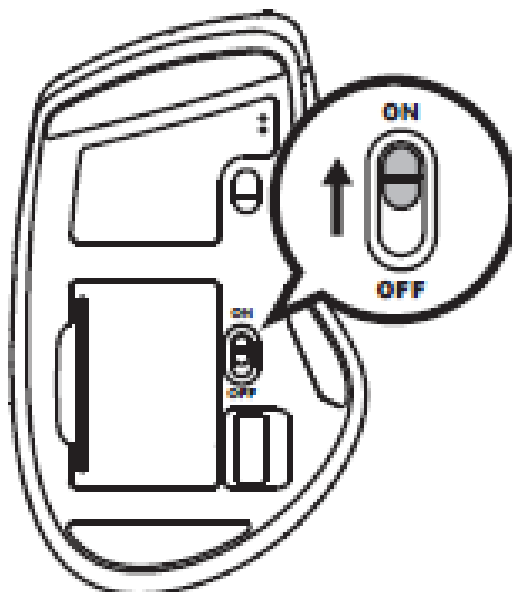

To save energy, switch the ON/OFF button to the off position to turn off the mouse and disconnect the mouse and the Nano Dongle.

DPI Button

Press the DPI button to adjust the resolution:

1. 800 dpi – LED indicator flashes once.
2. 800 – 1600 dpi (default) – LED indicator flashes twice.

Scrolling Mode

Press the Hyperfast Scrolling button to change the scrolling speed:

Hints and Tips

Mouse not working:

1. Check that the power switch is in the on position.
2. Make sure the Nano Dongle is plugged into a USB port and the computer is on or try the Nano Dongle in a different USB port.
3. Check battery installation. Replace battery if needed.
4. If mouse performance is slow or intermittent around a wireless network, unplug the Nano Dongle from the USB port and then reinsert it. To reactivate the mouse, switch it on, off and on again using the ON/ OFF switch on the bottom of the mouse.
5. Repeat the connection procedure. You can also try moving the mouse closer to the Nano Dongle.
6. If the mouse is moving erratically, change the working surface which the mouse is operating on.

Specifications

- Model SMWLHYP15
- Wireless Frequency 2.4GHz
- Operating Range 8 m
- Resolution 800 / 800 – 1600 dpi
- Frequency Band(s) 2403 – 2479 MHz
- Max. Radio Frequency Power Transmitted -4 dBm
- Dimension (L) x (W) x (H) 124 x 75 x 44 mm
- Net Weight 97 g

Features and specifications are subject to change without prior notice.

Visit Partmaster.co.uk today for the easiest way to buy electrical spares and accessories. With over 1 million spares and accessories available we can deliver direct to your door the very next day. Visit www.partmaster.co.uk or call **0344 800 3456** (UK customers only). Calls charged at National Rate.

The symbol on the product or its packaging indicates that this product must not be disposed of with your other household waste. Instead, it is your responsibility to dispose of your waste equipment by handing it over to a designated collection point for the recycling of waste electrical and electronic equipment. The separate collection and recycling of your waste equipment at the time of disposal will help conserve natural resources and ensure that it is recycled in a manner that protects human health and the environment. For more information about where you can drop off your waste for recycling, please contact your local authority, or where you purchased your product.

Notes for battery disposal

The batteries used with this product contain chemicals that are harmful to the environment. To preserve our environment, dispose of used batteries according to your local laws or regulations. Do not dispose of batteries with normal household waste. For more information, please contact the local authority or your retailer where you purchased the product.

- This unit is designed for indoor use only.
- This equipment is a Class II or double insulated electrical appliance. It has been designed in such a way that it does not require a safety connection to electrical earth.
- **AC voltage:** This symbol indicates that the rated voltage marked with the symbol is AC voltage.
- **DC voltage:** This symbol indicates that the rated voltage marked with the symbol is DC voltage.

Declaration of Conformity (RER)

Hereby, Currys Group Limited declares that the radio equipment type [SMWLHYP15] is in compliance with Radio Equipment Regulations 2017 (S.I. 2017/1206). The full text of the UK declaration of conformity is available at the following internet address: <https://www.currys.co.uk/> Click on HELP & SERVICES/Repairs & maintenance/Product Manuals and enter the model number.

Currys Group Limited (co. no. 504877) 1 Portal Way, London, W3 6RS, UK

EU Representative

Currys Ireland Limited (259460)
3rd Floor Office Suite
Omni Park SC, Santry, Dublin 9, Republic of Ireland

Documents / Resources

	<p>Sandstrom SMWLHYP15 Long Life Hyper Scroll Mouse with Bluetrace [pdf] Instruction Manual</p> <p>SMWLHYP15, Long Life Hyper Scroll Mouse with Bluetrace, SMWLHYP15 Long Life Hyper Scroll Mouse with Bluetrace, Mouse with Bluetrace</p>
---	--