



Sandstrom SDESWLW19 Wireless Combo Keyboard and Mouse Set Instruction Manual

[Home](#) » [Sandstrom](#) » Sandstrom SDESWLW19 Wireless Combo Keyboard and Mouse Set Instruction Manual 

Contents

- 1 Sandstrom SDESWLW19 Wireless Combo Keyboard and Mouse Set
- 2 Safety Warnings
- 3 Unpacking
- 4 Product Overview
- 5 Installing the Batteries
 - 5.1 Activating the Keyboard & Mouse
- 6 Specifications
- 7 Documents / Resources
- 8 Related Posts

Sandstrøm

Sandstrom SDESWLW19 Wireless Combo Keyboard and Mouse Set



Safety Warnings

Read all the instructions carefully before using the unit and keep them for future reference. Retain the manual. If you pass the unit onto a third party, make sure to include this manual. Never point the optical sensor towards the face, particularly the eyes, to avoid possible injury. While the mouse is in use, the optical light is visible to the naked eye. Avoid looking directly into the emitter hole while the mouse is active.

Wireless Devices:

- Before boarding any aircraft or packing a wireless device in luggage that will be checked in, remove the batteries from the wireless device.
- Wireless devices can transmit radio frequency (RF) energy, whenever batteries are installed and the wireless device is turned on (If it has an On/ Off switch).

Battery-Powered Devices:

- Improper use of batteries may result in battery fluid leakage, overheating or explosion.
- Released battery fluid is corrosive and may be toxic. It can cause skin and eye burns, and is harmful if swallowed.
- Do not disassemble the unit or remove any parts.
- Do not immerse the unit in water or any liquid.
- Do not use the unit close to heat sources or expose to high temperatures.
- Do not use the unit where strong electromagnetic waves are present. Strong electromagnetic waves will cause damage to the keyboard.
- Keep the keyboard away from direct sunlight, moisture, dirt or abrasive chemical products (cleaning products etc).

To Reduce the Risk of Injury:

- Keep batteries out of the reach of children.
- Do not heat, open, puncture, mutilate, or dispose of batteries in fire.
- Do not mix new and old batteries or batteries of different types.
- Do not allow metal objects to touch the battery terminals on the device; they can become hot and cause burns.

Thank you for purchasing your new keyboard and mouse. We recommend that you spend some time reading this instruction manual in order that you fully understand all the operational features it offers. You will also find some hints and tips to help you resolve any issues. Read all the safety instructions carefully before use and keep this instruction manual for future reference.

Unpacking

Remove all items from the packaging. Retain the packaging. If you dispose of it please do so according to local regulations. The following items are included:

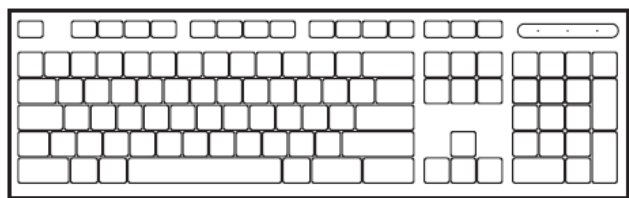

Main Unit



Mouse (with Nano Dongle)



AAA Size Battery x 4

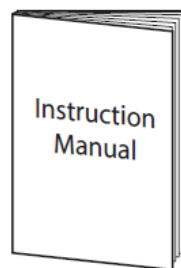

Instruction Manual

If items are missing or damaged, please contact Partmaster (UK only). **Tel: 0344 800 3456** for assistance.

Product Overview

Keyboard

Top View

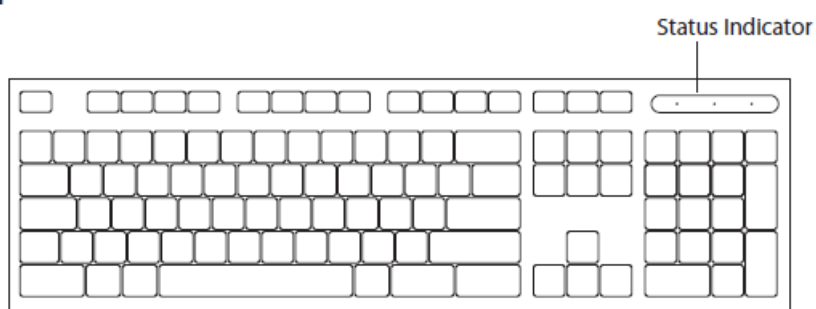

Bottom View

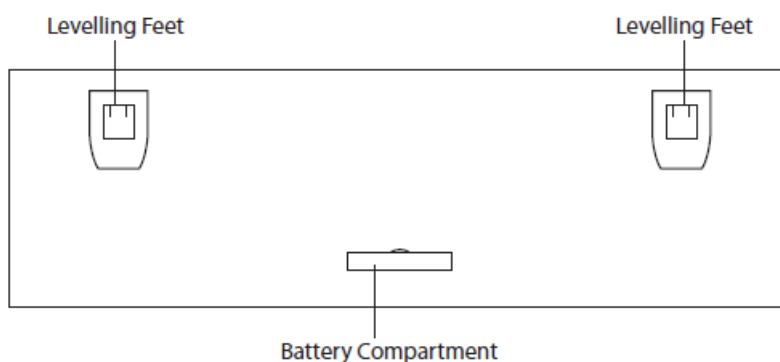

Mouse

Top View

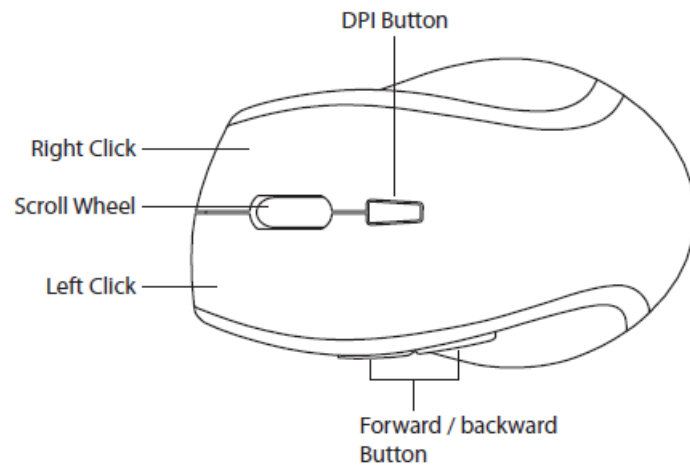

Bottom View

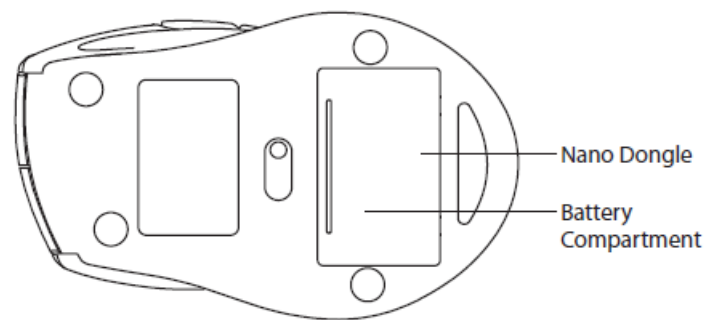

Installing the Batteries

When battery is low, the LED indicator will flash continuously.

1. Remove the battery cover.
2. Insert the batteries.
3. Close the battery cover.

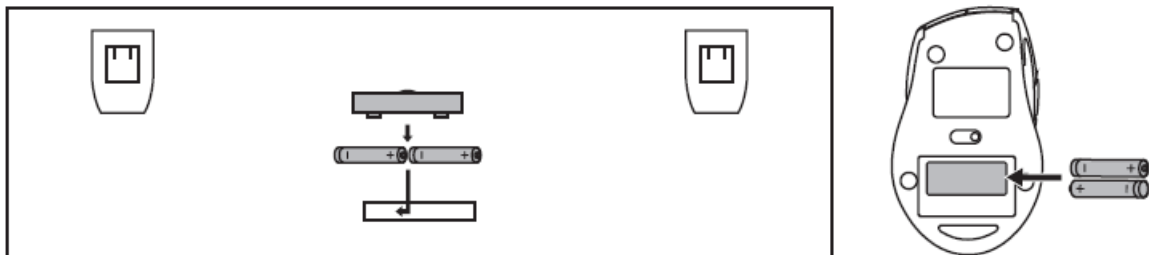

Please ensure the battery's polarities(+/-) match the battery compartment's polarities.

Activating the Keyboard & Mouse

Plug the Dongle directly into your computer's USB port. The keyboard and mouse will automatically connect to the computer.

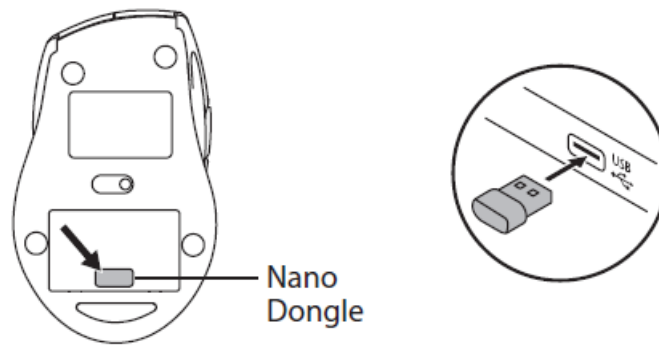

Mouse DPI Setting

Press the DPI button on the mouse repeatedly to adjust the resolution (800 – 1200 – 1600 dpi).

Energy Saving Function

- The keyboard and mouse have an energy saving function. If keyboard or mouse is not activated for approx. 5 seconds, it switches to energy saving mode. After 30 minutes of no activity, the LED switches off and enters sleep mode. To wake up the keyboard or mouse, press any button or move the scroll wheel.
- The keyboard or mouse switches off if a transmission signal is no longer received. If necessary, remove the nano receiver to use this energy saving function. Insert it in the receiver dock on the bottom of the mouse as the receiver is very small and can be easily lost.

Hints and Tips

Mouse or Keyboard not Working:

- Make sure the Nano Dongle is plugged into a USB port and the computer is on or try the Nano Dongle in a different USB port.
- Change the battery if the keyboard or mouse no longer reacts to input.
- If the Nano Receiver is plugged into a USB hub, try plugging it directly into the computer.
- Move the mouse or keyboard closer to the receiver.
- If the mouse is moving erratically, change the working surface which the mouse is operating on.
- Restart the computer.
- If automatic pairing fails, pair the dongle with the keyboard manually.
 1. Switch on the keyboard.
 2. Plug the dongle into the USB port.
 3. Press and hold the ESC + K buttons to enter the pairing mode and the LED indicator will flash rapidly.
 4. After successfully connecting in 2.4GHz Wireless mode, the LED indicator light will extinguish.

Specifications

- Model SDESWLW19
- Operating Systems Microsoft® Windows® 7 / 8 / 10
- Wireless Frequency 2.4GHz
- Operating Range 6m (8m in open space)

Dongle

- Frequency Band(s) 2406 – 2476 MHz
- Max. Radio Frequency
- Power Transmitted -5 dBm

Keyboard

- Frequency Band(s) 2406 – 2476 MHz
- Max. Radio Frequency
- Power Transmitted -1 dBm
- Dimension (L x W x H) 450 x 175 x 25 mm
- Net Weight 882 g

Mouse

- Resolution 800 / 1200 / 1600 dpi
- Frequency Band(s) 2406 – 2476 MHz
- Max. Radio Frequency
- Power Transmitted -5 dBm
- Dimension (L x W x H) 122 x 75 x 43 mm
- Net Weight 80 g

Features and specifications are subject to change without prior notice.

Notes for battery disposal



The batteries used with this product contain chemicals that are harmful to the environment. To preserve our environment, dispose of used batteries according to your local laws or regulations. Do not dispose of batteries with normal household waste. For more information, please contact the local authority or your retailer where you purchased the product.

The symbol on the product or its packaging indicates that this product must not be disposed of with your other household waste. Instead, it is your responsibility to dispose of your waste equipment by handing it over to a designated collection point for the recycling of waste electrical and electronic equipment. The separate collection and recycling of your waste equipment at the time of disposal will help conserve natural resources and ensure that it is recycled in a manner that protects human health and the environment. For more information about where you can drop off your waste for recycling, please contact your local authority, or where you purchased your product. The wireless LAN hardware in your product conforms to the requirements and provisions set out in European Directive 1999/5/EC (R&TTE). Limitations may apply for details go to www.currys.co.uk/compliance. Windows is a registered trademark of Microsoft Corporation in the United States and other countries. All trademarks are the property of their respective owners and all rights are acknowledged. This unit is designed for indoor use only. This equipment is a Class II or double insulated electrical appliance. It has been designed in such a way that it does not require a safety connection to electrical earth. AC voltage: This symbol indicates that the rated voltage marked with the symbol is AC voltage.

DC voltage: This symbol indicates that the rated voltage marked with the symbol is DC voltage.

Visit Partmaster.co.uk today for the easiest way to buy electrical spares and accessories. With over 1 million

spares and accessories available we can deliver direct to your door the very next day. Visit www.partmaster.co.uk or call **0344 800 3456** (UK customers only). Calls charged at National Rate.

Currys Group Limited (co. no. 504877)
1 Portal Way, London, W3 6RS, UK
EU Representative
Currys Ireland Limited (259460)
3rd Floor Office Suite
Omni Park SC, Santry, Dublin 9, Republic of Ireland

Documents / Resources

	<p>Sandstrom SDESWLW19 Wireless Combo Keyboard and Mouse Set [pdf] Instruction Manual</p> <p>SDESWLW19, Wireless Combo Keyboard and Mouse Set, SDESWLW19 Wireless Combo Keyboard and Mouse Set, Combo Keyboard and Mouse Set, Keyboard and Mouse Set, Mouse Set, Keyboard and Mouse, Mouse, Keyboard</p>
---	--