



**Contents** [ [hide](#) ]

- [1 SAMVIX Smart Time Digital Player](#)
- [2 PREFACE](#)
- [3 Important Safety Instructions](#)
- [4 Warranty Certificate](#)
- [5 MAIN FUNCTIONS](#)
- [6 BUTTON INSTRUCTION](#)
- [7 QUICK INTERFACE INSTRUCTIONS](#)
- [8 Setting](#)
- [9 SPECIAL STATEMENT](#)
- [10 PACKING LIST](#)
- [11 PRODUCT SPECIFICATION](#)
- [12 WARRANTY](#)
- [13 Frequently Asked Questions](#)
- [14 Documents / Resources](#)
  - [14.1 References](#)

**SAMVIX**

**SAMVIX Smart Time Digital Player**



## **PREFACE**

### **Thank you**

- For purchasing Samvix smart time digital player.
- Please read the user manual carefully before using this product. When you start using this product, our company assumes that you have carefully read this user manual.
- This user manual is written based on the latest type after the production. If the product is subject to change, no further notice will be given.
- The power interface of this product is designed for charging the built-in battery. Please use a computer USB port or a 5VDC/1A power adapter that meets national standards to charge the player. Do not connect to other power supply equipment, otherwise it may cause irreparable consequences such as failure to charge or damage to data and hardware, for which our company does not assume any responsibility.
- Users are advised not to repair or disassemble the product by themselves; otherwise we will not be able to provide you with normal after-sales service. Our company is not responsible for editorial errors or omissions in this document; in view of the continuous improvement of products, our company reserves the right to modify the specifications of this product without prior notice; The content of this user manual may not be copied, modified, republished, or disseminated in any way for any purpose without the prior written permission of our company.

## Important Safety Instructions

Follow the safety guidelines below when using the product:

- Do not modify, disassemble, or open the product.
- Keep the product away from water, moisture, or wetness.
- Do not expose the product to any heat source, including leaving it in a hot car, direct sunlight, etc.
- Use the product only for its intended purpose and according to the usage instructions.
- Do not leave the product charging for an extended period.
- Use a suitable charger for the product's battery – maximum 5V and 1A.
- Do not charge in a car, bus, computer, or stereo system.
- Do not use the product while driving or crossing the street.

## Warranty Certificate

The certificate is valid for the device: Smart-Time

- We, Samvix USA., the official importer (hereinafter: “the company”), are responsible for the proper functioning of the device subject to the following conditions:
- The warranty certificate is valid for 12 months from the date of purchase and is effective according to the “company’s” regulations and only when accompanied by the purchase receipt and warranty certificate.
- The battery warranty is 30 days from the date of purchase, and the buttons and connectors are covered for 3 months from the date of purchase.
- The essence of the warranty is to perform necessary repairs for the proper functioning of the device. The warranty does not apply if the copy and transfer function is not working.

The warranty under this certificate does not apply in the following cases:

- The malfunction was caused by improper use, or the device was damaged by charging with an improper charger as described in the safety instructions.
- Malfunction due to electrical faults, fire, water, moisture, corrosion, or any other damage caused by force majeure.

- Repair or opening of the device by someone not authorized by “the company.”
- Physical breakage or damage to the device for any reason, or software alteration.
- Malfunction due to a corrupted file or folder, or any virus introduced into the device.

“The company” is not responsible for preserving the content on the device, so it is advisable to back up the device content before submitting it for repair.

“The company” undertakes to return the defective device to the state it was in before the malfunction. If “the company” is unable to repair the device, “the company” will provide a new device or a refund at the company’s discretion.

## **MAIN FUNCTIONS**

- 1.91 inches TFT color screen.
- Physical buttons + Rotation button + Full touch screen. Support MP3, WMA, APE, FLAC, WAV Etc main stream music format, Support lyrics synchronization.
- 6 menu style optional.
- Multiple playback modes: sequential playback, single loop, repeat all, browse playback, random playback.
- Build in Mic recorder.
- Support external speaker.
- Magnetic thimble for data transmission/charging
- With alarm clock function.
- Multiple sound effects to choose from.
- support multi language.
- Support WIN7 and above systems.

## **BUTTON INSTRUCTION**

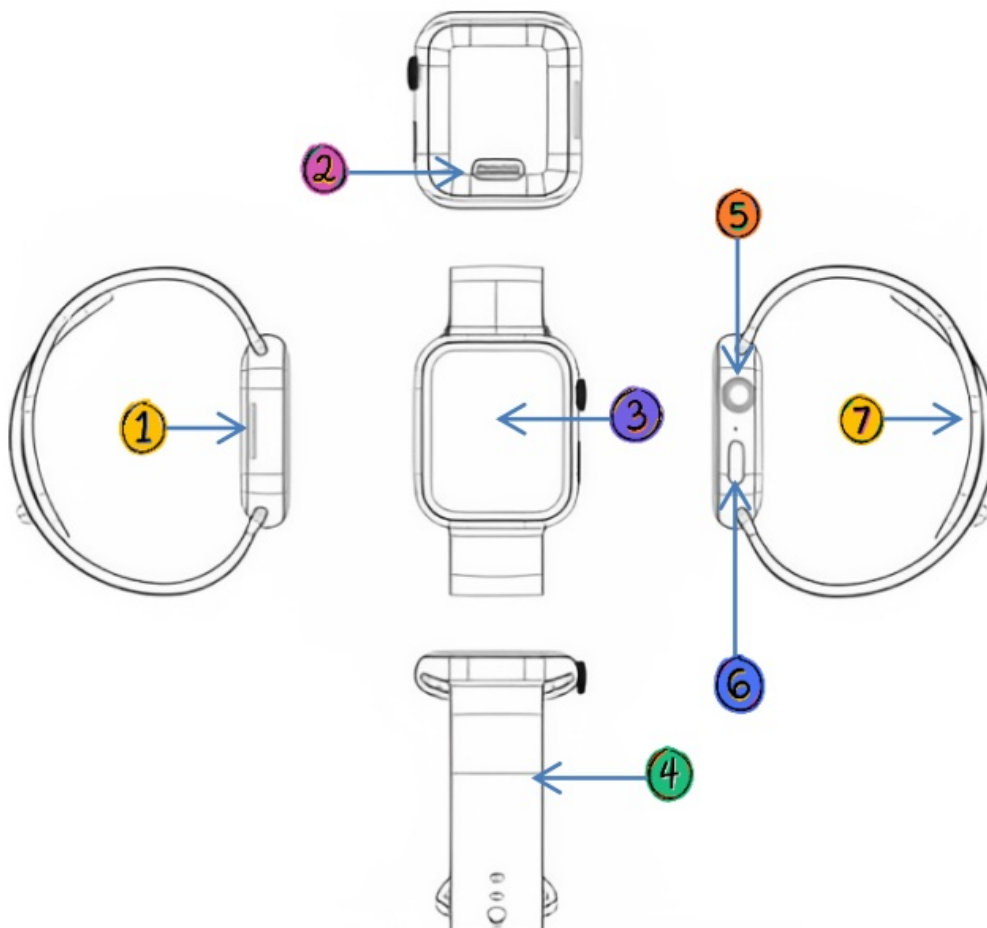

1. Speaker
2. Charge/ Transmission interface
3. Display
4. Wrist strap
5. Volume key
6. Power key
7. Record hole

## QUICK INTERFACE INSTRUCTIONS

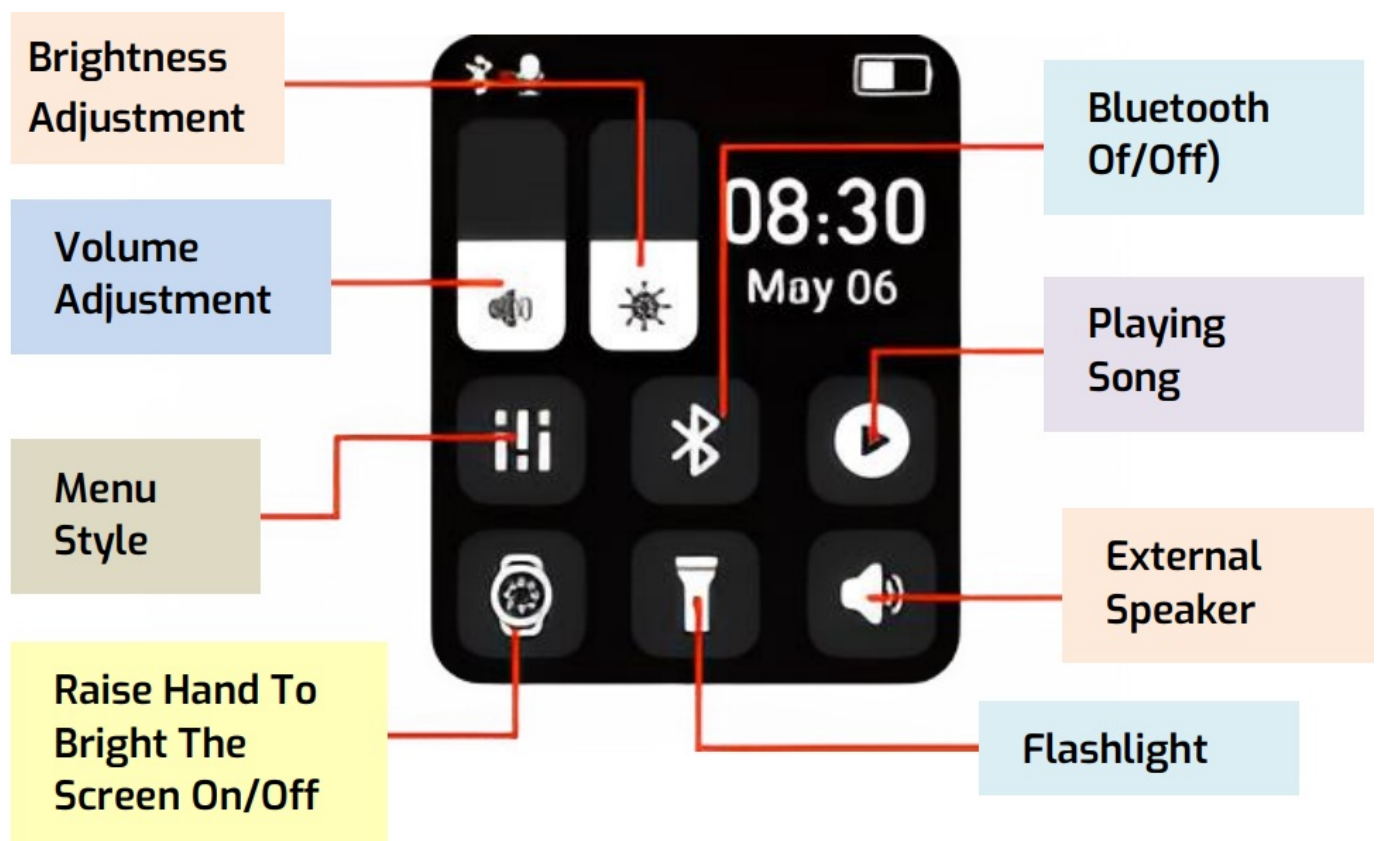

## Power On/Off

1. Press the power key for 3 seconds to boot up, press another 3 seconds to choose shut down restart interface. when player connect with PC, Short press the power key to exit connection.
2. Short press the power key to control the screen off and on while the device is power on.

## Volume Key

Short press enter into shortcut key setting interface, adjust the volume and back light, main interface style, flashlight, hands control screen brightness, Bluetooth on/off, external speaker on/off, file browser, the music playback interface can be rotated to increase or decrease the volume, and long press the button enter the on key recording.

## Return to previous page

The default return operation of the machine is to swipe from right to left to return to the previous level.

## Main interface function

Main interface applications: music, recording, E-book, Bluetooth, folder, settings,

pictures, calendar, game, wallpaper, alarm clock, stopwatch, calculator, watch face selection.

## **Music play**

1. Touch the music icon on the main interface to enter the menu: Current Playing, All Songs, Artist, Album, Style, Favorites, and Update Playlist.
  1. Now playing: Enter the currently playing music or recording playback interface;
  2. All songs: enter the list of all music files on the disk;
  3. Singer: music files are classified by singer;
  4. Album: Music files are classified by album;
  5. Style: music files are classified by style;
  6. Favorites: Display favorites (1-3), which can be classified by favorites;
  7. Update playlist: update the current music playlist;
2. **Music playback interface**
  1. Touch the play icon to play/pause music, touch the previous and next song icon to switch music, and long press the previous and next song icon to fast forward or rewind the music;
  2. AB repeat function: Touch the "AB" icon, the icon "B" turns red (repeat starting point), touch the "AB" icon again, the icon "A" turns red (repeat end point). The system will repeatedly play the music of the "A-B" segment. Touch the "AB" icon for the third time, the icon will turn back to white, and the repeat playback will stop;
  3. Touch the play mode icon to switch between 4 play modes, which are: repeat all, random play, sequential play, and single repeat;
  4. Touch the variable speed playback icon "X" to pop up the variable speed playback interface. Swipe up and down to select the variable speed level (-X8~X8). The default is X, which only supports MP3 format music;
  5. Touch the heart-shaped icon: the favorites interface will pop up, swipe up and down to select;
  6. Touch the sound effect icon to enter the equalizer menu settings. The equalizer has 8 sound effects that can be switched: off (default off), rock, funk, hip-hop, jazz, classical, electronic, and custom;
  7. Touch the delete icon to delete the current music.

## **Recorder**

1. On the recording interface, touch the circle to start or end recording, touch the recording format and bitrate icons to switch options, touch the play icon to pause/continue recording, and touch the folder icon to directly enter the recording library.
2. One-key recording function: Long press the volume button on the menu interface, the device will turn on (off)the background recording function and jump to the Quick operation interface, and the recording icon in the upper left corner of the display will start (stop)flashing; When Settings-Password interface is turned on, re-open the device after the device screen turn off one time, in the password input interface, long press the volume button to turn on(off)the recording function, and the recording icon will flash in the upper right corner of the display.
3. Touch the three small dots in the upper right corner to enter the menu: recording file format, recording bit rate, noise reduction settings, and segmented recording.
  - Recording file format: There are two formats: MP3 format and WAV;
  - Recording bit rate: There are 9 bit rates in MP3 format and WAV format. The higher the bit rate, the better the recording quality and the larger space occupied by the recording file. The default WAV format for recording is 512kbps;
  - Noise reduction settings: Turn off noise reduction, level one to level ten options;
  - Segment recording: off, 30 minutes, 60 minutes, 90 minutes, custom options;

## **E-Book**

Enter the E-Book playback interface, long press the screen to display the quick setting interface, where you can set the automatic playback duration, background color, book addition, bookmark selection, chapter selection, and deletion. Touch the page number position to enter the page number to jump the certain page directly. Slide left to return to the e-book file list interface.Slide up and down can read the e-book content.

## **Bluetooth**

1. Bluetooth switch control: set Bluetooth on/off;
2. Search device: search for all nearby Bluetooth devices, touch the Bluetooth device name to automatically connect;



3. Paired devices: View the paired Bluetooth devices. Click the device name to choose to disconnect the connected device or delete the device name.

## **Folder**

Touch to enter the file list interface and select the corresponding file to operate.

## **Setting**

1. Enter the settings menu in order: language, display settings, date and time, information, formatted device, recover factory settings, password settings;
2. Language: twelve languages can be selected, the default is English;
3. Display settings: Set the backlight brightness (level 1- 10) and set the backlight time (Always light, 10 seconds, 20 seconds, 30 seconds);
4. Date and time: Slide up and down to set the digital value, switch between 12-hour/24-hour format on the upper right corner, automatic save while slide into left;
5. Information: displays player information and disk memory state;
6. Format device: formats the disk;
7. Recover factory settings: restores factory settings;
8. Password setting: Setting password at first time, waiting for the input box pop up, enter 6 digital number password, and click “√”, and enter the same password twice for confirmation. During the setting process, short press the button to stop setting process. after the password set down, the device need to enter a password to unlock it when waking up and restarting.

## **Picture**

Touch the picture icon to enter the picture list interface, touch the file name to open the picture, and touch the picture playback interface. Touch “<” and “>” to switch to the previous and next pictures. Touch the play icon to turn on or off the automatic browsing function, touch the screensaver and wallpaper icons to set the current picture as screensaver and wallpaper, touch the delete icon to delete the current picture.

## **Calendar**

Display current month information, slide up and down can switch Month value.

## **Wallpaper**

Touch the wallpaper icon to switch the back picture of display.

## **Alarm clock**

Enter the alarm clock menu in order: alarm clock (on\off), alarm clock time, alarm clock cycle, alarm clock music, and alarm clock volume.

1. Alarm clock (on\off): turn on/off the alarm clock, off by default;
2. Alarm clock time: Set the alarm clock ringing time;
3. Alarm clock cycle: three options: single, daily, and weekdays;
4. Alarm clock music: built-in ringtone and user-defined;
5. Alarm volume: Set the alarm sound volume.

## **Stopwatch**

Enter the stopwatch interface and touch the playback icon in the middle to start the timer, touch the icon in the lower left corner to switch timers, and touch the icon in the lower right corner to clear all timers.

## **Calculator**

Able to complete basic operations of addition, subtraction, multiplication and division calculation in life and study.

## **Watch face**

Touch the watch face selection icon to enter the 14 watch face options, swipe left and right to switch selections, touch the middle area to confirm the selection and exit.

## **SPECIAL STATEMENT**

1. During the process of data uploading and downloading, please do not unplug the machine, otherwise the software may be damaged and the machine may not work properly. At the same time, after the file transfer is completed, be sure to eject the machine safely before unplugging the USB cable, otherwise data loss may occur.
2. Users are particularly reminded to operate with caution and back up important data separately. Our company will not be held responsible in case of data loss.

## **PACKING LIST**

- Device 1
- Cable 1
- Use manual 1
- Watches Bands 6

Product accessories are subject to the actual items in the packaging.

## **PRODUCT SPECIFICATION**

- Product name Digital player
- Mode Smart time
- Size 45.4×38.4x11mm Without band
- Battery capacity 200mAh
- Bluetooth BT5.3
- Music format MP3, APE, FLAC, WMA, WAV, AAC
- Record format WAV MP3
- E-book TXT
- Input Magnetic thimble, 4PIN, charging + transmission
- Work temperature 0 to 45 °
- Language Multi Language

## **WARRANTY**

1. Please keep this product away from the electromagnetic environment; away from excessive moisture, smoke and other harsh environments;
2. This device is prohibited from being immersed in water; do not use any corrosive or abrasive cleaners to clean the device;
3. Please do not use excessive force to squeeze the product;
4. Please do not shake or impact the product violently;
5. It is recommended to turn down the volume before using the headphones, and then gradually increase the volume until it is suitable to your ears. In order to protect your hearing, please do not adjust the volume too high (doctors point out that listening at a higher volume for a long time can damage the listener's hearing). When tinnitus occurs, please turn down the volume or stop using it;
6. Ensure that this product is placed safely to prevent accidents and falls from being

- touched by children;
7. Under normal circumstances, the device charge time is about 2-3 hours. It is recommend- ed to unplug it from the USB interface after completing charging, and do not connect it to the power supply for a long time;
  8. Do not use headphones when driving, riding, operating machinery, or doing work that requires attention to external sounds;
  9. Precautions for battery charging :
    - The battery of this player is a polymer battery, which is rechargeable;
    - Polymer batteries must be replaced by professionals staff and cannot be replaced by users themselves (note: if the battery is replaced improperly, there is a risk of explosion and can only be replaced with the same type or equivalent type of battery); to protect the environment, Please hand over discard battery to a professional organization for recycling;
    - The life of the battery may vary depending on usage conditions and production time;
    - The battery must not be exposed to sunlight, fire or similar overheating environments;
  10. Due to software updates, the actual use of this product may differ from the content in the user manual. Please refer to the product you purchased. The user manual is for reference only.

Keep the warranty page and the purchase receipt, Only through them will it be possible to process the Warranty

## **Note**

There may be some changes to the product, from what is listed in this manual, including technical specification changes. The manufacturer reserves the right to improve the version of the player and its technical specifications, without prior notification and/or updating the instructions.

In case the store/supplier does not honor the warranty, you can contact us at

- **ISRAEL**

E mail: [s@goldfox.co](mailto:s@goldfox.co) Fax: 077-444-7848

- **USA**

## Frequently Asked Questions

- **Q: Can I use any power adapter to charge the player?**

A: It is recommended to use a 5VDC/1A power adapter that meets national standards to charge the player. Avoid connecting to other power supply equipment.

- **Q: How long does it take to charge the device?**

A: Under normal circumstances, the device takes about 2-3 hours to charge. Once fully charged, unplug it from the power source promptly.

- **Q: Can I replace the battery myself?**

A: The polymer battery should only be replaced by professional staff. Incorrect replacement poses risks of explosion. Dispose of old batteries responsibly through professional organizations.

## Documents / Resources

	<a href="#">SAMVIX Smart Time Digital Player [pdf]</a> User Manual Smart Time Digital Player, Time Digital Player, Digital Player
---	--

## References

- [User Manual](#)

📁 Digital Player, Samvix, Smart Time Digital Player, Time Digital

📁 Samvix Player

—Previous Post

[Samvix GLASBA 8 MP3 Player User Guide](#)

---

## Leave a comment

Your email address will not be published. Required fields are marked \*

Comment \*

Name

Email

Website

☐ Save my name, email, and website in this browser for the next time I comment.

Post Comment

Search:

e.g. whirlpool wrf535swhz

Search

[Manuals+](#) | [Upload](#) | [Deep Search](#) | [Privacy Policy](#) | [@manuals.plus](#) | [YouTube](#)

This website is an independent publication and is neither affiliated with nor endorsed by any of the trademark owners. The "Bluetooth®" word mark and logos are registered trademarks owned by Bluetooth SIG, Inc. The "Wi-Fi®" word mark and logos are registered trademarks owned by the Wi-Fi Alliance. Any use of these marks on this website does not imply any affiliation with or endorsement.