



## SAMSUNG USING THE REMOTE CONTROL User Guide

[Home](#) » [Samsung](#) » SAMSUNG USING THE REMOTE CONTROL User Guide 

# SAMSUNG



### Contents

- [1 USING THE REMOTE CONTROL](#)
- [2 INSTALLING THE WALL MOUNT](#)
- [3 Documents / Resources](#)
- [4 Related Posts](#)

## USING THE REMOTE CONTROL

1. Power button

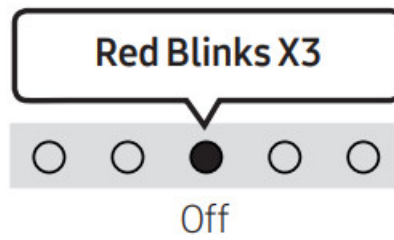
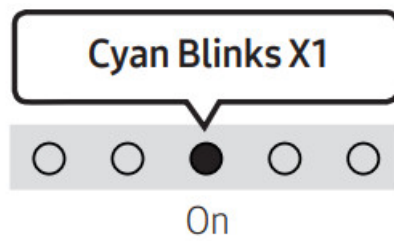

2.  (Source) button

Press to select a source connected to the Soundbar.

3.  Bluetooth PAIR button Switch the Soundbar to Bluetooth pairing mode.

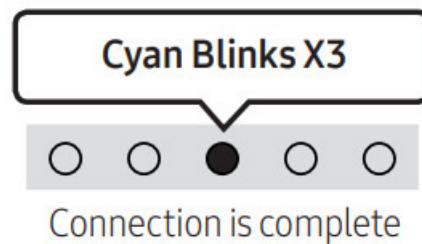
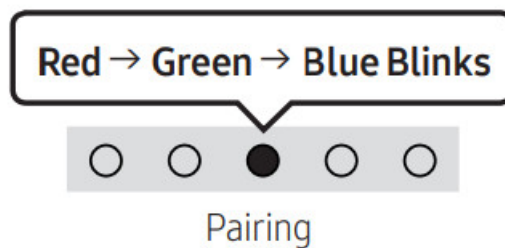

 "Ready to connect via Bluetooth."

4. Up/Down/Left/Right buttons

5.  (Play / Pause) button

6.  (Mute) button



7. SOUND MODE button

By pressing the button, you can select the desired audio mode.

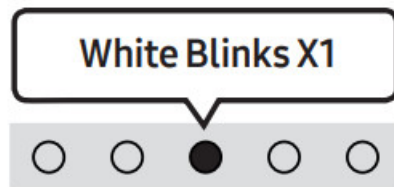

Speaker icon "Standard" → "Music" → "Adaptive Sound"

#### 8. (Sound Control) button

By pressing the button, you can select the desired audio mode. The desired settings can be adjusted using the Up/Down buttons. Each time the model changes, the Multicolour LED blinks in white.

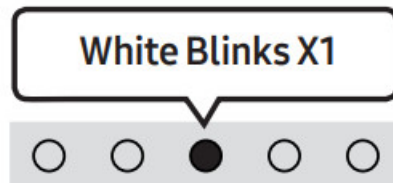

Speaker icon "Treble" → "Bass" → "Sync" → "Centre Level" → "Side Level"

#### 9. VOLUME button

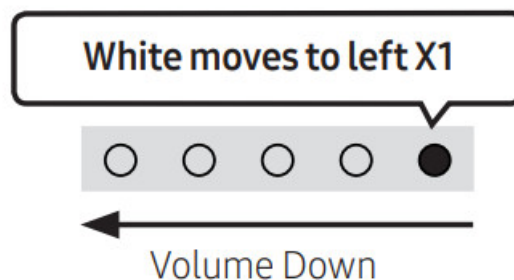
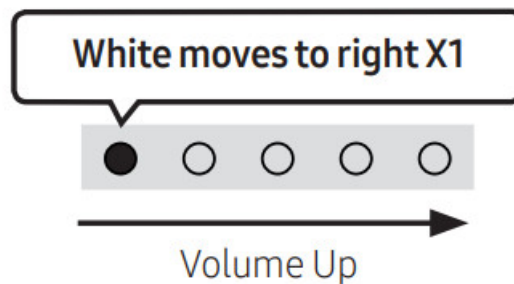

#### 10. WOOFER (BASS) LEVEL button

Push the button up or down to adjust the level of the woofer (bass).

## INSTALLING THE WALL MOUNT

### Installation Precautions

- Install on a vertical wall only.
- Do not install in a place with high temperature or humidity.
- Verify whether the wall is strong enough to support the product's weight. If not, reinforce the wall or choose another installation point.
- Purchase and use the fixing screws or anchors appropriate for the kind of wall you have (plasterboard, iron board, wood, etc.).

If possible, fix the support screws into wall studs.

- Purchase wall mounting screws according to the type and thickness of the wall you want to mount the Soundbar on.
  - Diameter: M5
  - Length: 1 3/8 inches (35 mm) or longer recommended.
- Connect cables from the unit to external devices before you install the Soundbar on the wall.
- Make sure the unit is turned off and unplugged from the power source before you install it. Otherwise, it may cause an electric shock.

## Components

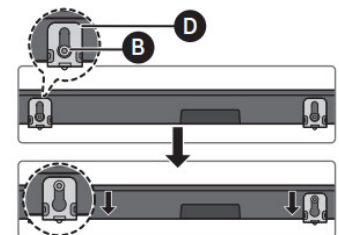
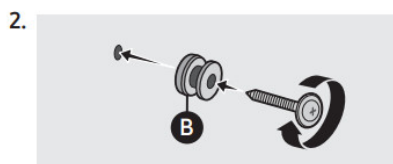
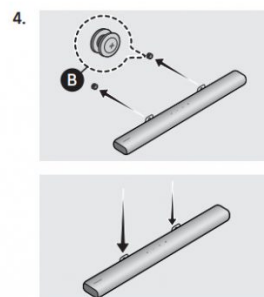
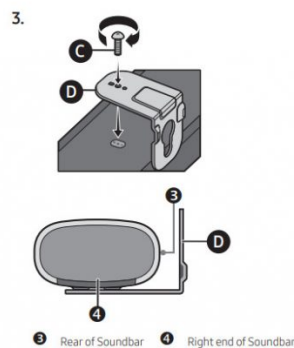
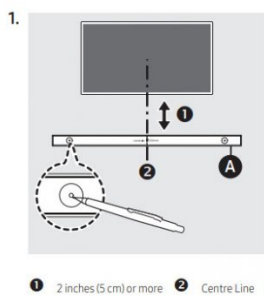

AH81-13933G-00

AH81-13933G

## Documents / Resources

	<a href="#">SAMSUNG USING THE REMOTE CONTROL</a> [pdf] User Guide USING THE REMOTE CONTROL
--	---

