

SAMSUNG QB13R-M Interactive Display



SAMSUNG QB13R-M Interactive Display User Guide

[Home](#) » [Samsung](#) » SAMSUNG QB13R-M Interactive Display User Guide 

Contents

- [1 SAMSUNG QB13R-M Interactive Display](#)
- [2 Product Information](#)
- [3 Product Usage Instructions](#)
- [4 INTRODUCTION](#)
- [5 Checking the Components](#)
- [6 Parts](#)
- [7 Troubleshooting](#)
- [8 Connecting and Using](#)
- [9 Specifications](#)
- [10 Documents / Resources](#)
 - [10.1 References](#)

SAMSUNG

SAMSUNG QB13R-M Interactive Display



Product Information

- **Specifications:**

- **Model:** QB13R-M, QB13R-TM
- **Recommended Hours of Use:** Under 16 hours per day
- **Colour and Appearance:** Subject to variation
- **Components:** Quick Setup Guide, Regulatory guide, AC/DC adapter, Remote Control, STAND-BAR x 2, Warranty card, Power cord, Batteries (AAA x 2), RS232C adapter, TOUCH OUT cable (Supported model: QB13R-TM)

Product Usage Instructions

- **Using the STAND-BAR:**

- To utilize the STAND-BAR, follow the instructions provided in the user manual for proper installation and setup.

- **Speaker Usage:**

- The product is equipped with a speaker. Adjust the volume settings as needed for optimal sound output.

- **Remote Control:**

- Point the remote control at the sensor on the front of the product to perform functions. Avoid using other display devices that may interfere with remote control signals.

- **Ports:**

- Output sound to an audio device via an audio cable.
- Connect to MDC using an RS232C adapter.
- Connect to a USB memory device (ensure current does not exceed 1.0A).
- Connect to MDC and the Internet using a LAN cable (Cat7 STP Type recommended).
- Connect to a source device using HDMI or HDMI-DVI cable.
- Connect to a PC using a TOUCH OUT cable for touch functions (Supported model: QB13R-TM).
- Connect to the AC/DC adapter for power.

- **Touchscreen Control:**

- If touchscreen control is available, access the administrator menu by touching and holding the screen when the product is turned on. Adjust settings using the OSD menu or remote control as needed.

- **Frequently Asked Questions (FAQ):**

- **The screen keeps switching on and off.**
 - Check cable connections between the product and the PC.
 - Ensure all devices are connected correctly.
- **No Signal is displayed on the screen.**
 - Ensure the source device is powered on.
 - Enable the HDMI Hot Plug function if needed.
- **Not Optimum Mode is displayed.**
 - Adjust the graphics card signal to match the product's resolution and frequency limits.

INTRODUCTION

- The recommended hours of use per day of this product is under 16 hours.
- If the product is used for longer than 16 hours a day, the warranty may be void.
- The colour and appearance may differ depending on the product, and the content in the manual is subject to

change without prior notice to improve the performance.

- Download the user manual from the following Samsung Website for further details.

<http://www.samsung.com/displaysolutions>.

Checking the Components

Contact the vendor where you purchased the product if any components are missing. Components may not be supported depending on the model or geographical area.

- Quick Setup Guide
- Regulatory guide
- AC/DC adapter
- Remote Control
- STAND-BAR x 2
- Warranty card (Not available in some locations)
- Power cord
- Batteries (AAA x 2) (Not available in some locations)
- RS232C adapter
- TOUCH OUT cable (Supported model: QB13R-TM)

Using the STAND-BAR

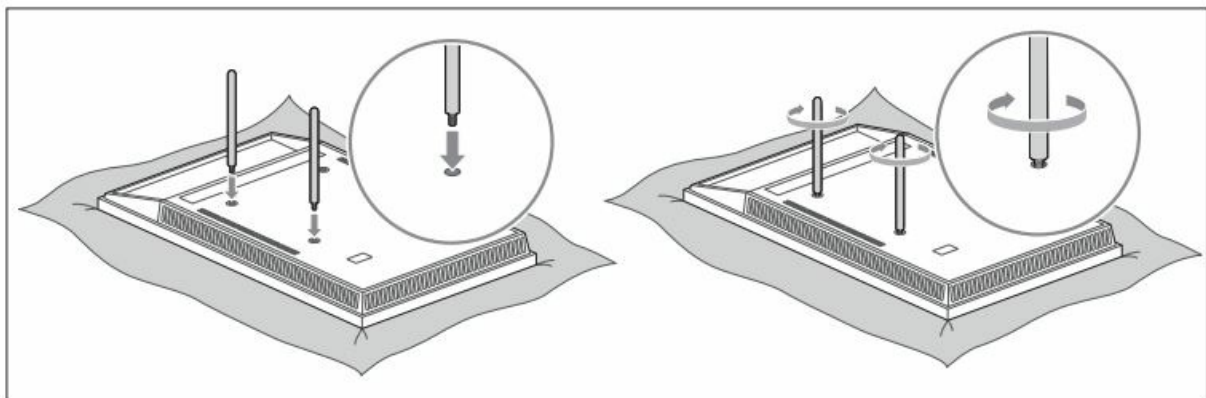

- Place the product with the face down on top of the protective cloth or cushion.
- Insert the bar into a slot on the product and then turn to fasten.

Parts

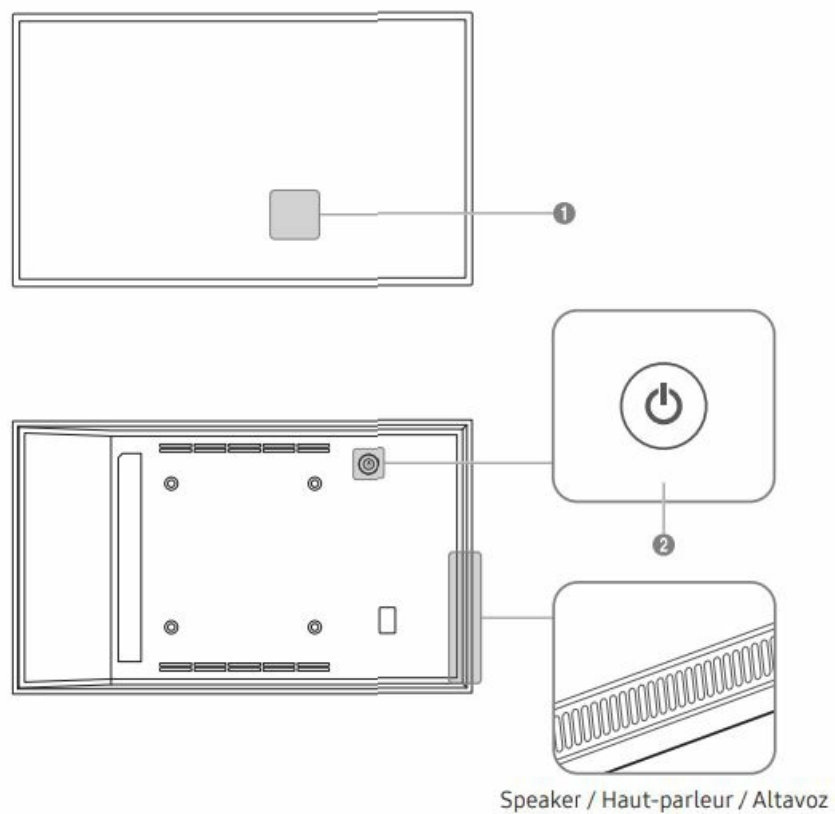

1. Remote sensor

- Press a button on the remote control pointing at the sensor on the front of the product to perform the corresponding function.
- Using other display devices in the same space as the remote control of this product can cause the other display devices to be inadvertently controlled.

2. Power button

- Turns the product on or off.

Ports

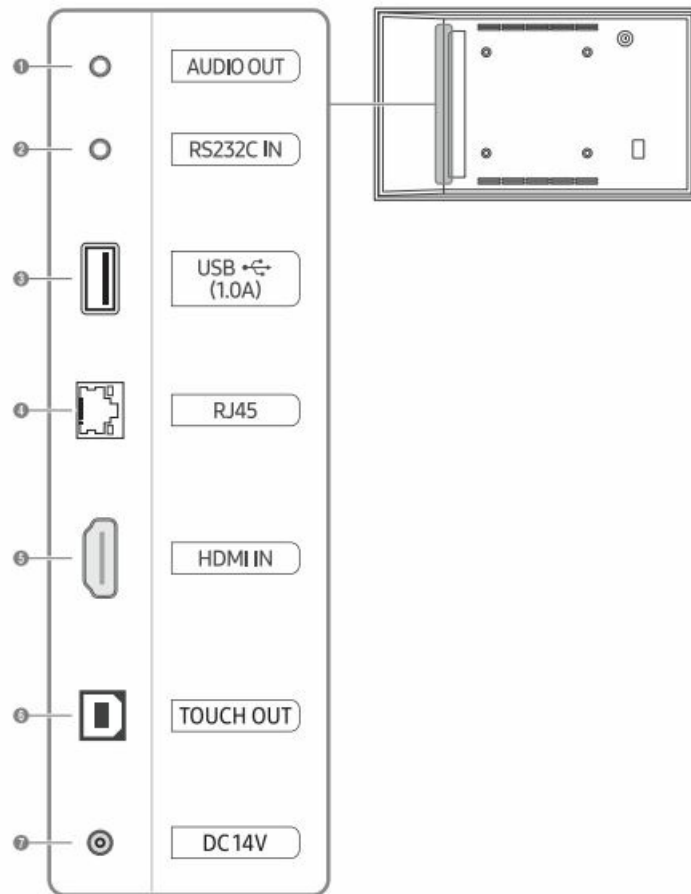

1. Outputs sound to an audio device via an audio cable.
2. Connects to MDC using an RS232C adapter.
3. Connect to a USB memory device.
 - The USB ports on the product accept a maximum constant current of 1.0A. If the maximum value is exceeded, USB ports may not work.
4. Connects to MDC and the Internet using a LAN cable. (10/100 Mbps)
 - Use Cat7(*STP Type) cable for the connection.
 - Shielded Twisted Pair.
5. Connects to a source device using a HDMI cable or HDMI-DVI cable.
6. Connects to a PC using a TOUCH OUT cable to enable touch functions.
 - **Supported model:** QB13R-TM
7. Connects to the AC/DC adapter.

Administrator menu (Supported model: QB13R-TM)

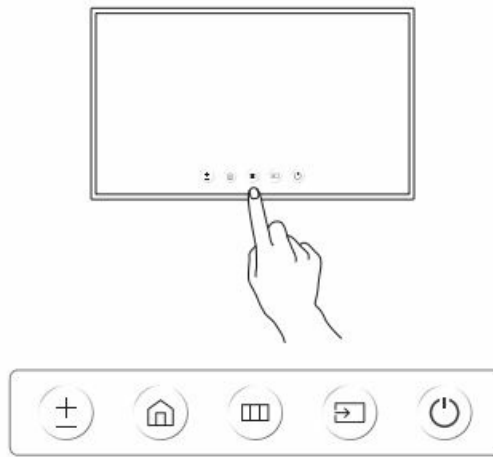

- Touching and holding on the screen when the product is turned on displays the administrator menu.
- If the touchscreen control is not available, use the remote control to go to System → Touch Control → Touch Control and select On from the OSD menu.
- Go to Device to Control and select Samsung SMART Signage or Auto.
- If the administrator menu is not displayed, use the remote control to go to System → Touch Control → Admin Menu Lock and select Off from the OSD menu.
- The administrator menu may not work properly when connecting a source device.

Troubleshooting

Issues	Solutions
The screen keeps switching on and off.	Check that the cable between the product and the PC is connected correctly.
No Signal is displayed on the screen.	Check that products (including source devices) are connected correctly with a cable.
	Check that the source device connected to the product is powered on.
	Depending on the type of external device, the screen may not display properly. In this case, connect it with the HDMI Hot Plug function turned On .
Not Optimum Mode is displayed.	This message is displayed when a signal from the graphics card exceeds the product's maximum resolution and frequency.
	Refer to the Standard Signal Mode Table and set the maximum resolution and frequency according to the product specifications.

Connecting and Using

Connecting and Using a Source Device

- **Connecting to a PC**

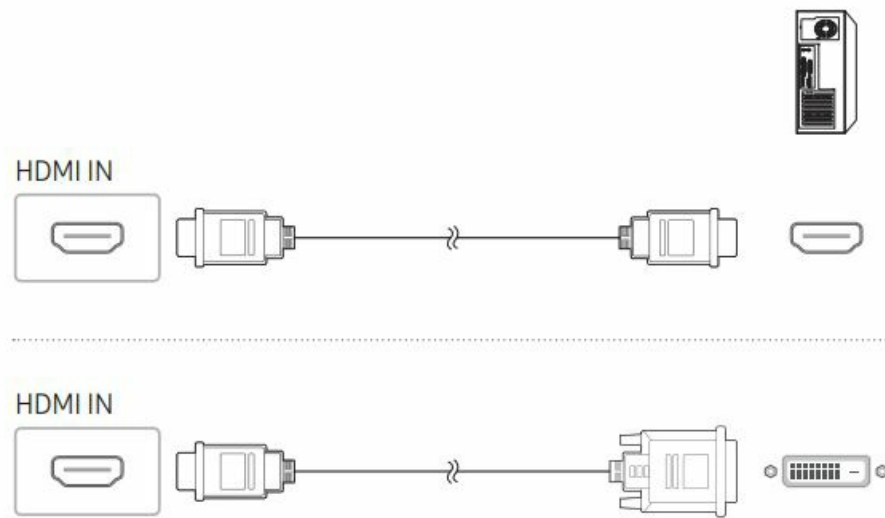

- **Connecting to a Video Device**

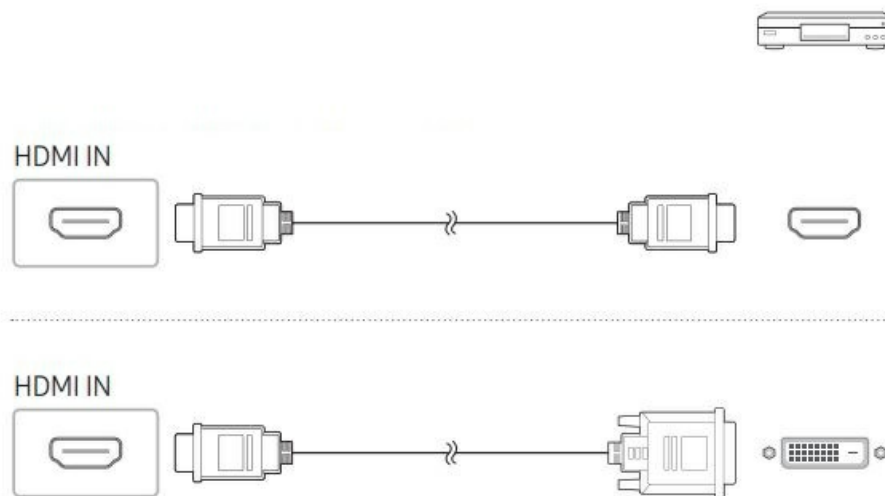

- **Connecting to an Audio System**

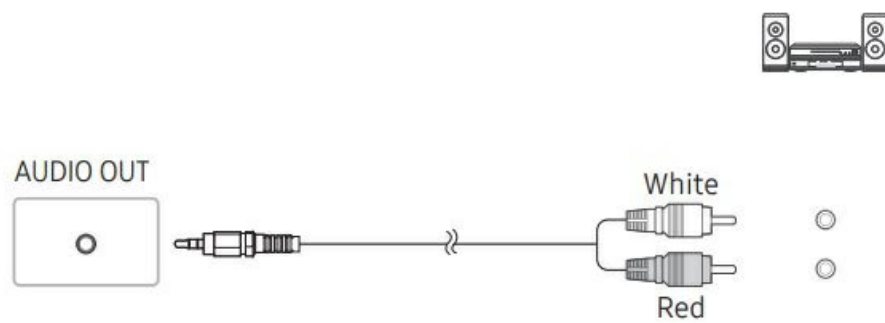

- **Connecting the LAN Cable**

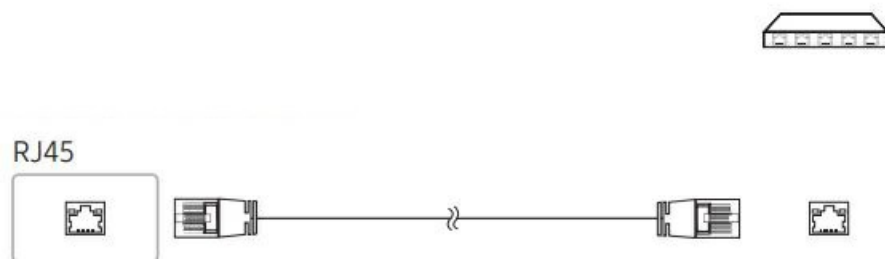

- **Connecting to MDC**

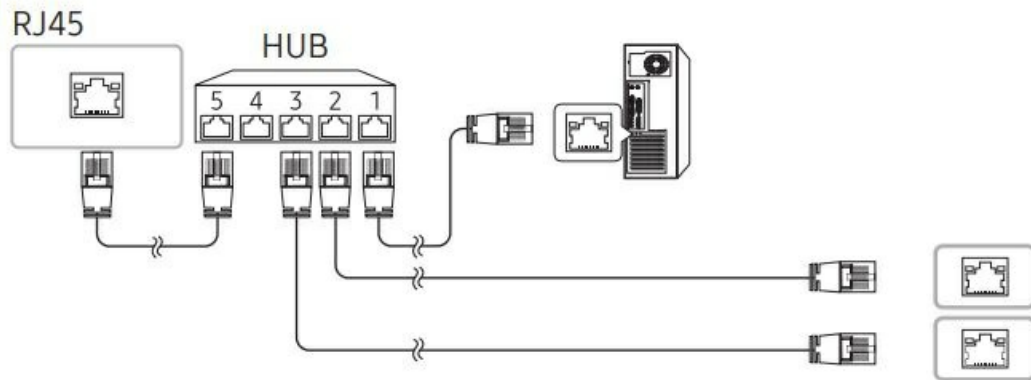

- For details on how to use the MDC program, refer to Help after installing the program.
- The MDC program is available on the website.
- <http://www.samsung.com/displaysolutions>.

Specifications

Model Name		QB13R-M / QB13R-TM
Panel	Size	13 CLASS (13.27 inches / 33.7 cm)
	Display area	295.37 mm (H) x 166.49 mm (V)
Power Supply		AC100-240V~ 50/60Hz Based on the AC voltage of the adapter. For the DC voltage of the product, refer to the product label.
Environmental considerations	Operating	Temperature: 32 °F – 104 °F (0 °C – 40 °C) Humidity: 10% – 80%, non-condensing
	Storage	Temperature: -4 °F – 113 °F (-20 °C – 45 °C) Humidity: 5% – 95%, non-condensing

- This device is a Class B digital apparatus.
- For detailed device specifications, visit the Samsung Electronics website.

Wall Mount Kit Specifications

① Model Name	QB13R-M / QB13R-TM	
② VESA screw hole specs (A * B) in millimeters	100 x 100	
③ C	5-7 mm (0.5-0.7 cm)	
④ Standard Screw	M4	
⑤ Quantity	4	

Contact **SAMSUNG WORLDWIDE**

Website: <http://www.samsung.com>.

Country/Area	Customer Care Center
U.S.A	1-800-SAMSUNG (726-7864)
CANADA	1-800-SAMSUNG (726-7864)
ARGENTINA	0800-555-SAMS (7267)
BOLIVIA	800 107 260
BRAZIL	0800 555 0000 (Demais cidades e regiões) 4004-0000 (Capitais e grandes centros)
CHILE	800 726 786
COLOMBIA	Bogotá en el 600 12 72 Sin costo en todo el país 01 8000 112 112 Y desde tu celular #726
COSTA RICA	00-800-1-SAMSUNG (726-7864)
DOMINICAN REPUBLIC	1-800-751-2676
ECUADOR	1-800-SAMSUN (72-6786)
EL SALVADOR	8000-SAMSUNG (726-7864)
GUATEMALA	1-800-299-0033
HONDURAS	800-2791-9111
JAMAICA	1-800-SAMSUNG (726-7864)
MEXICO	800-SAMSUNG
NICARAGUA	001-800-5077267

PANAMA	800-0101
PARAGUAY	0800-11-SAMS (7267)
PERU	080077708 Desde teléfonos fijos, públicos o celulares
PUERTO RICO	1-800-682-3180
TRINIDAD & TOBAGO	1-800-SAMSUNG (726-7864)
URUGUAY	0800-SAMS (7267)
VENEZUELA	0-800-100-5303

- General Mariano Escobedo 476, Piso 8 Col.
- Anzures, Alcaldía Miguel Hidalgo, Ciudad de México CP. 11590
- **TEL:** (55) 5747-5100 / 800 726 7864

The terms HDMI, HDMI High-Definition Multimedia Interface, HDMI trade dress and the HDMI Logos are trademarks or registered trademarks of HDMI Licensing Administrator, Inc.

Documents / Resources

	SAMSUNG QB13R-M Interactive Display [pdf] User Guide QB13R-M, QB13R-M Interactive Display, Interactive Display, Display, QB13R-TM
---	--

References

- [S Samsung US | Mobile | TV | Home Electronics | Home Appliances | Samsung US](#)
- [S Displays | SMART Signage, Business Monitors | Samsung Business UK](#)
- [User Manual](#)

[Manuals+](#), [Privacy Policy](#)

This website is an independent publication and is neither affiliated with nor endorsed by any of the trademark owners. The "Bluetooth®" word mark and logos are registered trademarks owned by Bluetooth SIG, Inc. The "Wi-Fi®" word mark and logos are registered trademarks owned by the Wi-Fi Alliance. Any use of these marks on this website does not imply any affiliation with or endorsement.