



SAMSON SM4 4-Channel Mixer Interface with Bluetooth Owner's Manual

[Home](#) » [SAMSON](#) » SAMSON SM4 4-Channel Mixer Interface with Bluetooth Owner's Manual 

SAMSON

MEDIA TRACK USB MIXER/INTERFACE WITH BLUETOOTH



Contents

- [1 Important Safety Information](#)
- [2 Introduction](#)
- [3 Features](#)
- [4 Front Panel callouts](#)
- [5 Quick Start](#)
- [6 Pairing with a Bluetooth® device](#)
- [7 Specifications](#)
- [8 Documents / Resources](#)
- [9 Related Posts](#)

Important Safety Information



ATTENTION RISQUE DE CHOC ELECTRONIQUE -NE PAS OUVRIR



This lightning flash with an arrowhead symbol within an equilateral triangle is intended to alert the user to the presence of non-insulated “dangerous voltage” within the product’s enclosure that may be of sufficient magnitude to constitute a risk of electric shock.



The exclamation point within an equilateral triangle is intended to alert the user to the presence of important operating and maintenance instructions in the literature accompanying the appliance.

WARNING: TO REDUCE THE RISK OF ELECTRIC SHOCK, DO NOT REMOVE COVER (OR BACK) AS THERE ARE NO USER-SERVICEABLE PARTS INSIDE. REFER SERVICING TO QUALIFIED SERVICE PERSONNEL.

The Bluetooth word mark and logos are registered trademarks owned by Bluetooth SIG, Inc. and any use of such marks by Samson Technologies is under license. Other trademarks and trade names are those of their respective owners?



If you want to dispose of this product, do not mix it with general household waste. There is a separate collection system for used electronic products in accordance with legislation that requires proper treatment, recovery, and recycling. In Private household in the 28 member states of the EU, in Switzerland and Norway may return their used electronic products free of charge to designated collection facilities or to a retailer (if you purchase a similar new one). For Countries not mentioned above, please contact your local authorities for a correct method of disposal. By doing so you will ensure that your disposed product undergoes the necessary treatment, recovery and recycling and thus prevent potential negative effects on the environment and human health.

MEDIA TRACK MIXER

1. Read these instructions.
2. Keep these instructions.
3. Heed all warnings.
4. Follow all instructions.
5. Do not use this apparatus near water.
6. Clean only with a dry cloth.
7. Do not block any ventilation openings. Install in accordance with the manufacturer’s instructions.
8. Do not install near any heat sources such as radiators, heat registers, stoves, or other apparatus (including amplifiers) that produce heat.
9. Do not defeat the safety purpose of the polarized or grounding-type plug. A polarized plug has two blades with one wider than the other. A grounding-type plug has two blades and a third grounding prong. The wide blade or the third prong are provided for your safety. If the provided plug does not fit into your outlet, consult an electrician for replacement of the obsolete outlet.
10. Protect the power cord from being walked on or pinched particularly at the plugs, convenience receptacles, and at the point where they exit from the apparatus.
11. Only use attachments/accessories specified by the manufacturer.
12. Use only with the cart, stand, tripod, bracket, or table specified by the manufacturer, or sold with the apparatus. When a cart is used, use caution when moving the cart/apparatus combination to avoid injury from tip-over.



13. Unplug the apparatus during lightning, short circuit or when unused for long periods of time.
14. Refer all servicing to qualified personnel. Service is required when the apparatus has been damaged in any way, such as power supply cord or plug is damaged, liquid has been spilled or objects have fallen into the apparatus has been exposed to rain or moisture, does not operate normally, or has been dropped.
15. This appliance shall not be exposed to dripping or splashing water and that no object filled with liquid such as vases shall be placed on the apparatus.
16. Caution – to prevent electrical shock, match wide blade plug to wide outlet slot fully insert the plug into the outlet.
17. Please keep a good ventilation environment around the entire unit.
18. **WARNING:** The direct plug-in adapter or AC/DC adapter is used as a disconnect device, the disconnect device shall remain readily operable.
19. No naked flame sources, such as lighted candles, should be placed on the apparatus.
20. This apparatus is intended to be used in moderate and/or tropical climates.

FCC Notice

1. This device complies with Part 15 of the FCC Rules. Operation is subject to the following two conditions: (1) This device may not cause harmful interference. (2) This device must accept any interference received, including interference that may cause undesired operation.
2. Changes or modifications not expressly approved by the party responsible for compliance could void the user's authority to operate the equipment.

FCC Statement

This equipment has been tested and found to comply with the limits for a Class B digital device, pursuant to Part 15 of the FCC Rules. These limits are designed to provide reasonable protection against harmful interference in a residential installation. This equipment generates uses and can radiate radio frequency energy and, if not installed and used in accordance with the instructions, may cause harmful interference to radio communications. However, there is no guarantee that interference will not occur in a particular installation. If this equipment does cause harmful interference to radio or television reception, which can be determined by turning the equipment off and on, the user is encouraged to try to correct the interference by one or more of the following measures:

- Reorient or relocate the receiving antenna.
- Increase the separation between the equipment and receiver.
- Connect the equipment into an outlet on a circuit different from that to which the receiver is connected.
- Consult the dealer or an experienced radio/TV technician for help.

FCC Radiation Exposure Statement

This equipment complies with FCC RF radiation exposure limits set forth for an uncontrolled environment. This equipment should be installed and operated with a minimum distance of 20 centimeters between the radiator and your body.

RF Warning Statement

This device complies with RSS 310 of Industry Canada. Operation is subject to the condition that this device does not cause harmful interference. Hereby, Samson Technologies Corp. declares that this MEDIA TRACK is in compliance with the essential requirements and other relevant provisions of Directive 2014/53/EU. The declaration of conformity may be consulted at:

Introduction

Thank you for purchasing the Samson MediaTrack USB Mixer/Interface. The MediaTrack rack mounts USB mixer is a versatile tool for many sound and recording applications. It features microphone and music inputs, Bluetooth connectivity for streaming audio, and a USB jack for connecting an optional Samson XPD USB Digital Wireless System. In the box, you'll find a registration card enclosed—please don't forget to follow the instructions so that you can receive online technical support and so we can send you updated information about this and other Samson products in the future. Also, be sure to check out our website (www.samsontech.com) for information about our full product line. We recommend you keep the following records for reference, as well as a copy of your sales receipt.

Serial number:.....

Date of purchase:.....

If you have any questions or comments regarding the MediaTrack or any other products from Samson, do not hesitate to contact us at support@samsontech.com. With proper care and maintenance, your MediaTrack will operate trouble-free for many years. Should your MediaTrack ever require servicing? a Return Authorization (RA) Number must be obtained before shipping your unit to Samson. Without this number, the unit will not be accepted. Please visit www.samsontech.com/ra for an RA number prior to shipping your unit. Please retain the original packing materials and, if possible, return the unit in its original carton. If your MediaTrack was purchased outside of the United States, contact your local distributor for warranty details and service information.

Features

- 4-channel stereo line mixer
- USB Interface for connecting with computers or tablets
- XLR-1/4" balanced microphone input
- Stereo line channel with RCA, 1/4", and 1/8" (3.5mm) inputs
- Bluetooth connectivity to wirelessly stream from a mobile device
- Samson XPD Wireless USB Port (system sold separately)
- Voiceover priority ducking with variable hold time
- 15V phantom power
- Rackmount kit and power adapter included

Front Panel callouts

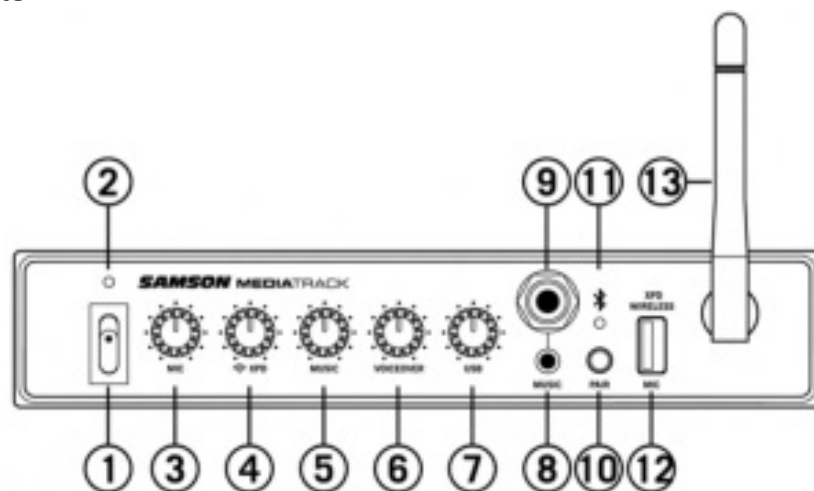

1. **Power Switch** – Use this switch to turn the MediaTrack on and off. To avoid potential damage to your speakers, turn the MediaTrack on before you turn on any connected power amps, and turn it off after the power amps are turned off.

2. **Power Indicator** – LED lights green indicating the unit is powered on.
3. **MIC Volume** – This knob controls the level of the MIC input.
4. **XPD Level** – This knob controls XPD Wireless volume level.
4. **MUSIC Volume** – This knob controls the level of the Music inputs (rear panel RCA, front panel 1/4" and 1/8") and the Bluetooth audio.
5. **VOICEOVER** – Controls the amount the Music and Bluetooth audio will be lowered (ducking) when there is a signal present at the Mic channel.
6. **USB Level** – Controls volume of USB computer audio stream to the MediaTrack audio outputs.
7. **1/8" (3.5mm) Music Input** – Stereo 1/8" (3.5mm) jack to connect line-level sources. The level of this input is controlled by the MUSIC Volume knob.
8. **1/4" Music Input** – Stereo 1/4" jack to connect line level sources. The level of this input is controlled by the MUSIC Volume knob.
9. **Pairing Indicator** – Displays the Bluetooth status of the MediaTrack.
10. **Pairing Button** – Press and hold this button to enable discoverable mode in order to pair with a Bluetooth audio device. The LED will blink quickly when the discoverable mode is enabled.
11. **Samson XPD WIRELESS USB Input** – Connect an optional Samson XPD USB Digital Wireless receiver to this input. The wireless level is controlled by the XPD Volume control.
12. **Bluetooth Antenna** – This antenna receives the signal from a paired device and should be placed in a vertical position when using Bluetooth. The Bluetooth receiver has a range of approximately 100' (30m).

Real Panel callouts

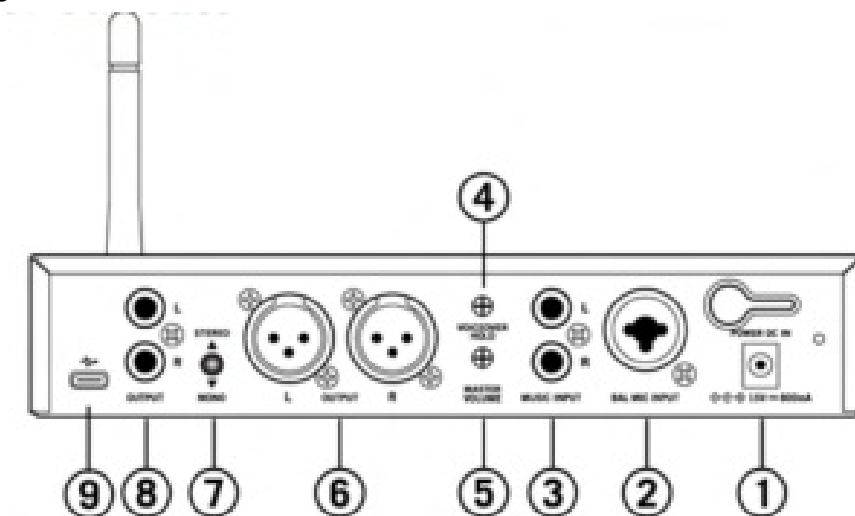

1. **DC Input** – Connect the supplied power adapter here, using the strain relief* as shown in the illustration below.
WARNING: Do not substitute any other kind of power adapter. Doing so can cause severe damage to the MediaTrack and will void your warranty.
2. **BAL MIC INPUT** – Use this Combo XLR plus 1/4" jacks to connect a microphone or wireless microphone receiver. The XLR input provides 15-volt phantom power for use with condenser microphones.
3. **Stereo RCA MUSIC INPUT** – Stereo line-level input for connecting the output of devices such as MP3, CD, or any line level audio device using standard RCA cables.
4. **VOICEOVER HOLD** – This knob controls the hold time of the VOICEOVER priority ducking from 0.5s-3s.
5. **MASTER VOLUME** – The MASTER VOLUME knob controls the overall output level. This knob determines the final output signal level. Signals from all channels are routed here just before being routed to the OUTPUT jacks.

6. **Balanced XLR OUTPUT** – Balanced XLR outputs to connect the MediaTrack to a power amplifier or speakers. In recording applications, these outputs can be used to connect to a stereo device such as a computer sound card, MP3, or hard disk recorder. The signal at the OUTPUT jacks follows the MASTER VOLUME control.
7. **STEREO / MONO Switch** – When the switch is in the out, STEREO position, the left, and right signals are routed to the corresponding outputs. In the in, MONO, position, the left, and right input signals are summed together and fed to both Left and Right OUTPUT jacks.
8. **Unbalanced RCA OUTPUT** – Unbalanced RCA outputs to connect the MediaTrack to a power amplifier or speakers. In recording applications, these outputs can be used to connect to a stereo device such as a computer sound card, MP3, or hard disk recorder. The signal at the OUTPUT jacks follows the MASTER VOLUME control.
9. **USB C OUTPUT** – Using the supplied USB C cable connect your laptop or tablet to record your performance. Adjust the input level with the USB control knob on the front panel.

“Using the strain relief: Gather up a loop of wire and pass it through the strain relief, then pass the adapter plug through the loop in order to create a knot



Quick Start

1. Remove all packing materials and decide where the unit is to be physically placed. The MediaTrack can be mounted in any standard 19" rack (requiring one rack space), or used on a tabletop.
 2. Before connecting a microphone or line-level audio device, make sure that the power to all your systems components, including the MediaTrack, is turned off.
 3. Using an XLR or 1/4" cable, connect a wired microphone or the output of a wireless microphone receiver to the Mic input jack on the rear of the MediaTrack.
 4. Connect a music source, like a CD player, to the RCA jacks on the rear panel of the MediaTrack. The red connector is the right input and the white connector is the left input. Portable audio devices, like an MP3 player, can be connected to the 1/4" or 1/8" stereo inputs on the front of the MediaTrack.
 5. Connect the outputs of the MediaTrack to the inputs of a power amplifier or speaker system using XLR or RCA cables.
 6. Turn the MediaTrack Master Volume control all the way down and turn the MediaTrack power on.
- NOTE:** It is important to remember the Golden Rule of audio ... "LAST ON, FIRST OFF". Translated, this

means that when turning on your system, you should always turn your power amplifiers or powered monitors on LAST, and when turning your system off, turn your power amps off FIRST. This helps avoid any loud pops caused by inrush current at power-up, which can sometimes damage loudspeakers.

7. Turn the power amplifier or speaker system on and turn the volume up.
8. Set the MIC volume control of the MediaTrack to the 12 o'clock position.
9. While talking into the microphone, raise the MASTER VOLUME control until you have reached the desired level.
10. Play music from the connected music source and raise the MUSIC volume control. Adjust the MIC and MUSIC volume until the microphone signal is able to be heard above the music.

Avoiding Feedback

Feedback is the annoying howling and squealing that can be heard when the microphone picks up sound from the speaker. The sound is then re-amplified back through the speaker again, creating a feedback loop. Follow these steps to minimize the likelihood of feedback:

- Avoid pointing the microphone directly at the speakers. In general, it is recommended that the microphone be positioned behind the speaker enclosure. This uses the directional characteristics of the speaker and microphone to your advantage.
- Keep the microphone as far from the speakers as possible. This will help achieve isolation between the speaker and the microphone.
- Position the microphone as close to the sound source as possible. This will enable the microphone to pick up more direct sound and allow you to reduce the microphone input gain control.

Pairing with a Bluetooth® device

Bluetooth is a wireless communication technology that allows for connectivity between a wide range of devices. The MediaTrack uses Bluetooth to stream high-quality audio from your Bluetooth-enabled device without the need for connecting any cables. In order for your device to work with the MediaTrack, it must first be paired.

1. With the MediaTrack and your Bluetooth device powered on, press and hold the PAIR button on the front panel of the MediaTrack mixer to make the mixer discoverable. The white Bluetooth indicator will flash slowly.
2. In the settings of your Bluetooth device, set it to "discover" available devices.
3. From the Bluetooth device list, select the "SAMSON BLUETOOTH" device.
4. If your device asks for a passkey, enter digits 0000 (four zeros) and press OK. Some devices may also ask you to accept the connection.
5. As the MediaTrack is connecting to your device, the Bluetooth indicator will quickly flash white.
6. The MediaTrack indicates that pairing is complete when the indicator turns steady white. You can now stream audio from your device to the MediaTrack.
7. On your Bluetooth device, set the volume to the maximum setting and start playing music.
8. Use the MUSIC volume knob on the front panel of the MediaTrack to set the desired level of the Bluetooth audio.

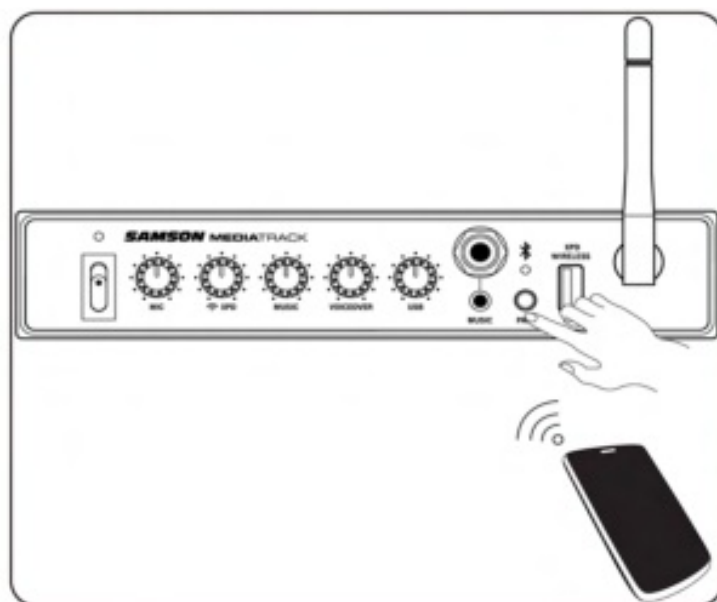

Specifications

Frequency Response (to XLR balanced output, re +4 dBu output) Music Inputs (1/4", 1/8", RCA) XLR Mic Input Bluetooth USB Playback	20Hz-20kHz, +0/-0.5dB 73.5Hz-20kHz, +0/-3dB 20Hz-20kHz, +0/-3dB 12.4Hz-18.2kHz, +0/-1dB
THD+N (to XLR balanced output, re +4 dBu output) Music Inputs (1/4", 1/8", RCA) XLR Mic Input Bluetooth USB Playback	<0.004%, 25Hz-17kHz <0.006%, 75.5Hz-20kHz <0.01%, 20Hz-20kHz <0.005%, 20Hz-20kHz
Equivalent Input Noise XLR Mic Input	-108dBu, A-weighted, (1% THD+N output), 1kHz
Maximum Gains (to XLR balanced output, master volume maximum, 1kHz test tone) Music inputs (1/4", 1/8", RCA) XLR mic input Samson XPD System Bluetooth USB playback	20.5dB, 200 source 51.6dB, 1500 source 43.1dB, 200 source 20.3dB 11.9dB

Residual Noise (A-weighted, all controls minimum) XLR OUT RCA OUT USB recording	-113.8dBu -113.8dBu -96dBFS
Minimum input Level (1%THD+N) Misc inputs (1/4",1/8",RCA) XLR mic input	+5.46dBu, 9Hz-7kHz, -D+N, 1500 source
Maximum Output Level (1% THD+N) MIC Output +14.7 dBu (1% THD+N)	
Dynamic Range XLR Out RCA Out	95dB, re +15dBu output 100dB, re +15dBu output
Input Impedance (1kHz test tone) Music Inputs (1/5",1/8",RCA) XLR Mic Input	10k Ω 1.6k Ω
Output Impedance (1 kHz test tone) XLR Out RCA Out	400 Ω 200 Ω
Voiceover Attack Time Hold Time Release Time Maximum gain reduction	8ms 250ms (shortest setting) 485ms 28.6dB

USB C 110 Number of input channels Number of output channels Maximum sample rate Bit depth USB Playback to XLR Output gain USB Output Power Phantom Power Power Adapter Bluetooth Working Frequency RF Power Transmission Range	2 2 48 kHz 16 bits OdBFS = +12dE USB3.0 5VDC 200mA 15VDC 15VDC 800mA V4.0, A2DP 2.402GHz – 2.480GHz <10mW EIRP >10m (>32')
--	---

Dimensions and Weight Dimensions Weight	8.78" x 5.43" x 1.69" 22 1.88 lbs / 0.852 kg
--	---

MEDIA TRACK MIXER
Samson Technologies Corp
278-B Duffy Ave
Hicksville, New York 11801
www.samsontech.com

Documents / Resources

	SAMSON SM4 4-Channel Mixer Interface with Bluetooth [pdf] Owner's Manual MEDIATRACK, CCRMEDIATRACK, SM4 4-Channel Mixer Interface with Bluetooth, 4-Channel Mixer Interface with Bluetooth, Interface with Bluetooth, Bluetooth
---	--