



samsara SC21 Bullet IP Site Camera Installation Guide

[Home](#) » [Samsara](#) » samsara SC21 Bullet IP Site Camera Installation Guide 



Bullet IP Site Camera

INSTALL GUIDE

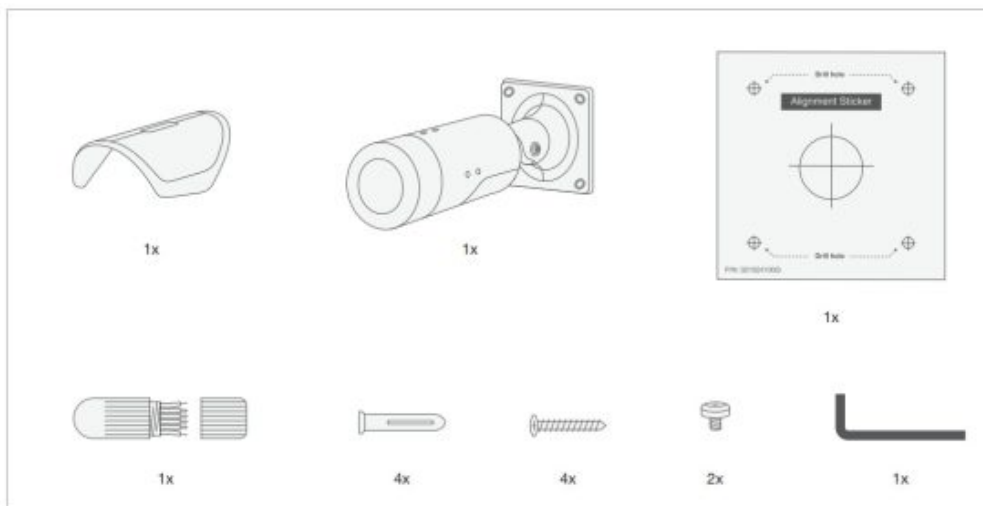

For more details on mounting or additional technical information, visit the Connected Sites knowledge base at samsara.com/support

1

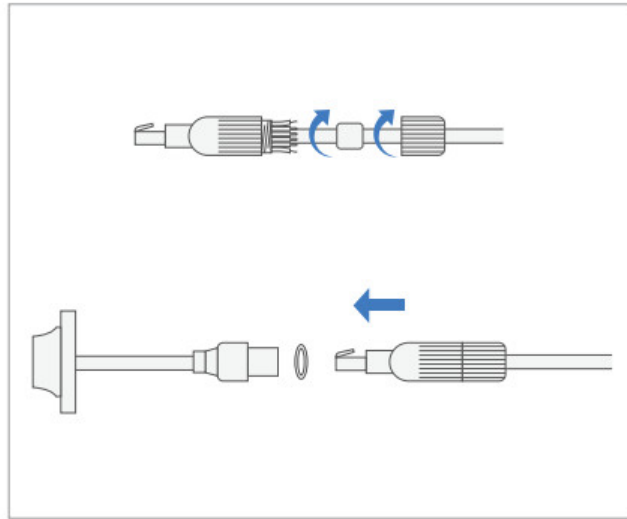

Attach cable gland if used outdoors or in a wet environment.

Note: The SC21 has cabling to support different deployments and features. Only the ethernet cable is necessary for this installation.

2

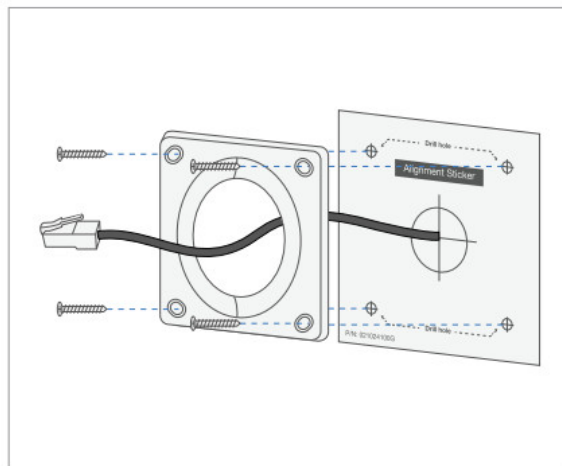

If necessary, install drywall anchors using the alignment sticker for reference. Feed the ethernet cable through the middle opening of the back plate, then fasten the backplate to the mounting surface using the provided screws.

3

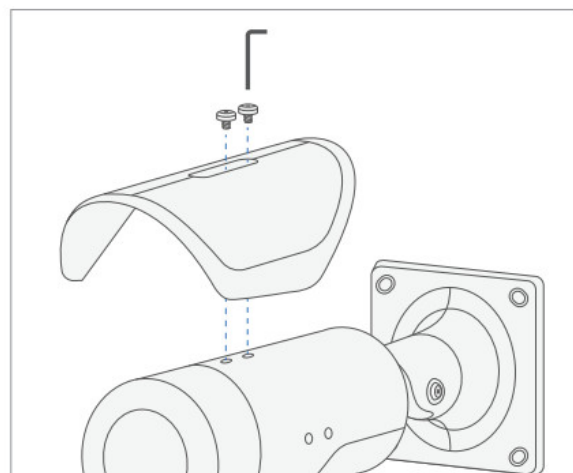

If using the SC21 in an outdoor deployment, attach the sunshield using the provided screws and Torx Driver provided.

4

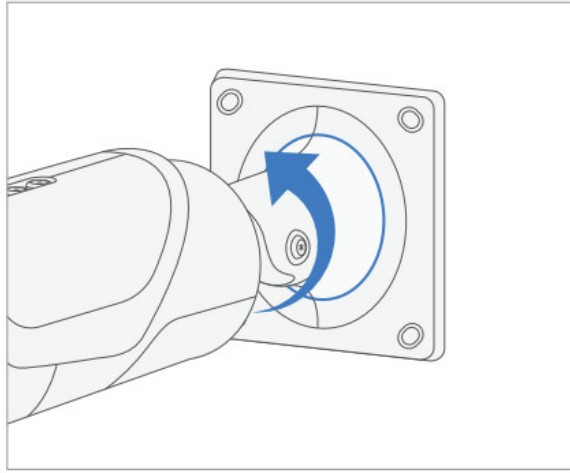

Loosen the fastening ring.

5

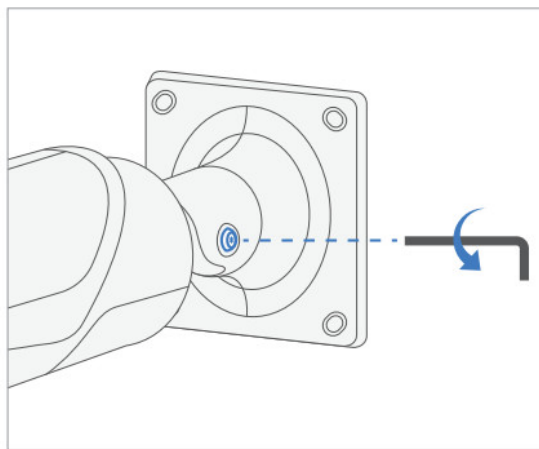

Loosen camera pan screw with Torx driver provided.

6

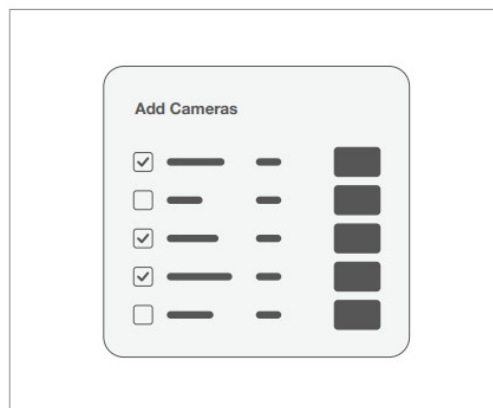

When your camera is plugged into the network, add the camera to your dashboard by going to Devices > Cameras > Add Cameras. You can identify your camera in the results via the serial and/or MAC address printed on the camera's box.

7

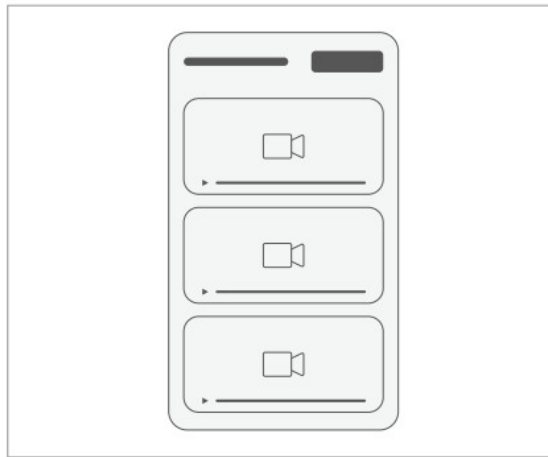

Once added, confirm the camera is positioned correctly by viewing it in the mobile app or dashboard. The next steps demonstrate the different axes you can use to adjust the camera's field of view.

8a

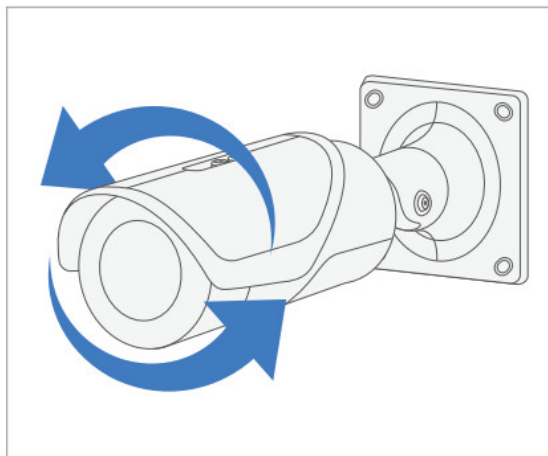

Optional: Twist the camera to rotate.

8b

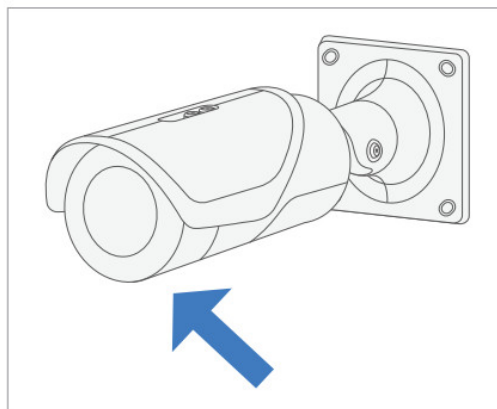

Optional: Tilt camera.

8c

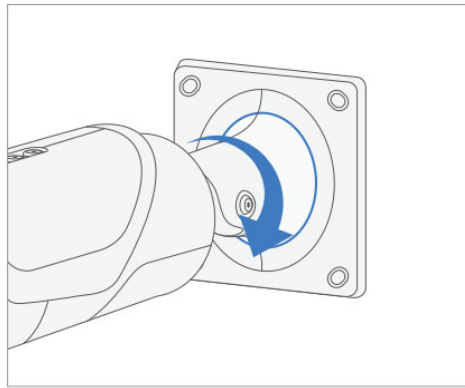

Optional: Tighten the fastening ring.

9

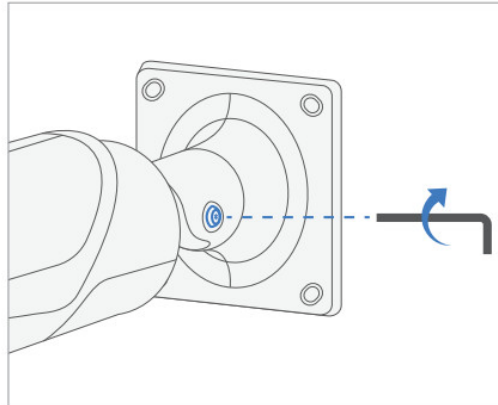

Tighten the camera pan screw with the Torx driver.

samsara.com/support

Contents

[1 Documents / Resources](#)

[2 Related Posts](#)

Documents / Resources

	<p>samsara SC21 Bullet IP Site Camera [pdf] Installation Guide SC21, Bullet IP Site Camera</p>
---	--