



SALUS TS600 Wireless Temperature Sensor Thermostat User Guide

[Home](#) » [SALUS](#) » SALUS TS600 Wireless Temperature Sensor Thermostat User Guide 



Model: TS600
Quick Guide



Contents

- 1 Introduction
- 2 Product Compliance
- 3 Box content
- 4 Mounting
- 5 LED Indication
- 6 Pairing
- 7 Button operation
- 8 Documents / Resources
 - 8.1 References
- 9 Related Posts

Introduction

TS600 is a multi-functional device that can be configured to be a programmable room thermostat or a hot water timer built into a smartly designed casing and it is compatible with the SALUS Smart Home system.

Product Compliance

This product complies with the essential requirements and other relevant provisions of Directives 2014/53/EU and 2011/65/EU. The full text of the EU Declaration of Conformity is available at the following internet address:
www.saluslegal.com



2405-2480MHz; <14dBm



Safety Information

Use in accordance with the regulations. Indoor use only.
Keep your device completely dry. Disconnect your device before cleaning it with a dry cloth.

Box content



Front case



Back case



2x fixing screws



Quick Guide



2x 2AA alkaline batteries

Mounting

1. An external sensor can be connected to the S1 and S2 terminals. Purchased separately.



2. Mount the back case on the wall.



3. Insert the batteries. TS600 will automatically go into pairing mode.



4. Add the front case.



LED Indication

LED	Meaning
Red LED on for 5 seconds	Factory Reset
Green LED flashes 0.25s on and 0.75s off	Identify Mode
Red LED flashes 0.3s on and 0.3s off (3.5s off last cycle) for 10 minutes	Joining network
Amber LED flashes 0.3s on and 0.3s off (3.5s off last cycle) for 10 minutes	Pairing device
Green LED on for 0.5 seconds	Calling heat/cool if the button is pressed
Red LED on for 0.5 seconds	No calling heat/cool if the button is pressed
Red LED flashes 3 times every 10 seconds	Low Battery
Red LED flashes 4 times every 10 seconds	Lost link with the parent
Red LED flashes twice every 10 seconds	Error

Pairing

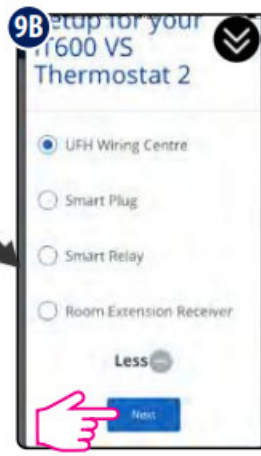
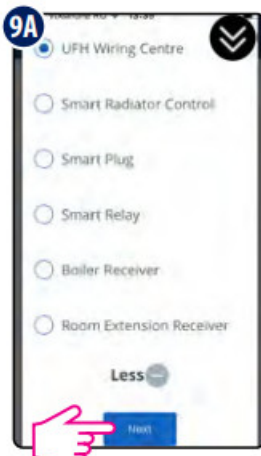
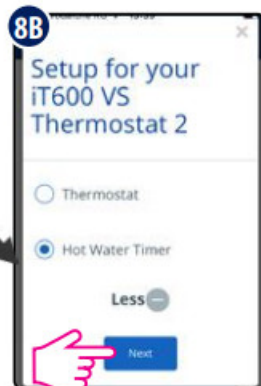
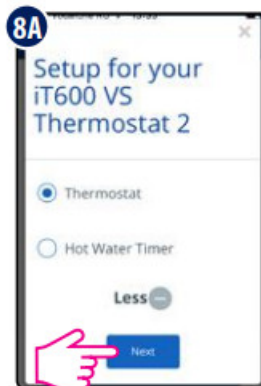
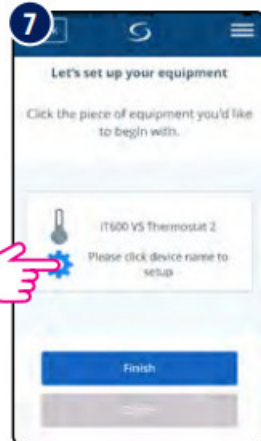
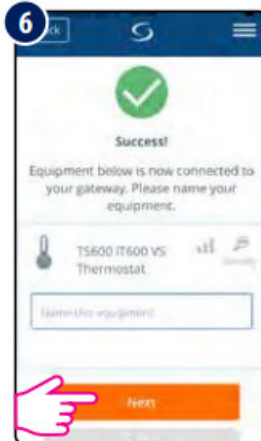
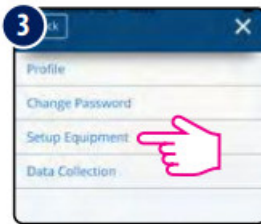
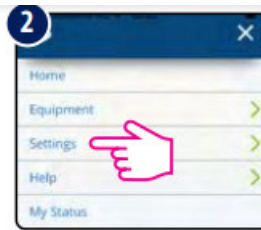
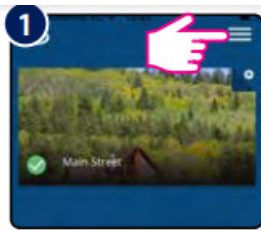

10

Follow the onscreen instructions to complete the setup.

11

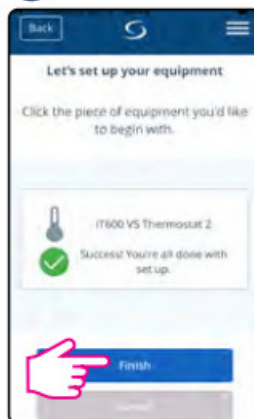

Button operation



Touch sensor area

Press the touch button to see the status of the device. If TS600 is calling for HEAT, the LED will be GREEN. If TS600 is SATISFIED, the LED will be RED.

If TS600 is paired, press and hold the touch button for 3 seconds. TS600 will enter Identify mode and will send Identify commands to all related devices.

TS600 can be locked or unlocked via the app. To unlock the device manually, you need to reset the device first and then press and hold the touch button for 10 seconds during the first minute after reboot. The device will reset again and unlock.

To perform a reset, press and hold the touch button for 10 seconds. The LED will turn red for 5 seconds. TS600 will leave the network and reset. Once completed, the TS600 will re-enter pairing mode.

DISTRIBUTOR OF SALUS CONTROLS:

QL CONTROLS Sp. z o.o., Sp. k.
Rona 4,
43-262 Kobielice,
Poland

Importer:

SALUS Controls Plc
Units 8-10 Northfield Business Park
Forge Way, Parkgate, Rotherham
S60 1SD, United Kingdom

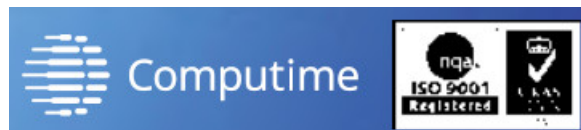





www.salus-controls.eu

SALUS Controls is a member of the Computime Group Maintaining a policy of continuous product development SALUS Controls plc reserves the right to change specifications, design, and materials of products listed in this brochure without prior notice.







Issue date: 2021 01
Version: V001

Documents / Resources

	<p>SALUS TS600 Wireless Temperature Sensor Thermostat [pdf] User Guide TS600, Wireless Temperature Sensor Thermostat, TS600 Wireless Temperature Sensor Thermostat, Temperature Sensor Thermostat, Thermostat</p>
	<p>SALUS TS600 Wireless Temperature Sensor Thermostat [pdf] User Guide TS600, TS600 Wireless Temperature Sensor Thermostat, Wireless Temperature Sensor Thermostat</p>
	<p>SALUS TS600 Wireless Temperature Sensor Thermostat [pdf] User Guide TS600, Wireless Temperature Sensor Thermostat</p>
	<p>SALUS TS600 Wireless Temperature Sensor Thermostat [pdf] User Guide TS600, Wireless Temperature Sensor Thermostat, TS600 Wireless Temperature Sensor Thermostat, Temperature Sensor Thermostat, Sensor Thermostat, Thermostat</p>

References

-  [Salus – Smart Technology for your comfort](#)
-  [Choose your country – Salus](#)
-  [SALUS Controls - intelligent temperature control](#)
-  [Salus – Smart Technology for your comfort](#)
-  [Suelo radiante y Soluciones climáticas - Sysclima](#)