

SALUS



SALUS OS600 Window/Door Sensor Installation Guide

[Home](#) » [SALUS](#) » SALUS OS600 Window/Door Sensor Installation Guide 

Contents

[1 SALUS OS600 Window/Door Sensor](#)

- [1.1 Introduction](#)
- [1.2 Product Compliance](#)
- [1.3 Safety Information](#)
- [1.4 Installation](#)
- [1.5 Factory Reset](#)

[2 Documents / Resources](#)

[3 Related Posts](#)



SALUS OS600 Window/Door Sensor



Introduction

A window/door sensor is a small, wireless piece of equipment that detects when a window / door is open or closed. This product must be used with the Universal Gateway (UG600/UGE600) and the Salus Smart Home App . Go to www.salus-manuals.com for the PDF version of the manual.

Product Compliance

This product complies with the essential requirements and other relevant provisions of Directives 2014/30/EU, 2014/35/EU and 1999/5/EC. The full text of the EU Declaration of Conformity is available at the following internet address: www.saluslegal.com

Safety Information

Use in accordance with the regulations. Indoor use only. Keep your equipment completely dry. Disconnect your equipment before cleaning it with a dry towel.



Installation

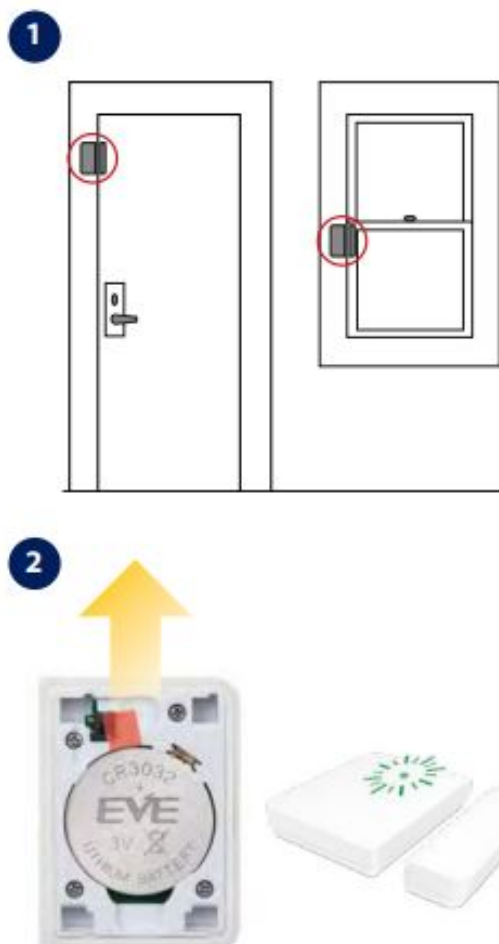

After removing the plastic battery tab, the LED will flash green intermittently.



Follow the on screen instructions. The LED stops flashing completely when Scan for equipment is pressed.



Factory Reset

Keep the reset button pressed when inserting back the battery.





[SALUS OS600 Window/Door Sensor](#) [pdf] Installation Guide

OS600, Window Door Sensor, OS600, Window Sensor, Door Sensor, Sensor

[Manuals+](#)