



## SALUS CSB600 Protective Smart Button Installation Guide

[Home](#) » [SALUS](#) » SALUS CSB600 Protective Smart Button Installation Guide 

### SALUS CSB600 Protective Smart Button Installation Guide



## Contents

- 1 Introduction
- 2 Product Compliance
- 3 Safety Information
- 4 Connecting Instructions
- 5 Assembly And Installation Instructions
- 6 Factory Reset
- 7 Contact Us
- 8 Documents / Resources
  - 8.1 References
- 9 Related Posts

## Introduction

The Protective Smart Button can be used during a panic situation in order to trigger the “One touch” and “My Status” rules that you have created for your Salus Smart Home system . Normally “One touch” and “My Status” rules are triggered via the Salus Smart Home app, however the Smart Button provides an additional Method. This product must be used with the Universal Gateway (UG600/UGE600) and the Salus Smart Home App. Go to [www.salus-smarthome.com](http://www.salus-smarthome.com) for the PDF version of the manual.

## Product Compliance

This product complies with the essential requirements and other relevant provisions of Directive 2014/30/EU, 2014/35/EU, 2014/53/EU and 2011/65/EU.

The full text of the EU Declaration of Conformity is available at the following internet address:  
[www.saluslegal.com](http://www.saluslegal.com).

## Safety Information

- Use in accordance with the regulations.
- Designed to be used exclusively indoor.
- Keep your device completely dry.
- Disconnect your device before cleaning it with a dry towel.

## Connecting Instructions



## Assembly And Installation Instructions

1



2

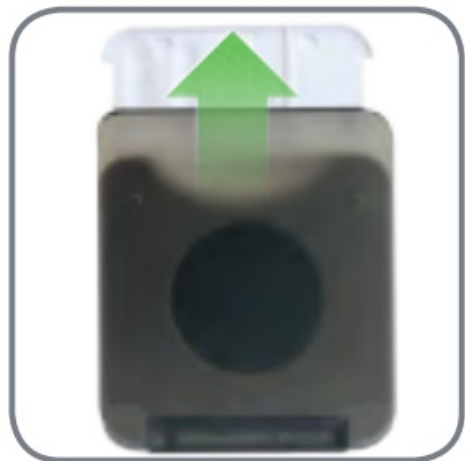

3



4



5



6



7



During initialisation, the LED lights up for 2 seconds, then will flash until the network is found (max 20 times). When joined the LED will go off.

8



9

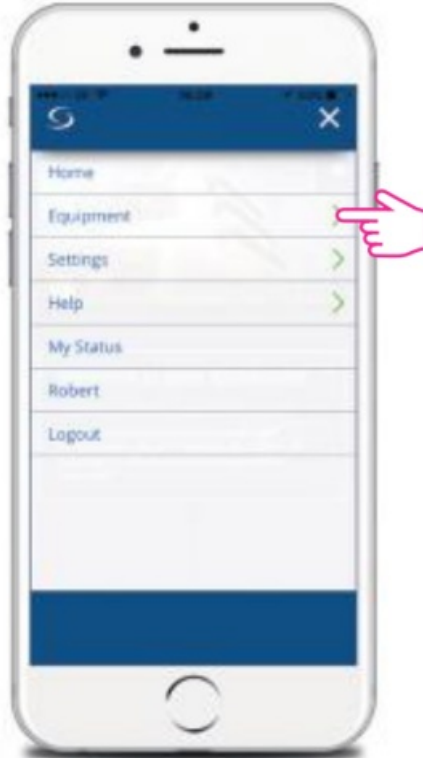

10

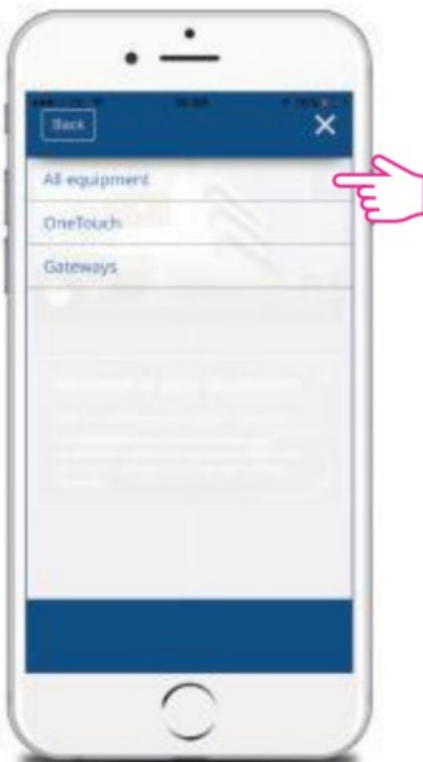

11

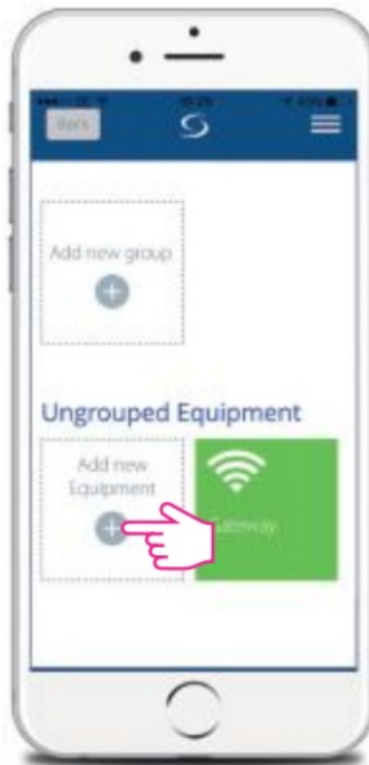

12



Follow the on screen instructions. Once connected, the LED will stop flashing.

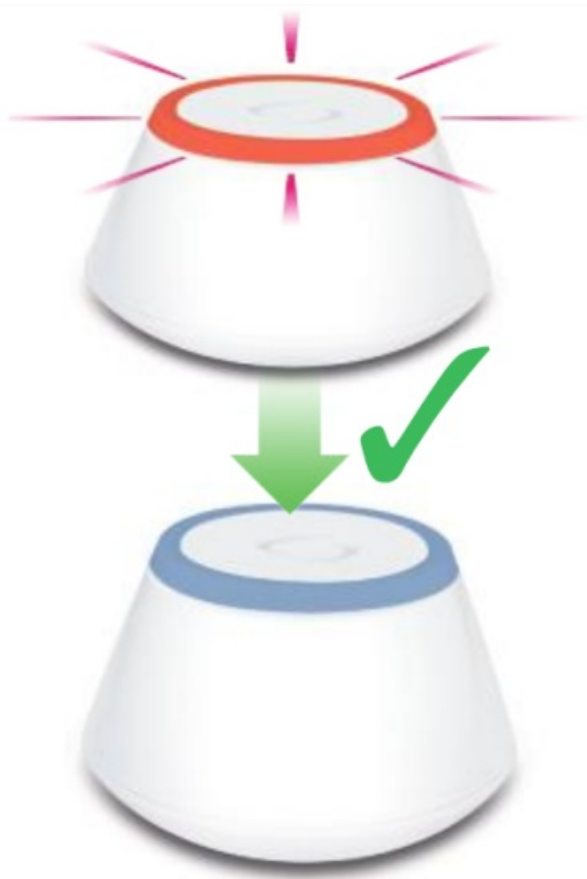

### Factory Reset

Remove one battery. Keep the reset button pressed when inserting back the battery.

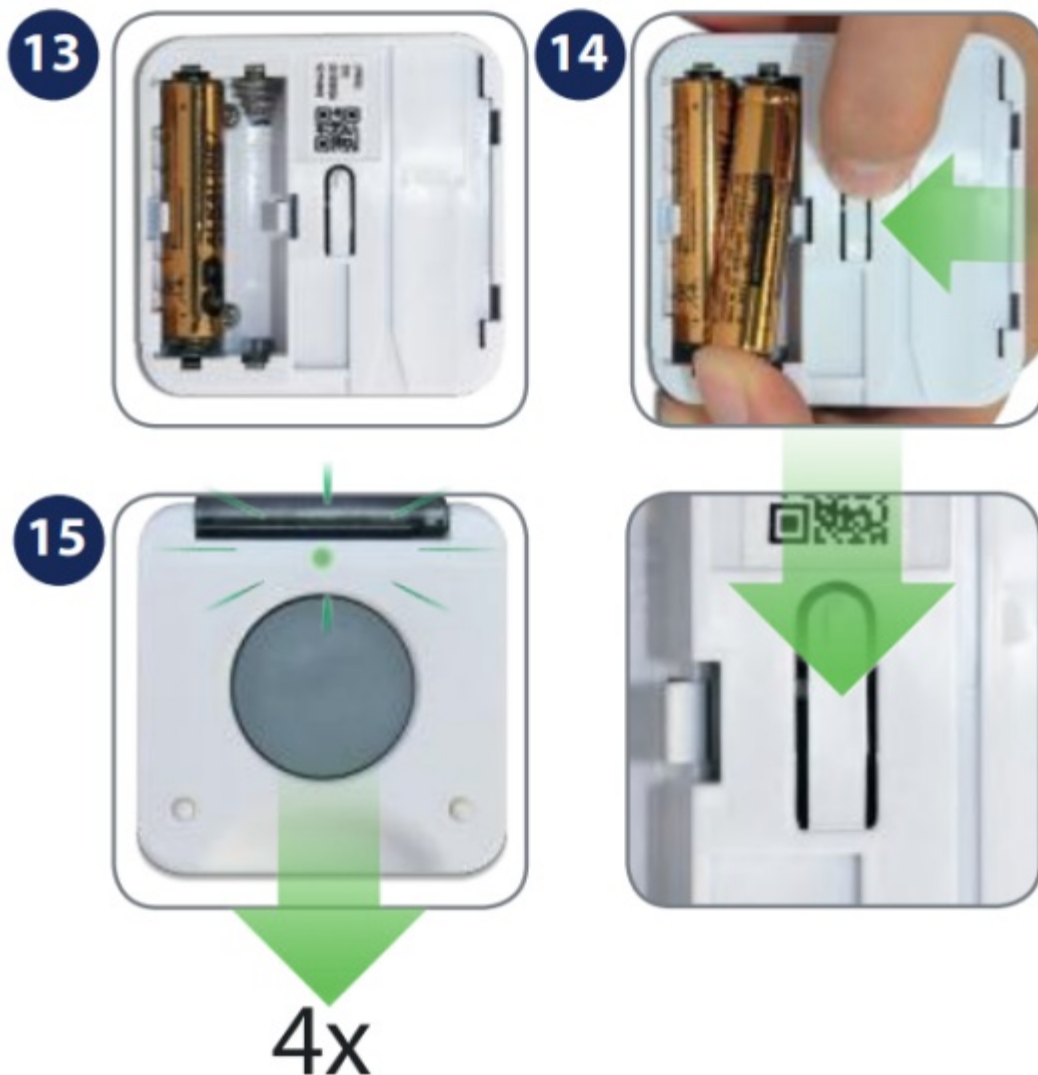

## Contact Us

DE / NL / FR:

[support@salus-controls.de](mailto:support@salus-controls.de)

tel: +49 6108 8258515

UK: [tech@salus-tech.com](mailto:tech@salus-tech.com)

tel: +44 (0) 1226 323961

## Head Office:

SALUS Controls Plc

Units 8-10 Northfield

Business Park

Forge Way, Parkgate,

Rotherham

S60 1SD, United Kingdom

T: +44 (0) 1226 323961

E: [sales@salus-tech.com](mailto:sales@salus-tech.com)

**SALUS Controls is a member of the Computime Group**

Maintaining a policy of continuous product development SALUS Controls plc reserve the right to change specification, design and materials of products listed in this brochure without prior notice.





For PDF Installation guide please go to [www.salus-manuals.com](http://www.salus-manuals.com)



**Documents / Resources**

	<a href="#">SALUS CSB600 Protective Smart Button</a> [pdf] Installation Guide CSB600, Protective Smart Button
-----------------------------------------------------------------------------------	------------------------------------------------------------------------------------------------------------------

**References**

-  [Control4 Smart Homes](#)
-  [Choose your country – Salus](#)
-  [salus-manuals.com](#)
-  [Salus – Smart Technology for your comfort](#)
-  [Salus – Smart Technology for your comfort](#)